

FRONT ELEVATION

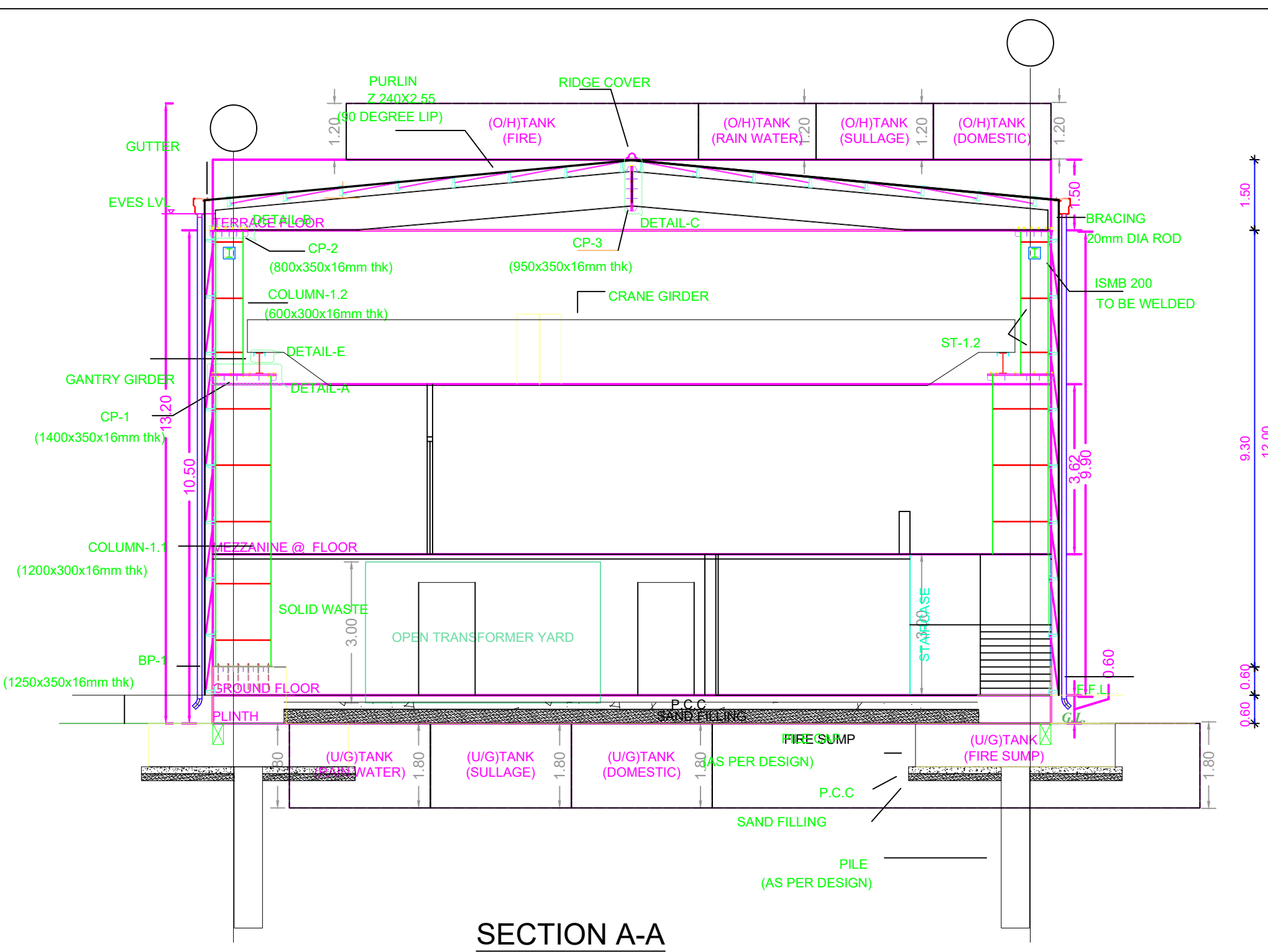

SECTION A-A

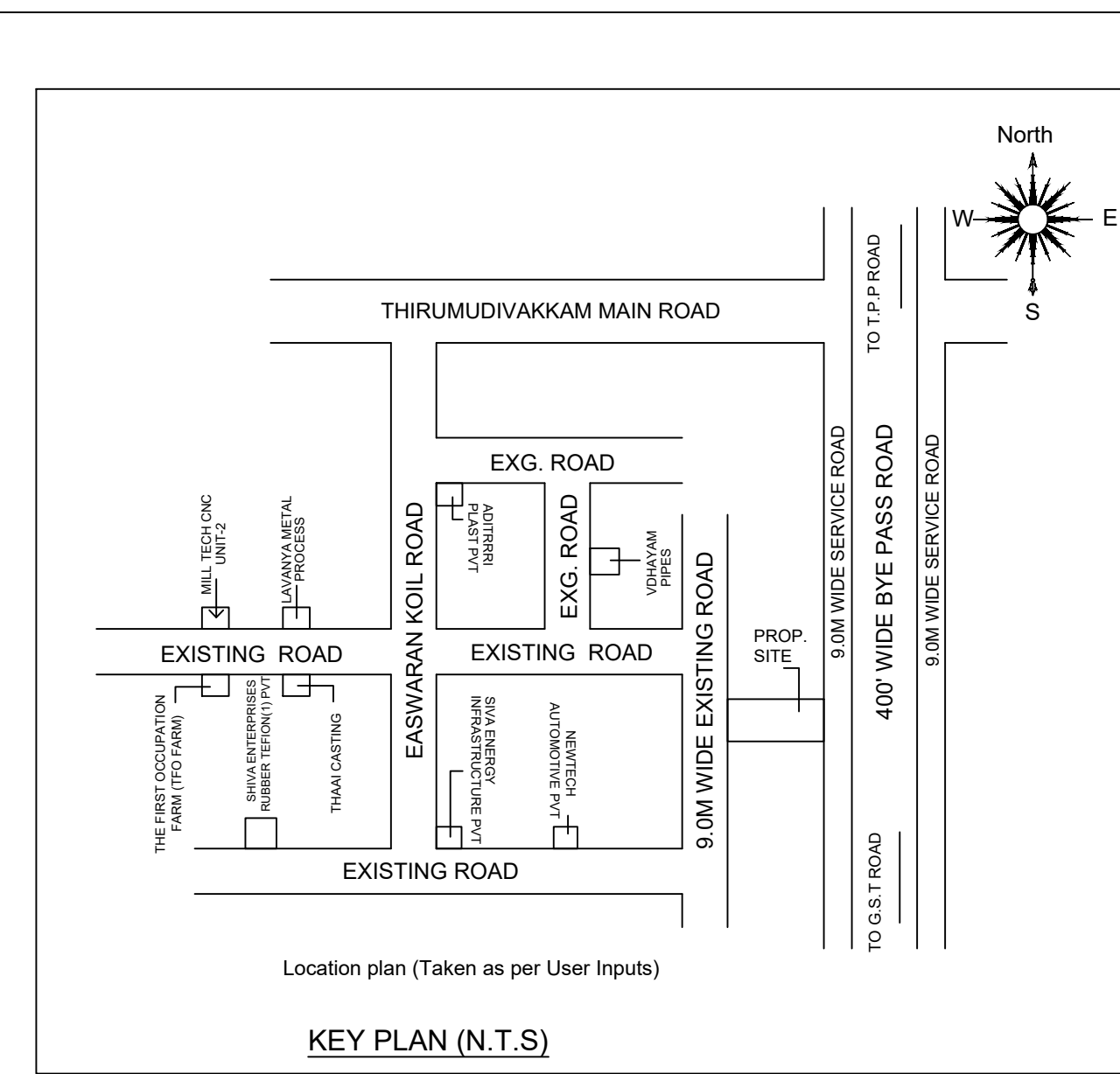

KEY PLAN (N.T.S)

SITE PLAN		SHEET NO. 1/2	
PLAN SHOWING THE PROPOSED CONSTRUCTION OF GROUND FLOOR + MEZZANINE FLOOR (HEIGHT 10.50m) 'PLASTIC INDUSTRIES LIKE INJECTION MOULDING' INDUSTRIAL BUILDING CLASSIFIED AS 'ORANGE' AT SERVICE ROAD TO ORR, THIRUMUDIVAKKAM, CHENNAI COMPRISED IN S.NO. 589/1B, 590/2A, 590/2B, 591/1A2, 592/1A2, 592/2A2, 593/2A & 593/2B OF THIRUMUDIVAKKAM VILLAGE WITHIN THE LIMITS OF KUNDRATHUR PANCHAYAT UNION, KUNDRATHUR TALUK, KANCHEEPURAM DISTRICT.			
A) AREA STATEMENT			SQ.M
AREA AS PER PATTI			3337.84
AREA AS PER DOCUMENT			3230.00
AREA CONSIDERED FOR FSI			3230.00
STREET ALIGNMENT/ ROAD WIDENING/LINK ROAD		0.00	
OSR AREA		0.00	
TOTAL FSI AREA			1818.44
FSI FACTOR			0.563
COVERAGE AREA (PERCENTAGE %)			NA
A) PARKING STATEMENT			
VEHICLE	REQUIRED	PROVIDED	
LORRY	5	5	
CAR	2	2	
TWO WHEELER	0	40	
CYCLE	0	40	

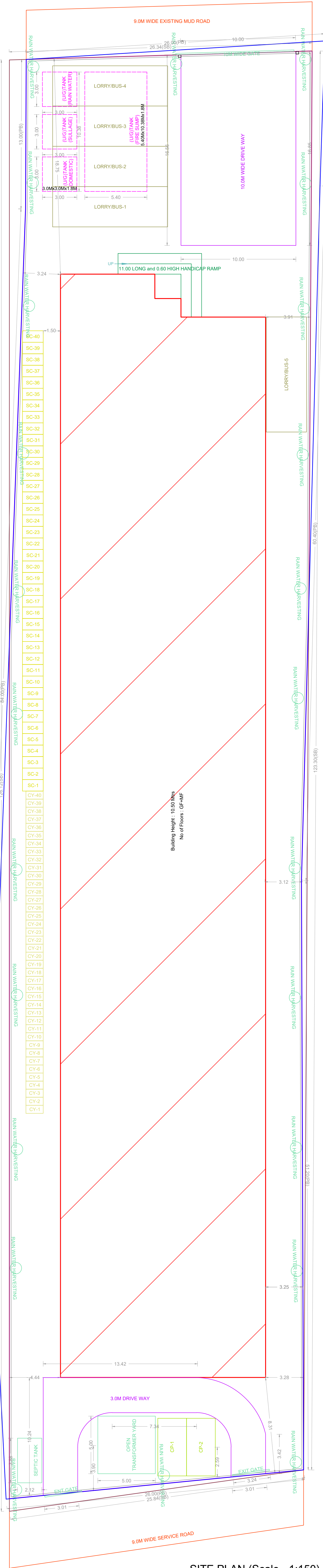

SITE PLAN (Scale - 1:150)

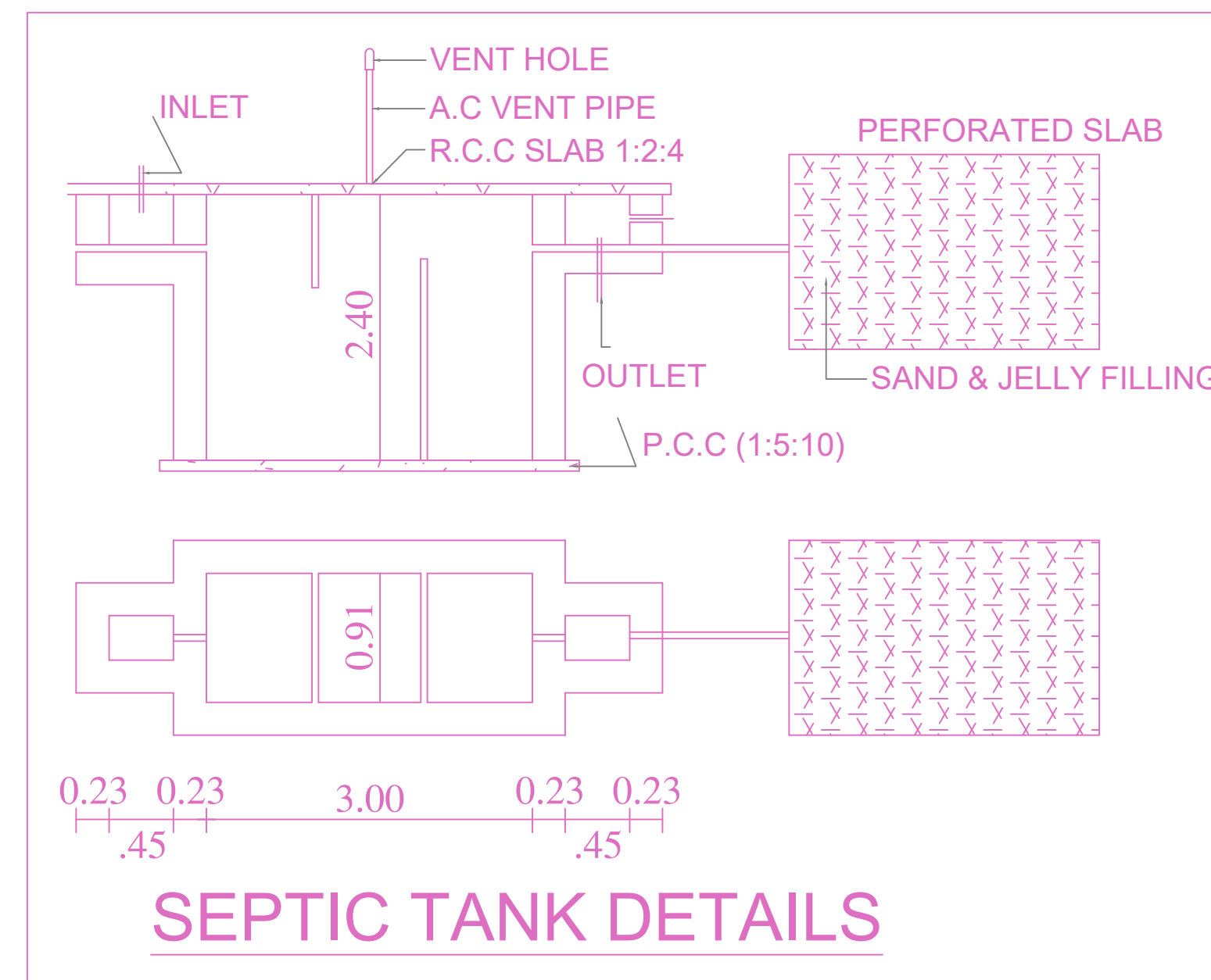

SEPTIC TANK DETAILS

**DESIGN OF SEPTIC TANK WITH UPFLOW FILTER**

NO. OF PERSONS > 50  
 NO. OF USERS ASSUMING > 50x2=100 UNITS.  
 2 FIXTURES PER FLAT  
 PER HOUR DISCHARGE > 100x6=600 LPM.

**SEPTIC TANK**  
 SURFACE AREA NEEDED > 600x0.92/10 = 55.20 SAY 5.5M

**VOLUME OF SEDIMENTATION**  
 ASSUMING 0.30M DEPTH  
 5.5x0.32 = 1.65M<sup>2</sup>  
 FOR DIGESTION 50x0.32 = 1.65M<sup>2</sup>  
 FOR SLUDGE STORAGE 0.0002x365x230 = 16.79M<sup>2</sup>  
 FREE BOARD FOR SLUDGE 10x0.3M = 3.00M<sup>2</sup>

DEPTH =  $\frac{\text{VOLUME}}{\text{AREA}} = \frac{7}{5} = 1.40M$

SIZE OF SEPTIC TANK 7.00x3.00x3.00

**UPFLOW FILTER**  
 LIQUID DEPTH OF SEPTIC TANK = 3.00M

UPFLOW FILTER DEPTH  
 ALLOWING 0.32M FREE BOARD 1.4 - 0.3 = 1.10M

AREA NEEDED =  $\frac{1.10}{1.10} = 1.0M$

SIZE OF UPFLOW FILTER 1.50x1.50  
 UPFLOW NO-1 = 0.91x1.50x1.36M  
 UPFLOW NO-2 = 0.91x1.50x1.36M

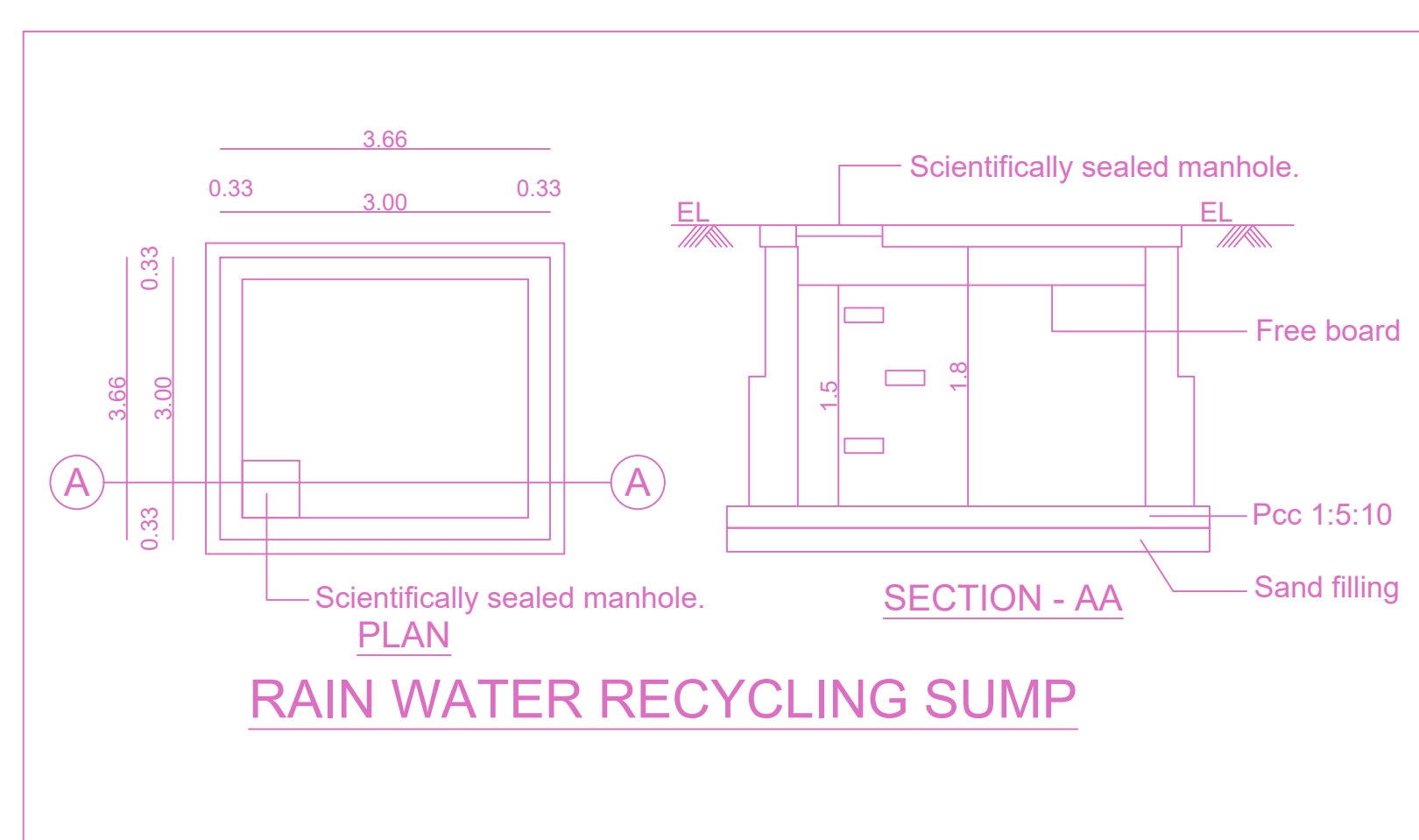

RAIN WATER RECYCLING SUMP

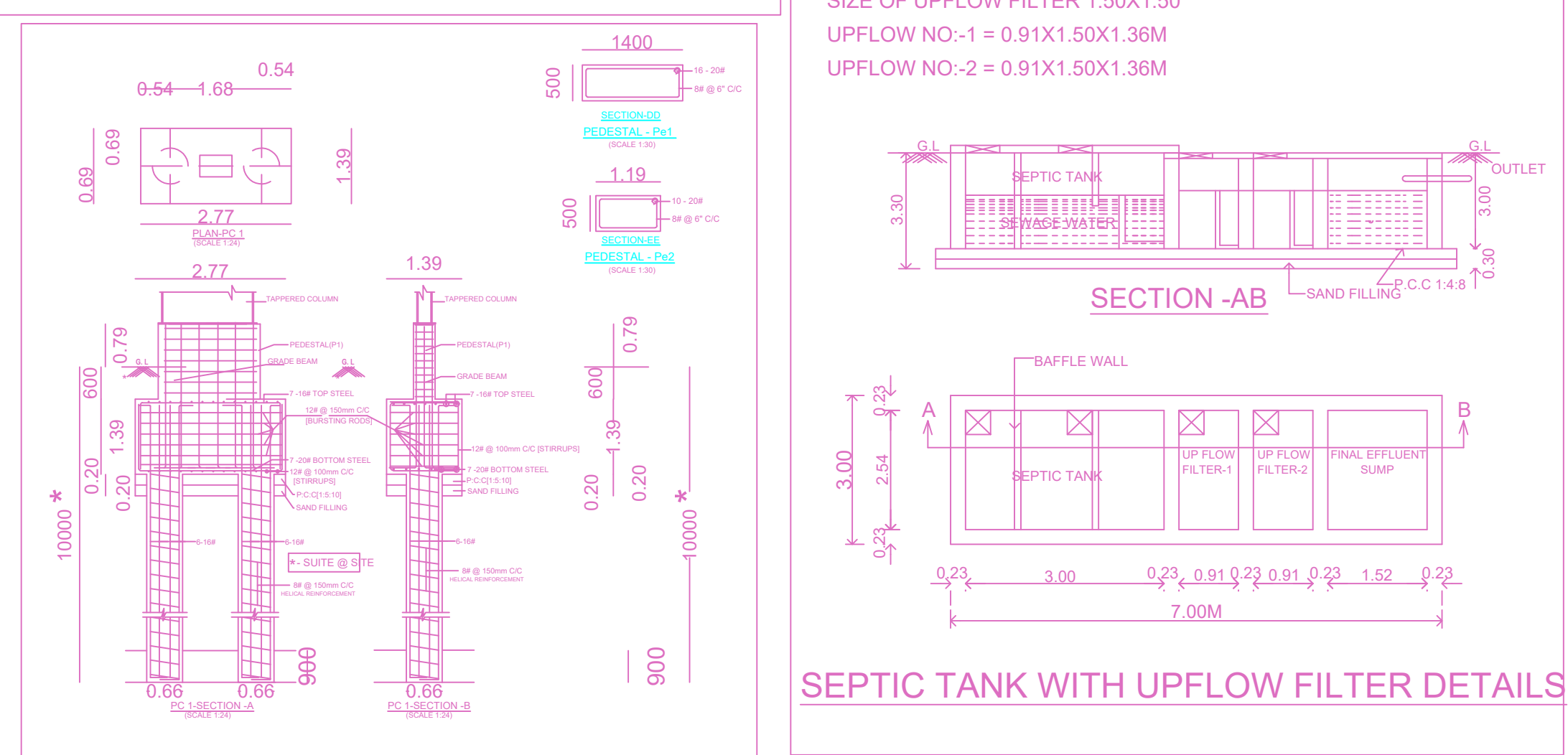

SEPTIC TANK WITH UPFLOW FILTER DETAILS

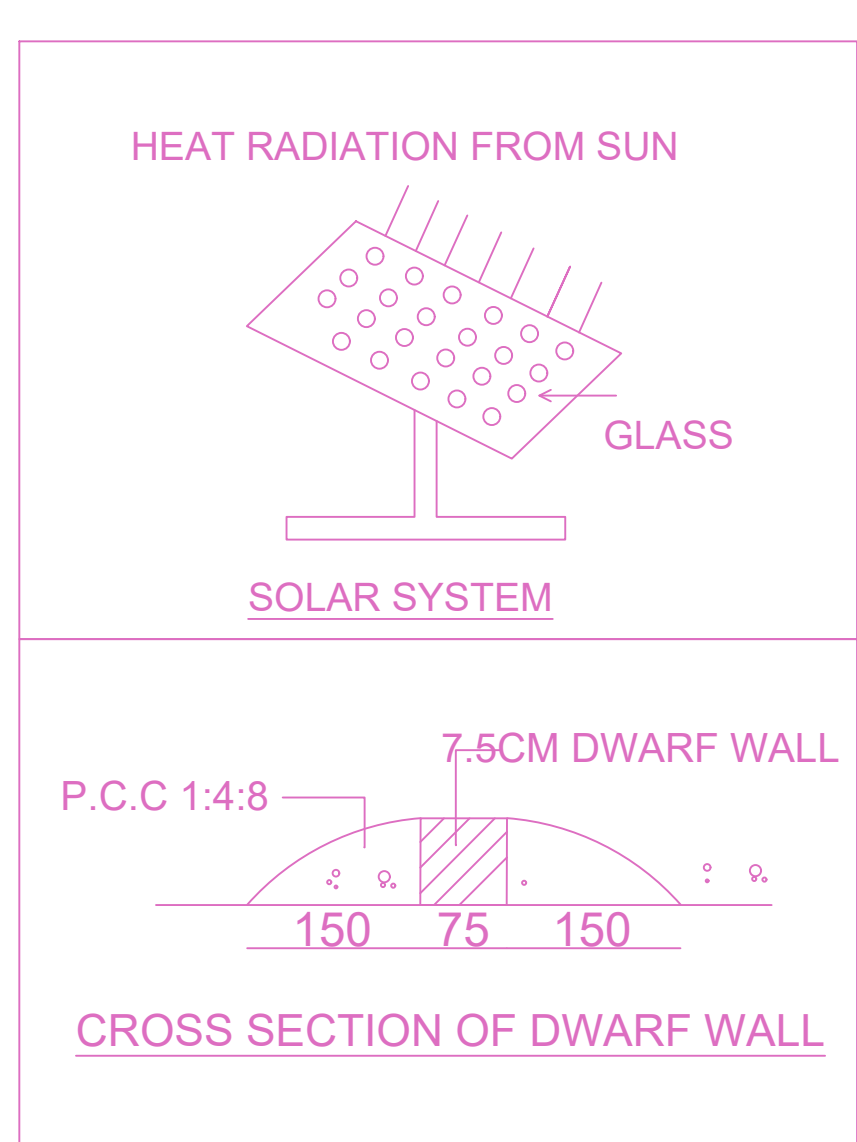

CROSS SECTION OF DWARF WALL

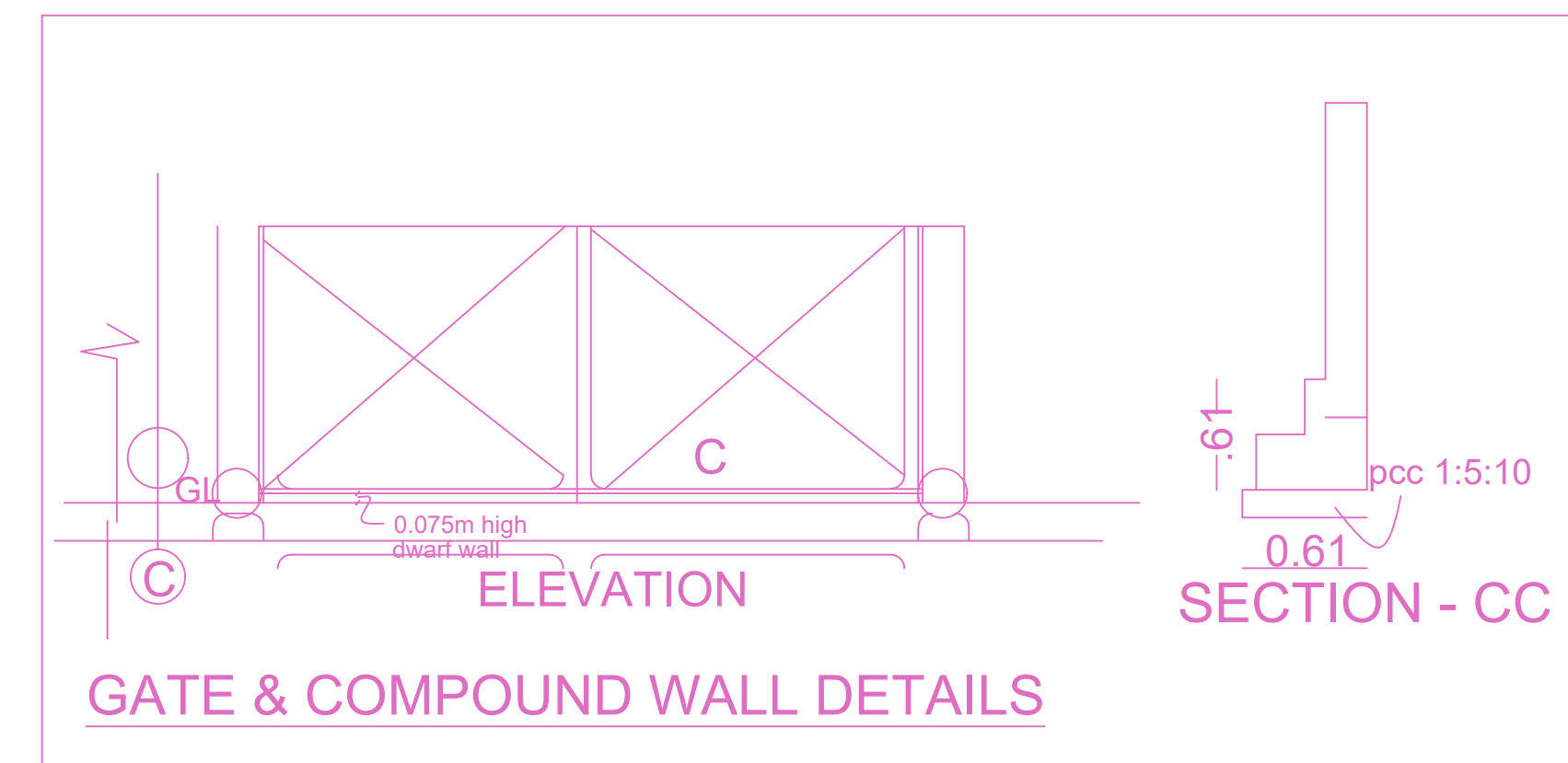

GATE & COMPOUND WALL DETAILS

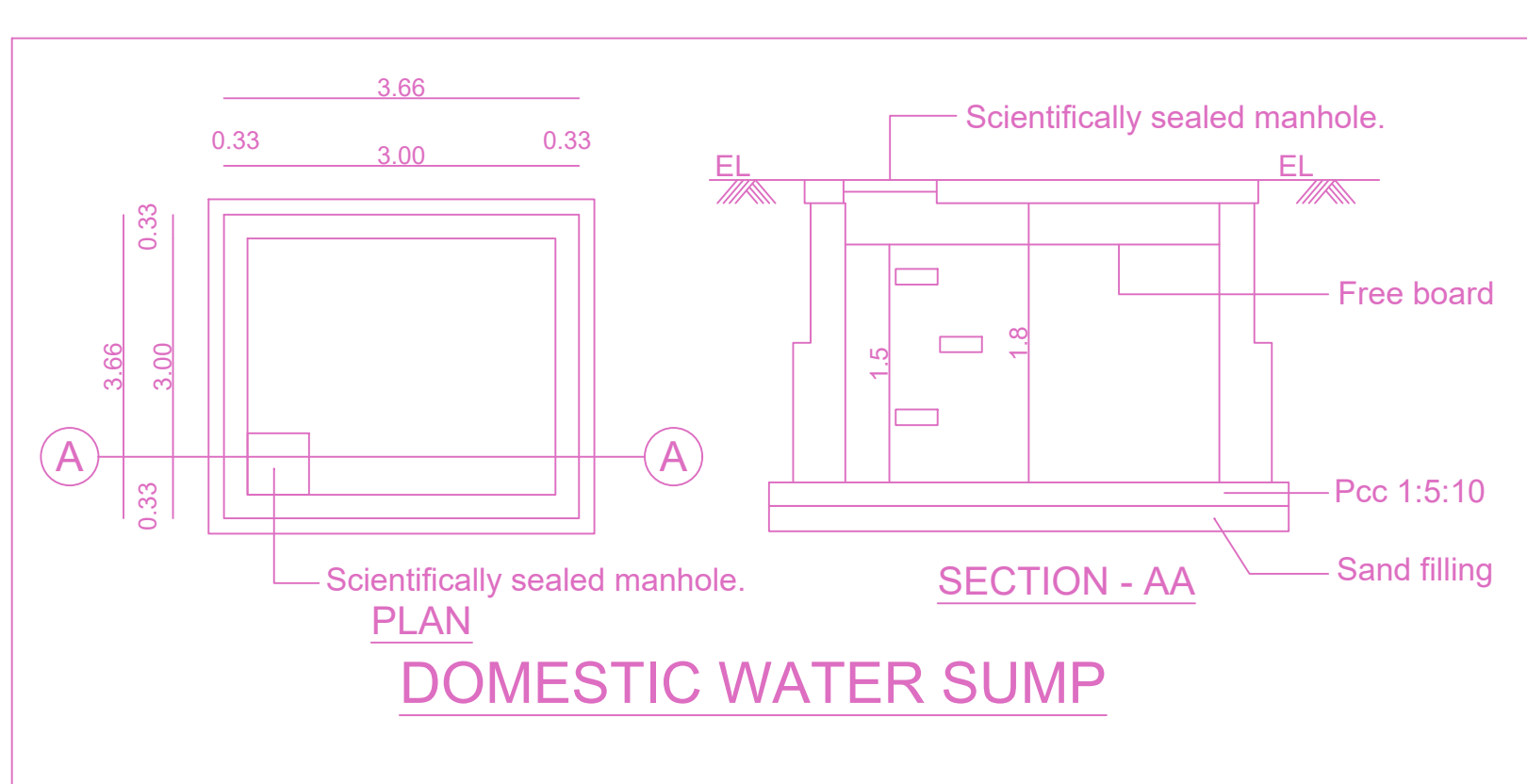

DOMESTIC WATER SUMP

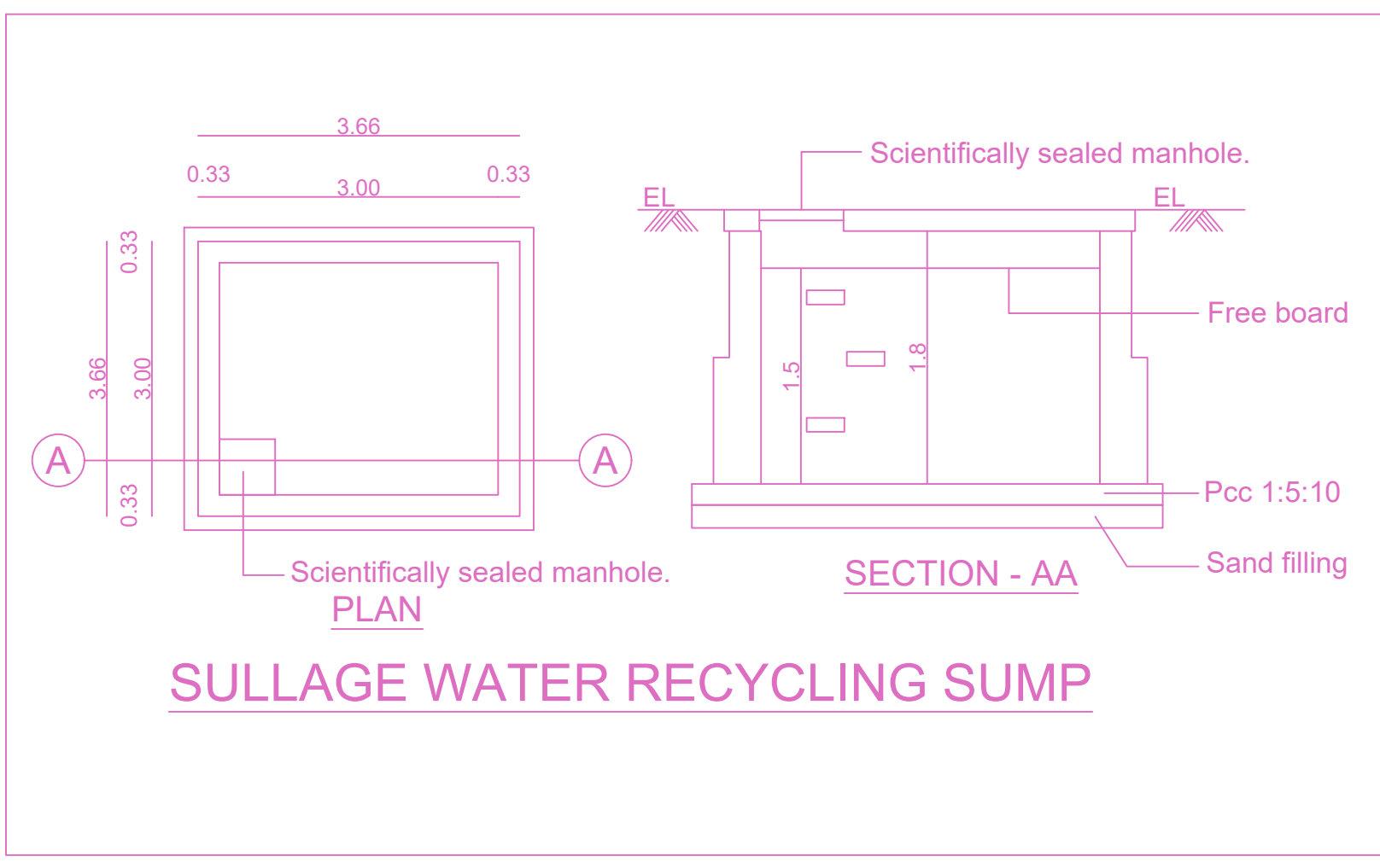

SULLAGE WATER RECYCLING SUMP

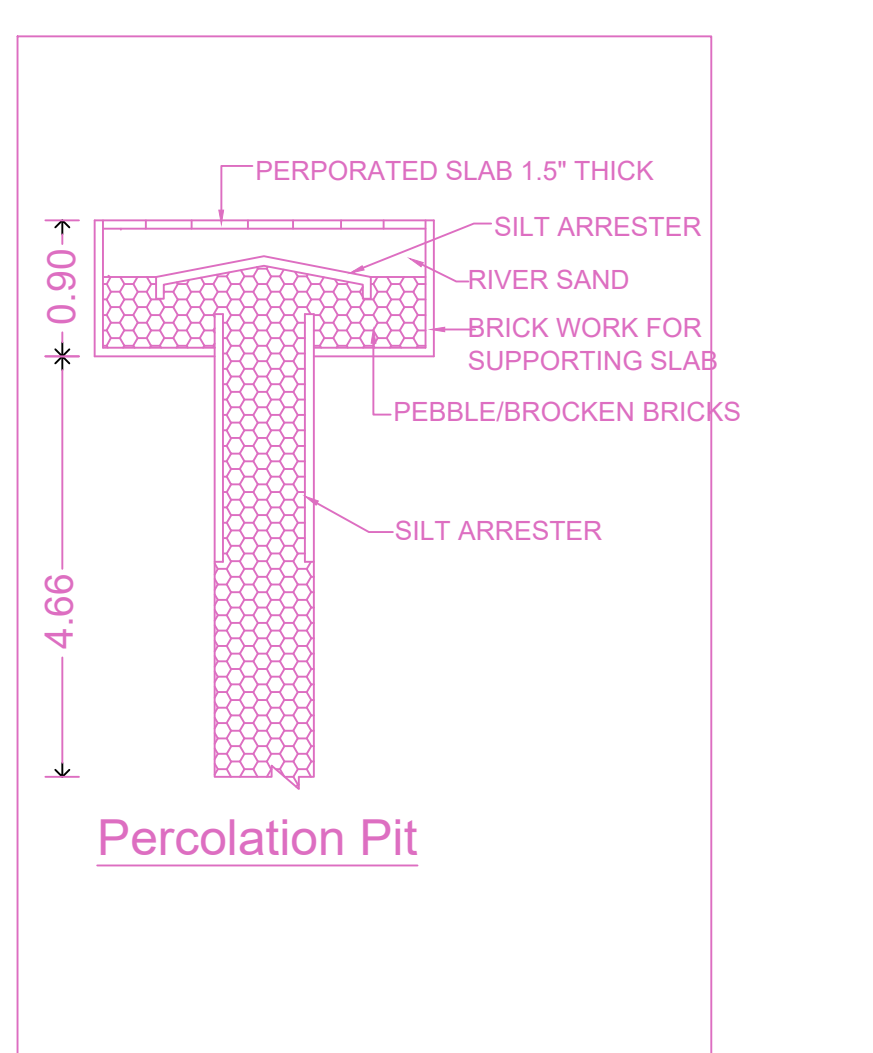

Percolation Pit

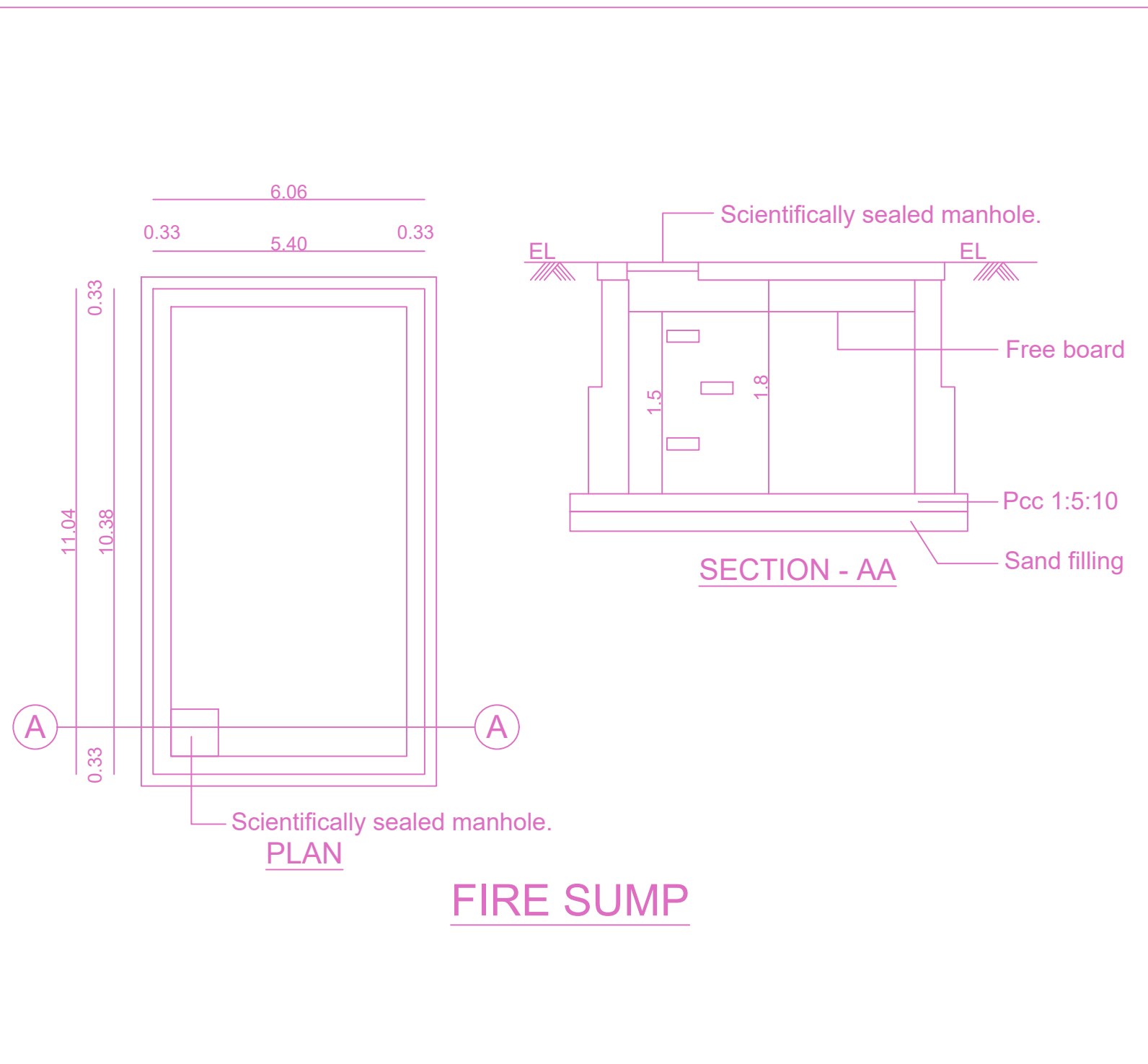

FIRE SUMP

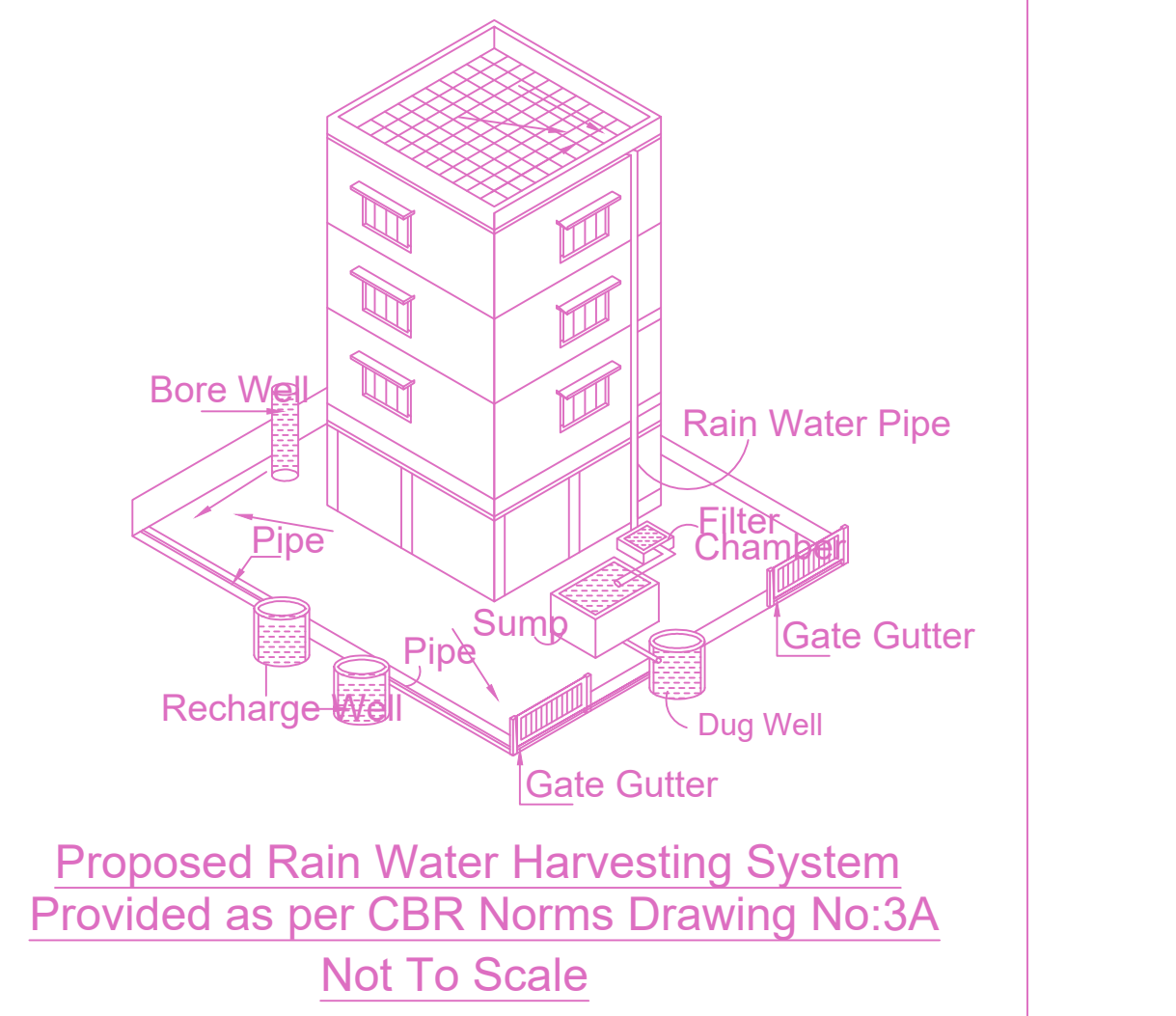

Proposed Rain Water Harvesting System Provided as per CBR Norms Drawing No:3A Not To Scale

BUILDING WISE FSI STATEMENT						
BUILDING	NO OF SAME BUILDING	FSI AREA			DU	TOTAL
A-1 (LENIN)		COMM.	RESI.	IND.	INST.	FSI AREA
		0.00	0.00	1678.05	0.00	1678.05
		0.00	0.00	140.39	0.00	140.39
		0.00	0.00	0.00	0.00	0.00
Total		0.00	0.00	1818.44	0.00	1818.44

FLOOR WISE FSI STATEMENT (A (LENIN))						
FLOORS	FSI AREA			DU	TOTAL	FSI AREA
	COMM.	RESI.	IND.	INST.		
GROUND FLOOR	0.00	0.00	1678.05	0.00	0	1678.05
MEZZANINE @ FLOOR	0.00	0.00	140.39	0.00	0	140.39
Terrace	0.00	0.00	0.00	0.00	0	0.00
Total	0.00	0.00	1818.44	0.00	0	1818.44

**APPROVAL CONDITION**

SCALE 1:100

**CHENNAI METROPOLITAN DEVELOPMENT AUTHORITY**

**APPROVED**

SUBJECT TO THE CONDITIONS MENTIONED IN THIS OFFICE.



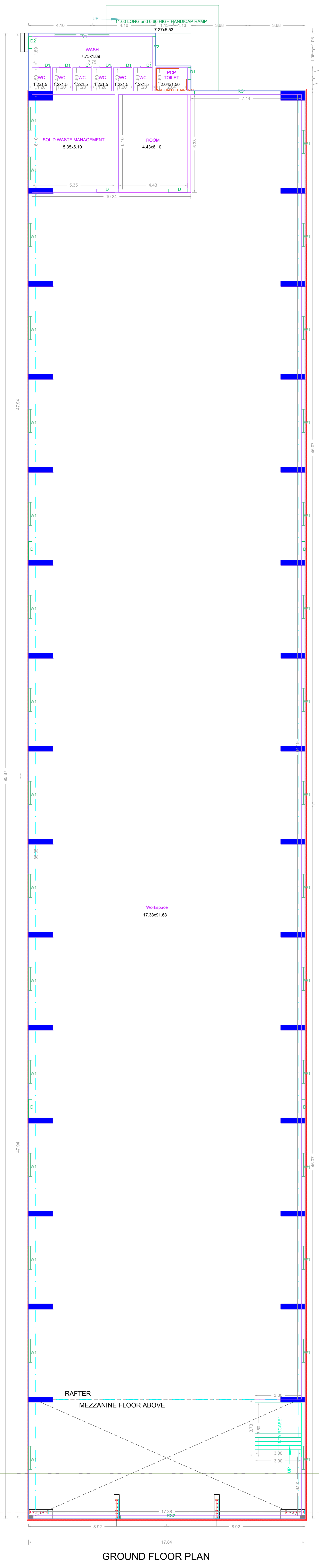

GROUND FLOOR PLAN

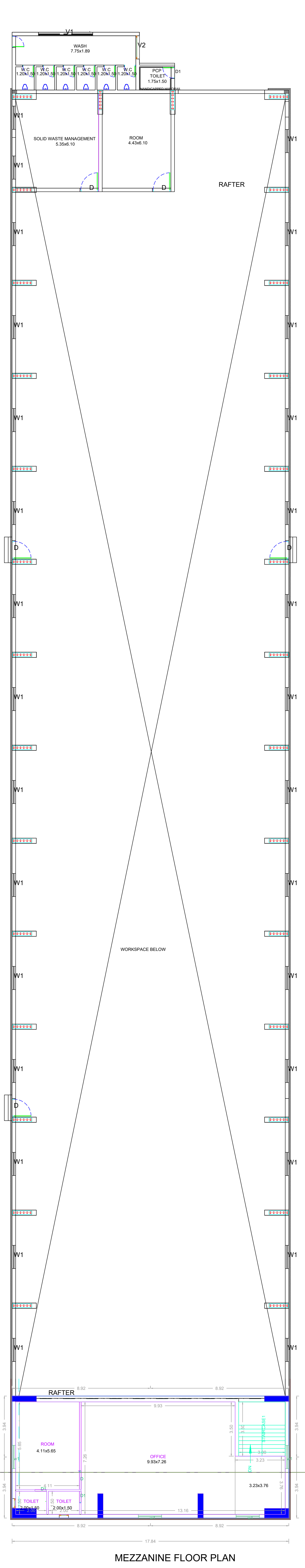

MEZZANINE FLOOR PLAN

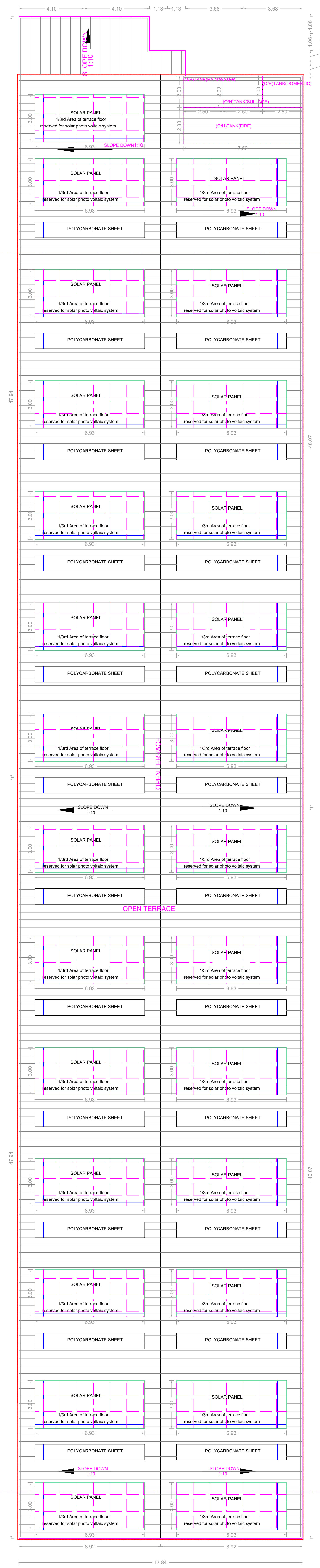

ROOF PLAN

APPROVAL CONDITION

SCALE 1:100

CHENNAI METROPOLITAN DEVELOPMENT AUTHORITY  
**APPROVED**  
 SUBJECT TO THE CONDITIONS MENTIONED IN THIS OFFICE

For Deputy Planner / Chief Planner / Member Secretary  
 High Rise Building / Non High Rise Building  
 This Approval is valid only after taking Permit is issued by the concerned Local Body.

KEY NO. 4688

QR CODE