

SITE PLAN SHEET NO. 1/3

CONSTRUCTION OF STILT FLOOR (TWO LEVEL PUZZLE PARKING) + 4 FLOORS (18.30M HEIGHT) IT/ITES USE BUILDING AT PLOT NO.164, INDUSTRIAL ESTATE PERUNGUDI, CHENNAI, COMPRISED IN S.NO.129/1A18 & 129/1B OF PALLAVAKKAM VILLAGE WITHIN THE LIMIT OF GREATER CHENNAI CORPORATION.

A) AREA STATEMENT	SQM.
AREA AS PER PATA	2740.00
AREA AS PER DOCUMENT	2740.00
AREA CONSIDERED FOR FSI	2740.00
STREET ALIGNMENT/ ROAD WIDENING/LINK ROAD	0.00
OSR AREA	0.00
TOTAL FSI AREA	6678.01
FSI FACTOR	2.437
COVERAGE AREA (PERCENTAGE %)	NA

A) PARKING STATEMENT		REQUIRED	PROVIDED
VEHICLE			
LORRY		-	0
CAR		100	102
TWO WHEELER		199	208
CYCLE		-	0

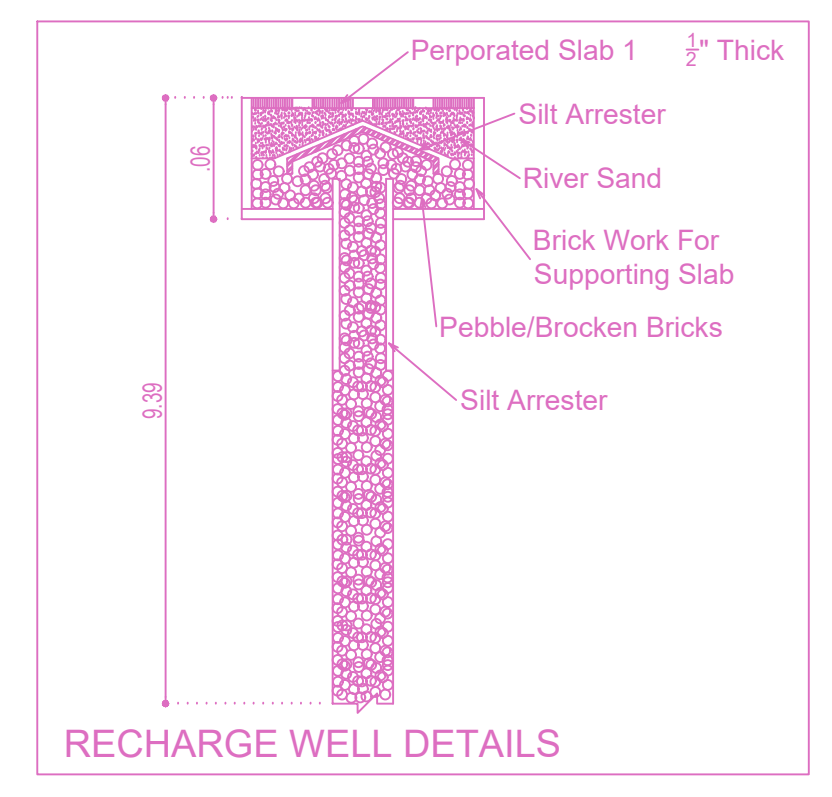
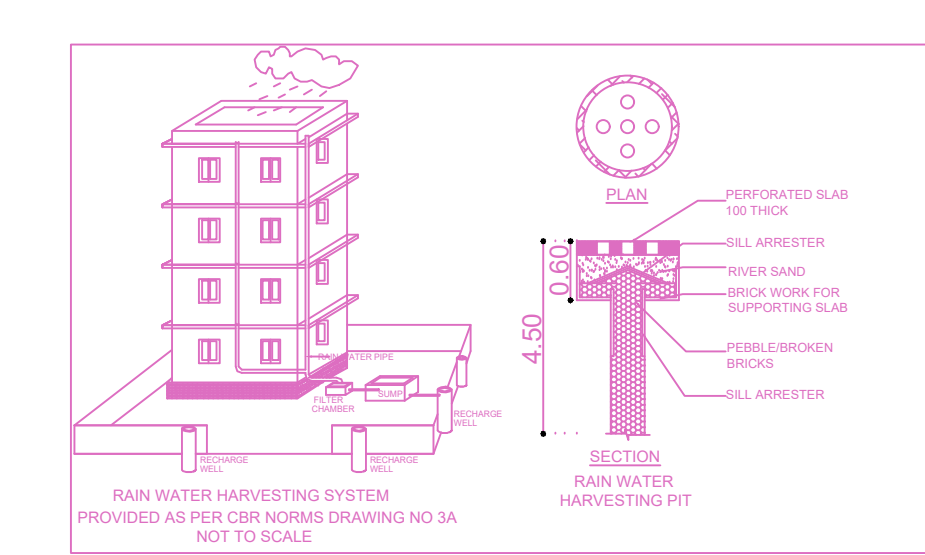
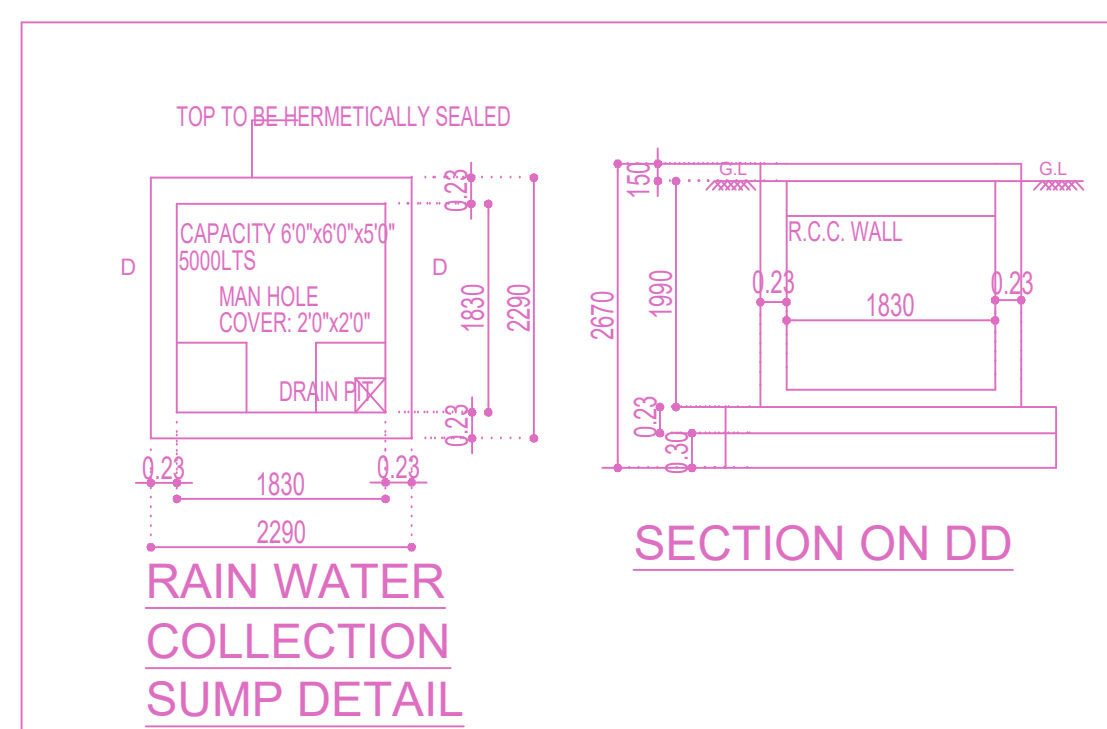
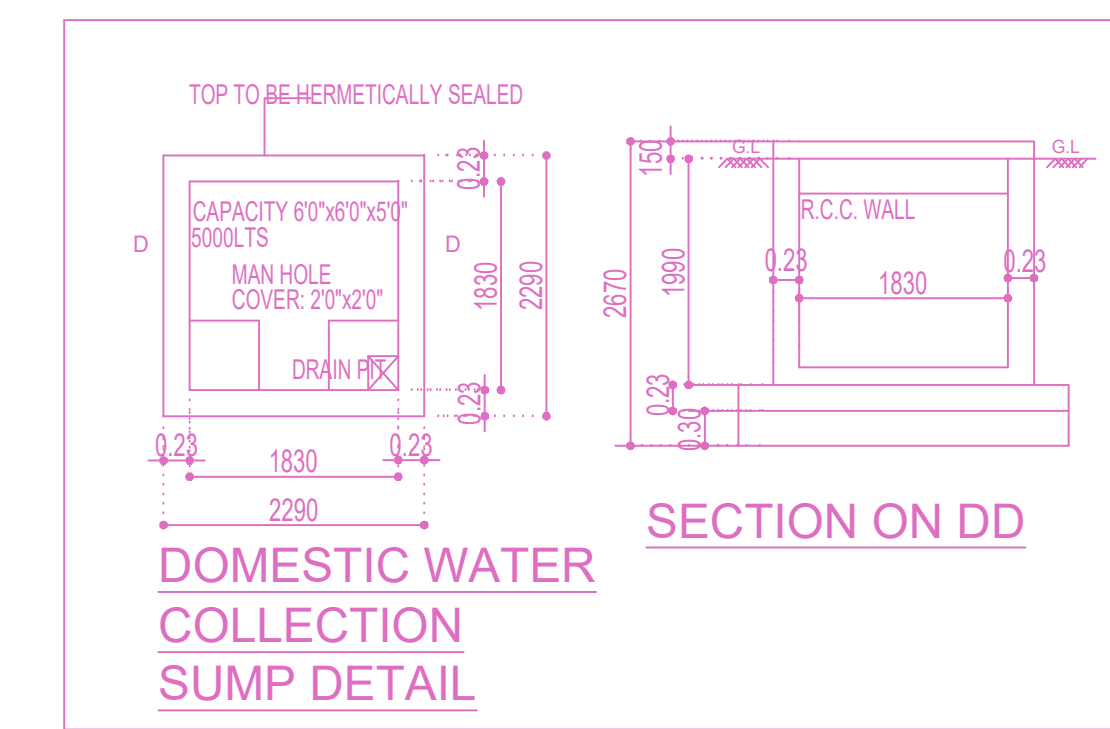
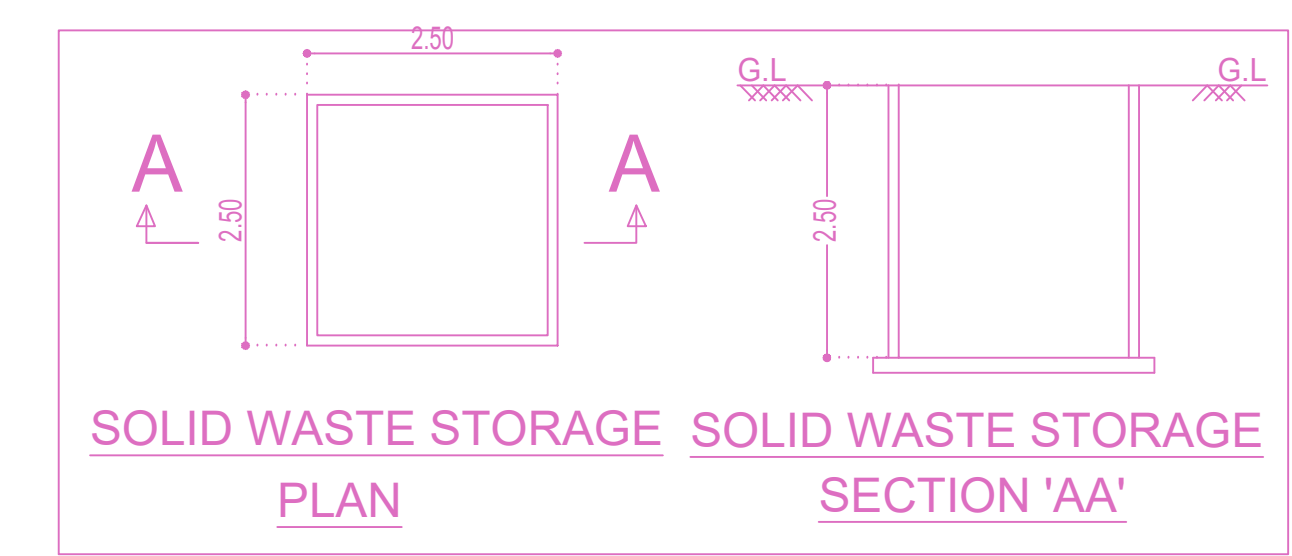

EARLIER APPROVAL:-  
 - PLANNING PERMISSION APPROVAL OBTAINED IN CMDA APPROVAL NO. C/14918/01/2023-A&B, VIDE LETTER NO. CMDA/PP/IND/S/0354/2022, DATED 17.06.2023, PLANNING PERMIT NO. 14918  
 - BUILDING PERMIT OBTAINED IN GREATER CHENNAI CORPORATION NO. CEBA/WDCN14/00264/2023, DATED 23.06.2023

FLOOR WISE FSI STATEMENT-A (TT/ITES)

FLOORS	FSI AREA				DU	TOTAL FSI AREA
	COMM.	RESI.	IND.	INST.		
STILT PARKING FLOOR	45.01	0.00	0.00	0.00	0	45.01
FIRST FLOOR	1658.25	0.00	0.00	0.00	0	1658.25
SECOND FLOOR	1658.25	0.00	0.00	0.00	0	1658.25
THIRD FLOOR	1658.25	0.00	0.00	0.00	0	1658.25
FOURTH FLOOR	1658.25	0.00	0.00	0.00	0	1658.25
Terrace	0.00	0.00	0.00	0.00	0	0.00
Total	6678.01	0.00	0.00	0.00	0	6678.01

BUILDING WISE FSI STATEMENT

BUILDING	NO OF SAME BUILDINGS	FSI AREA				DU	TOTAL FSI AREA
		COMM.	RESI.	IND.	INST.		
A-1 (TT/ITES)	1	6678.01	0.00	0.00	0.00	0	6678.01
Total	1	6678.01	0.00	0.00	0.00	0	6678.01

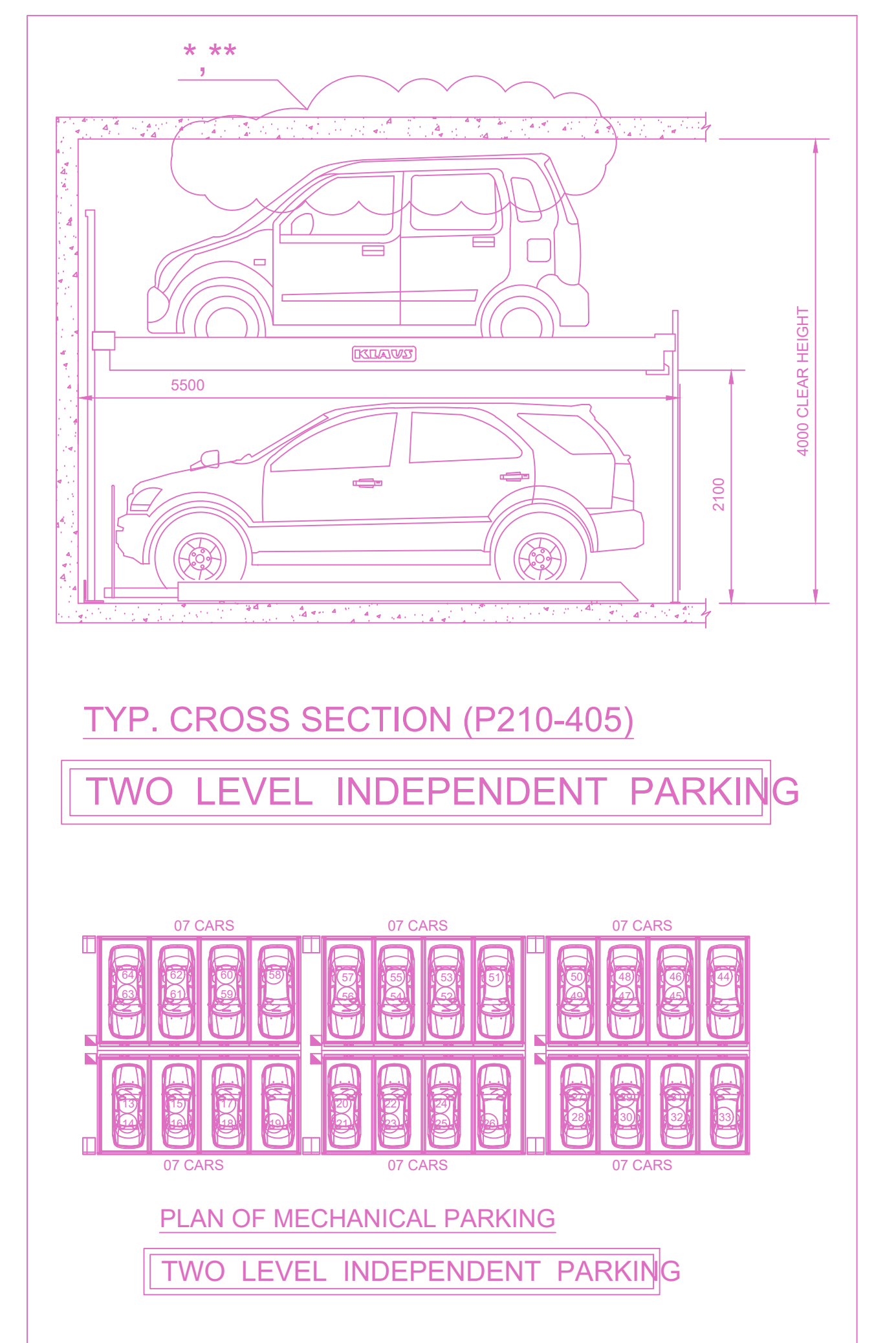
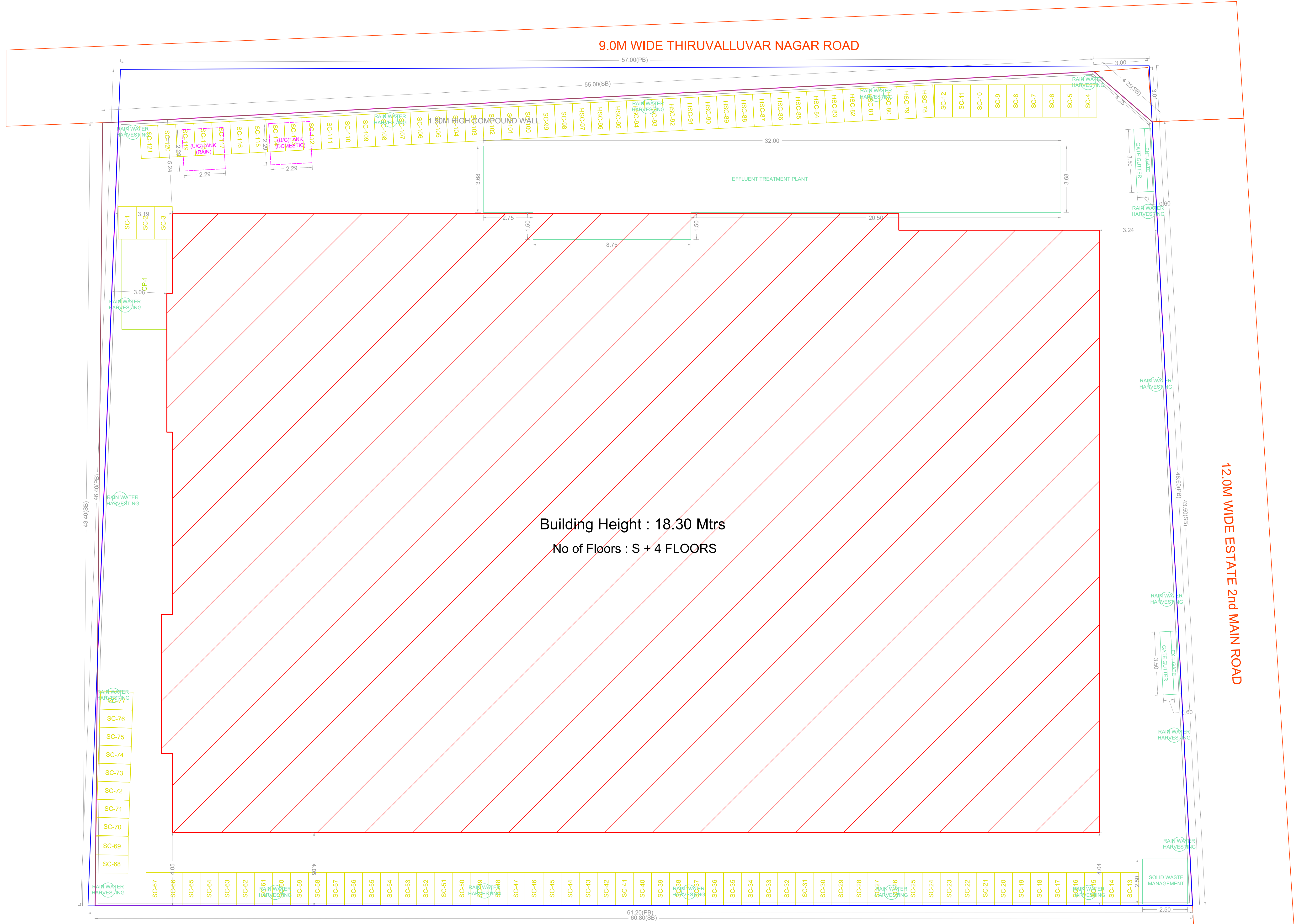

SITE PLAN

APPROVAL CONDITION

Previous File No. CMDA/PP/IND/0354/2022  
Approval Date 05/01/1984  
Approval No. 1237/A3/83/80506/EL1/80  
Permit No. CEBA/WDCN14/00264/2023

SCALE 1:100

CHENNAI METROPOLITAN DEVELOPMENT AUTHORITY  
APPROVED

SUBJECT TO THE CONDITIONS MENTIONED IN THIS OFFICE

Applicants ( Owner / Developer / Power of Attorney )

KEY NO. 7688

QR CODE

This is a system generated drawing as per the soft copy submitted by the Architect/ License Engineer



PLAN SHOWING THE PROPOSED CONSTRUCTION OF STILT FLOOR (TWO LEVEL PUZZLE PARKING) + 4 FLOORS (18.30M HEIGHT) IT/ITES USE BUILDING AT PLOT NO.164, INDUSTRIAL ESTATE PERUNGUDI, CHENNAI, COMPRISED IN S.NO.129/1A1B & 129/1B OF PALLAVAKAM VILLAGE WITHIN THE LIMIT OF GREATER CHENNAI CORPORATION.

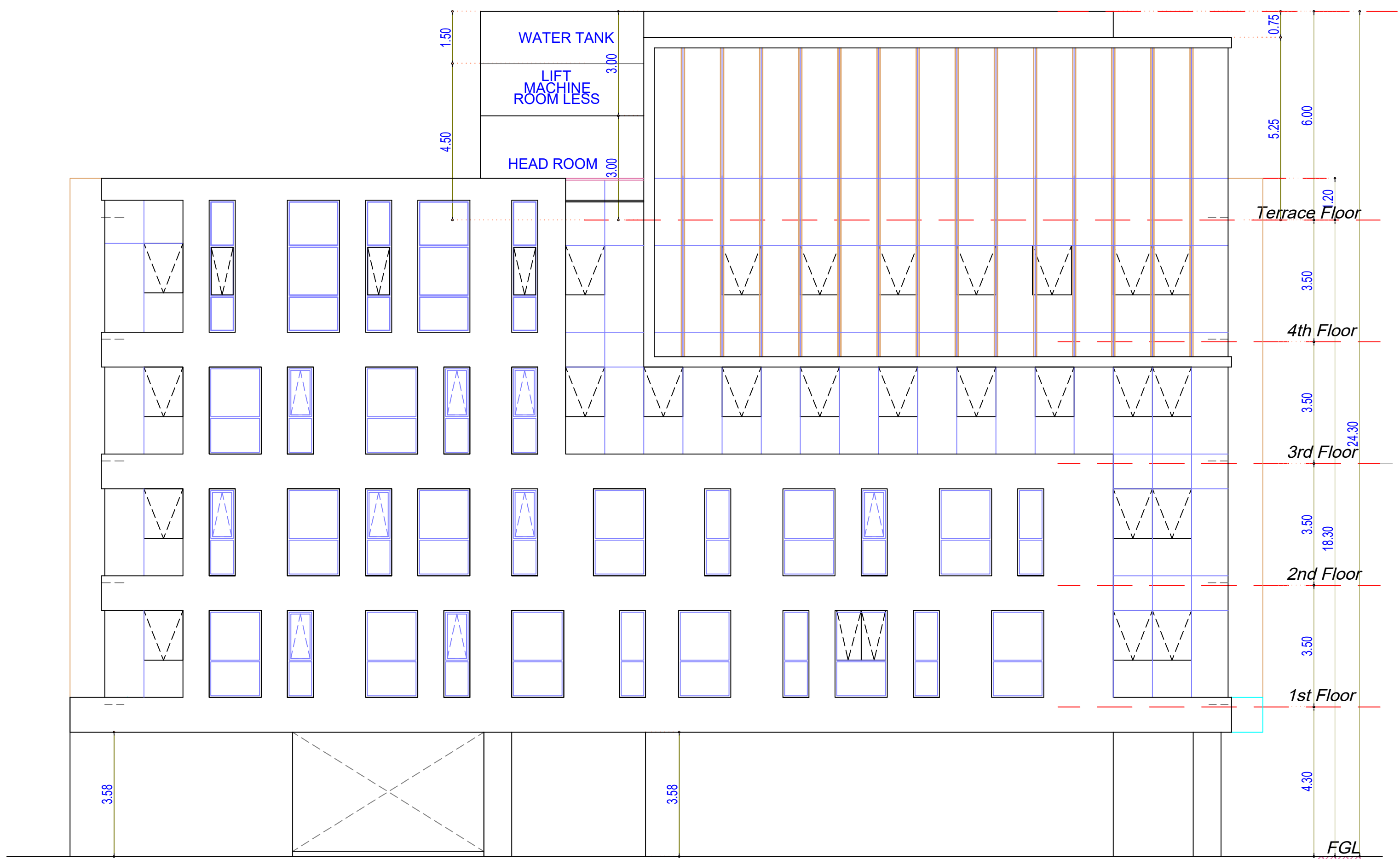

EAST SIDE ELEVATION

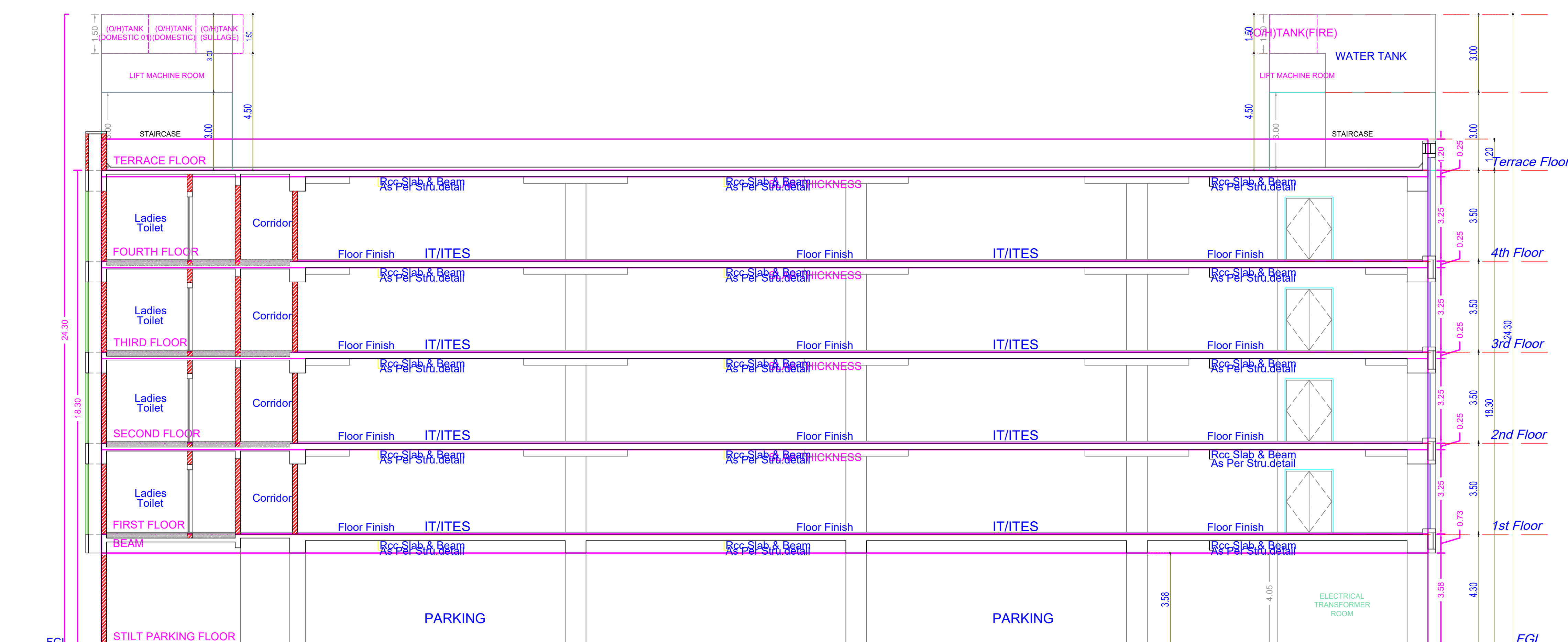

SECTION - XX

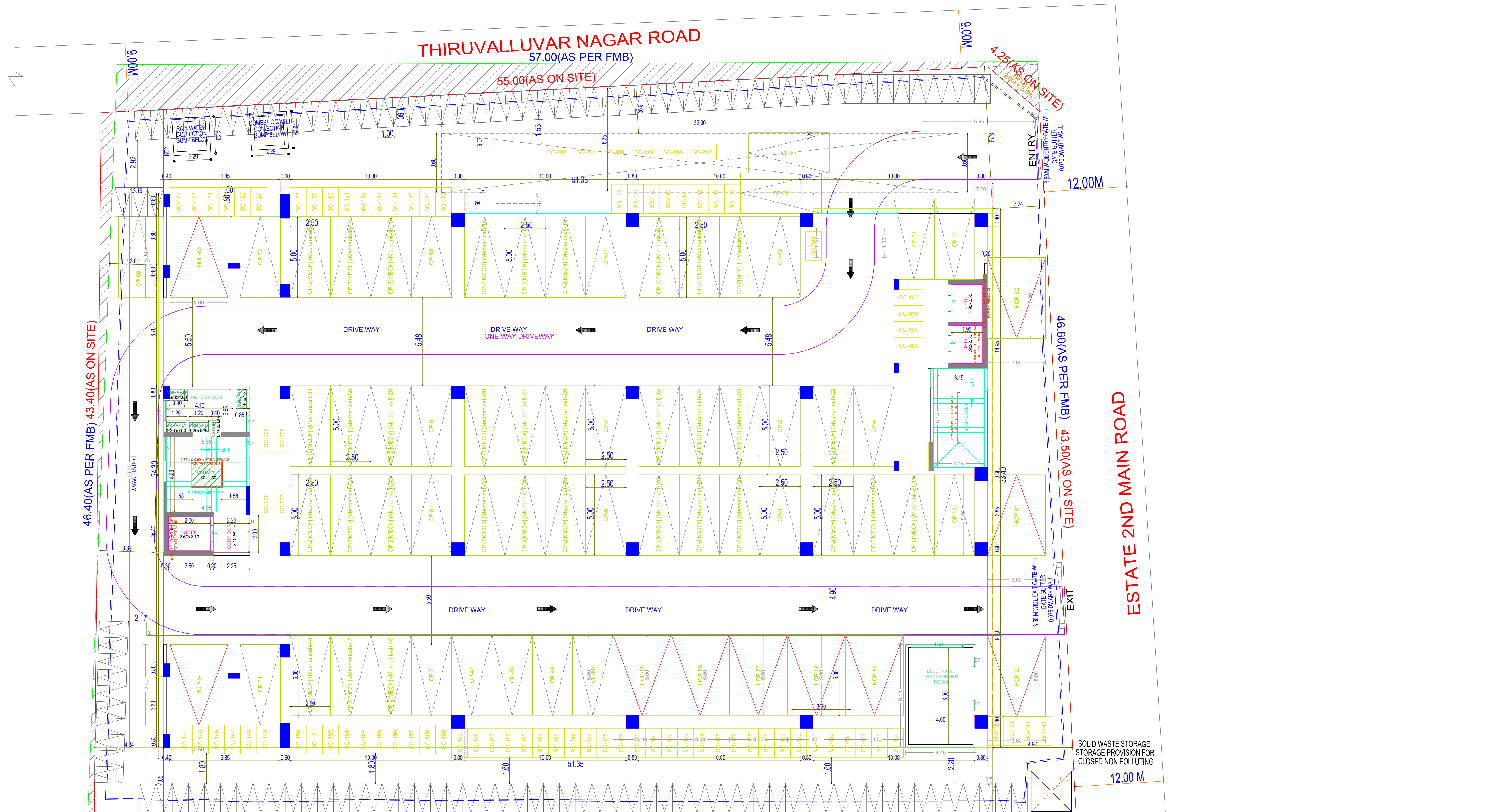

SITE CUM STILT FLOOR PLAN

APPROVAL CONDITION

Previous File No. CMDA/PP/IND/0354/2022  
 Approval Date 05/01/1984  
 Approval No. 1237/A3/83/80506/EL1/80  
 Permit No. CEBA/WDCN14/00264/2023

SCALE 1:100

CHENNAI METROPOLITAN DEVELOPMENT AUTHORITY

APPROVED

SUBJECT TO THE CONDITIONS MENTIONED IN THIS OFFICE

This Planning Permission issued under the provisions of the Chennai Metropolitan Act, 1919 and the Chennai Metropolitan Development Authority Act, 1971 is valid only for the purpose specified therein and shall not be used for any other purpose without the prior approval of the Authority.

For Clerk/Planner / Chief Planner / Member Secretary  
 High Rise Building / Non High Rise Building  
 This Approval is valid only after Building Permit is issued by the concerned Local Body.

KEY NO. 7688

QR CODE



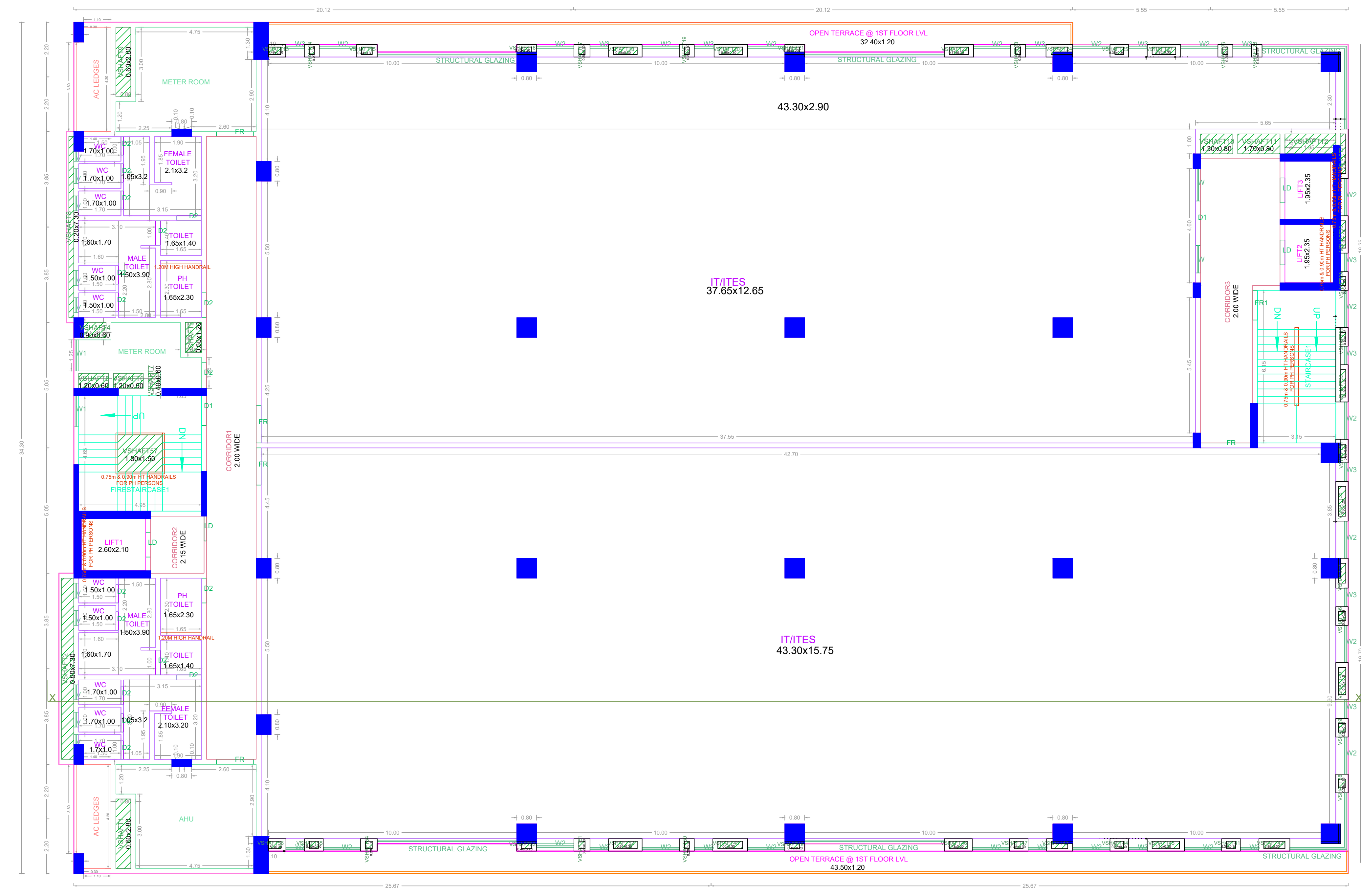

FIRST FLOOR PLAN

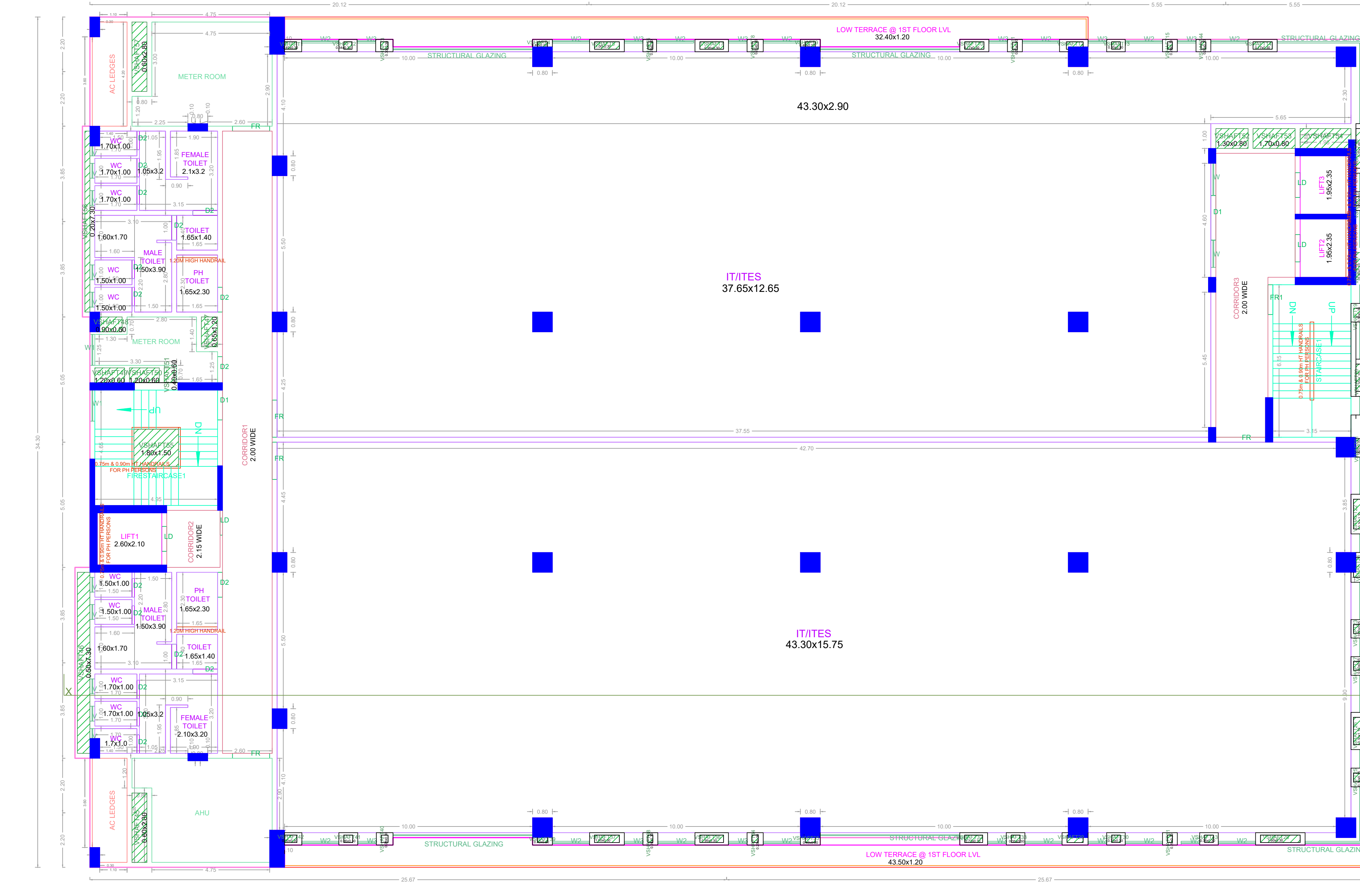

TYPICAL - 2, 3 & 4 FLOOR PLAN



TERRACE FLOOR PLAN

APPROVAL CONDITION

Previous File No. CMDA/PP/IND/0354/2022  
 Approval Date 05/01/1984  
 Approval No. 1237/A3/83/80506/EL1/80  
 Permit No. CEBA/WDCN14/00264/2023

SCALE 1:100

CHENNAI METROPOLITAN DEVELOPMENT AUTHORITY  
**APPROVED**  
 SUBJECT TO THE CONDITIONS MENTIONED IN THIS OFFICE

For Check Planner / Chief Planner / Member (Secretary)  
 High Rise Building / Non High Rise Building  
 This Approval is valid only after building Permit is issued by the concerned Local Body.

KEY NO. 7688

QR CODE