

BUILDING WISE FSI STATEMENT

BUILDING	NO OF SAME BUILDING	FSI AREA				DU	TOTAL
		COMM.	RESI.	IND.	INST.		FSI AREA
A-1 ((INST...))		0.00	0.00	0.00	5404.71	0	5404.71
Total		0.00	0.00	0.00	5404.71	0	5404.71

FLOOR WISE FSI STATEMENT: A ((INSTITUTE))

FLOORS	FSI AREA				DU	TOTAL
	COMM.	RESI.	IND.	INST.		FSI AREA
GROUND PARKING FLOOR	0.00	0.00	0.00	1314.30	0	1314.30
FIRST FLOOR	0.00	0.00	0.00	1363.67	0	1363.67
SECOND FLOOR	0.00	0.00	0.00	1363.67	0	1363.67
THIRD FLOOR	0.00	0.00	0.00	1363.07	0	1363.07
Terrace	0.00	0.00	0.00	0.00	0	0.00
Total	0.00	0.00	0.00	5404.71	0	5404.71

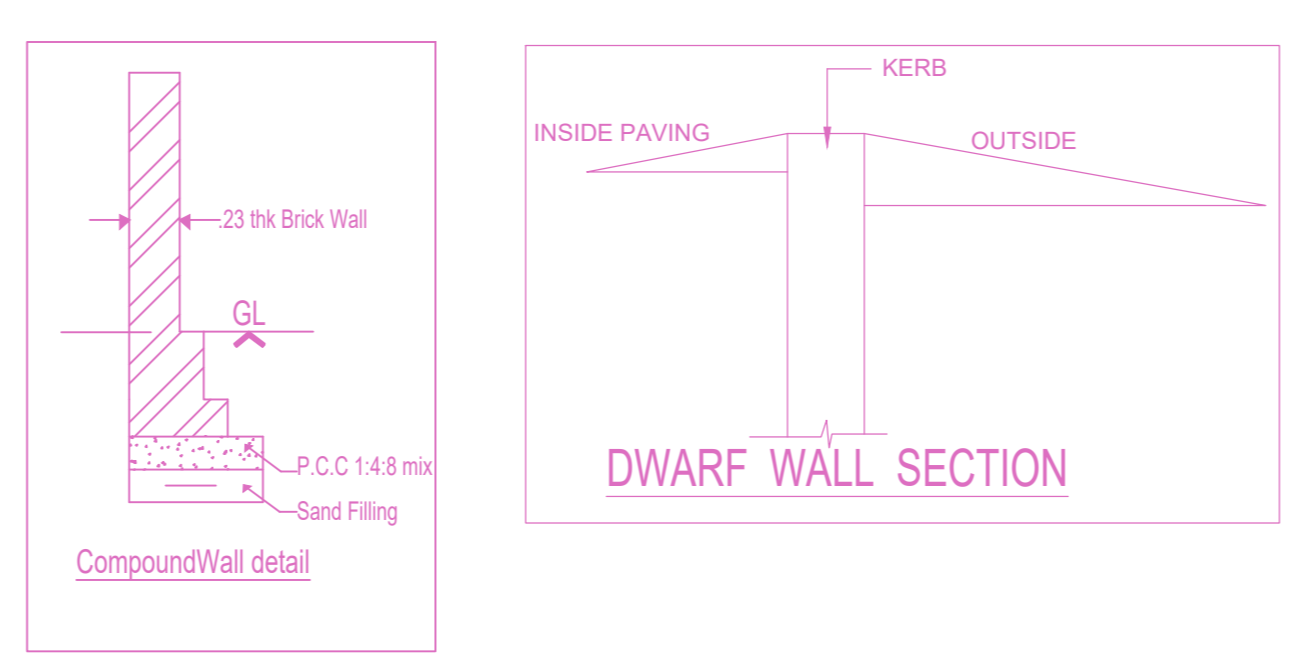
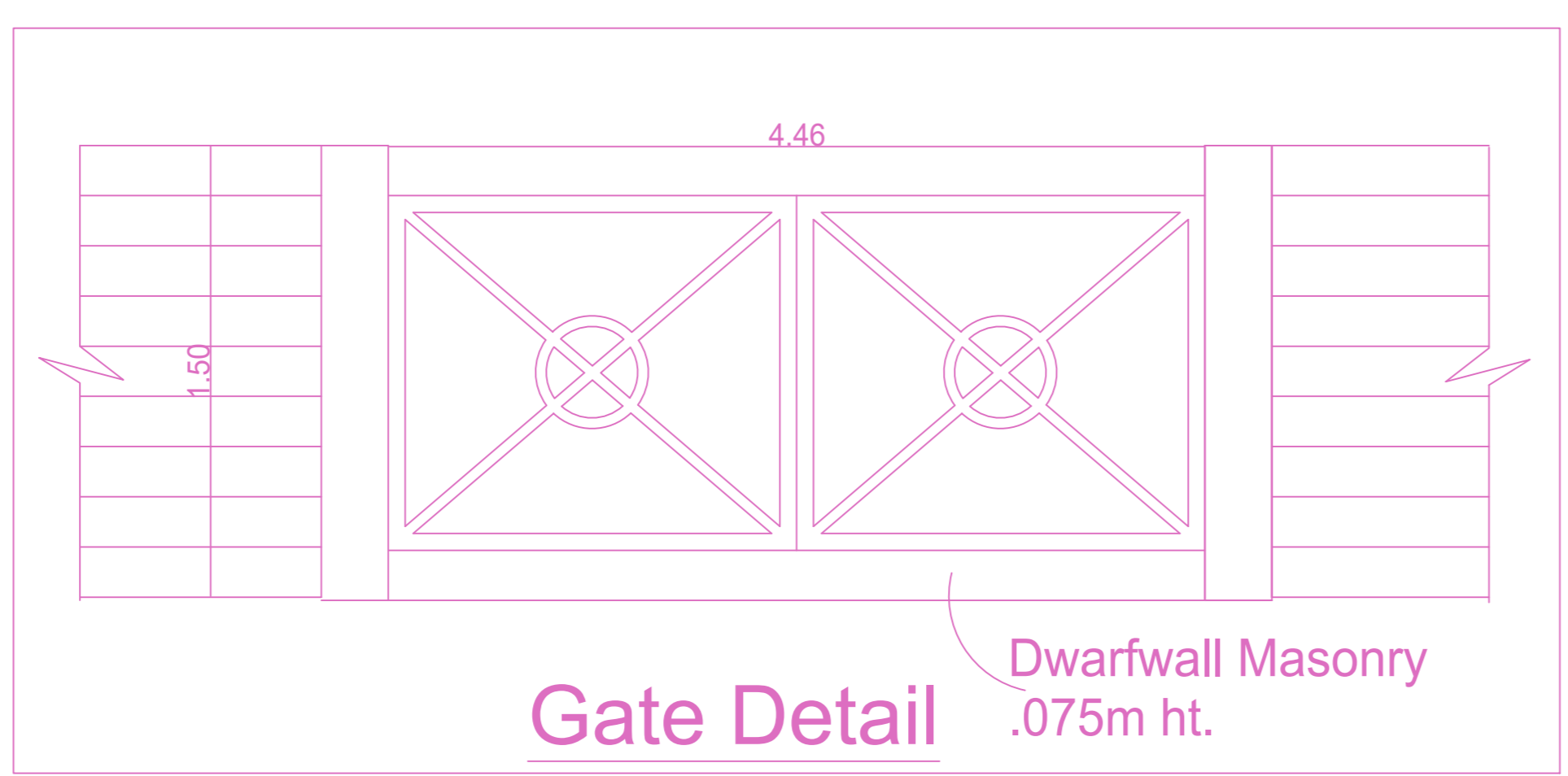
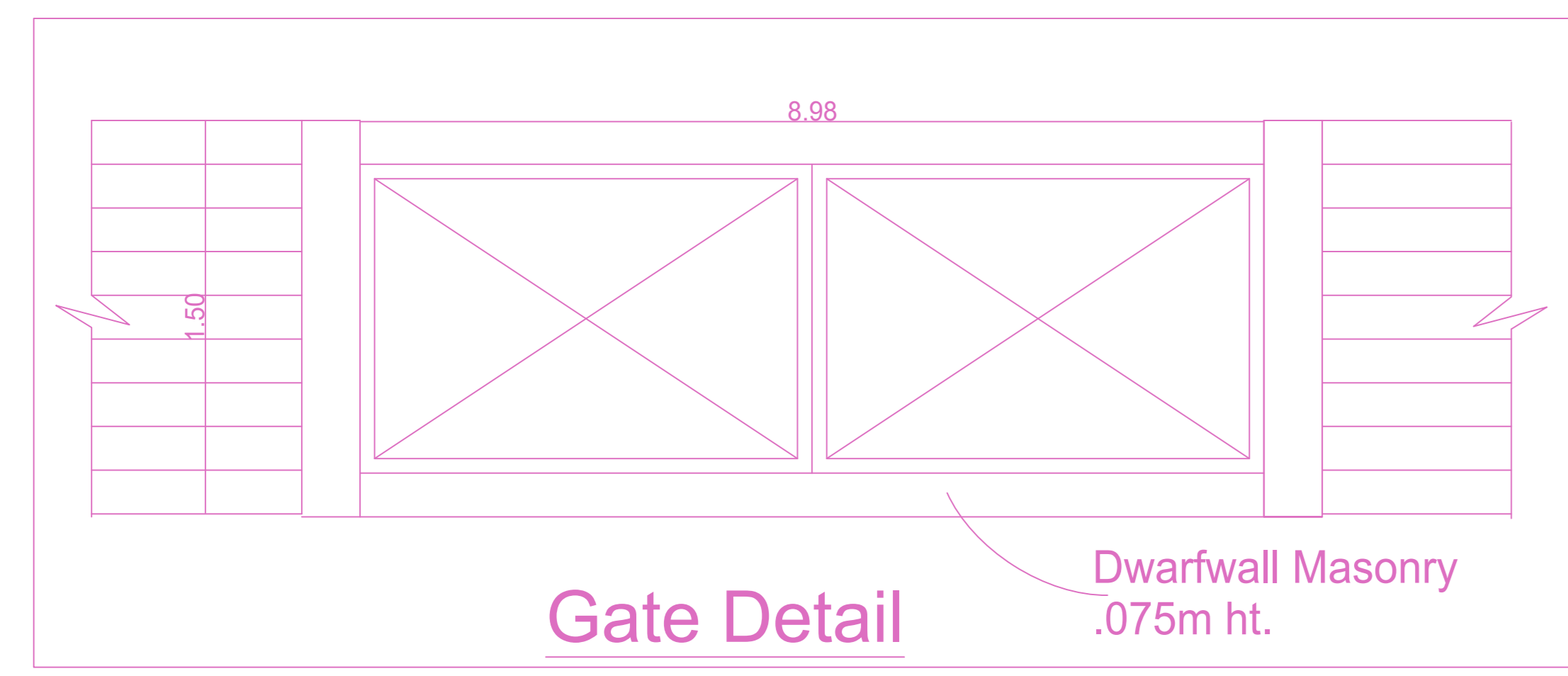
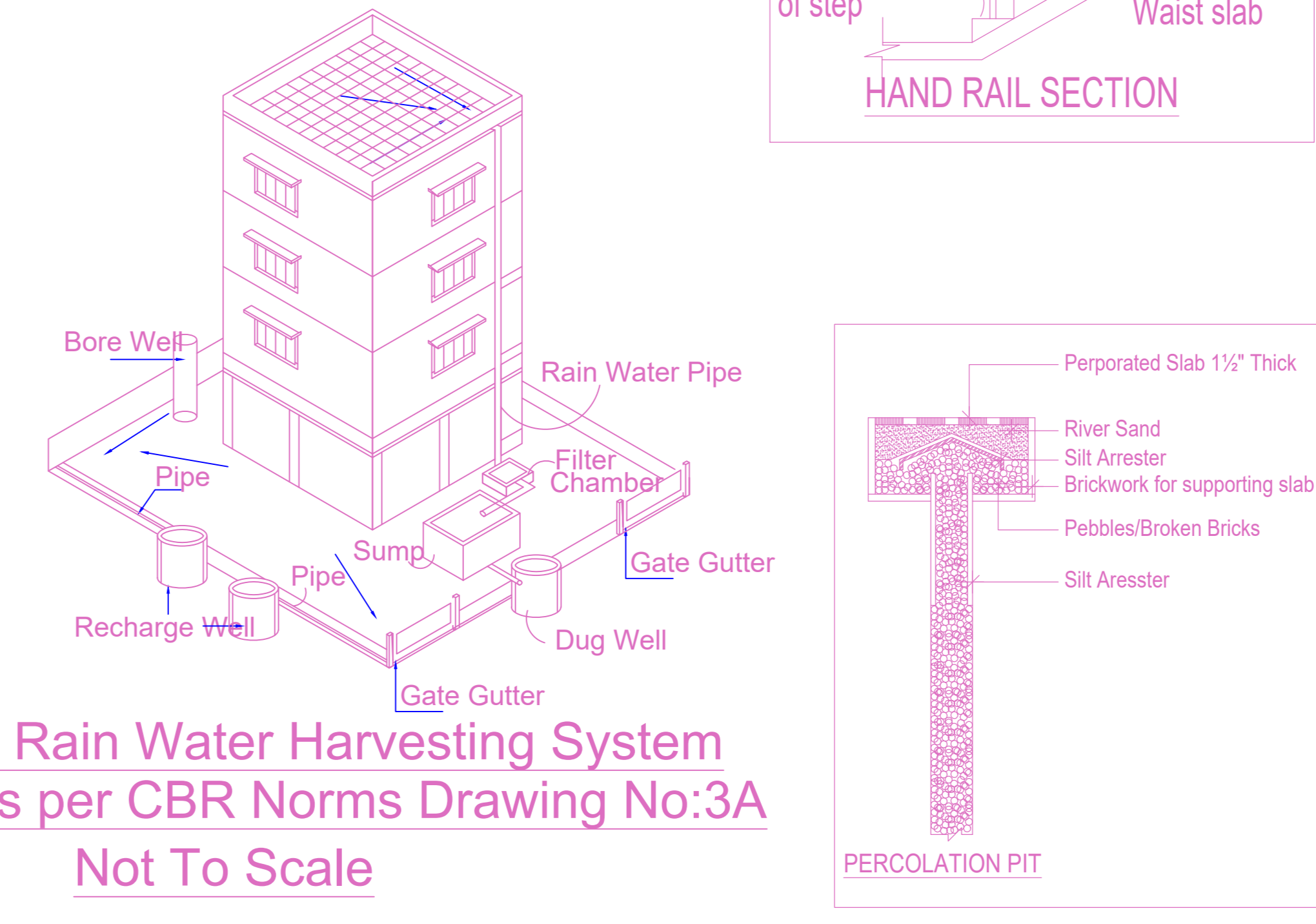
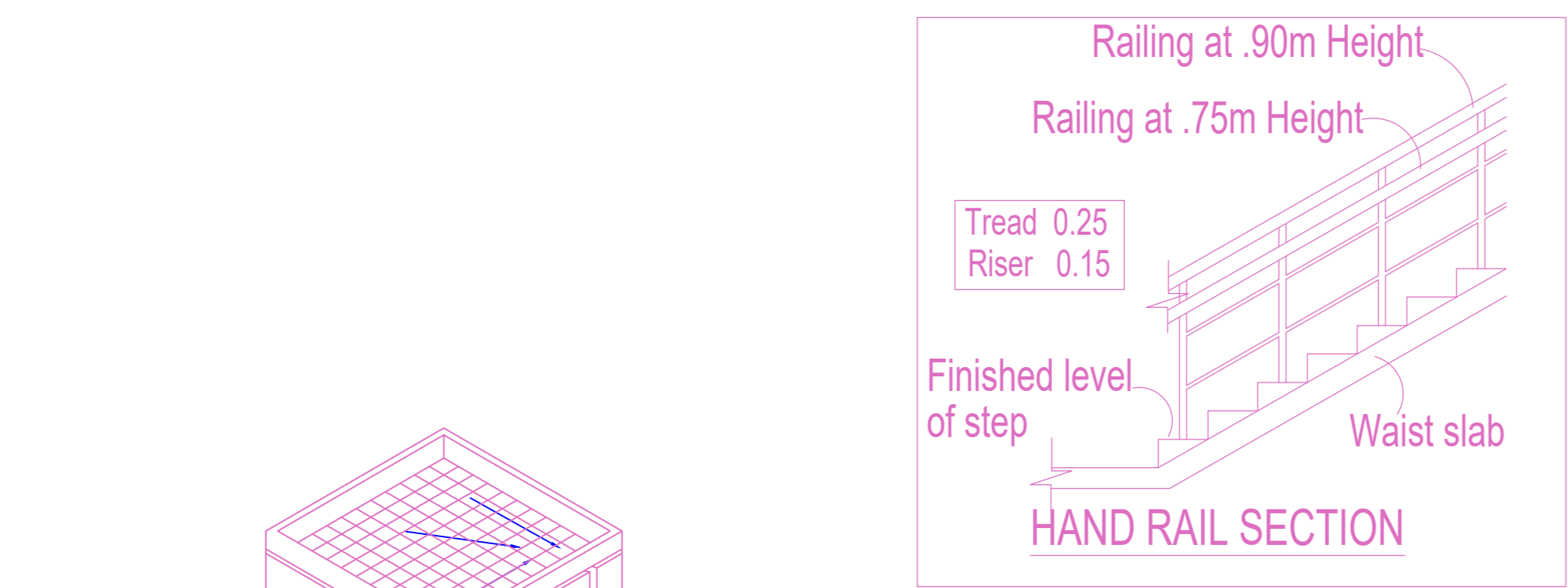
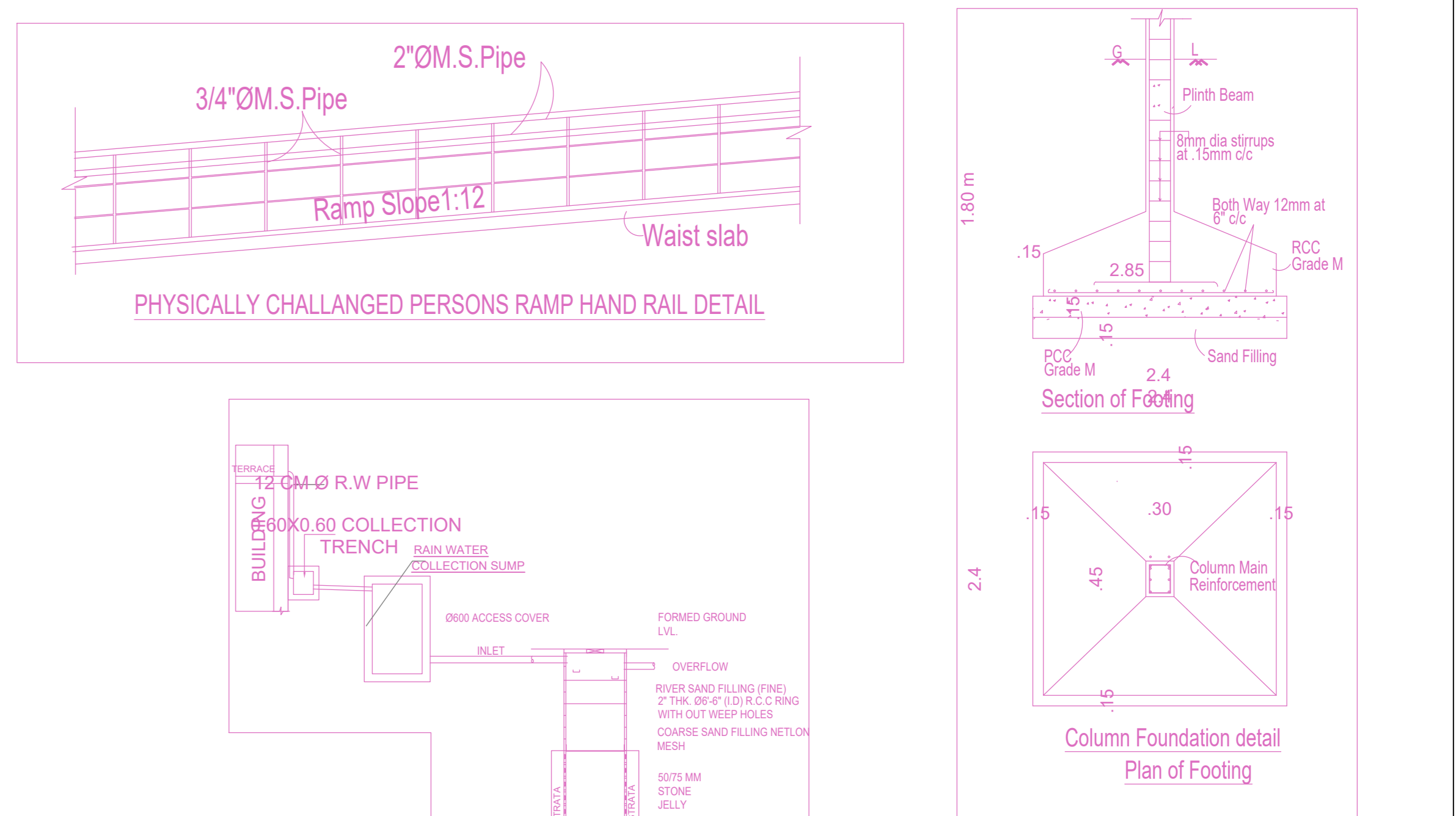
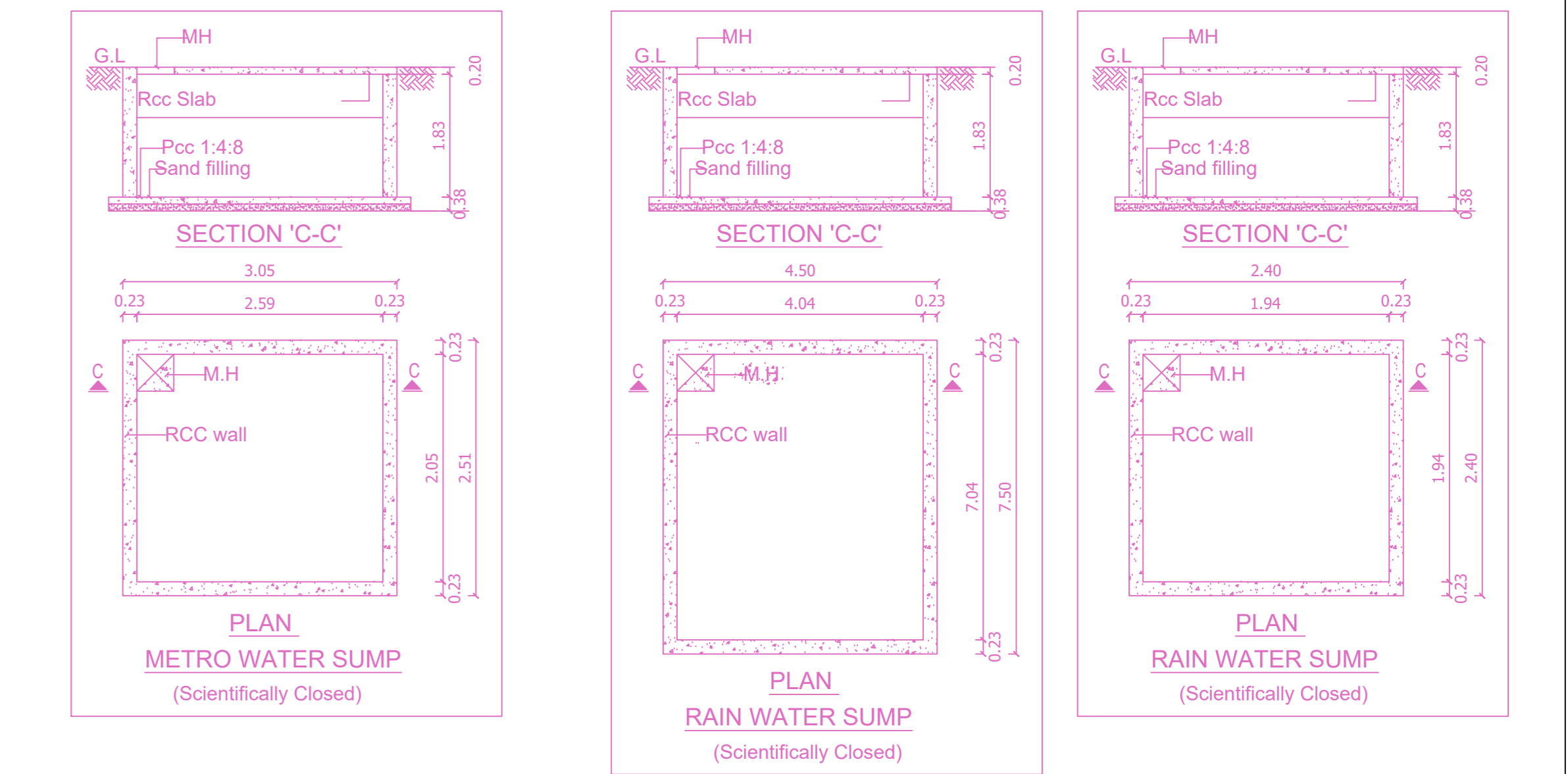
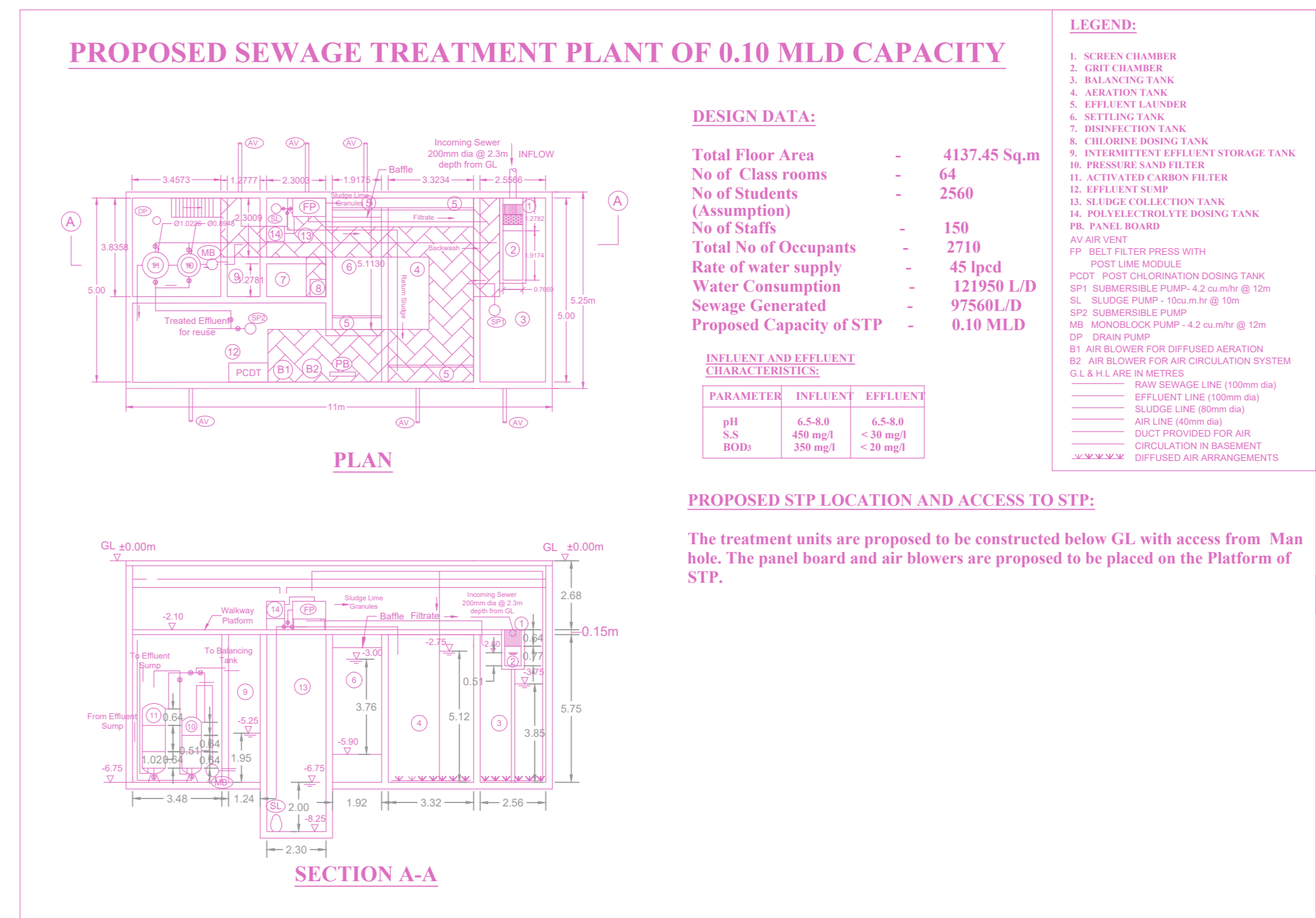
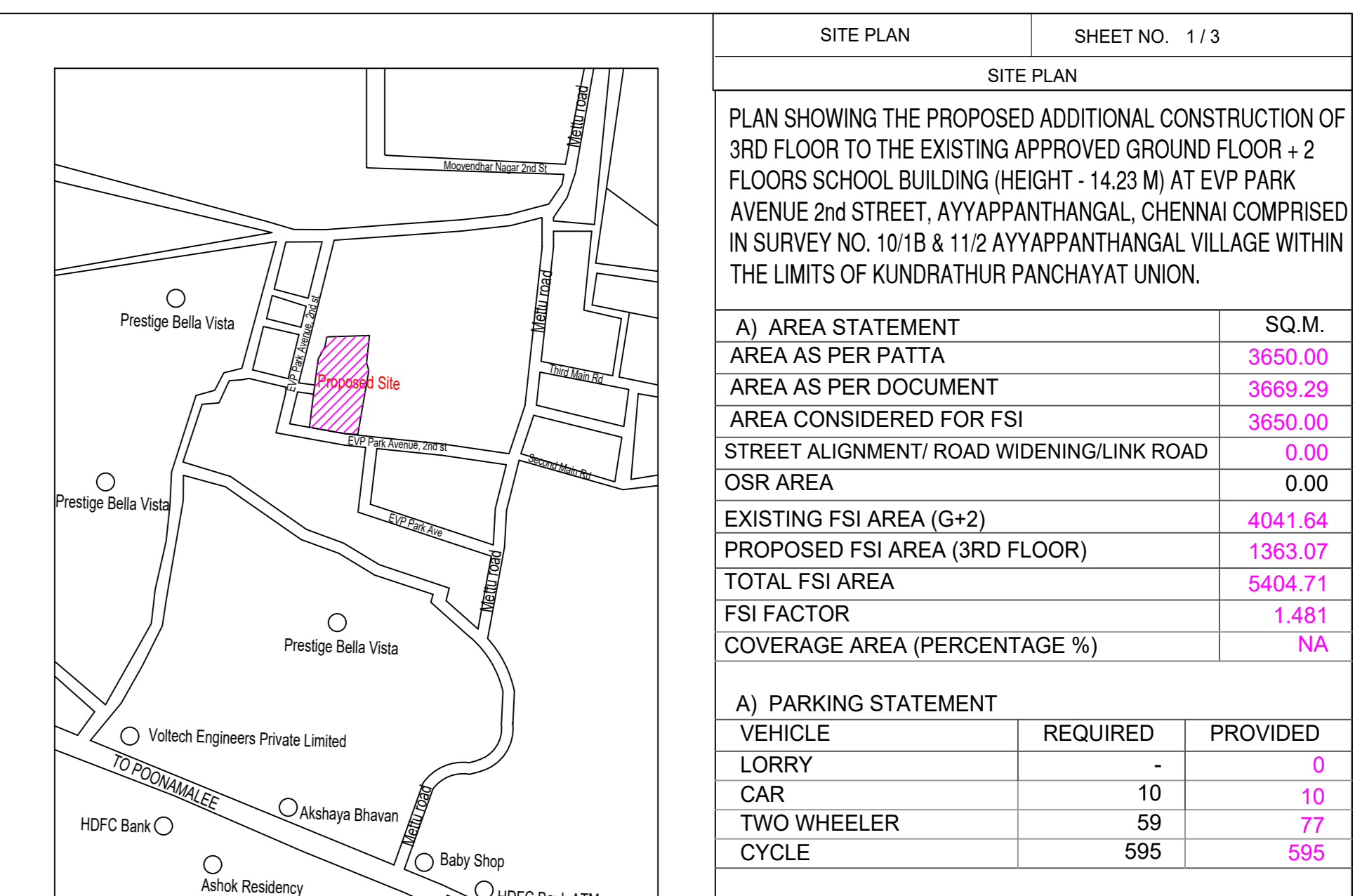

APPROVAL CONDITION

SCALE 1:100

CHENNAI METROPOLITAN DEVELOPMENT AUTHORITY
APPROVED

SUBJECT TO THE CONDITIONS MENTIONED IN THIS OFFICE

KEY NO. 8888

QR CODE

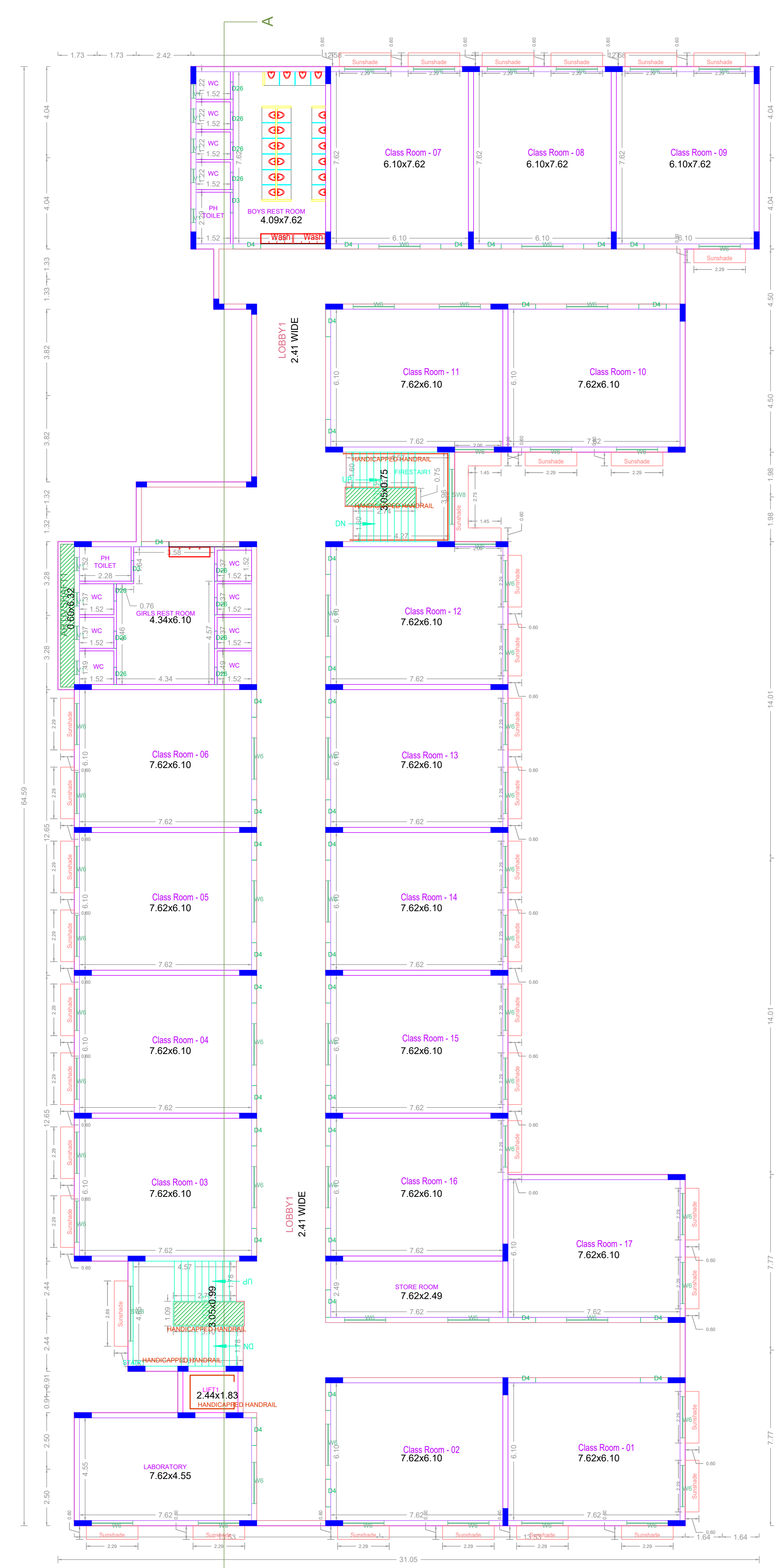

TYPICAL - 1& 2 FLOOR PLAN (EXISTING)

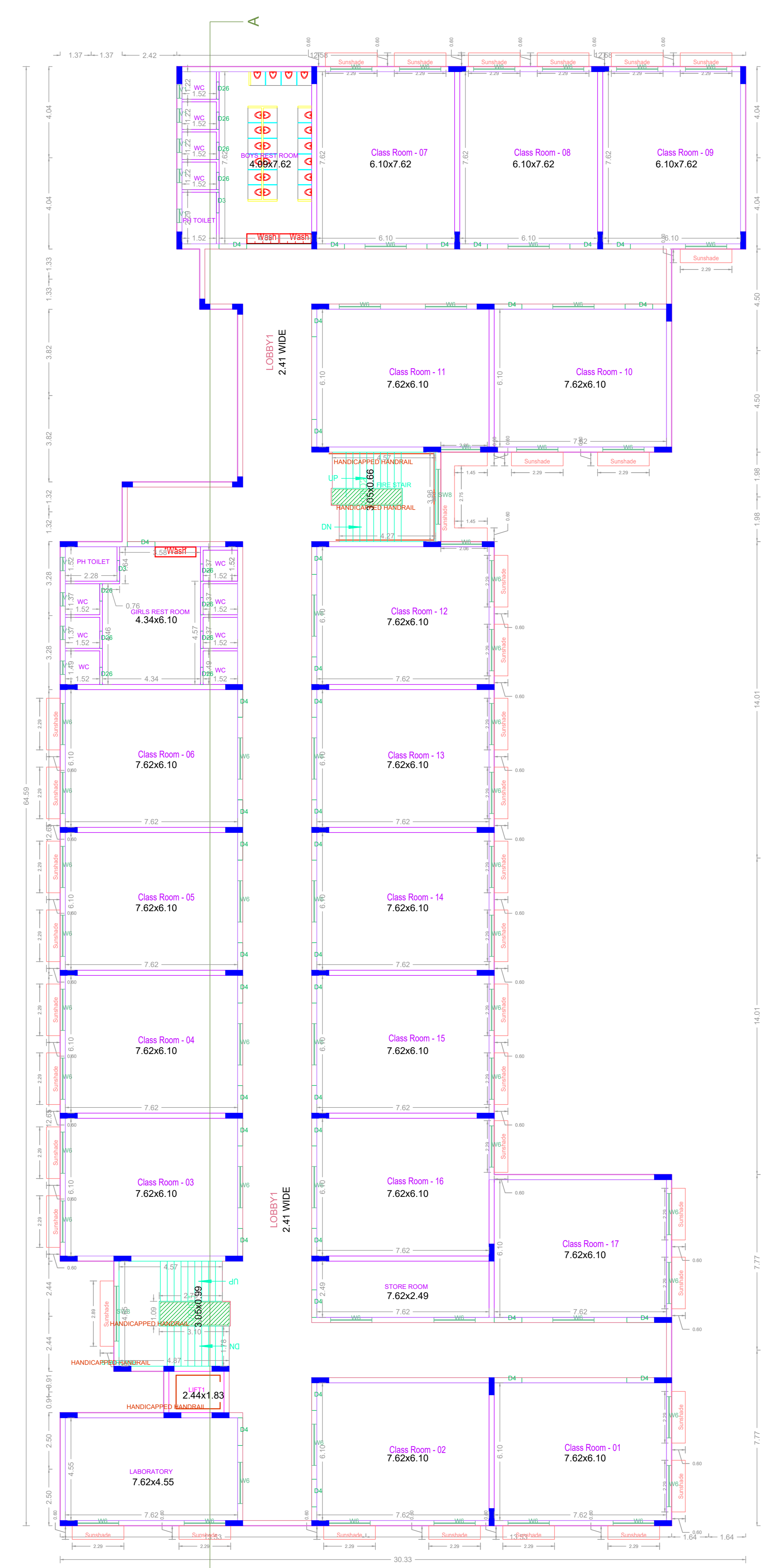

THIRD FLOOR PLAN (PROPOSED)

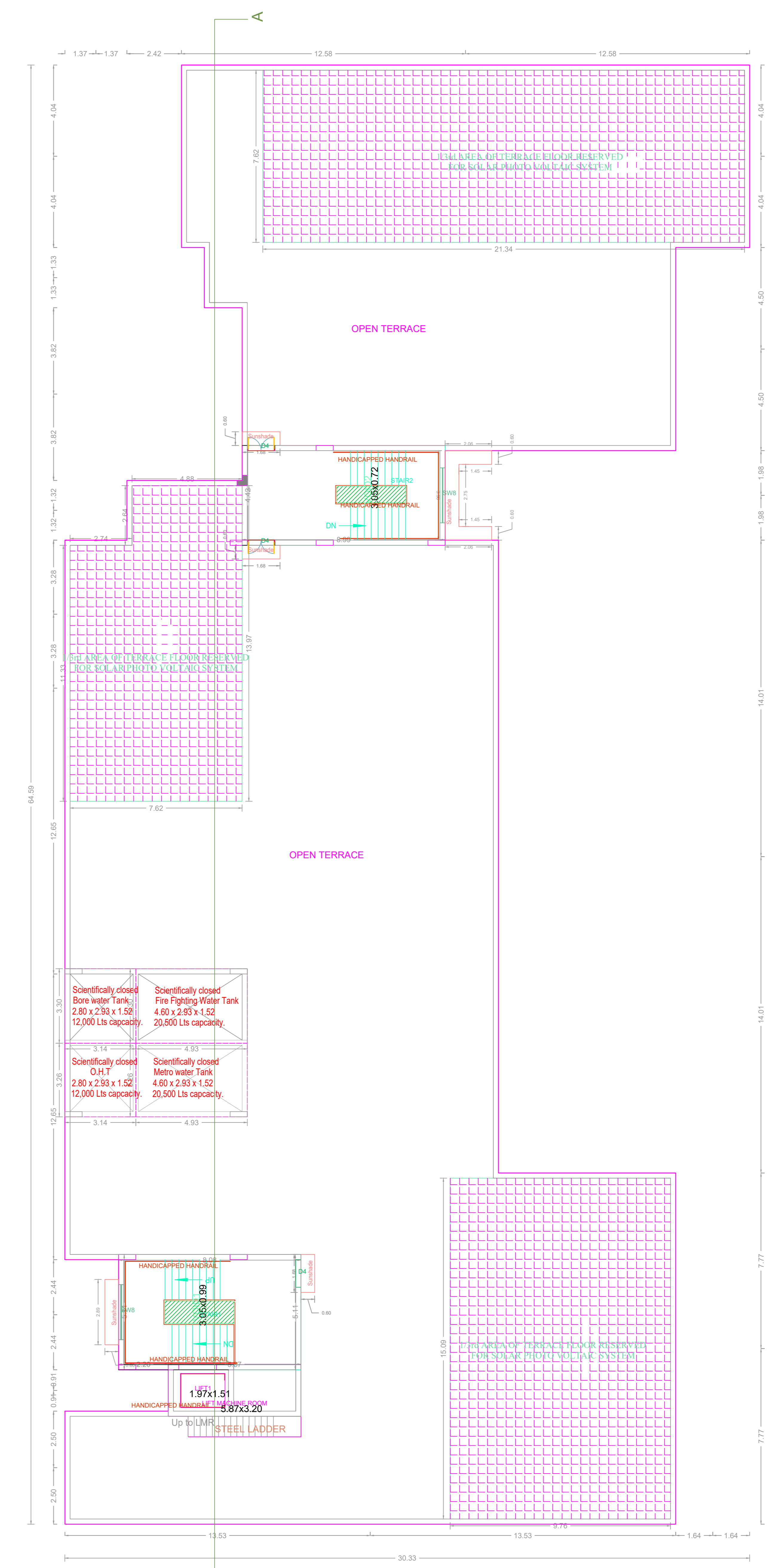

TERRACE FLOOR PLAN

APPROVAL CONDITION	
SCALE	1:100
CHENNAI METROPOLITAN DEVELOPMENT AUTHORITY APPROVED	
SUBJECT TO THE CONDITIONS MENTIONED IN THIS OFFICE	
KEY NO.	8688
QR CODE	

This Planning Permission is valid under New Rule 74(2)(b), 2016 as subject to the condition of the plan. New Rule 74(2)(b) of 2016.

For (Design/Preparer / Check/Preparer / Material/Quantity) High Rise Building / High Rise Floor Building. The Approval is valid only after building Permit is issued by the concerned Local Body.

