

SITE PLAN		SHEET NO. 1 / 5	
SITE PLAN			
PLAN SHOWING THE PROPOSED ADDITIONAL CONSTRUCTION OF GROUND FLOOR + 3 FLOORS TO THE EXISTING GROUND FLOOR + 3 FLOORS SCHOOL BUILDING (HEIGHT-15.00M) AT POONAMALLEE BYE PASS ROAD, SENEERKUPPAM, THIRUVALLUR COMPREHENSIVE IN NO.54/2A2, 54/3A1, 54/3A2, 54/6A1A & 54/6A1B OF SENEERKUPPAM VILLAGE WITHIN THE LIMITS OF POONAMALLEE PANCHAYAT UNION			
A) AREA STATEMENT			SQ.M.
AREA AS PER PATA			10950.00
AREA AS PER DOCUMENT			11007.45
AREA CONSIDERED FOR FSI			10950.00
STREET ALIGNMENT/ ROAD WIDENING/LINK ROAD			0.00
OSR AREA			1098.09
TOTAL FSI AREA			9767.61
FSI FACTOR			0.892
COVERAGE AREA (PERCENTAGE %)			NA
A) PARKING STATEMENT			
VEHICLE	REQUIRED	PROVIDED	
LORRY	-	0	
CAR	14	48	
TWO WHEELER	85	91	
CYCLE	846	915	

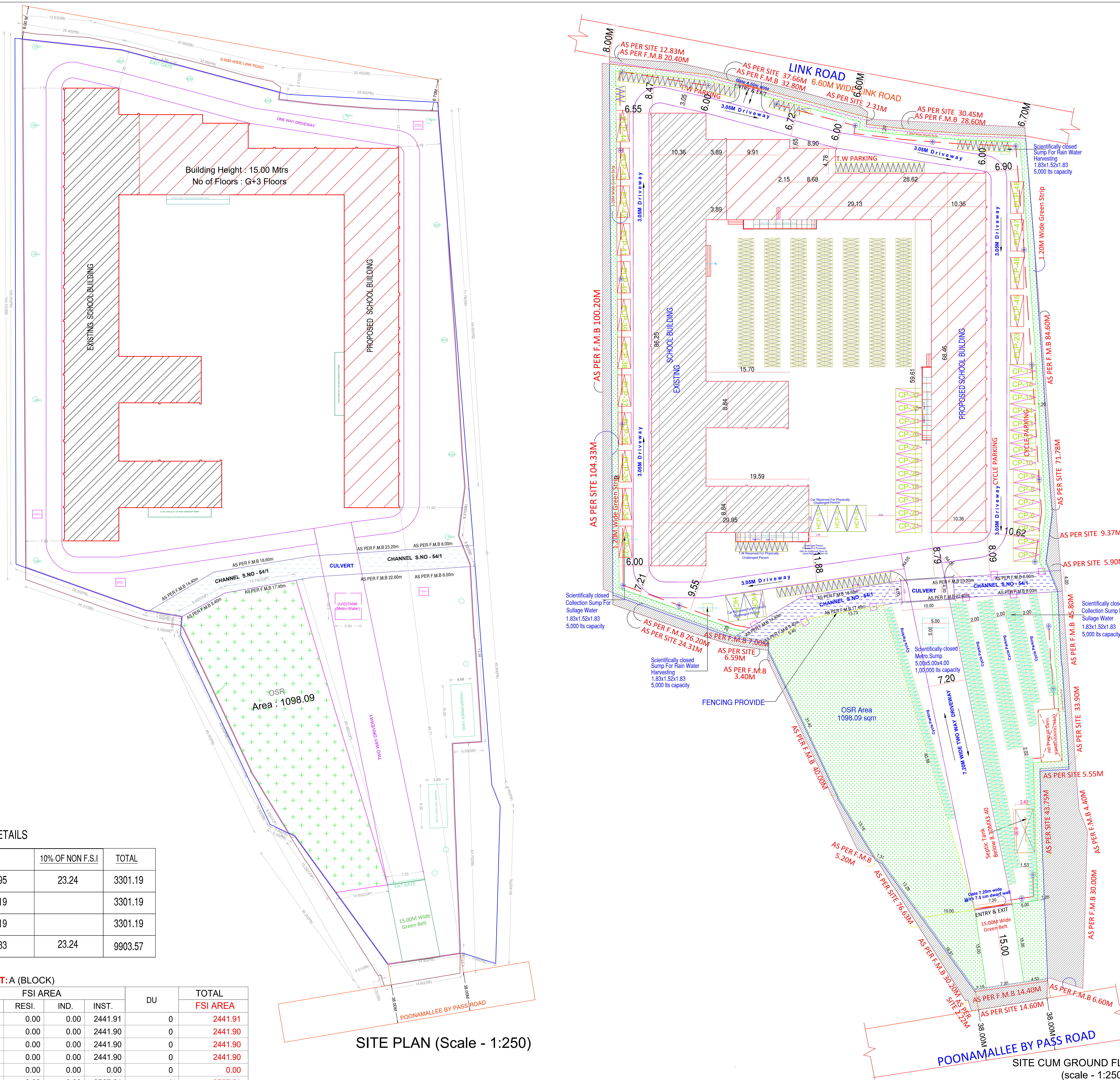
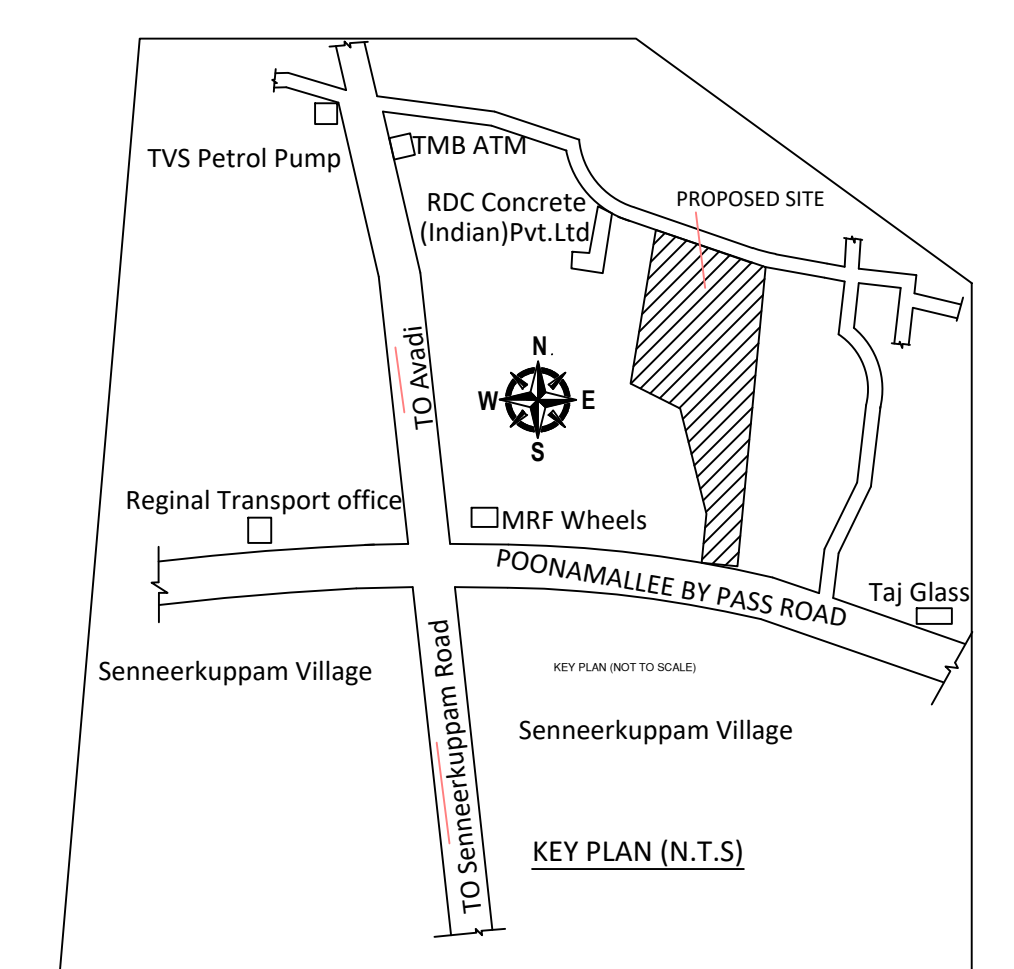

EARLIER APPROVED PLAN DETAILS

FLOOR	F.S.I	10% OF NON F.S.I	TOTAL
GROUND FLOOR	3277.95	23.24	3301.19
FIRST FLOOR	3301.19		3301.19
SECOND FLOOR	3301.19		3301.19
TOTAL	9880.33	23.24	9903.57

FLOOR WISE FSI STATEMENT: A (BLOCK)

FLOORS	FSI AREA				DU	TOTAL FSI AREA
	COMM.	RESI.	IND.	INST.		
GROUND FLOOR	0.00	0.00	0.00	2441.91	0	2441.91
FIRST FLOOR	0.00	0.00	0.00	2441.90	0	2441.90
SECOND FLOOR	0.00	0.00	0.00	2441.90	0	2441.90
THIRD FLOOR	0.00	0.00	0.00	2441.90	0	2441.90
Terrace	0.00	0.00	0.00	0.00	0	0.00
Total	0.00	0.00	0.00	9767.61	0	9767.61

BUILDING WISE FSI STATEMENT

BUILDING	NO OF SAME BUILDING	FSI AREA				DU	TOTAL FSI AREA
		COMM.	RESI.	IND.	INST.		
A-1 (BLOCK)		0.00	0.00	0.00	9767.61	0	9767.61
Total		0.00	0.00	0.00	9767.61	0	9767.61

SITE PLAN (Scale - 1:250)

SITE CUM GROUND FLOOR PLAN (scale - 1:250)

Earlier Approval Details :
 Planning Permit No:- C/9693/56/56 A TO F / 2017
 Dated : 05/12/2017
 Building Permit No:- 3059 / 2017
 Dated : 24/01/2018

APPROVAL CONDITION

Previous File No: C4/15309/2016
 Approval Date 05/12/2017
 Approval No. C/9693/56 A TO F/2017
 Permit No. 3059/2017

SCALE : 1:100

CHENNAI METROPOLITAN DEVELOPMENT AUTHORITY
APPROVED
 SUBJECT TO THE CONDITIONS MENTIONED IN THIS OFFICE

For Check/Planner / Chief Planner / Member (Secretary)
 High Rise Building / Non High Rise Building
 This Approval is valid only after building Permit is issued by the concerned Local Body.

OR
 CODE

PLAN SHOWING THE PROPOSED ADDITIONAL CONSTRUCTION OF GROUND FLOOR + 3 FLOORS TO THE EXISTING GROUND FLOOR + 3 FLOORS SCHOOL BUILDING (HEIGHT-15.00M) AT POONAMALLEE BYE PASS ROAD, SENEERKUPPAM, THIRUVALLUR COMPRISED IN NO.54/2A2, 54/3A1, 54/3A2, 54/6A1A & 54/6A1B OF SENEERKUPPAM VILLAGE WITHIN THE LIMITS OF POONAMALLEE PANCHAYAT UNION

DESIGN DATA AREA:

- TOTAL FSI AREA-9767Sqm
- NO OF ROOMS-89Nos
- NO OF STAFFS & STUDENTS-3000Nos
- RATE OF WATER SUPPLY-15Lpcd
- WATER CONSUMPTION-45000Lpcd
- SEWAGE GENERATED(85%)-38250Lpd
- PROPOSED CAPACITY OF STP-40000Lpd
- PROPOSED CAPACITY OF STP-40Kld

ACF	ACTIVATED CARBON FILTER
PSF	PRESSURE SAND FILTER
OZR	OZONATOR
FFP1/2	FILTER FEED PUMP
OMT II	OZONE MIXING TANK-II
OMT I	OZONE MIXING TANK-I
P.F	PRE FILTER
TAG NO.	DESCRIPTION

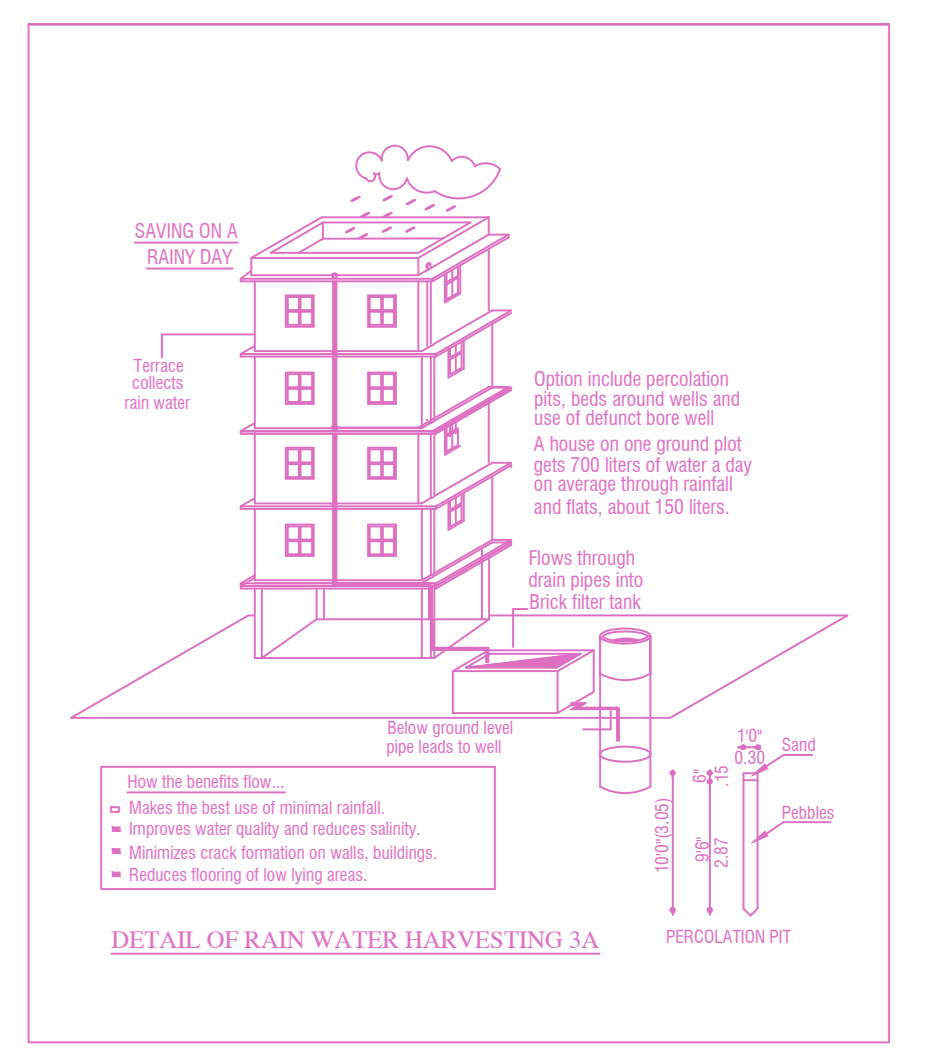
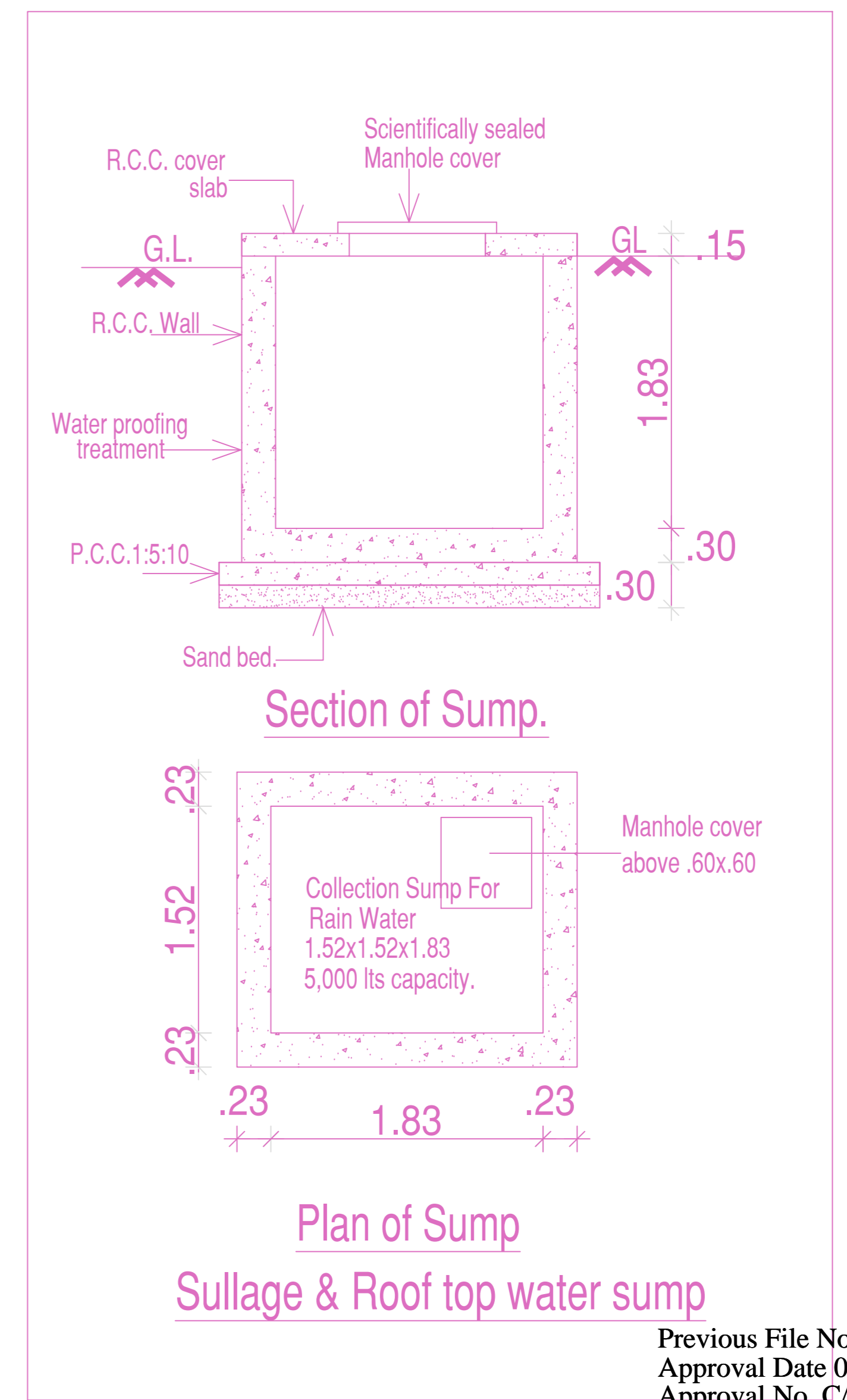
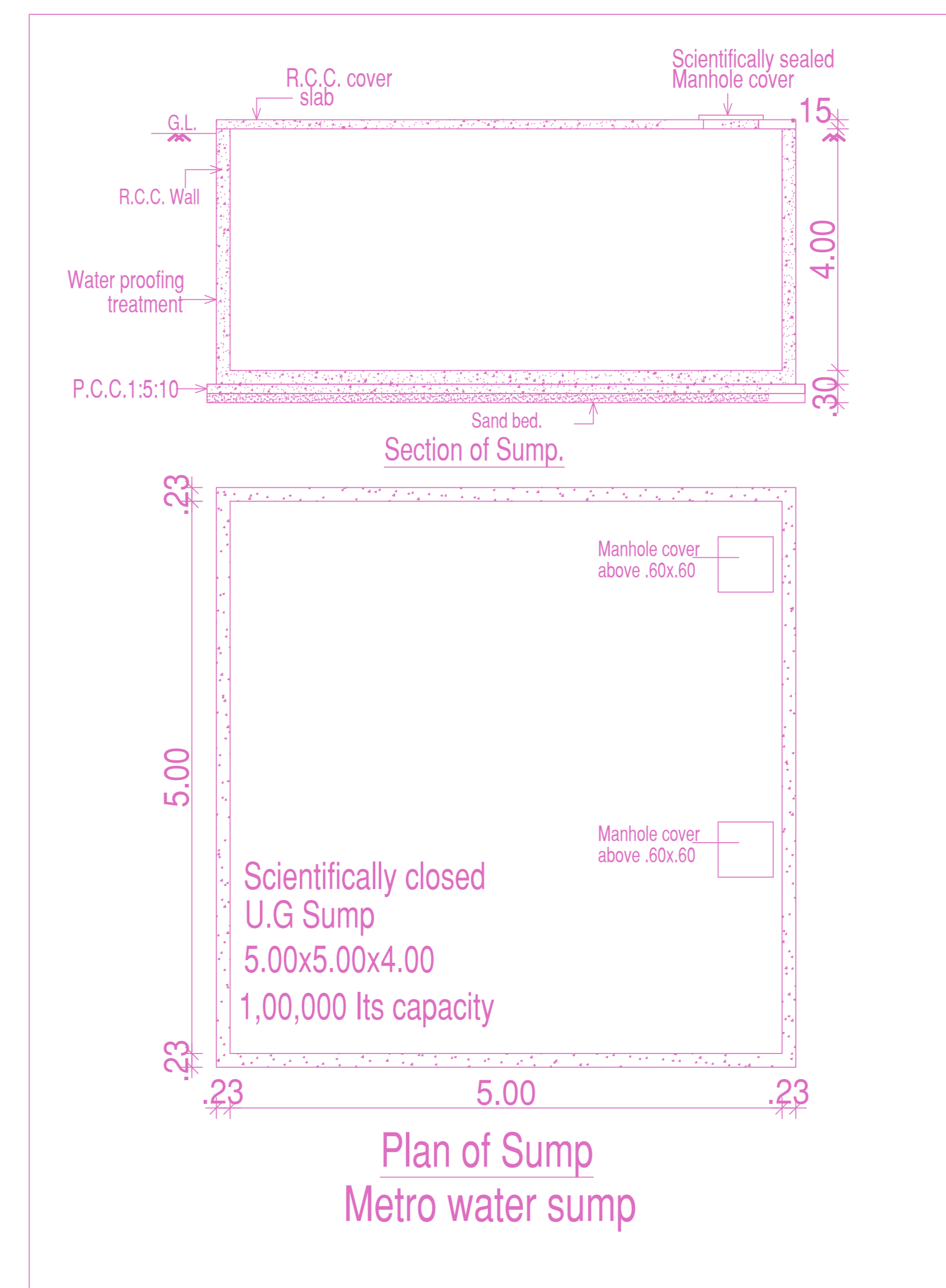
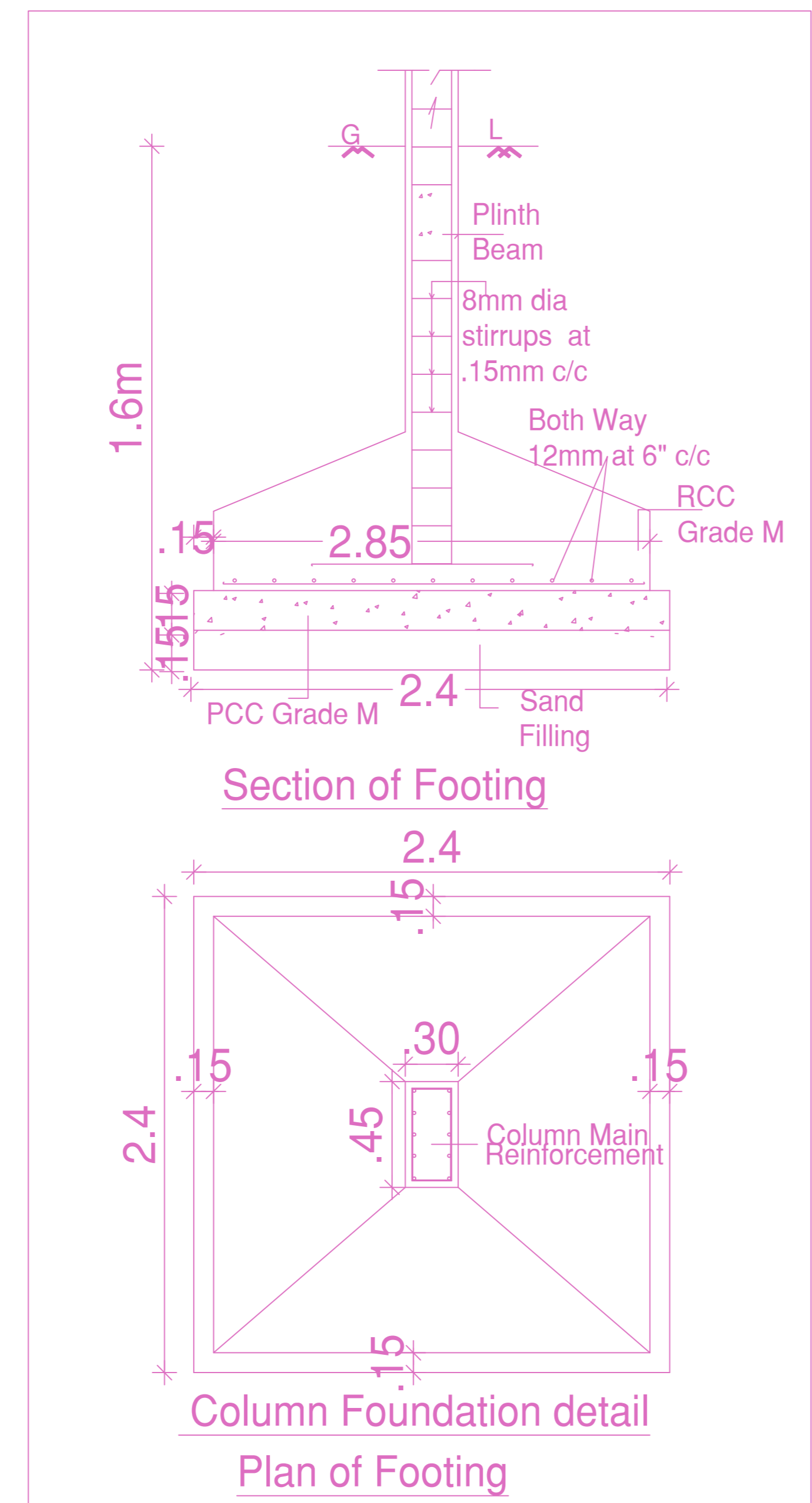
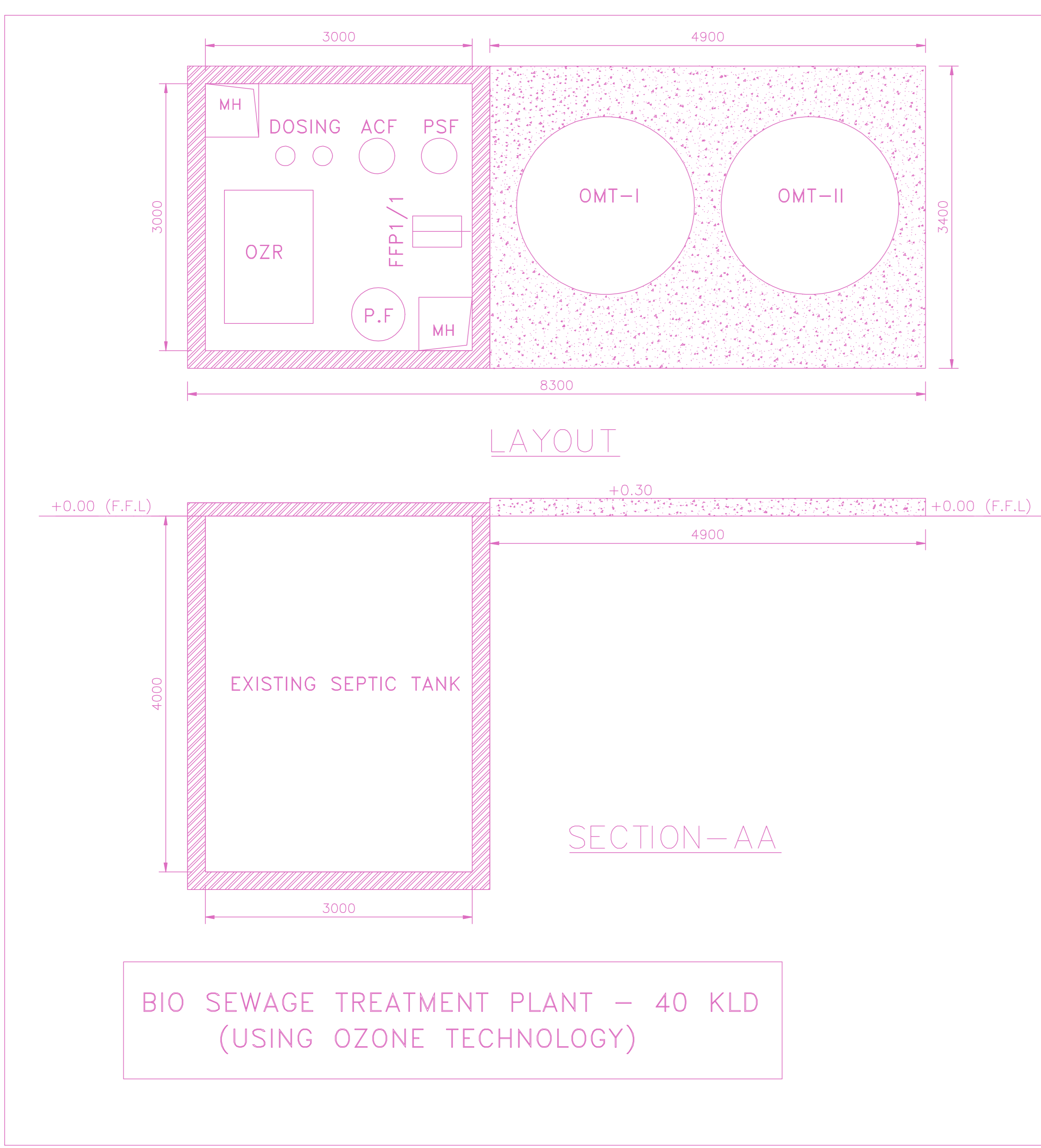
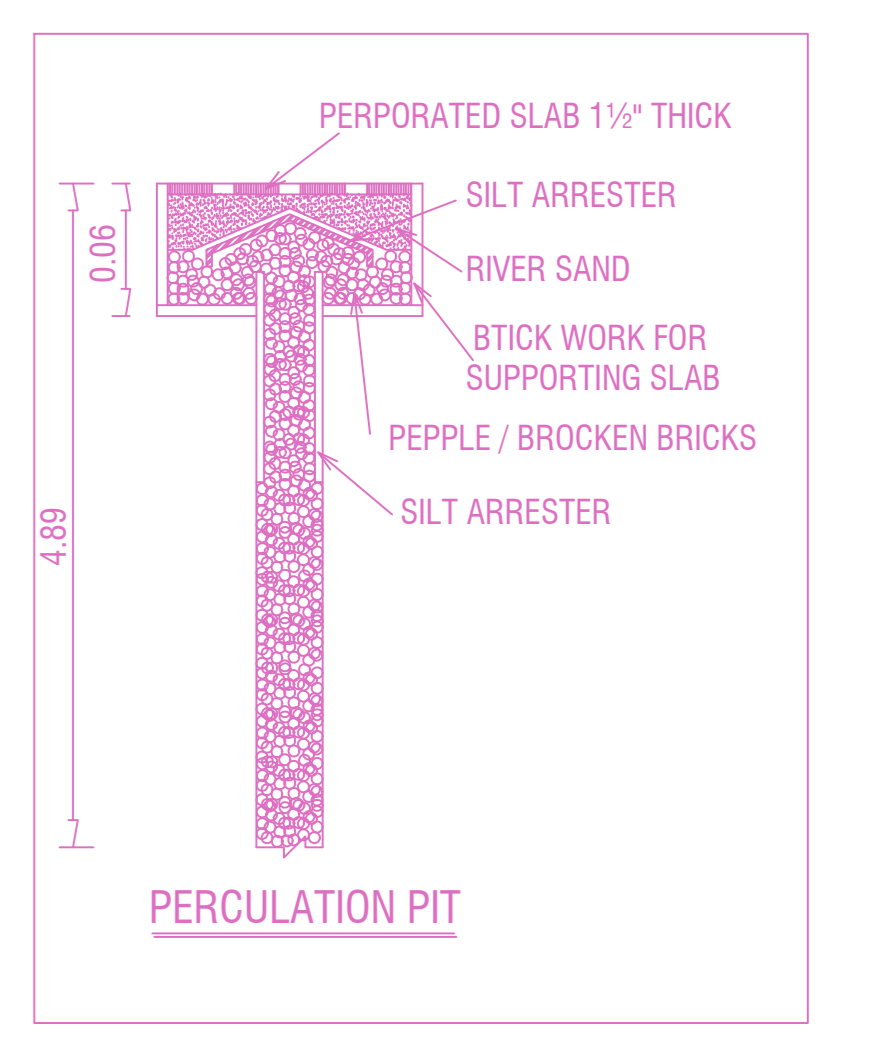
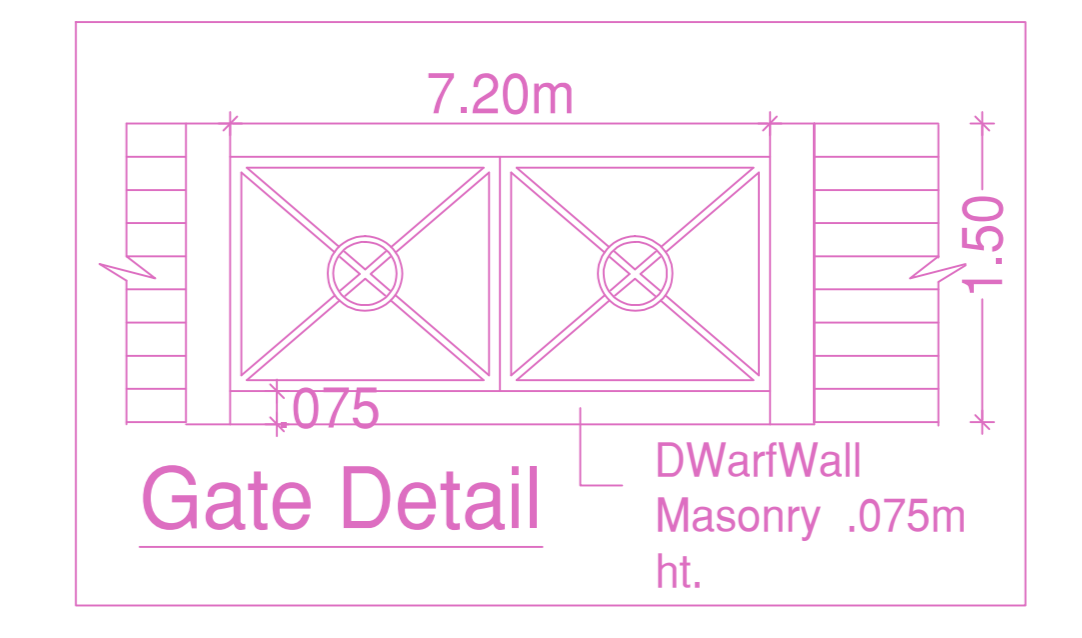
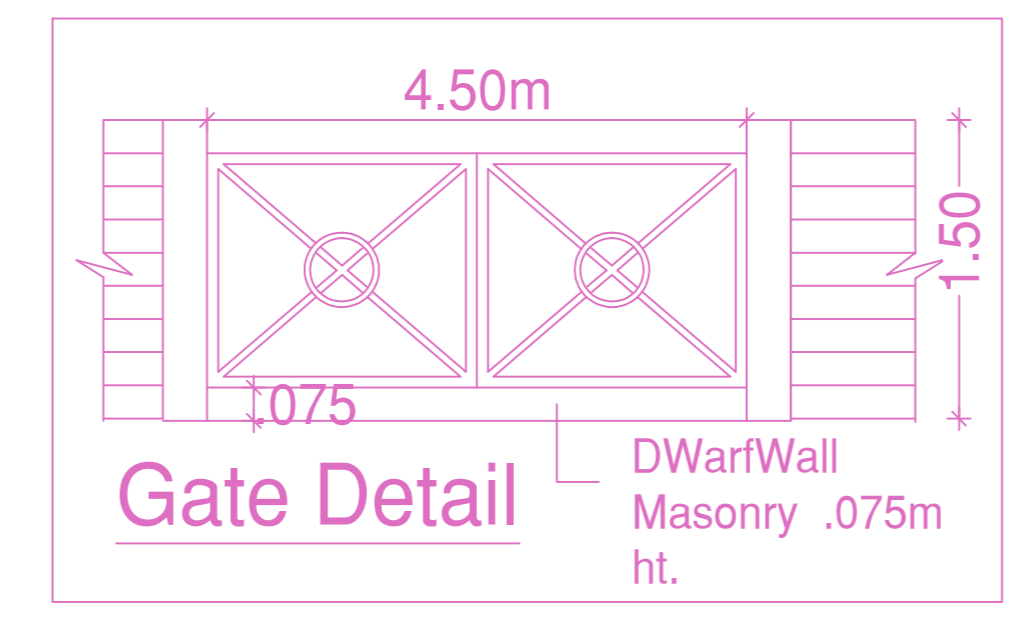
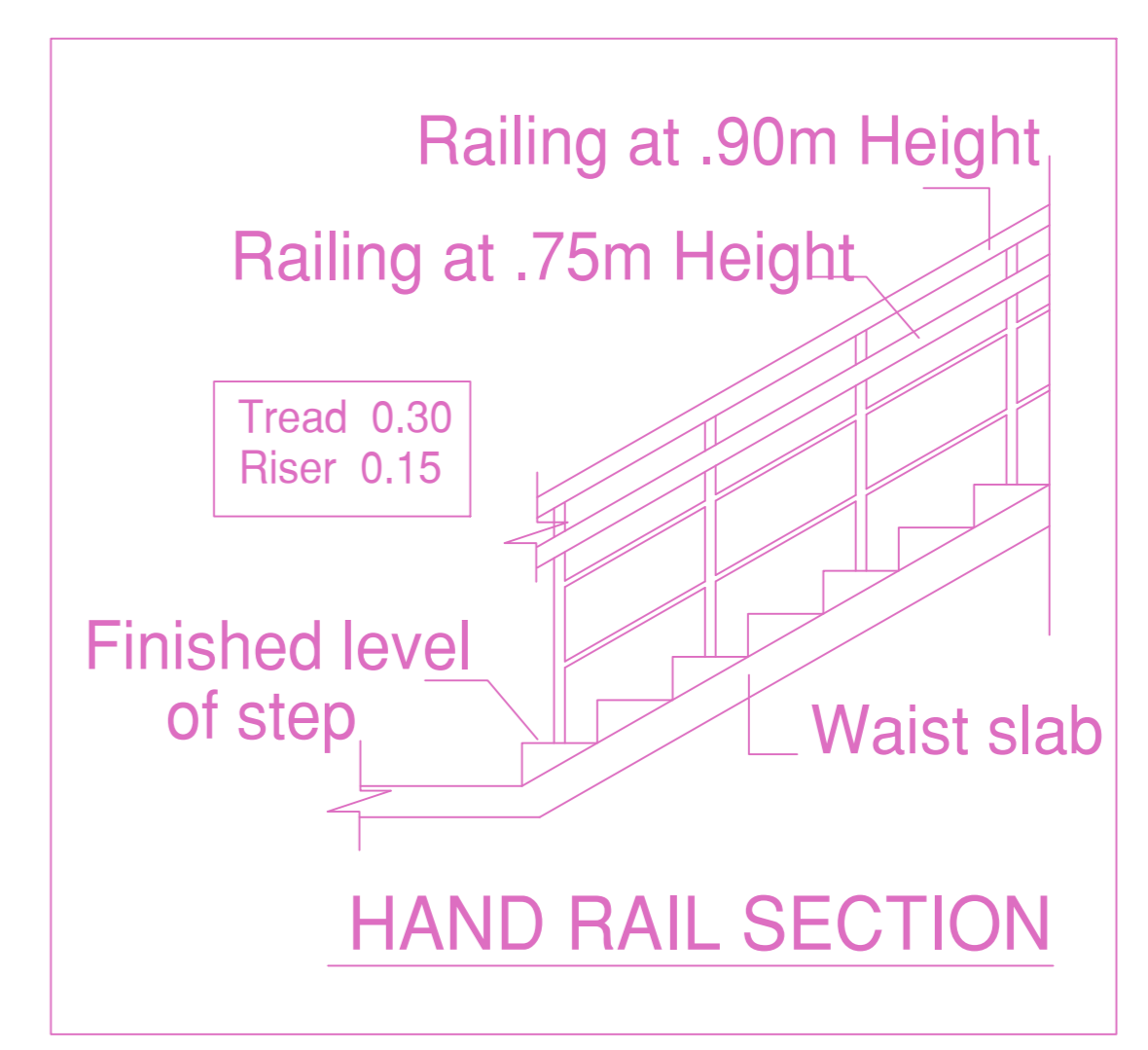
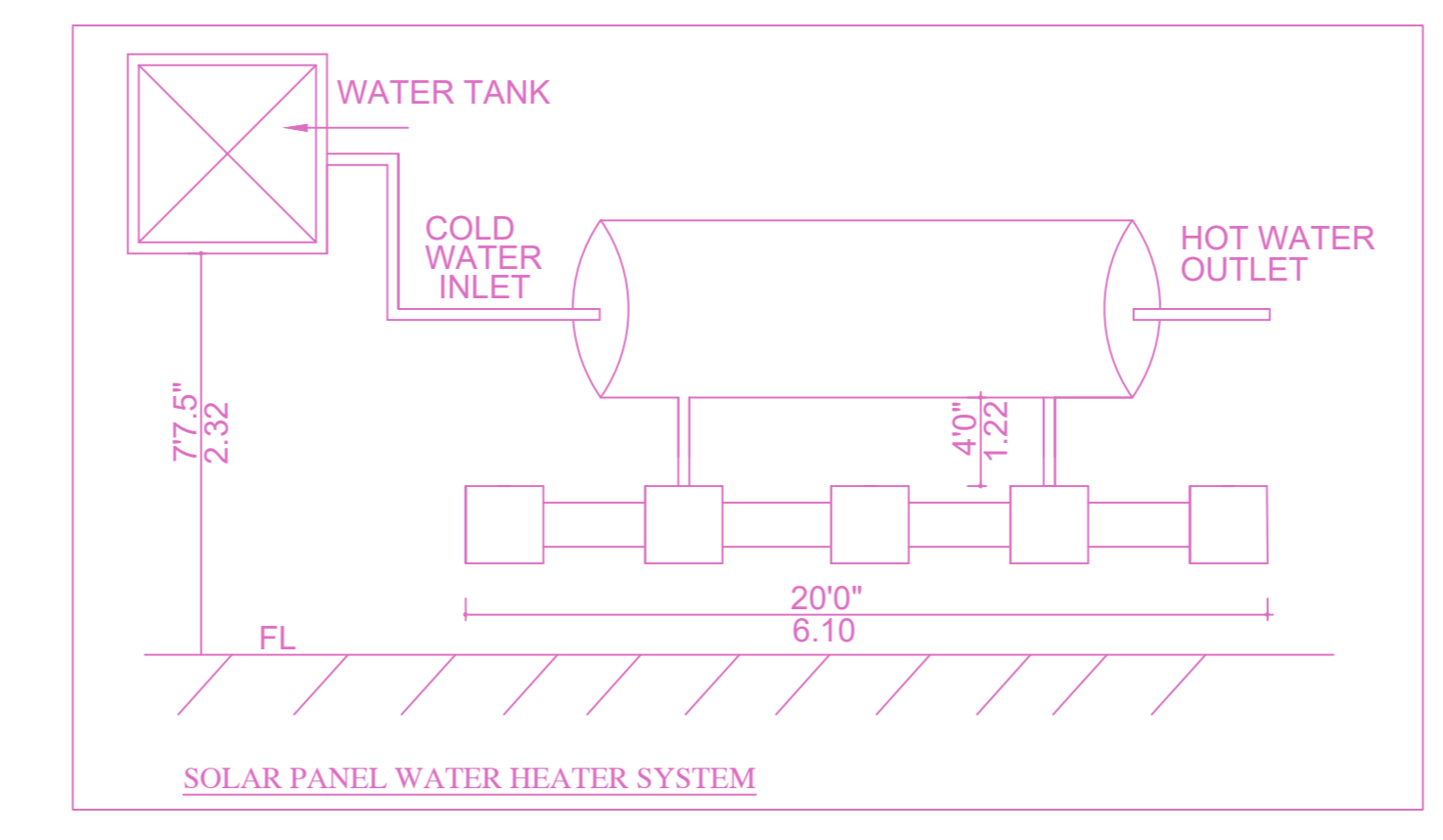
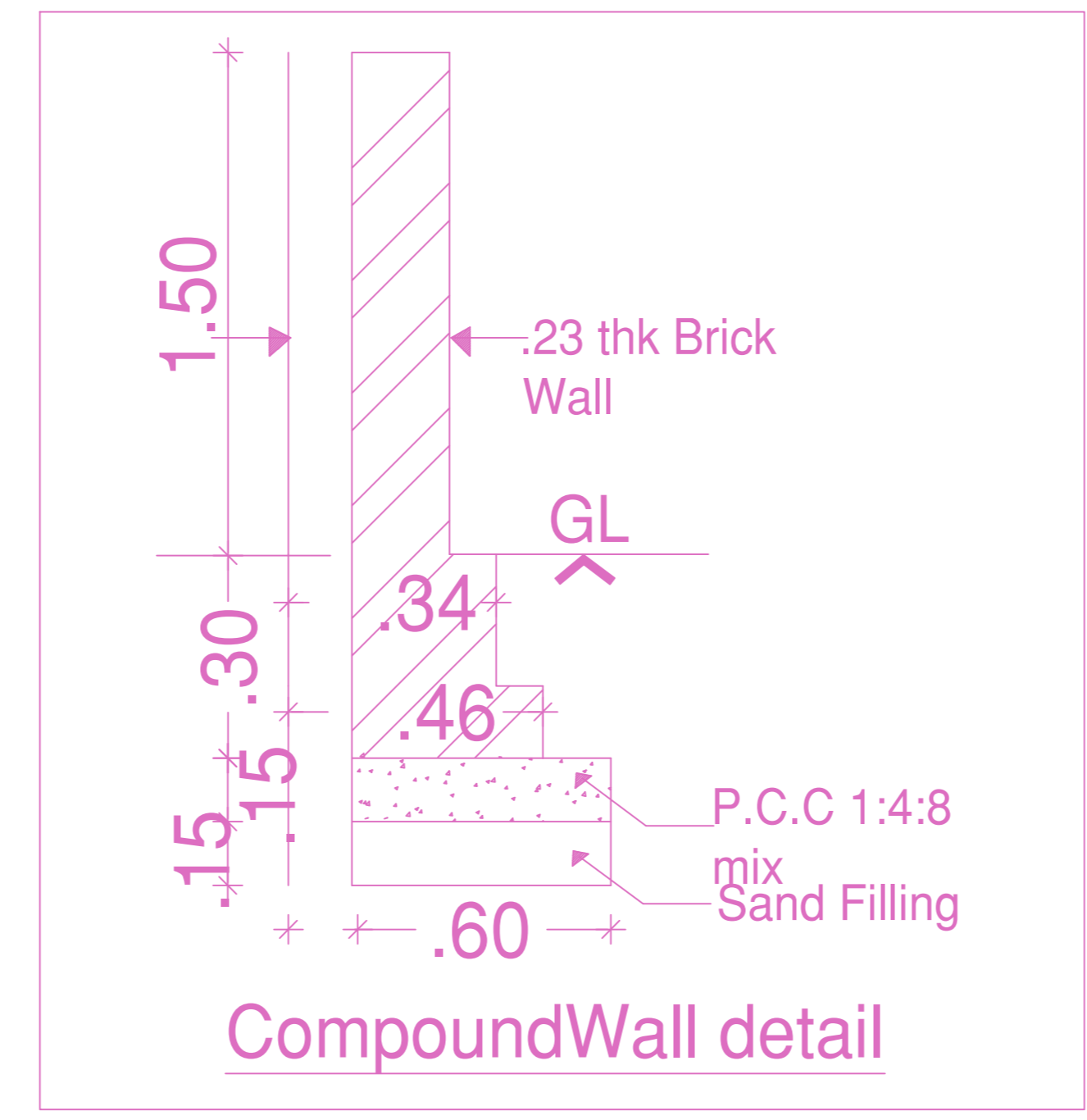

Number of Students = 3640 Nos
Number of Boys = 1820 Nos
Number of Girls = 1820 Nos

Sl. No.	Sanitary Unit	Boys	Required Nos	Provided Nos	Girls	Required Nos	Provided Nos
1	Water Closet (W.C.)	One for 40 boys or part thereof	46	46	One for 25 girls or part thereof	73	76
2	Ablution Taps	One in each W.C.	46	46	One in each W.C.	73	76
3	Urinals	One per every 20 pupils or part thereof	91	93	-		
4	Wash Basins	One for every 40 pupils or part thereof	46	46	One for every 40 pupils or part thereof	46	48
5	Drinking Water Fountains	One for every 50 pupils or part thereof	36	36	One for every 50 pupils or part thereof	36	36
6	Cleaner's Sink	One per Floor minimum	1	2	One per Floor minimum	1	2

Previous File No. C4/15309/2016
Approval Date 05/12/2017
Approval No. C/9693/56 A TO E/2017
Permit No. 3059/2017

APPROVAL CONDITION

SCALE 1:100

CHENNAI METROPOLITAN DEVELOPMENT AUTHORITY
APPROVED

SUBJECT TO THE CONDITIONS MENTIONED IN THIS OFFICE

For (Deputy Planner / Chief Planner / Member Secretary)
High Rise Building / Non High Rise Building
This Approval is valid only after building Permit is issued by the Government Local Body.

OR CODE

PLAN SHOWING THE PROPOSED ADDITIONAL CONSTRUCTION OF GROUND FLOOR + 3 FLOORS SCHOOL BUILDING (HEIGHT-15.00M) AT POONAMALLEE BYE PASS ROAD, SENEERKUPPAM, THIRUVALLUR COMPRISED IN NO.54/2A2, 54/3A1, 54/3A2, 54/6A1A & 54/6A1B OF SENEERKUPPAM VILLAGE WITHIN THE LIMITS OF POONAMALLEE PANCHAYAT UNION

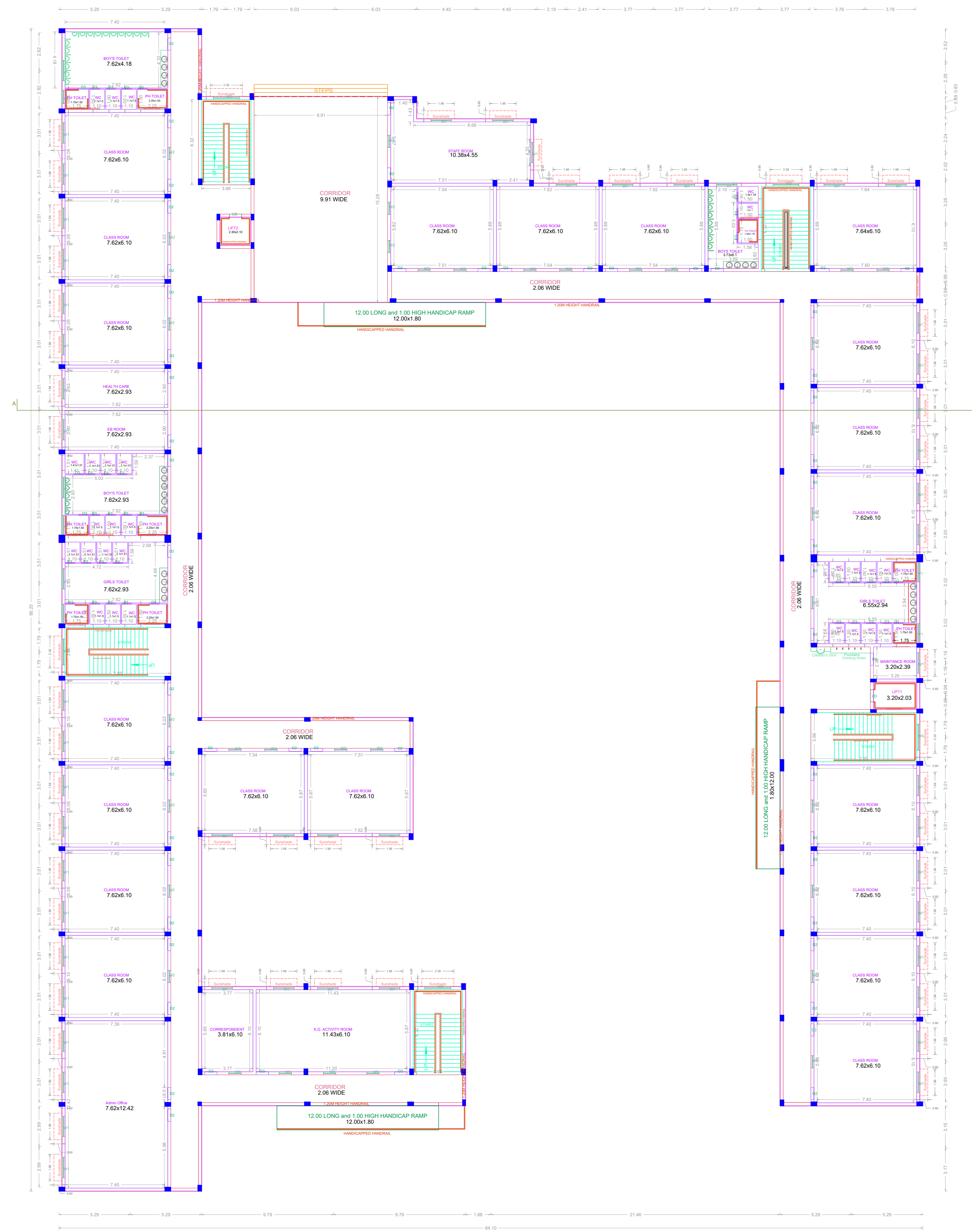

EXISTING CUM PROPOSED GROUND FLOOR PLAN

(Scale - 1:150)

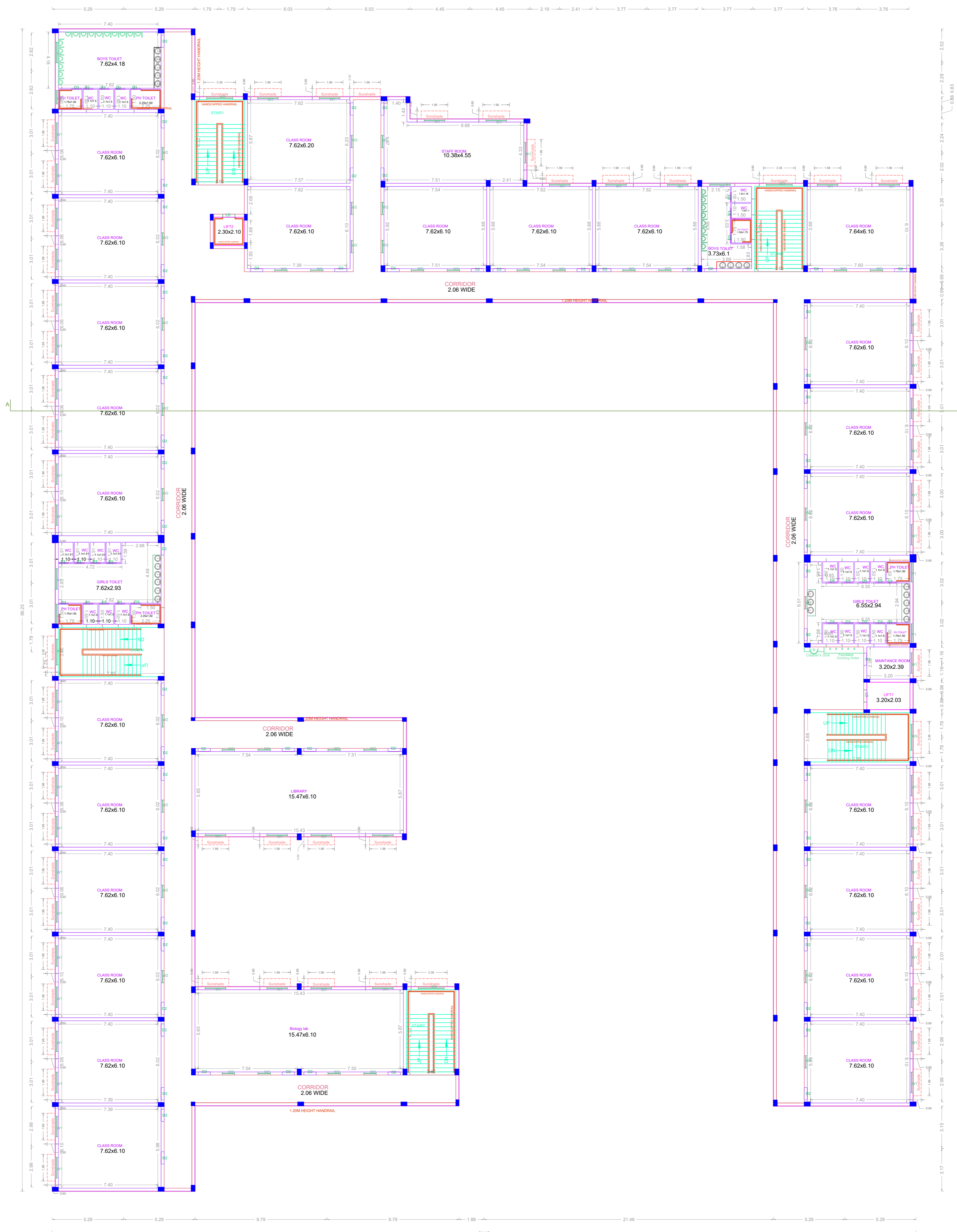

EXISTING CUM PROPOSED FIRST FLOOR PLAN

(Scale - 1:150)

Previous File No. C4/15309/2016
Approval Date 05/12/2017
Approval No. C/9693/56 A TO E/2017
Permit No. 3059/2017

APPROVAL CONDITION

SCALE 1:100

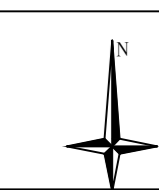

CHENNAI METROPOLITAN DEVELOPMENT AUTHORITY

APPROVED

SUBJECT TO THE CONDITIONS MENTIONED IN THIS OFFICE

For (Deputy Planner / Chief Planner / Member Secretary)
High Rise Building / Non High Rise Building
This Approval is valid only after building Permit is issued by the Government Local Body.

KEY NO.

QR CODE

This Drawing Permission Granted under
New Rule 194-C/D/E/F, 2015 is subject to
the provisions of Rule 192, 193,
(M) No. 2008 of 2015 and (M)P (M)C
New Rule 4 & 5 of 2015.

PLAN SHOWING THE PROPOSED ADDITIONAL CONSTRUCTION OF GROUND FLOOR + 3 FLOORS TO THE EXISTING GROUND FLOOR + 3 FLOORS SCHOOL BUILDING (HEIGHT-15.00M) AT POONAMALLEE BYE PASS ROAD, SENEERKUPPAM, THIRUVALLUR COMPRISED IN NO.54/2A2, 54/3A1, 54/3A2, 54/6A1A & 54/6A1B OF SENEERKUPPAM VILLAGE WITHIN THE LIMITS OF POONAMALLEE PANCHAYAT UNION

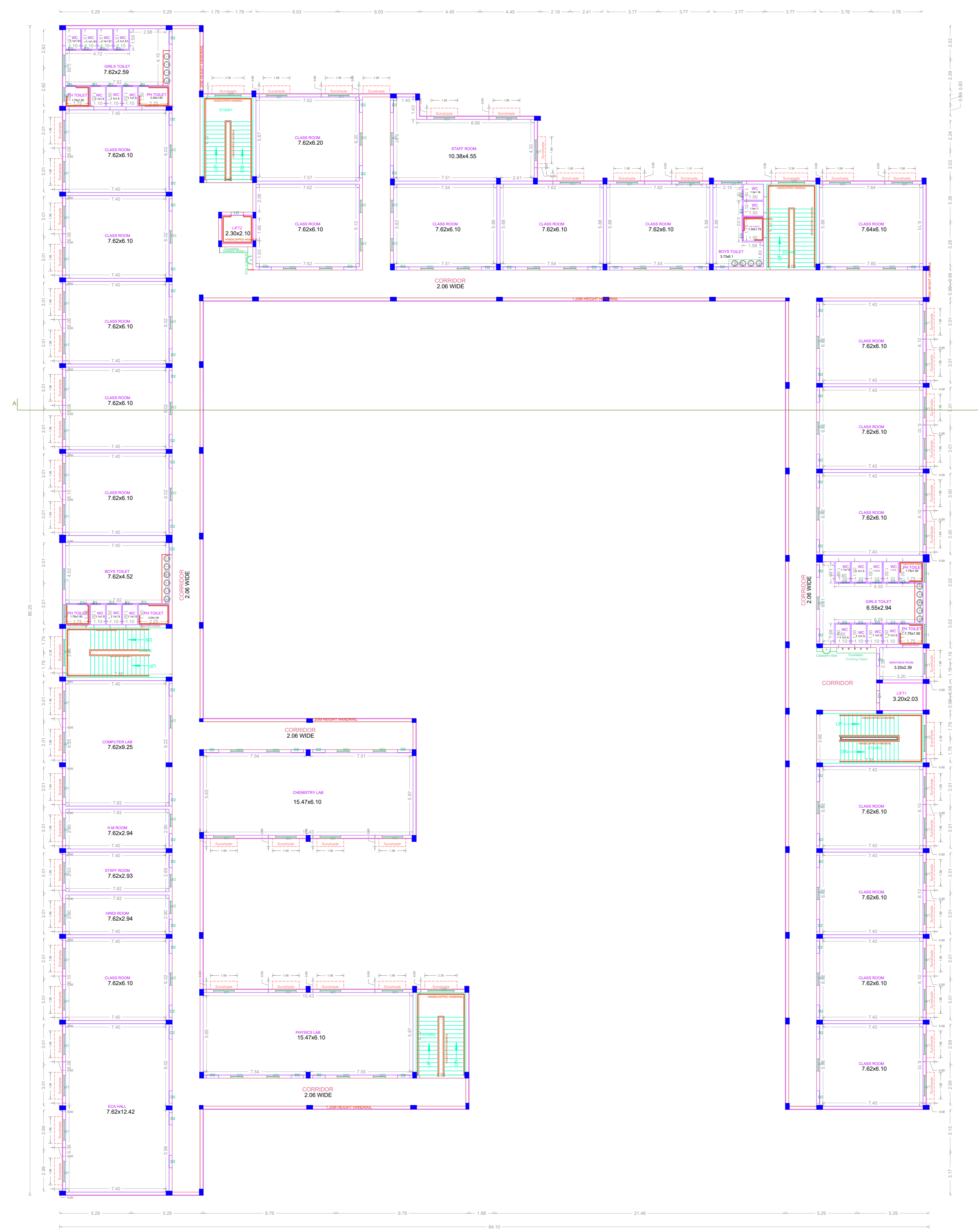

EXISTING CUM PROPOSED SECOND FLOOR PLAN
(Scale - 1:150)

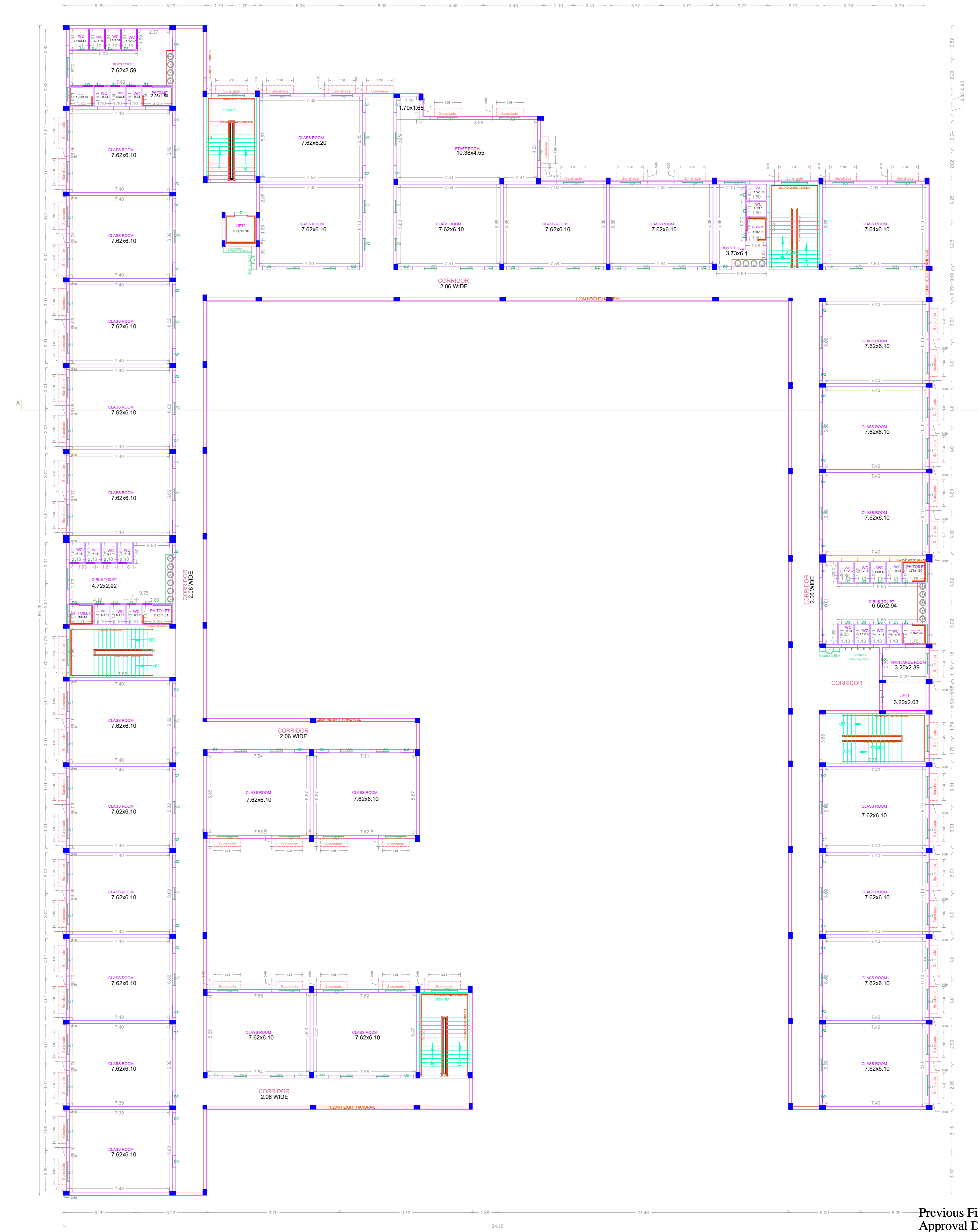

EXISTING CUM PROPOSED THIRD FLOOR PLAN
(Scale - 1:150)

Previous File No. C4/15309/2016
Approval Date 05/12/2017
Approval No. C/9693/56 A TO E/2017
Permit No. 3059/2017

APPROVAL CONDITION

SCALE 1:100

CHENNAI METROPOLITAN DEVELOPMENT AUTHORITY
APPROVED

SUBJECT TO THE CONDITIONS MENTIONED IN THIS OFFICE

For (Deputy Planner / Chief Planner / Member Secretary)
High Rise Building / Non High Rise Building
This Approval is valid only after building Permit is issued by the Government Local Body.

APPLICANTS (Owner / Developer / Power of Attorney)

APPROVED

QR CODE

