

PLAN SHOWING THE PROPOSED CONSTRUCTION OF GROUND FLOOR + 2 FLOORS (HEIGHT-11.72M) HIGHER SECONDARY SCHOOL BUILDING AT THIRUVANCHERI VILLAGE, TAMBARAM TALUK COMPRISED IN S.NO.71/7A1E & 45, 72/1A3, 1B1, 1B2, 1D2, 1E2, 1E3, 1E8, 1E9, 1E10, 1E11, 1E12, 1E13, 1F1, 1F2 OF THIRUVANCHERI VILLAGE WITHIN THE LIMIT OF ST. THOMAS MOUNT PANCHAYAT UNION.

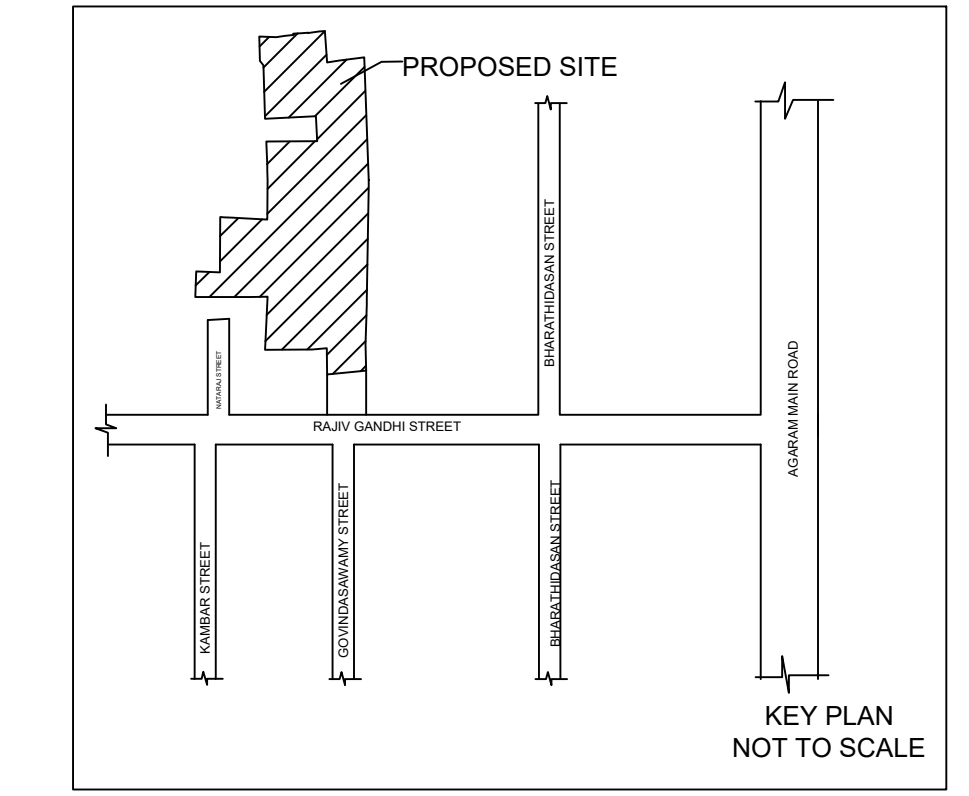

A) AREA STATEMENT	SQ.M.
AREA AS PER PATTA	6333.00
AREA AS PER DOCUMENT	6997.22
AREA CONSIDERED FOR FSI	6333.00
STREET ALIGNMENT/ ROAD WIDENING/ LINK ROAD	0.00
OSR AREA	0.00
TOTAL FSI AREA	4344.20
FSI FACTOR	0.686
COVERAGE AREA (PERCENTAGE %)	NA

A) PARKING STATEMENT	REQUIRED	PROVIDED
VEHICLE		
LORRY	-	0
CAR	5	12
TWO WHEELER	33	44
CYCLE	288	410

FLOOR	COLM	REAR	INLET	DU	TOTAL
GROUND FLOOR	0.00	0.00	0.00	1462.24	0
FIRST FLOOR	0.00	0.00	0.00	1446.96	0
SECOND FLOOR	0.00	0.00	0.00	1446.96	0
Sum	0.00	0.00	0.00	4356.16	0
Total	0.00	0.00	0.00	4344.20	0

BUILDING USE	FSI AREA	COLM	REAR	INLET	DU	TOTAL
AT/SCHOOL	0.00	0.00	0.00	284.20	0	284.20
Total	0.00	0.00	0.00	284.20	0	284.20

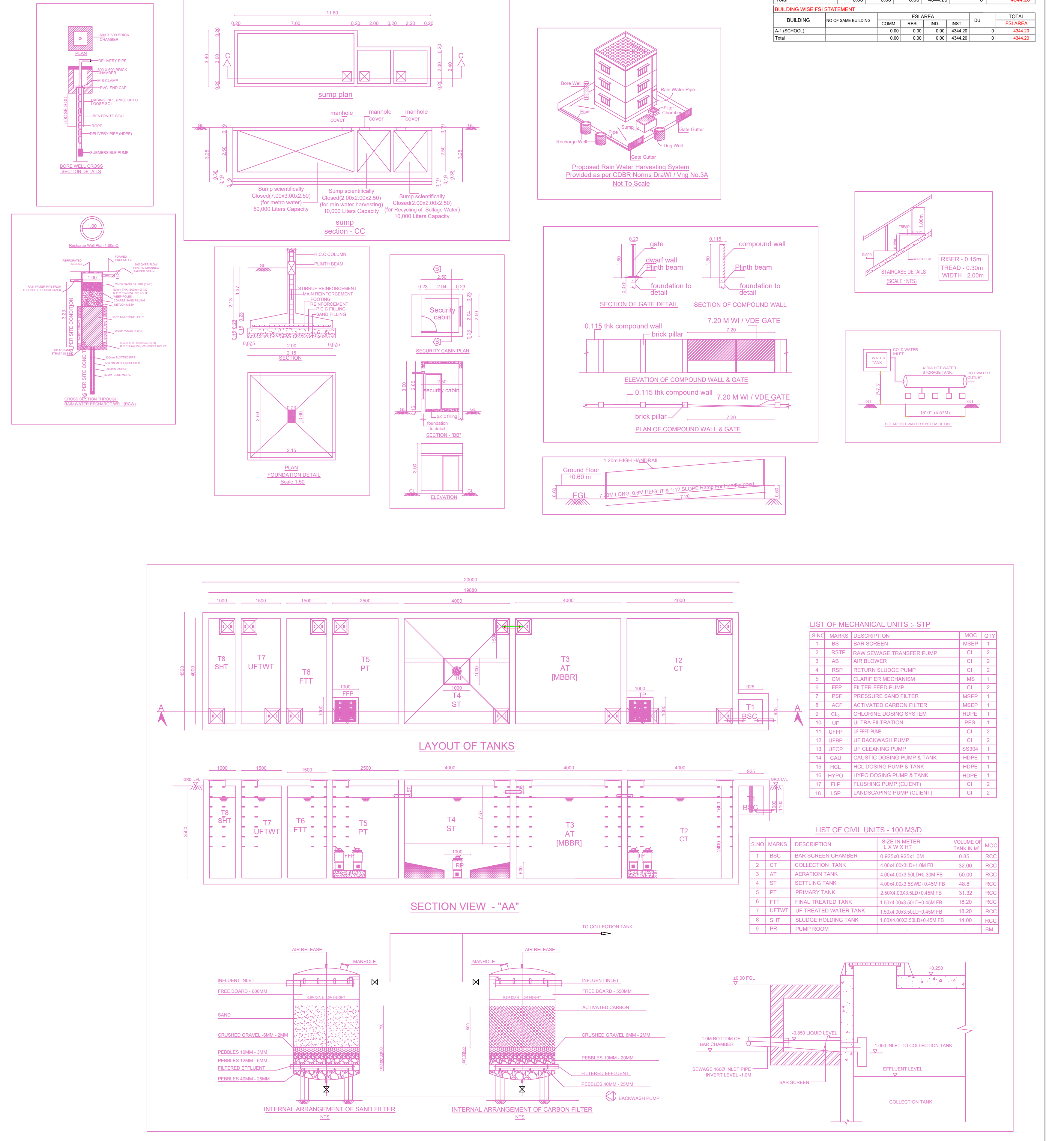
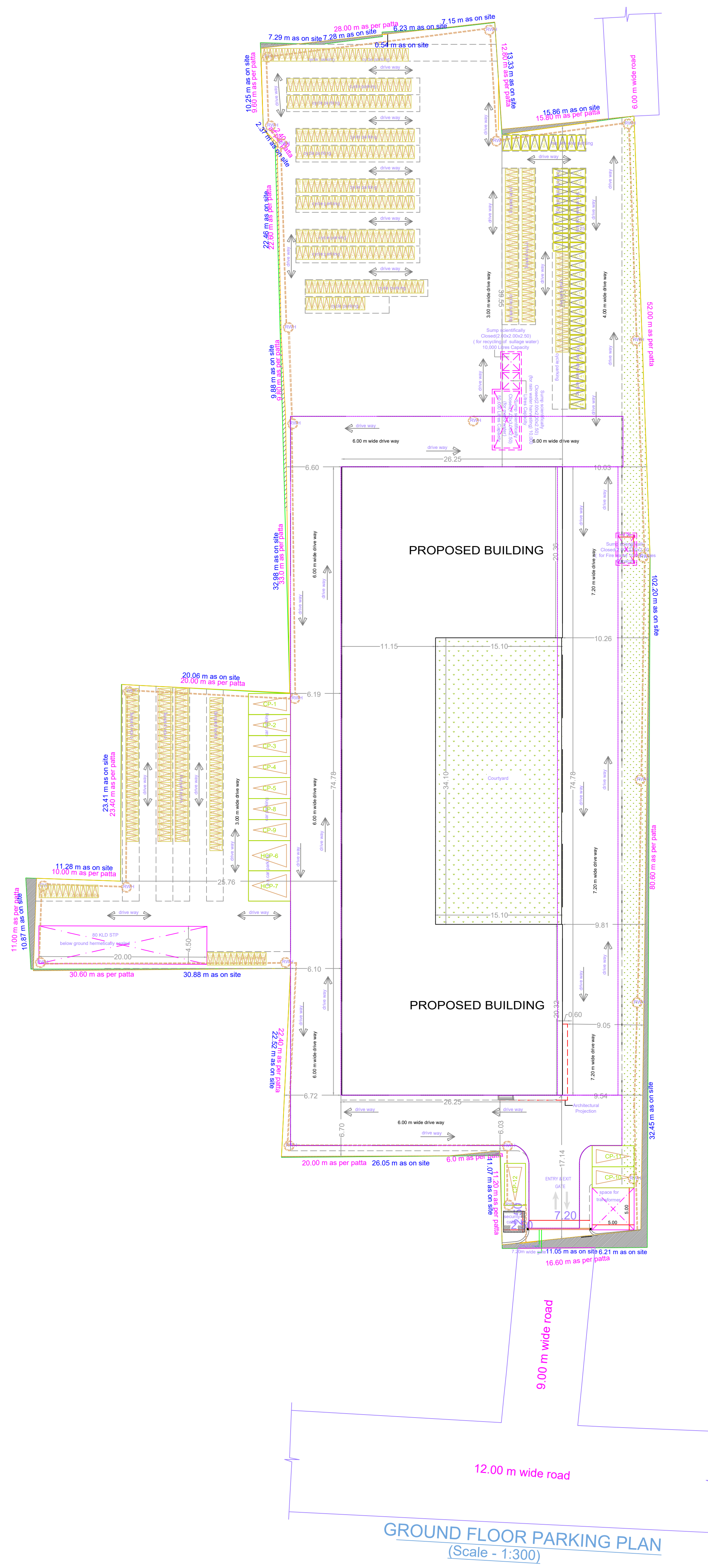
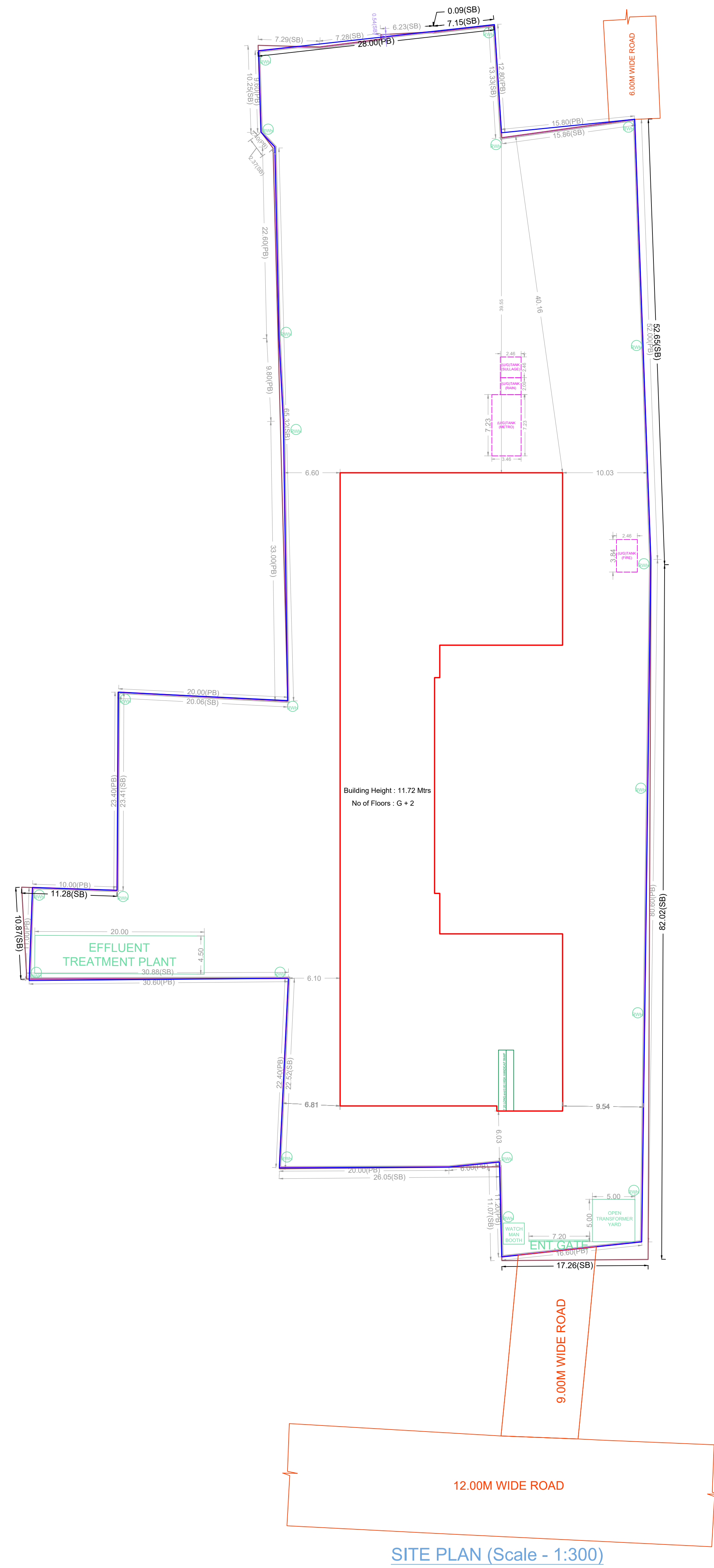

APPROVAL CONDITION

SCALE: 1:300

CHENNAI METROPOLITAN DEVELOPMENT AUTHORITY

APPROVED

SUBJECT TO THE CONDITIONS MENTIONED IN THIS OFFICE

(Signature)

For Deputy Planner / Chief Planner / Member (Secretary)
High Rise Building / Non High Rise Building
This Approval is valid only after Building Permit is issued by the concerned Local Body.

OR CODE

Sl. No.	Name	Designation	Signature	Date

PLAN SHOWING THE PROPOSED CONSTRUCTION OF GROUND FLOOR + 2 FLOORS (HEIGHT-11.72M) HIGHER SECONDARY SCHOOL BUILDING AT THIRUVANCHERI VILLAGE, TAMBARAM TALUK COMPRISED IN S.NO.71/7A1E & 45, 72/1A3, 1B1, 1B2, 1D2, 1E2, 1E3, 1E8, 1E9, 1E10, 1E11, 1E12, 1E13, 1F1, 1F2 OF THIRUVANCHERI VILLAGE WITHIN THE LIMIT OF ST. THOMAS MOUNT PANCHAYAT UNION.



SOUTH / FRONT ELEVATION

SECTION-"AA"

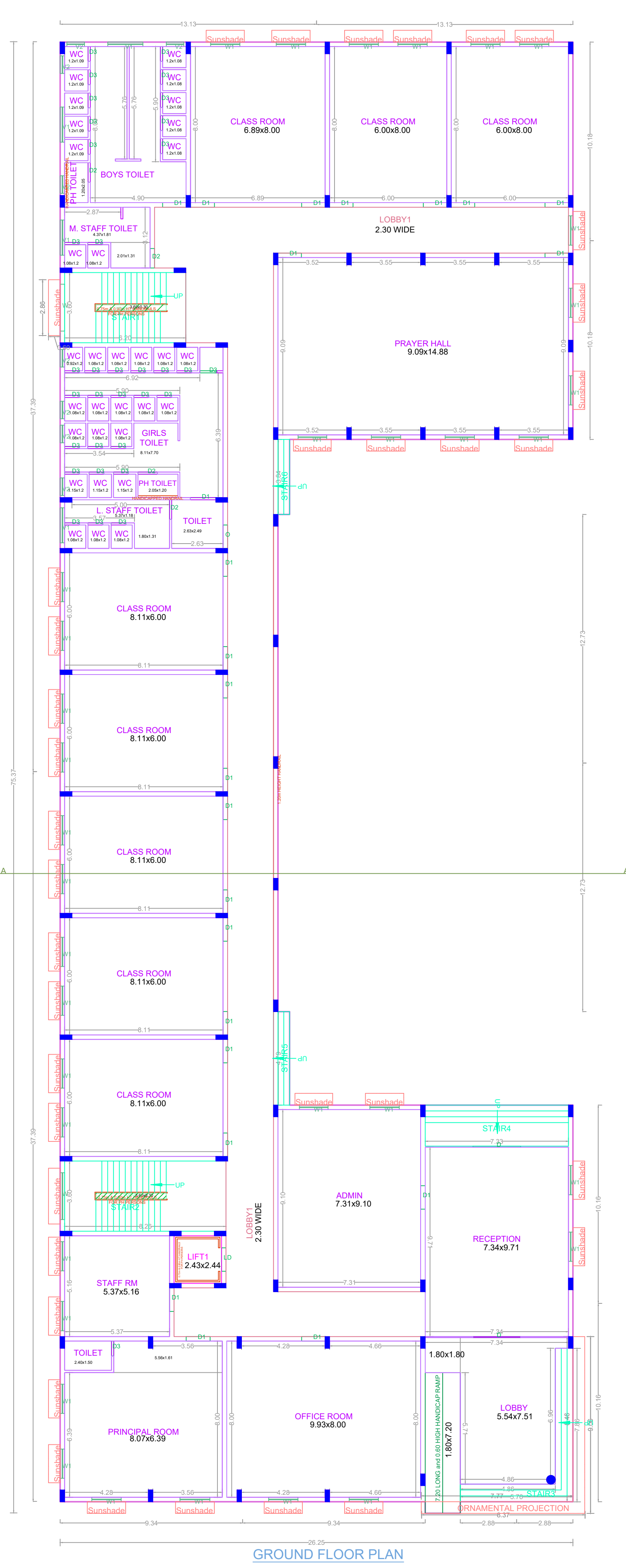

GROUND FLOOR PLAN

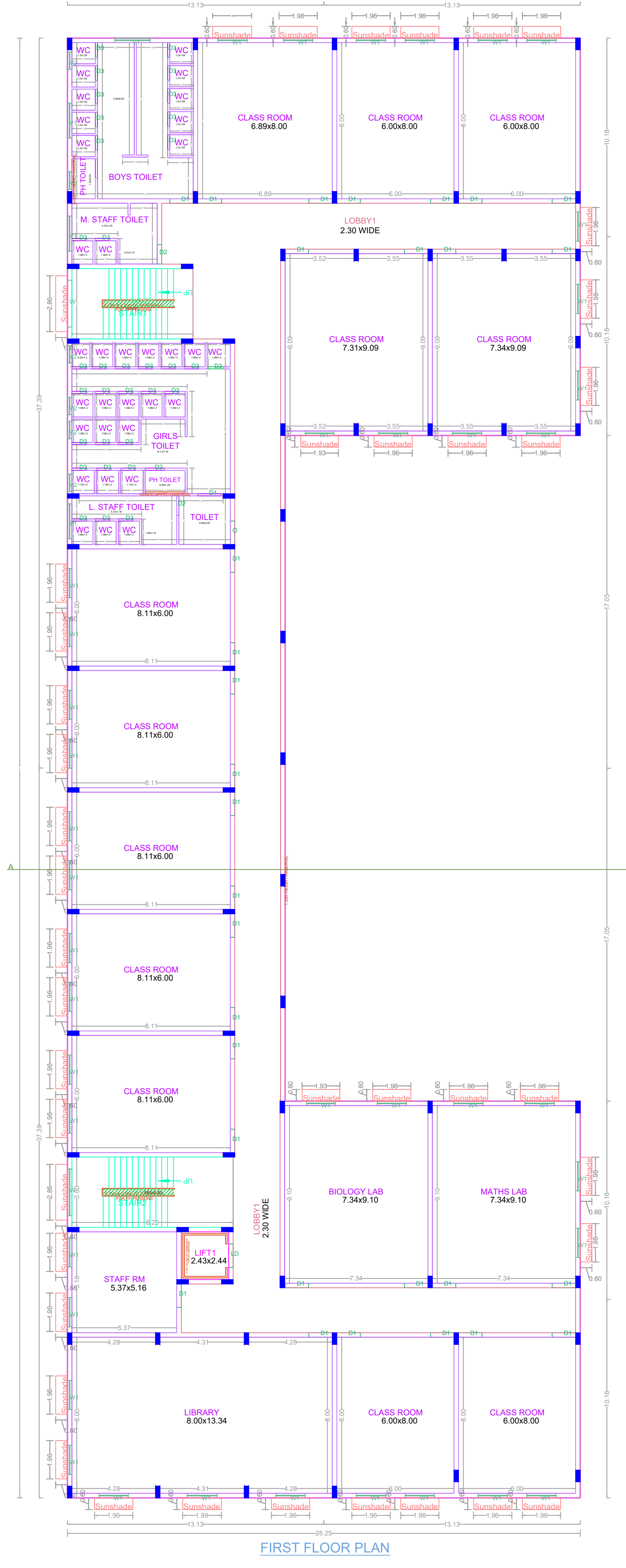

FIRST FLOOR PLAN

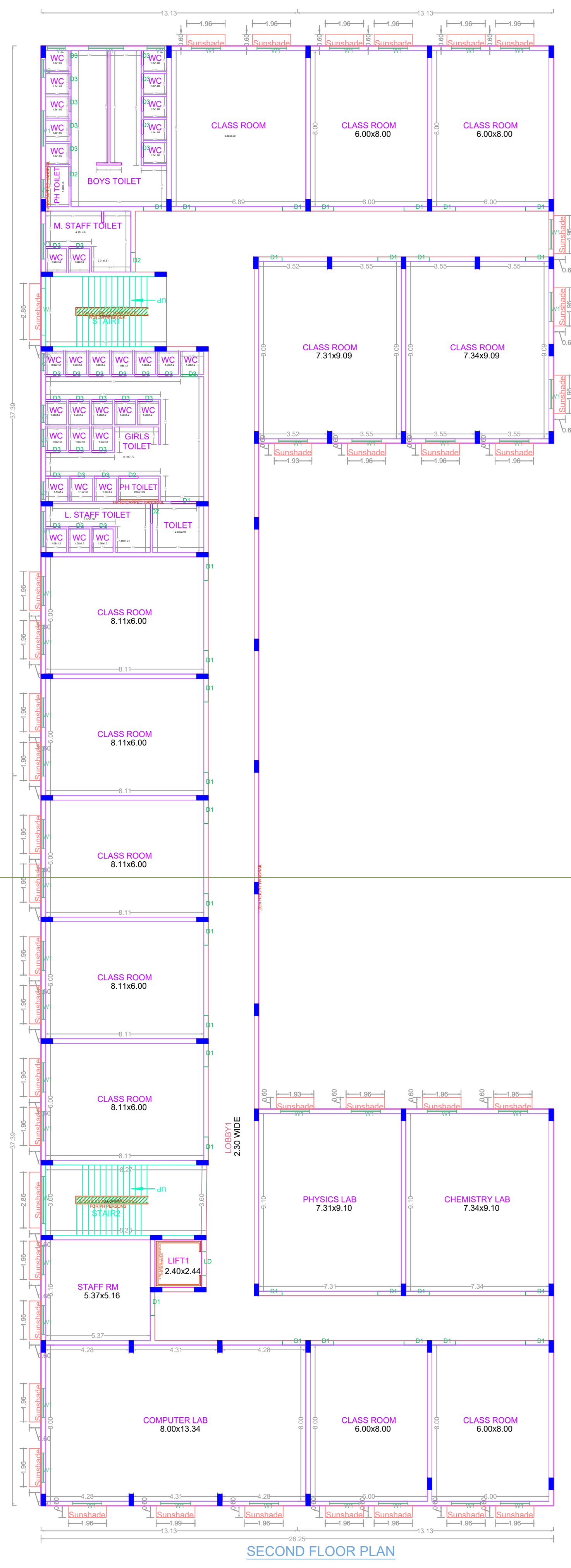

SECOND FLOOR PLAN

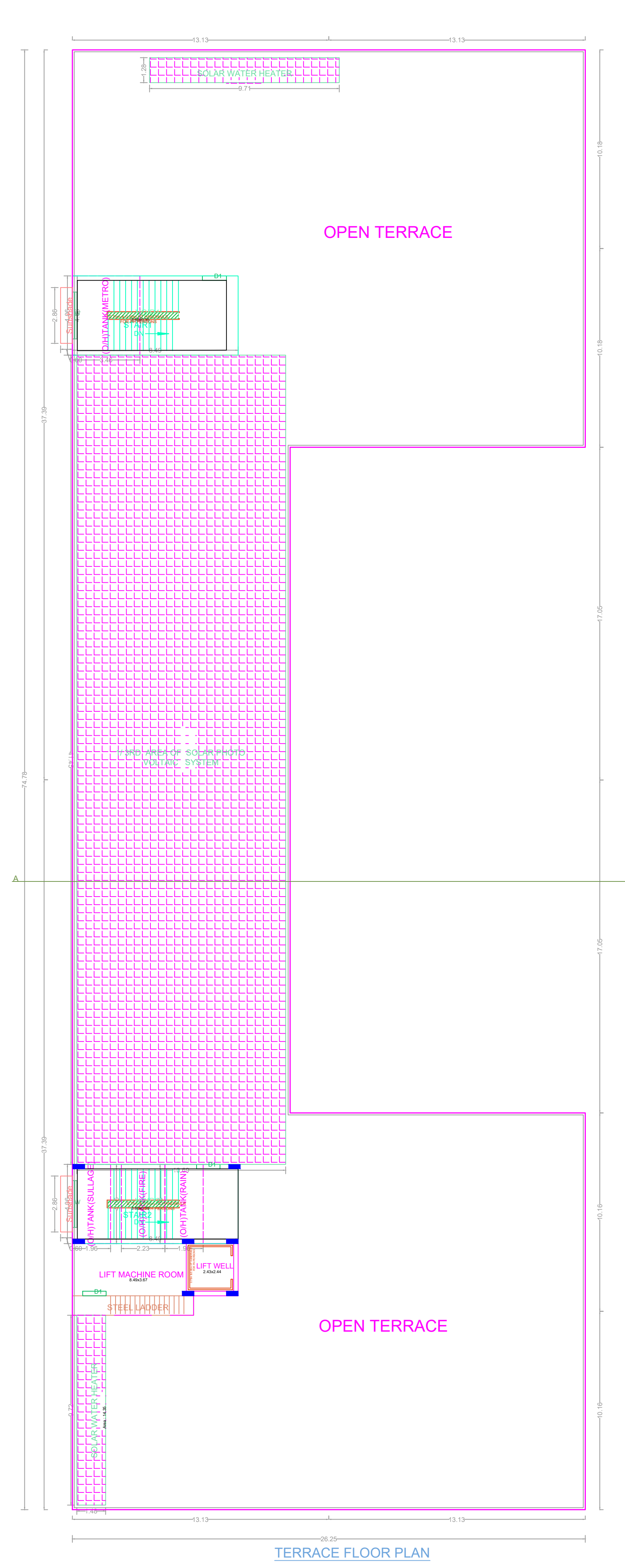

TERRACE FLOOR PLAN

APPROVAL CONDITION

SCALE 1:150



CHENNAI METROPOLITAN DEVELOPMENT AUTHORITY
APPROVED

SUBJECT TO THE CONDITIONS MENTIONED IN THIS OFFICE

This Planning Permission issued under New Rule 142(B)(ii) is valid to the extent of the RFP 602 to 606 of 2015 and 607P (AC) Nos. 6012 & 6013 of 2015.

For Clerk/Planner / Chief Planner / Member (Secretary)
High Rise Building / Non High Rise Building
This Approval is valid only after Building Permit is issued by the concerned Local Body.

QR CODE