

TOTAL EXTENT (AS PER PATTI) : 5450 SQ.M  
 ROAD AREA (29%) : 1605 SQ.M  
 PLOTTABLE AREA (71%) : 3845 SQ.M  
 OSR EXEMPTED UP TO : 3000 SQ.M  
 BALANCE AREA : 845 SQ.M  
 10% OSR CHARGES REQUIRED : 85 SQ.M  
 OSR CHARGES TO BE COLLECTED : 85 SQ.M  
 1% PUBLIC PURPOSE REQUIRED : 38 SQ.M  
 PUBLIC PURPOSE PROVIDED : 43 SQ.M

(PUBLIC PURPOSE AREA-1 : 24.0 SQ.M)  
 (PUBLIC PURPOSE AREA-2 : 19.0 SQ.M)

NO.OF.PLOTS : 41 Nos.

NOTE:

- SPLAY-1.5MX1.5M
- MEASUREMENTS ARE INDICATED EXCLUDING SPLAY DIMENSION
- |  |   |                         |
|--|---|-------------------------|
|  | ROAD AREA                                     | } TO REFER FINAL LETTER |
|  | PUBLIC PURPOSE AREA-1                         |                         |
|  | PUBLIC PURPOSE AREA-2 (RESERVED FOR TANGEDCO) |                         |

CONDITIONS :

(I) TNCDBR-2019,RULE NO: 47 (8) IN G.O(Ms) No.18,MAWS DEPARTMENT DATED:04.02.2019 & & AMENDMENTS APPROVED IN G.O.Ms.No.16,(MA1)DEPARTMENT DATED:31.1.2020 AND PUBLISHED IN TNGG ISSUE NO.41, DATED:31.1.2020

ONE PERCENT OF LAYOUT AREA EXCLUDING ROAD,ADDITIONALLY,SHALL BE RESERVED FOR"PUBLIC PURPOSE" WITHIN THE ABOVE CEILING 0.5%OF AREA SHALL BE TRANSFERRED TO THE LOCAL BODY AND 0.5% OF AREA SHALL BE TRANSFERRED TO THE TANGEDCO OR TO THE LOCAL BODY FREE OF COST THROUGH A REGISTERED GIFT DEED BEFORE THE ACTUAL SANCTION OF THE LAYOUT .

(II) TNCDBR-2019, RULE NO: 47 (11)

THE COST OF LAYING IMPROVEMENTS TO THE SYSTEMS IN RESPECT OF ROAD, WATER SUPPLY, SEWERAGE, DRAINAGE OR ELECTRIC POWER SUPPLY THAT MAY BE REQUIRED AS ASSESSED BY THE CONCERNED AUTHORITY, NAMELY, THE LOCAL BODY AND TAMIL NADU ELECTRICITY BOARD, SHALL BE BORNE BY THE APPLICANT.

(III) THE APPLICANT IS RESPONSIBLE FOR THE SHAPE,SIZE & DIMENSIONS OF THE SITE UNDER REFERENCE.

© NECESSARY SPACE FOR BUILDING LINE TO BE LEFT AS PER THE RULE IN FORCE WHILE TAKING UP DEVELOPMENT IN EVERY PLOT

LEGEND :

- SITE BOUNDARY
- PROPOSED ROAD
- EXISTING ROAD
- PUBLIC PURPOSE-1
- PUBLIC PURPOSE-2

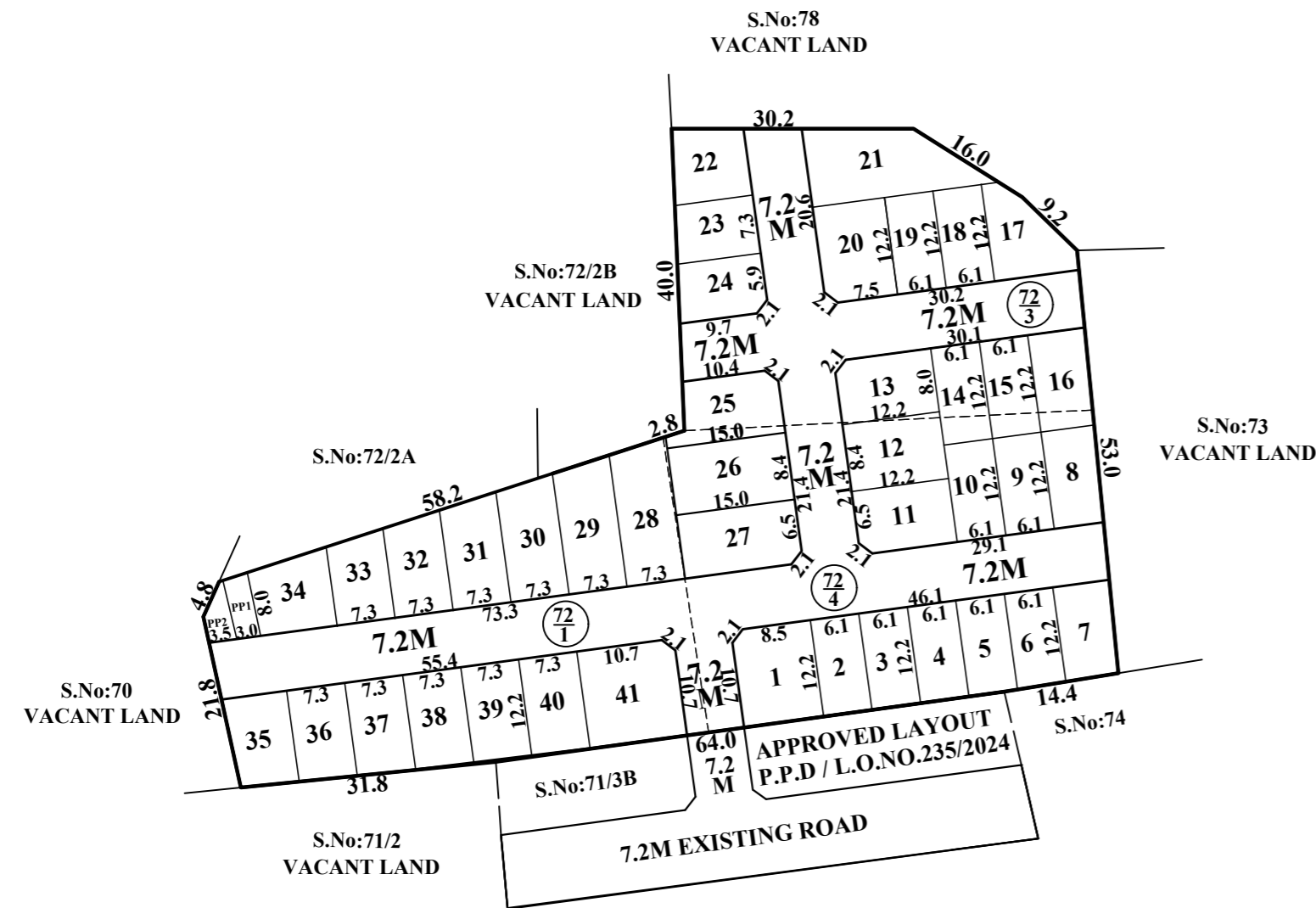

# PUZHAL PANCHAYAT UNION

## LAYOUT OF HOUSE SITES IN S.Nos: 72/1,3 & 72/4 OF SIRUGAVOOR VILLAGE.

SCALE-1:800 (ALL MEASUREMENTS ARE IN METRE)

APPROVAL CONDITION  
 THE LAYOUT/SUB-DIVISION APPROVAL IS VALID  
 SUBJECT TO OBTAINING SANCTION FROM THE  
 LOCAL BODY CONCERNED

SCALE 1:800



CHENNAI METROPOLITAN DEVELOPMENT AUTHORITY

APPROVED

SUBJECT TO THE CONDITIONS MENTIONED IN THIS OFFICE

This Planning Permission issued under  
 New Rule TNCDBR, 2019 is subject  
 to final outcome of the W.P.  
 (MD) No.8948 of 2019 and WMP (MD)  
 Nos. 6912 & 6913 of 2019.

For (Deputy Planner / Chief Planner / Member-Secretary)  
 Layout Division.

QR  
 CODE