

FRONT ELEVATION

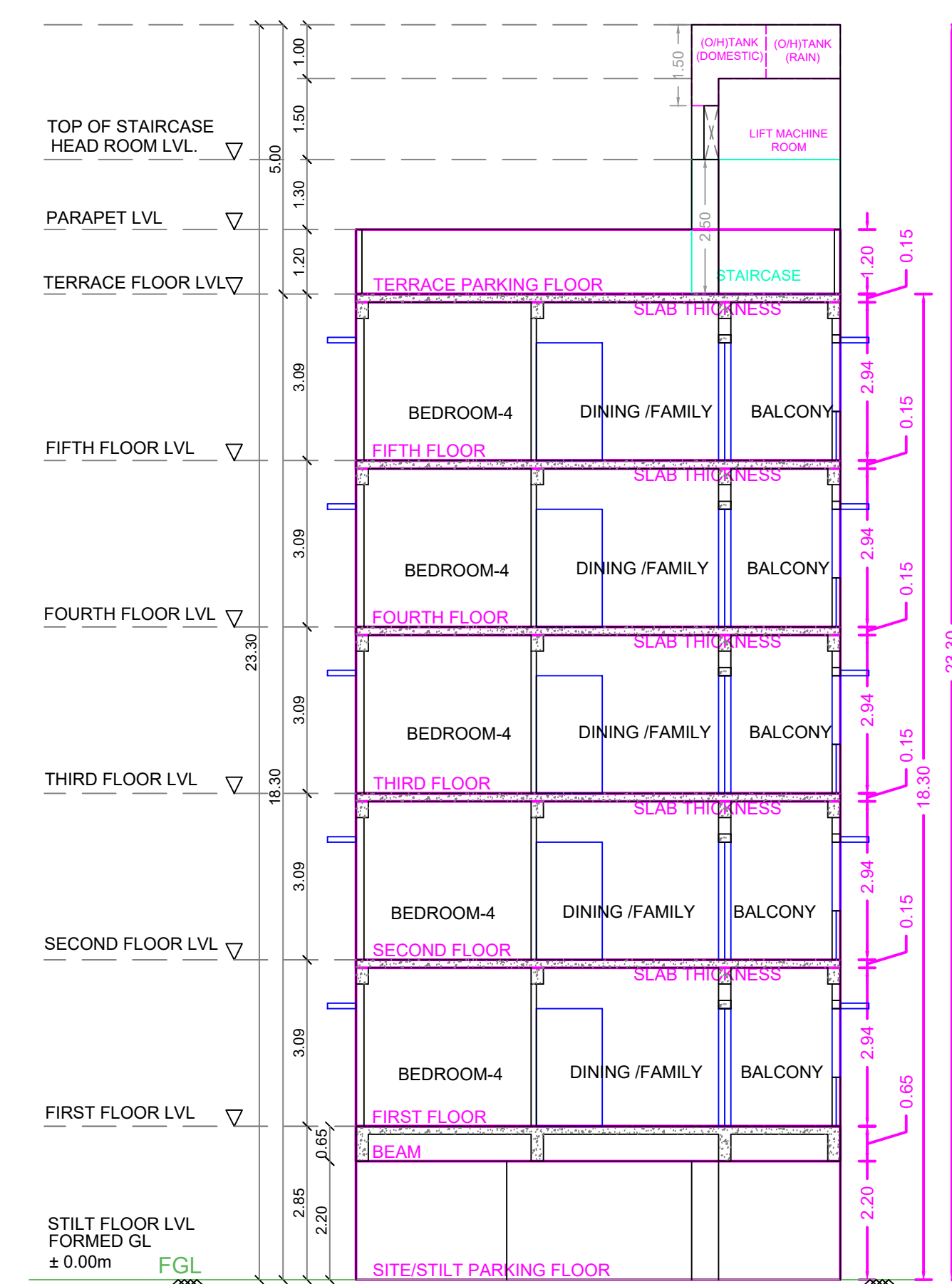

SECTION-AA

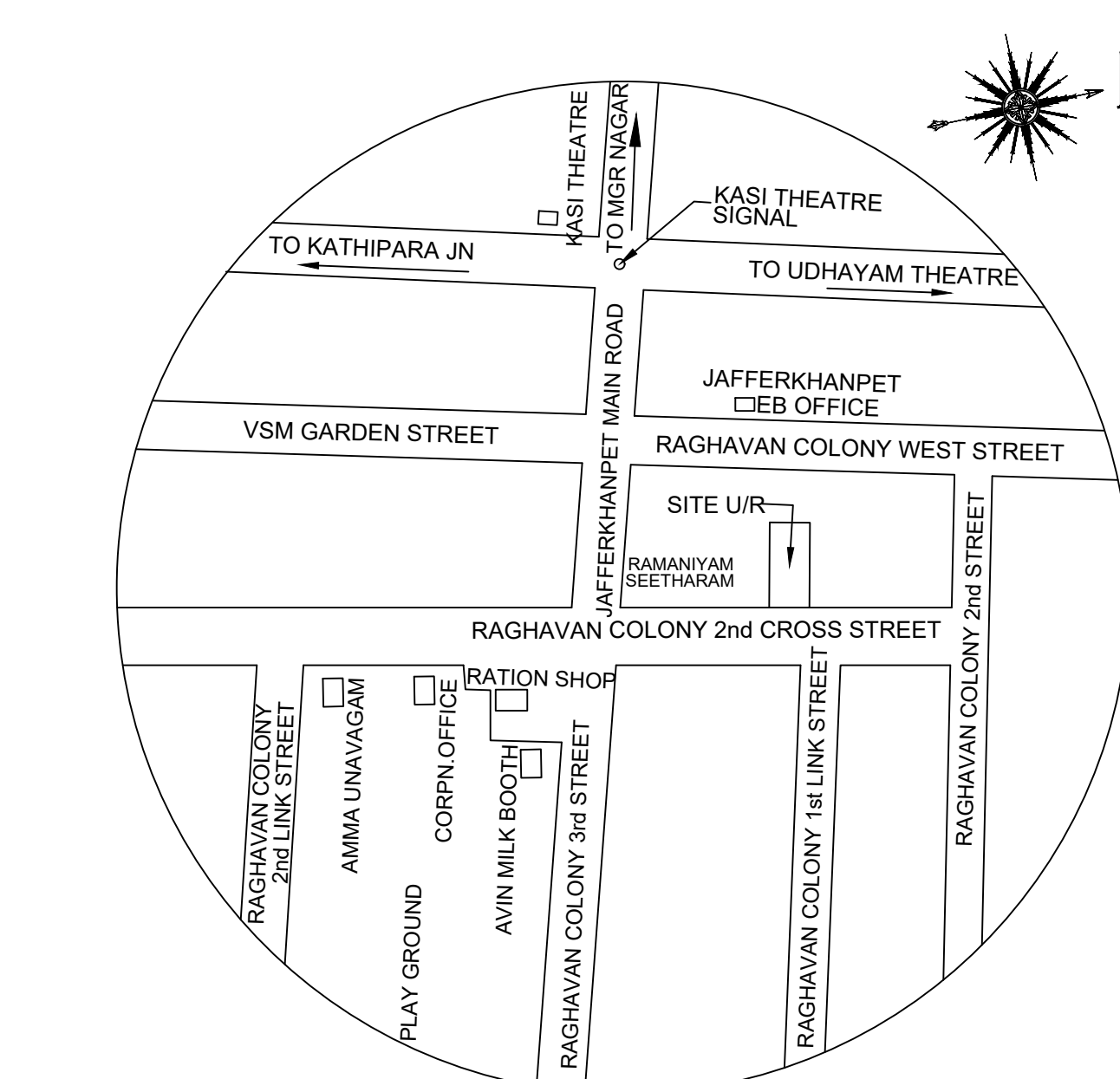
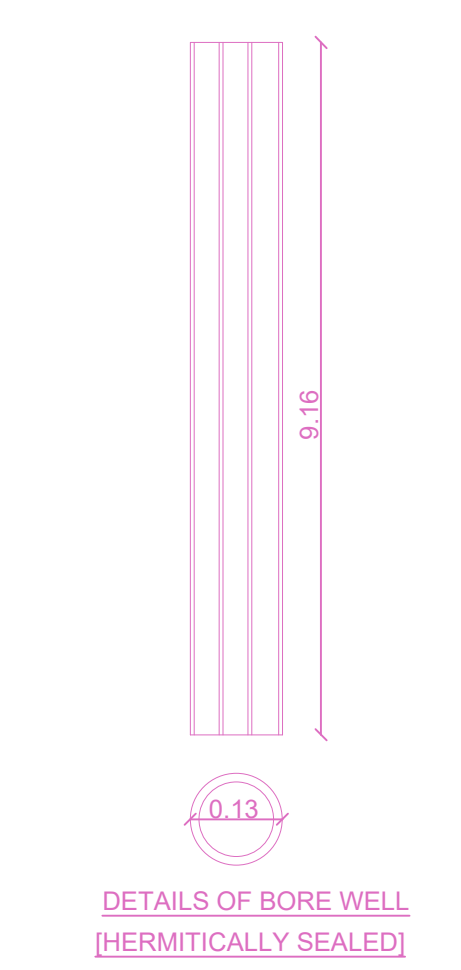
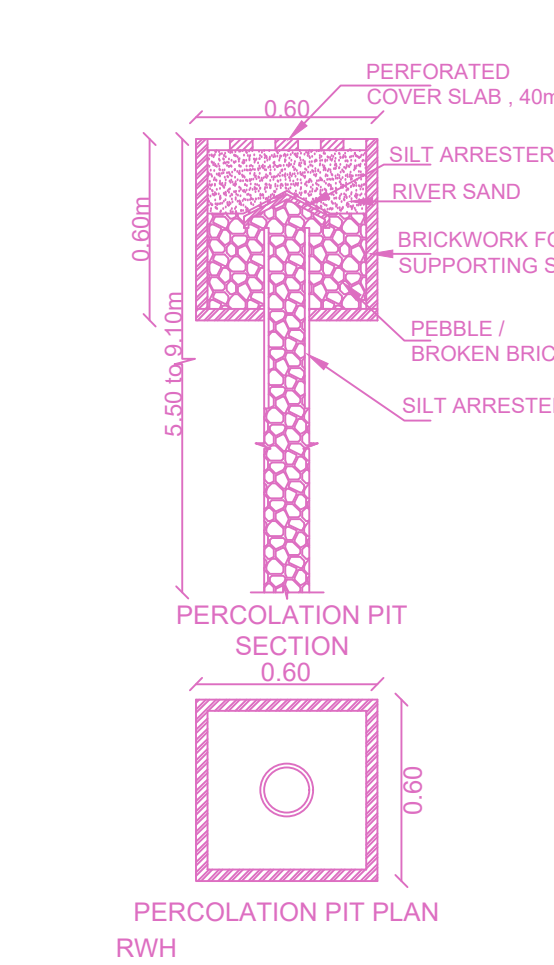
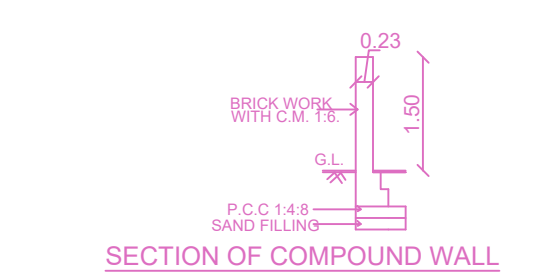
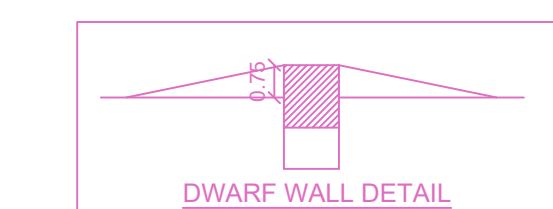
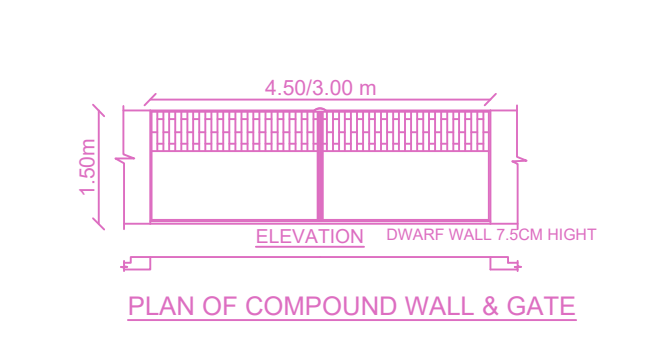
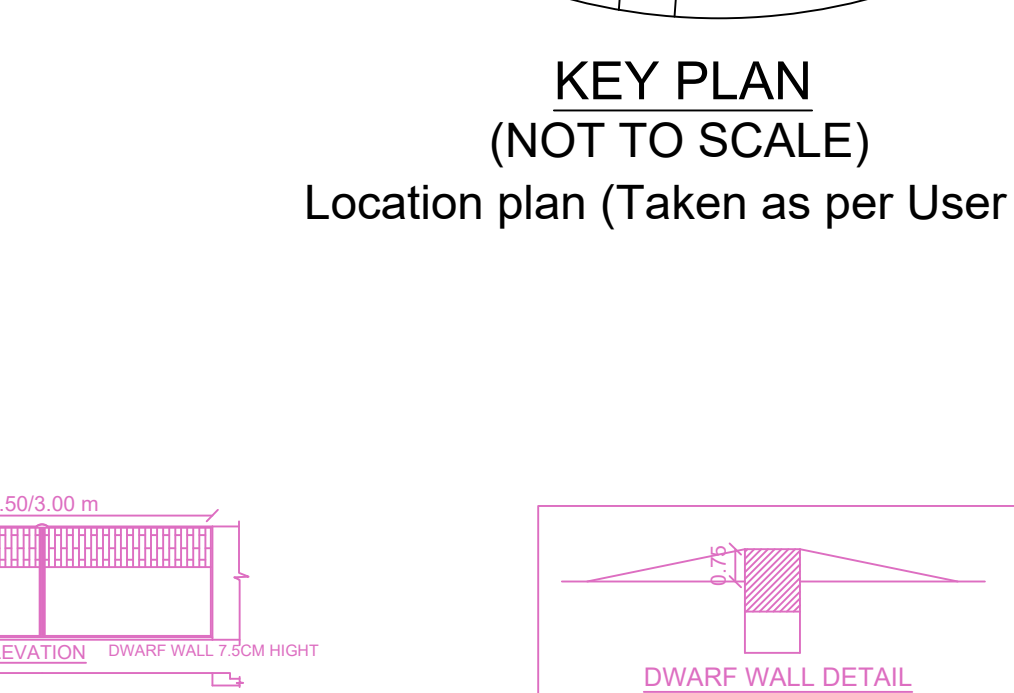
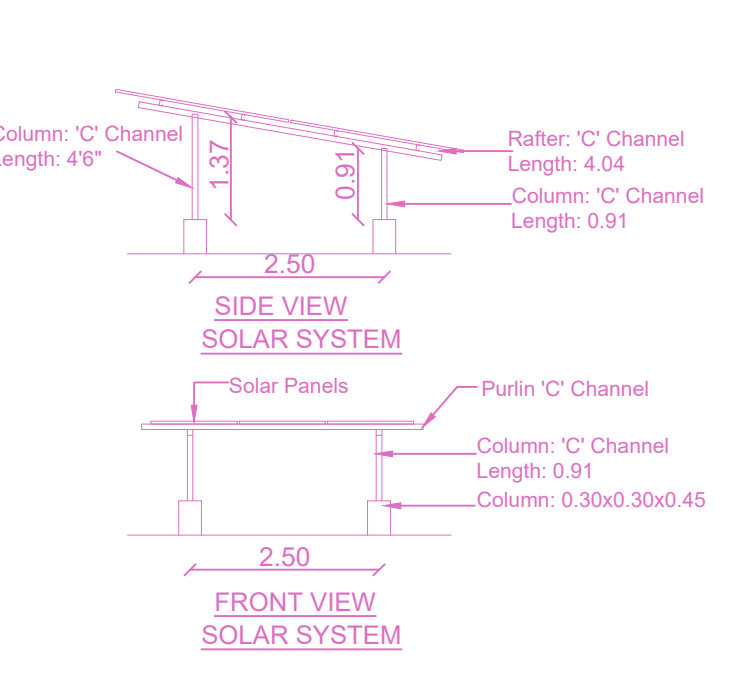
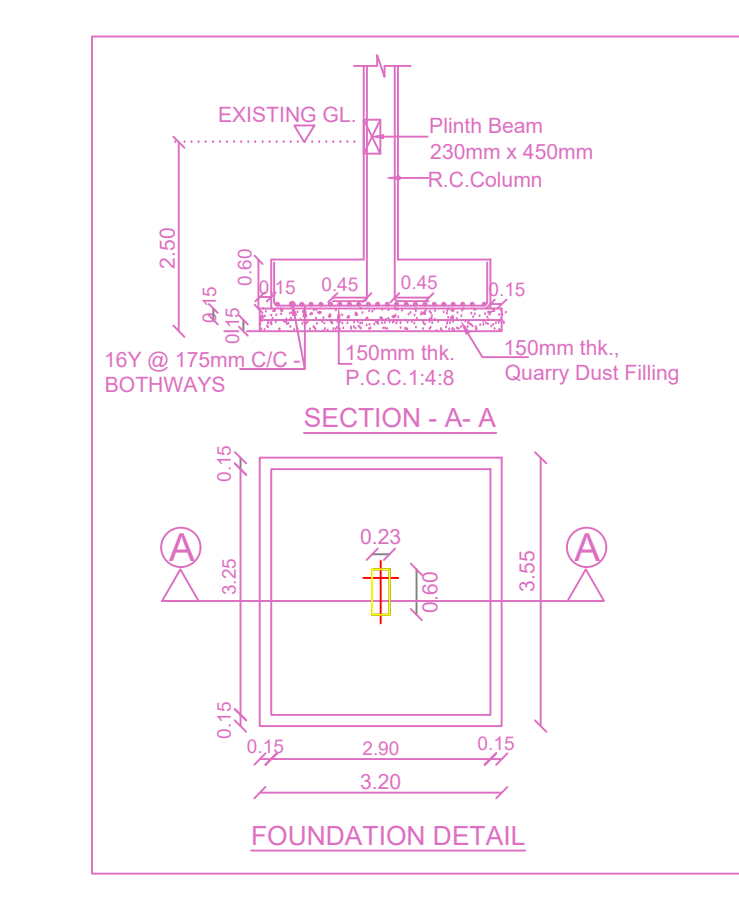
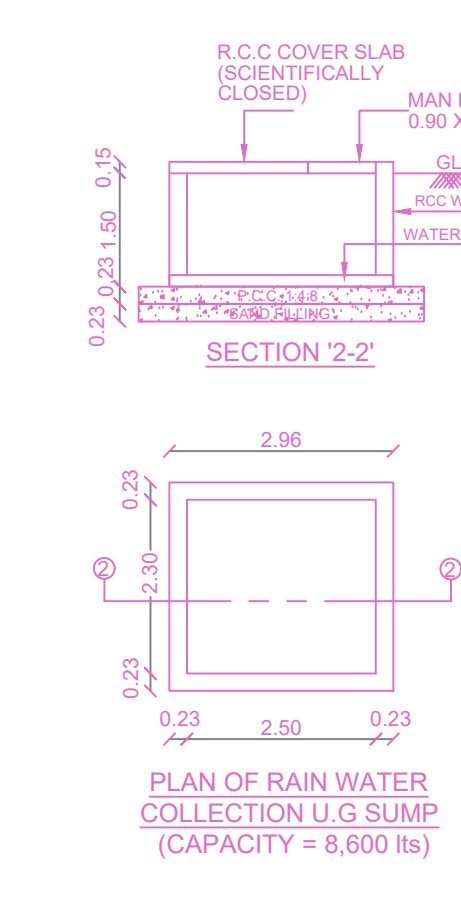
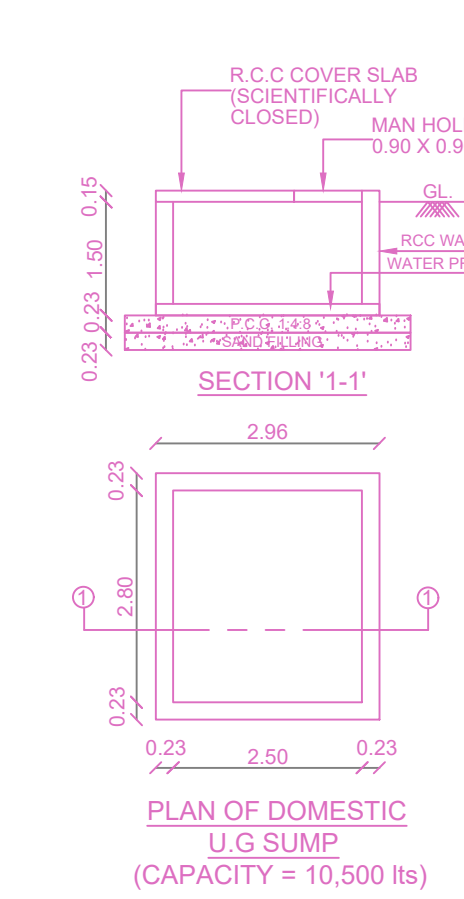
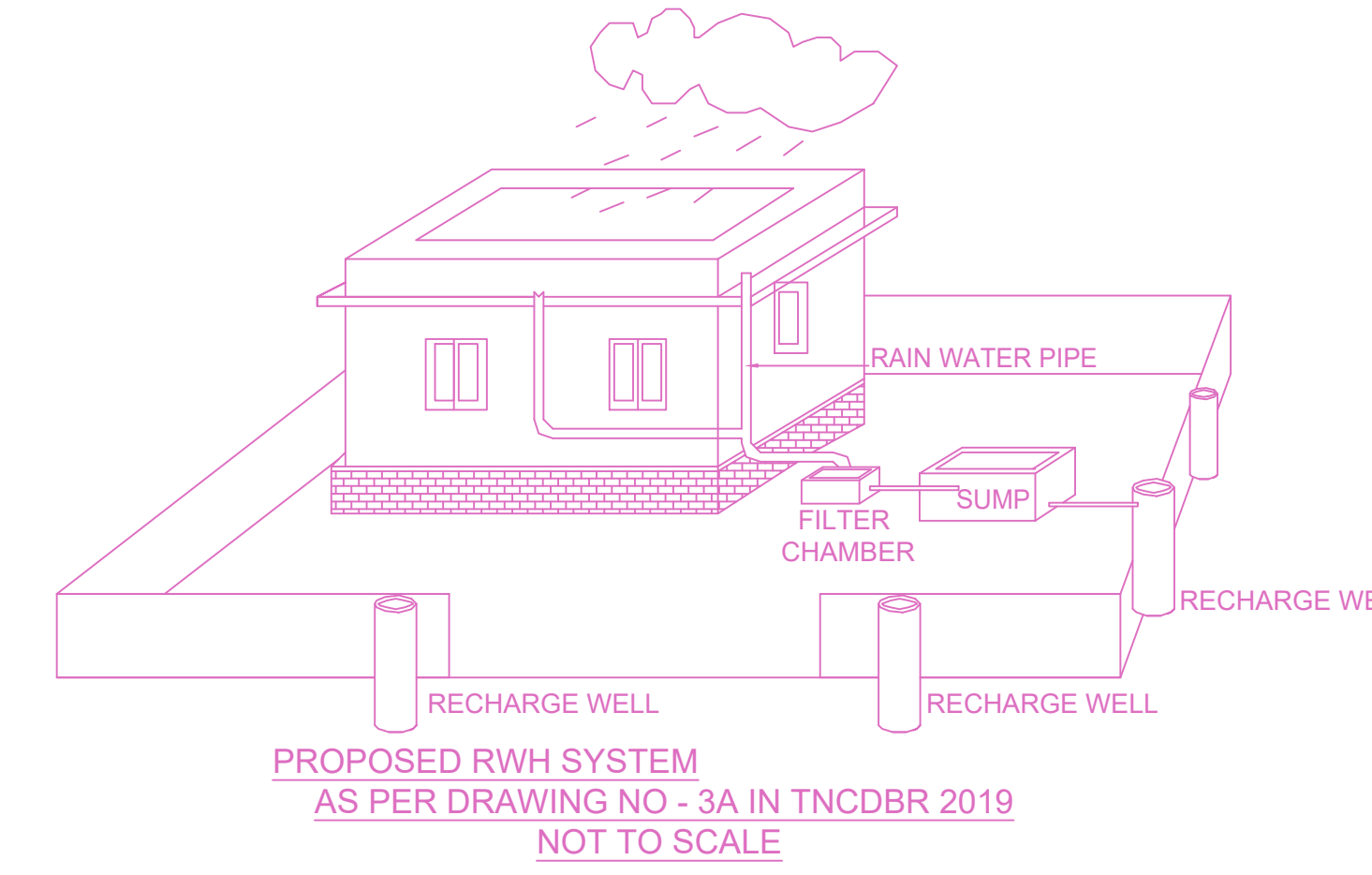

KEY PLAN (NOT TO SCALE) Location plan (Taken as per User Inputs)

PLAN SHOWING THE PROPOSED CONSTRUCTION OF STILT FLOOR + 5 FLOORS (HEIGHT-18.30 m) RESIDENTIAL BUILDING WITH 5 DWELLING UNITS AVAILING PREMIUM FSI AT PLOT NO. 39, NEW DOOR NO.12, OLD DOOR NO.19, RAGHAVAN COLONY SECOND CROSS STREET, ASHOK NAGAR, CHENNAI - 600 083, COMPRISED IN S.NO.231 AS PER DOCUMENT AND T.S.NO.43 AS PER PATTI, BLOCK NO.86 OF KODAMBAKKAM (PART 2) VILLAGE, MAMBALAM TALUK, WITHIN THE LIMIT OF GREATER CHENNAI CORPORATION, ZONE - X, DIVISION - 139.

A) AREA STATEMENT	SQ.M.
AREA AS PER PATTI	395.00
AREA AS PER DOCUMENT	394.93
AREA CONSIDERED FOR FSI	394.93
STREET ALIGNMENT/ ROAD WIDENING/LINK ROAD	0.00
OSR AREA	0.00
TOTAL FSI AREA	863.85
FSI FACTOR	2.183
COVERAGE AREA (PERCENTAGE %)	NA

A) PARKING STATEMENT	REQUIRED	PROVIDED
VEHICLE		
LORRY	-	0
CAR	10	11
TWO WHEELER	0	0
CYCLE	-	9

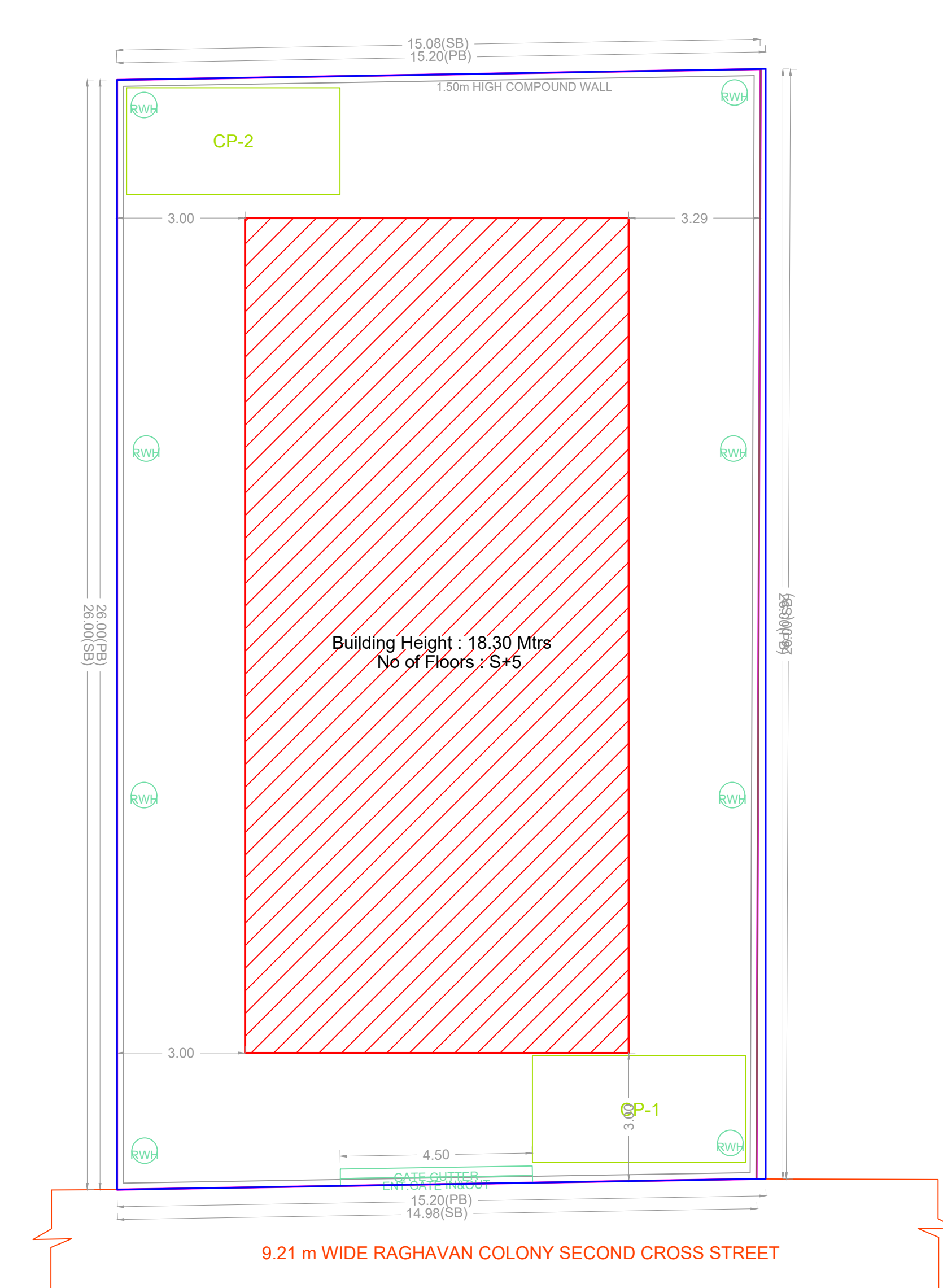

SITE PLAN

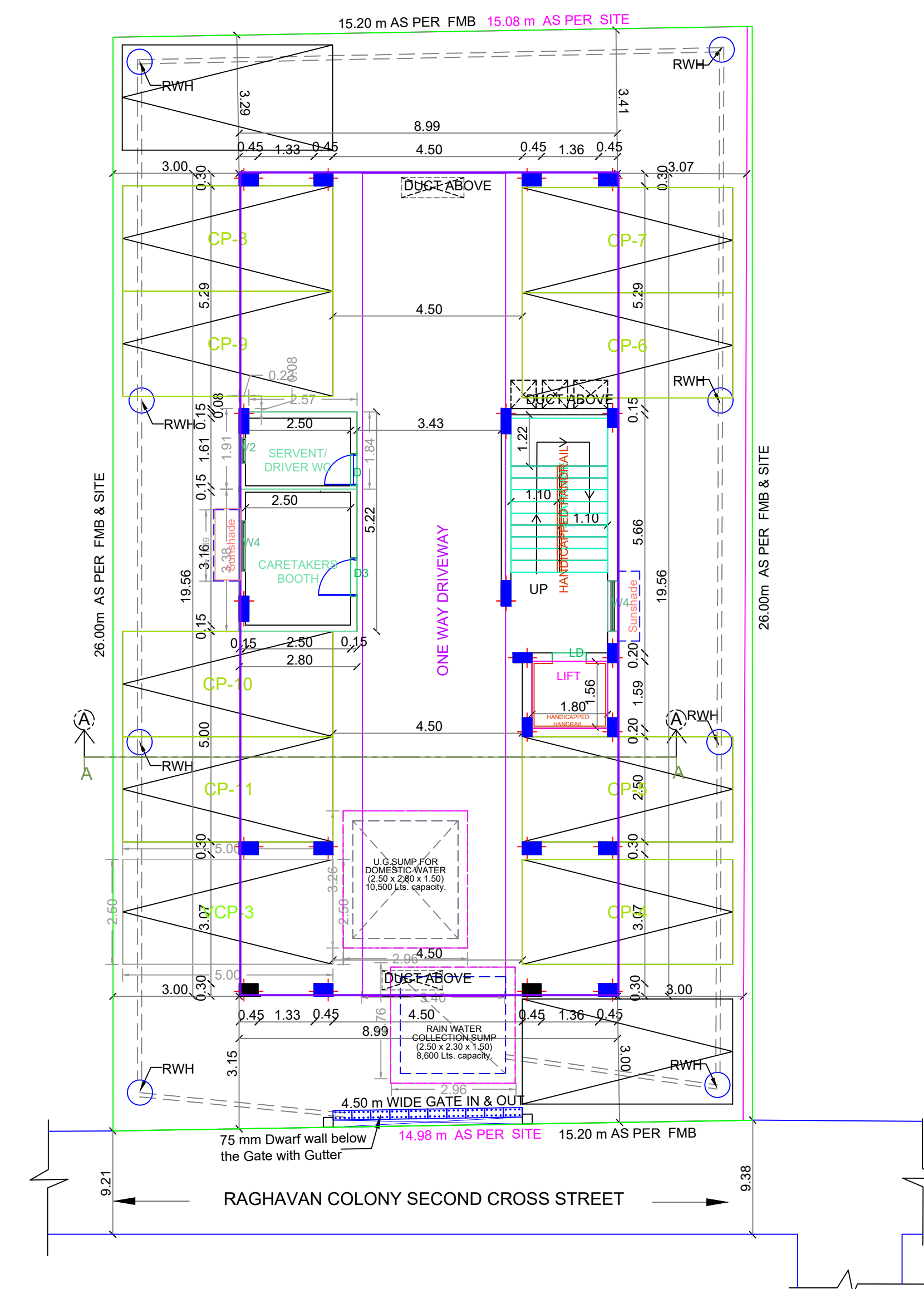

SITE CUM STILT FLOOR PLAN

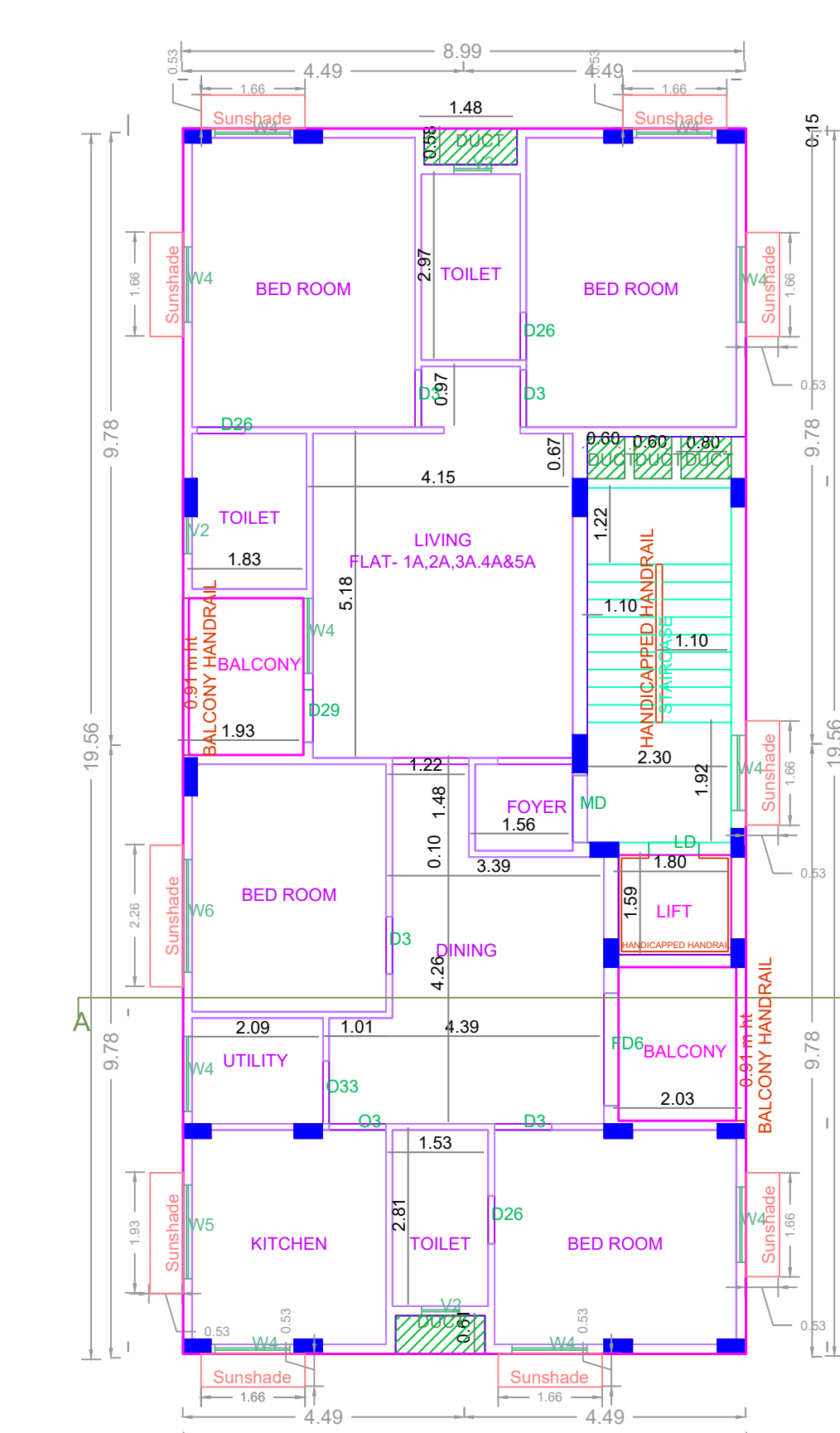

TYPICAL - 1, 2, 3, 4 & 5 FLOOR PLAN

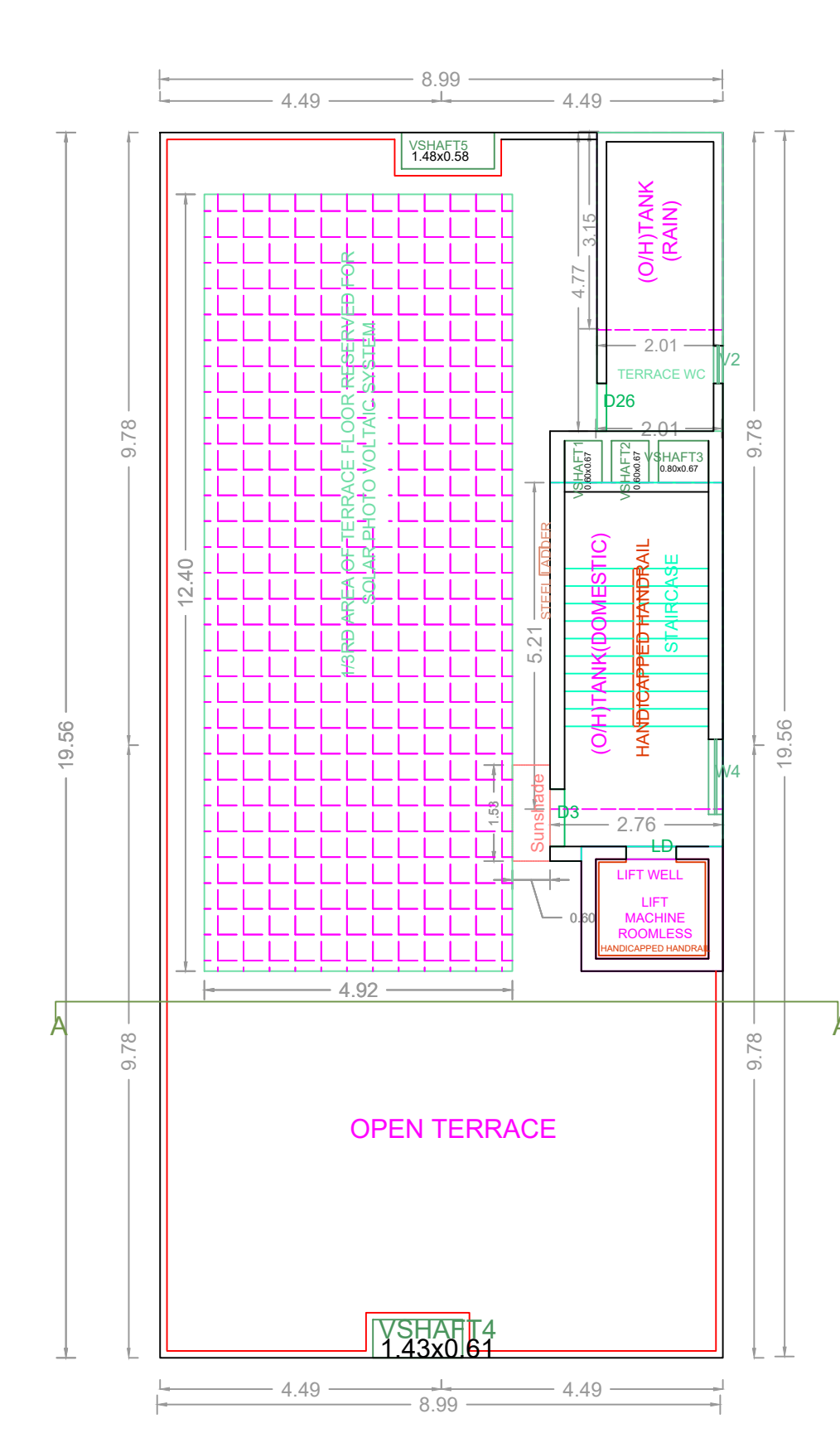

TERRACE FLOOR PLAN

**BUILDING WISE FSI STATEMENT**

BUILDING	NO OF SAME BUILDING	COMM.	RESI.	IND.	INST.	DU	TOTAL FSI AREA
NHRB-1 (RAG.)	0.00	863.85	0.00	0.00	0.00	05	863.85
Total	0.00	863.85	0.00	0.00	0.00	05	863.85

**FLOOR WISE FSI STATEMENT: NHRB (RAGHAVAN COL)**

FLOORS	FSI AREA				DU	TOTAL FSI AREA
	COMM.	RESI.	IND.	INST.		
SITE/STILT PARKING FLOOR	0.00	0.00	0.00	0.00	0	0.00
FIRST FLOOR	0.00	172.77	0.00	0.00	01	172.77
SECOND FLOOR	0.00	172.77	0.00	0.00	01	172.77
THIRD FLOOR	0.00	172.77	0.00	0.00	01	172.77
FOURTH FLOOR	0.00	172.77	0.00	0.00	01	172.77
FIFTH FLOOR	0.00	172.77	0.00	0.00	01	172.77
Terrace	0.00	0	0.00	0.00	0	0
Total	0.00	863.85	0.00	0.00	05	863.85

APPROVAL CONDITION

SCALE 1:100

CHENNAI METROPOLITAN DEVELOPMENT AUTHORITY

APPROVED

SUBJECT TO THE CONDITIONS MENTIONED IN THIS OFFICE

For (Chief Planner / Chief Planner / Member Secretary)  
High Rise Building / Non High Rise Building  
This Approval is valid only after Building Permit is issued by the concerned Local Body.

OR CODE