

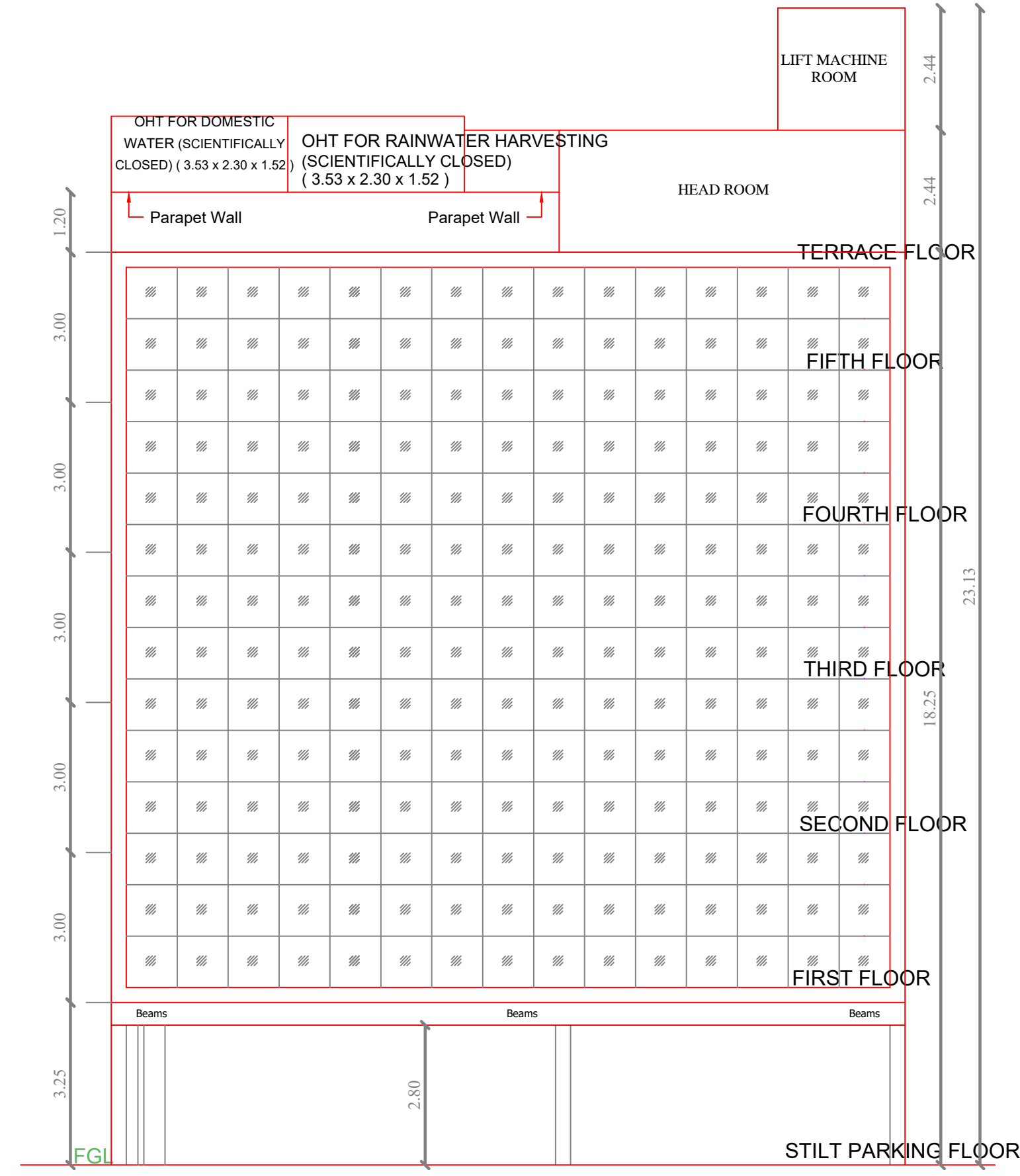

SITE PLAN

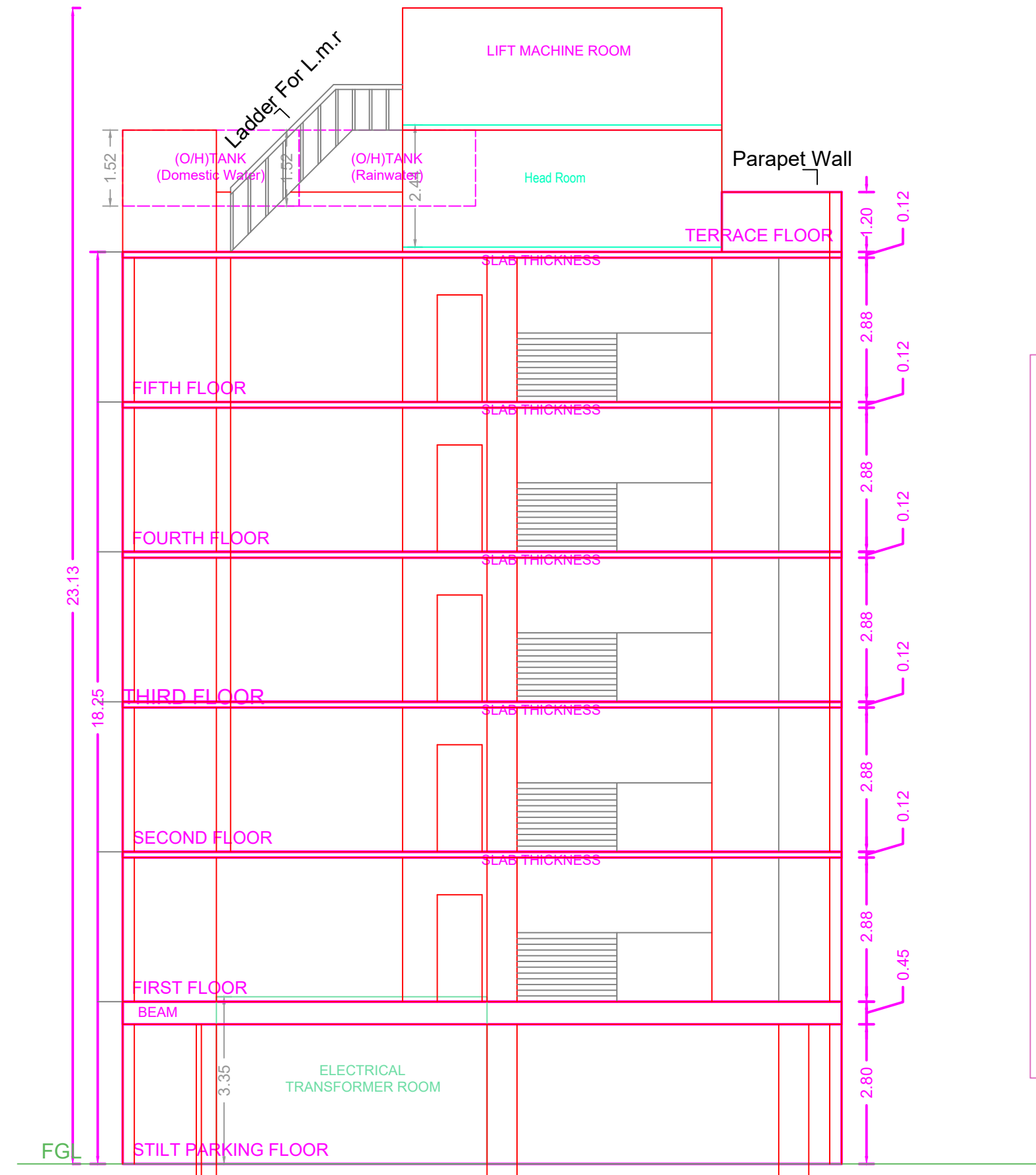

ELEVATION



SECTION AT AA

BUILDING WISE FSI STATEMENT							
BUILDING	NO OF SAME BUILDING	FSI AREA				DU	TOTAL FSI AREA
		COMM.	RESI.	IND.	INST.		
A-1 (WWW)		1110.50	0.00	0.00	0.00	0	1110.50
Total		1110.50	0.00	0.00	0.00	0	1110.50

FLOOR WISE FSI STATEMENT: A (WWW)						
FLOORS	FSI AREA				DU	TOTAL FSI AREA
	COMM.	RESI.	IND.	INST.		
STILT PARKING FLOOR	29.24	29.24	0.00	0.00	0	29.24
FIRST FLOOR	222.10	0.00	0.00	0.00	0	222.10
SECOND FLOOR	222.10	0.00	0.00	0.00	0	222.10
THIRD FLOOR	222.10	0.00	0.00	0.00	0	222.10
FOURTH FLOOR	222.10	0.00	0.00	0.00	0	222.10
FIFTH FLOOR	222.10	0.00	0.00	0.00	0	222.10
Terrace	0.00	0.00	0.00	0.00	0	0.00
Total	1139.74	29.24	0.00	0.00	0	1139.74

PLAN SHOWING THE PROPOSED CONSTRUCTION OF STILT + 5 FLOORS COMMERCIAL BUILDING (HEIGHT 18.25M) AT DOOR NO :126 SERVICE ROAD - POONAMALEE HIGH ROAD KOYEBEDU, CHENNAI COMPRISED IN OLD. S.NO: 132 / 4A1, OLD T.S.NO: 5 AND NEW T.S.NO. 5/1, BLOCK NO. 42 OF KOYEBEDU VILLAGE, AMINIKARAI TALUK CORPORATION.

A) AREA STATEMENT SQ.M.
 AREA AS PER PATTI 526.00
 AREA AS PER DOCUMENT 526.83
 AREA CONSIDERED FOR FSI 526.83
 STREET ALIGNMENT/ ROAD WIDENING/LINK ROAD 0.00
 OSR AREA 0.00
 TOTAL FSI AREA 1139.74
 FSI FACTOR 2.108
 COVERAGE AREA (PERCENTAGE %) NA

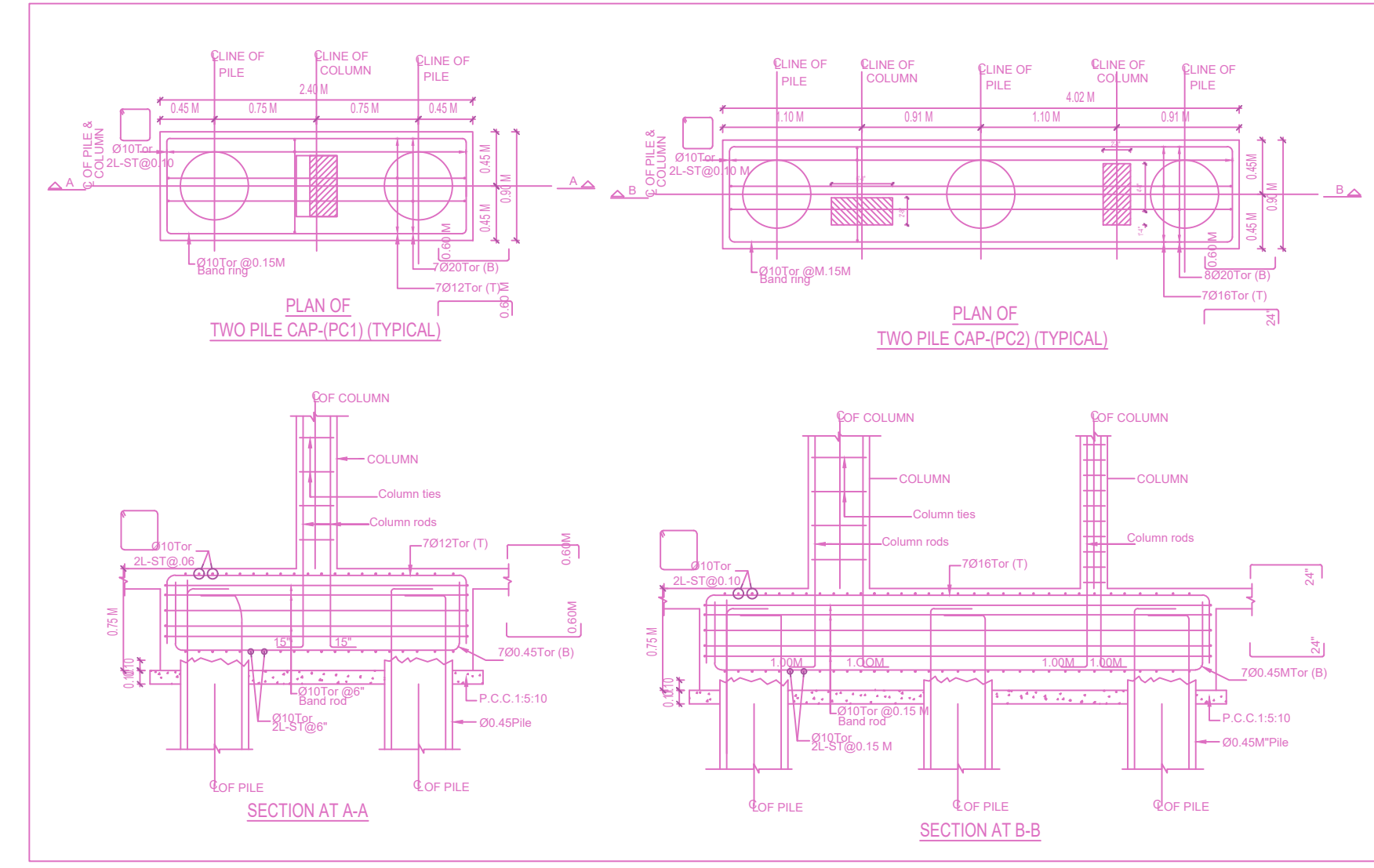

A) PARKING STATEMENT		
VEHICLE	REQUIRED	PROVIDED
LORRY	-	0
CAR	10	10
TWO WHEELER	38	41
CYCLE	-	9

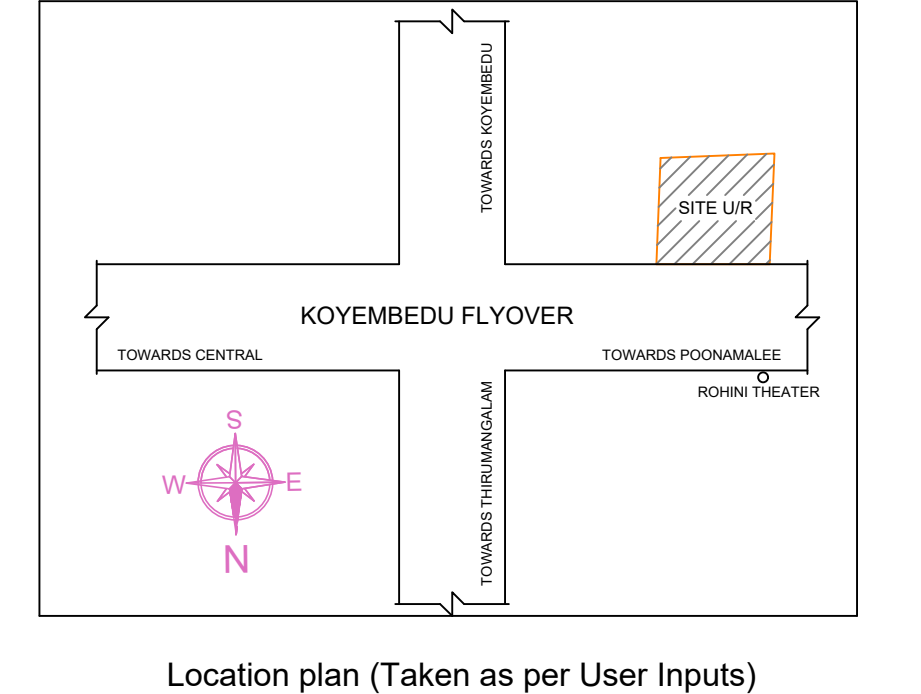

Location plan (Taken as per User Inputs)

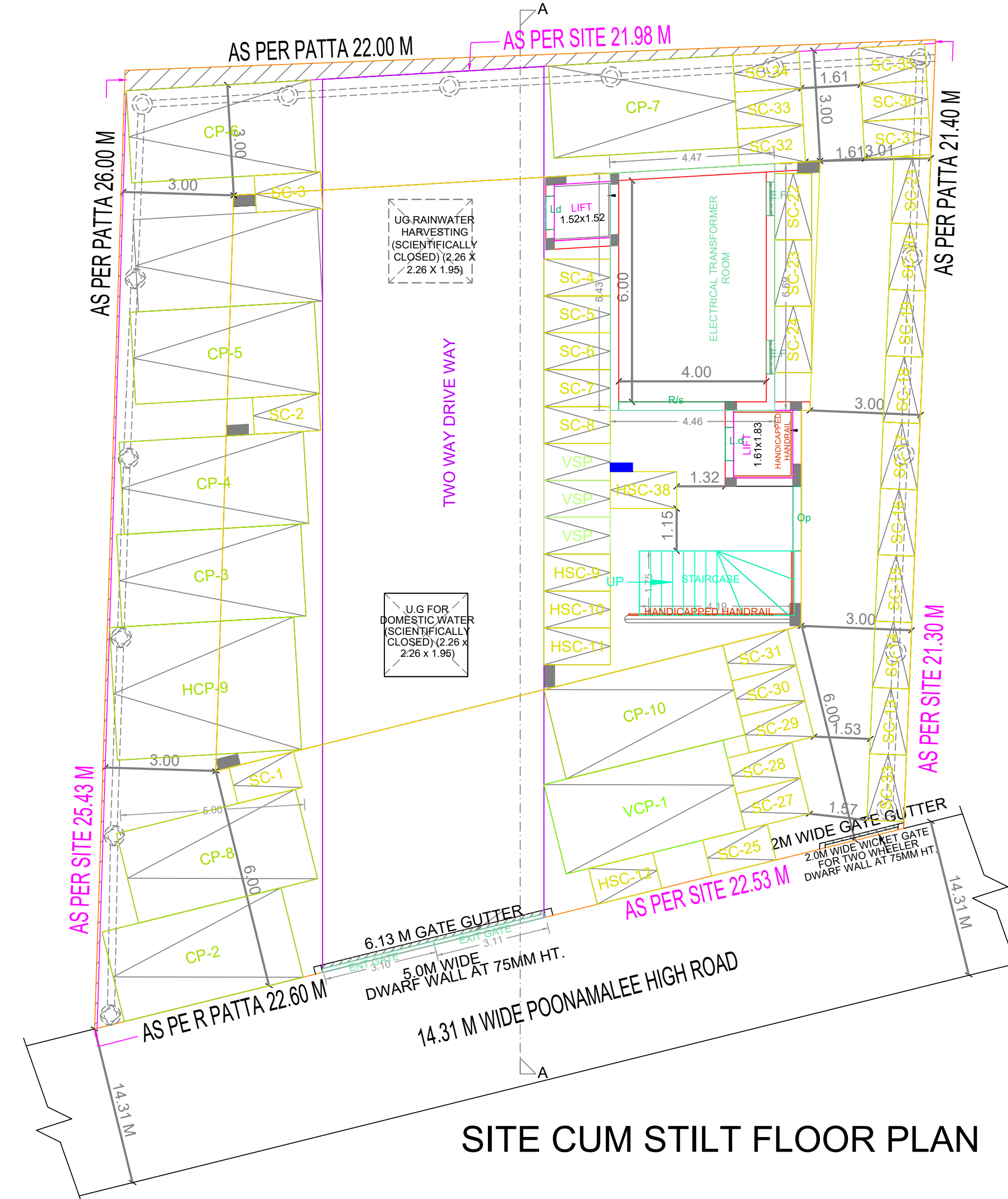

SITE CUM STILT FLOOR PLAN

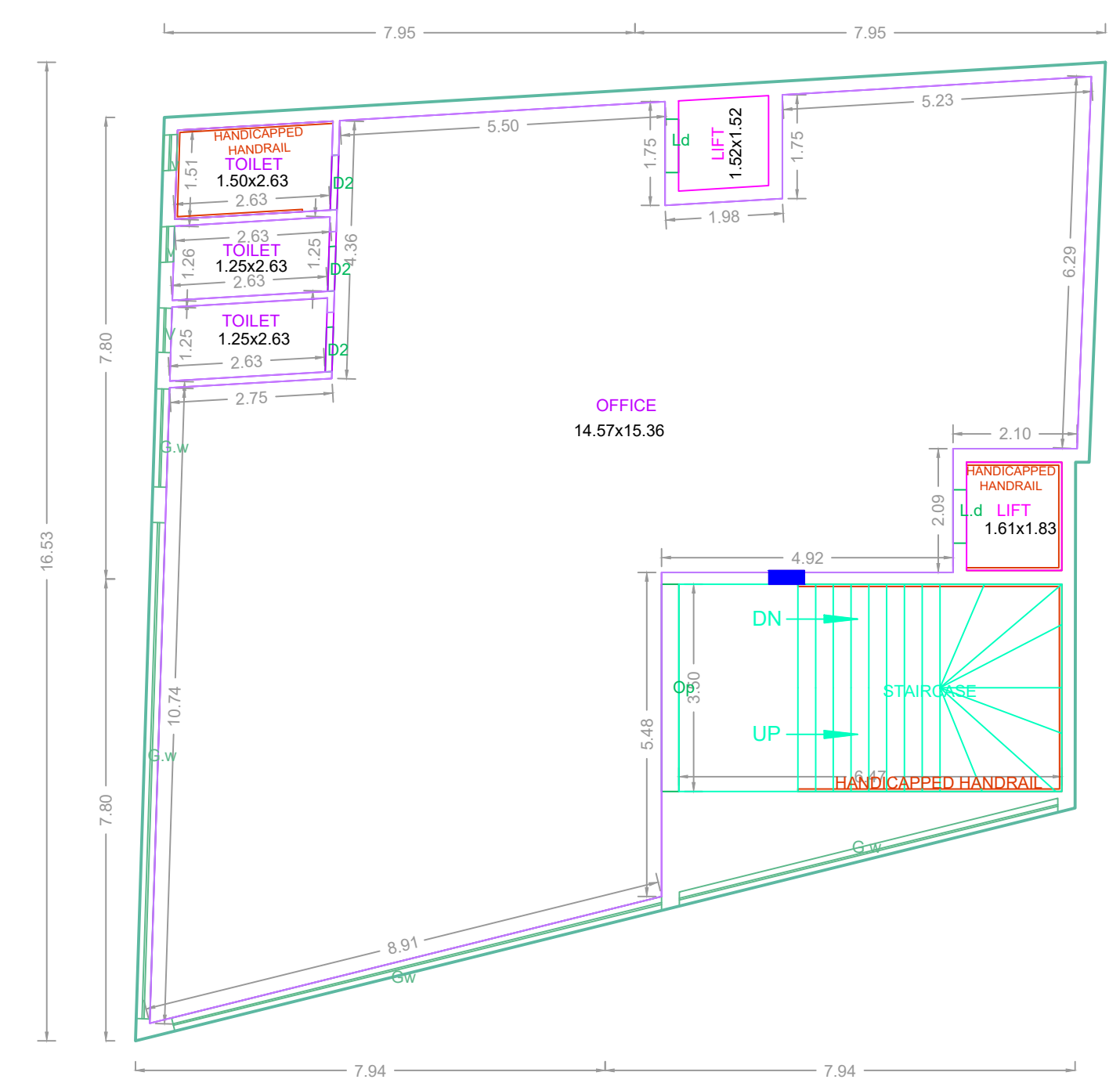

TYPICAL - 1, 2, 3, 4 & 5 FLOOR PLAN

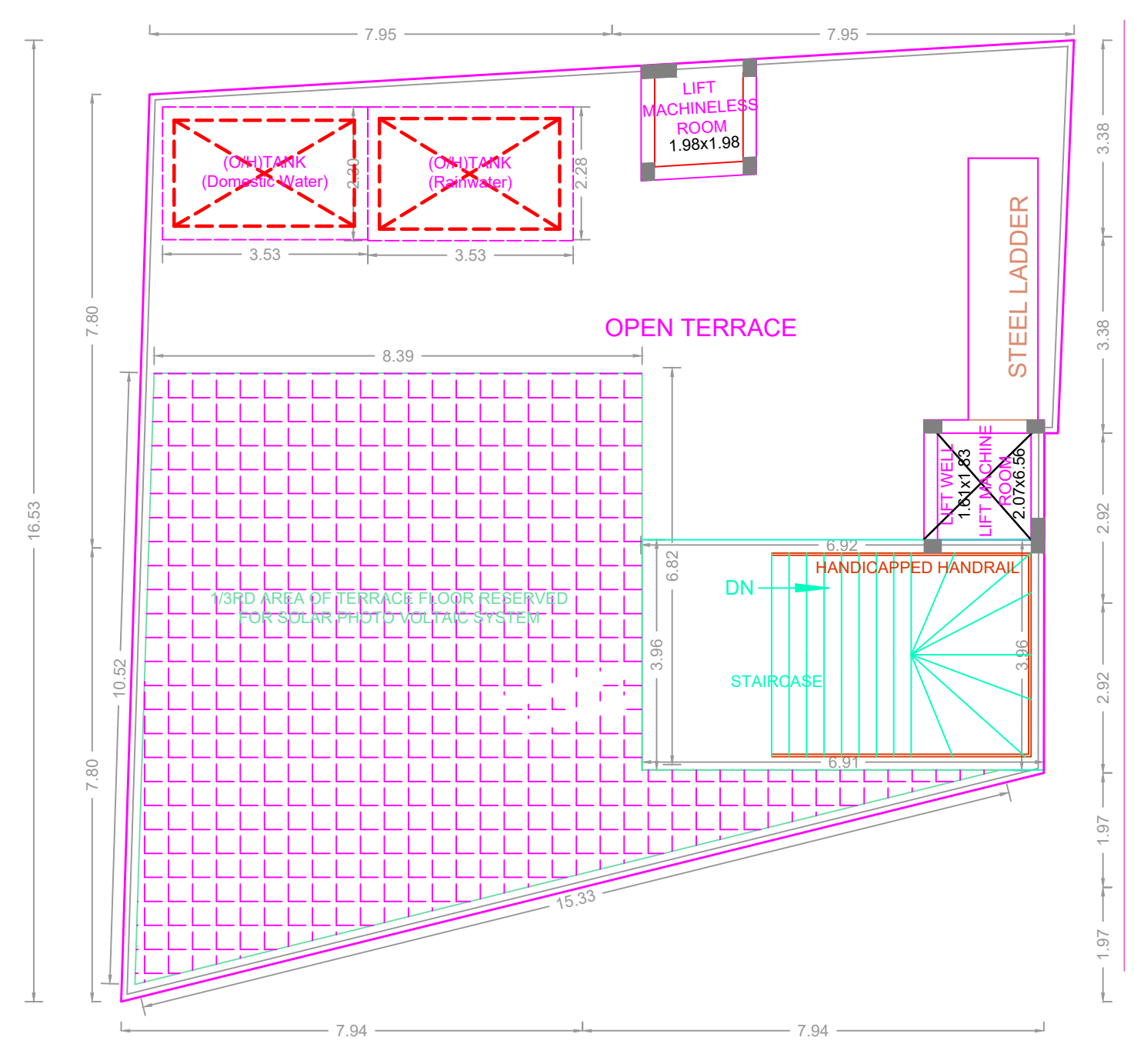

TERRACE FLOOR PLAN

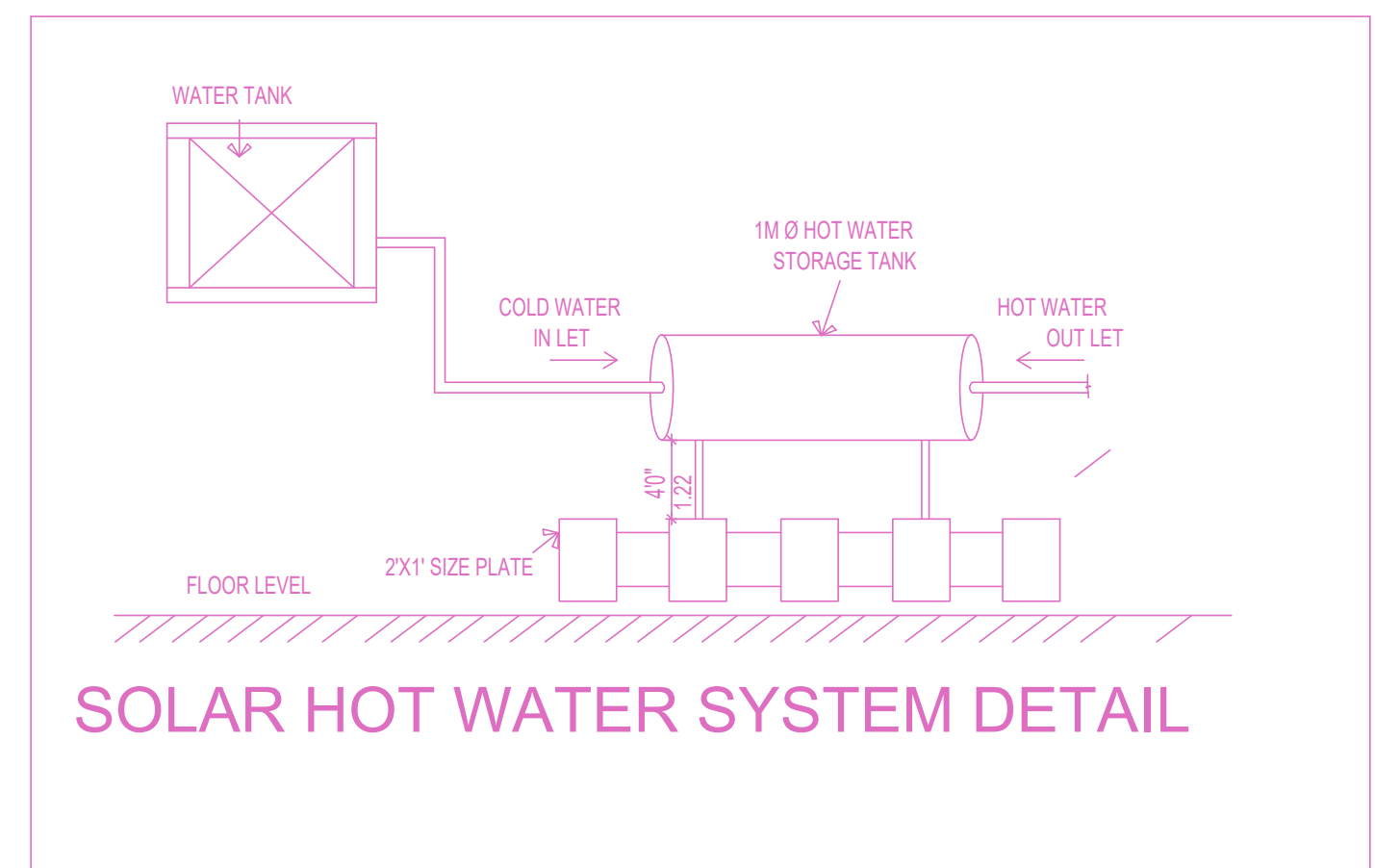

SOLAR HOT WATER SYSTEM DETAIL

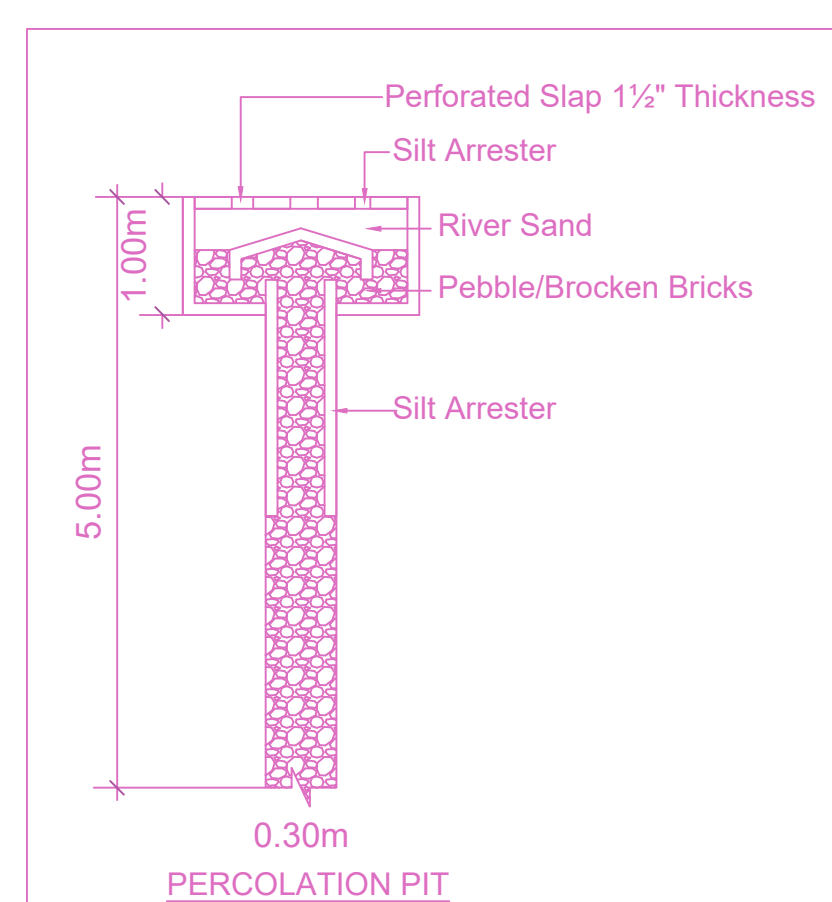

PERCOLATION PIT

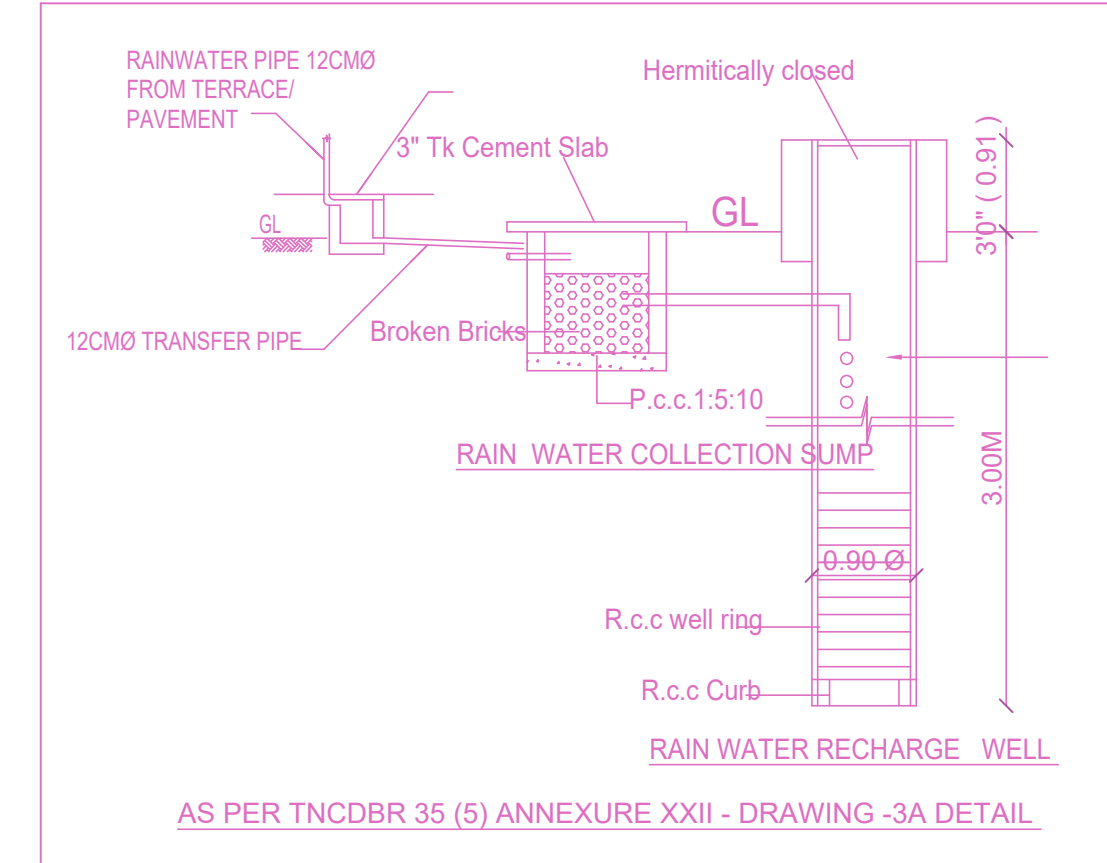

RAIN WATER COLLECTION SUMP

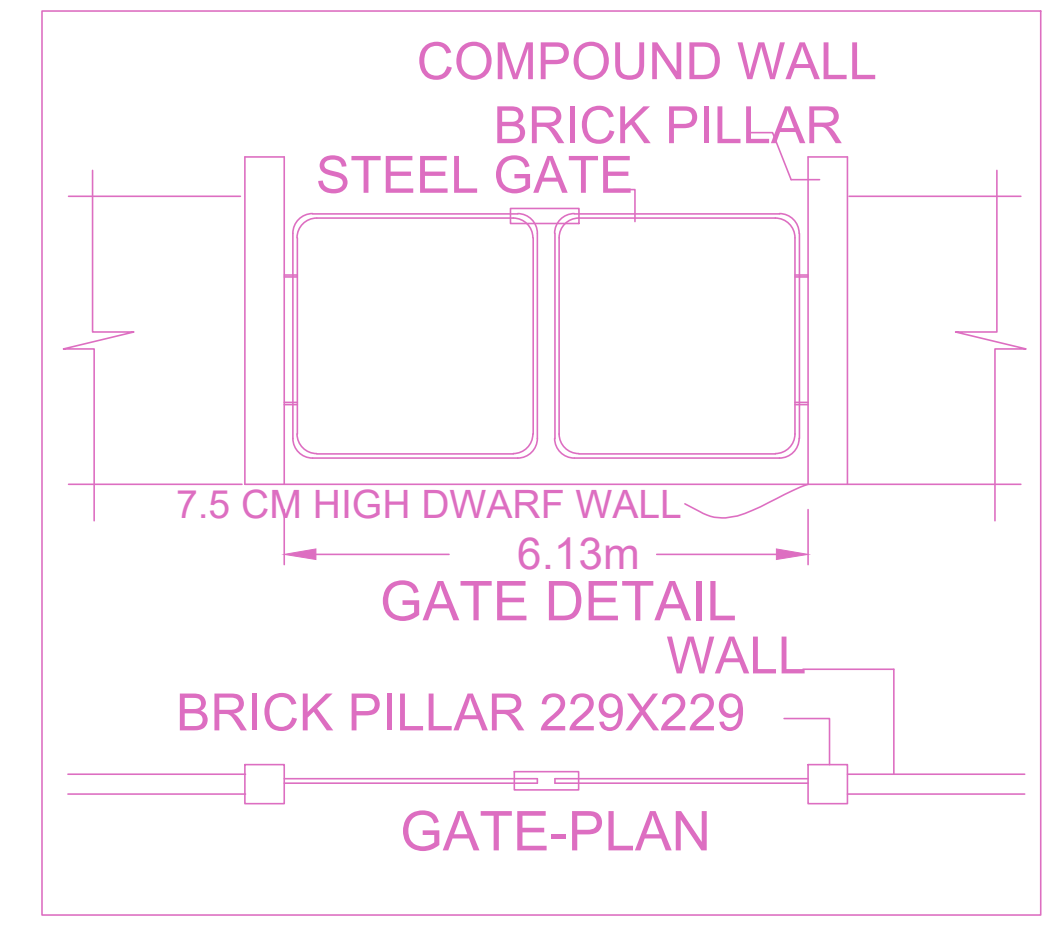

GATE-PLAN

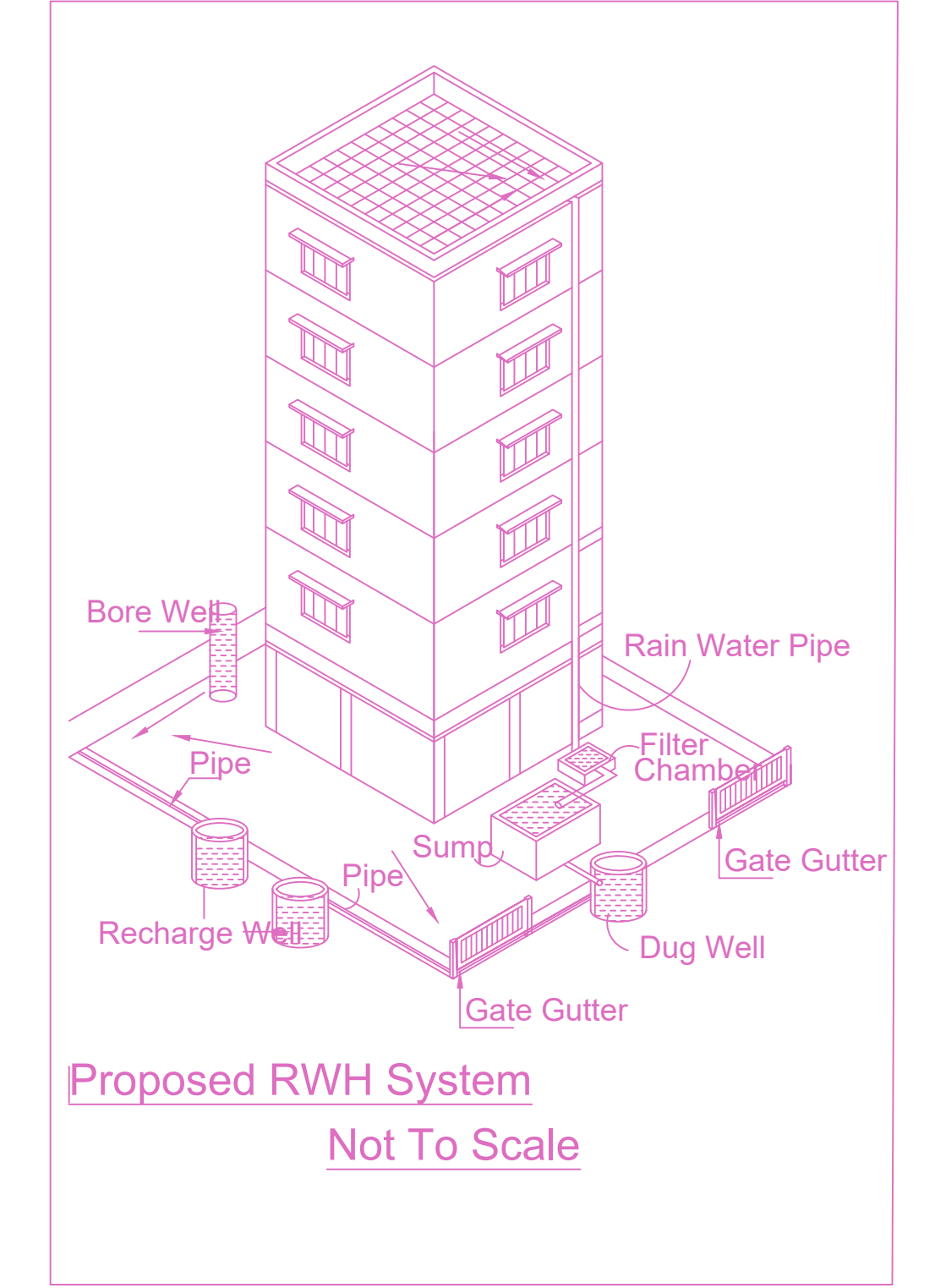

Proposed RWH System Not To Scale

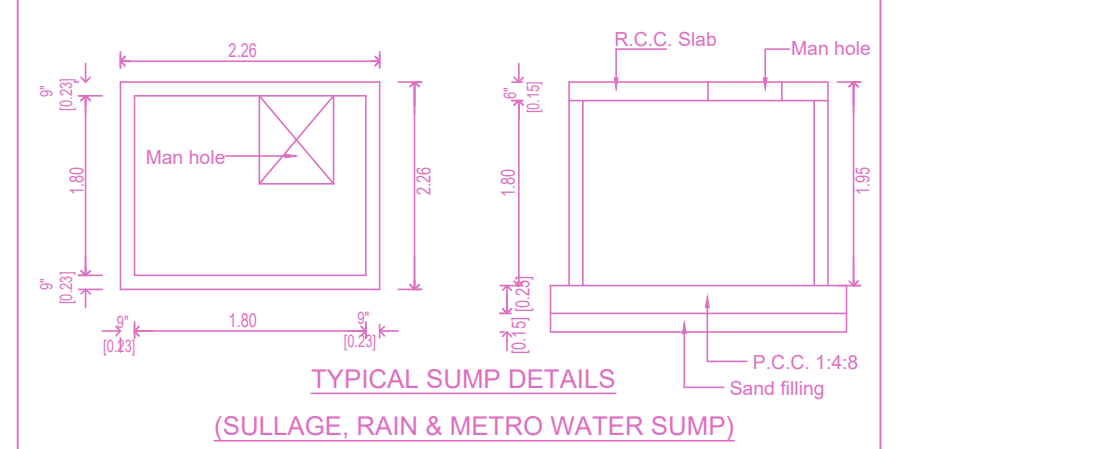

TYPICAL SUMP DETAILS (SULLAGE, RAIN & METRO WATER SUMP)

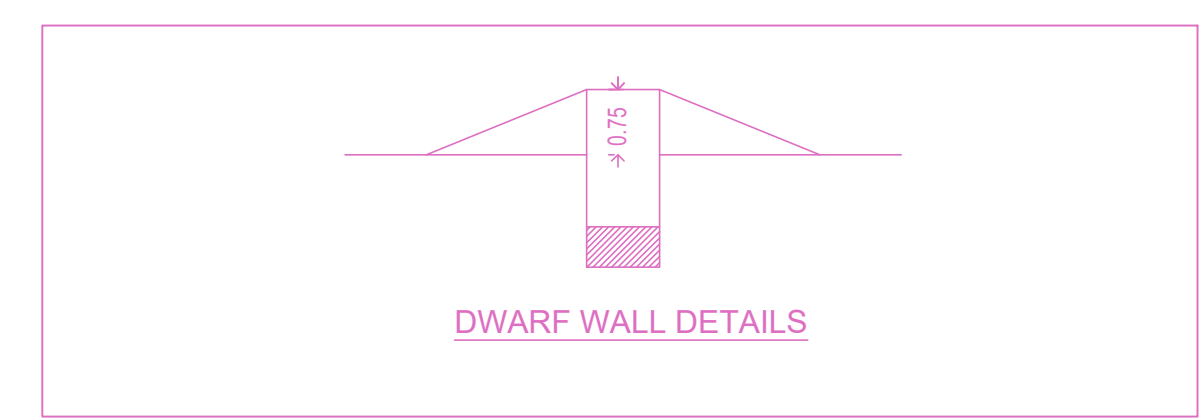

DWARF WALL DETAILS

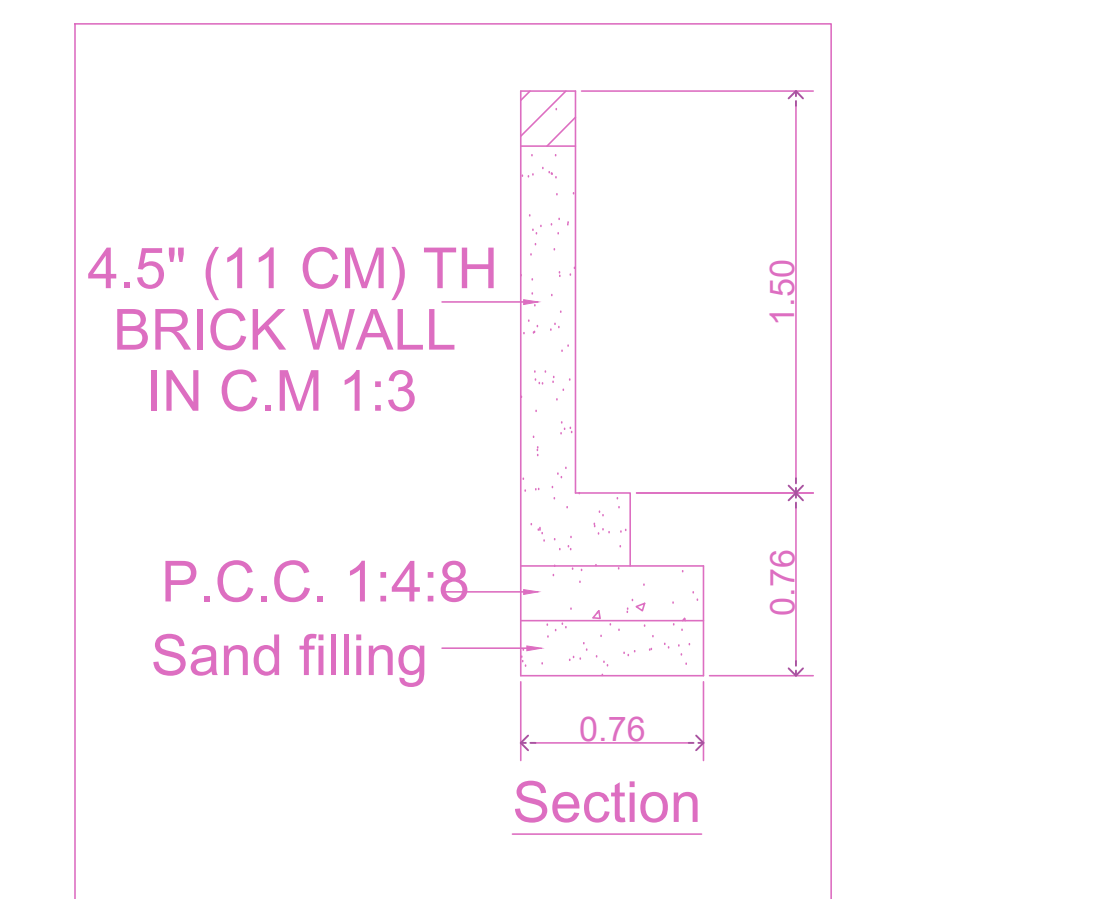

4.5\"/>

APPROVAL CONDITION

SCALE: 1:100

CHENNAI METROPOLITAN DEVELOPMENT AUTHORITY
 APPROVED
 SUBJECT TO THE CONDITIONS MENTIONED IN THIS OFFICE

This Planning Permission issued under New Rule TNCDDR, 2019 is subject to final outcome of the W.P. (MD) No.8948 of 2019 and WMP (MD) No. 6912 & 6913 of 2019.