

SECTION - AA

FLOOR WISE FSI STATEMENT: A (1)

FLOORS	FSI AREA				DU	TOTAL FSI AREA
	COMM.	RESI.	IND.	INST.		
THIRD FLOOR	0.00	336.36	0.00	0.00	3	336.36
SECOND FLOOR	0.00	336.36	0.00	0.00	3	336.36
FIRST FLOOR	0.00	336.36	0.00	0.00	3	336.36
STILT PARKING FLOOR	0.00	28.48	0.00	0.00	0	28.48
Terrace	0.00	0.00	0.00	0.00	0	0.00
<b>Total</b>	<b>0.00</b>	<b>1037.56</b>	<b>0.00</b>	<b>0.00</b>	<b>9</b>	<b>1037.56</b>

BUILDING WISE FSI STATEMENT

BUILDING	NO OF SAME BUILDING	FSI AREA				DU	TOTAL FSI AREA
		COMM.	RESI.	IND.	INST.		
A-1 (1)		0.00	1037.56	0.00	0.00	9	1037.56
<b>Total</b>		<b>0.00</b>	<b>1037.56</b>	<b>0.00</b>	<b>0.00</b>	<b>9</b>	<b>1037.56</b>

PLAN SHOWING THE PROPOSED CONSTRUCTION OF STILT FLOOR + 3 FLOORS RESIDENTIAL BUILDING WITH 9 DWELLING UNITS (HEIGHT-12.00M) AT OLD DOOR NO -10, NEW DOOR NO-17, VEERABADRAN STREET, NUNGAMBAKKAM, CHENNAI COMPRISED IN OLD R.S.NO - 198 /16, NEW R.S.NO. 198/35 & 198/40 BLOCK NO-24 OF NUNGAMBAKKAM VILLAGE WITHIN THE LIMITS OF GREATER CHENNAI CORPORATION.

A) AREA STATEMENT	SQ.M.
AREA AS PER PATTA	520.50
AREA AS PER DOCUMENT	520.44
AREA CONSIDERED FOR FSI	520.44
STREET ALIGNMENT/ ROAD WIDENING/LINK ROAD	0.00
OSR AREA	0.00
TOTAL FSI AREA	1037.56
FSI FACTOR	1.994
COVERAGE AREA (PERCENTAGE %)	NA

A) PARKING STATEMENT

VEHICLE	REQUIRED	PROVIDED
LORRY	-	0
CAR	7	9
TWO WHEELER	3	3
CYCLE	-	0

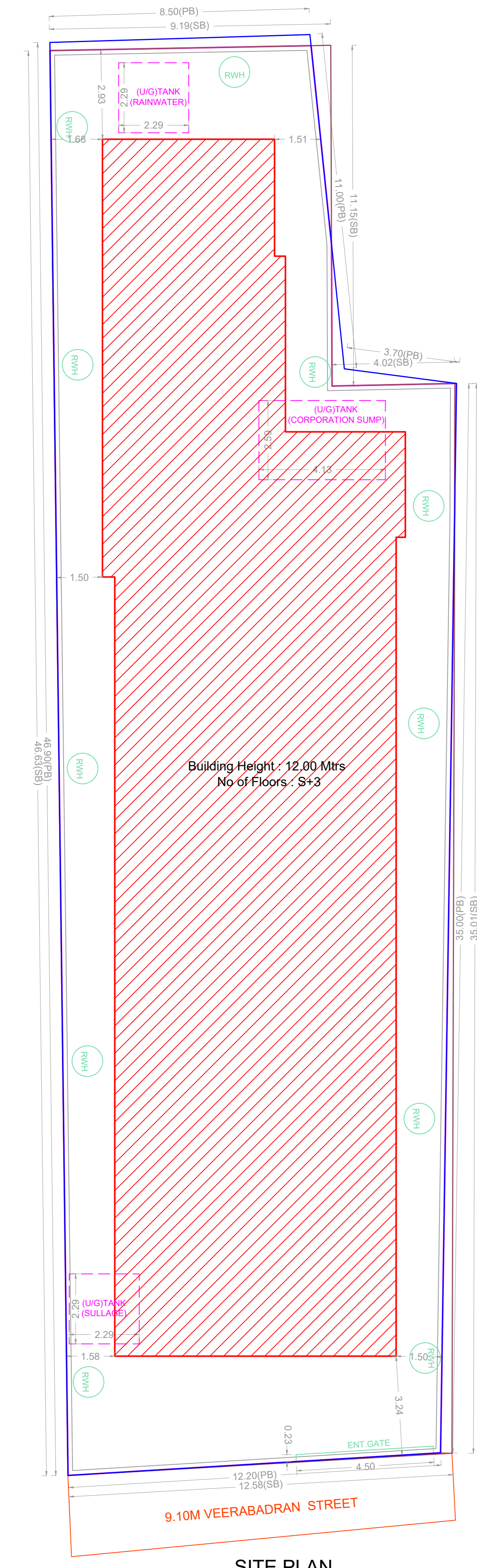

SITE PLAN

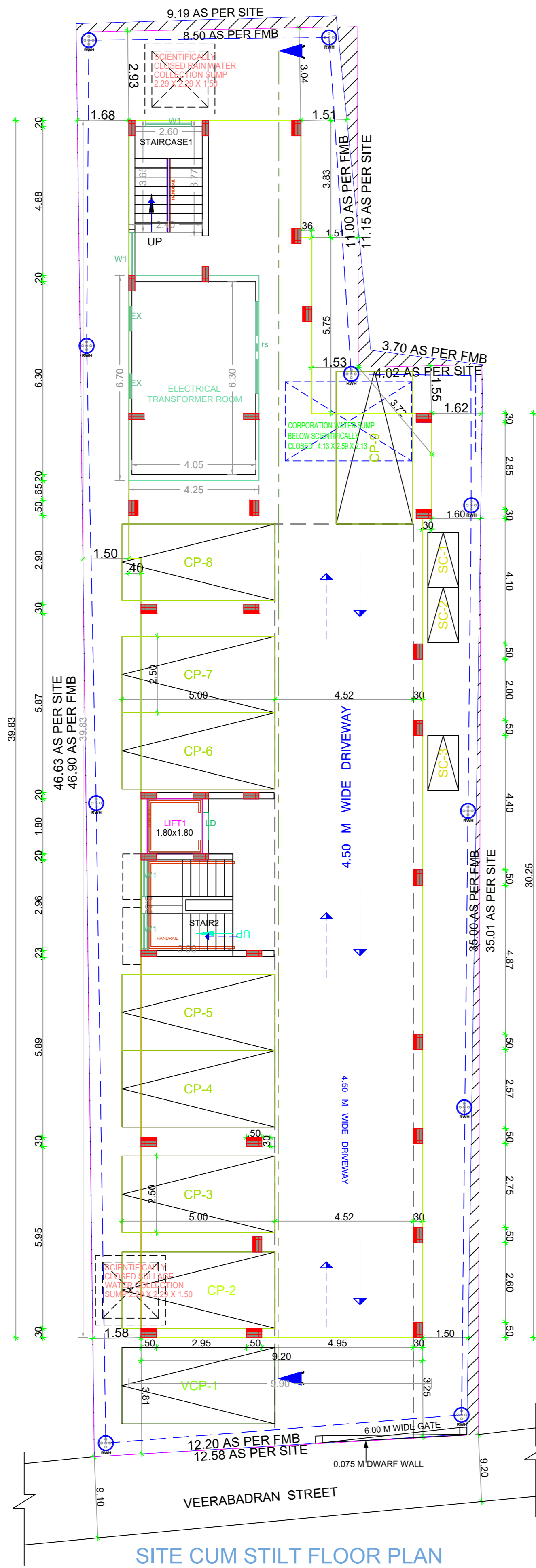

SITE CUM STILT FLOOR PLAN

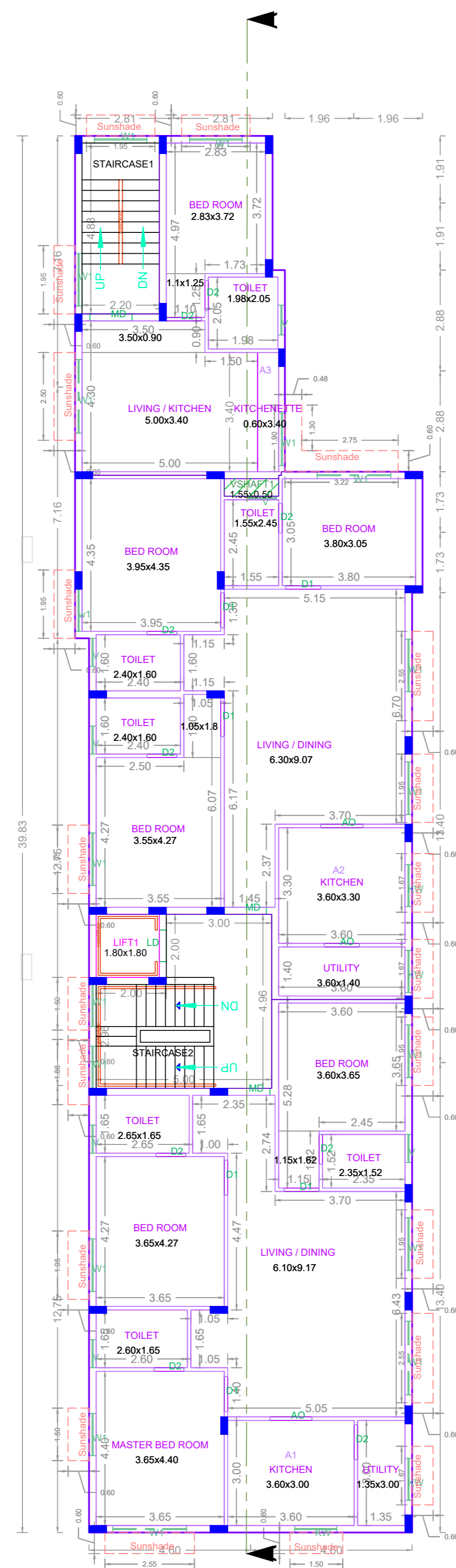

TYPICAL - 1, 2 & 3 FLOOR PLAN

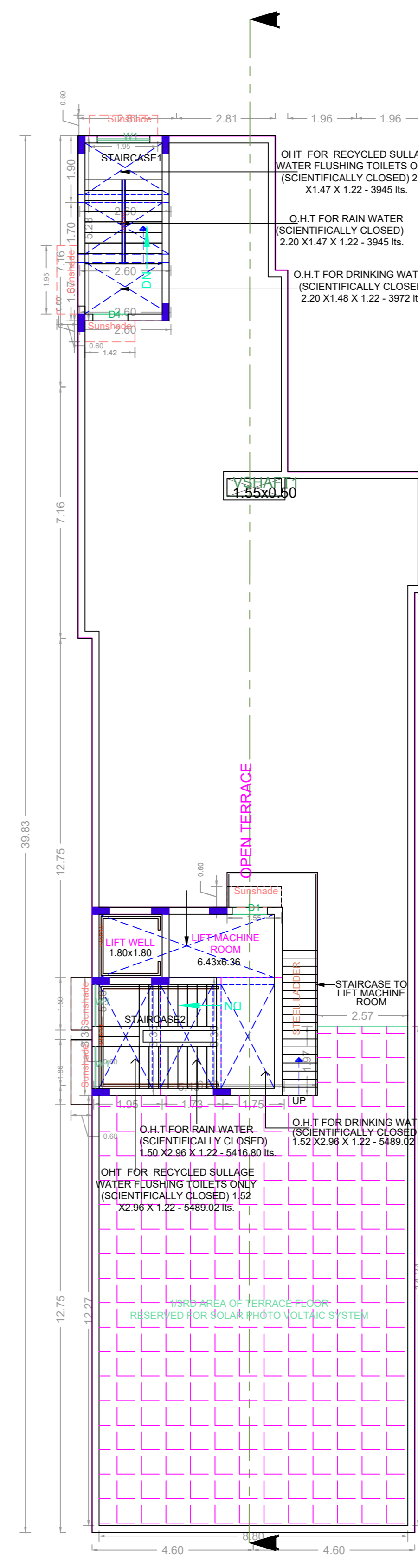

TERRACE FLOOR PLAN

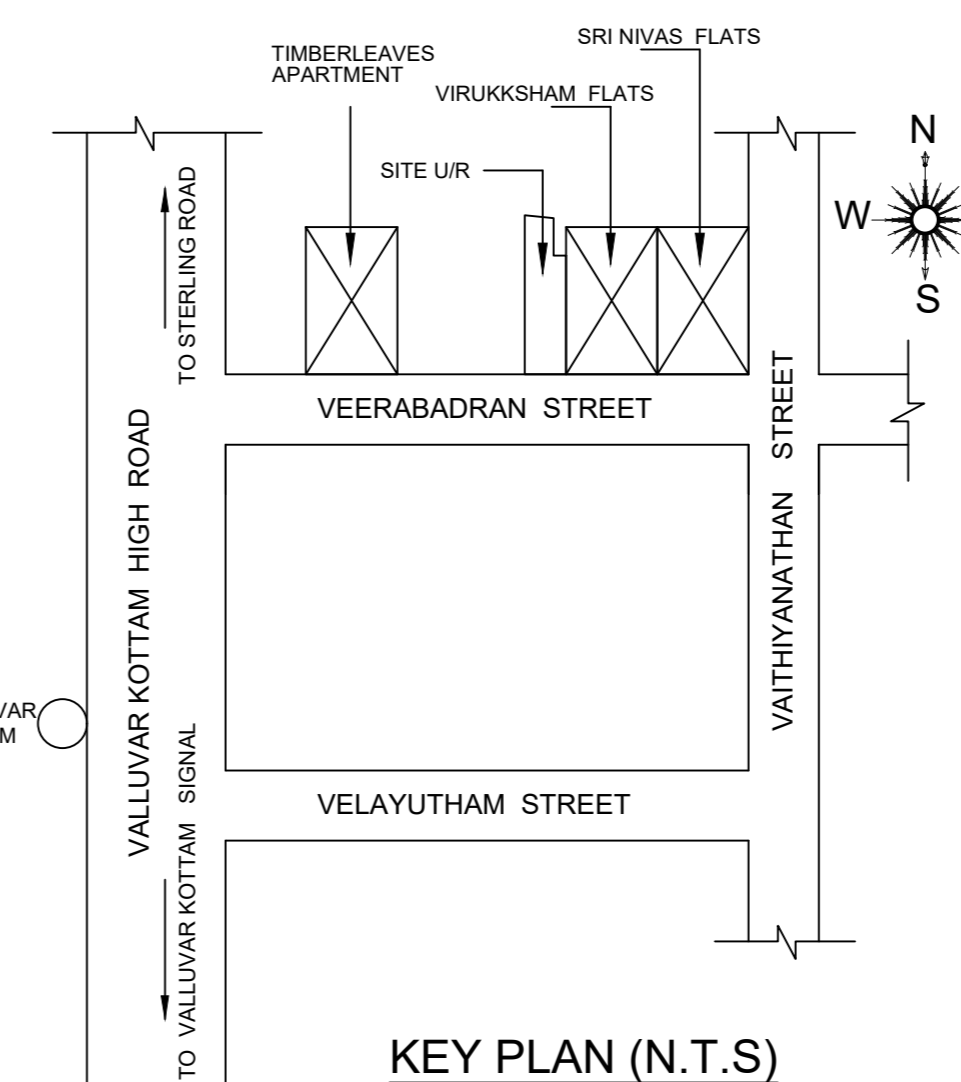

KEY PLAN (N.T.S)

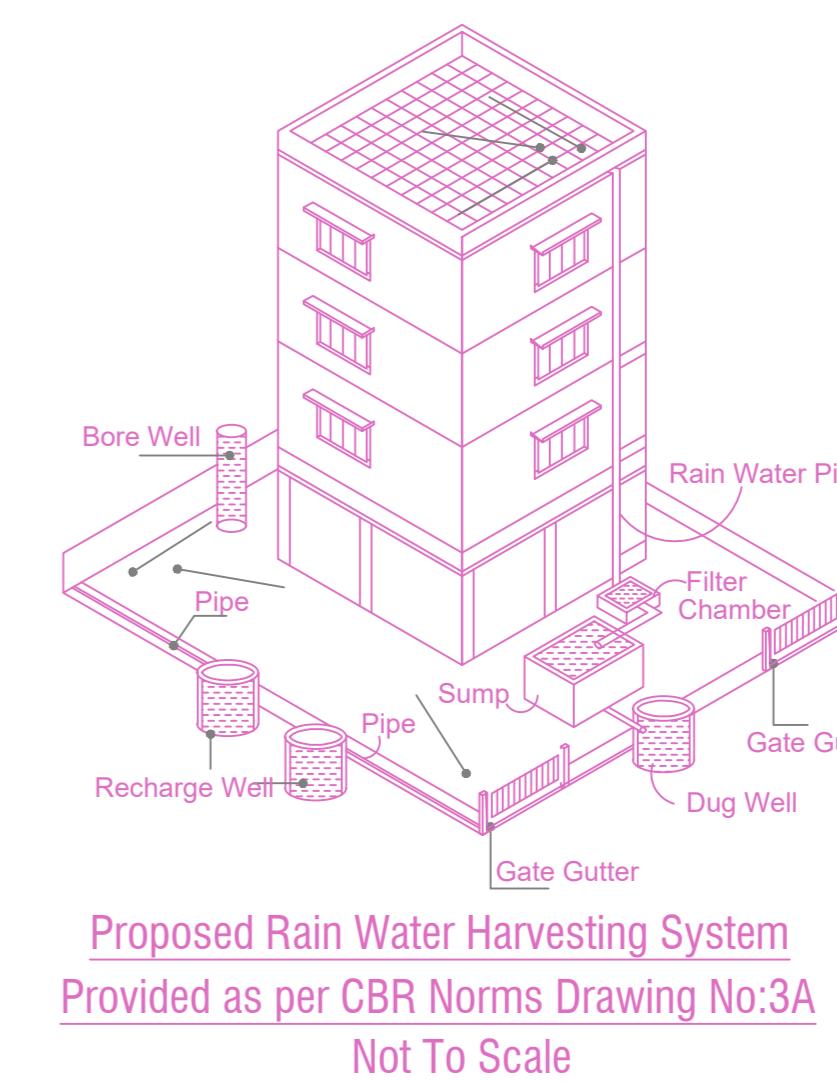

Proposed Rain Water Harvesting System  
Provided as per Chennai Norms Drawing No:3A  
Not To Scale

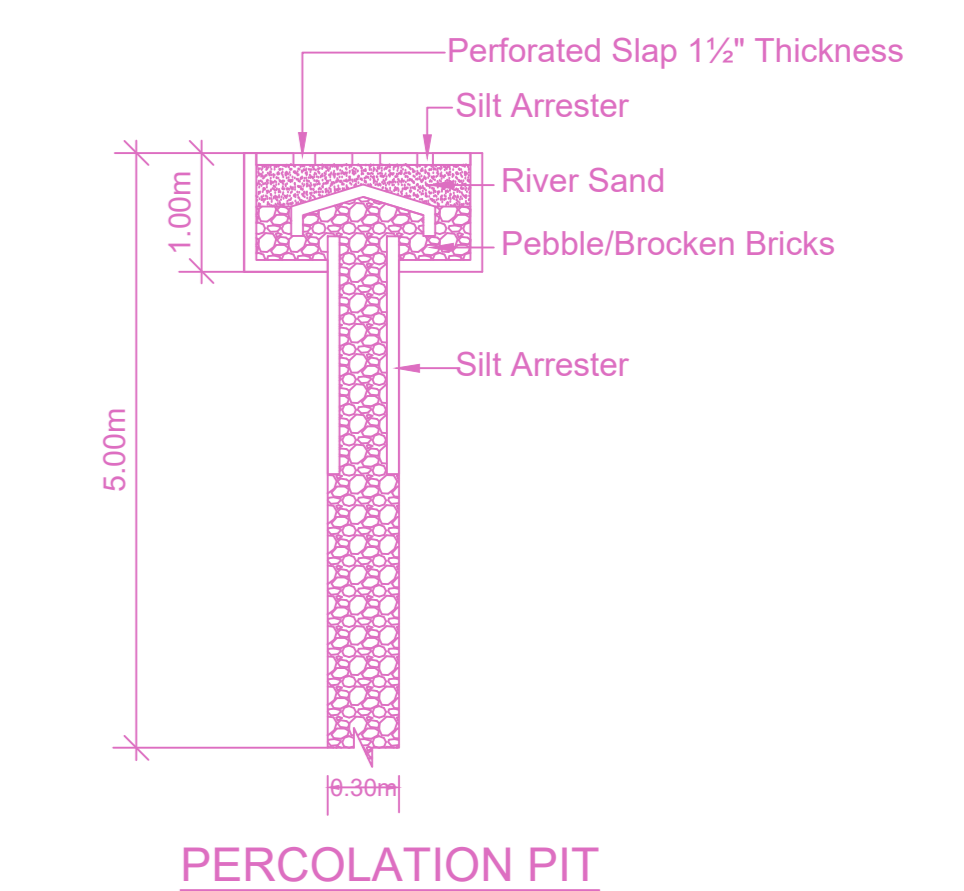

PERCOLATION PIT

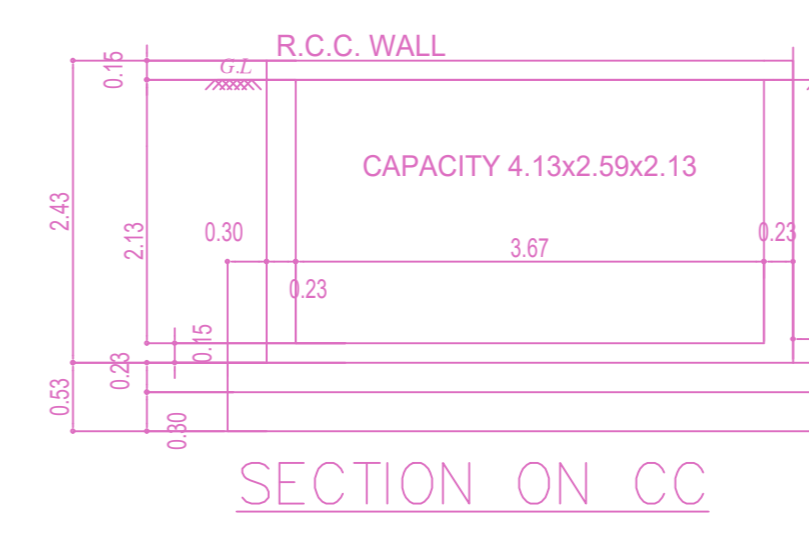

SECTION ON CC

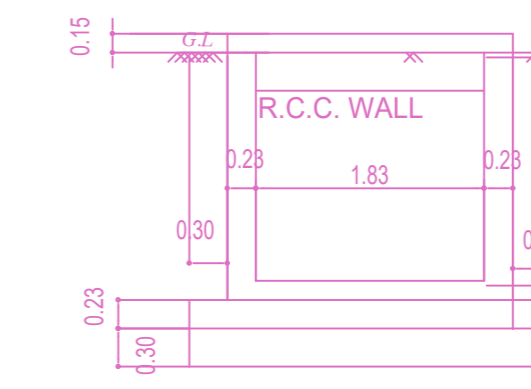

SECTION ON DD

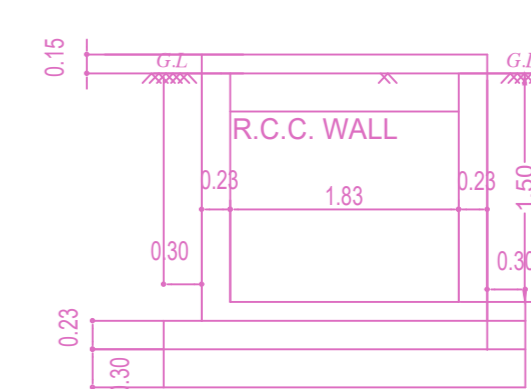

SECTION ON DD

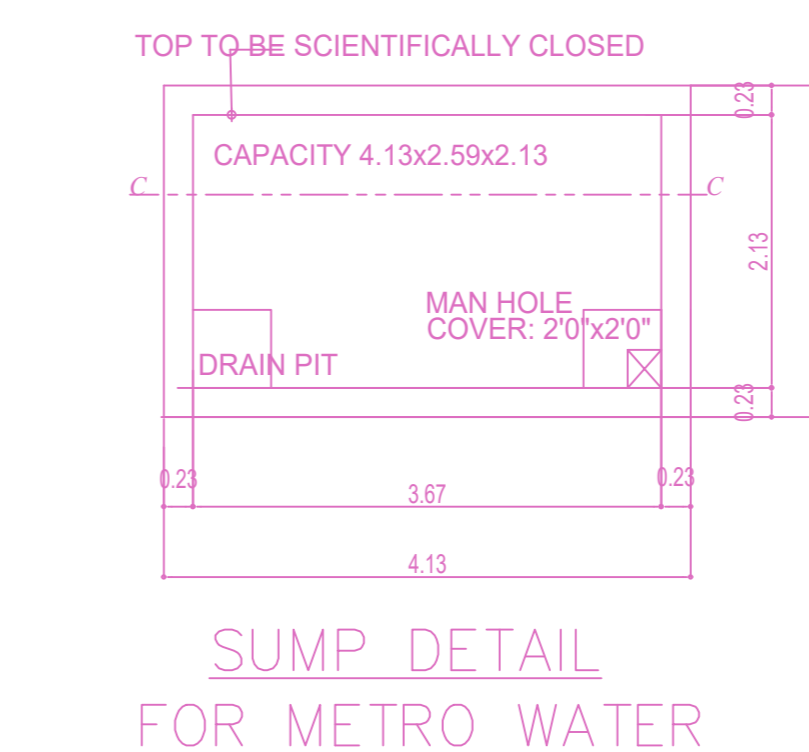

SUMP DETAIL FOR METRO WATER

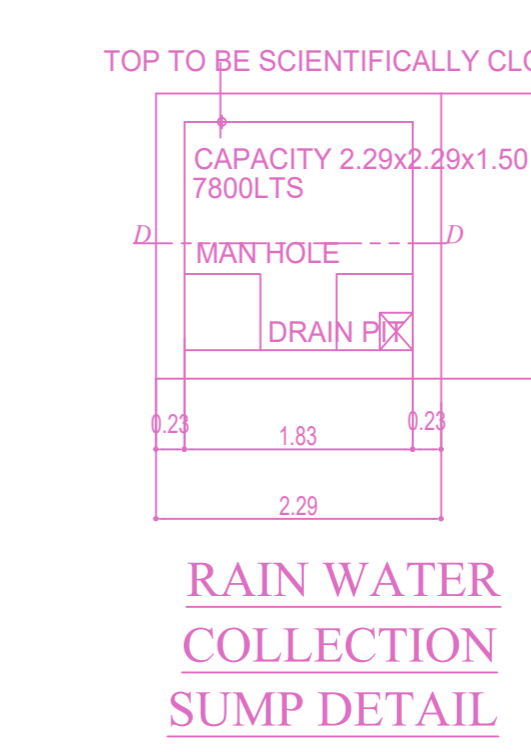

RAIN WATER COLLECTION SUMP DETAIL

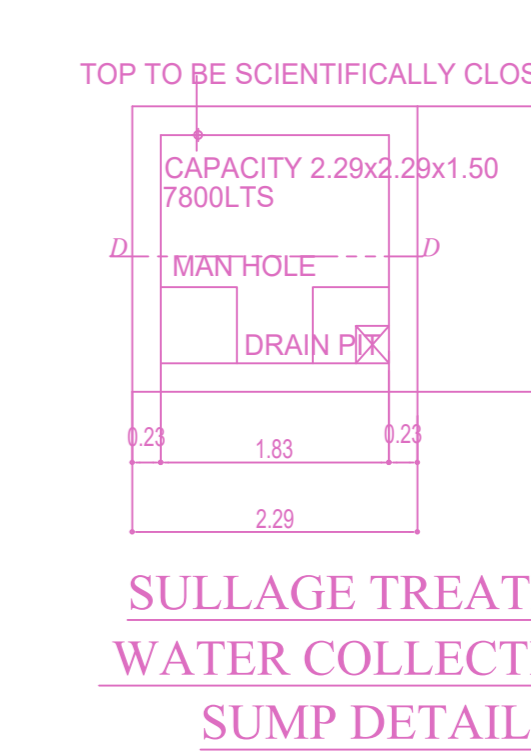

SULLAGE TREATED WATER COLLECTION SUMP DETAIL

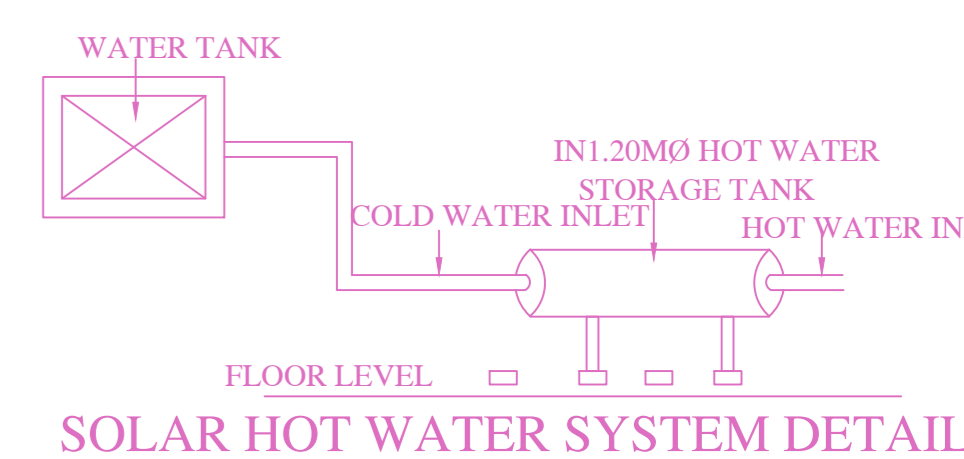

SOLAR HOT WATER SYSTEM DETAIL

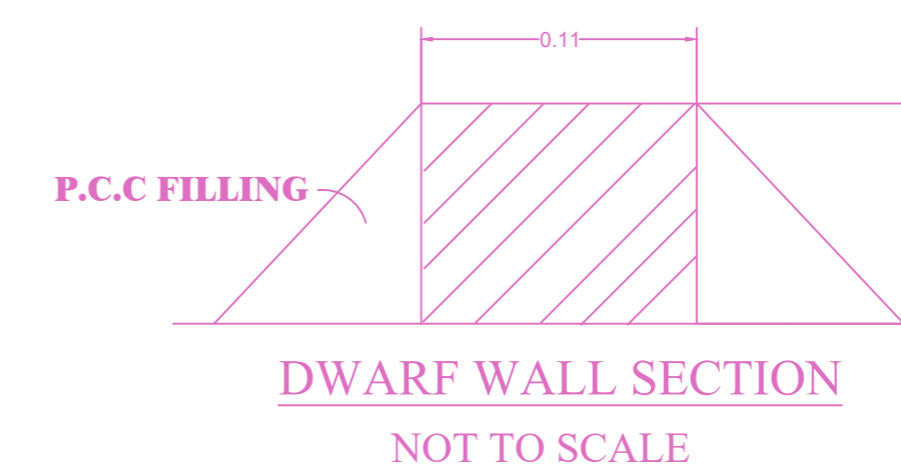

DWARF WALL SECTION NOT TO SCALE

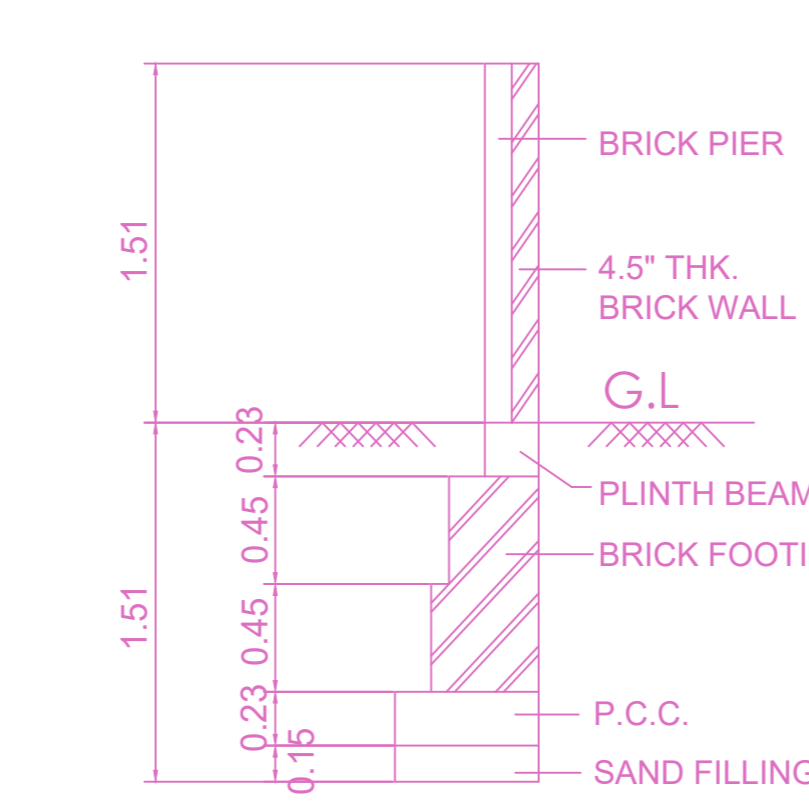

COMPOUND WALL DETAIL

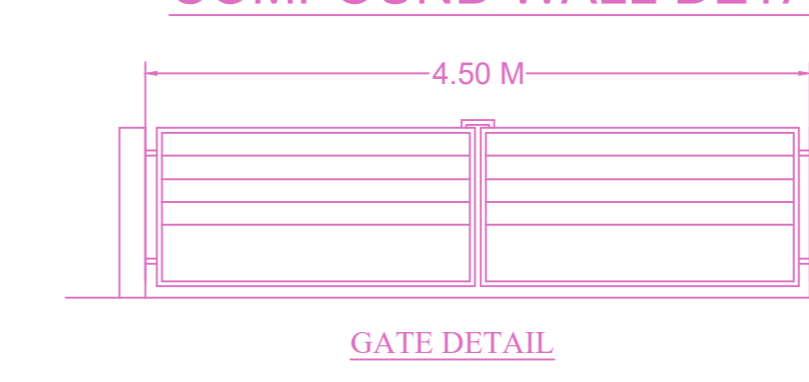

GATE DETAIL

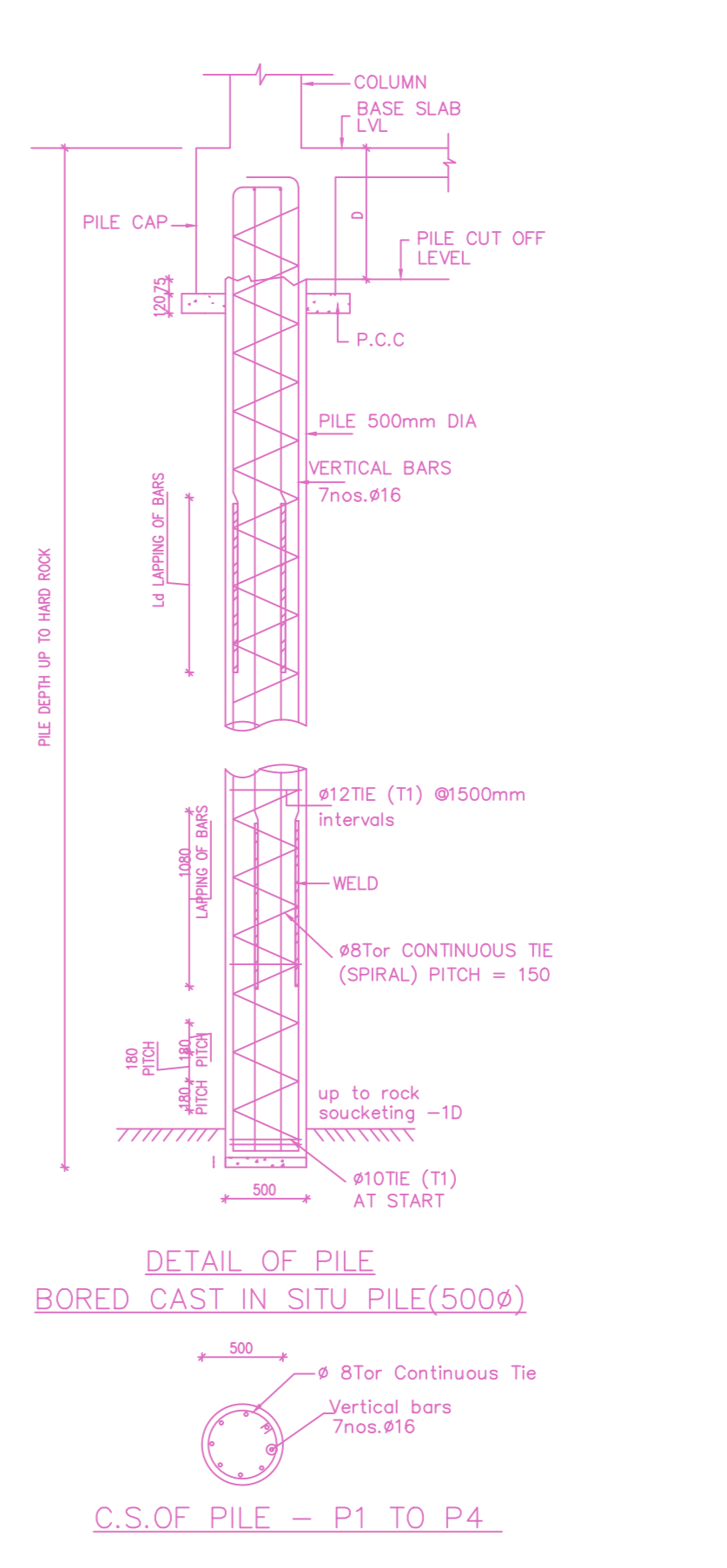

DETAIL OF PILE BORED CAST IN SITU PILE(500φ)

C.S.OF PILE - P1 TO P4

APPROVAL CONDITION	
1.	As per the conditions mentioned in this office.
2.	As per the conditions mentioned in this office.
3.	As per the conditions mentioned in this office.
4.	As per the conditions mentioned in this office.
5.	As per the conditions mentioned in this office.
6.	As per the conditions mentioned in this office.
7.	As per the conditions mentioned in this office.
8.	As per the conditions mentioned in this office.
9.	As per the conditions mentioned in this office.
10.	As per the conditions mentioned in this office.

SCALE 1:100

CHENNAI METROPOLITAN DEVELOPMENT AUTHORITY

APPROVED

SUBJECT TO THE CONDITIONS MENTIONED IN THIS OFFICE

For (Deputy Planner / Chief Planner / Member-Secretary)  
High Rise Building / Non High Rise Building  
This Approval is valid only after building Permit is issued by the concerned Local Body.

KEY NO. 7688

QR CODE