

PLAN SHOWING THE PROPOSED CONSTRUCTION OF STILT FLOOR (PARKING) + 4 FLOORS (COMMERCIAL) OFFICE BUILDING (HEIGHT - 15.20M) AT PLOT NO.1229, DOOR NO.55, 18TH MAIN ROAD, ANNA NAGAR, CHENNAI-600040, COMPRISED IN OLD S.NO - 137/1 (PART), T.S.NO. 207, BLOCK NO. 34, WARD - 1 OF VILLIVAKKAM VILLAGE WITHIN THE LIMITS OF GREATER CHENNAI CORPORATION.

A) AREA STATEMENT		SQ.M
AREA AS PER PATA		456.50
AREA AS PER DOCUMENT		455.23
AREA CONSIDERED FOR FSI		454.93
STREET ALIGNMENT/ ROAD WIDENING LINK ROAD		0.00
OSR AREA		0.00
TOTAL FSI AREA		728.92
FSI FACTOR		1.004
COVERAGE AREA (PERCENTAGE %)		NA

A) PARKING STATEMENT		
VEHICLE	REQUIRED	PROVIDED
LORRY	-	0
CAR	7	7
TWO WHEELER	24	28
CYCLE	-	9

FLOOR WISE FSI STATEMENT: A (OFFICE)

FLOORS	COMM	RESI	IND	INST	DU	TOTAL FSI AREA
STILT PARKING FLOOR	0.00	0.00	0.00	0.00	0	0.00
FIRST FLOOR	182.23	0.00	0.00	0.00	0	182.23
SECOND FLOOR	182.23	0.00	0.00	0.00	0	182.23
THIRD FLOOR	182.23	0.00	0.00	0.00	0	182.23
FOURTH FLOOR	182.23	0.00	0.00	0.00	0	182.23
Terrace	0.00	0.00	0.00	0.00	0	0.00
Total	728.92	0.00	0.00	0.00	0	728.92

BUILDING WISE FSI STATEMENT

BUILDING	NO OF SAME BUILDING	COMM	RESI	IND	INST	DU	TOTAL FSI AREA
A-1 (OFFICE)	1	728.92	0.00	0.00	0.00	0	728.92
Total		728.92	0.00	0.00	0.00	0	728.92

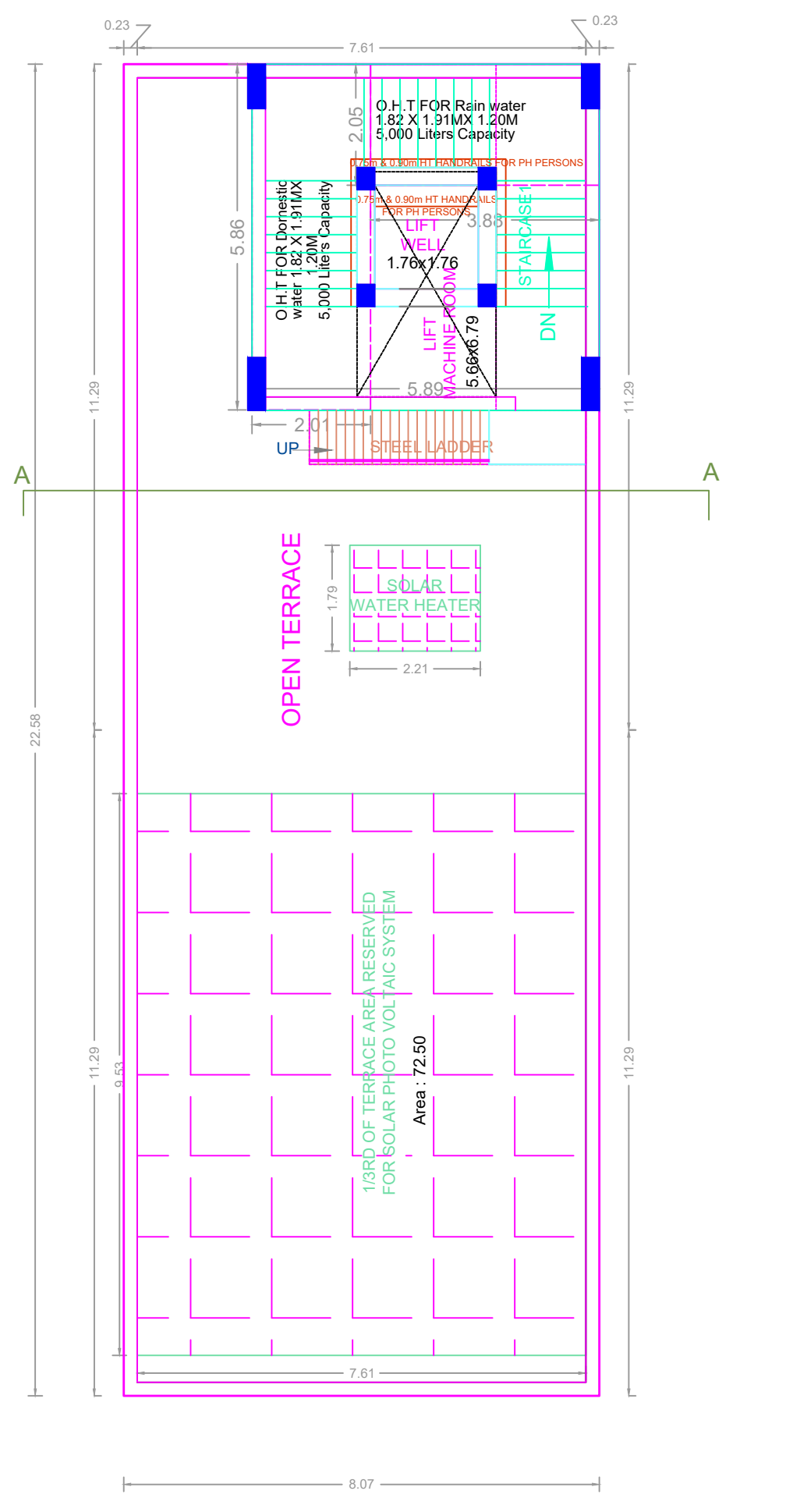
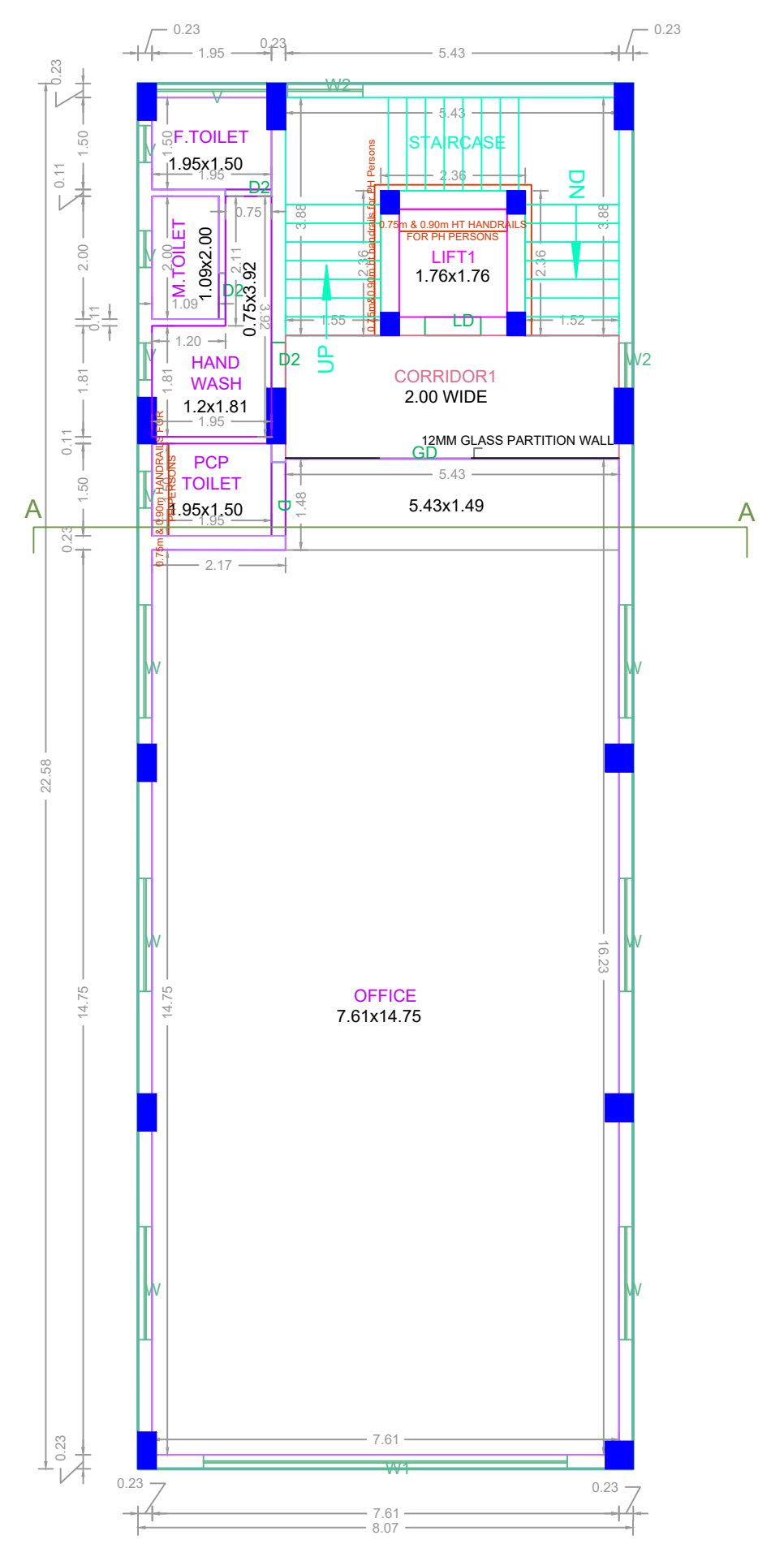
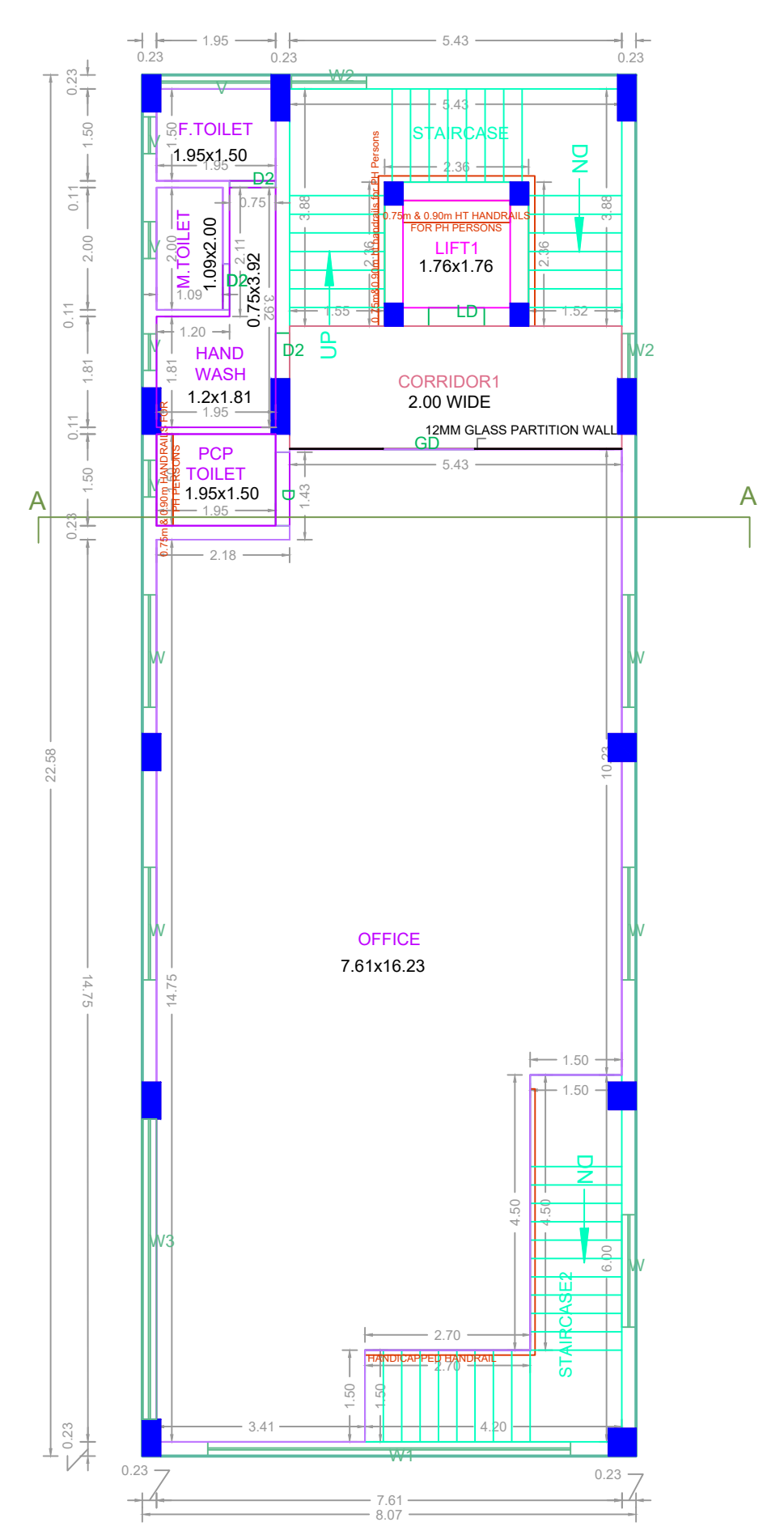
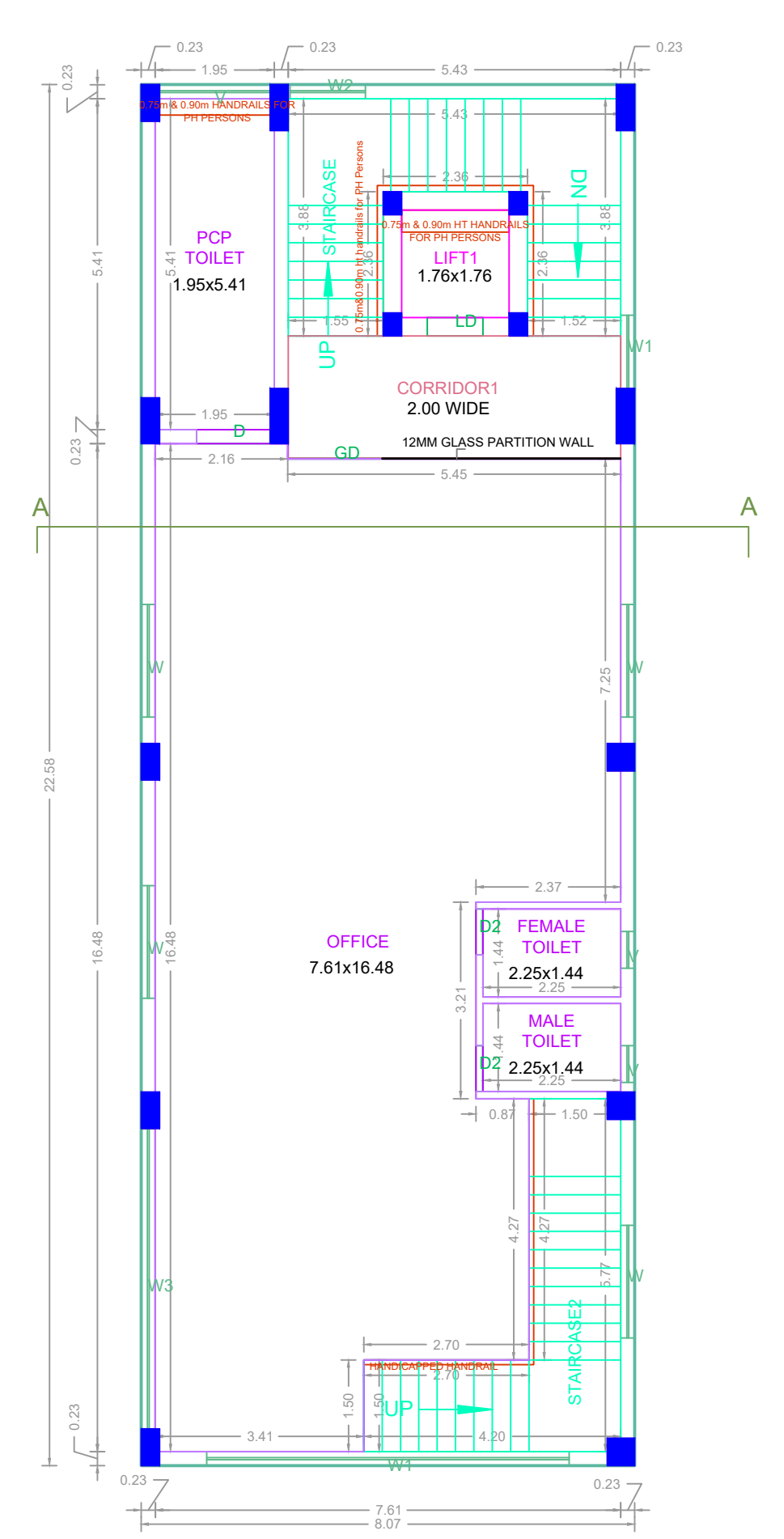
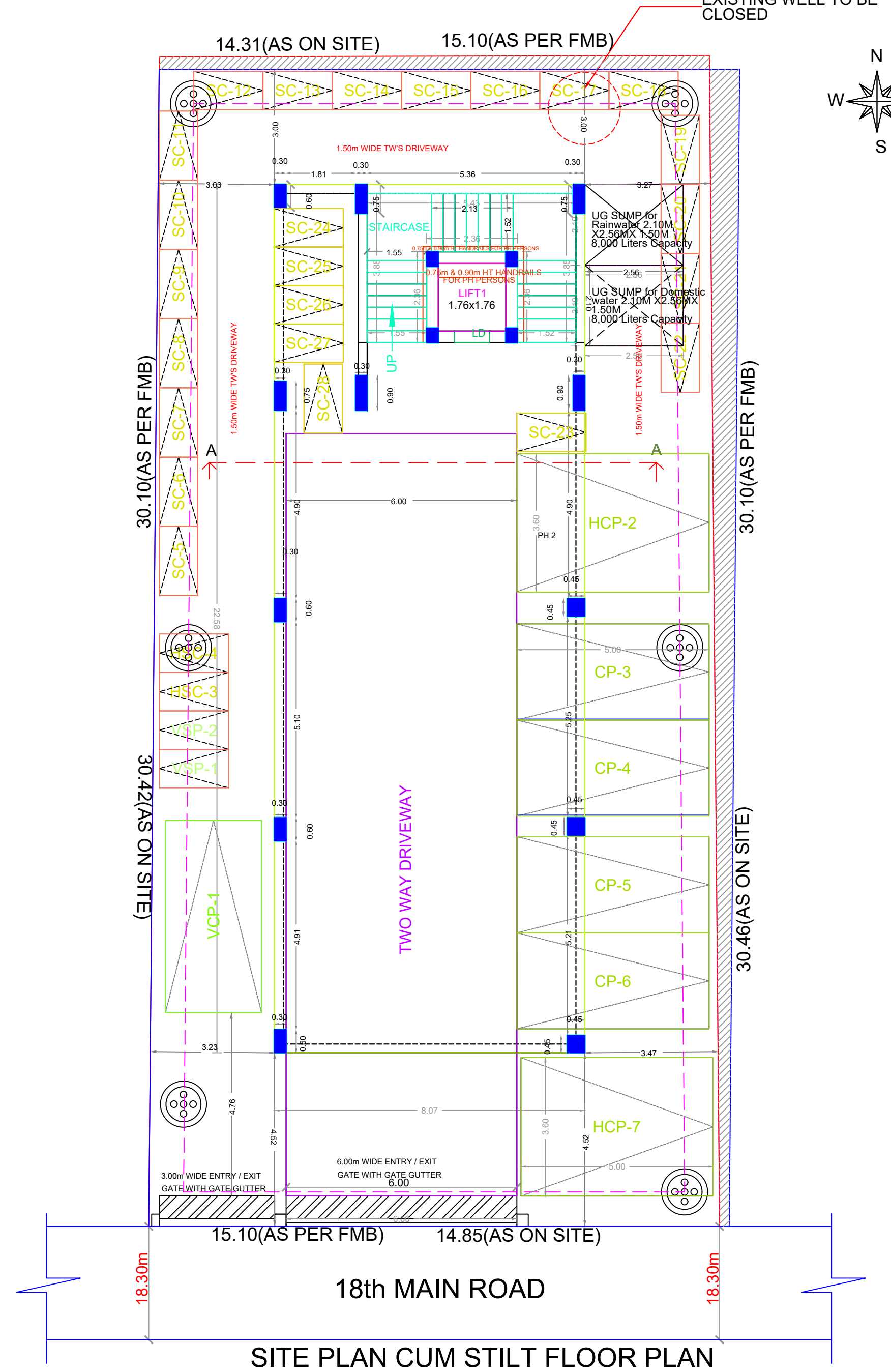
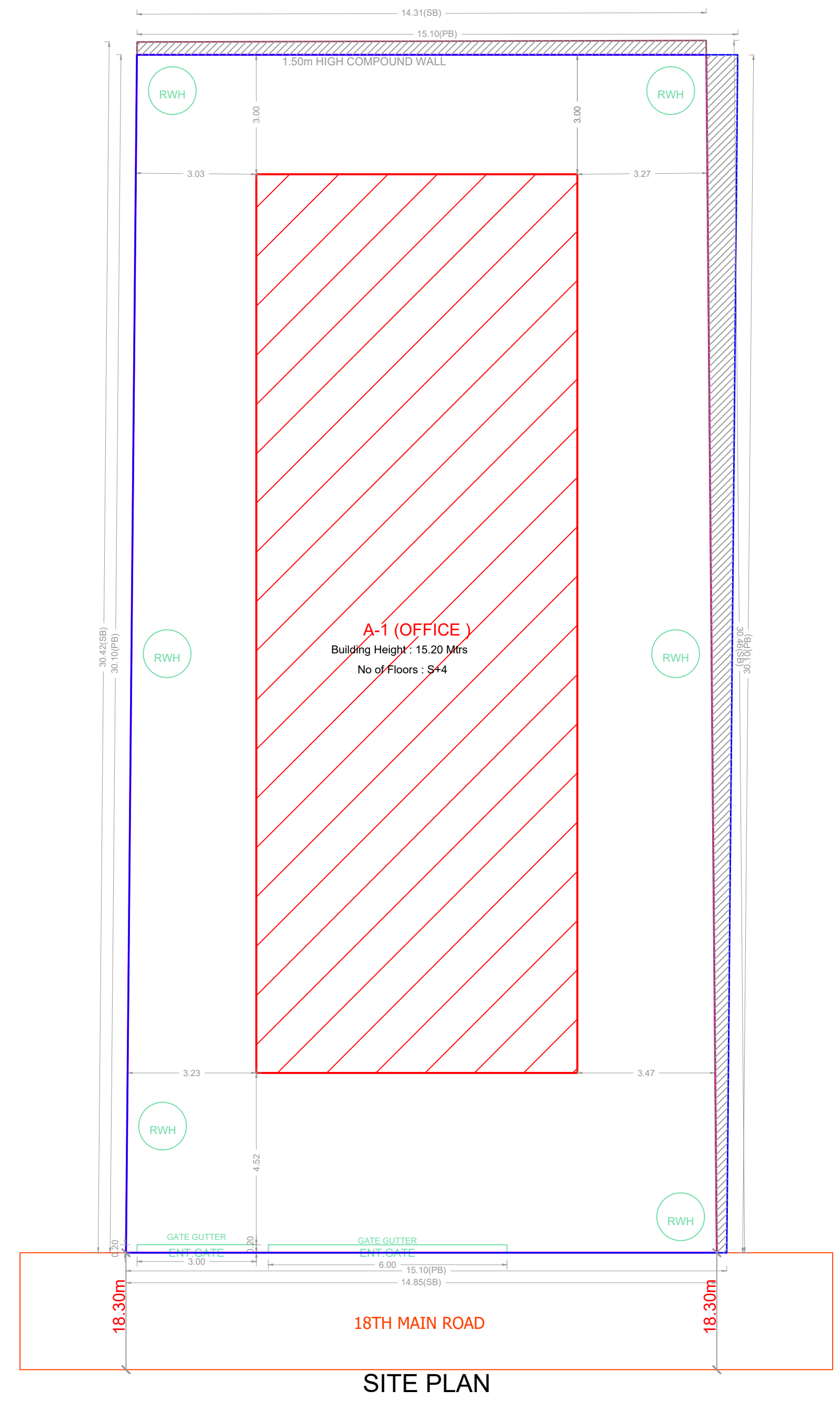
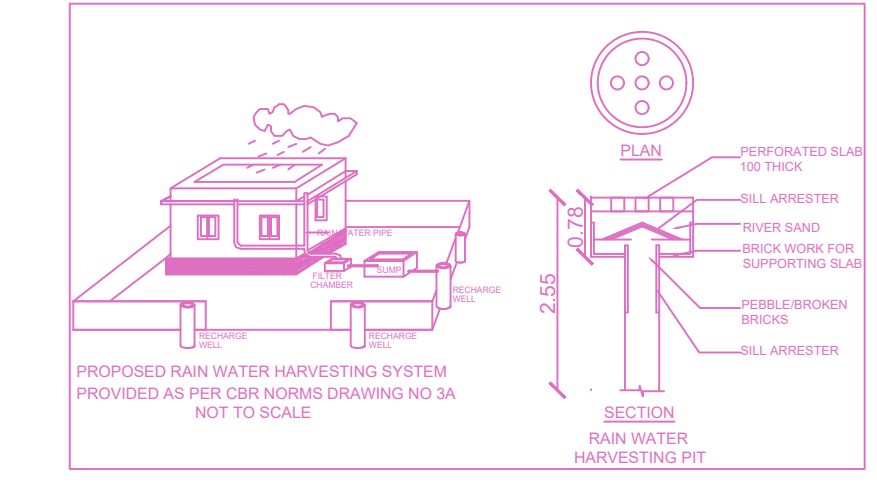

APPROVAL CONDITION

SCALE: 1:100

CHENNAI METROPOLITAN DEVELOPMENT AUTHORITY

APPROVED

SUBJECT TO THE CONDITIONS MENTIONED IN THIS OFFICE

For Check/Planner / Chief Planner / Member Secretary
High Rise Building / Non High Rise Building
This Approval is valid only after Building Permit is issued by the concerned Local Body.

KEY NO. 9688

QR CODE