

PLAN SHOWING THE PROPOSED CONSTRUCTION OF STILT FLOOR PARKING + 5 FLOORS RESIDENTIAL BUILDING WITH 5 DWELLING UNITS (HEIGHT - 18.30) AVALING PREMIUM FSI AT PLOT NO.534A, OLD DOOR NO -129, NEW DOOR No. 8, 17th STREET, L- BLOCK, ANNA NAGAR EAST, CHENNAI - 600 102. COMPRISED IN OLD S.No. 8 PART AND 29 PART, T.S.No.29/51, BLOCK No - 12 OF AYANAVARAM VILLAGE, GREATER CHENNAI CORPORATION. DIVISION No : 101 ZONE : 8

A) AREA STATEMENT	SQ.M.
AREA AS PER PATTA	464.50
AREA AS PER DOCUMENT	464.51
AREA CONSIDERED FOR FSI	464.50
STREET ALIGNMENT/ ROAD WIDENING/LINK ROAD	0.00
OSR AREA	0.00
TOTAL FSI AREA	1115.95
FSI FACTOR	2.402
COVERAGE AREA (PERCENTAGE %)	NA

A) PARKING STATEMENT		
VEHICLE	REQUIRED	PROVIDED
LORRY	-	0
CAR	10	11
TWO WHEELER	0	0
CYCLE	-	0

FLOOR WISE FSI STATEMENT: 1 (2)						
FLOORS	COMM.	RESI.	IND.	INST.	DU	TOTAL FSI AREA
STILT PARKING FLOOR	0.00	33.00	0.00	0.00	0	33.00
FIRST FLOOR	0.00	216.59	0.00	0.00	1	216.59
SECOND FLOOR	0.00	216.59	0.00	0.00	1	216.59
THIRD FLOOR	0.00	216.59	0.00	0.00	1	216.59
FOURTH FLOOR	0.00	216.59	0.00	0.00	1	216.59
FIFTH FLOOR	0.00	216.59	0.00	0.00	1	216.59
Terrace	0.00	0.00	0.00	0.00	0	0.00
<b>Total</b>	<b>0.00</b>	<b>1115.95</b>	<b>0.00</b>	<b>0.00</b>	<b>5</b>	<b>1115.95</b>

BUILDING WISE FSI STATEMENT							
BUILDING	NO OF SAME BUILDING	COMM.	RESI.	IND.	INST.	DU	TOTAL FSI AREA
1-1 (2)	1	0.00	1115.95	0.00	0.00	5	1115.95
<b>Total</b>	<b>1</b>	<b>0.00</b>	<b>1115.95</b>	<b>0.00</b>	<b>0.00</b>	<b>5</b>	<b>1115.95</b>

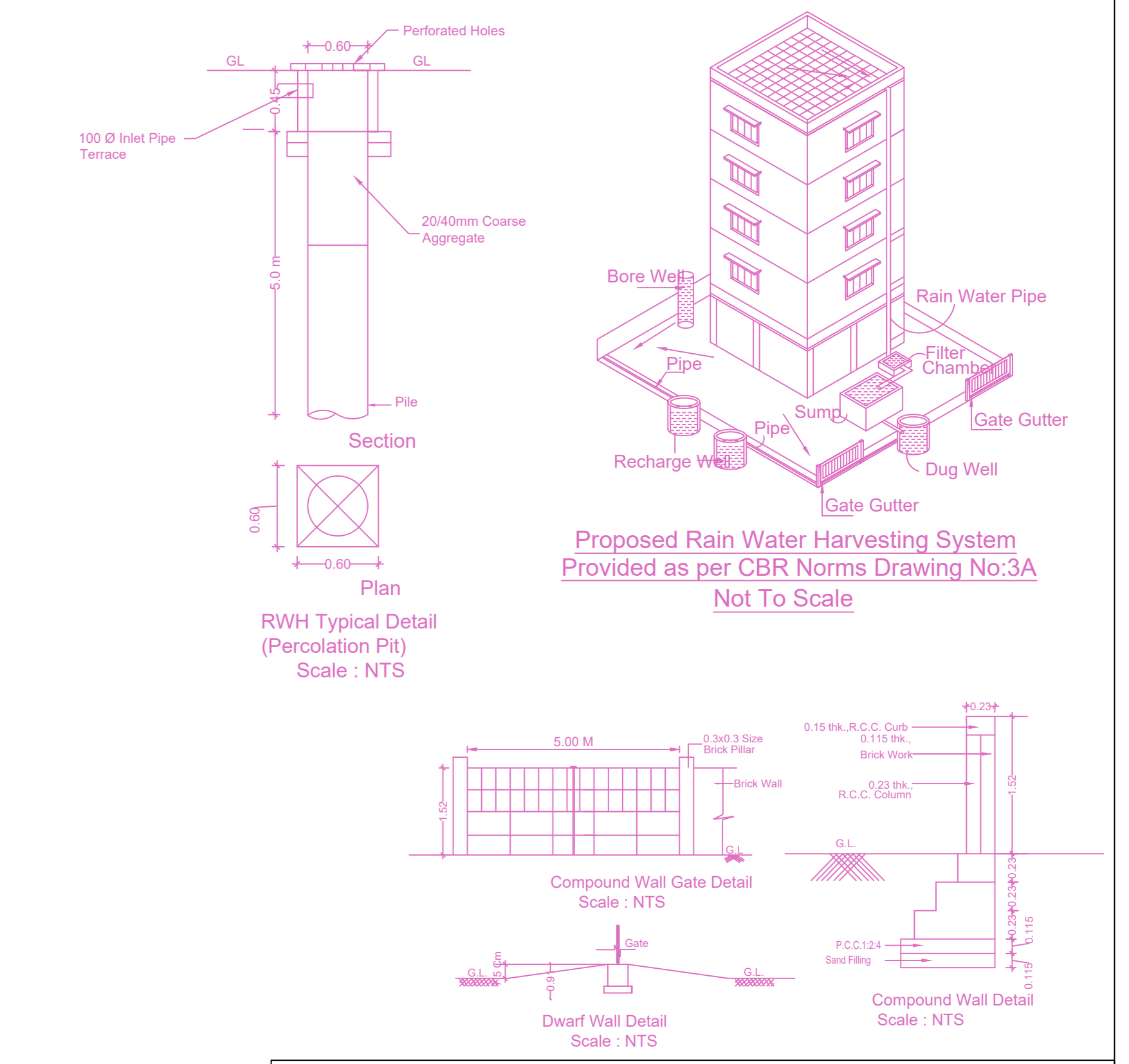
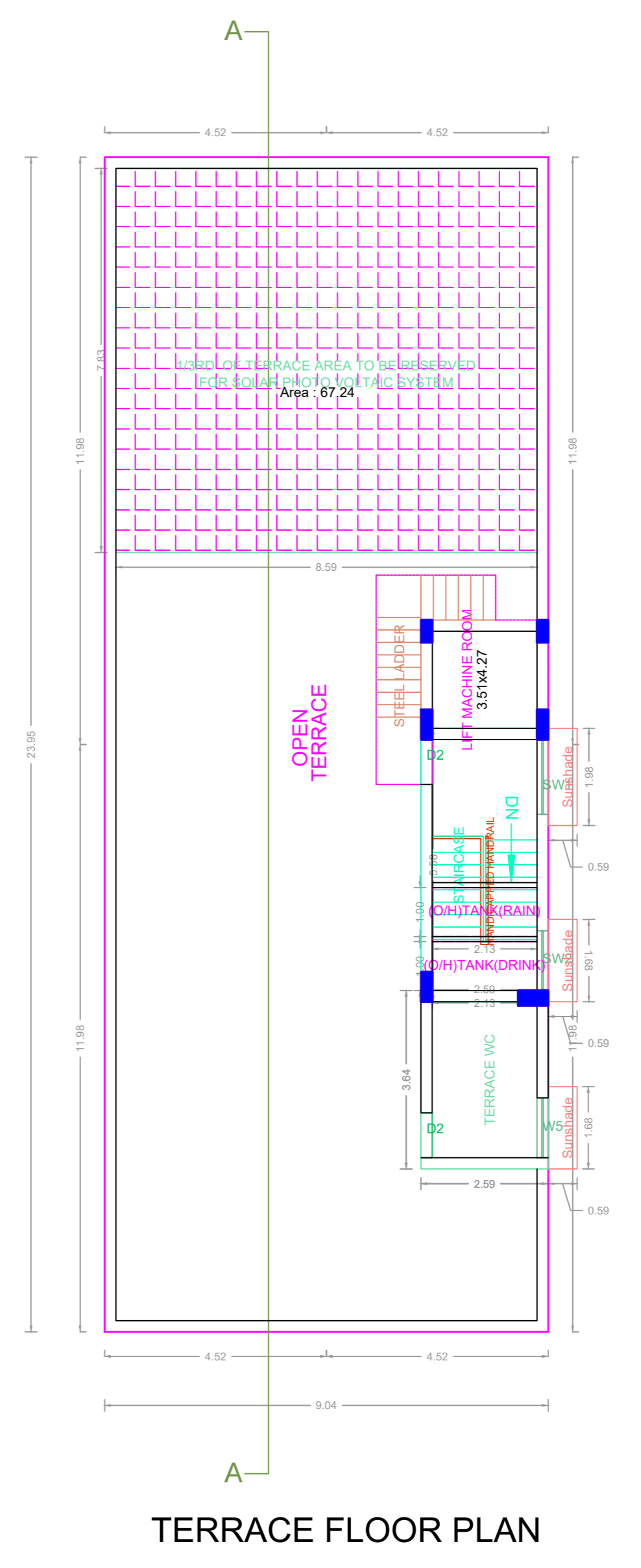
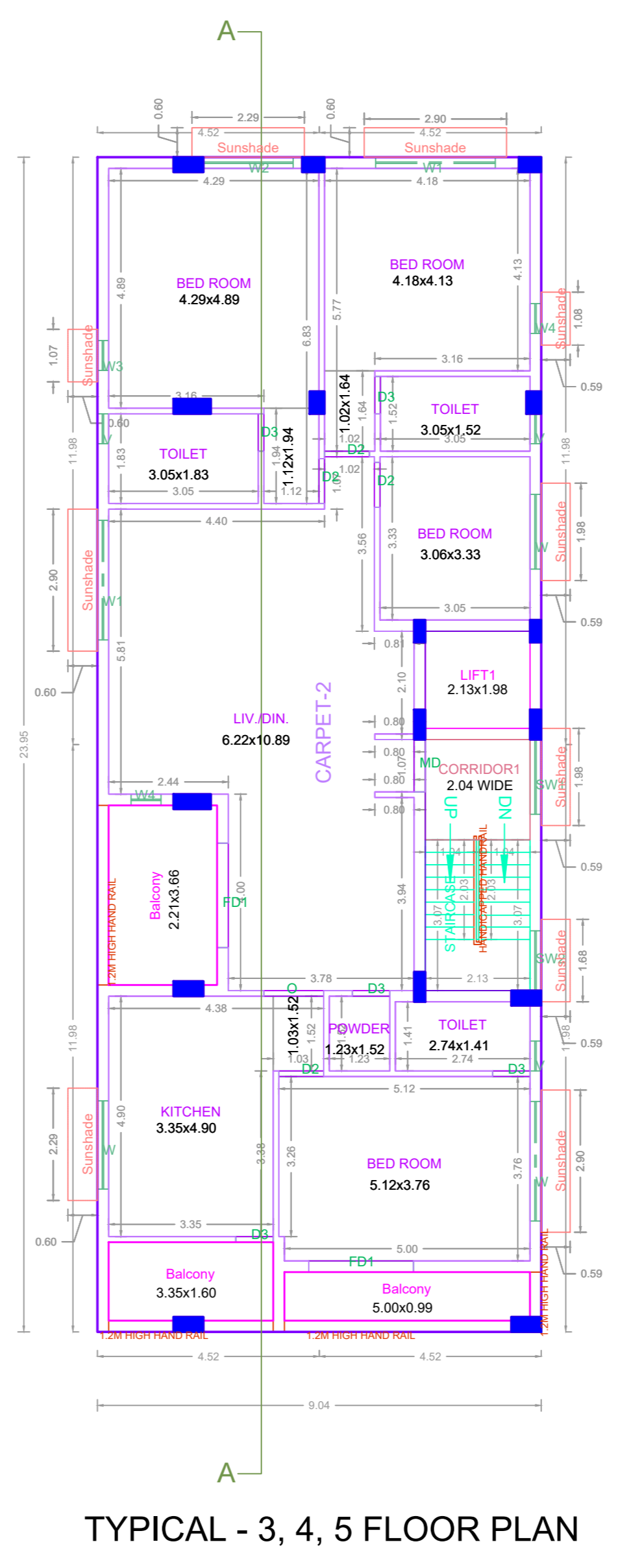
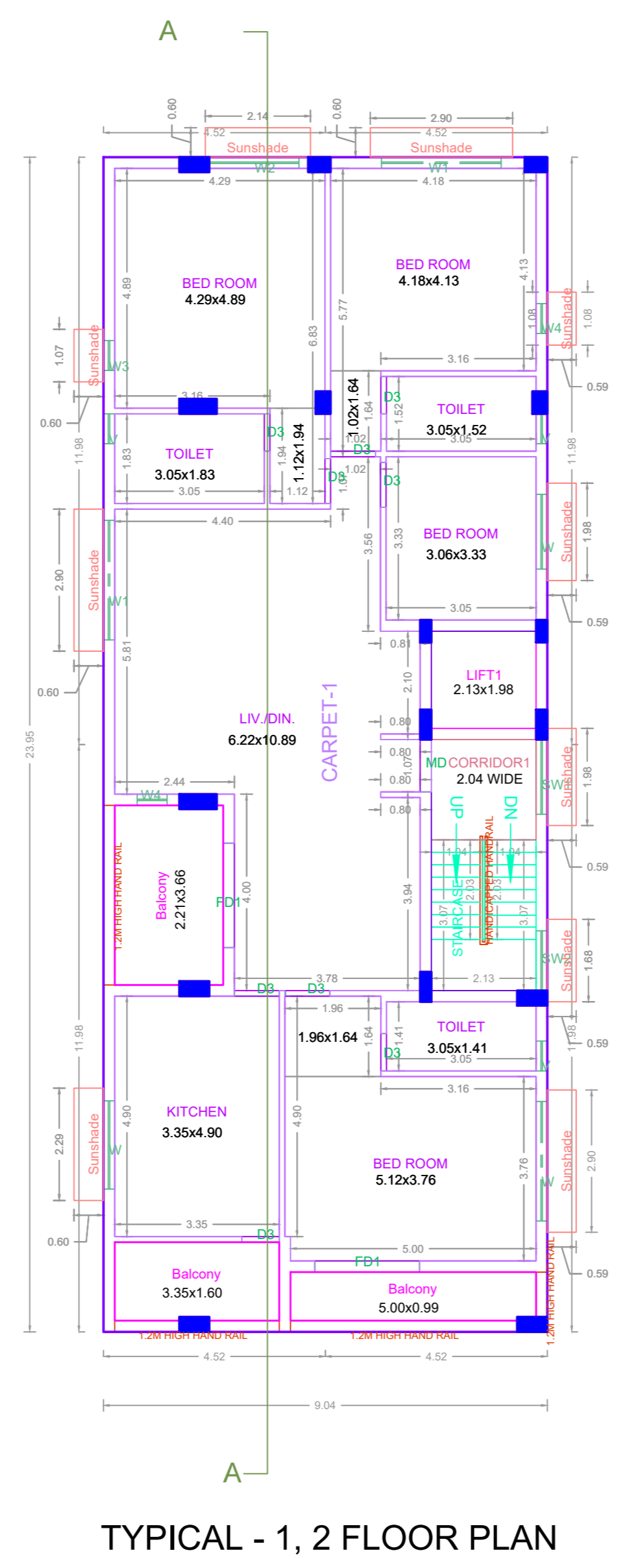
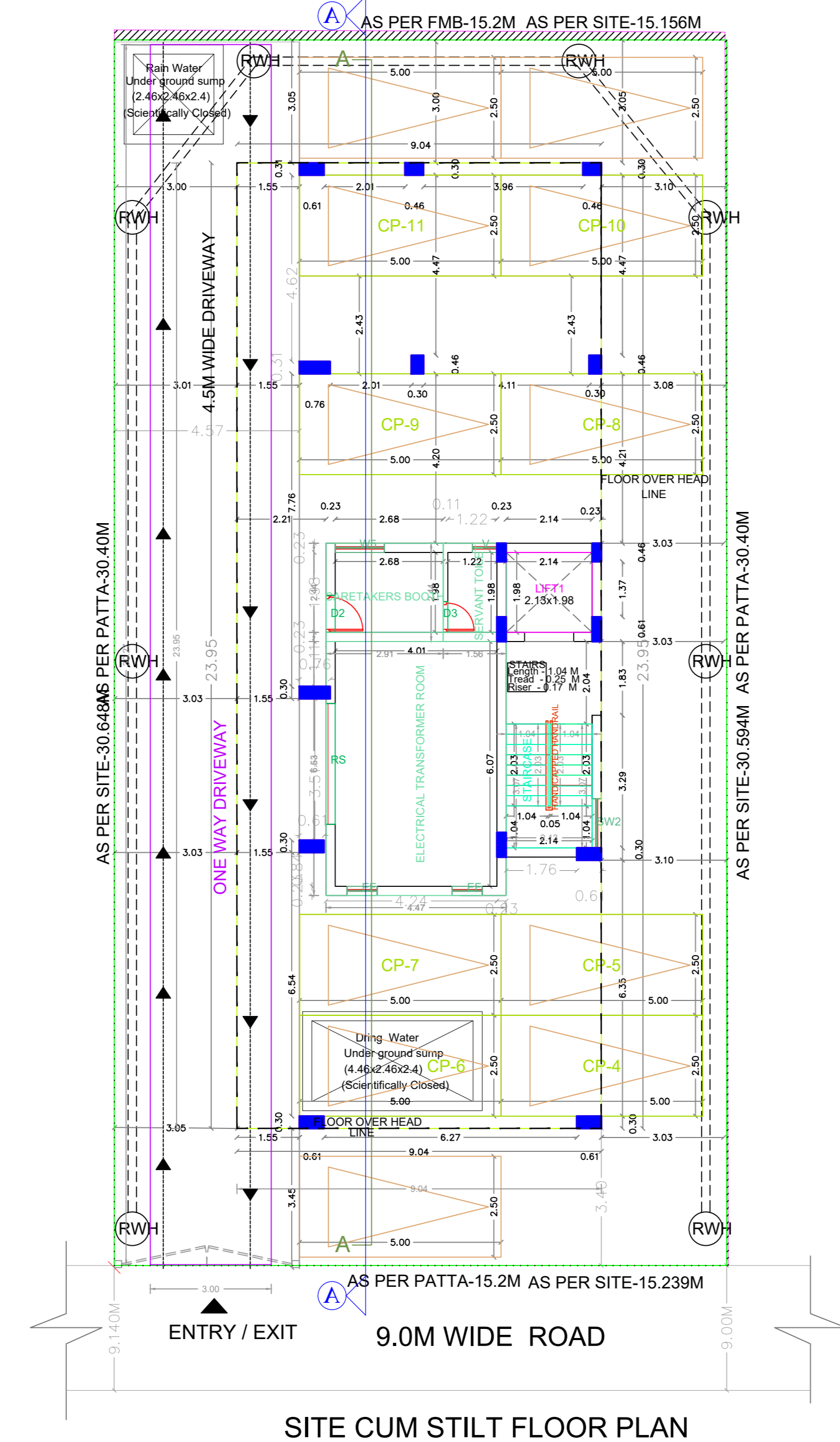
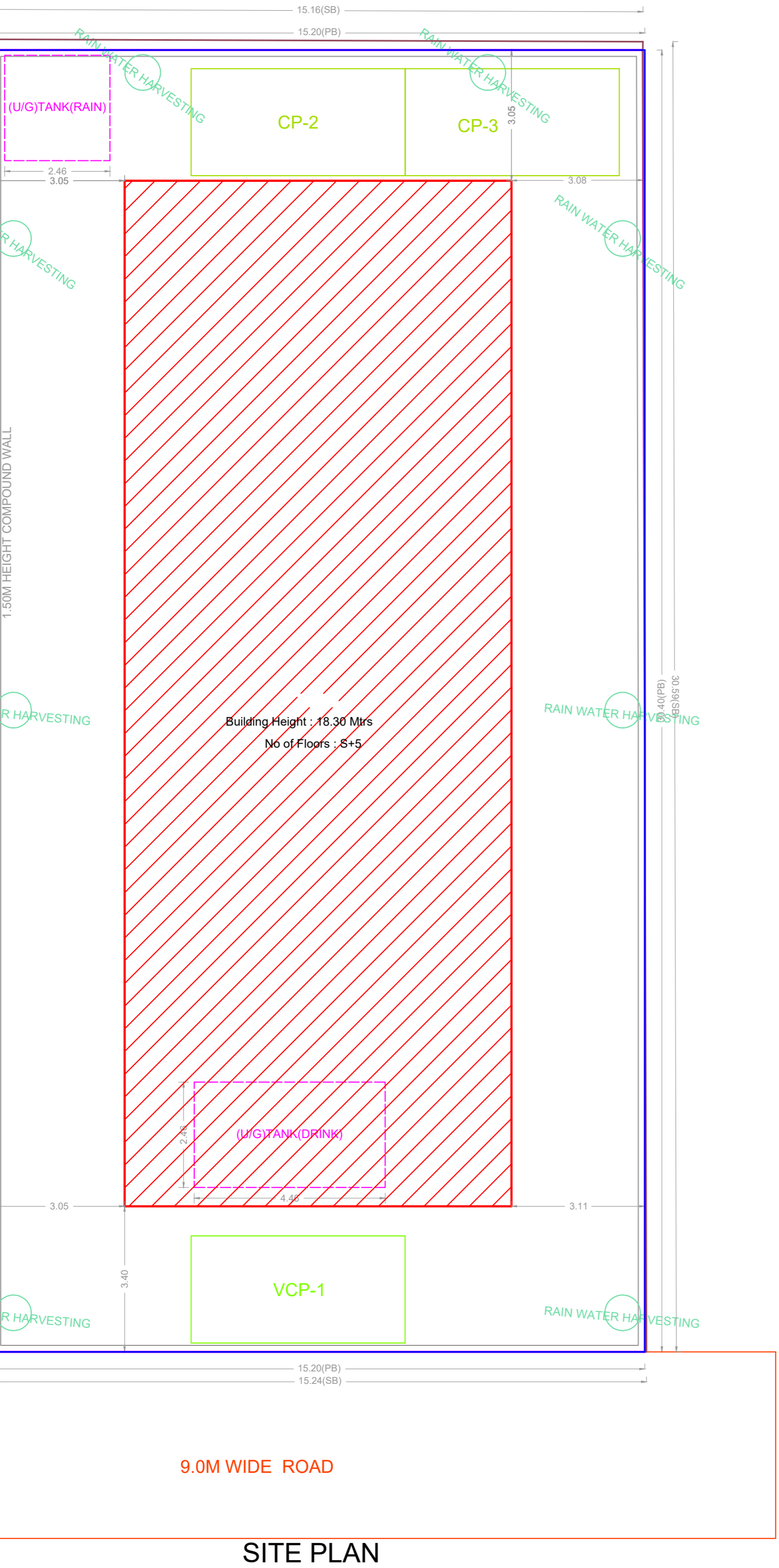

APPROVAL CONDITION

SCALE 1:100

CHENNAI METROPOLITAN DEVELOPMENT AUTHORITY  
APPROVED  
SUBJECT TO THE CONDITIONS MENTIONED IN THIS OFFICE

For (Deputy Planner / Chief Planner / Member-Secretary)  
High Rise Building / Non High Rise Building  
This Approval is valid only after building Permit is issued by the concerned Local Body.

KEY NO. 2688

QR CODE