

FRONT ELEVATION

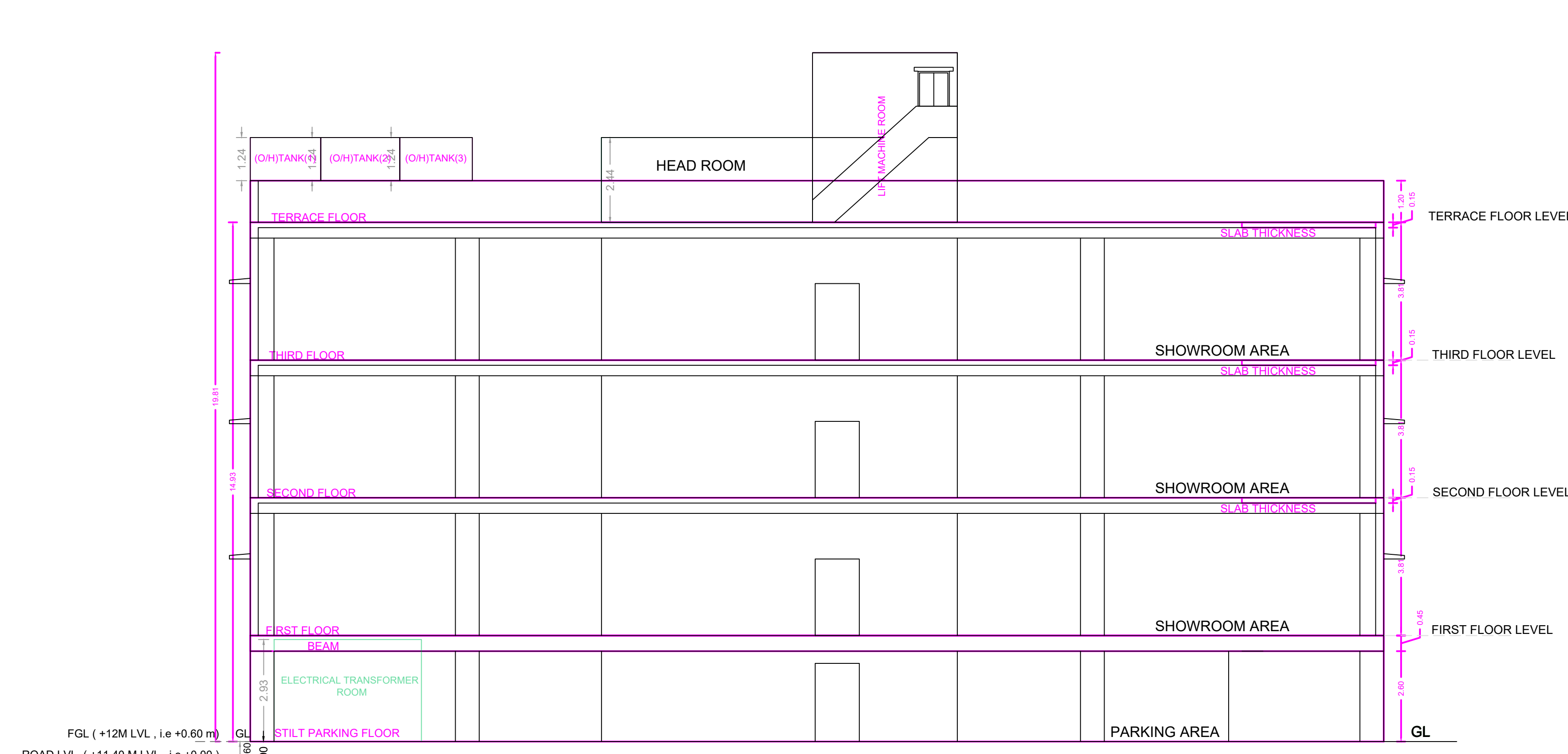

SECTION

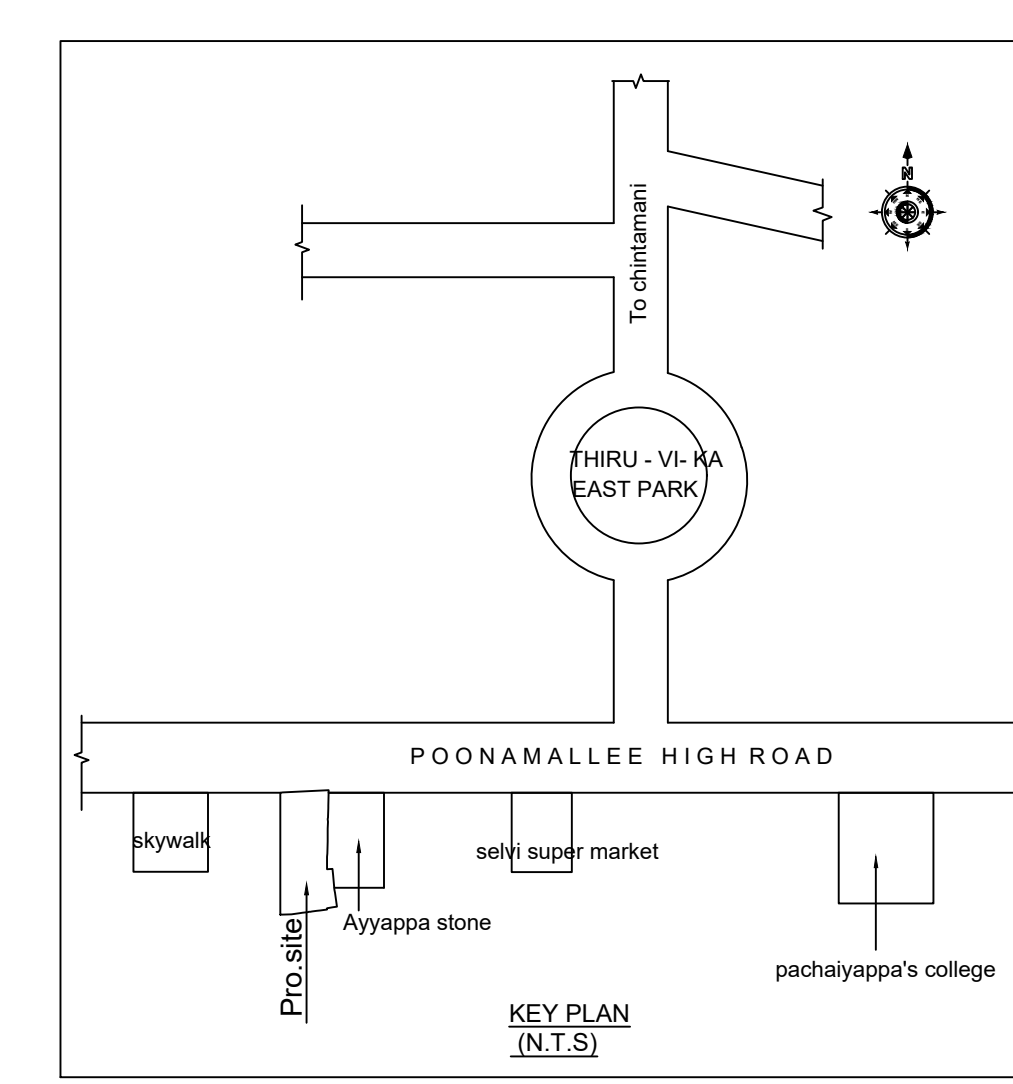
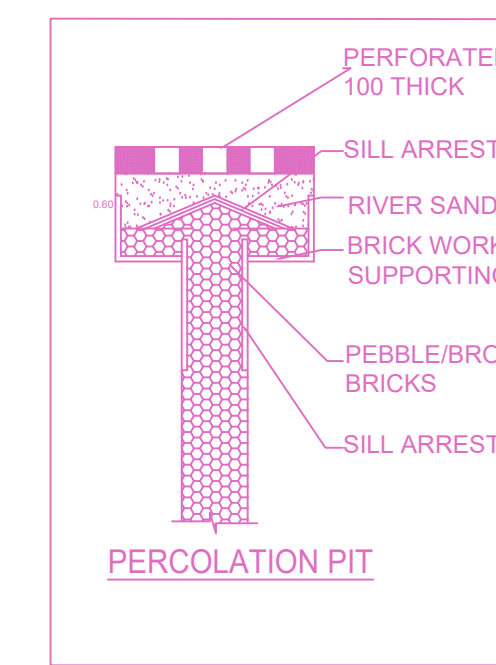
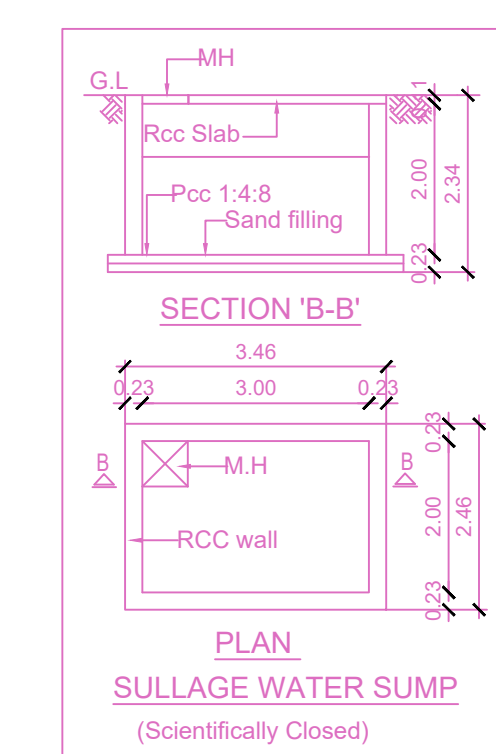

Location plan (Taken as per User Inputs)

**PLAN SHOWING THE PROPOSED CONSTRUCTION OF A STILT FLOOR (PARKING) + 3 FLOORS (OFFICE) COMMERCIAL BUILDING HEIGHT - 14.93M AVALING PREMIUM FSI WITH TOD BENEFIT AT OLD DOOR NO.336 TO 344, NEW DOOR NO.336, POONAMALLEE HIGH ROAD, AMINJIKARAI, CHENNAI - 600029. COMPRISED IN OLD S. NO.70/1 PART. T.S. NO. 2/8, BLOCK NO. 23, WARD - 1 OF AMINJIKARAI VILLAGE WITHIN THE LIMITS OF GREATER CHENNAI CORPORATION**

**BUILDING: A1 (A1)**

A) AREA STATEMENT	SQ.M.
AREA AS PER PATTA	714.00
AREA AS PER DOCUMENT	714.05
AREA CONSIDERED FOR FSI	714.00
STREET ALIGNMENT/ROAD WIDENING LINK ROAD	0.00
OSR AREA	0.00
TOTAL FSI AREA	1453.64
FSI FACTOR	2.036
COVERAGE AREA (PERCENTAGE %)	NA

A) PARKING STATEMENT	REQUIRED	PROVIDED
VEHICLE	-	0
LORRY	-	0
CAR	12	12
TWO WHEELER	47	51
CYCLE	-	0

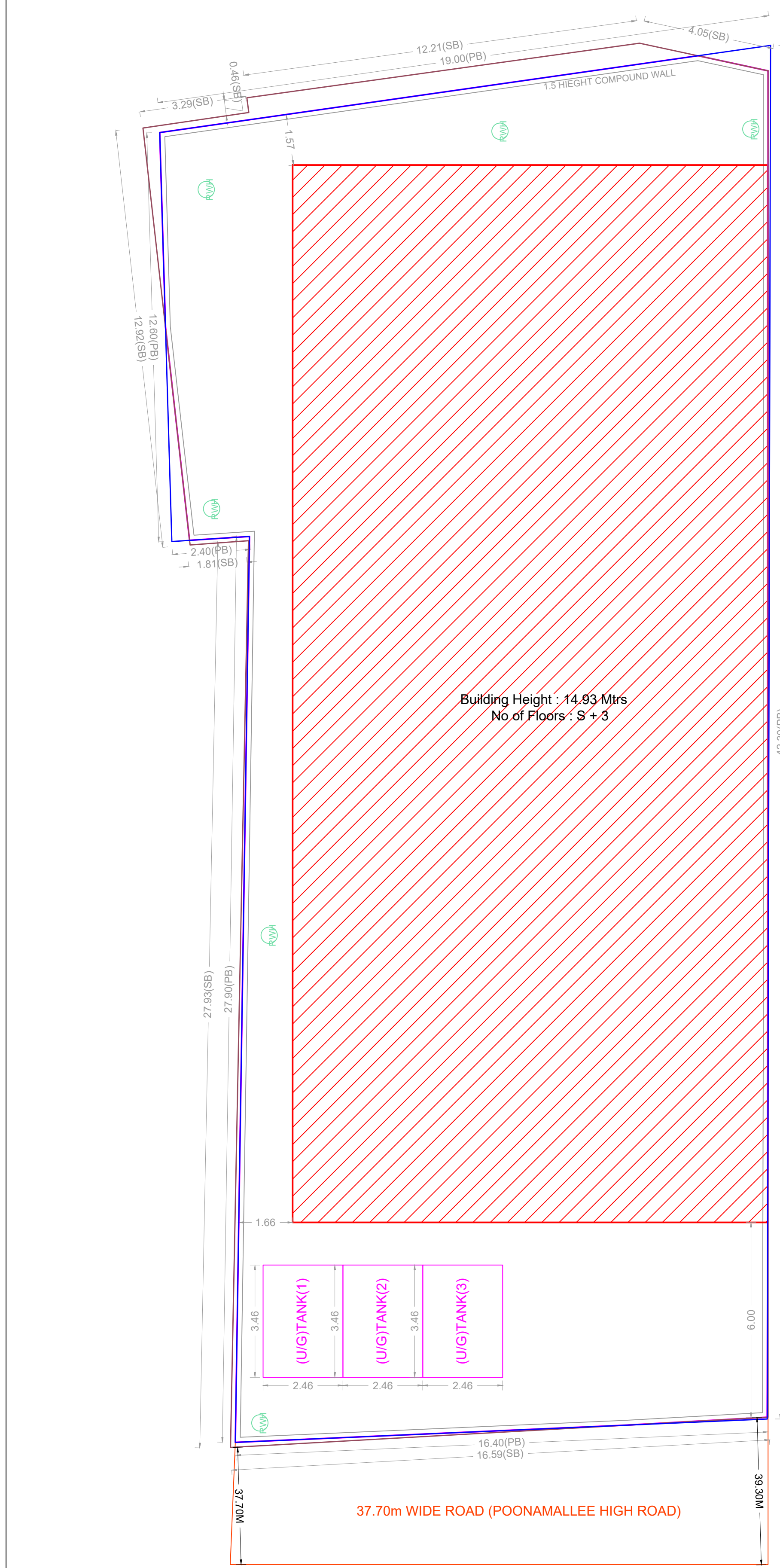

SITE PLAN

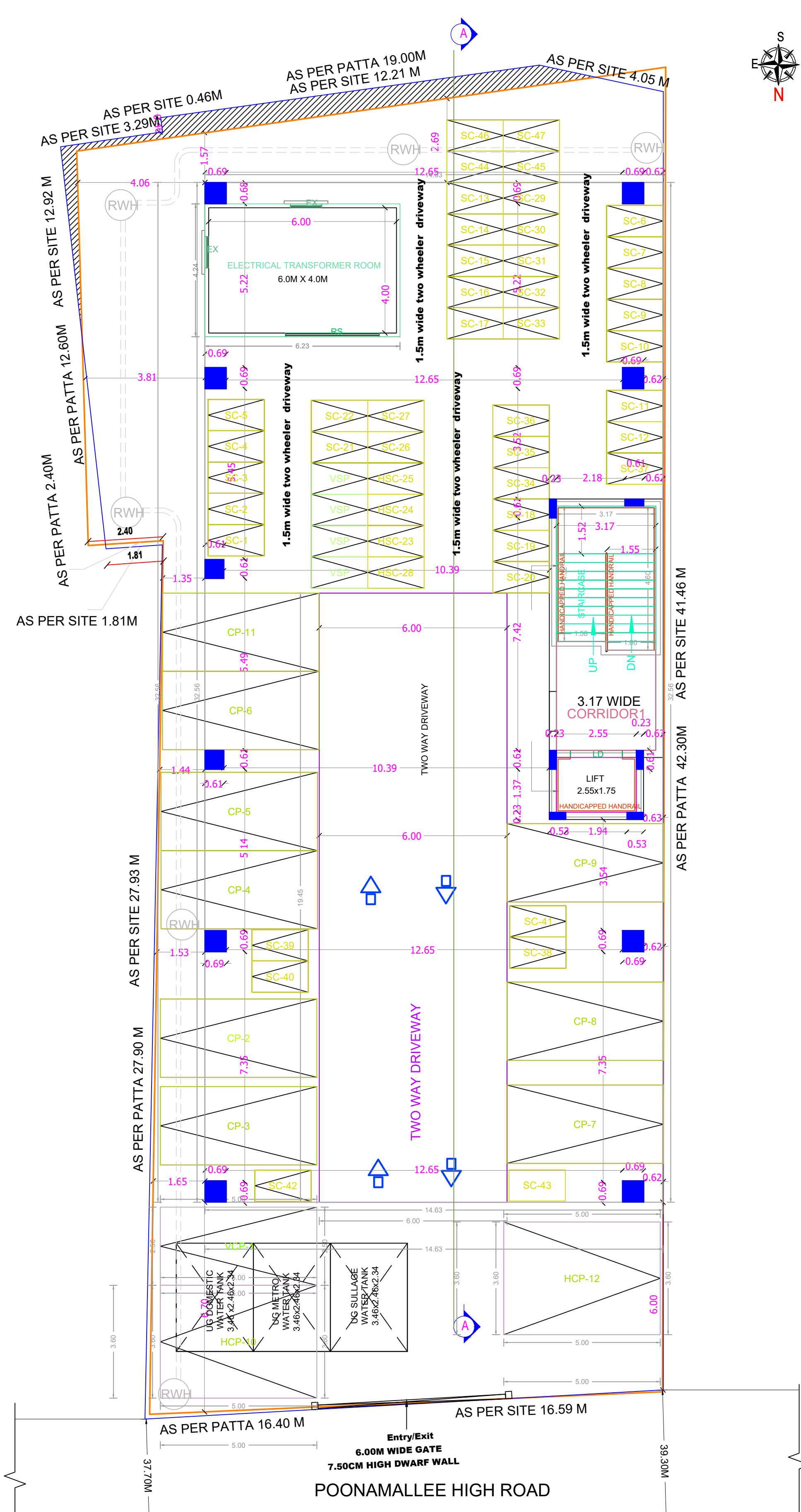

SITE CUM STILT PARKING FLOOR PLAN

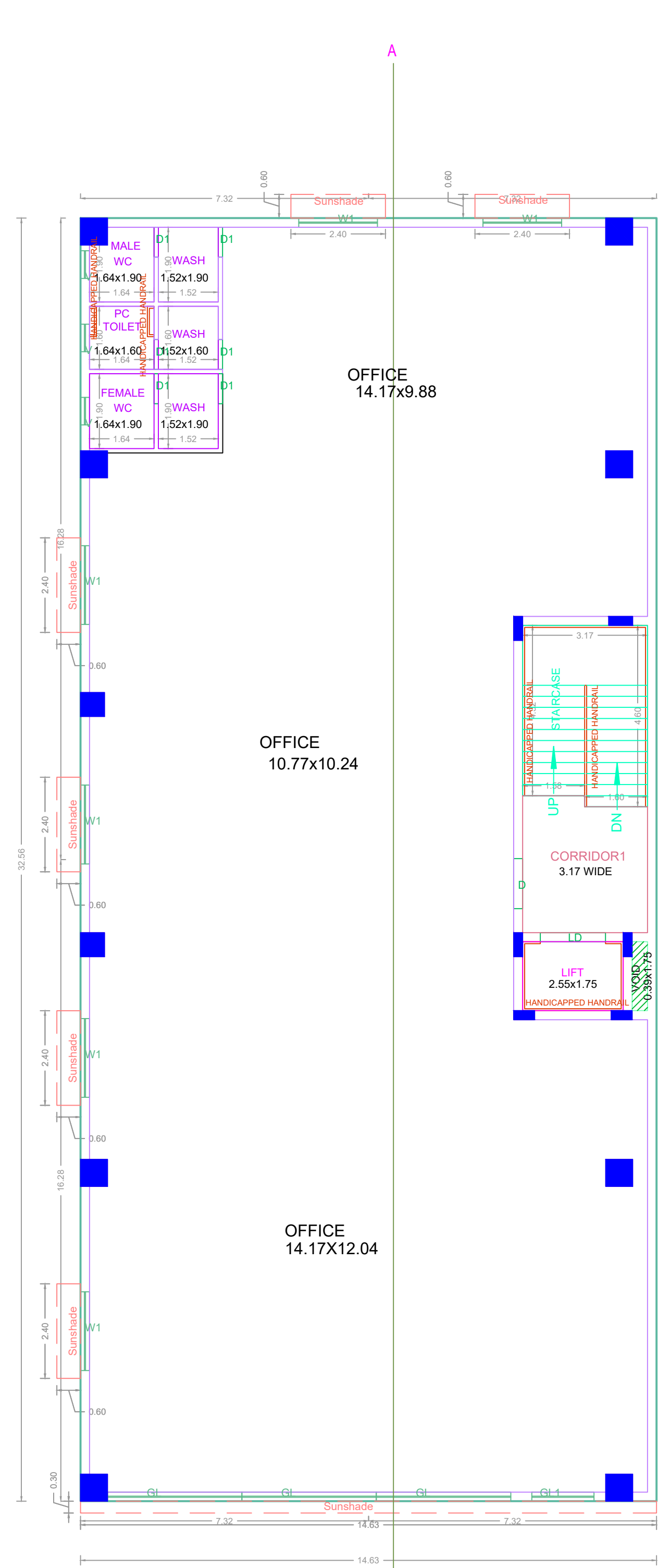

TYPICAL - 1-3 FLOOR PLAN

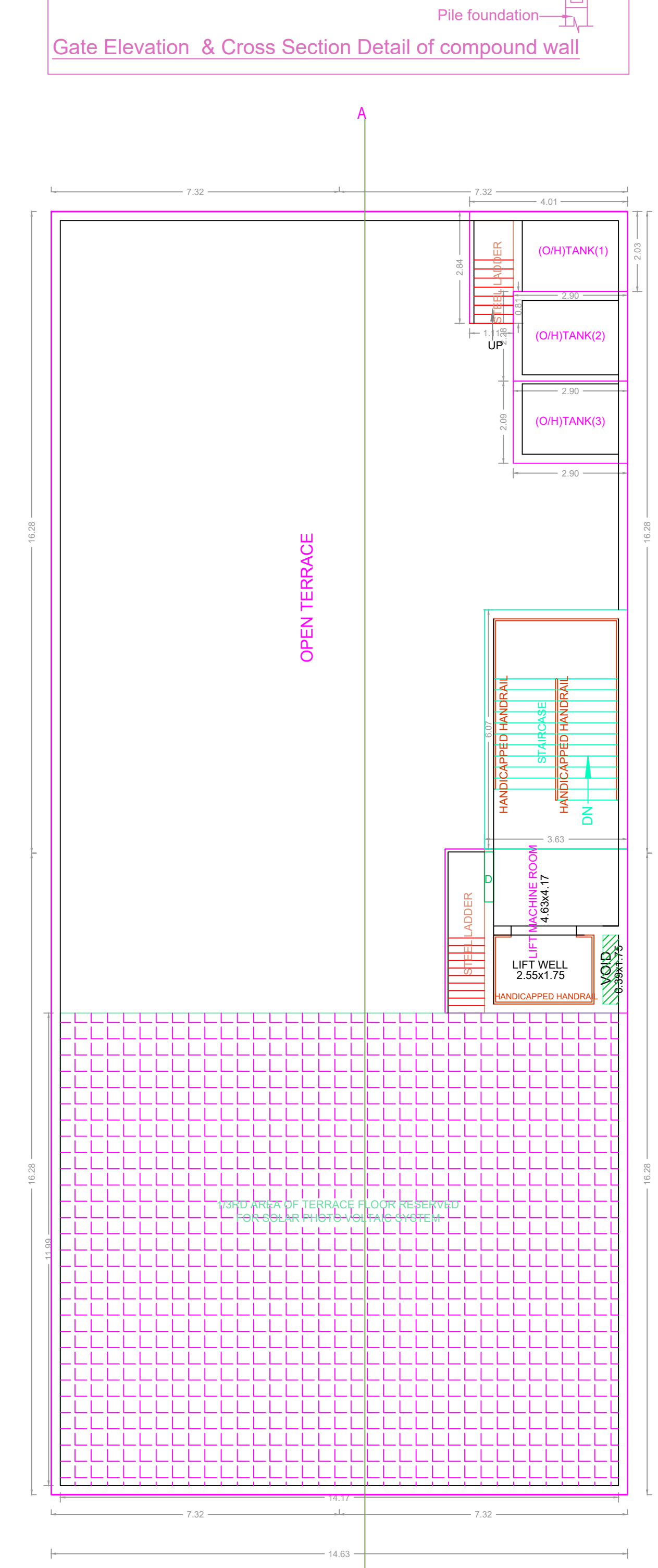

TERRACE FLOOR PLAN

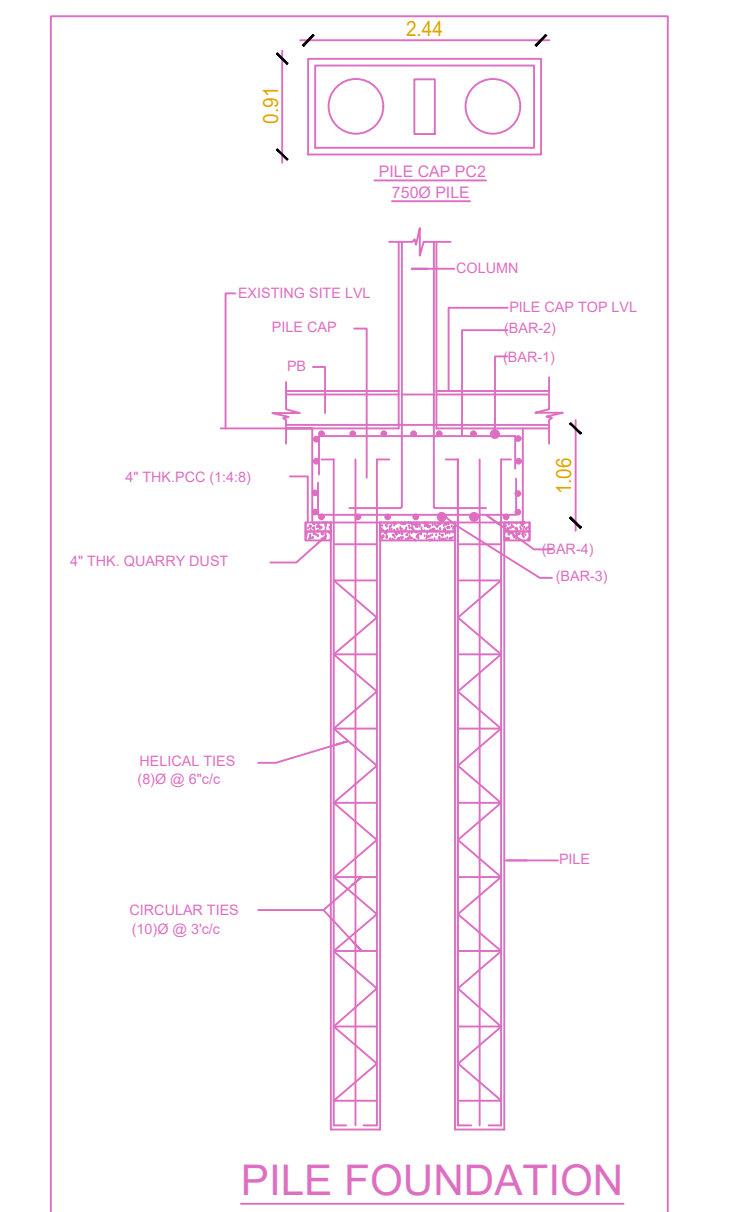
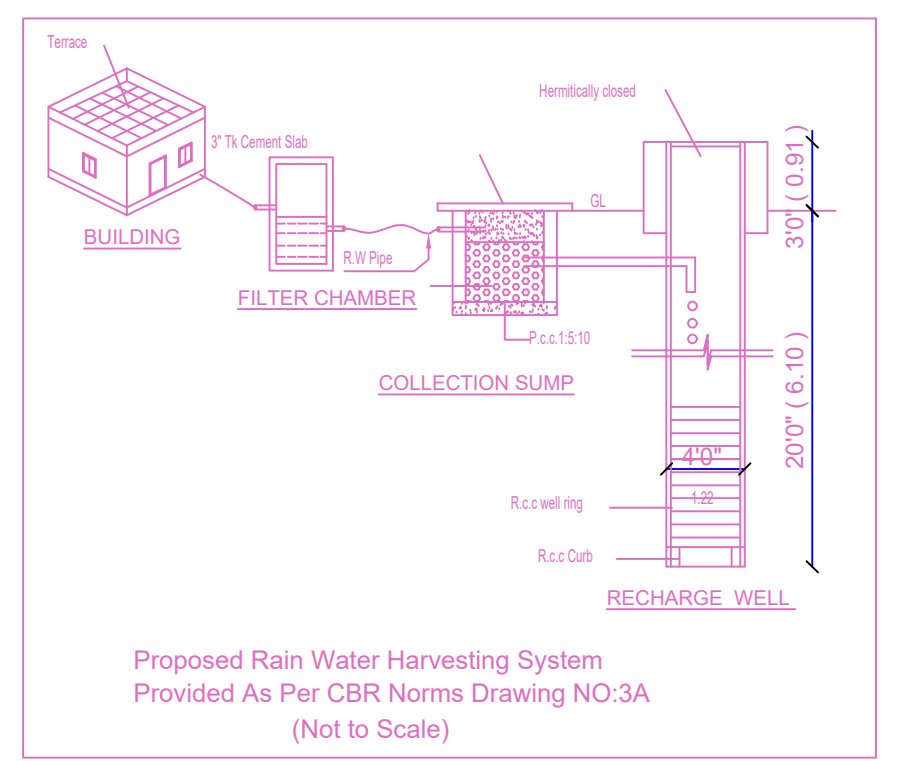
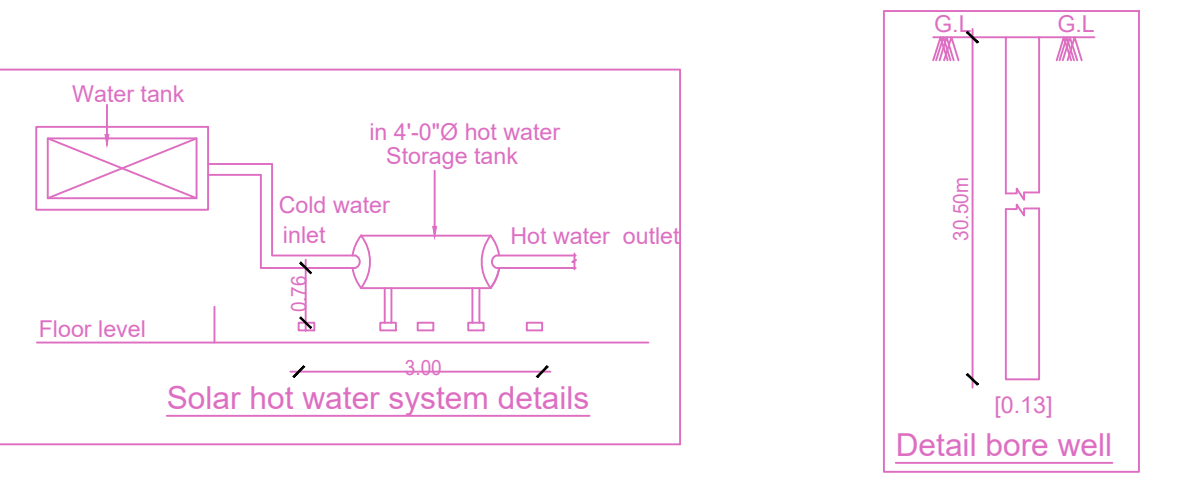
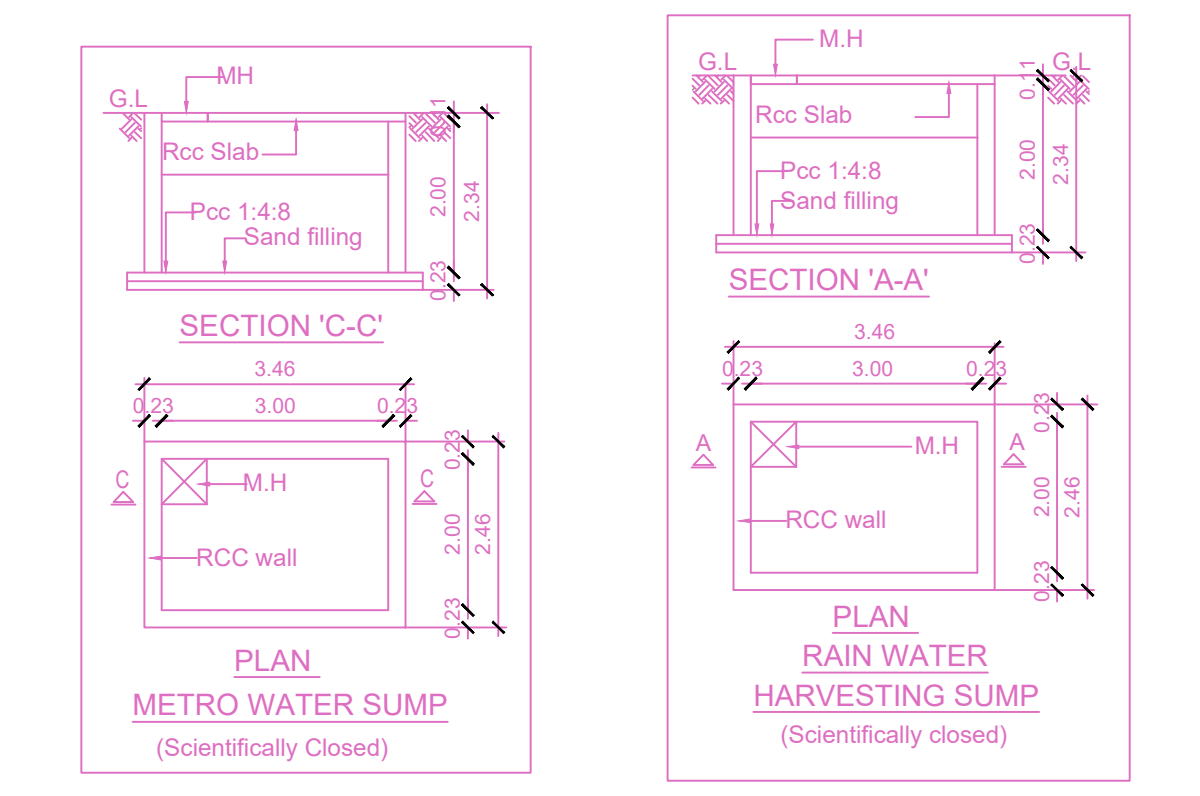
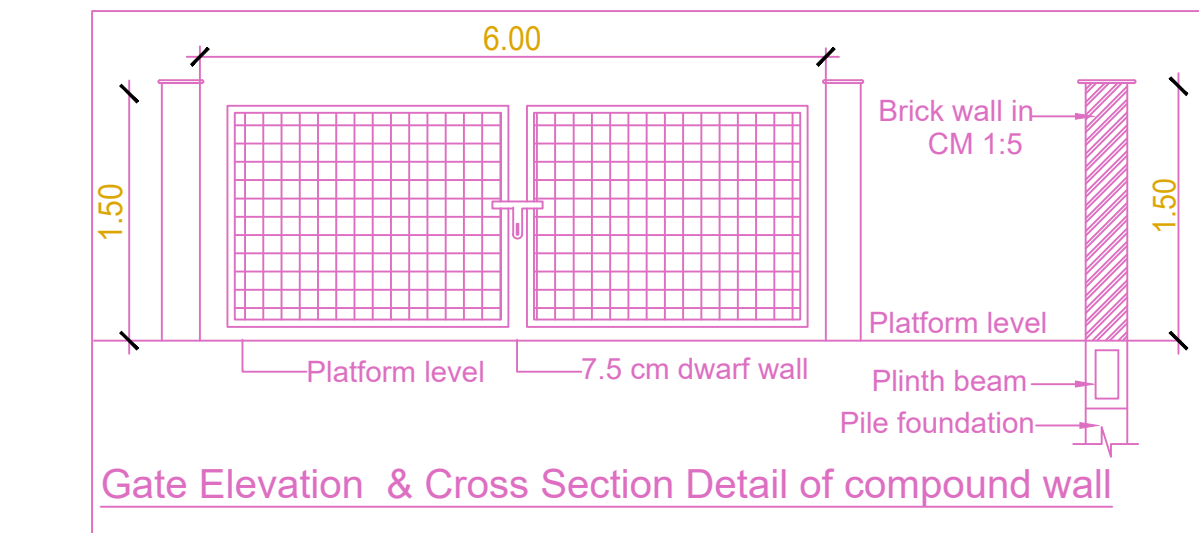

**BUILDING WISE FSI STATEMENT**

BUILDING	NO OF SAME BUILDING	FSI AREA				DU	TOTAL
		COMM.	RESI.	IND.	INST.		FSI AREA
A1-1 (A1)	1	1453.64	0.00	0.00	0.00	0	1453.64
Total	1	1453.64	0.00	0.00	0.00	0	1453.64

**FLOOR WISE FSI STATEMENT-A1 (A1)**

FLOORS	COMM.	RESI.	IND.	INST.	DU	TOTAL
STILT PARKING FLOOR	26.42	0.00	0.00	0.00	0	26.42
FIRST FLOOR	475.74	0.00	0.00	0.00	0	475.74
SECOND FLOOR	475.74	0.00	0.00	0.00	0	475.74
THIRD FLOOR	475.74	0.00	0.00	0.00	0	475.74
Terrace	0.00	0.00	0.00	0.00	0	0.00
Total	1453.64	0.00	0.00	0.00	0	1453.64

**APPROVAL CONDITION**

SCALE: 1:100

**CHENNAI METROPOLITAN DEVELOPMENT AUTHORITY**

**APPROVED**

SUBJECT TO THE CONDITIONS MENTIONED IN THIS OFFICE