

PLAN SHOWING THE PROPOSED CONSTRUCTION OF STILT FLOOR + 5 FLOORS (HEIGHT - 18.0M) RESIDENTIAL BUILDING WITH 15 DWELLING UNITS AVAILING AFFORDABLE HOUSING BENEFIT AT PERUMBAKKAM, CHENNAI COMPRISED IN S.NO.344/2PART (DOCUMENT), S.NOS.344/2A, 344/2B (PATTA) OF PERUMBAKKAM VILLAGE WITHIN THE LIMITS OF ST.THOMAS MOUNT PANCHAYAT UNION.

A) AREA STATEMENT		SQ.M.
AREA AS PER PATTA		650.00
AREA AS PER DOCUMENT		648.08
AREA CONSIDERED FOR FSI		648.08
STREET ALIGNMENT/ ROAD WIDENING/LINK ROAD		0.00
OSR AREA		0.00
TOTAL FSI AREA		1653.56
FSI FACTOR		2.551
COVERAGE AREA (PERCENTAGE %)		NA

A) PARKING STATEMENT		
VEHICLE	REQUIRED	PROVIDED
LORRY	-	0
CAR	9	12
TWO WHEELER	17	20
CYCLE	-	0

FLOOR WISE FSI STATEMENT:A (NHRB RESI)						
FLOORS	FSI AREA				DU	TOTAL FSI AREA
	COMM.	RESI.	IND.	INST.		
STILT PARKING FLOOR	0.00	28.81	0.00	0.00	0	28.81
FIRST FLOOR	0.00	324.95	0.00	0.00	3	324.95
SECOND FLOOR	0.00	324.95	0.00	0.00	3	324.95
THIRD FLOOR	0.00	324.95	0.00	0.00	3	324.95
FOURTH FLOOR	0.00	324.95	0.00	0.00	3	324.95
FIFTH FLOOR	0.00	324.95	0.00	0.00	3	324.95
Terrace	0.00	0.00	0.00	0.00	0	0.00
Total	0.00	1653.56	0.00	0.00	15	1653.56

BUILDING WISE FSI STATEMENT						
BUILDING	NO OF SAME BUILDING	FSI AREA			DU	TOTAL FSI AREA
		COMM.	RESI.	IND.		
A1 (NHRB RESI)	0.00	1653.56	0.00	0.00	15	1653.56
Total	0.00	1653.56	0.00	0.00	15	1653.56

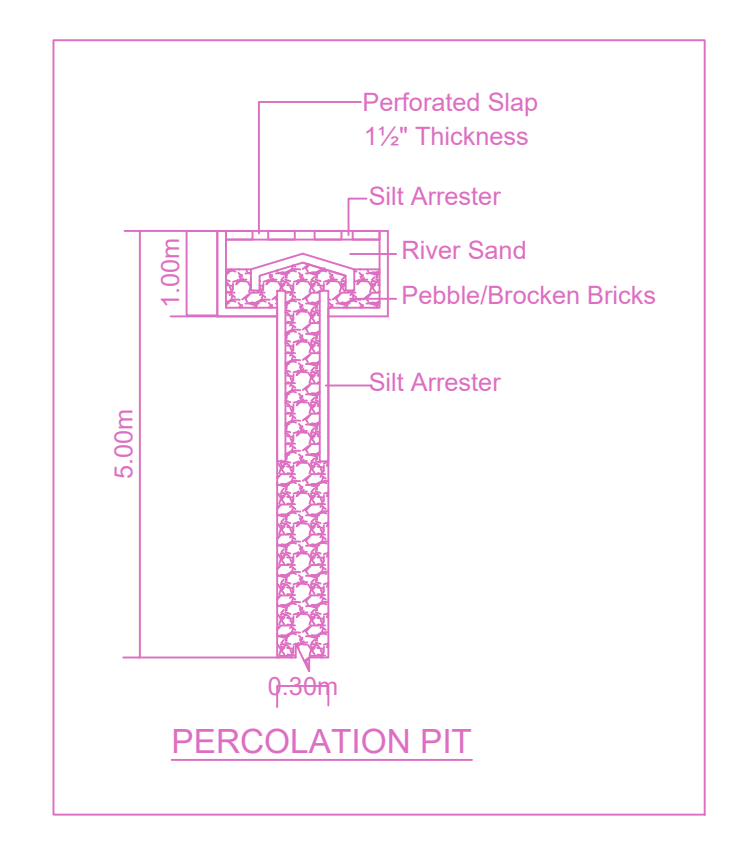
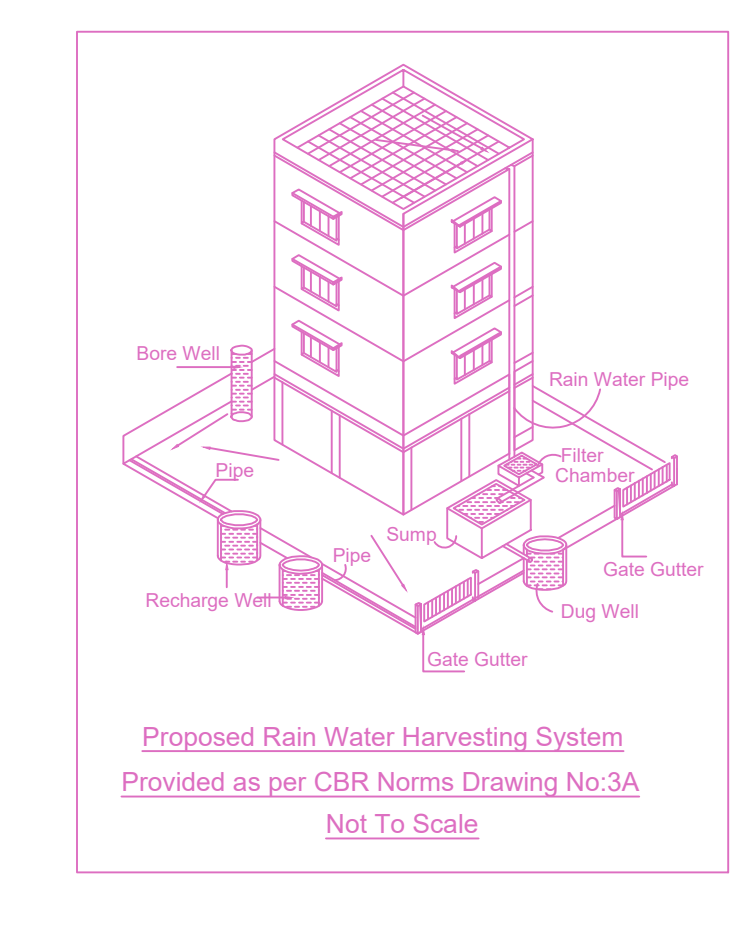
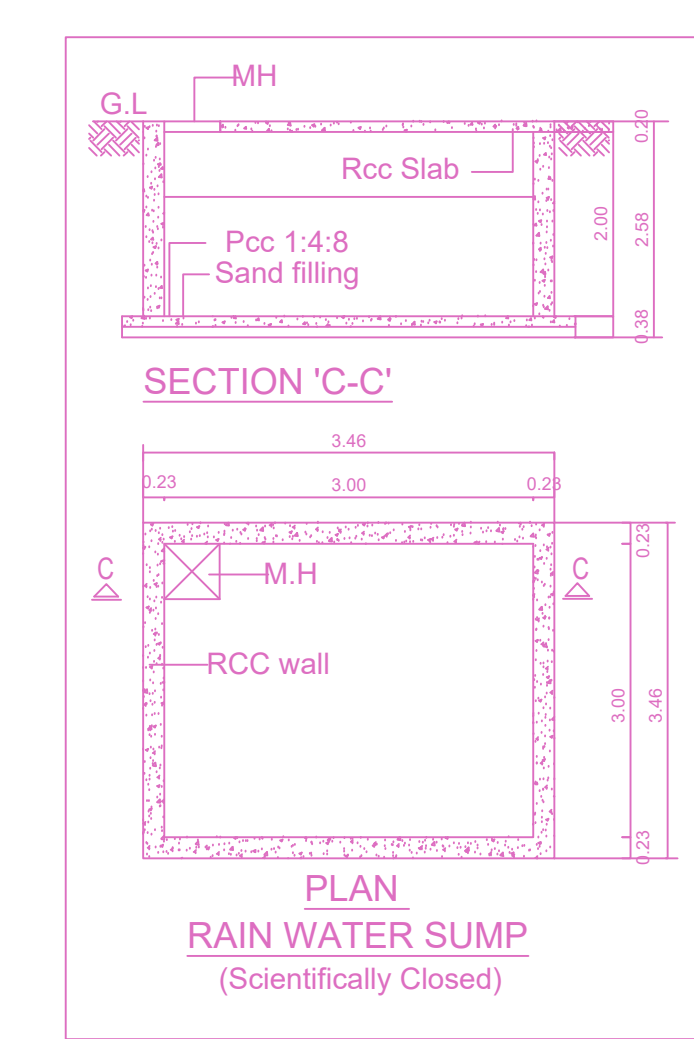
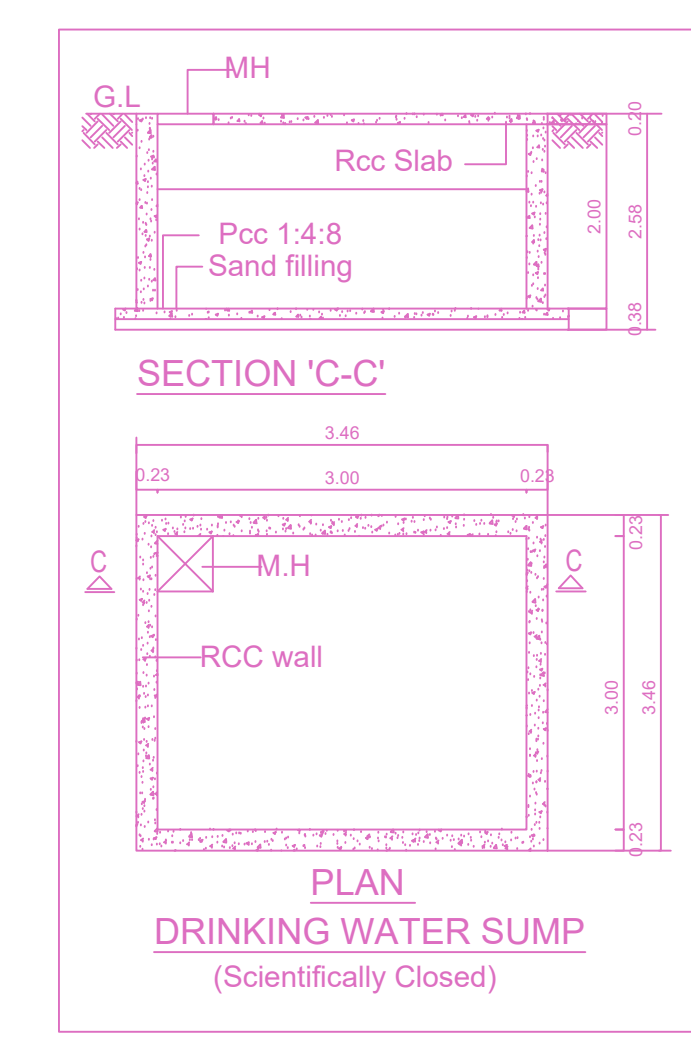
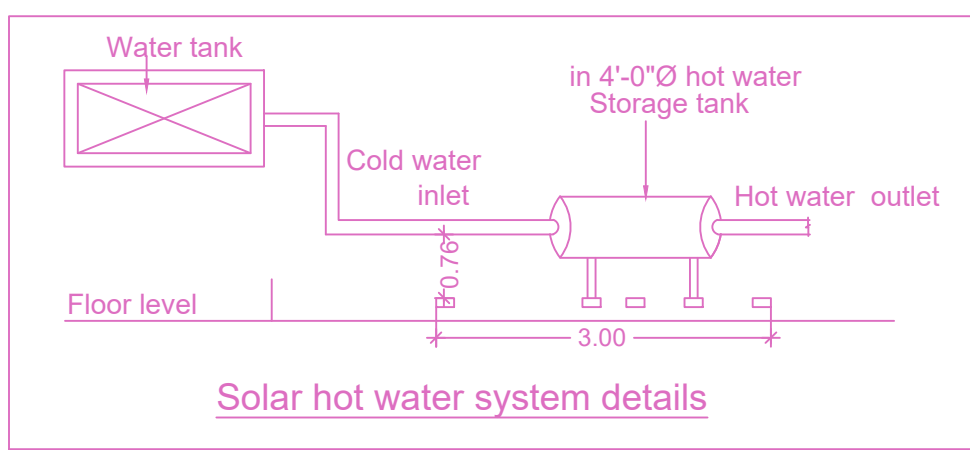
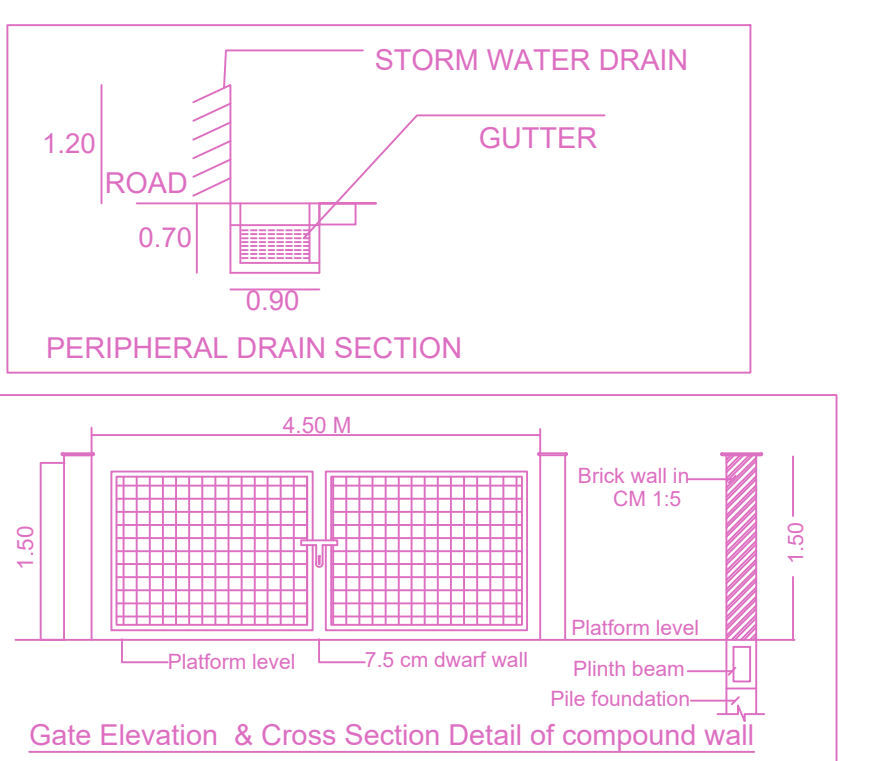
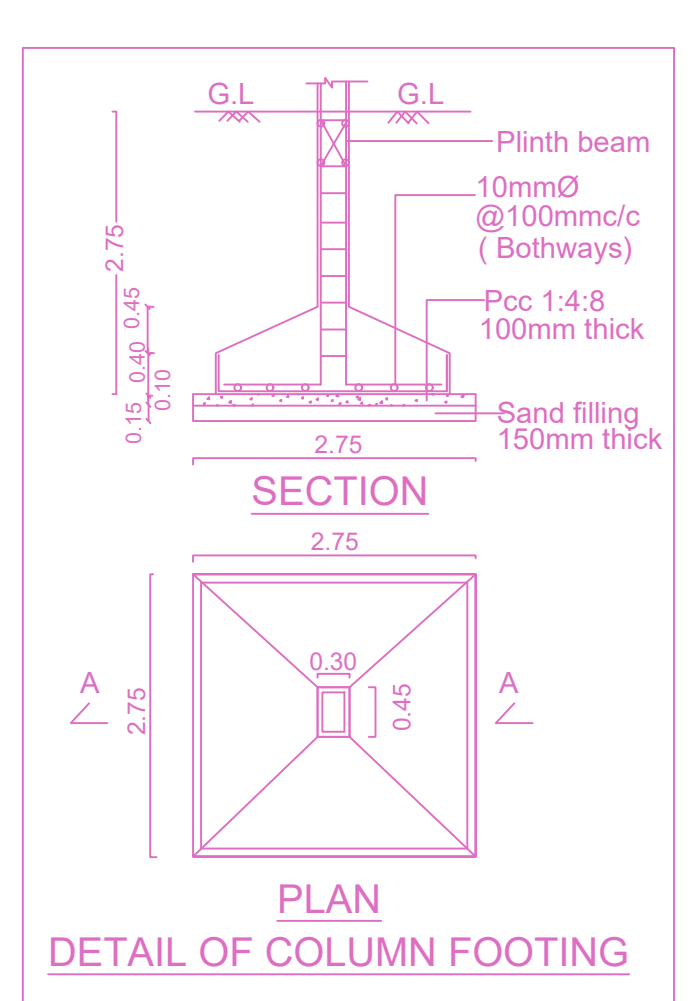
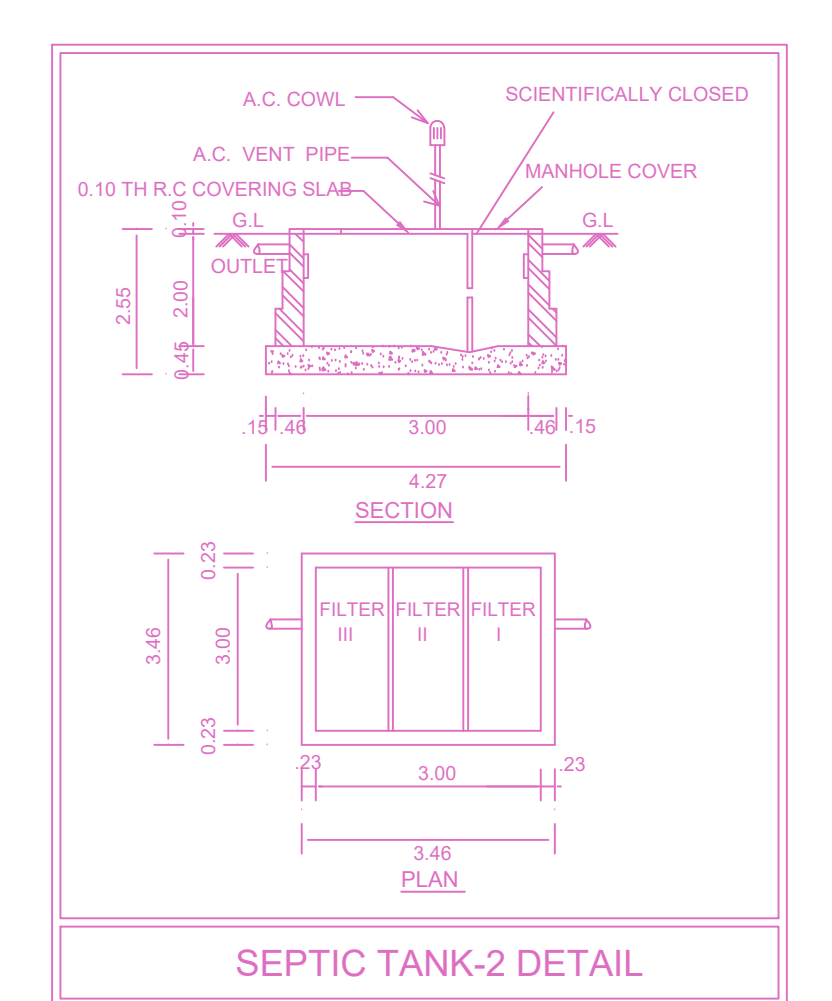
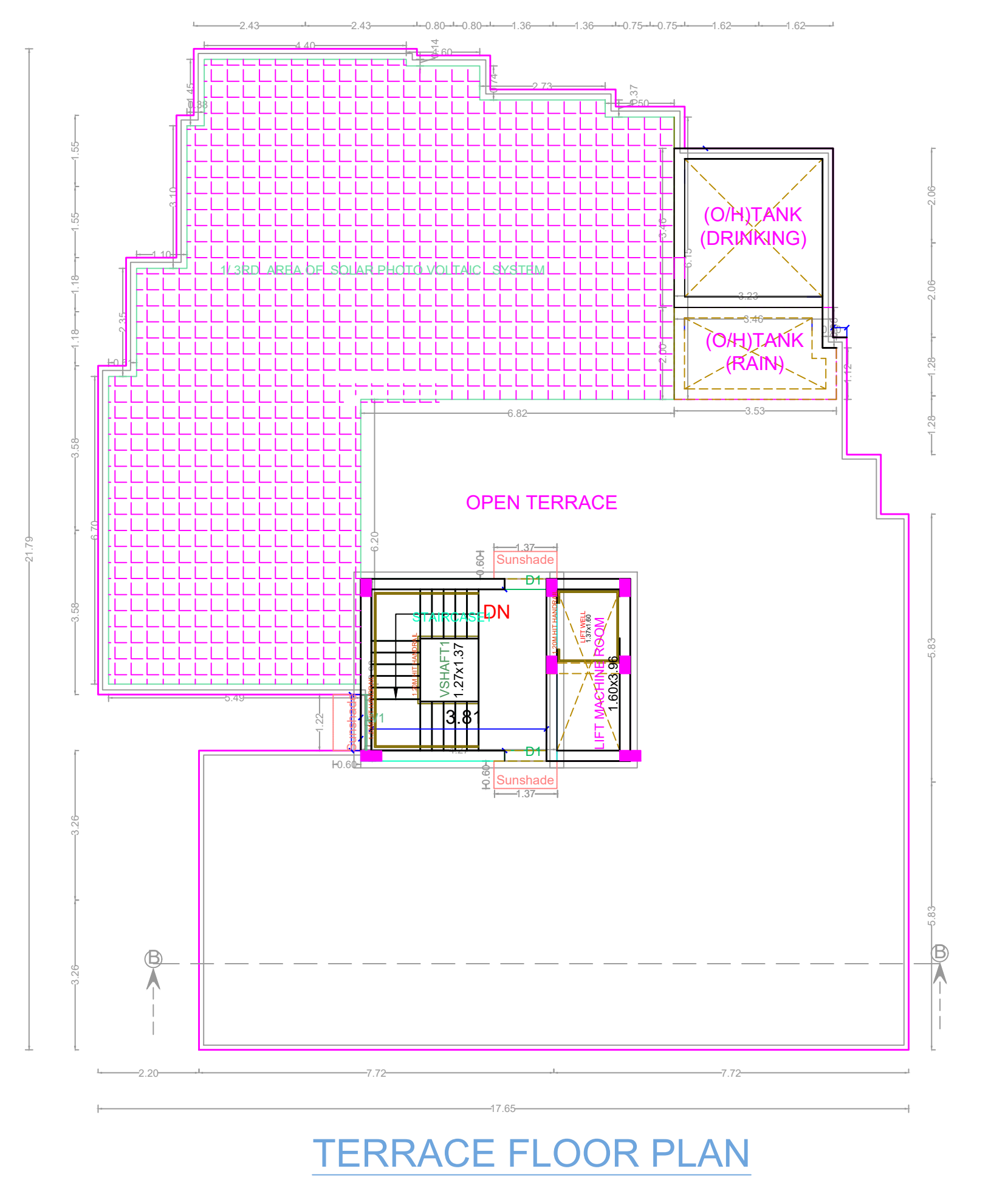
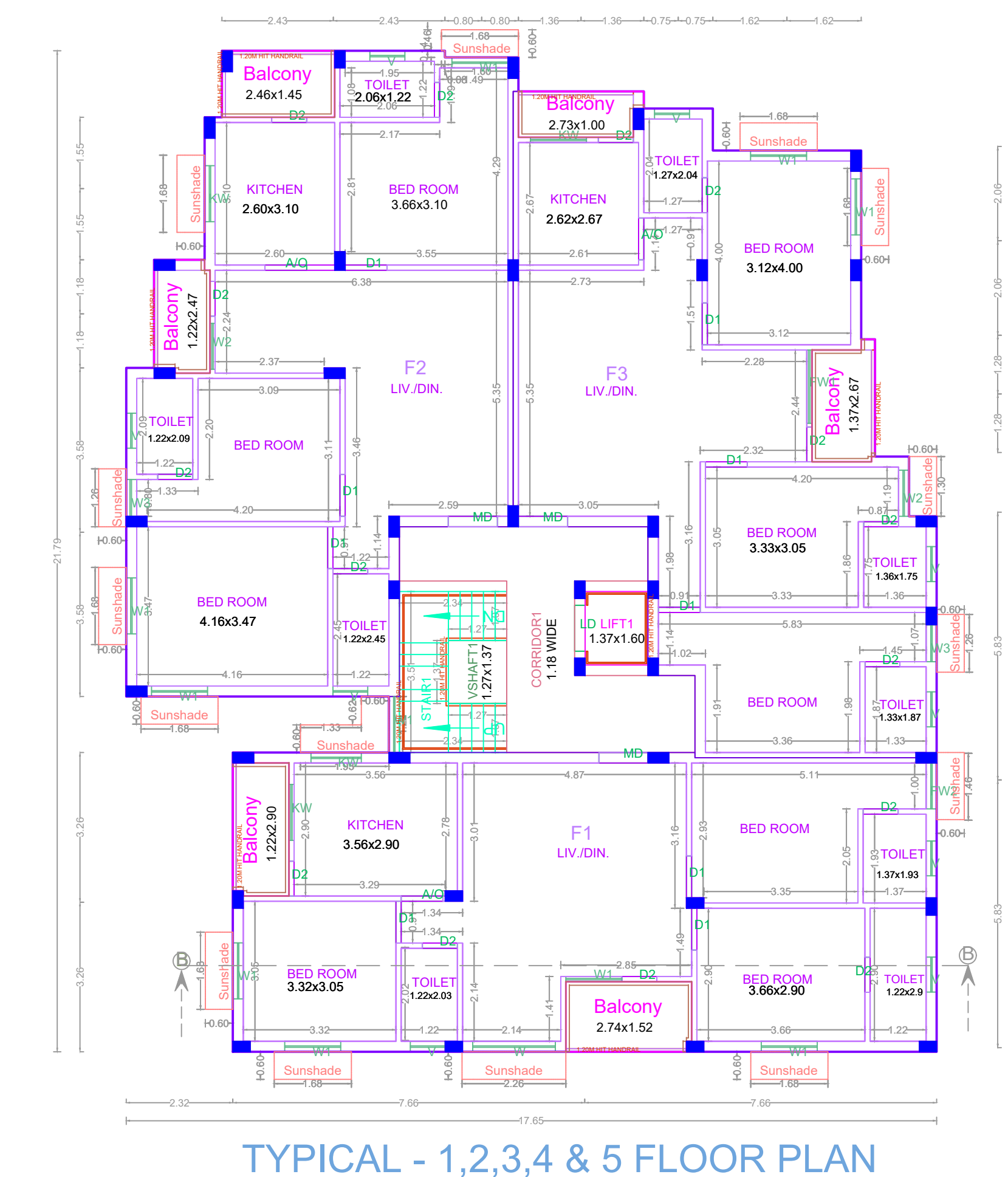
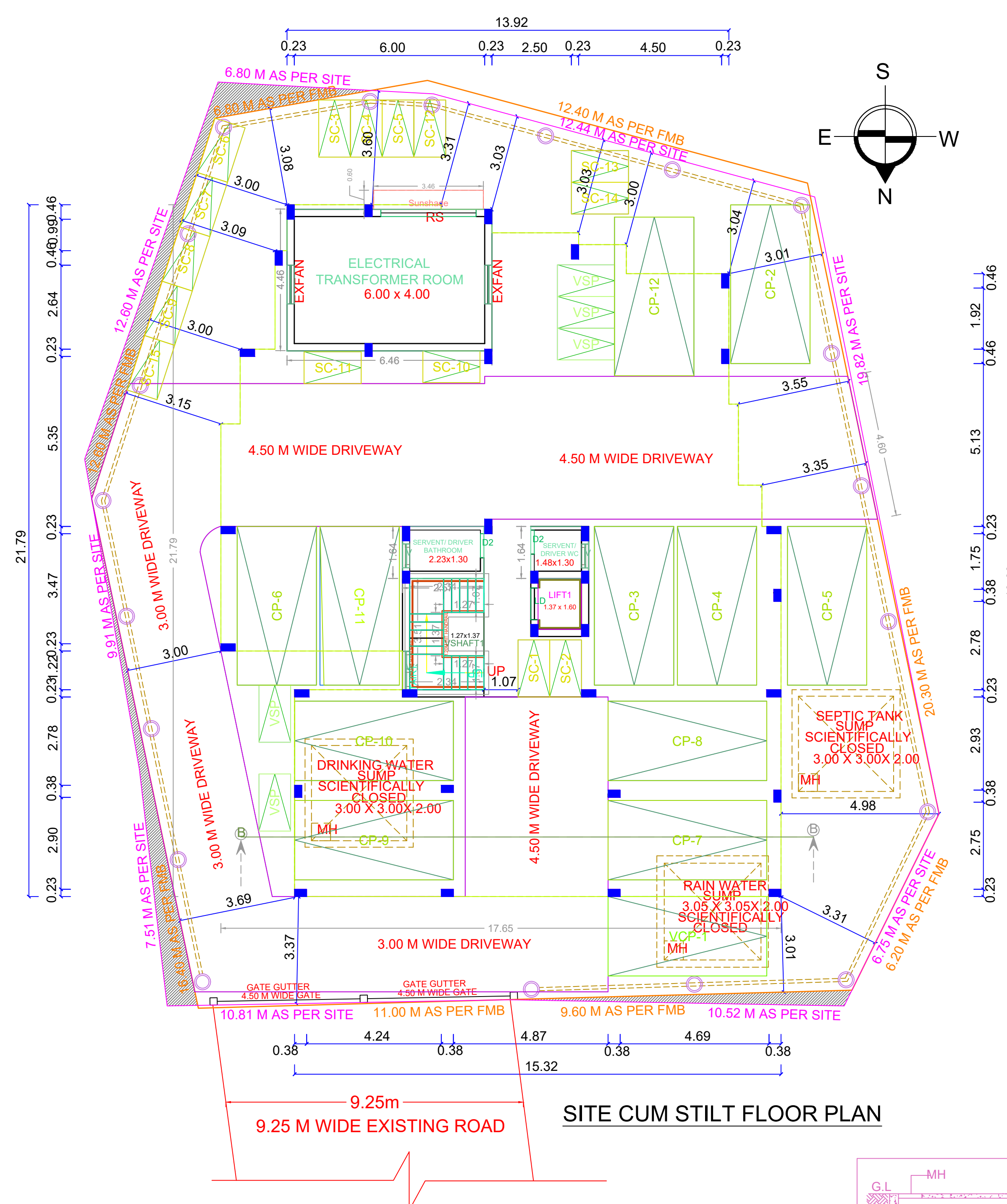
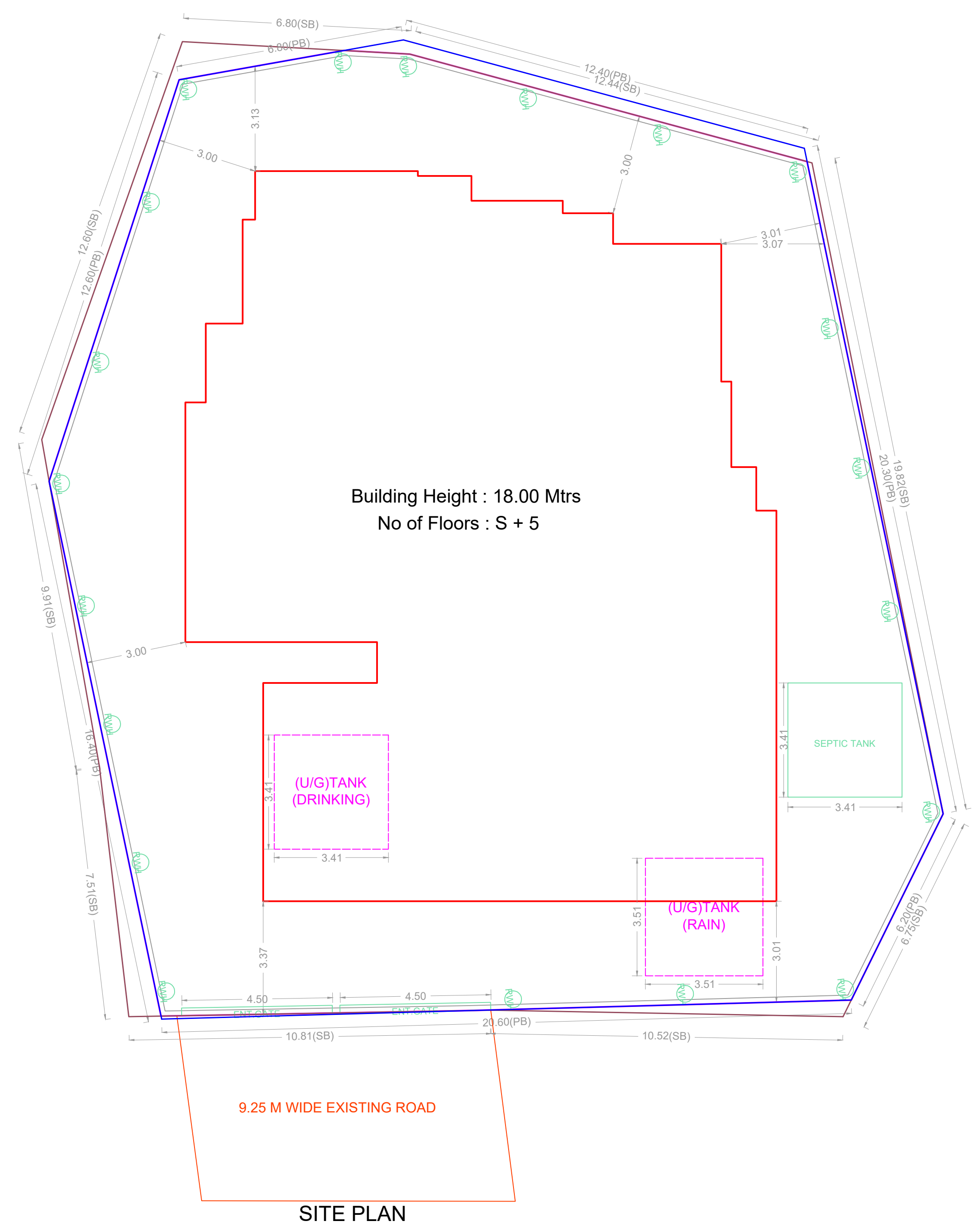

APPROVAL CONDITION

SCALE: 1:100

CHENNAI METROPOLITAN DEVELOPMENT AUTHORITY

APPROVED

SUBJECT TO THE CONDITIONS MENTIONED IN THIS OFFICE

For Clerk/Planner / Chief Planner / Member Secretary
High Rise Building / Non High Rise Building
This Approval is valid only after building Permits is issued by the concerned Local Body.

OR CODE