

SITE PLAN

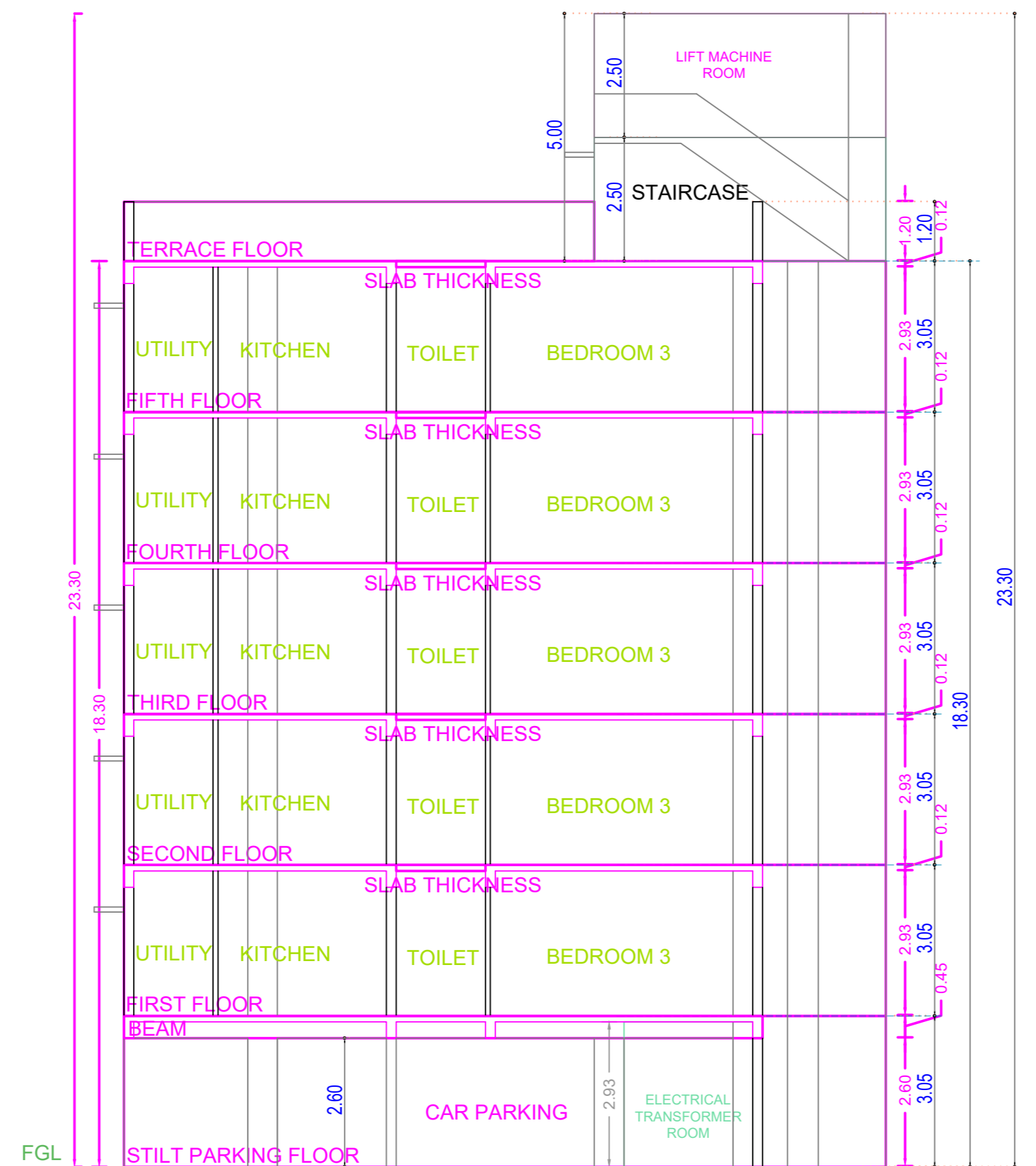

SECTION ON 'XX'



FRONT ELEVATION

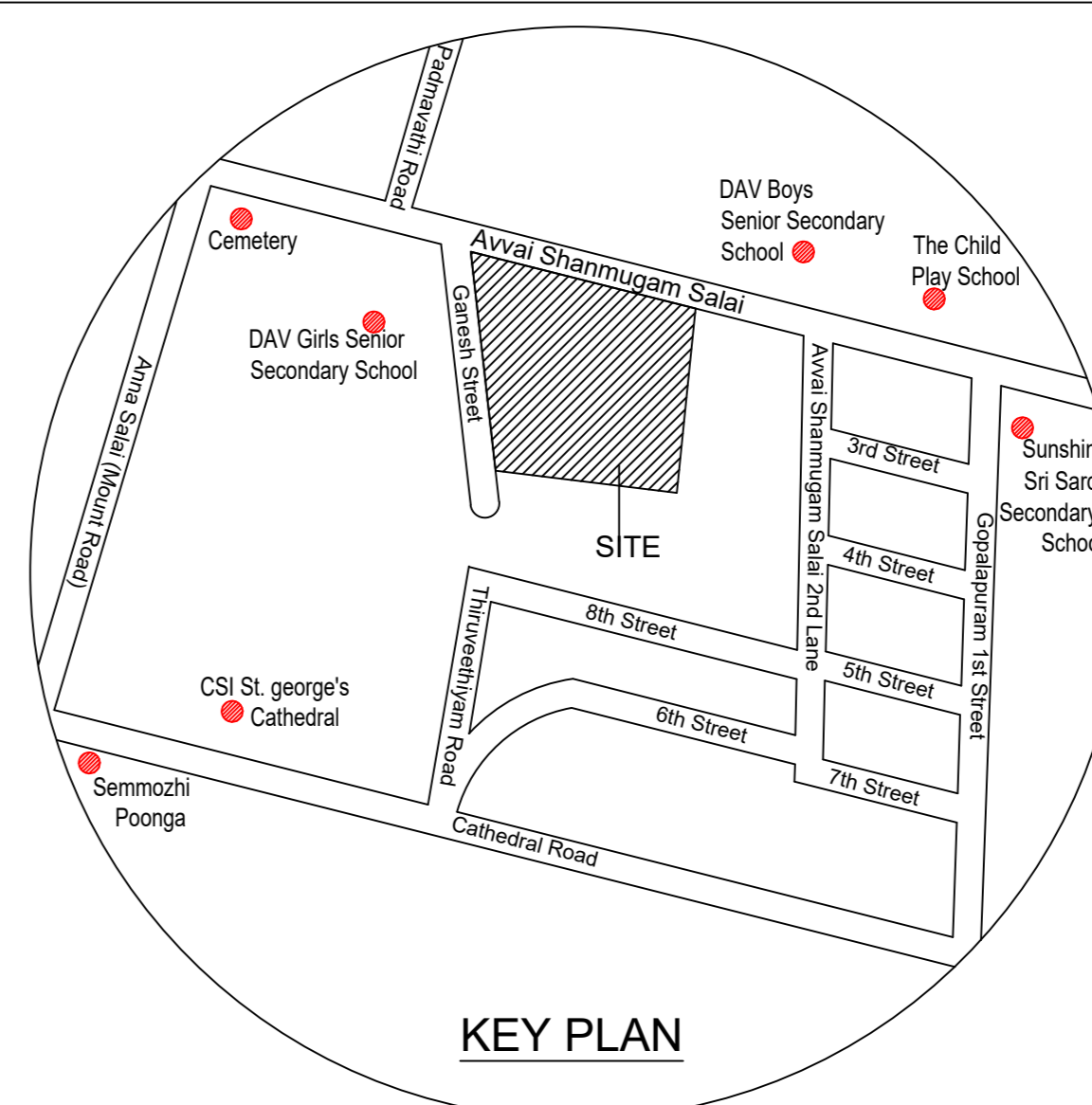

KEY PLAN

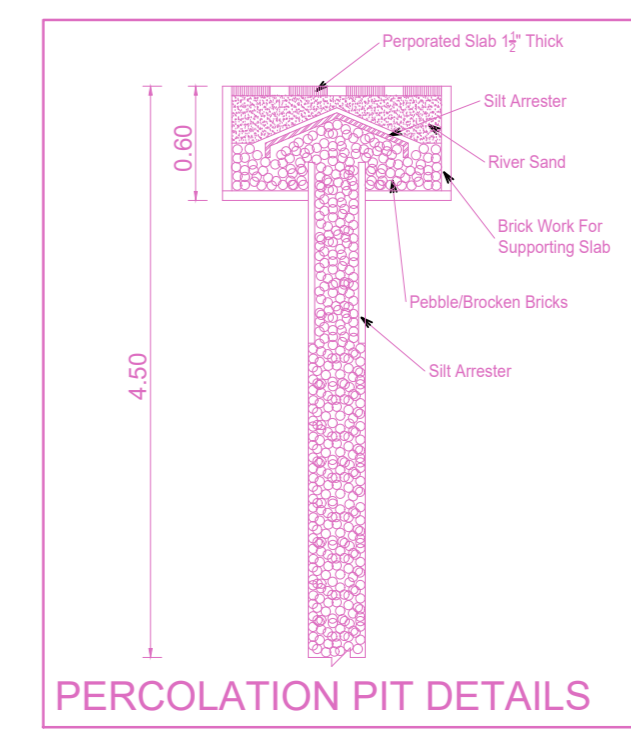

PERCOLATION PIT DETAILS

PLAN SHOWING THE PROPOSED STILT + 5 FLOORS (5nos D.UNITS) RESIDENTIAL BUILDING AT NEW DOOR NO:371(177), AVVAI SHUNMUGAM SALAI, GOPALPURAM, THOUSAND LIGHTS, CHENNAI - 600086. COMPRISED IN R.S.NO: 69/81, BLOCK NO: 4 OF MYLAPORE VILLAGE, MYLAPORE TALUK, CHENNAI DISTRICT, GREATER CHENNAI CORPORATION.ZONE NO: 09, DIVISION NO: 111.

A) AREA STATEMENT		SQ.M.
AREA AS PER PATTA		444.50
AREA AS PER DOCUMENT		444.44
AREA CONSIDERED FOR FSI		444.44
STREET ALIGNMENT/ ROAD WIDENING/LINK ROAD		0.00
OSR AREA		0.00
TOTAL FSI AREA		1080.63
FSI FACTOR		2.431
COVERAGE AREA (PERCENTAGE %)		NA

A) PARKING STATEMENT		
VEHICLE	REQUIRED	PROVIDED
LORRY	-	0
CAR	10	11
TWO WHEELER	0	0
CYCLE	-	0

FLOOR WISE FSI STATEMENT: NHRB (NHRB)						
FLOORS	FSI AREA				DU	TOTAL FSI AREA
	COMM.	RESI.	IND.	INST.		
STILT PARKING FLOOR	0.00	29.38	0.00	0.00	0	29.38
FIRST FLOOR	0.00	210.25	0.00	0.00	1	210.25
SECOND FLOOR	0.00	210.25	0.00	0.00	1	210.25
THIRD FLOOR	0.00	210.25	0.00	0.00	1	210.25
FOURTH FLOOR	0.00	210.25	0.00	0.00	1	210.25
FIFTH FLOOR	0.00	210.25	0.00	0.00	1	210.25
Terrace	0.00	0.00	0.00	0.00	0	0.00
Total	0.00	1080.63	0.00	0.00	5	1080.63

BUILDING WISE FSI STATEMENT							
BUILDING	NO OF SAME BUILDING	FSI AREA				DU	TOTAL FSI AREA
		COMM.	RESI.	IND.	INST.		
NHRB-1 (NHRB)	0.00	1080.63	0.00	0.00	0.00	5	1080.63
Total	0.00	1080.63	0.00	0.00	0.00	5	1080.63

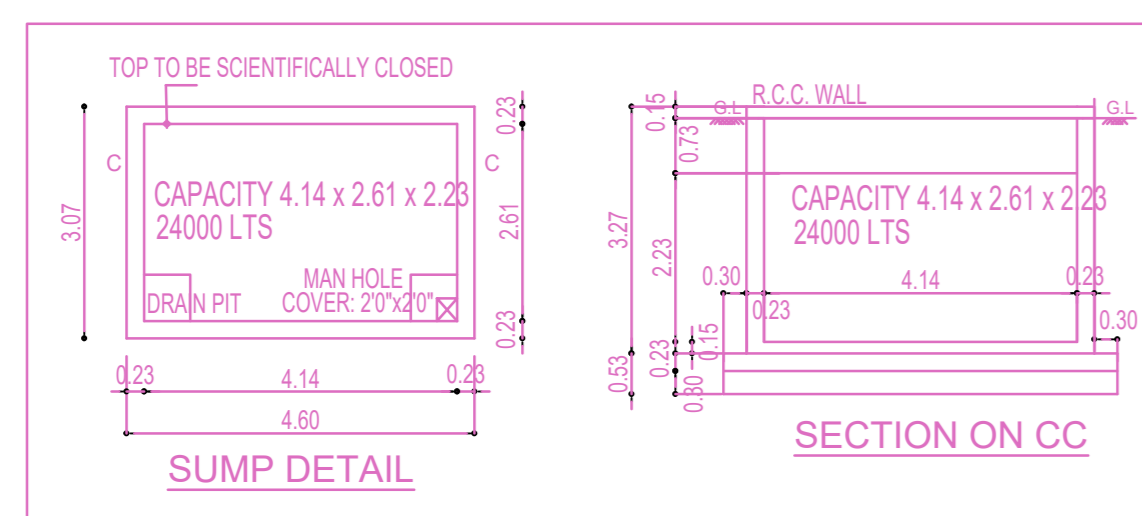

SUMP DETAIL

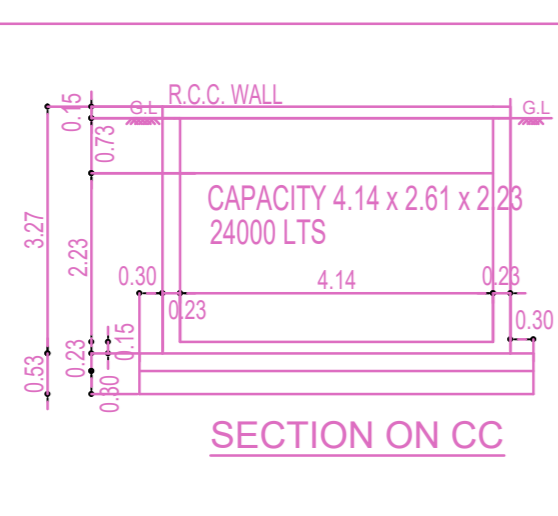

SECTION ON CC

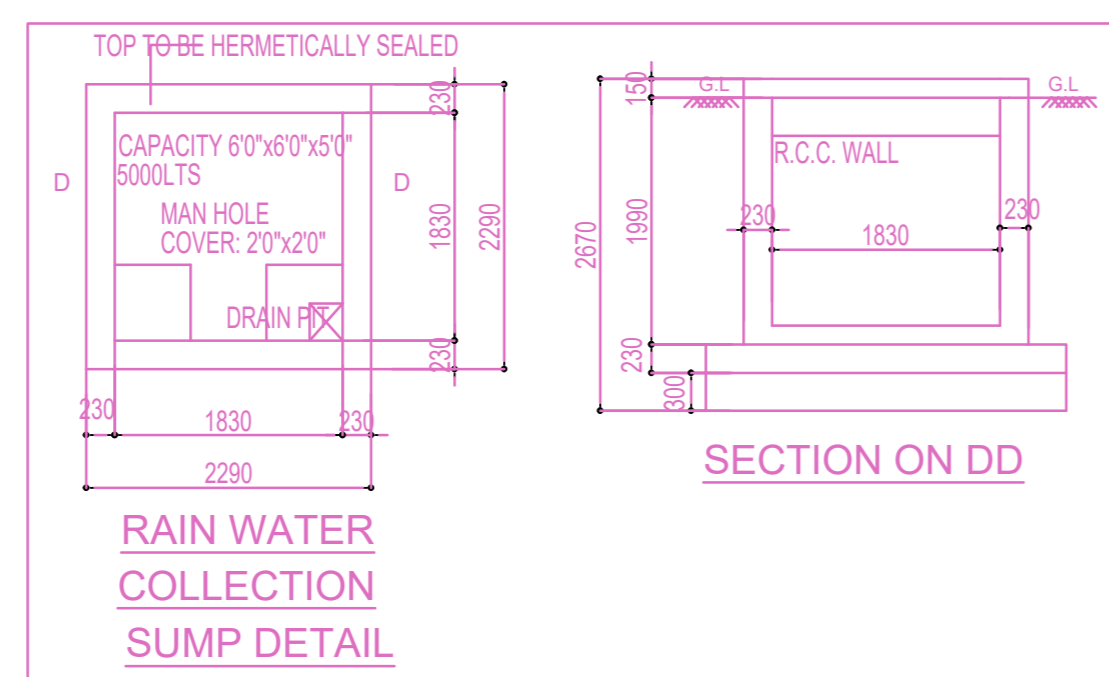

RAIN WATER COLLECTION SUMP DETAIL

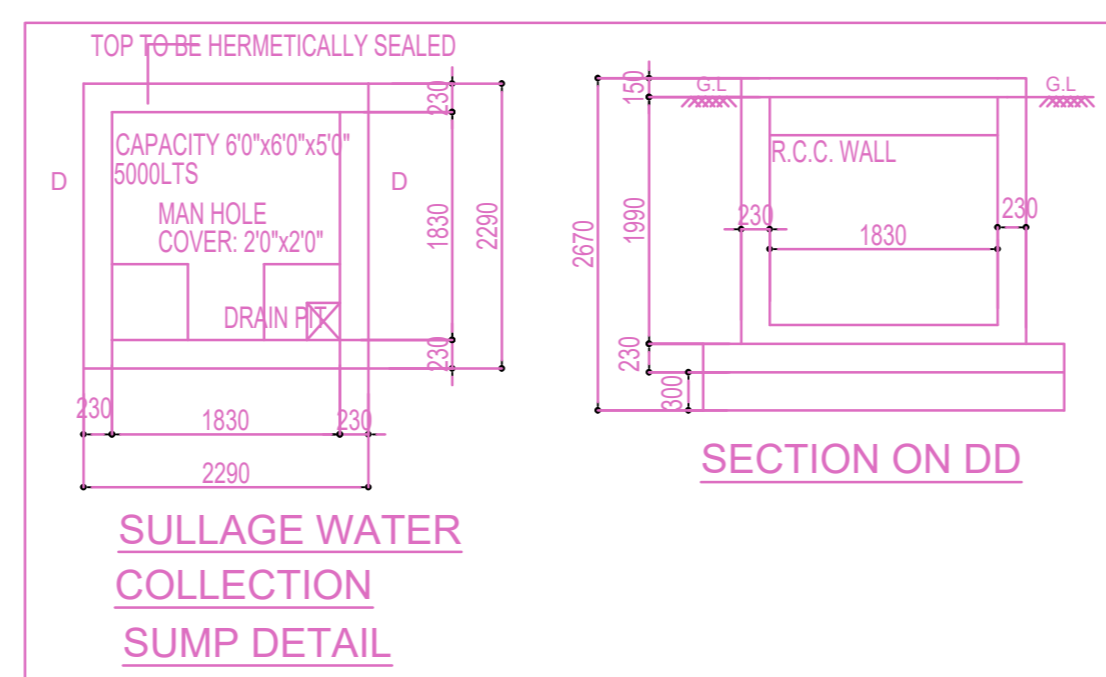

SULLAGE WATER COLLECTION SUMP DETAIL

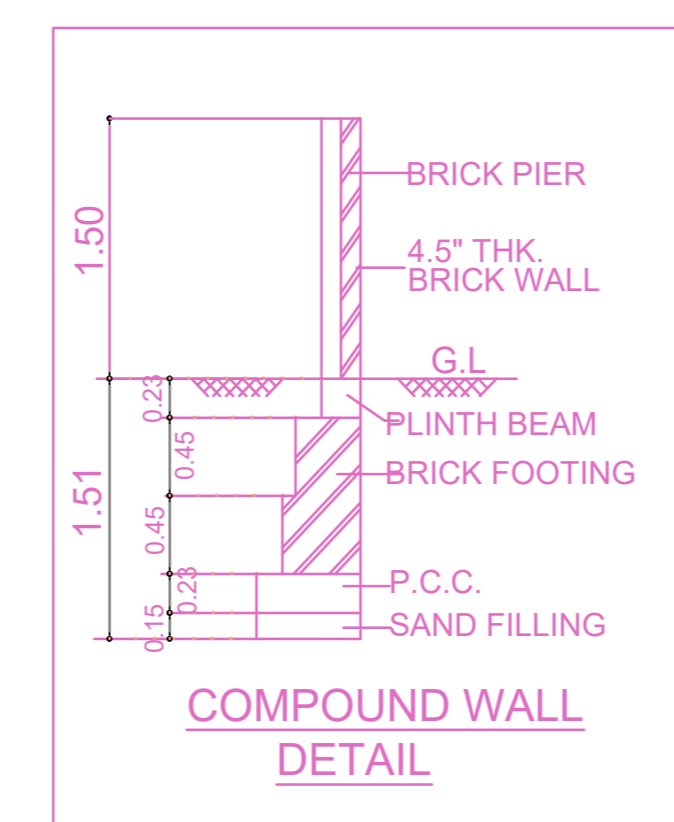

COMPOUND WALL DETAIL

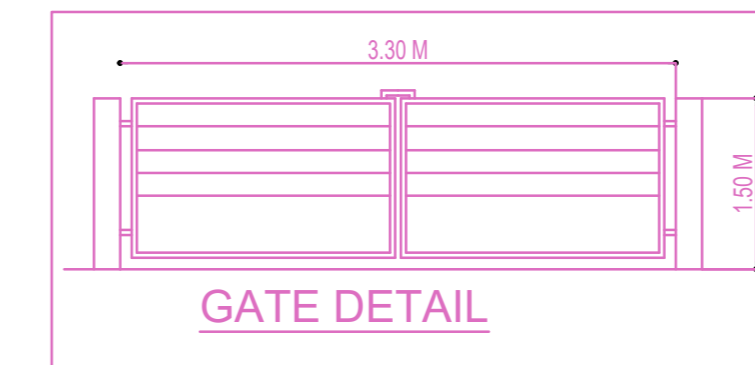

GATE DETAIL

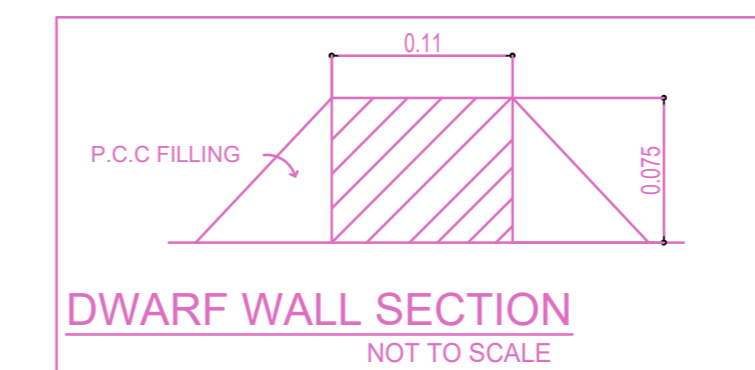

DWARF WALL SECTION NOT TO SCALE

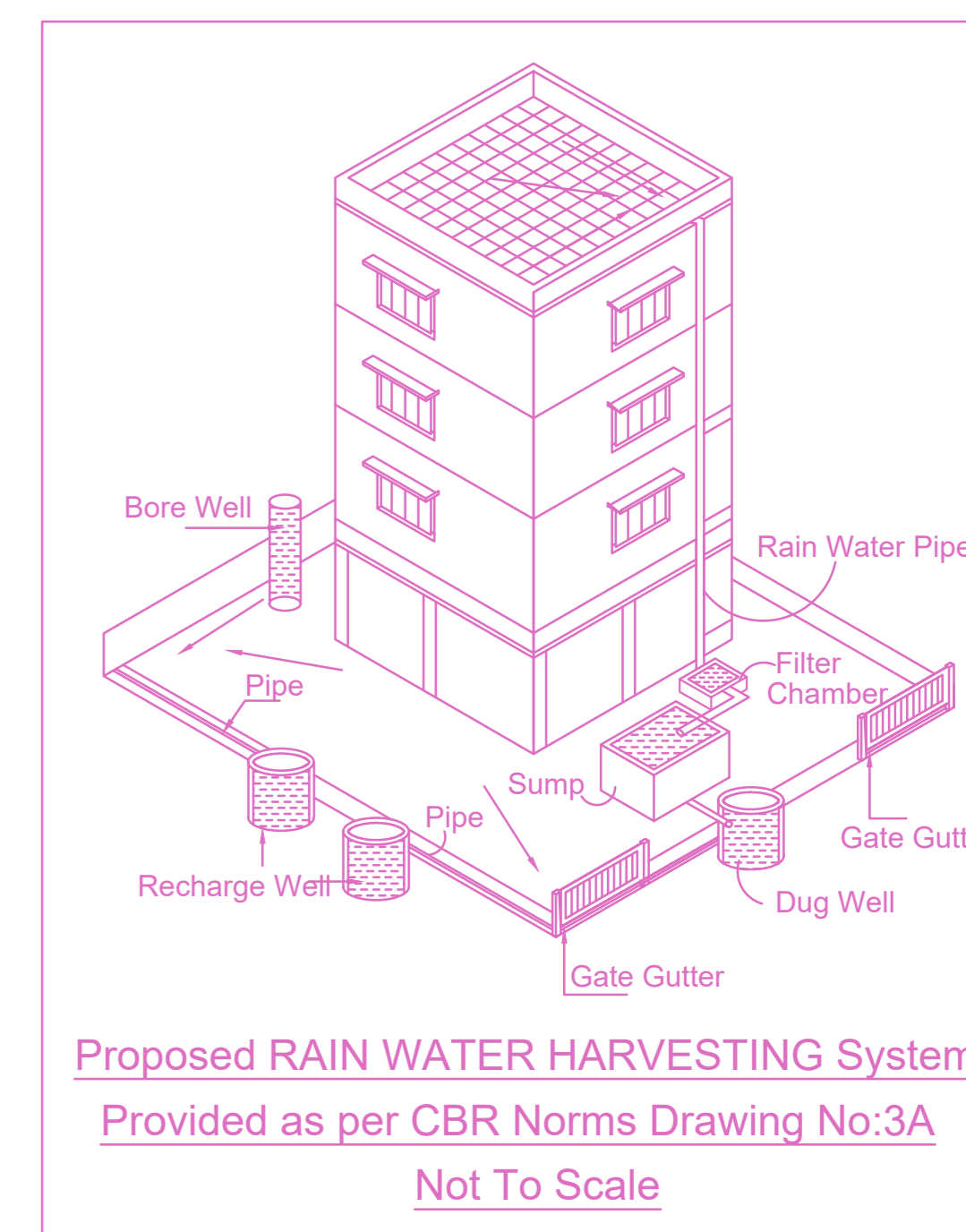
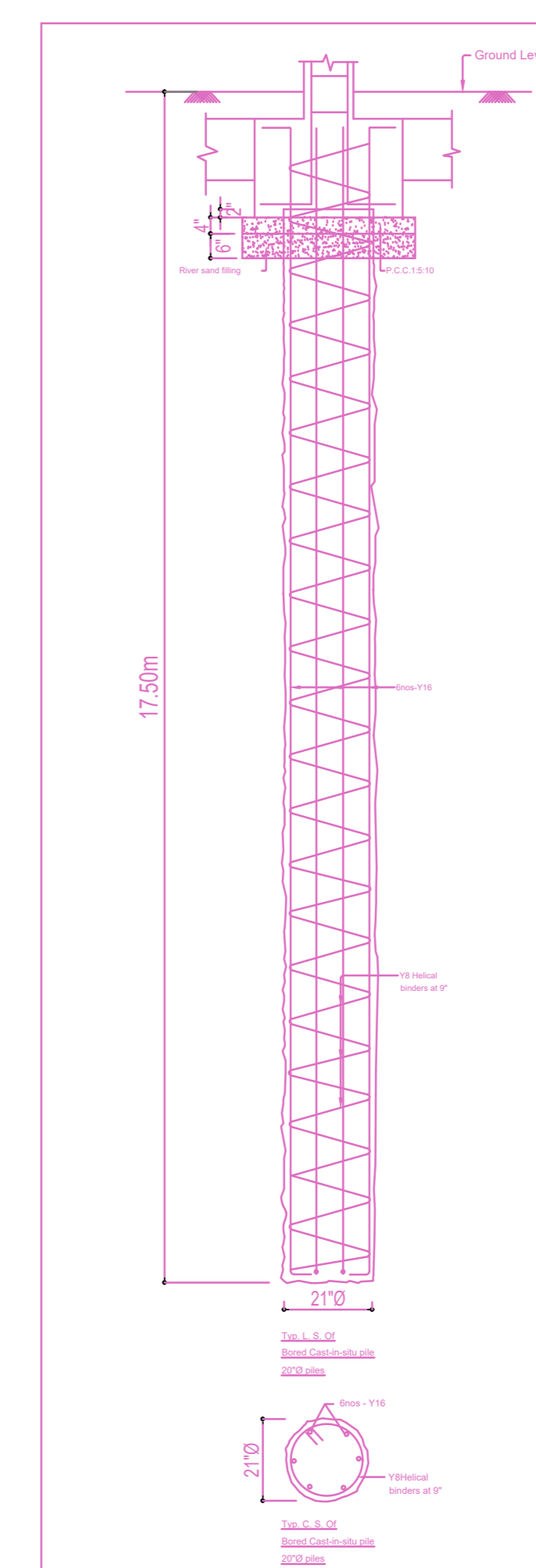

Proposed RAIN WATER HARVESTING System Provided as per CBR Norms Drawing No:3A Not To Scale

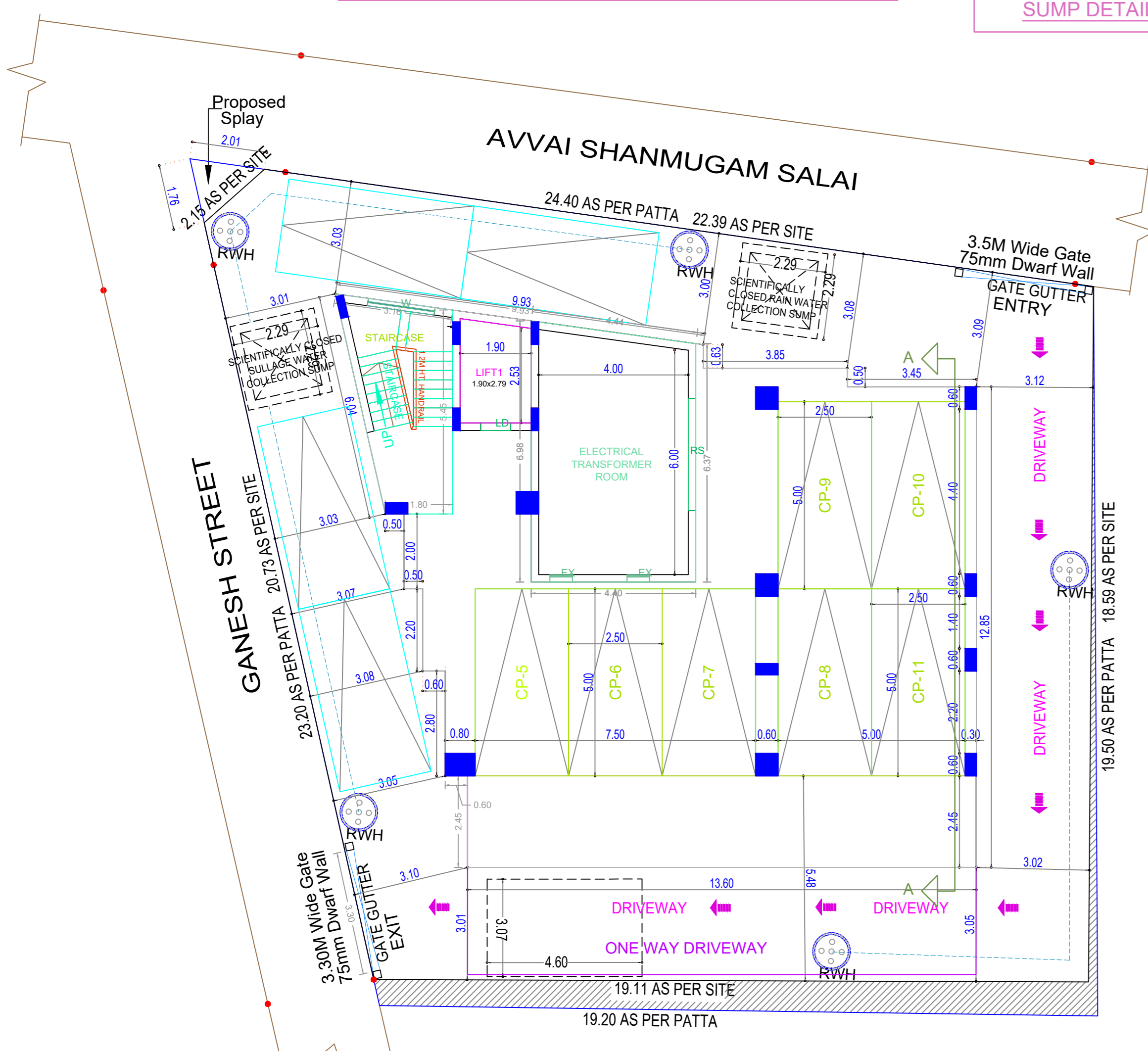

SITE CUM STILT FLOOR PLAN

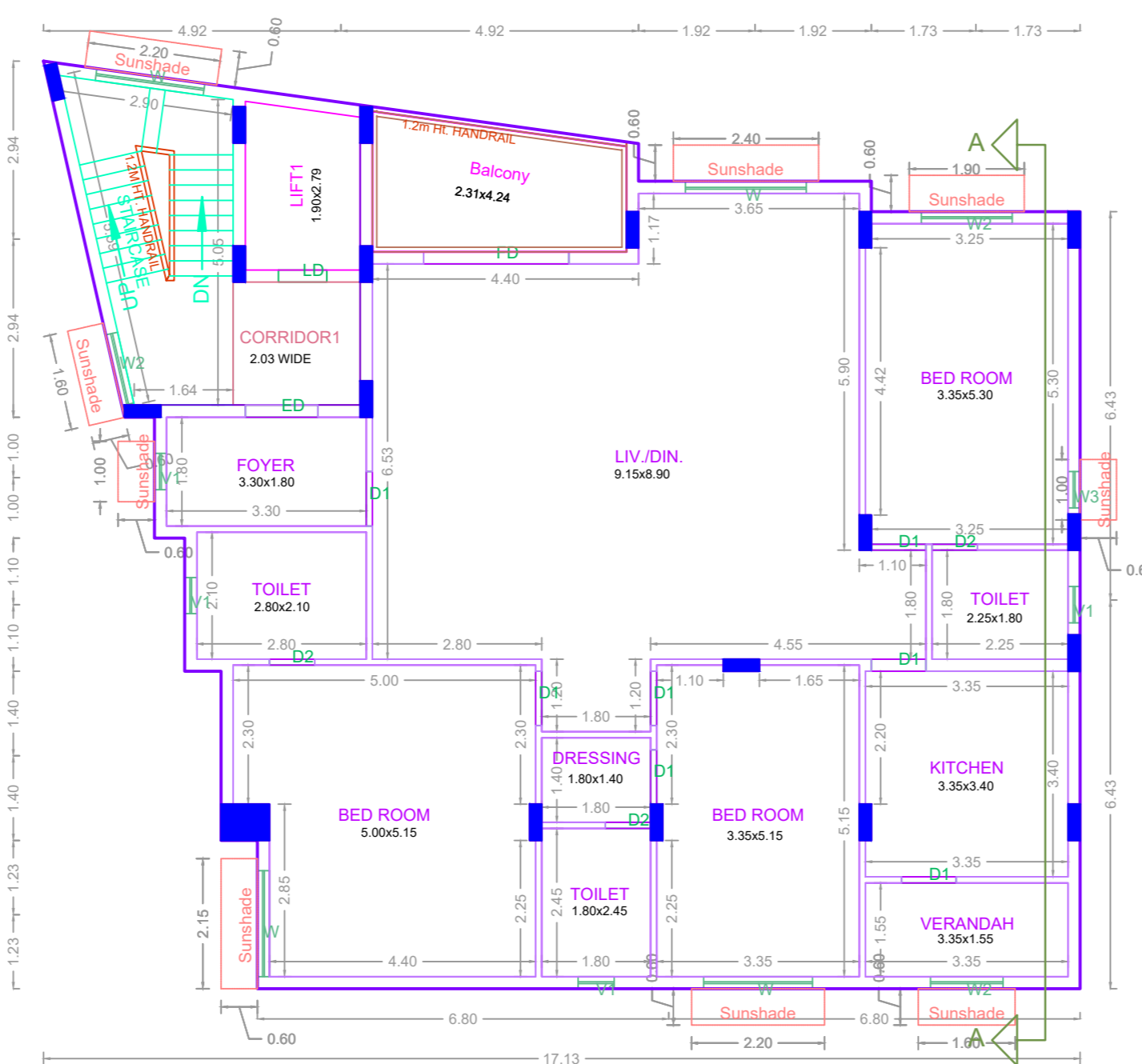

TYPICAL - 1, 2, 3, 4 & 5 FLOOR PLAN

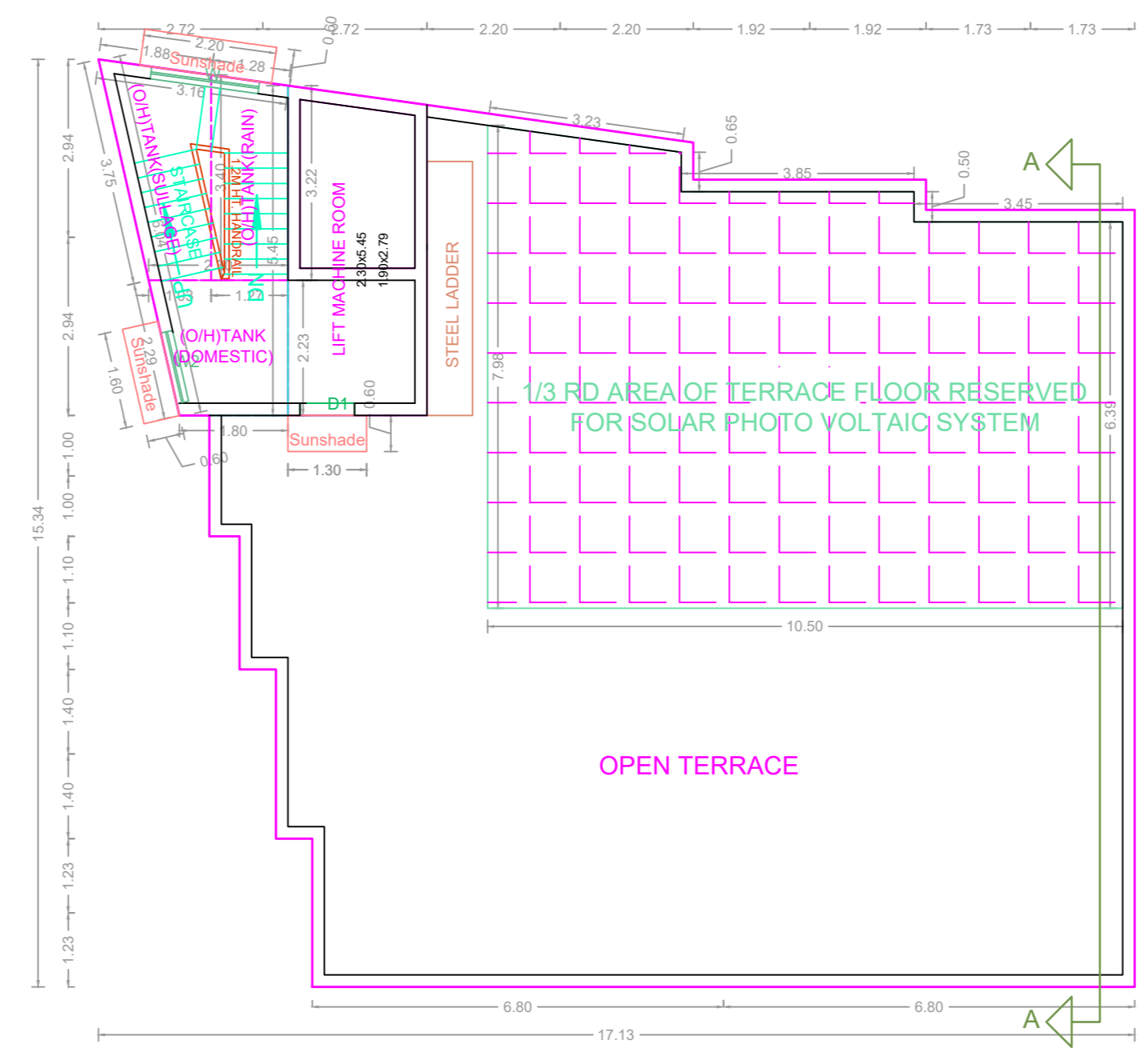

TERRACE FLOOR PLAN

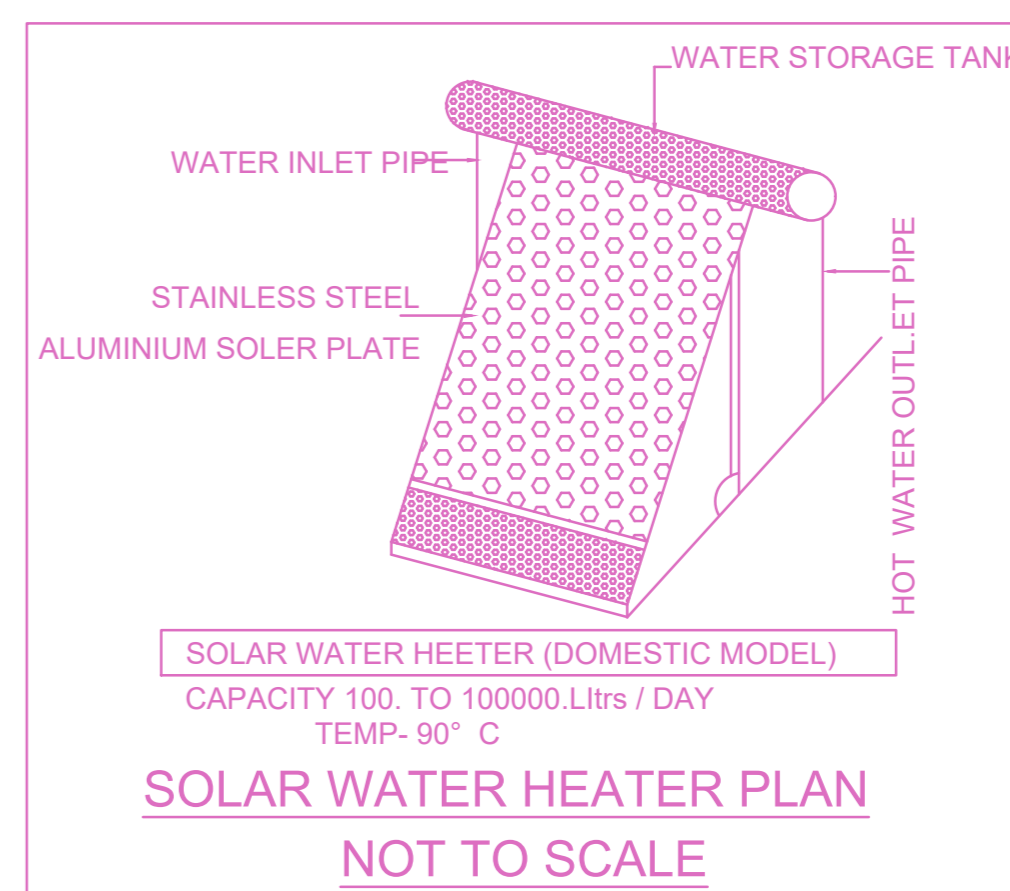

SOLAR WATER HEATER PLAN NOT TO SCALE

APPROVAL CONDITION	
1.	As per the conditions mentioned in this office.
2.	As per the conditions mentioned in this office.
3.	As per the conditions mentioned in this office.
4.	As per the conditions mentioned in this office.
5.	As per the conditions mentioned in this office.

CHENNAI METROPOLITAN DEVELOPMENT AUTHORITY  
APPROVED  
SUBJECT TO THE CONDITIONS MENTIONED IN THIS OFFICE

SCALE 1:100  
N  
This Planning Permission issued under New Rule TNCBR, 2019 is subject to final outcome of the W.P. (MD) No.8948 of 2019 and WMP (MD) Nos. 6912 & 6913 of 2019.

For (Deputy Planner / Chief Planner / Member-Secretary)  
High Rise Building / Non High Rise Building  
This Approval is valid only after building Permit is issued by the concerned Local Body.

QR CODE