

KEYPLAN (N.T.S)
Location plan (Taken as per User Inputs)

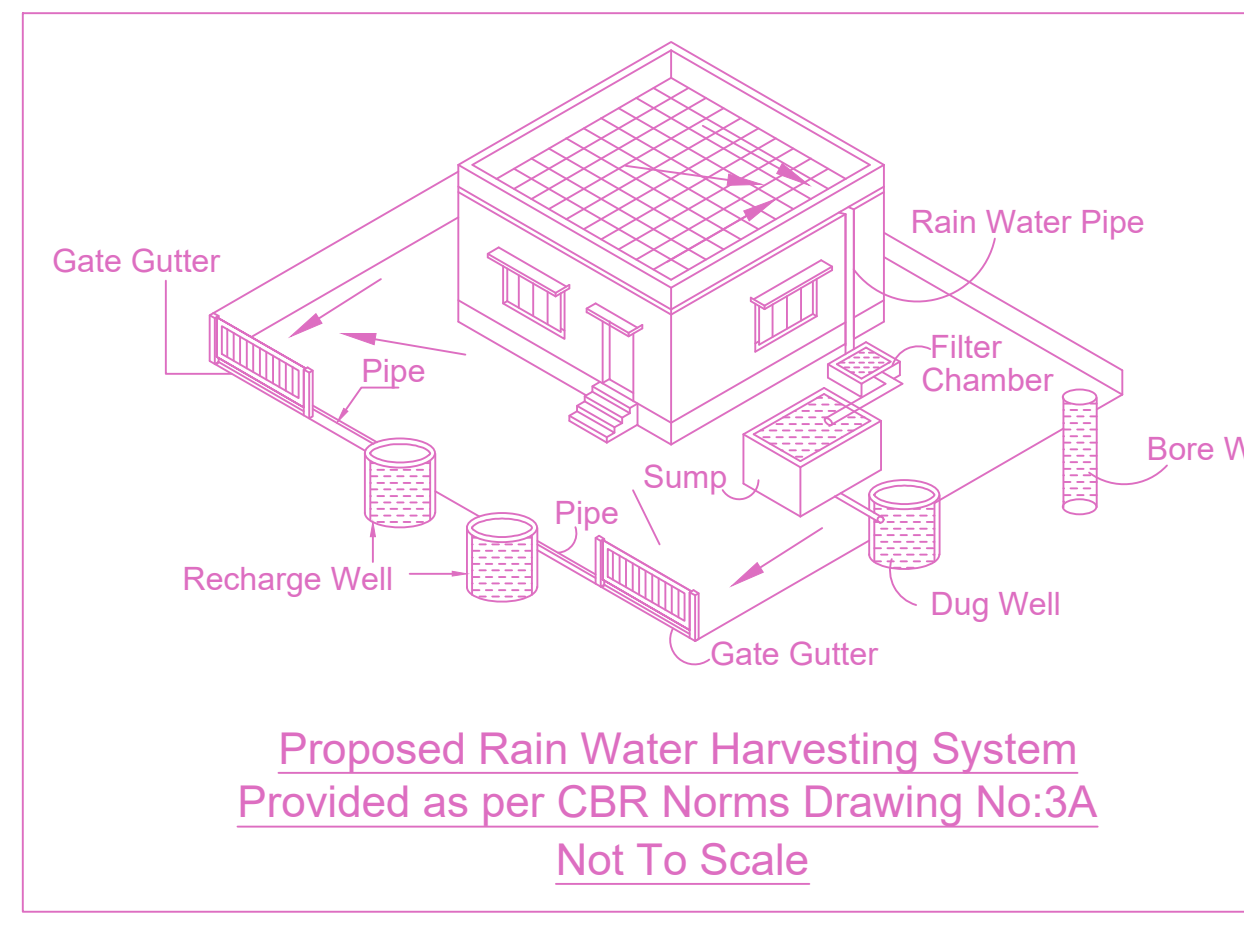

PLAN SHOWING THE PROPOSED CONSTRUCTION OF STILL FLOOR + 5 FLOORS (18.30M HEIGHT) RESIDENTIAL BUILDING WITH 20 DWELLING UNITS, AT PLOT NO. 59, OLD DOOR NO. 32 & NEW DOOR NO.74, 2ND MAIN ROAD, RAJA ANNAMALAI PURAM, CHENNAI - 600028, COMPRISED IN R.S.NO.3927/41 BLOCK NO.86 OF MYLAPORE VILLAGE WITH IN THE LIMIT OF GREATER CHENNAI CORPORATION

A) AREA STATEMENT	SQ.M
AREA AS PER PATA	626.53
AREA AS PER DOCUMENT	626.53
AREA CONSIDERED FOR FSI	626.53
STREET ALIGNMENT ROAD WIDENING LINK ROAD	0.00
OSR AREA	0.00
TOTAL FSI AREA	2318.04
FSI FACTOR	2.805
COVERAGE AREA (PERCENTAGE %)	NA

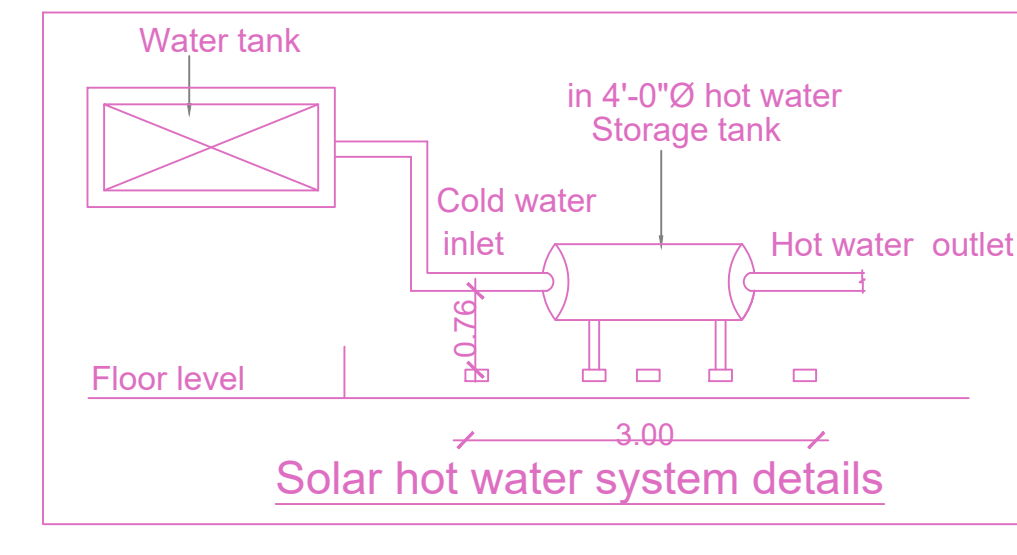
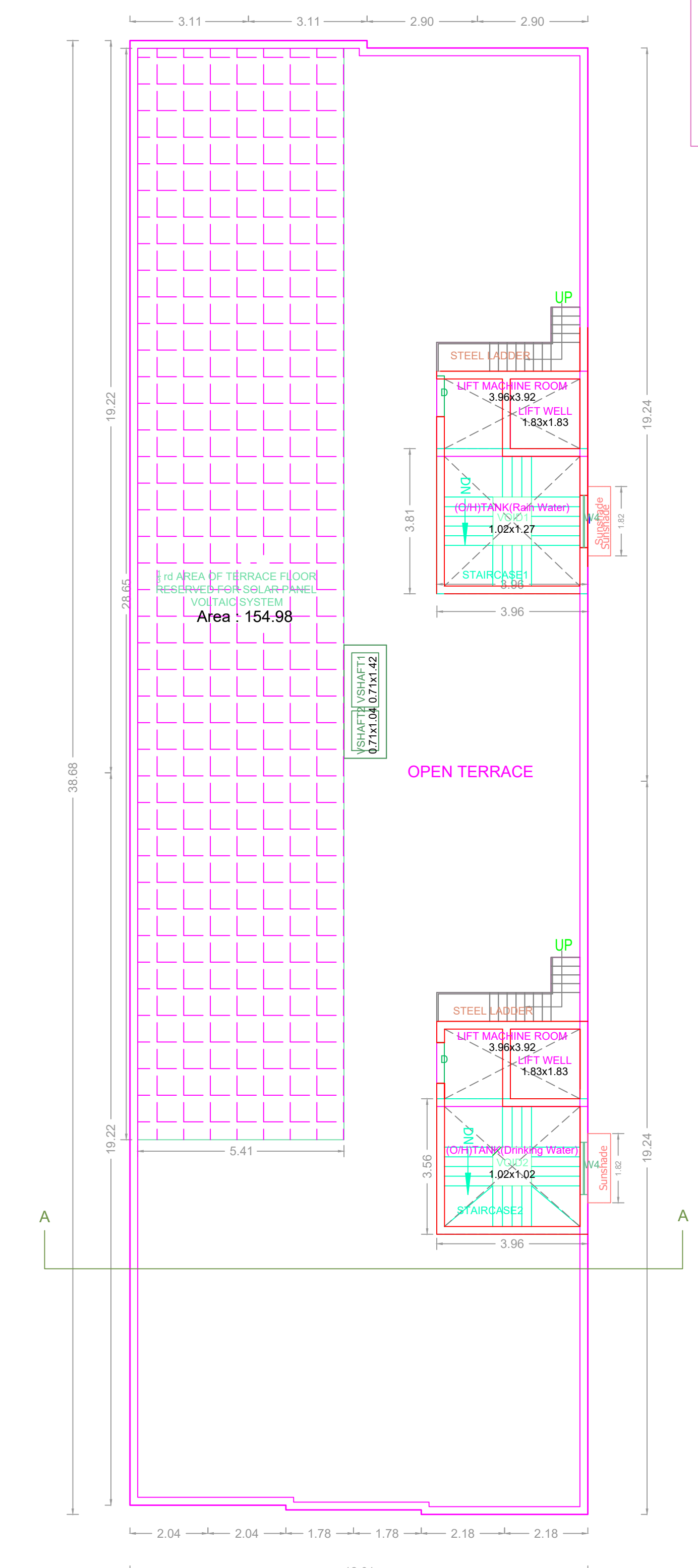
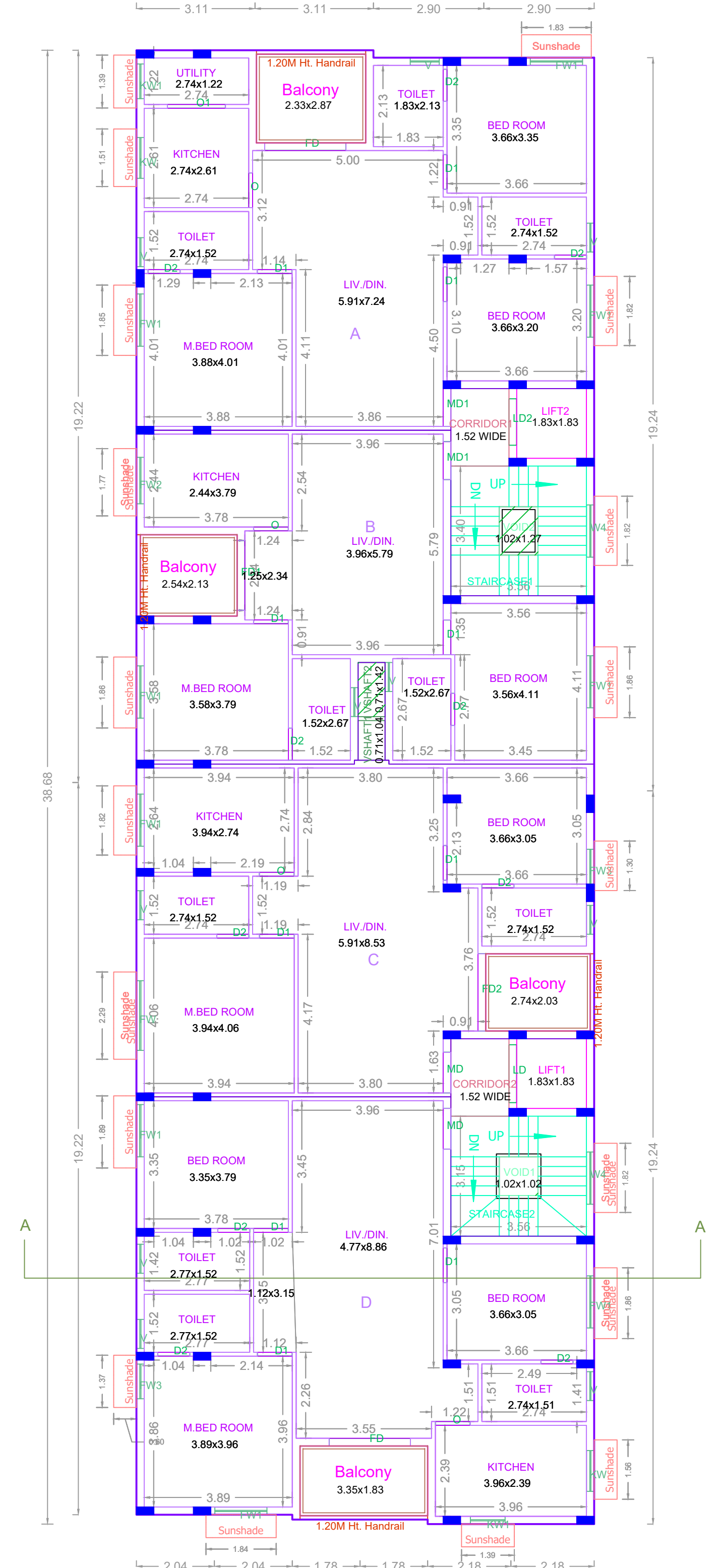
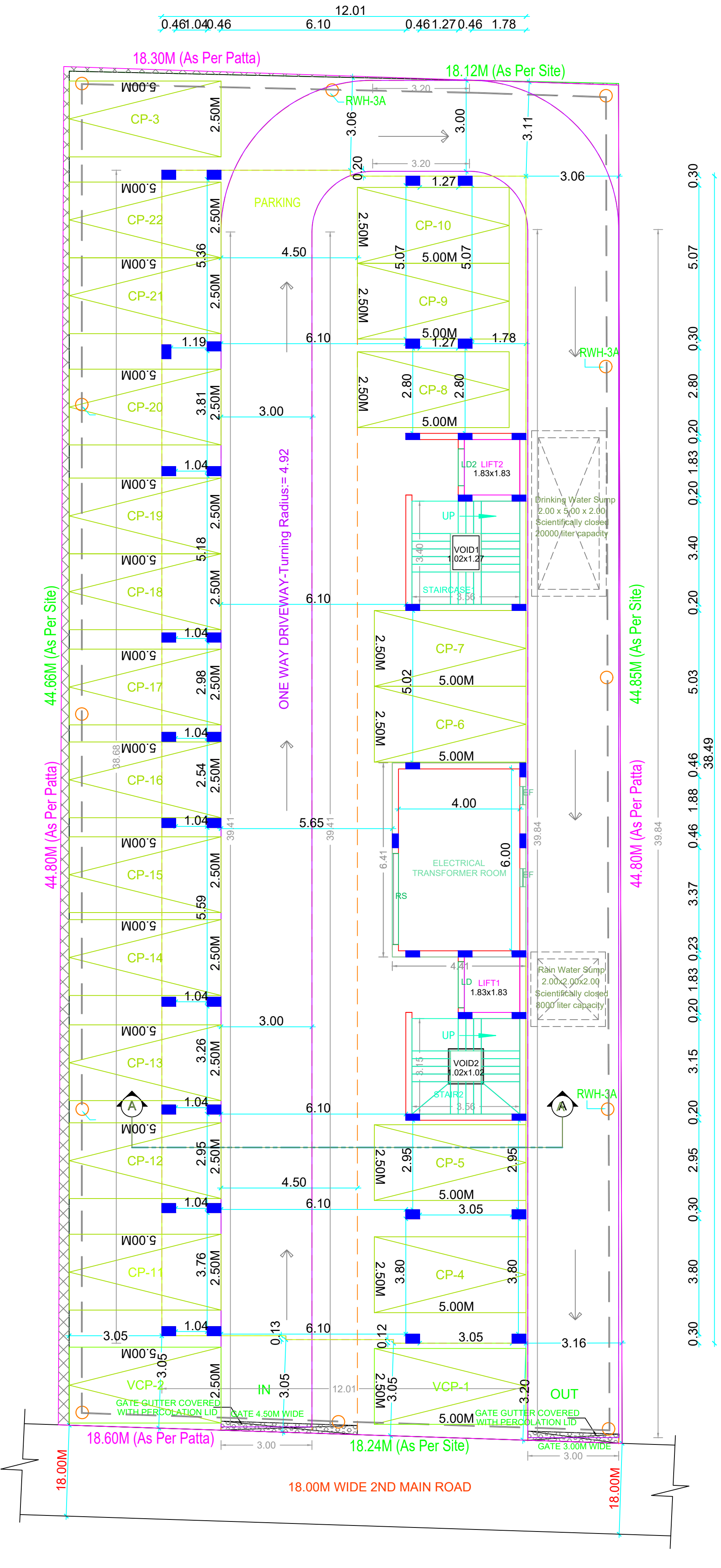
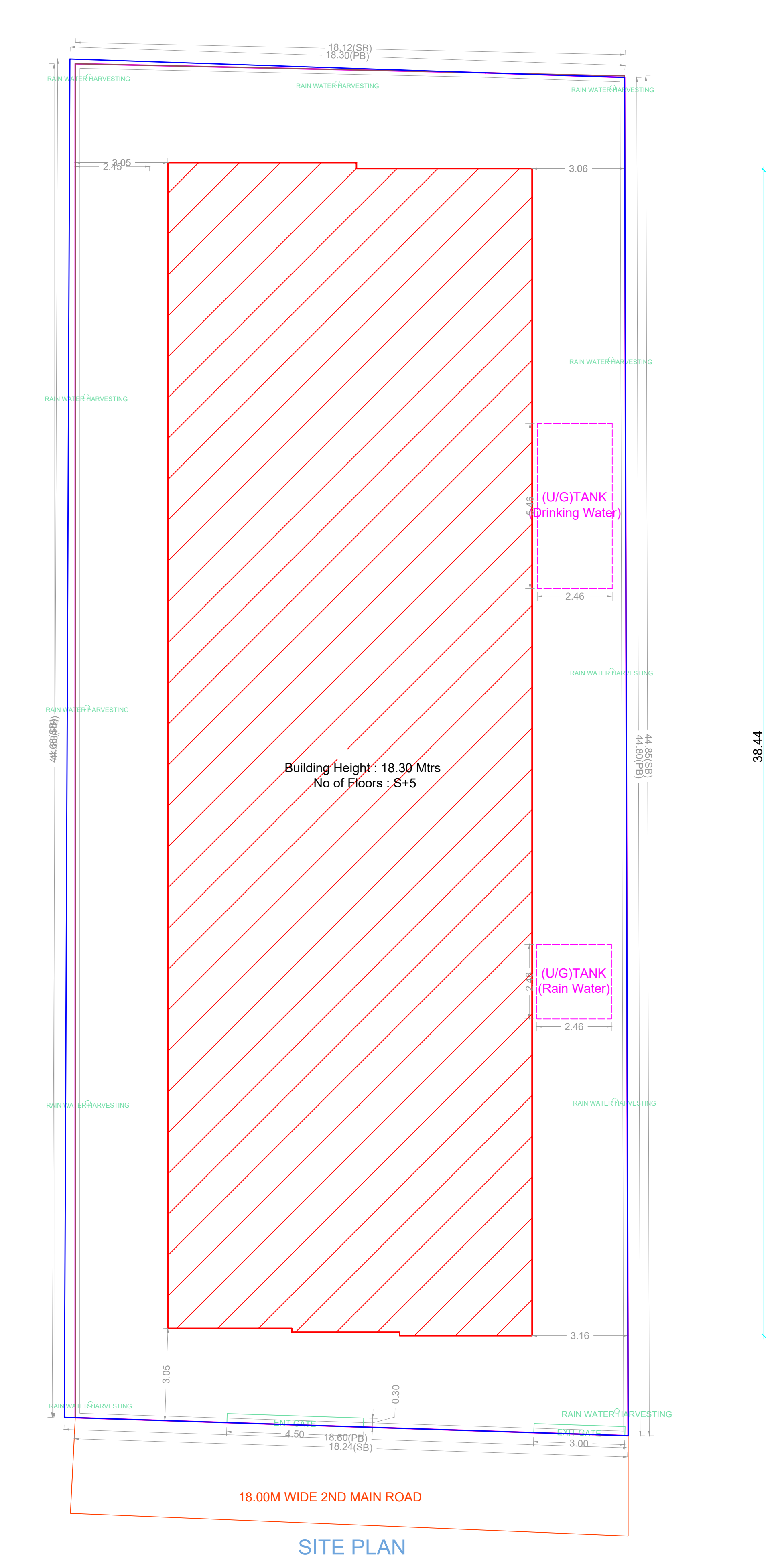
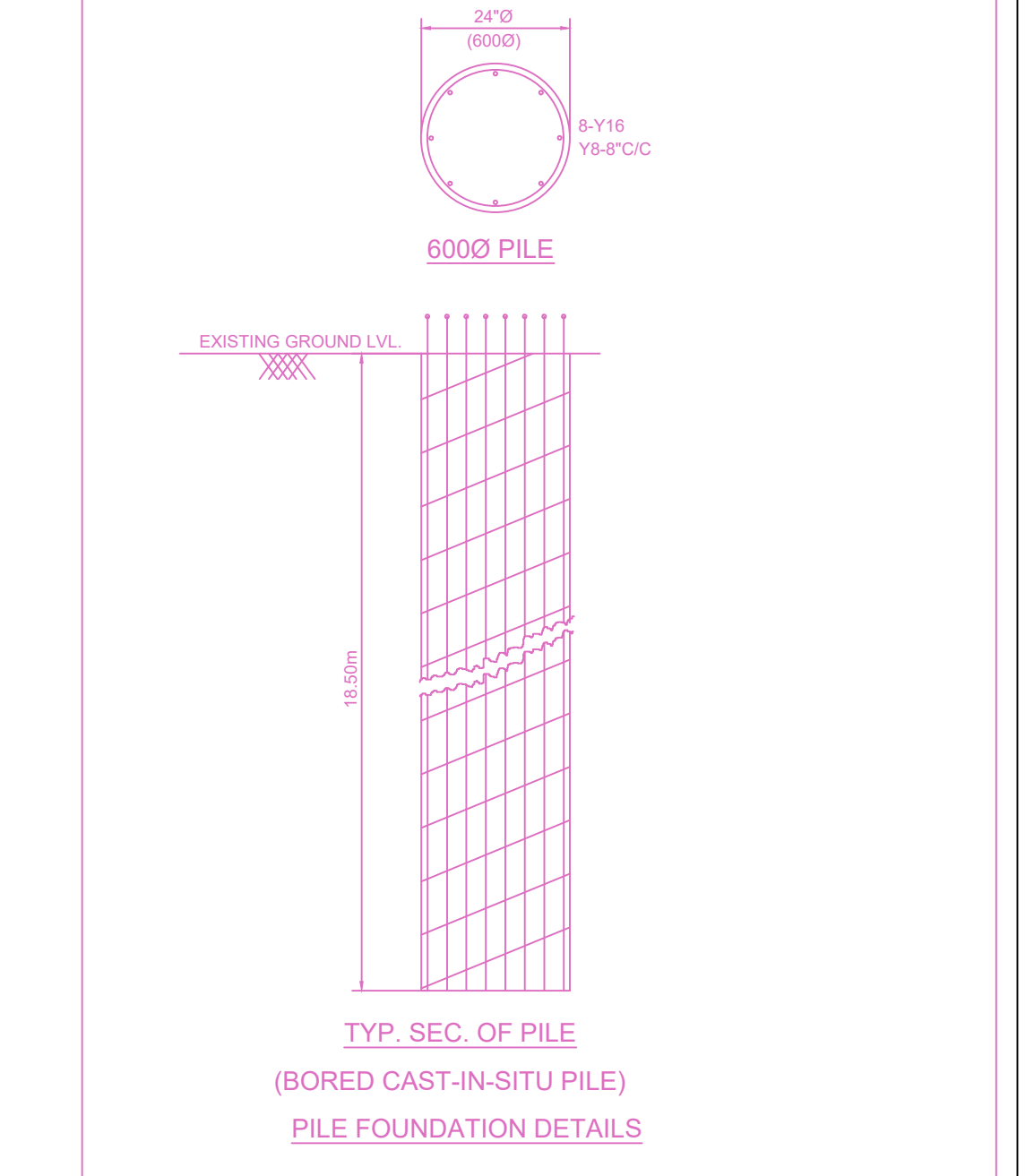
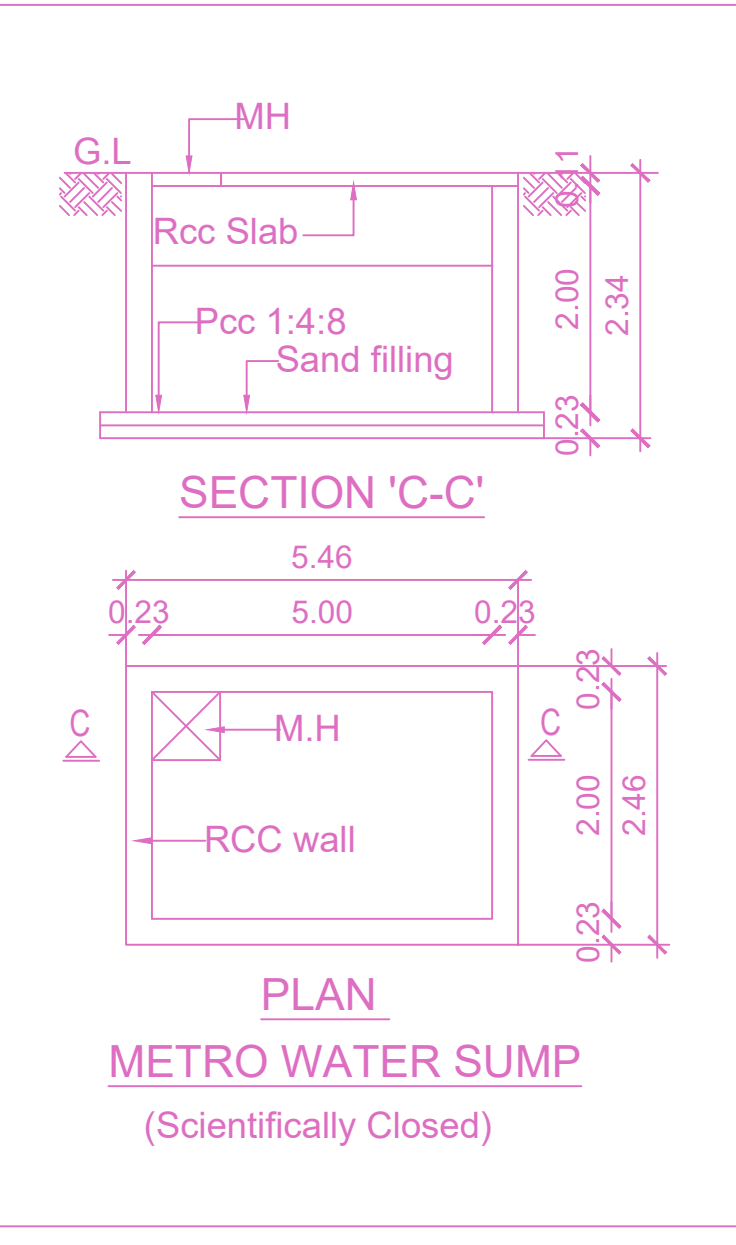
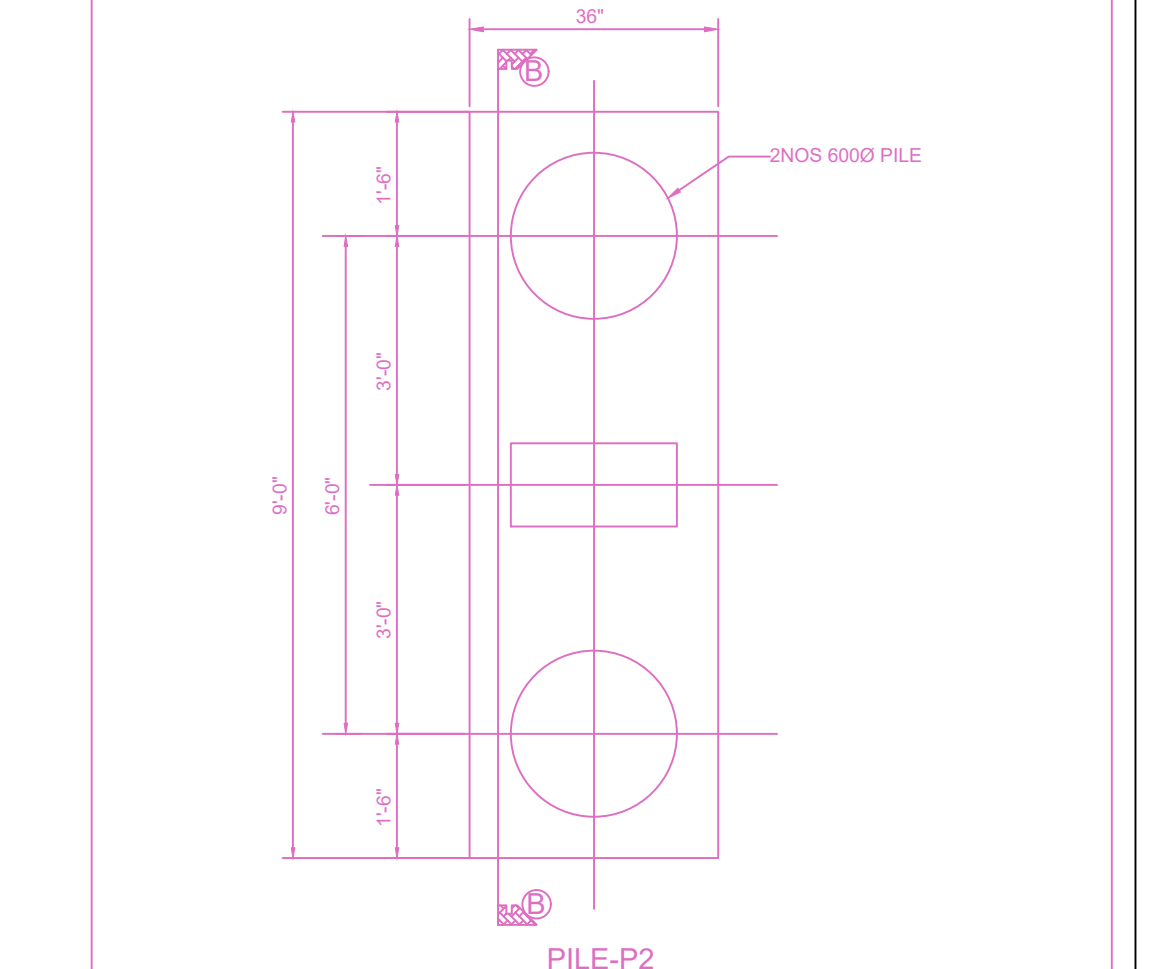
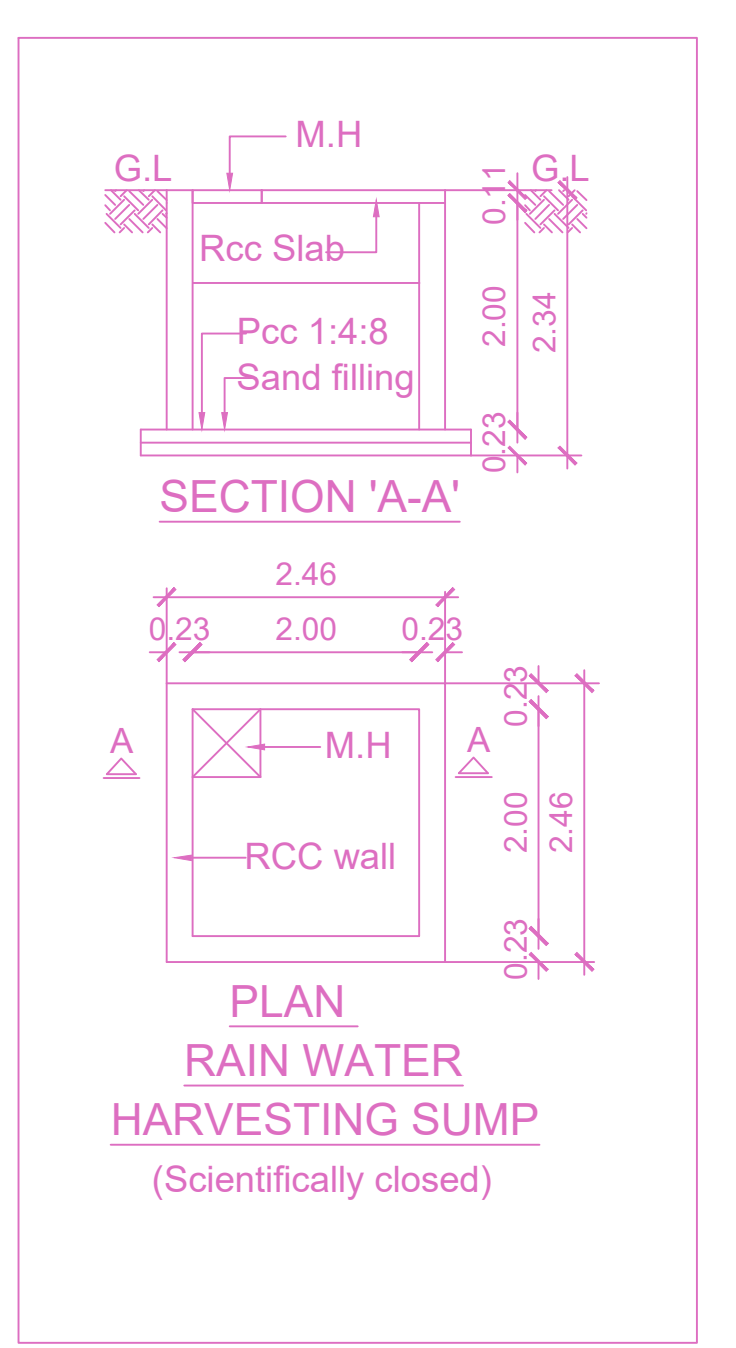
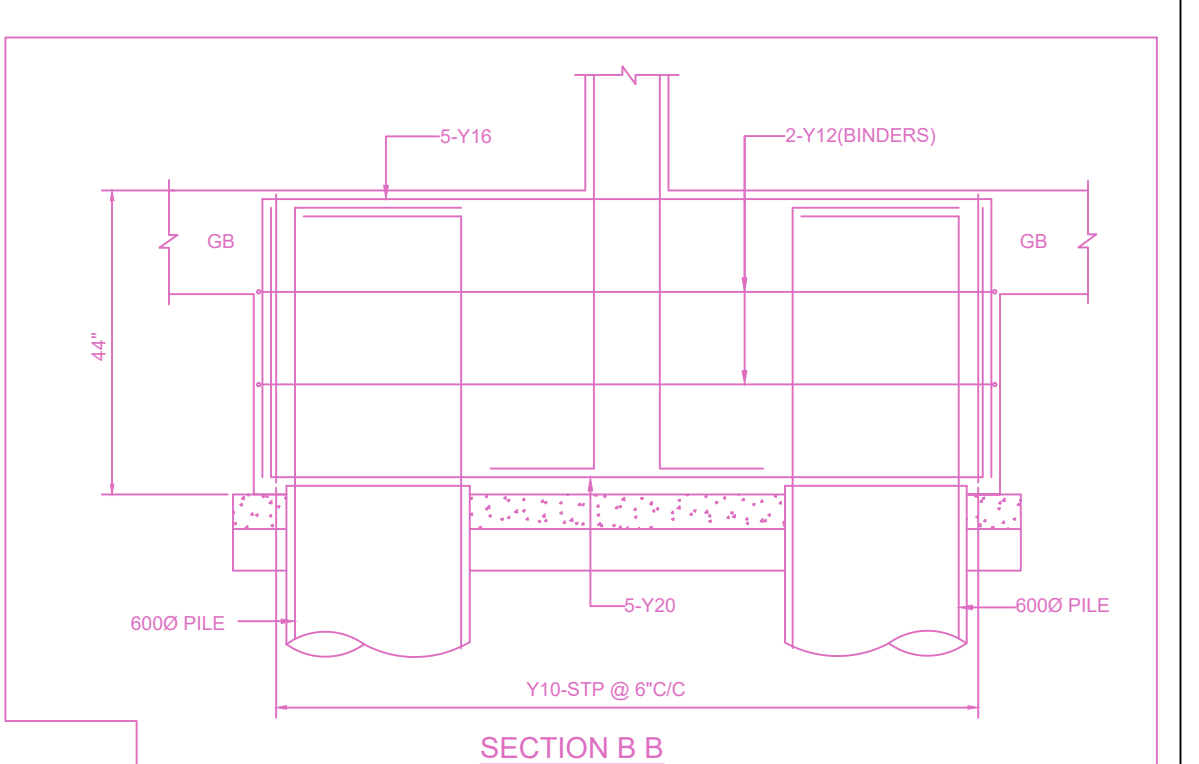
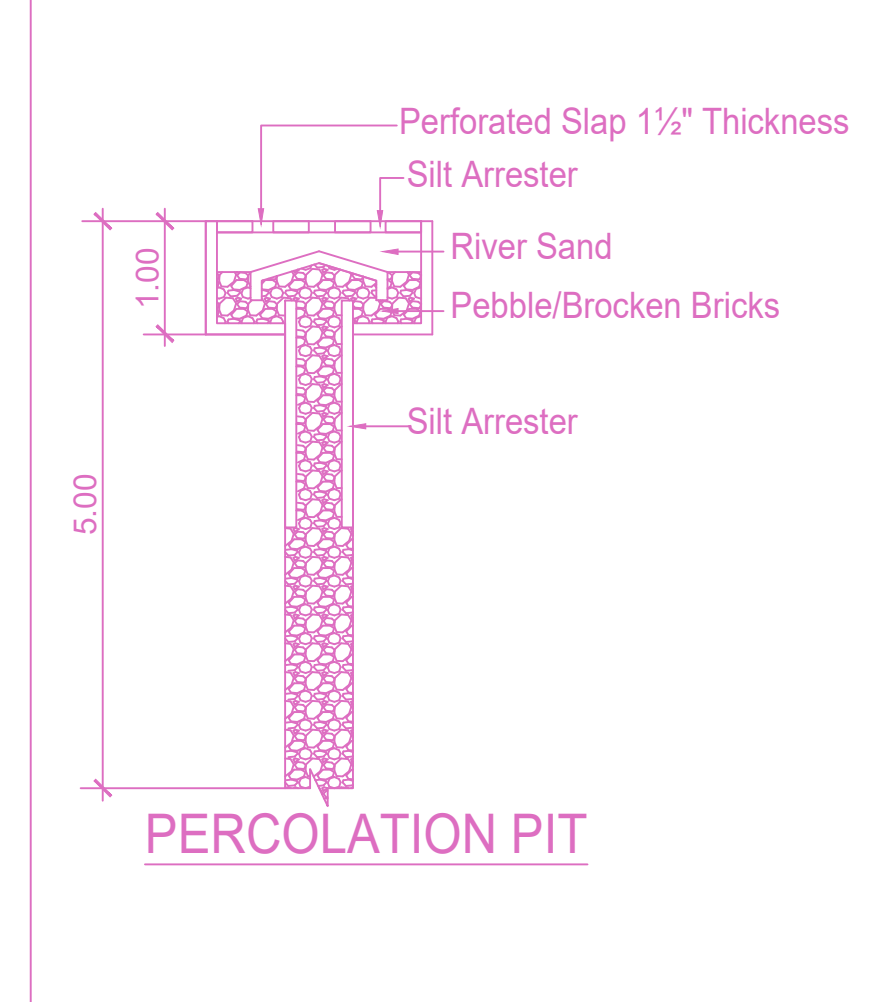
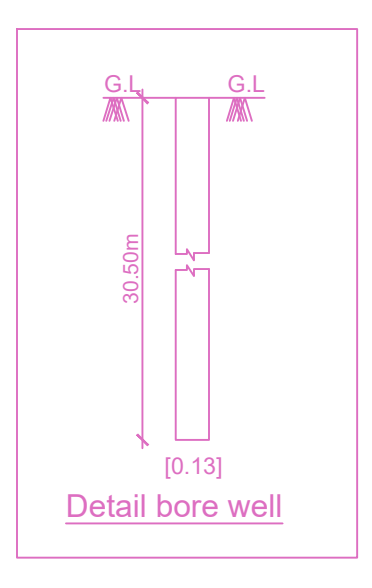
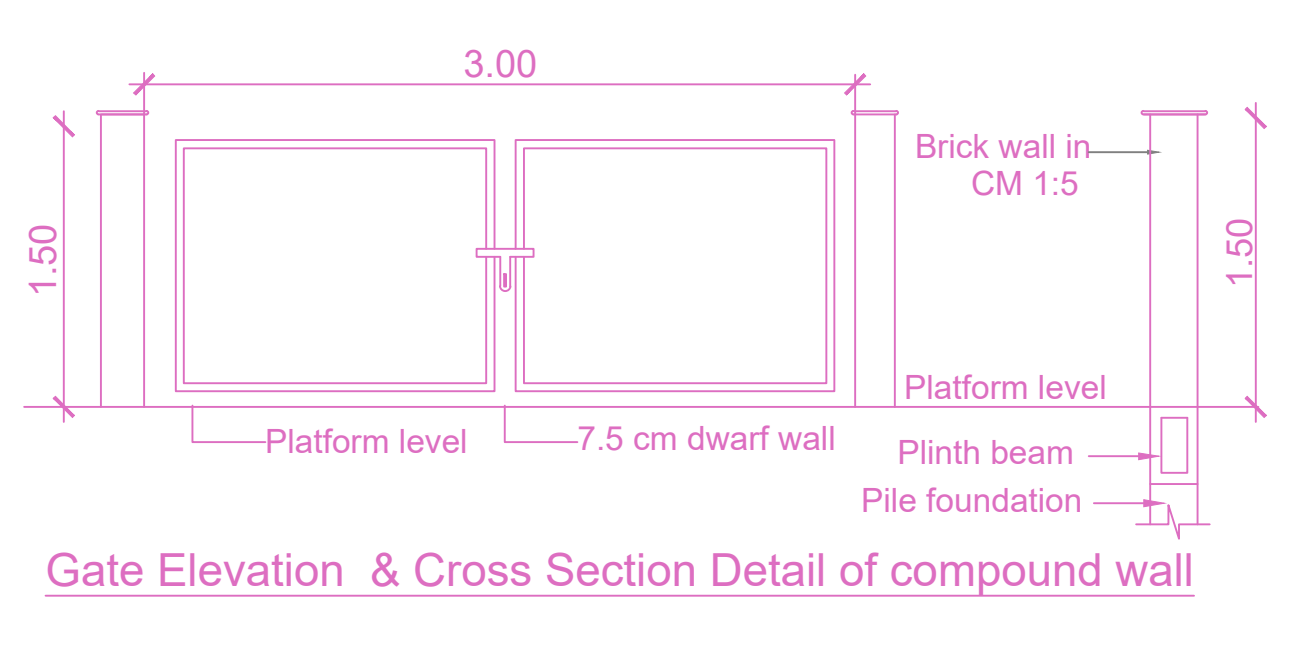

BUILDING WISE FSI STATEMENT

BUILDING	NO OF SAME BUILDING	FSI AREA				DU	TOTAL FSI AREA
		COMM.	RESI.	IND.	INST.		
Total		0.00	2318.04	0.00	0.00	20	2318.04
V-1 (BV)		0.00	2318.04	0.00	0.00	20	2318.04

FLOOR WISE FSI STATEMENT-V (BV)

FLOORS	FSI AREA				DU	TOTAL FSI AREA
	COMM.	RESI.	IND.	INST.		
STILT PARKING FLOOR	0.00	28.24	0.00	0.00	0	28.24
FIRST FLOOR	0.00	457.96	0.00	0.00	4	457.96
SECOND FLOOR	0.00	457.96	0.00	0.00	4	457.96
THIRD FLOOR	0.00	457.96	0.00	0.00	4	457.96
FOURTH FLOOR	0.00	457.96	0.00	0.00	4	457.96
FIFTH FLOOR	0.00	457.96	0.00	0.00	4	457.96
Terrace	0.00	0.00	0.00	0.00	0	0.00
Total	0.00	2318.04	0.00	0.00	20	2318.04

APPROVAL CONDITION

CHENNAI METROPOLITAN DEVELOPMENT AUTHORITY
APPROVED
SUBJECT TO THE CONDITIONS MENTIONED IN THIS OFFICE

SCALE: 1:100
KEY/KEY NO. 1788
QR CODE