

PLAN SHOWING THE PROPOSED CONSTRUCTION OF STILT + 4 FLOORS (HEIGHT-16.0m) RESIDENTIAL BUILDING WITH 4 DWELLING UNITS AT MUNICIPAL NEW DOOR NO.83, OLD NO.45, KASTHURI AVENUE, MRC NAGAR, RAJA ANNAMALAI PURAM, CHENNAI-600028, COMPRISED IN R.S.NO:4288/27 & 4288/28 (AS PER PATTA), BLOCK NO.94 OF MYLAPORE VILLAGE, MYLAPORE TALUK, CHENNAI DISTRICT WITHIN GREATER CHENNAI CORPORATION LIMIT

A) AREA STATEMENT	SQ.M.
AREA AS PER PATTA	316.50
AREA AS PER DOCUMENT	316.80
AREA CONSIDERED FOR FSI	316.50
STREET ALIGNMENT/ ROAD WIDENING/LINK ROAD	0.00
OSR AREA	0.00
TOTAL FSI AREA	555.36
FSI FACTOR	1.755
COVERAGE AREA (PERCENTAGE %)	NA

A) PARKING STATEMENT	REQUIRED	PROVIDED
VEHICLE	-	0
LORRY	-	0
CAR	4	4
TWO WHEELER	0	0
CYCLE	-	0

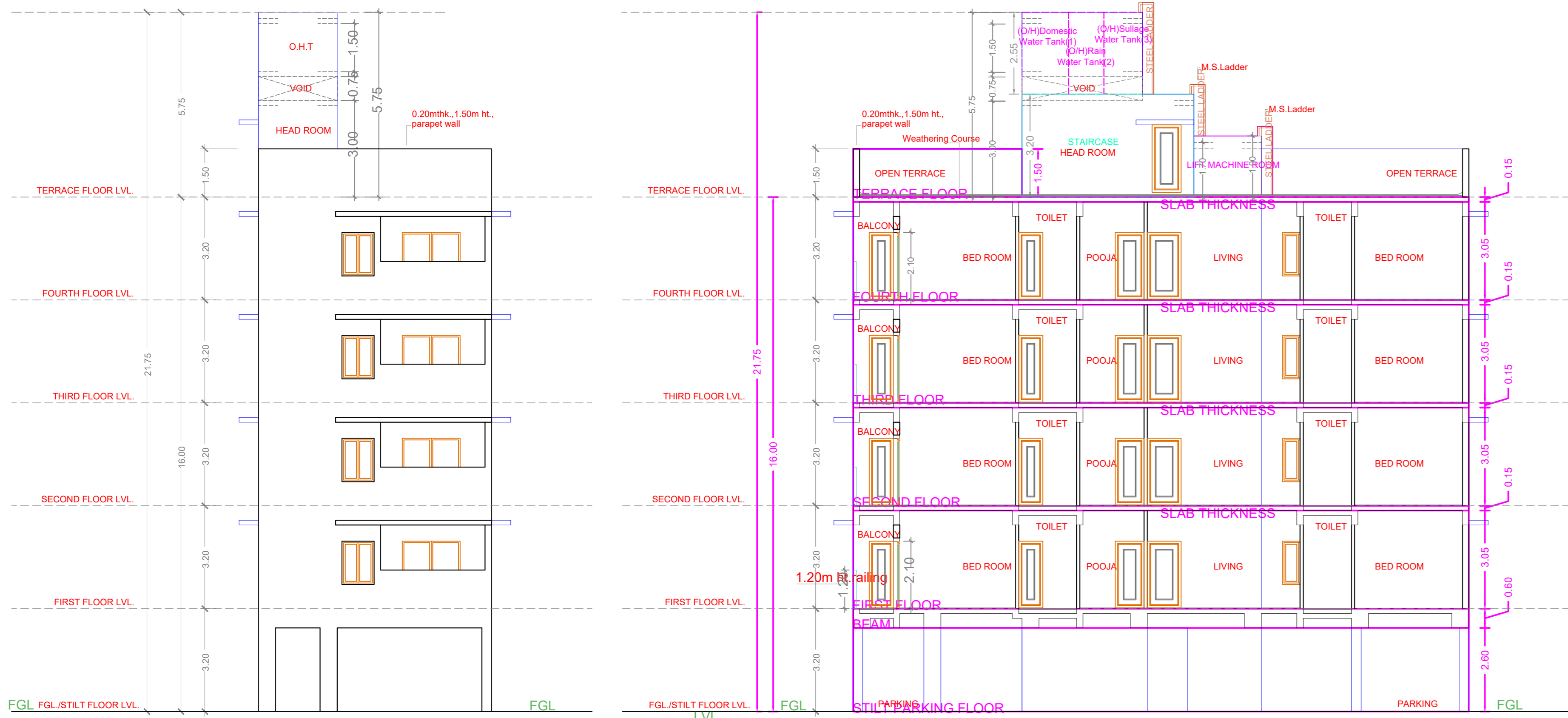

ELEVATION

SECTION : A - A

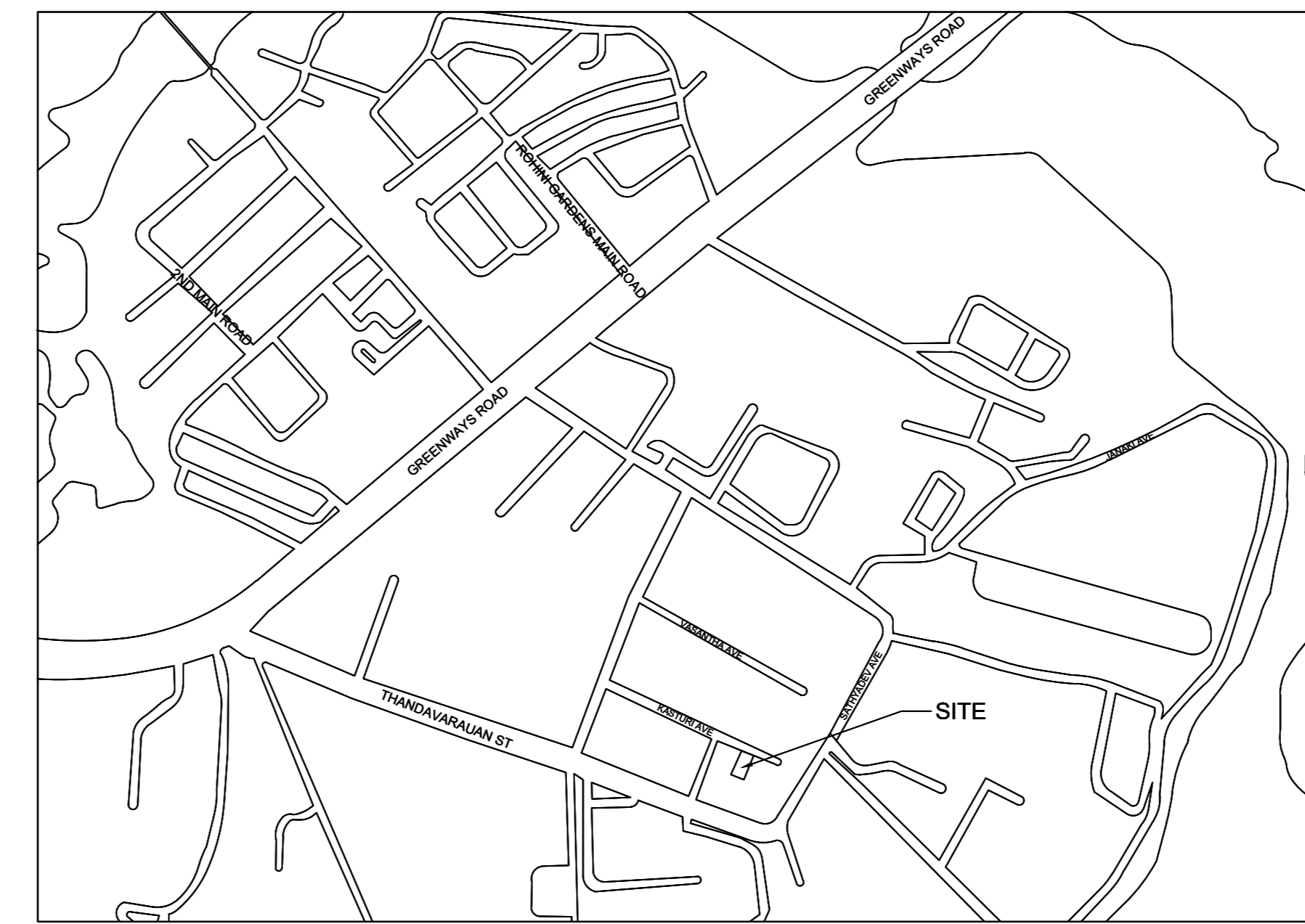

KEY PLAN (N.T.S)

Location plan (Taken as per User Inputs)

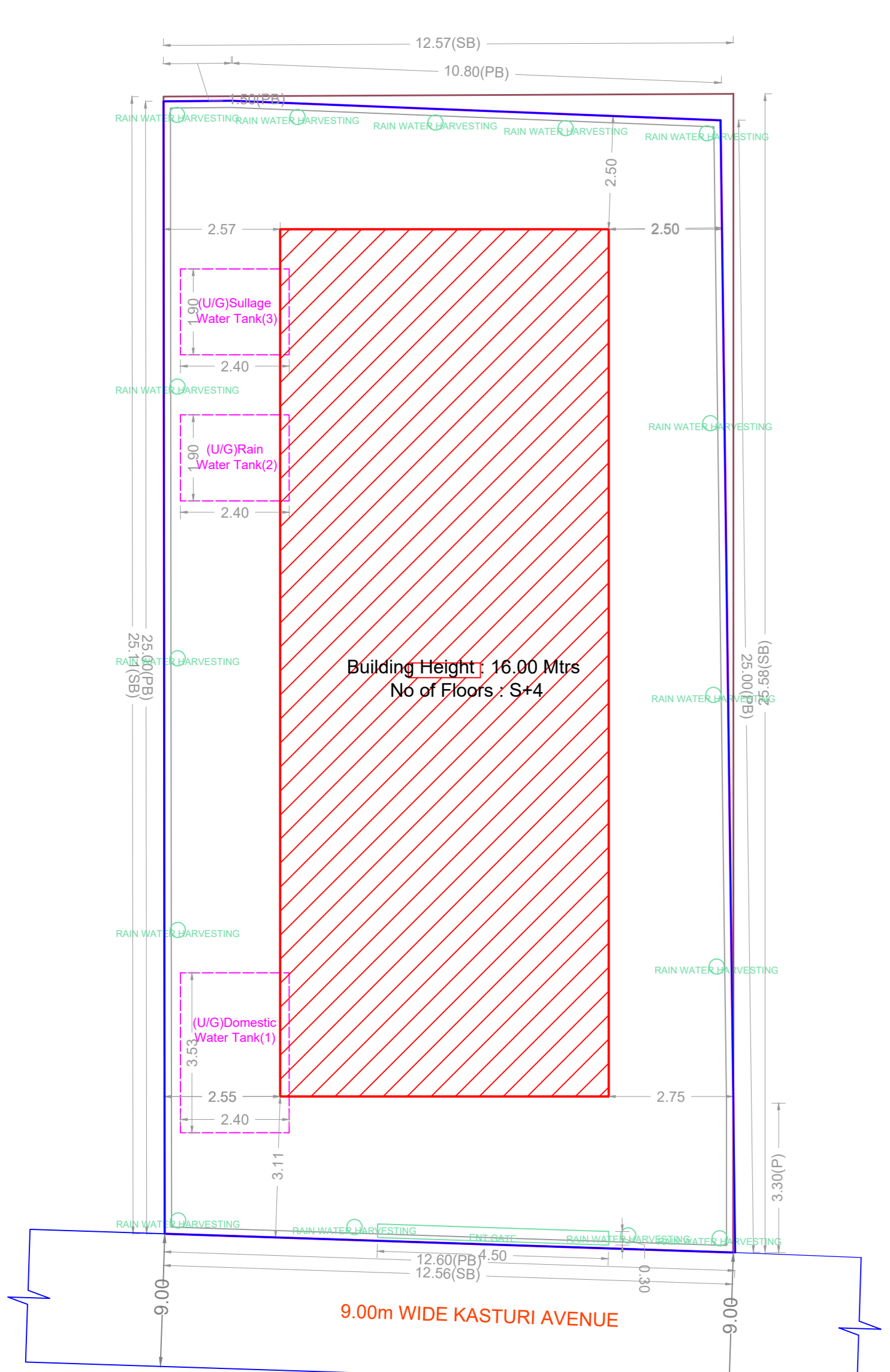
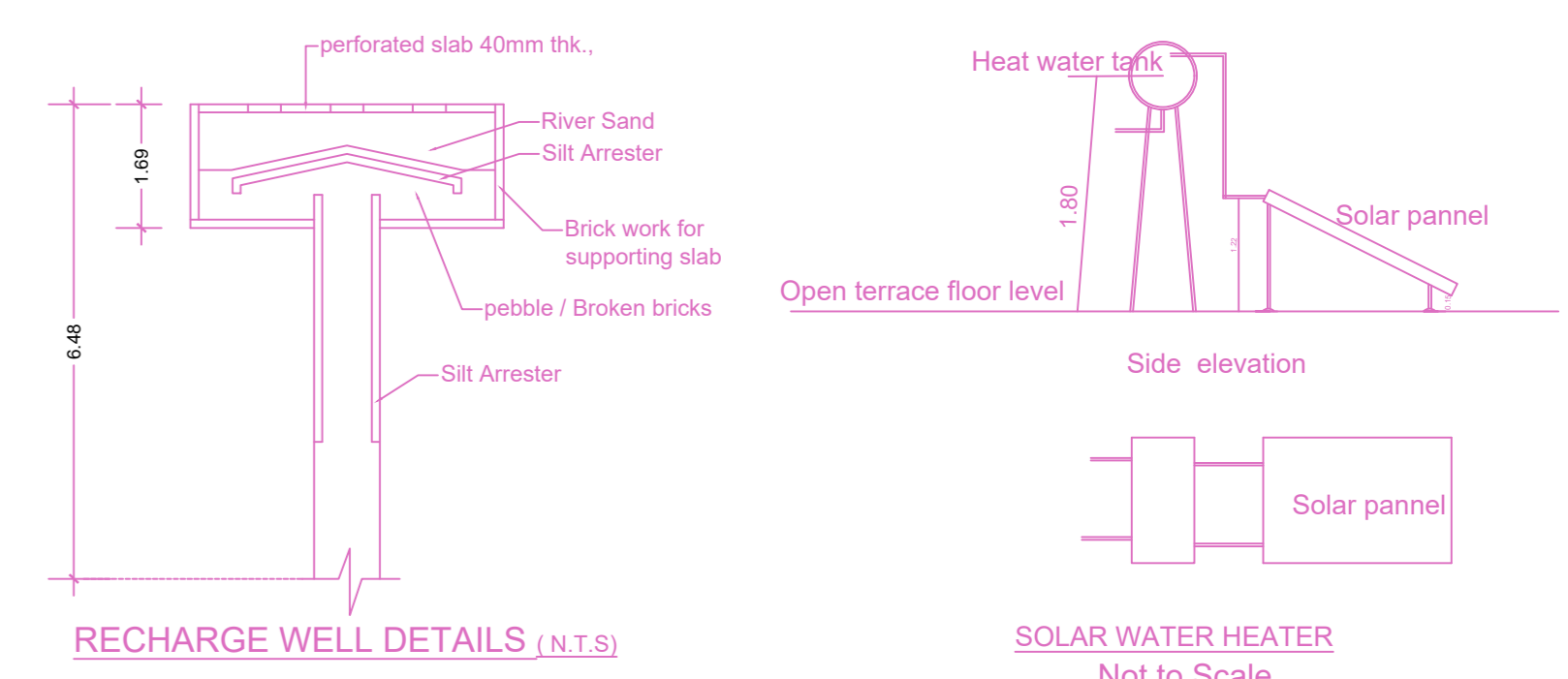
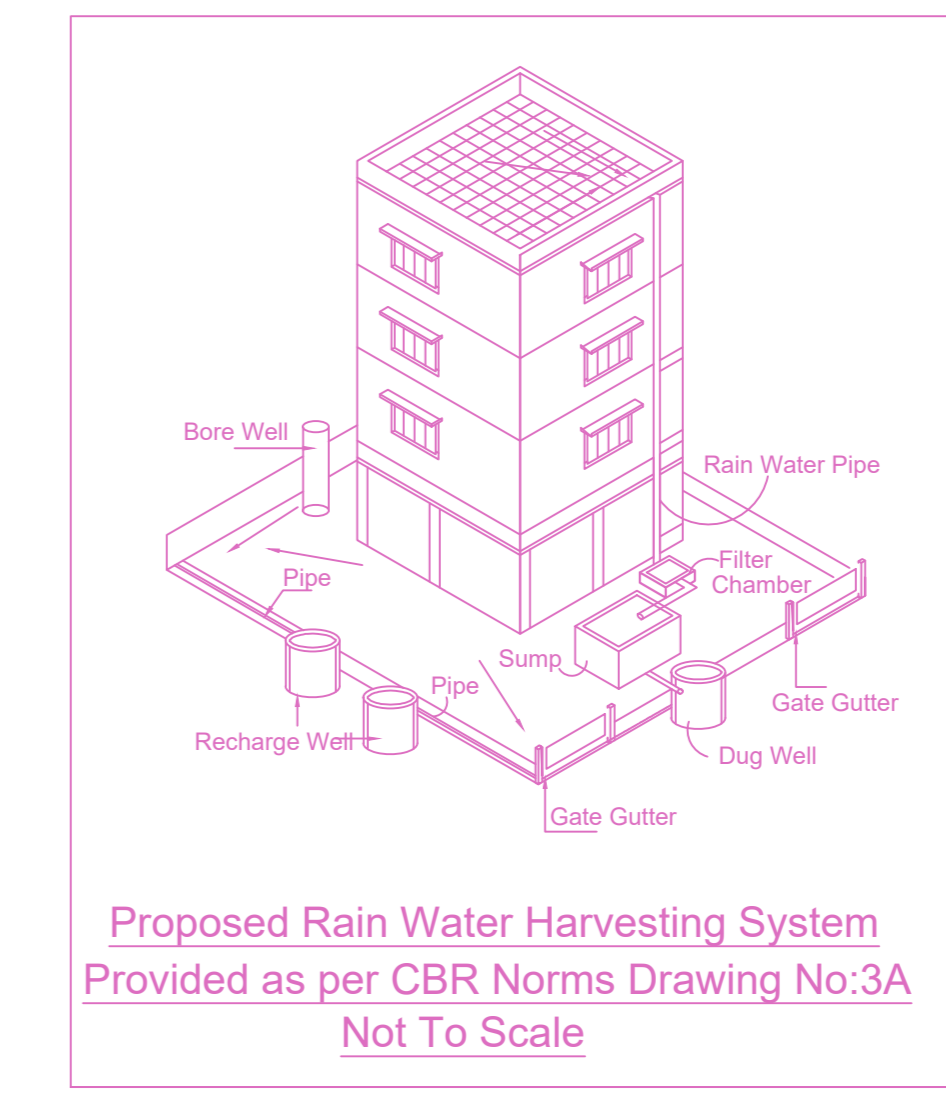

SITE PLAN

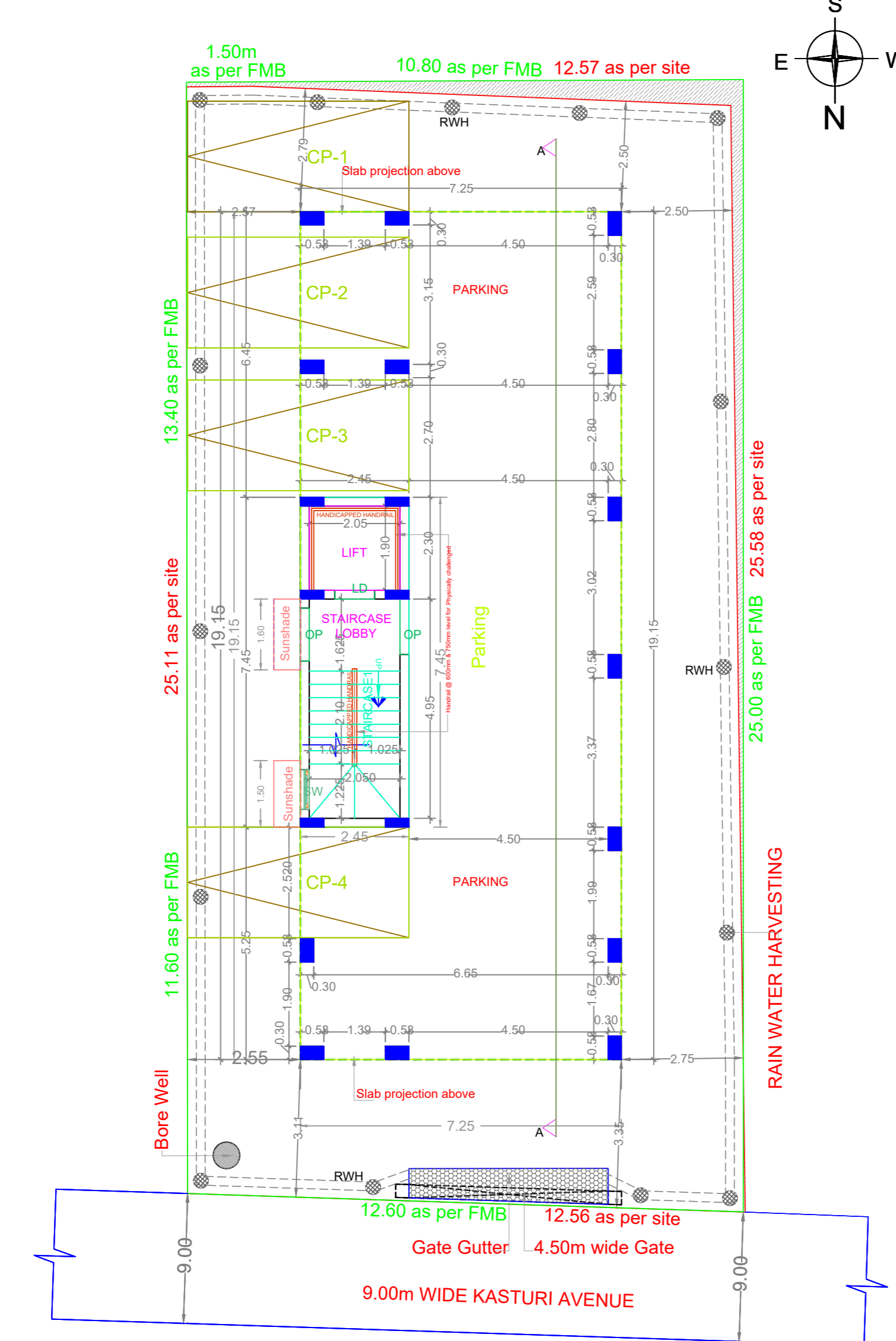

SITE CUM STILT FLOOR PLAN

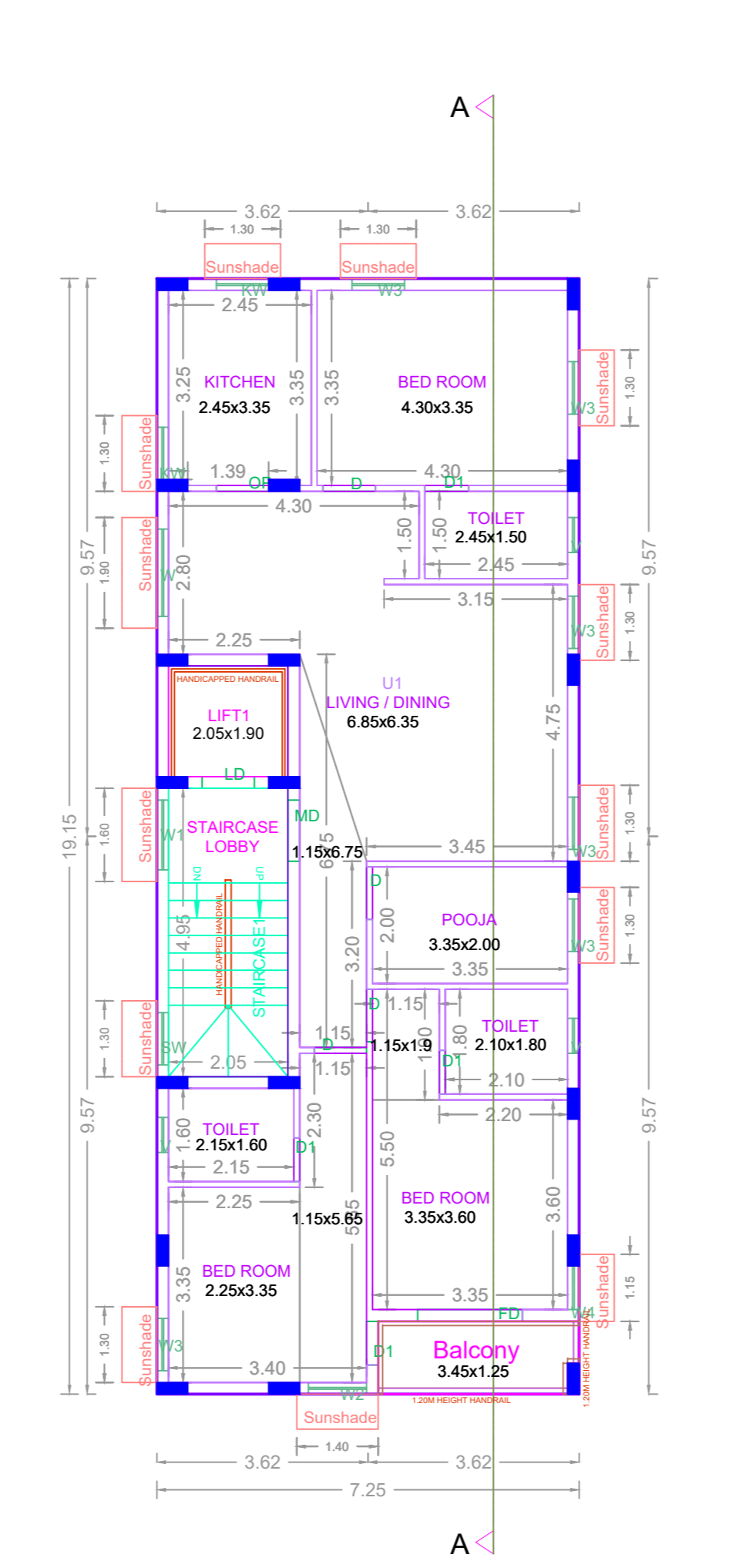

TYPICAL - 1, 2, 3 & 4 FLOOR PLAN

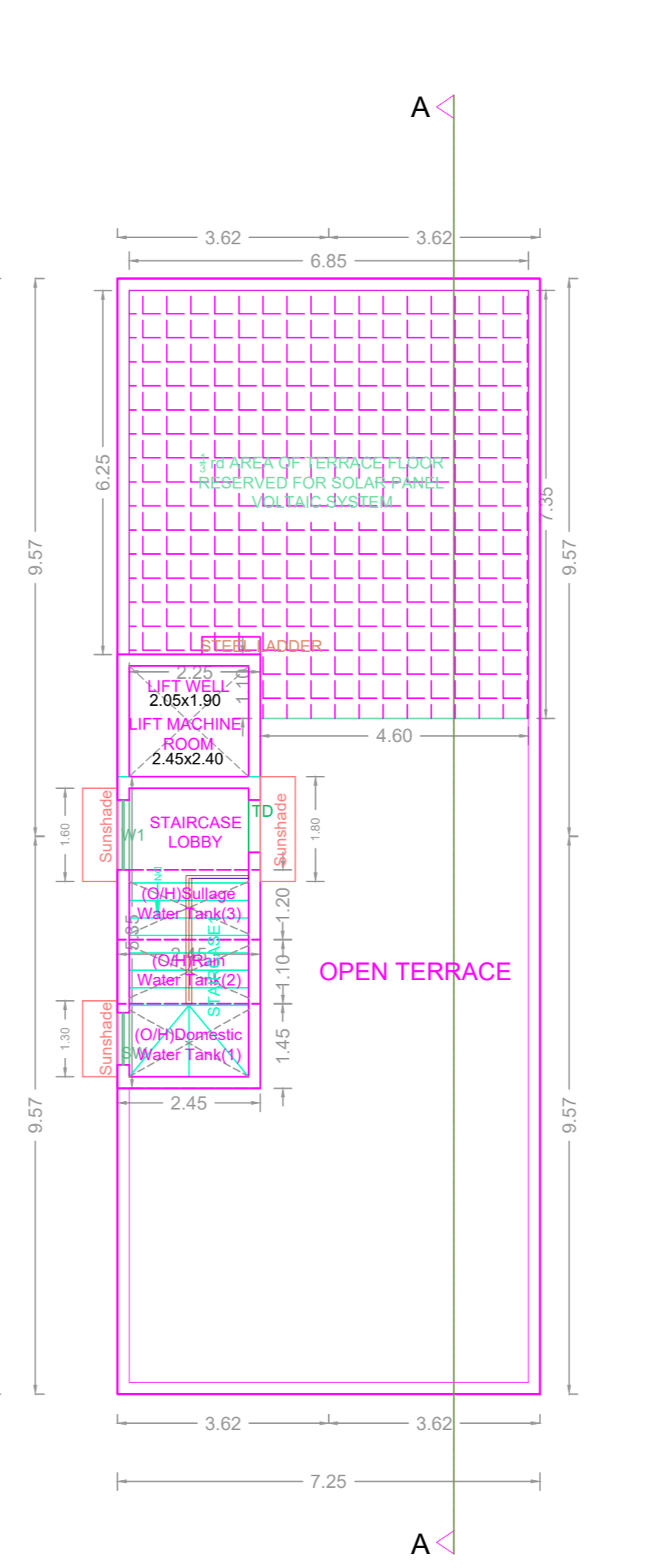

TERRACE FLOOR PLAN

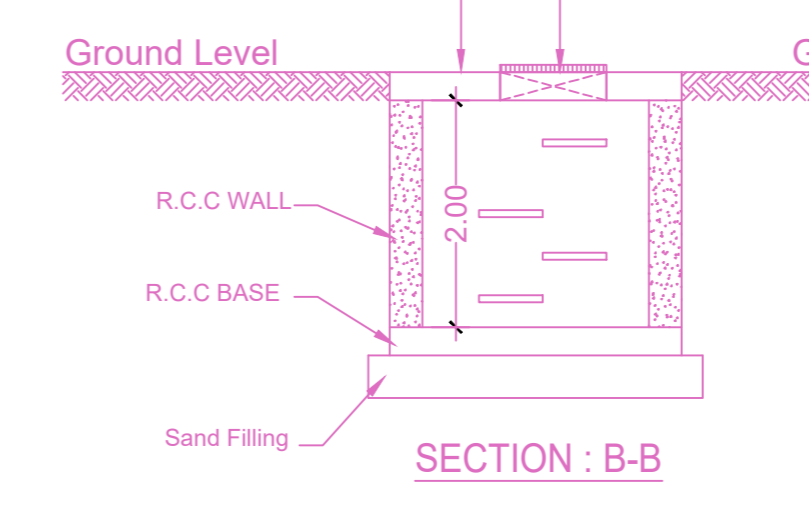
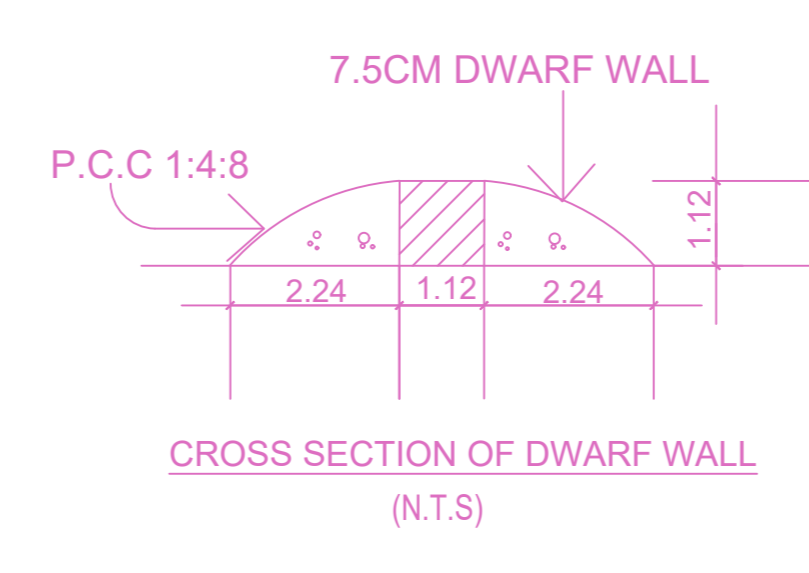

TYPICAL U.G SUMP FOR SULLAGE WATER & RAIN WATER

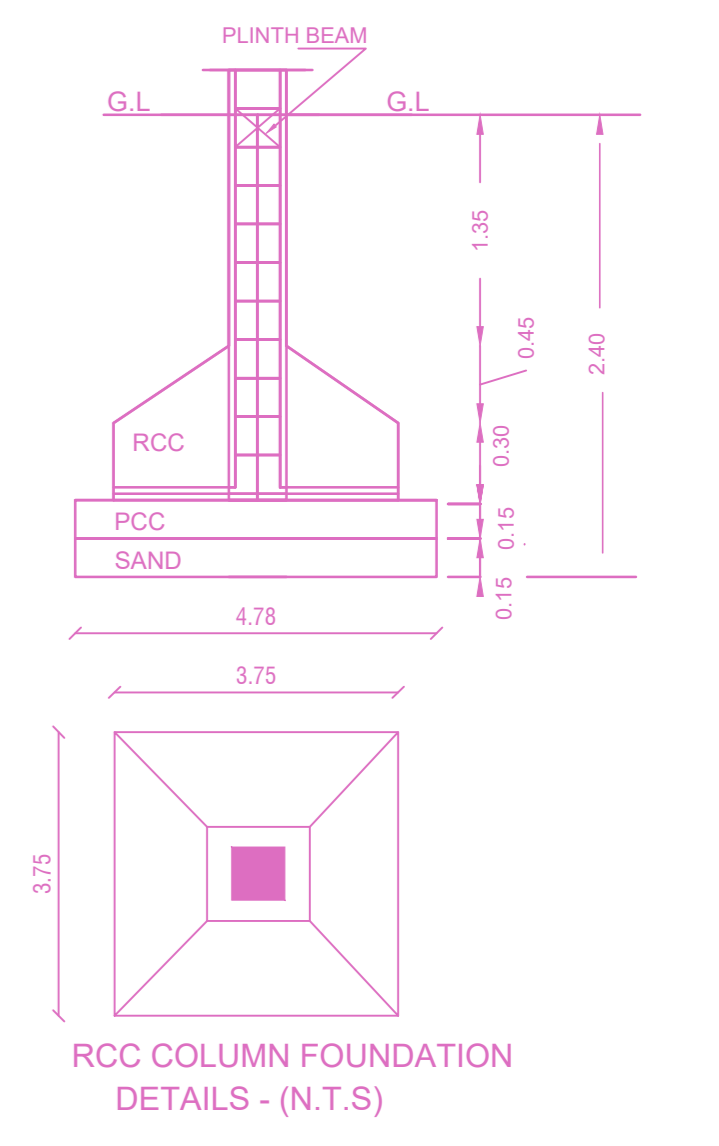
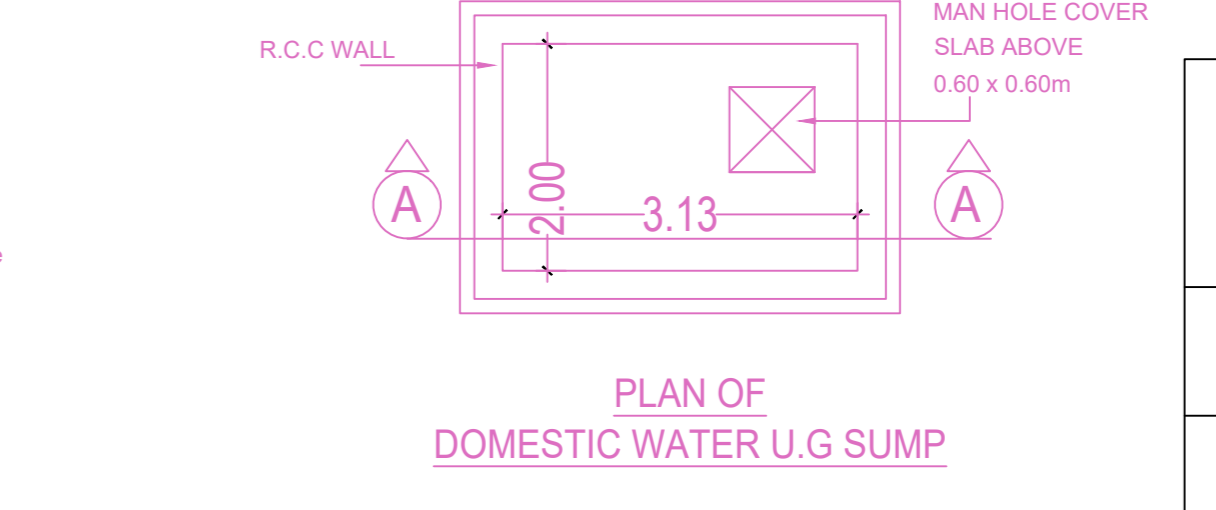
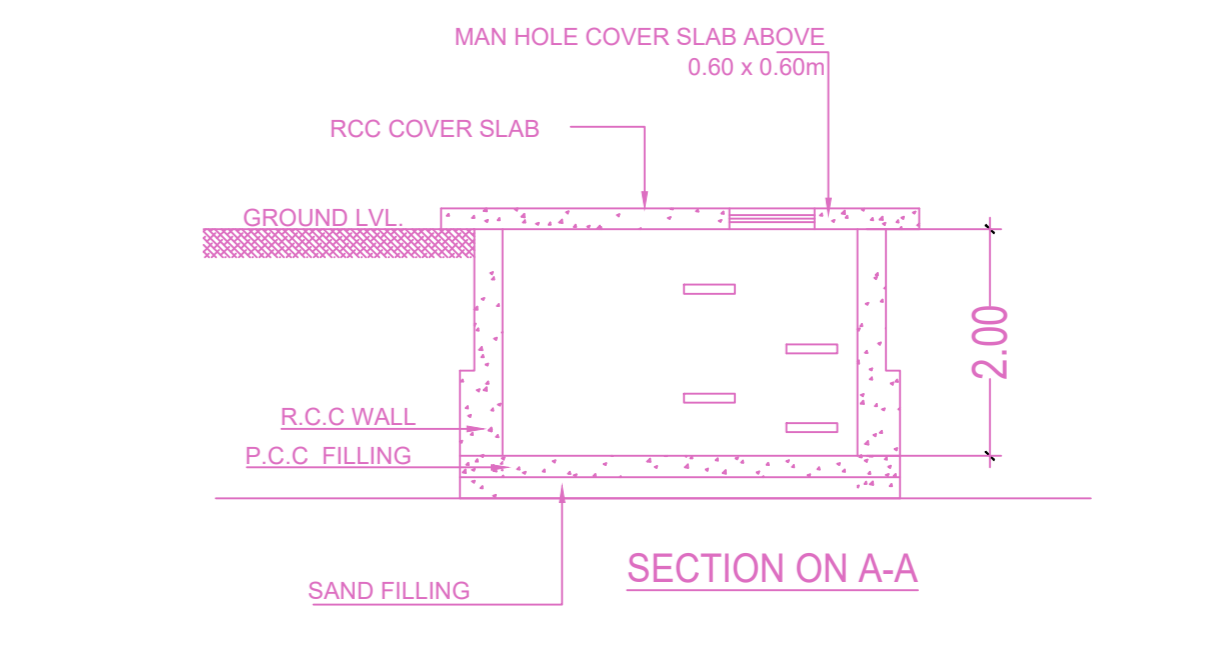
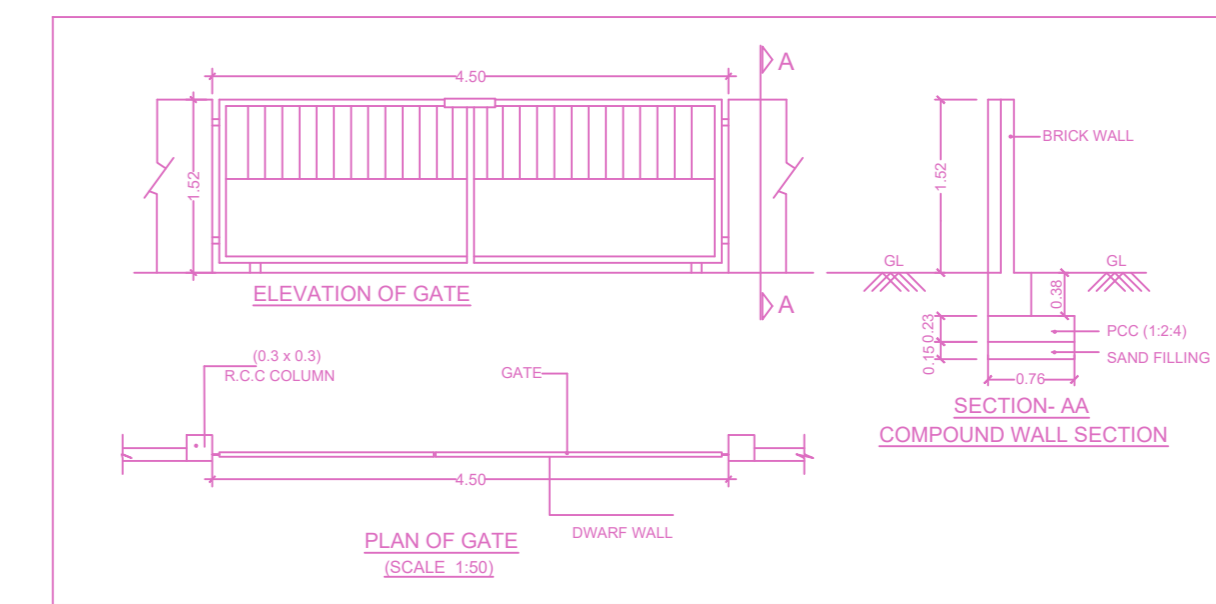

BUILDING WISE FSI STATEMENT

BUILDING	NO OF SAME BUILDING	FSI AREA				DU	TOTAL FSI AREA
		COMM.	RESI.	IND.	INST.		
MRC-1 (1)		0.00	555.36	0.00	0.00	4	555.36
Total		0.00	555.36	0.00	0.00	4	555.36

FLOOR WISE FSI STATEMENT: MRC (1)

FLOORS	FSI AREA				DU	TOTAL FSI AREA
	COMM.	RESI.	IND.	INST.		
STILT PARKING FLOOR	0.00	0.00	0.00	0.00	0	0.00
FIRST FLOOR	0.00	138.84	0.00	0.00	1	138.84
SECOND FLOOR	0.00	138.84	0.00	0.00	1	138.84
THIRD FLOOR	0.00	138.84	0.00	0.00	1	138.84
FOURTH FLOOR	0.00	138.84	0.00	0.00	1	138.84
Terrace	0.00	0.00	0.00	0.00	0	0.00
Total	0.00	555.36	0.00	0.00	4	555.36

APPROVAL CONDITION

FOR DEPUTY PLANNER
 MEMBER SECRETARY
 CHENNAI METROPOLITAN DEVELOPMENT AUTHORITY

SCALE 1:100

CHENNAI METROPOLITAN DEVELOPMENT AUTHORITY

APPROVED

SUBJECT TO THE CONDITIONS MENTIONED IN THIS OFFICE

FOR DEPUTY PLANNER
 MEMBER SECRETARY
 CHENNAI METROPOLITAN DEVELOPMENT AUTHORITY

For (Deputy Planner / Chief Planner / Member-Secretary)
 High Rise Building / Non High Rise Building
 This Approval is valid only after building Permit is issued by the concerned Local Body.

KEY NO. 8688 QR CODE