

FRONT ELEVATION

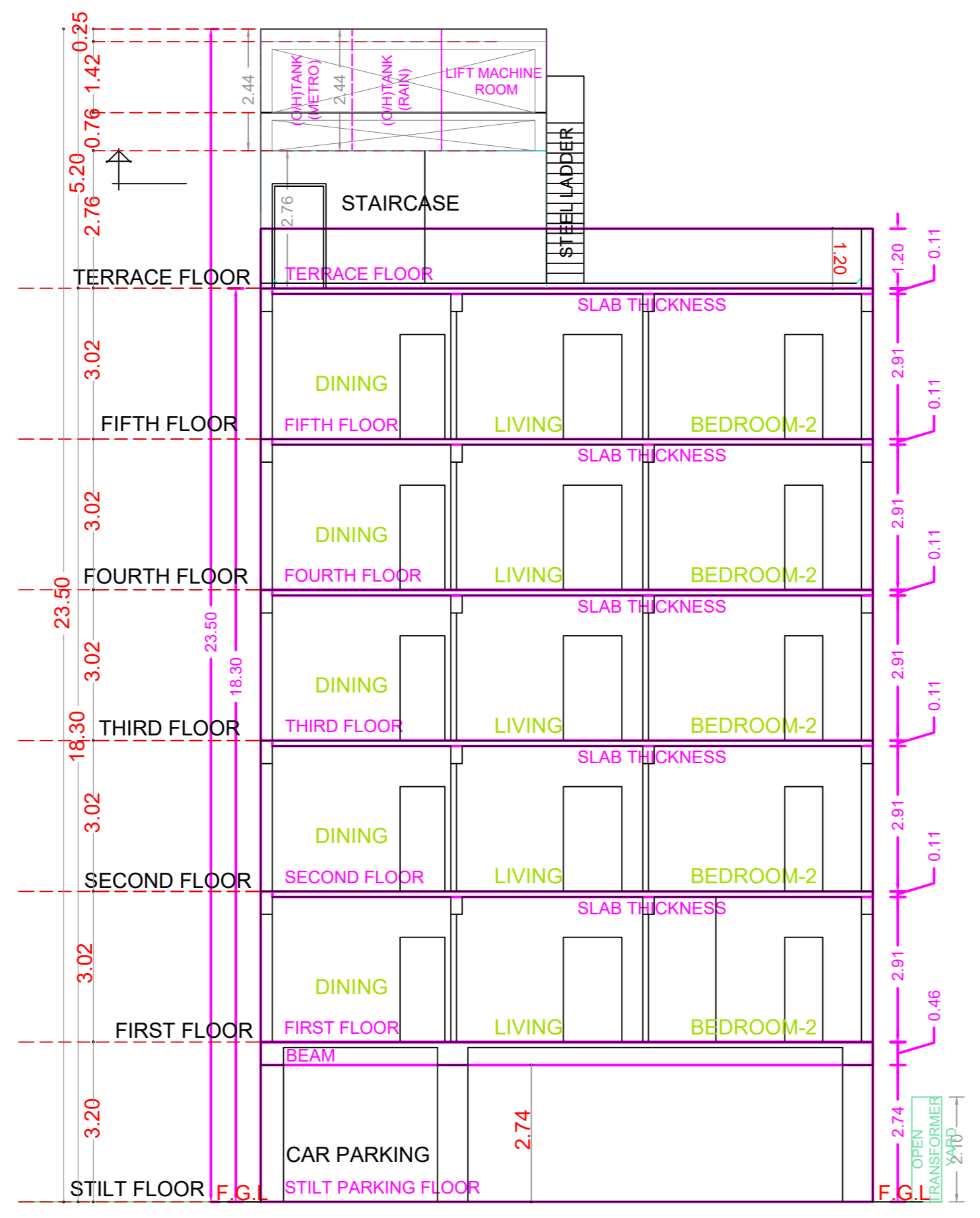

SECTION-AA

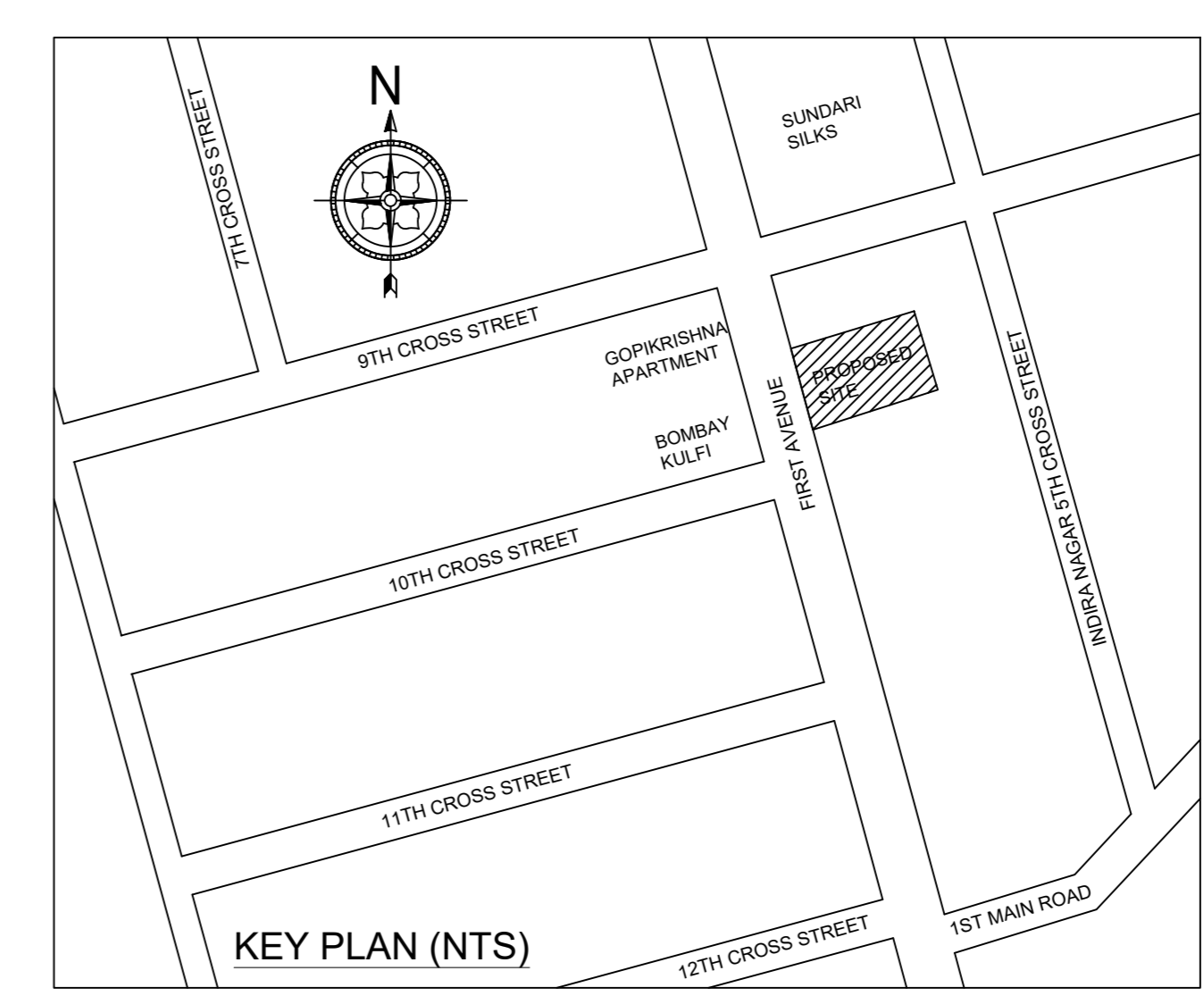
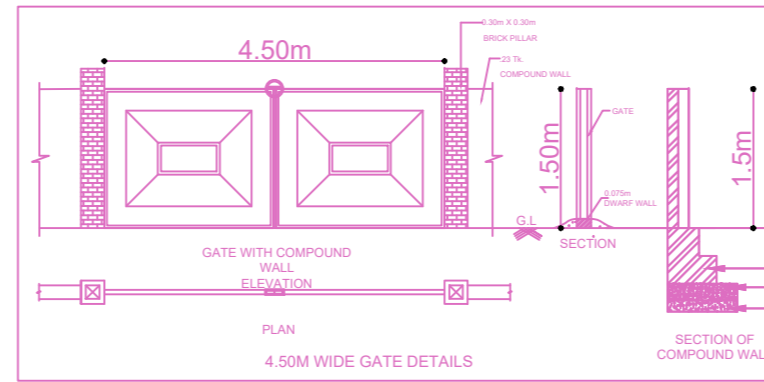
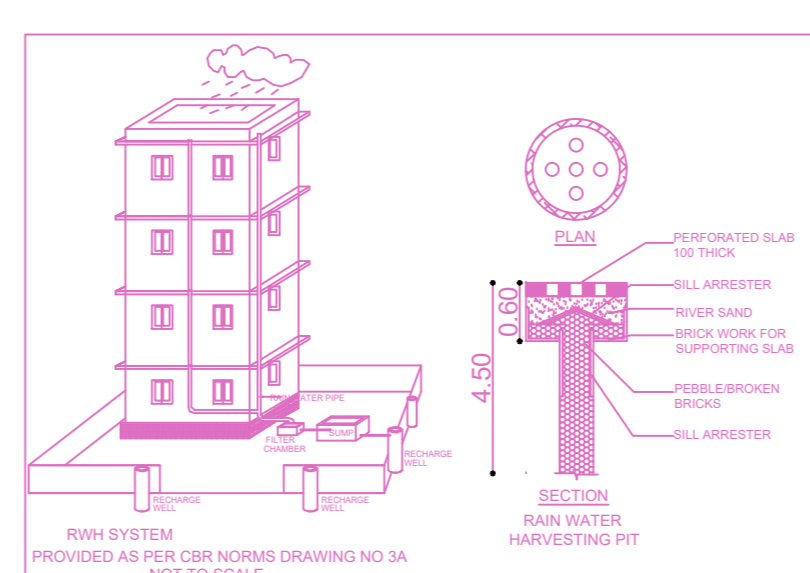
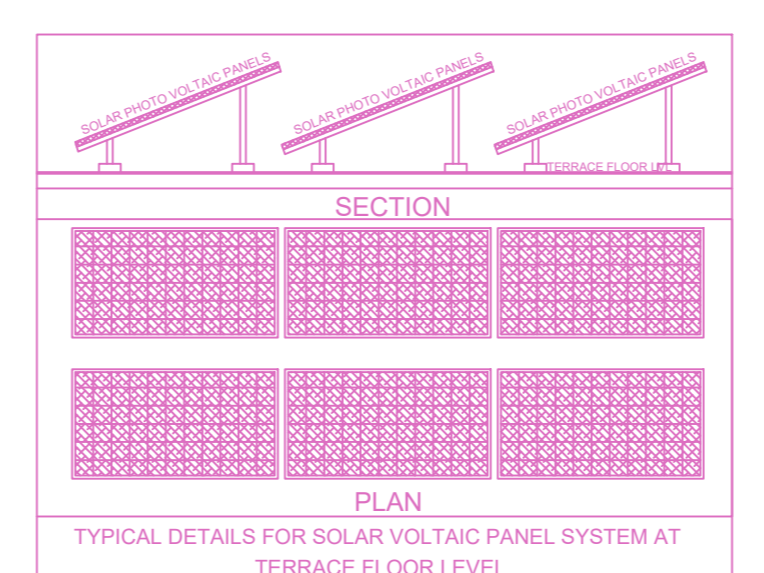
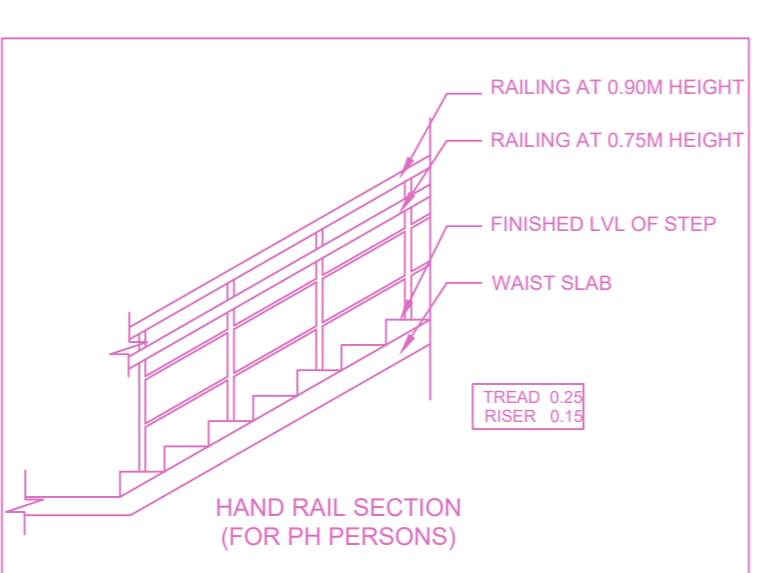
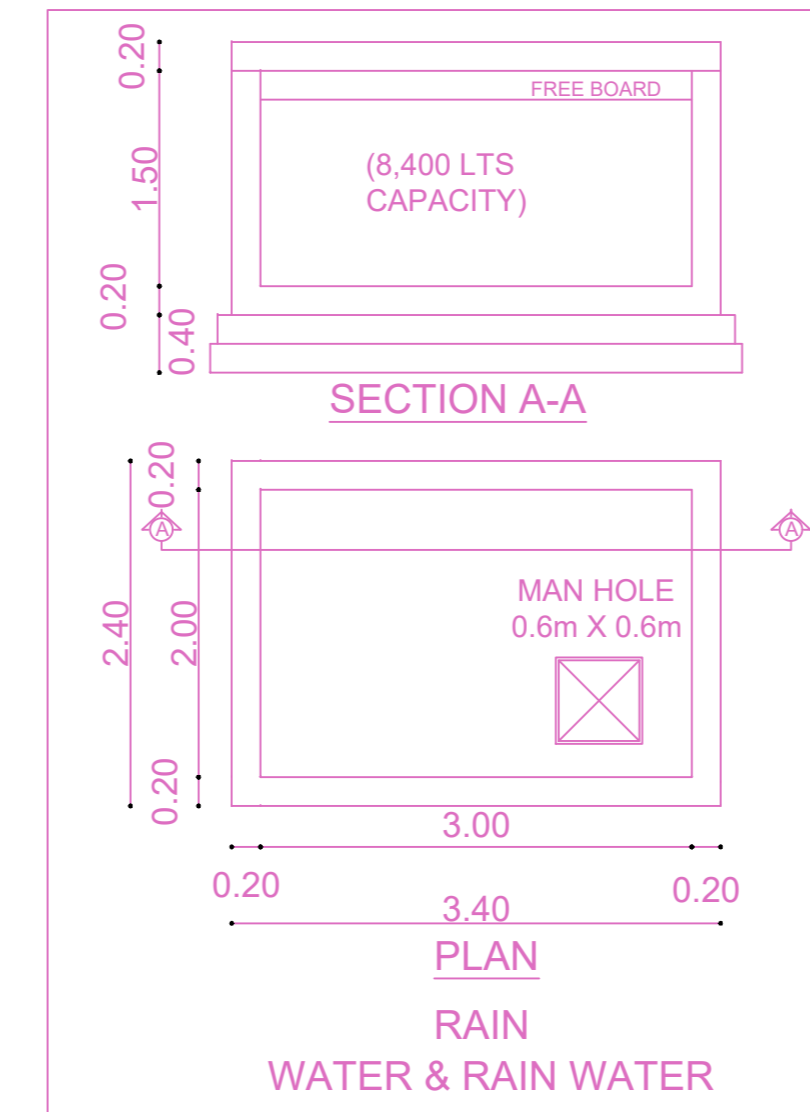
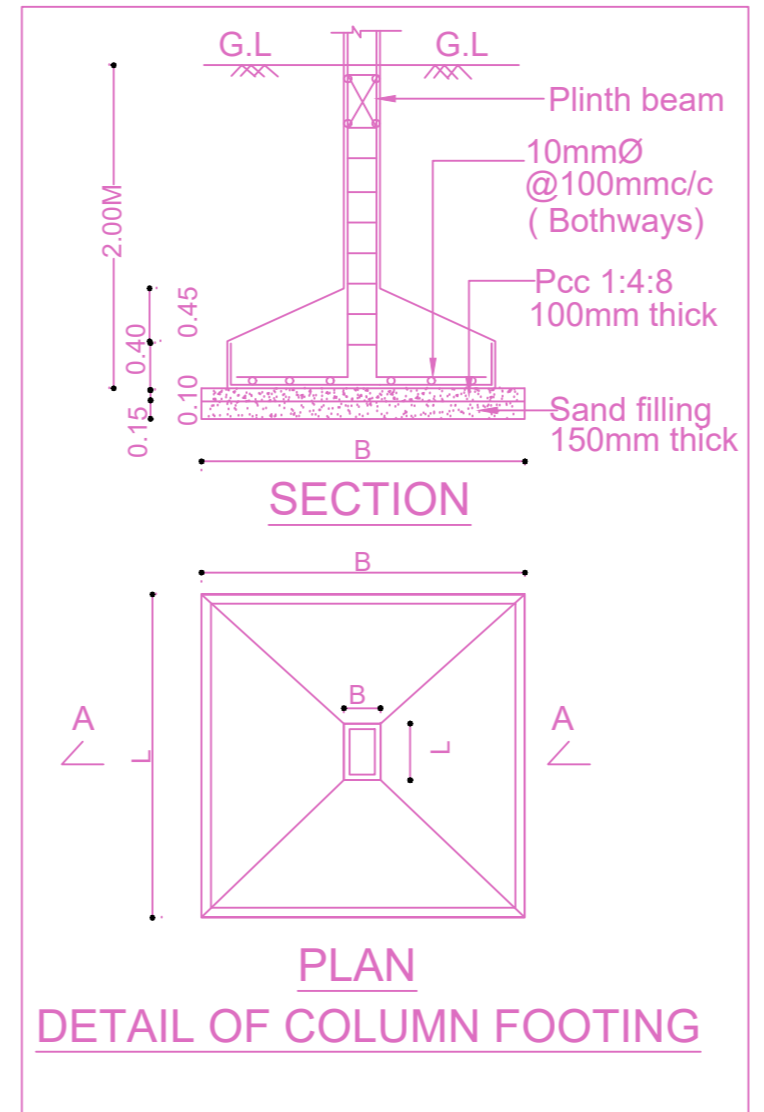
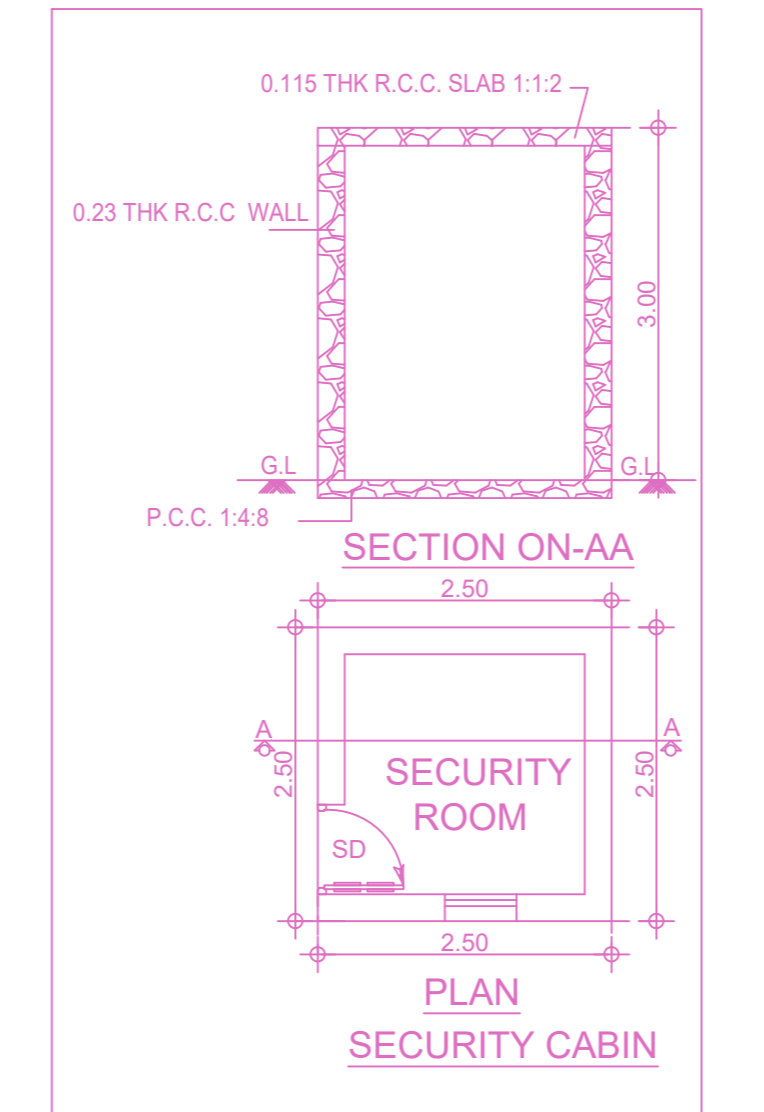

Location plan (Taken as per User Inputs)

PLAN SHOWING THE PROPOSED CONSTRUCTION OF STILT FLOOR + 5 FLOORS RESIDENTIAL BUILDING WITH 10 DWELLING UNITS (WITH HEIGHT 18.30M) AVALING PREMIUM FSI WITH TOD BENEFIT AT PLOT NO. 397, DOOR NO. 81/30, FIRST AVENUE, INDIRA NAGAR, ADYAR, CHENNAI-600 020 AND COMPRISED IN R.S. NO. 5/2 Part (AS PER DOCUMENT), AS PER PATTA NEW R.S. NO. 3, BLOCK NO. 15 OF KALKUNDRAM VILLAGE, VELACHERY TALUK AND WITHIN THE LIMITS OF GREATER CHENNAI CORPORATION.

A) AREA STATEMENT		SQ.M.
AREA AS PER PATTA		559.00
AREA AS PER DOCUMENT		557.41
AREA CONSIDERED FOR FSI		557.41
STREET ALIGNMENT/ ROAD WIDENING/LINK ROAD		0.00
OSR AREA		0.00
TOTAL FSI AREA		1407.15
FSI FACTOR		2.524
COVERAGE AREA (PERCENTAGE %)		281.43 (50.34%)

A) PARKING STATEMENT		
VEHICLE	REQUIRED	PROVIDED
LORRY	-	0
CAR	11	14
TWO WHEELER	0	0
CYCLE	-	0

FLOOR WISE FSI STATEMENT: A (RESIDENTIAL)

FLOORS	FSI AREA				DU	TOTAL FSI AREA
	COMM.	RESI.	IND.	INST.		
STILT PARKING FLOOR	0.00	0.00	0.00	0.00	0	0.00
FIRST FLOOR	0.00	281.43	0.00	0.00	2	281.43
SECOND FLOOR	0.00	281.43	0.00	0.00	2	281.43
THIRD FLOOR	0.00	281.43	0.00	0.00	2	281.43
FOURTH FLOOR	0.00	281.43	0.00	0.00	2	281.43
FIFTH FLOOR	0.00	281.43	0.00	0.00	2	281.43
Terrace	0.00	0.00	0.00	0.00	0	0.00
Total	0.00	1407.15	0.00	0.00	10	1407.15

BUILDING WISE FSI STATEMENT

BUILDING	NO OF SAME BUILDING	FSI AREA				DU	TOTAL FSI AREA
		COMM.	RESI.	IND.	INST.		
A-1 (RESIDE...)		0.00	1407.15	0.00	0.00	10	1407.15
Total		0.00	1407.15	0.00	0.00	10	1407.15

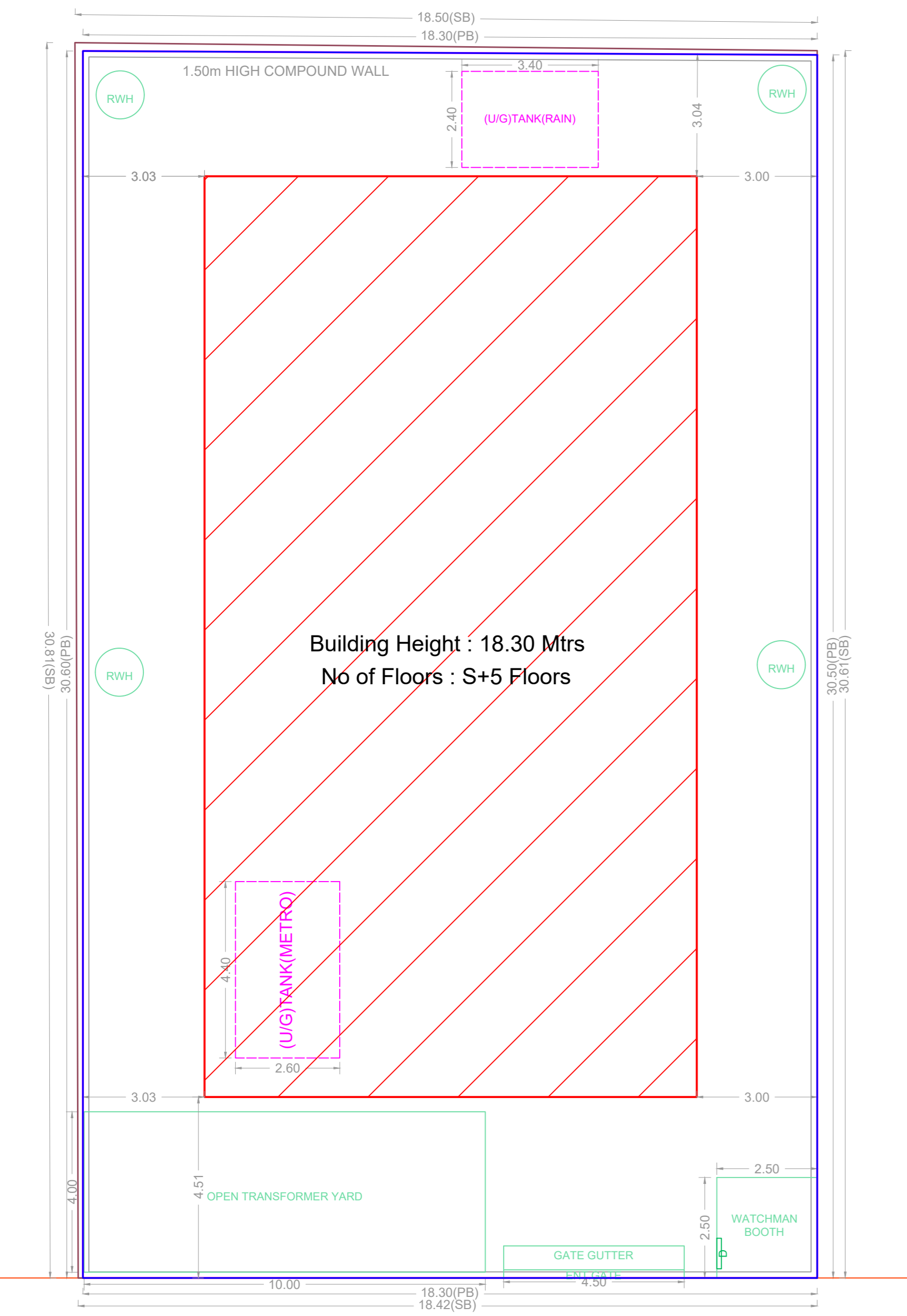

SITE PLAN

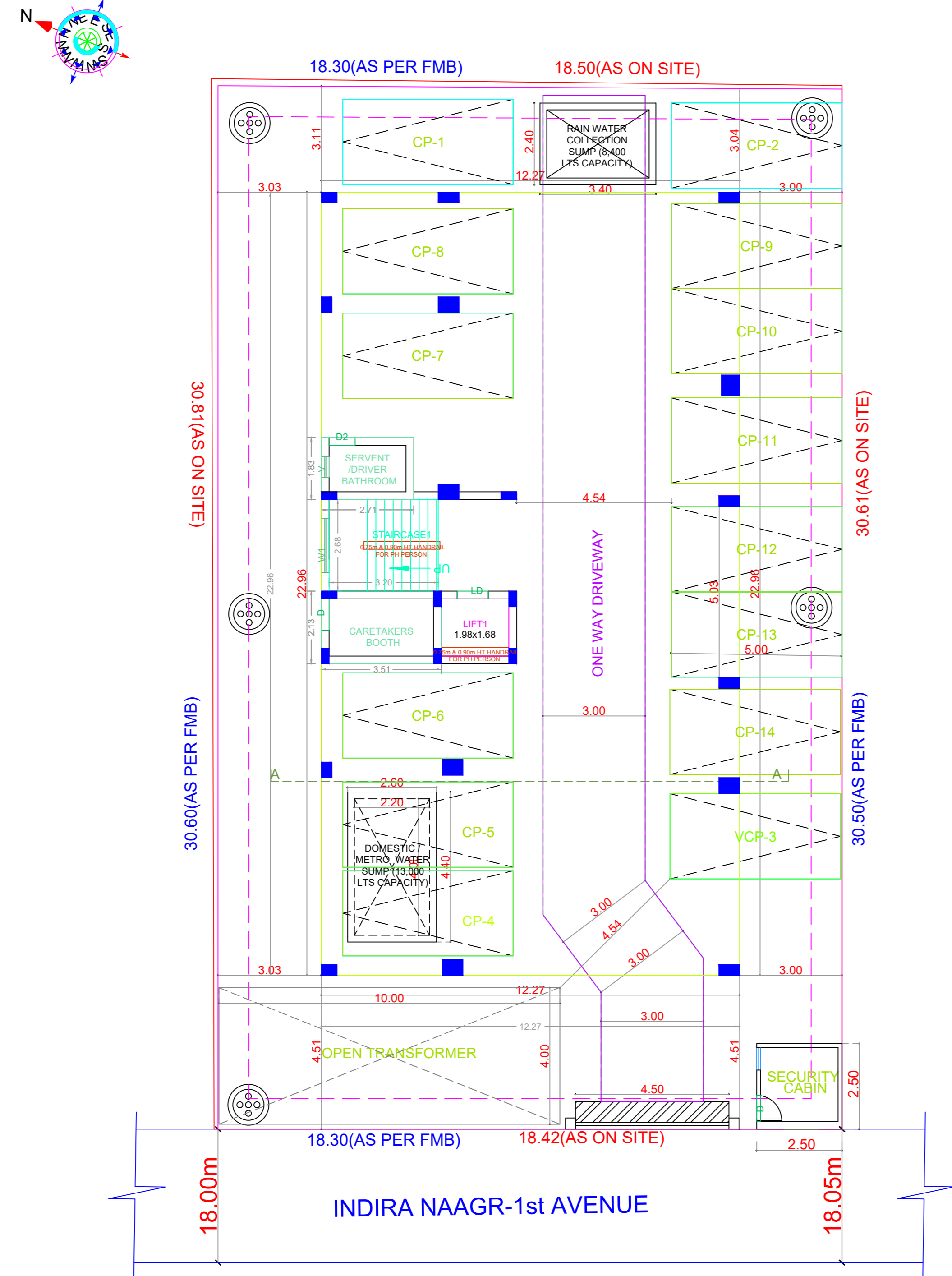

SITE CUM STILT FLOOR PLAN

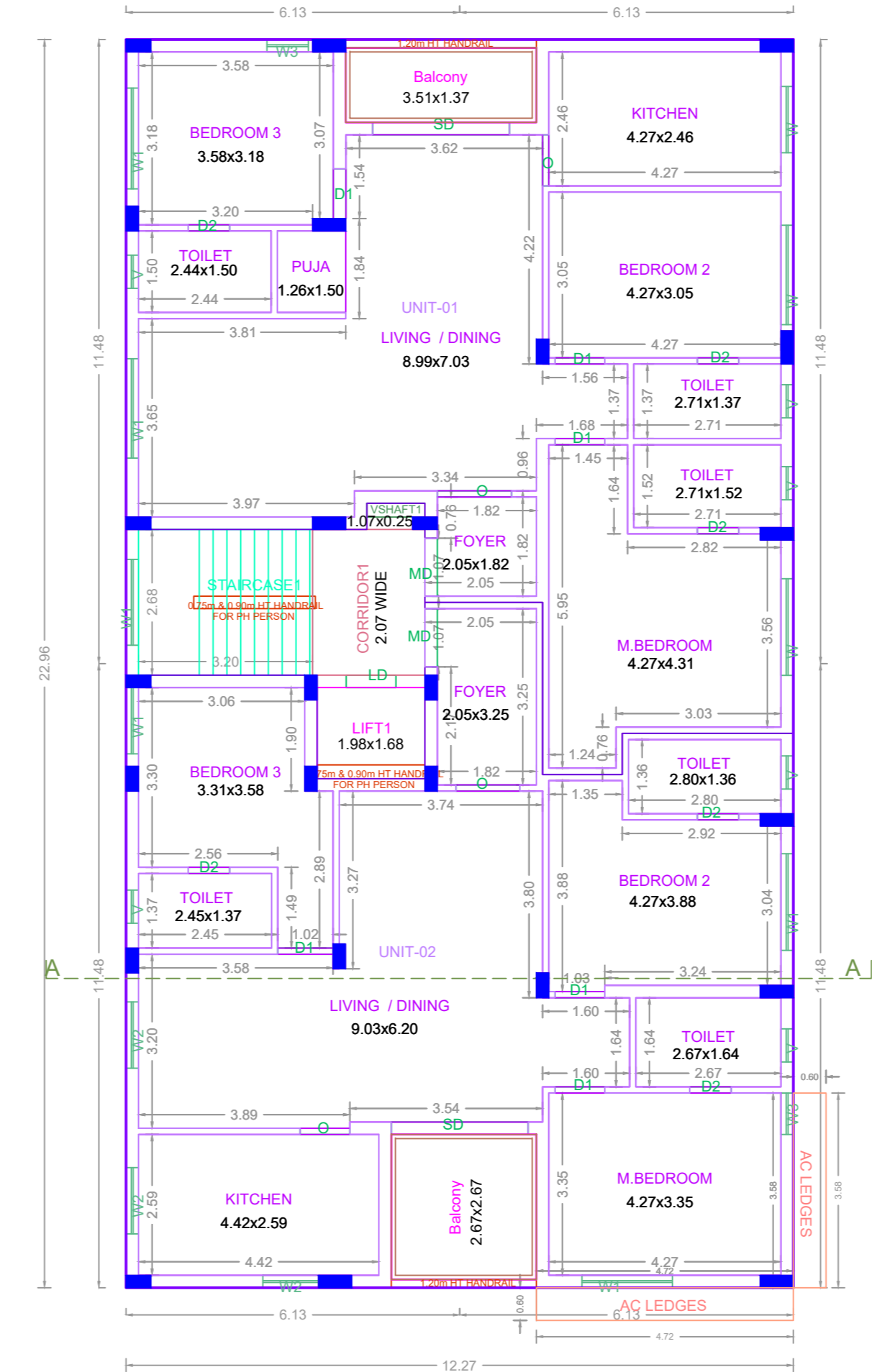

TYPICAL - 1-5 FLOOR PLAN

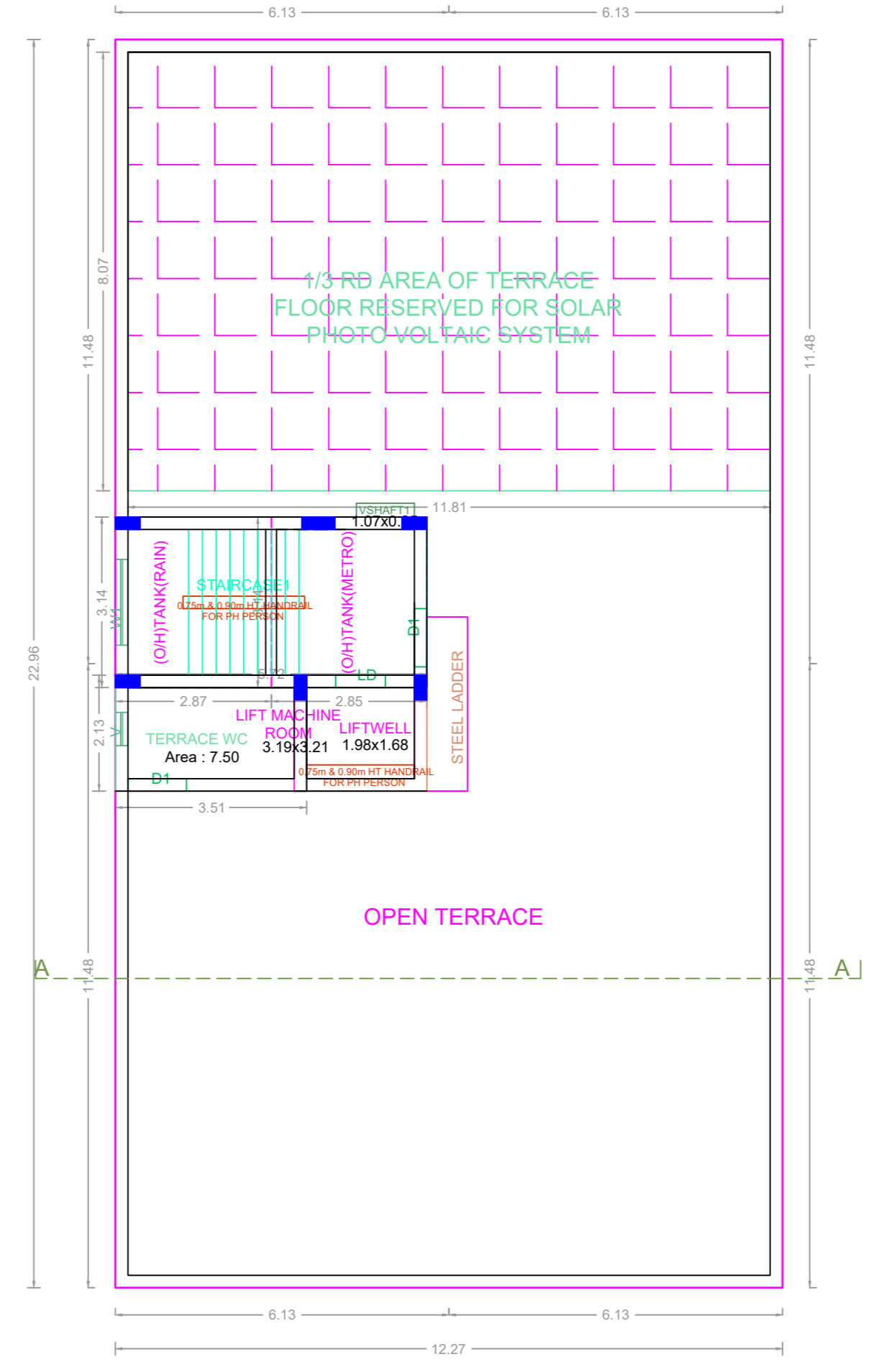

TERRACE FLOOR PLAN

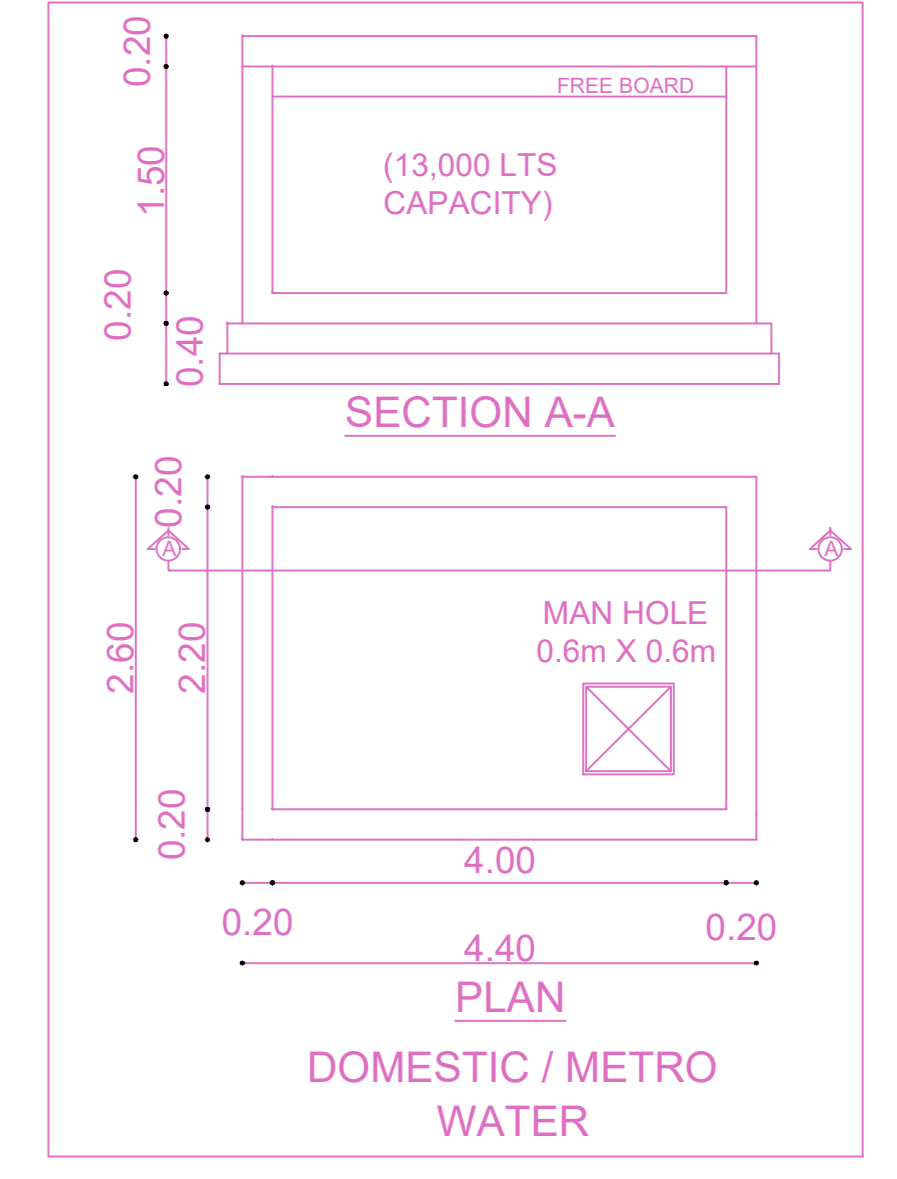

APPROVAL CONDITION

NO.	DESCRIPTION	STATUS
1
2
3
4
5

CHENNAI METROPOLITAN DEVELOPMENT AUTHORITY

APPROVED

SUBJECT TO THE CONDITIONS MENTIONED IN THIS OFFICE

For (Deputy Planner / Chief Planner / Member-Secretary)
High Rise Building / Non High Rise Building
This Approval is valid only after building Permit is issued by the concerned Local Body.

KEY NO. 5788

QR CODE