

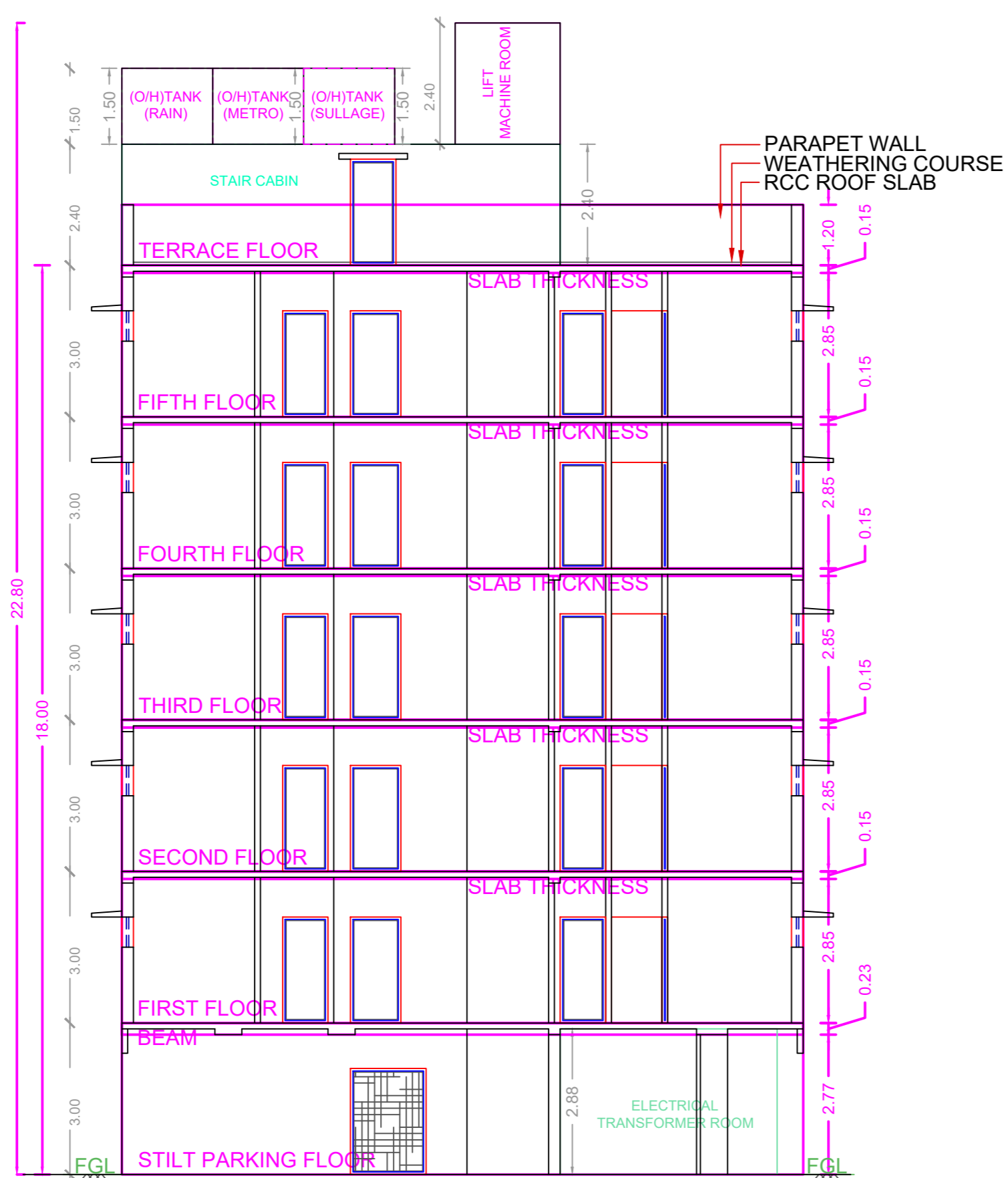

ELEVATION

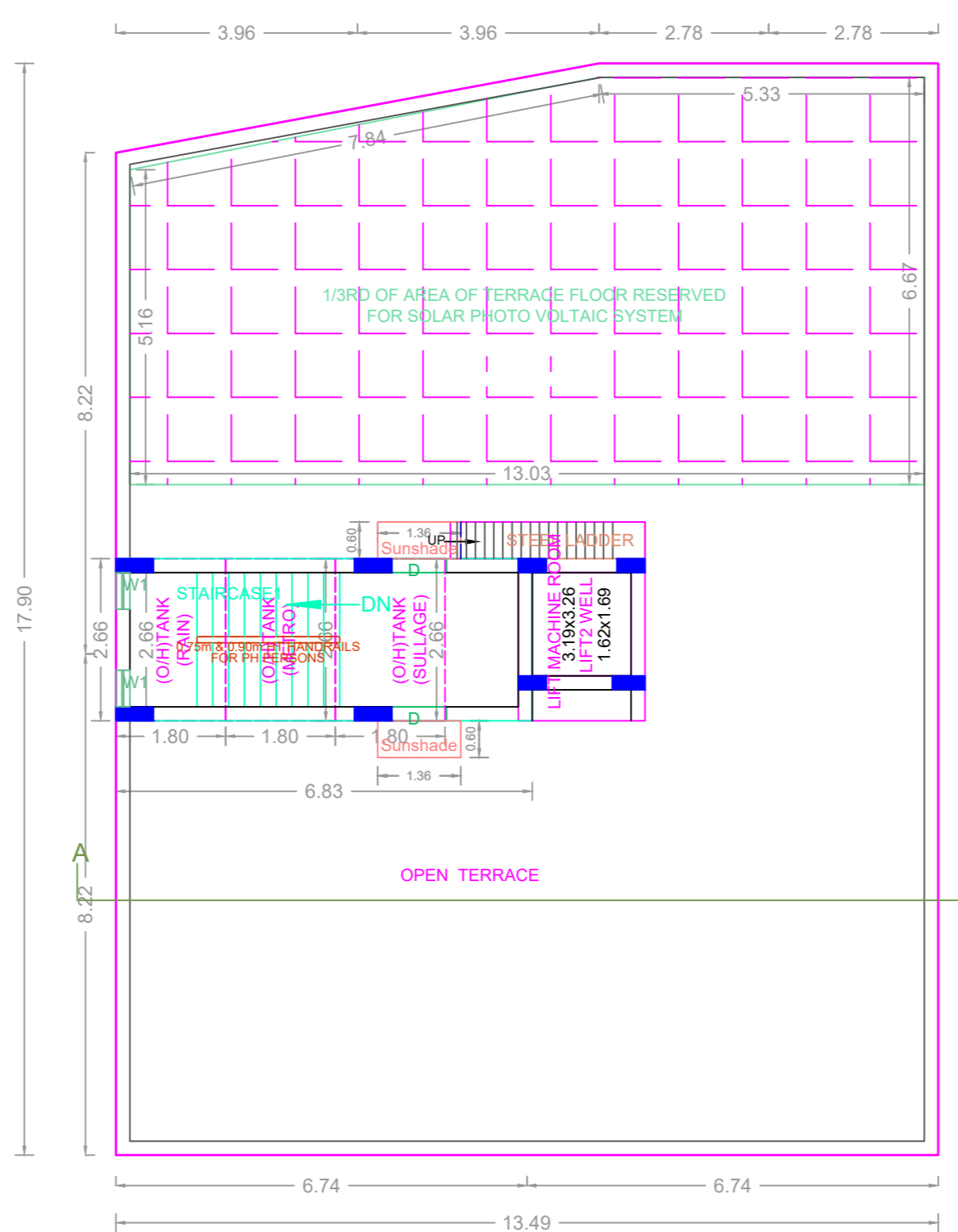

SECTION



TERRACE FLOOR PLAN

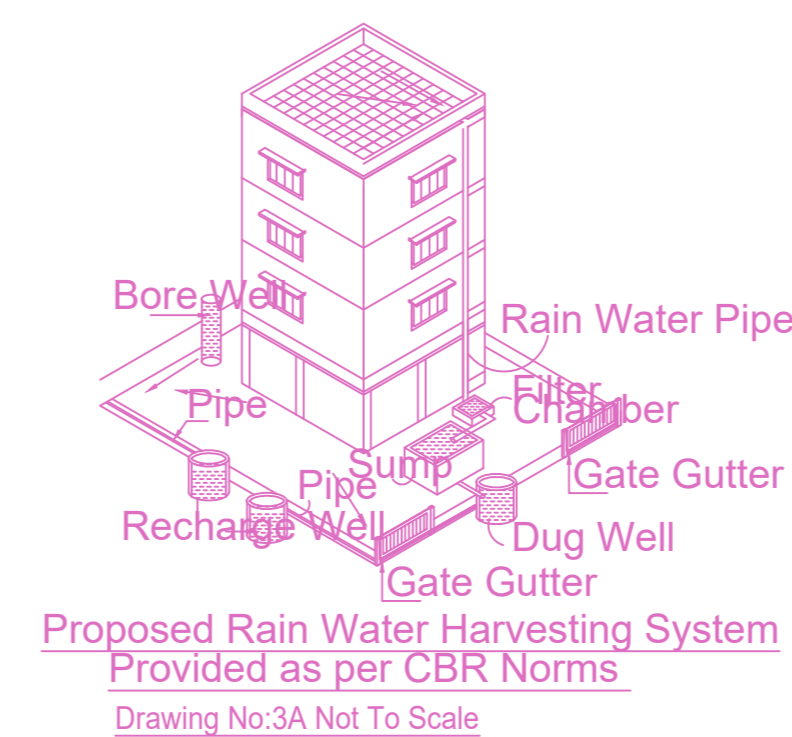

Proposed Rain Water Harvesting System Provided as per CBR Norms Drawing No:3A Not To Scale

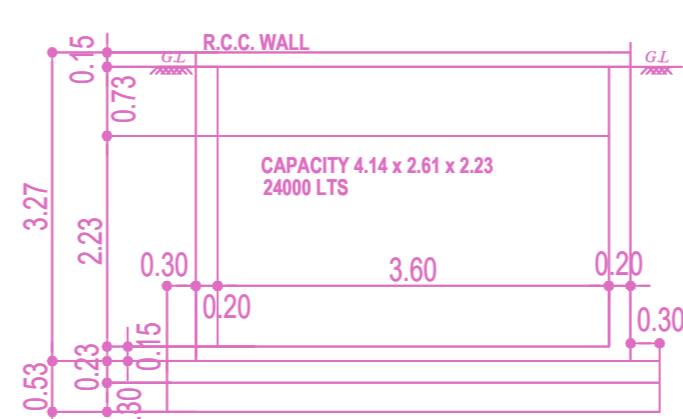

SECTION ON CC

TOP TO BE HERMETICALLY CLOSED

METRO WATER COLLECTION SUMP DETAIL

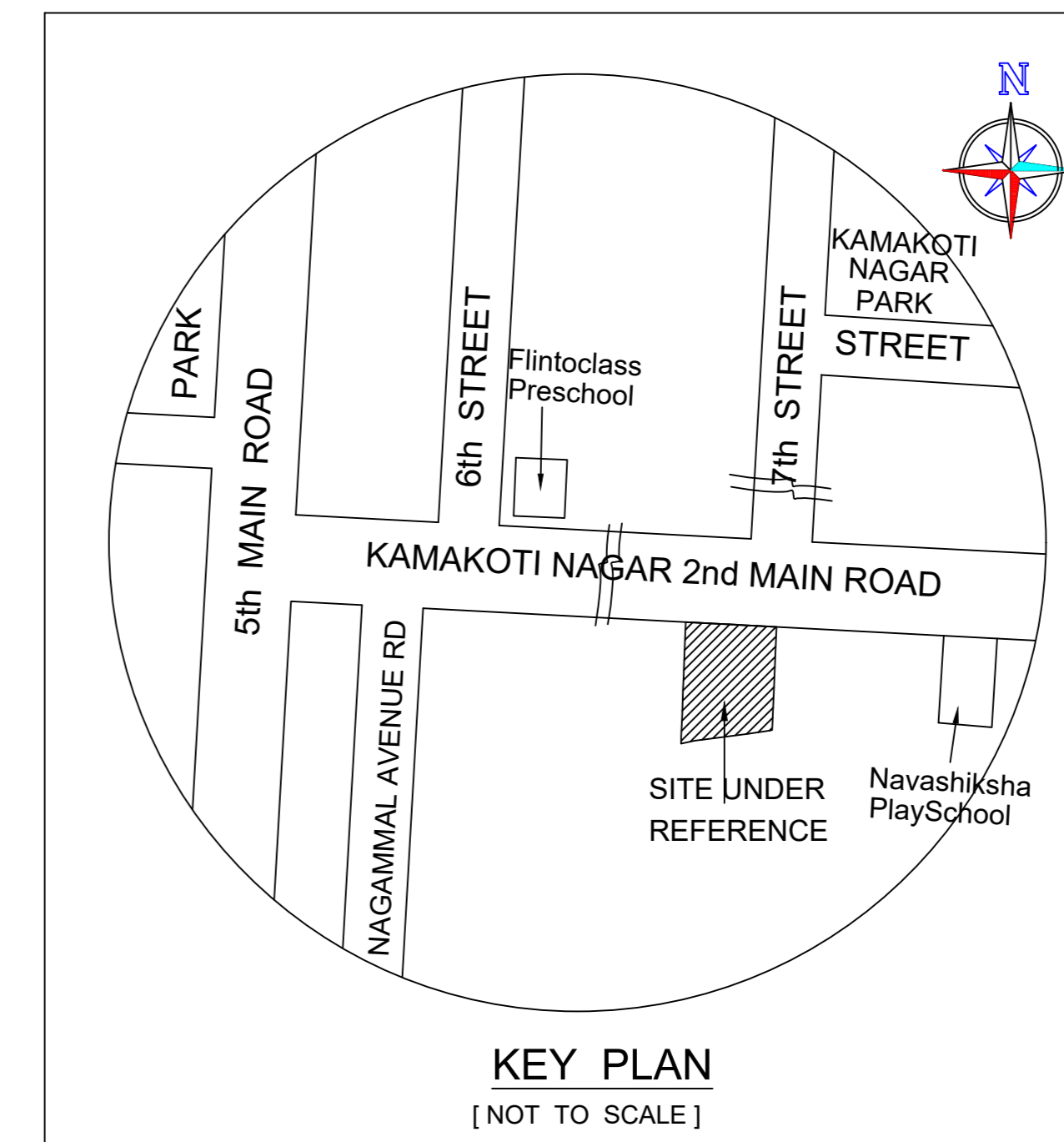

KEY PLAN

[NOT TO SCALE]

Location plan (Taken as per User Inputs)

PLAN SHOWING THE PROPOSED CONSTRUCTION OF STILT + 5 FLOORS (18.00M HEIGHT) RESIDENTIAL BUILDING WITH 10 DWELLING UNITS AT PLOT No. 117 & 118, 2nd MAIN ROAD, KAMAKOTI NAGAR, PALLIKARANAI, CHENNAI - 600 100. COMPRISED S.No. 631/15B OF PALLIKARANAI VILLAGE, GREATER CHENNAI CORPORATION. DIVISION - 189, ZONE - 14.

A) AREA STATEMENT		SQ.M.
AREA AS PER PATTA		500.00
AREA AS PER DOCUMENT		468.83
AREA CONSIDERED FOR FSI		468.83
STREET ALIGNMENT/ ROAD WIDENING/LINK ROAD		0.00
OSR AREA		0.00
TOTAL FSI AREA		1208.01
FSI FACTOR		2.577
COVERAGE AREA (PERCENTAGE %)		NA

A) PARKING STATEMENT		
VEHICLE	REQUIRED	PROVIDED
LORRY	-	0
CAR	11	11
TWO WHEELER	0	5
CYCLE	-	0

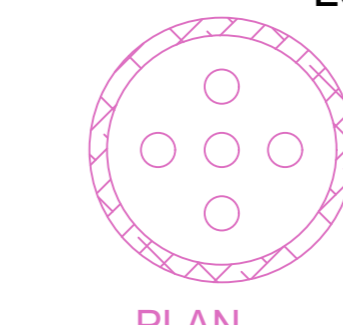

PLAN

RAIN WATER HARVESTING PIT

SECTION

RAIN WATER HARVESTING PIT

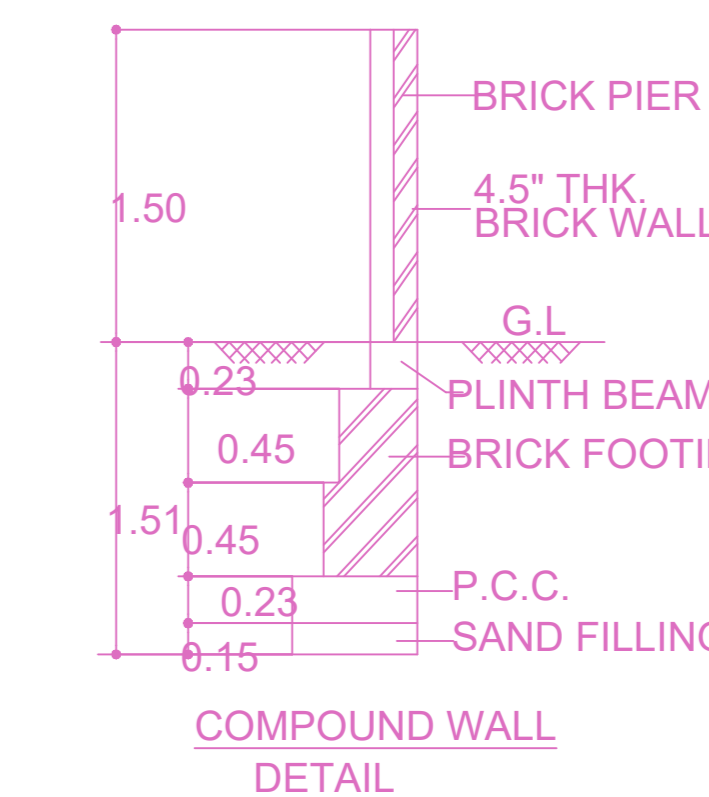

COMPOUND WALL DETAIL

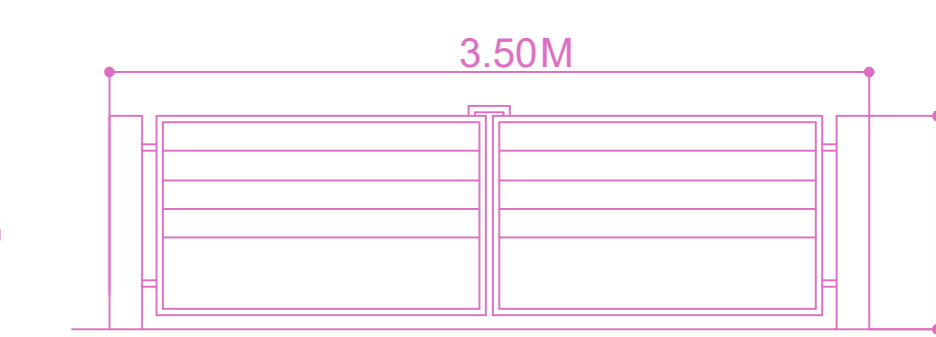

GATE DETAIL

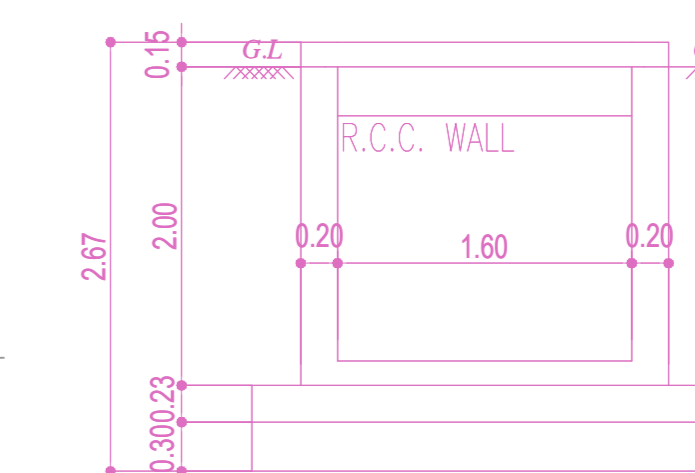

SECTION ON DD

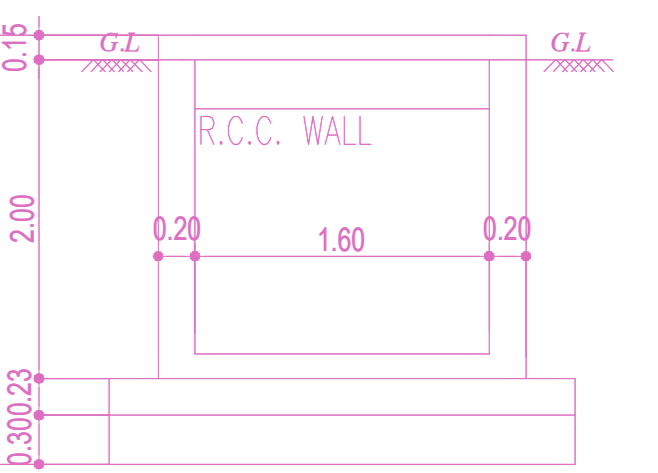

SECTION ON DD

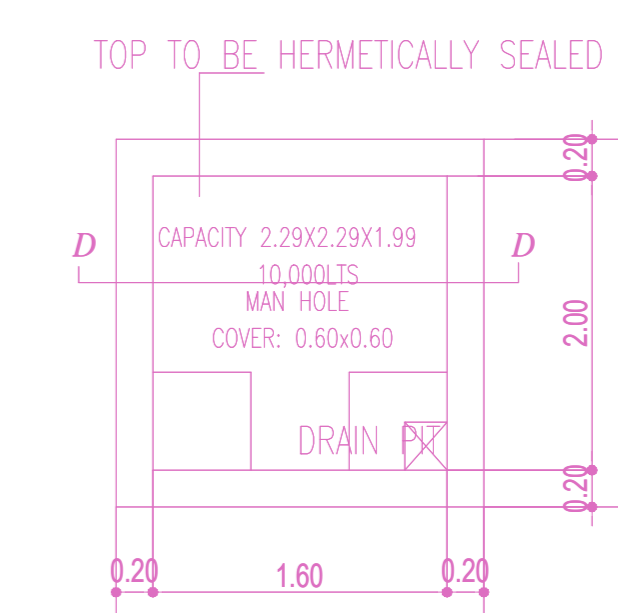

SULLAGE WATER COLLECTION SUMP DETAIL

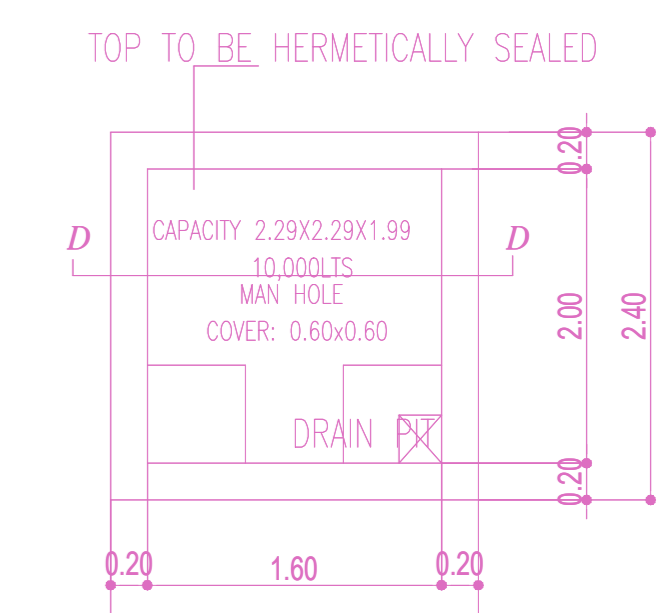

RAIN WATER COLLECTION SUMP DETAIL

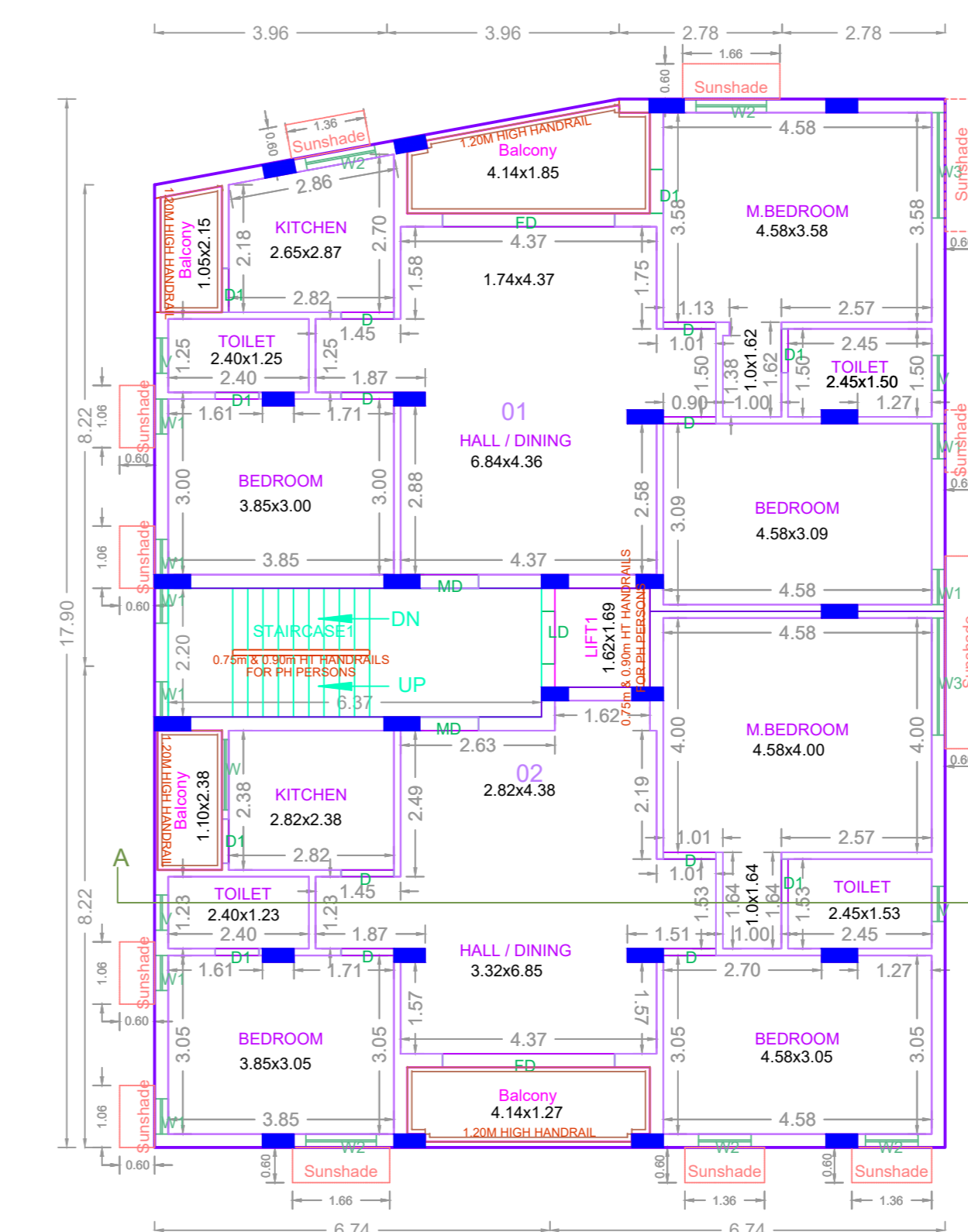

TYPICAL - 1, 2, 3, 4 & 5 FLOOR PLAN

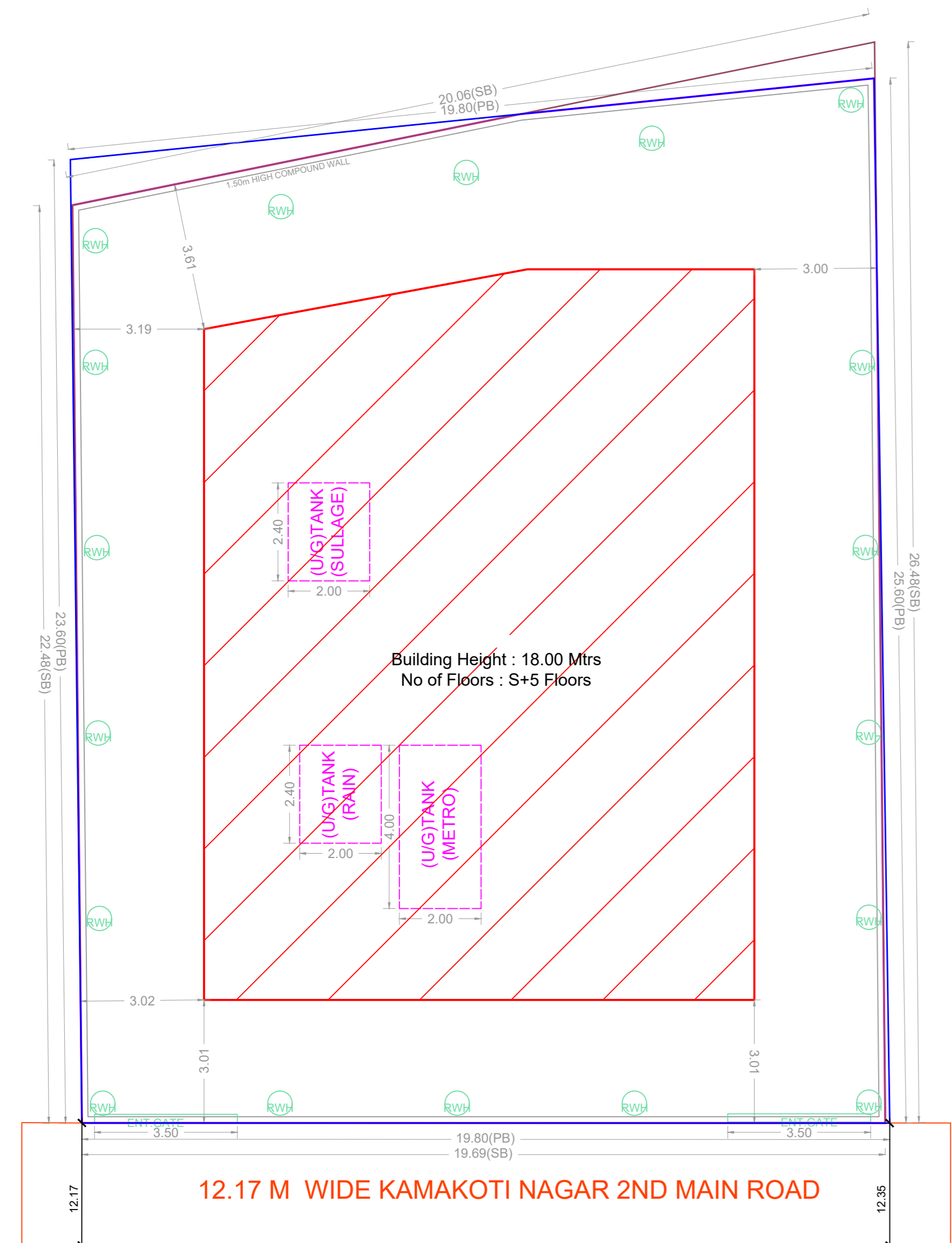

SITE PLAN

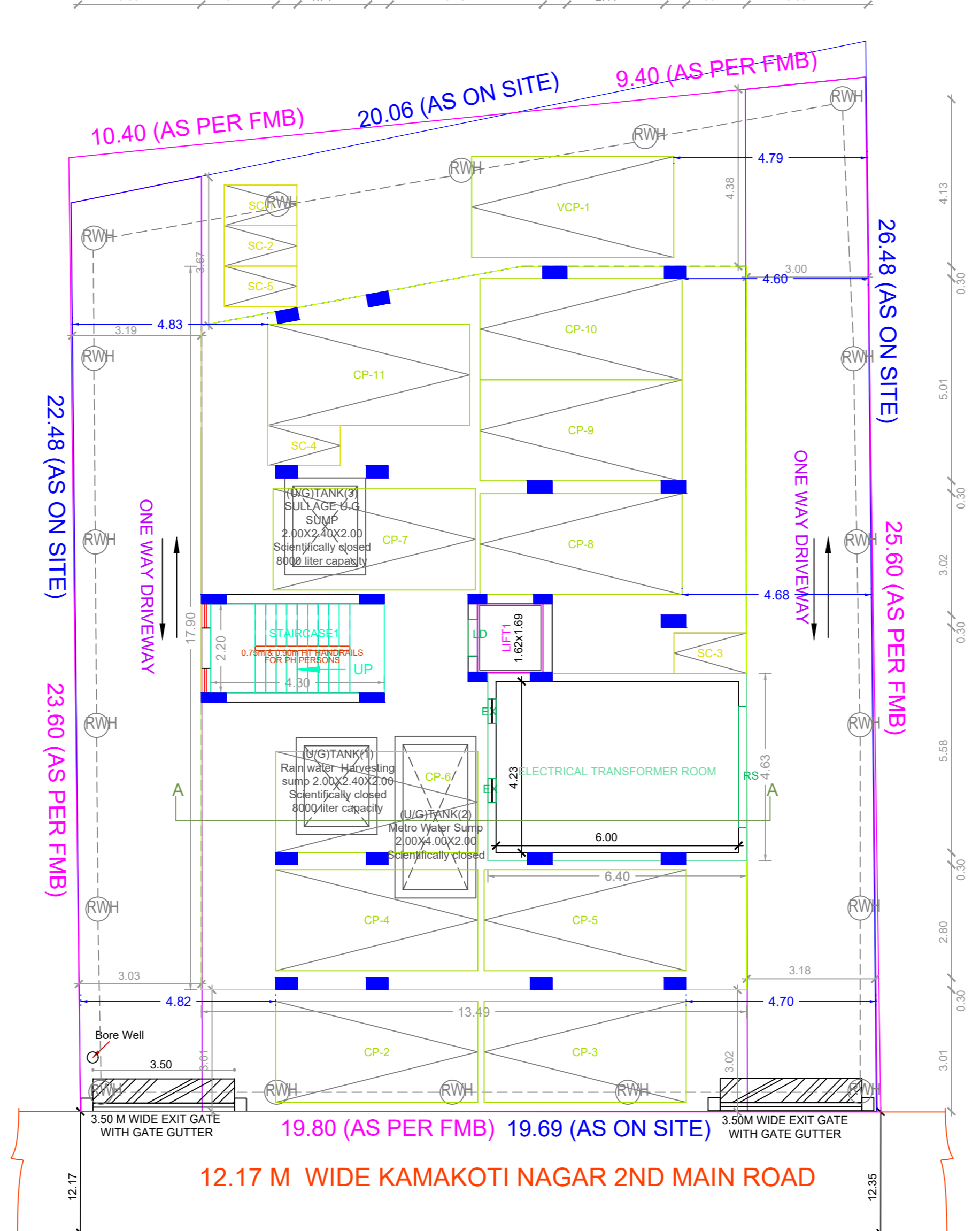

SITE CUM STILT FLOOR PLAN

BUILDING WISE FSI STATEMENT

BUILDING	NO OF SAME BUILDING	FSI AREA				DU	TOTAL FSI AREA
		COMM.	RESI.	IND.	INST.		
A1-1 (RESI)		0.00	1208.01	0.00	0.00	10	1208.01
Total		0.00	1208.01	0.00	0.00	10	1208.01

FLOOR WISE FSI STATEMENT: A1 (RESI)

FLOORS	FSI AREA				DU	TOTAL FSI AREA
	COMM.	RESI.	IND.	INST.		
STILT PARKING FLOOR	0.00	29.66	0.00	0.00	0	29.66
FIRST FLOOR	0.00	235.67	0.00	0.00	2	235.67
SECOND FLOOR	0.00	235.67	0.00	0.00	2	235.67
THIRD FLOOR	0.00	235.67	0.00	0.00	2	235.67
FOURTH FLOOR	0.00	235.67	0.00	0.00	2	235.67
FIFTH FLOOR	0.00	235.67	0.00	0.00	2	235.67
Terrace	0.00	0.00	0.00	0.00	0	0.00
Total	0.00	1208.01	0.00	0.00	10	1208.01

APPROVAL CONDITION

1. The Building shall be constructed as per the approved plans and specifications.

2. The Building shall be constructed within the stipulated time frame.

3. The Building shall be constructed in accordance with the provisions of the Tamil Nadu Building Regulation and Code of Practice, 2019.

SCALE 1:100

CHENNAI METROPOLITAN DEVELOPMENT AUTHORITY

APPROVED

SUBJECT TO THE CONDITIONS MENTIONED IN THIS OFFICE

For (Deputy Planner / Chief Planner / Member-Secretary)
High Rise Building / Non High Rise Building
This Approval is valid only after building Permit is issued by the concerned Local Body.

KEY NO. 7588

QR CODE