

PLAN SHOWING THE REGULARISATION (UNDER REGULARISATION SCHEME - 1999) OF BF+GF+3 FLOORS COMMERCIAL CUM RESIDENTIAL BUILDING WITH 5 DWELLING UNITS AT DOOR NO:406 (OLD NO:187/A), LLYODS ROAD, GOPALAPURAM, CHENNAI-600086, COMPRISED IN R.S. No.65/23 & 24, BLOCK No.3 OF MYLAPORE VILLAGE, GREATER CHENNAI CORPORATION, DIVISION No.111 ZONE No.9

SCHEDULE OF JOINERY

MD	MAIN DOOR	1.30X2.13
D	DOOR	1.06X2.13
D1	DOOR	0.91X2.13
D2	DOOR	0.76X2.13
W	WINDOW	1.83X1.35
W1	WINDOW	1.22X1.35
WK	WINDOW	1.83X1.35
WIK	WINDOW	1.22X1.35
V	VENTILATOR	1.83X0.61
V1	VENTILATOR	0.76X0.61

AREA STATEMENT

DESCRIPTION OF FLOORS	FSI AREA
BASEMENT	106.78
GROUND FLOOR	202.92
FIRST FLOOR	245.90
SECOND FLOOR	245.90
THIRD FLOOR	245.90
TOTAL AREA	1047.40
NON - FSI AREA	60.93
F.S.I: 1.72	
PLOT COVERAGE: 42.60%	

COLOUR INDEX

REGULARISATION	
ROAD	
PLOT BOUNDARY	

ALL DIMENSIONS ARE IN METRES
SCALE 1:100

OWNER'S SIGNATURE

(SUNDEEP KUMAR, SUPTA)

(SUPTA KRISHNA KUMAR, HUF)

(MANISHA SARAF)

A. SURESH KUMAR B.E. CIVIL
Registered Engineer Grade - I (RE)
Regn. No. RE102882020
COSMO CONSULTANTS & BUILDERS
#366/1, Green Gardens, 28th Street,
L-Block, Anna Nagar East,
Chennai - 102. Cell: 9786610666

LICENSED SURVEYOR

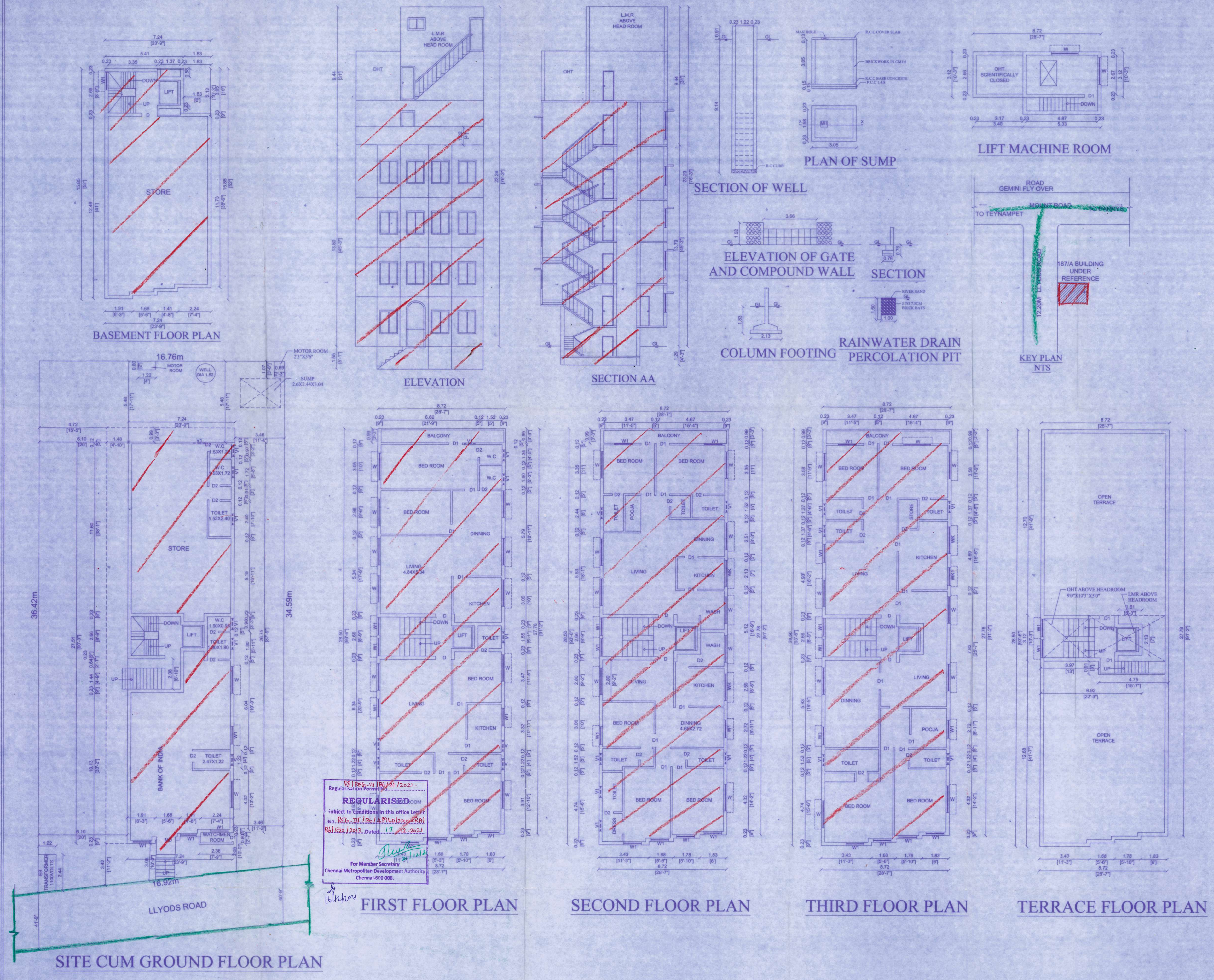

REGULARISED ROOM
Subject to Conditions in this office Letter No. REG-III/16/21/2021/1712/2021
661/201/2021, Dated: 17.12.2021

For Member Secretary
Chennai Metropolitan Development Authority
Chennai-600 008.

SITE CUM GROUND FLOOR PLAN

BASEMENT FLOOR PLAN

FIRST FLOOR PLAN

SECOND FLOOR PLAN

THIRD FLOOR PLAN

TERRACE FLOOR PLAN

ELEVATION

SECTION AA

PLAN OF SUMP

SECTION OF WELL

ELEVATION OF GATE AND COMPOUND WALL

SECTION

COLUMN FOOTING

RAINWATER DRAIN PERCOLATION PIT

LIFT MACHINE ROOM

KEY PLAN NTS