

V. No. 65
MUGALIVAKKAM
VILLAGE

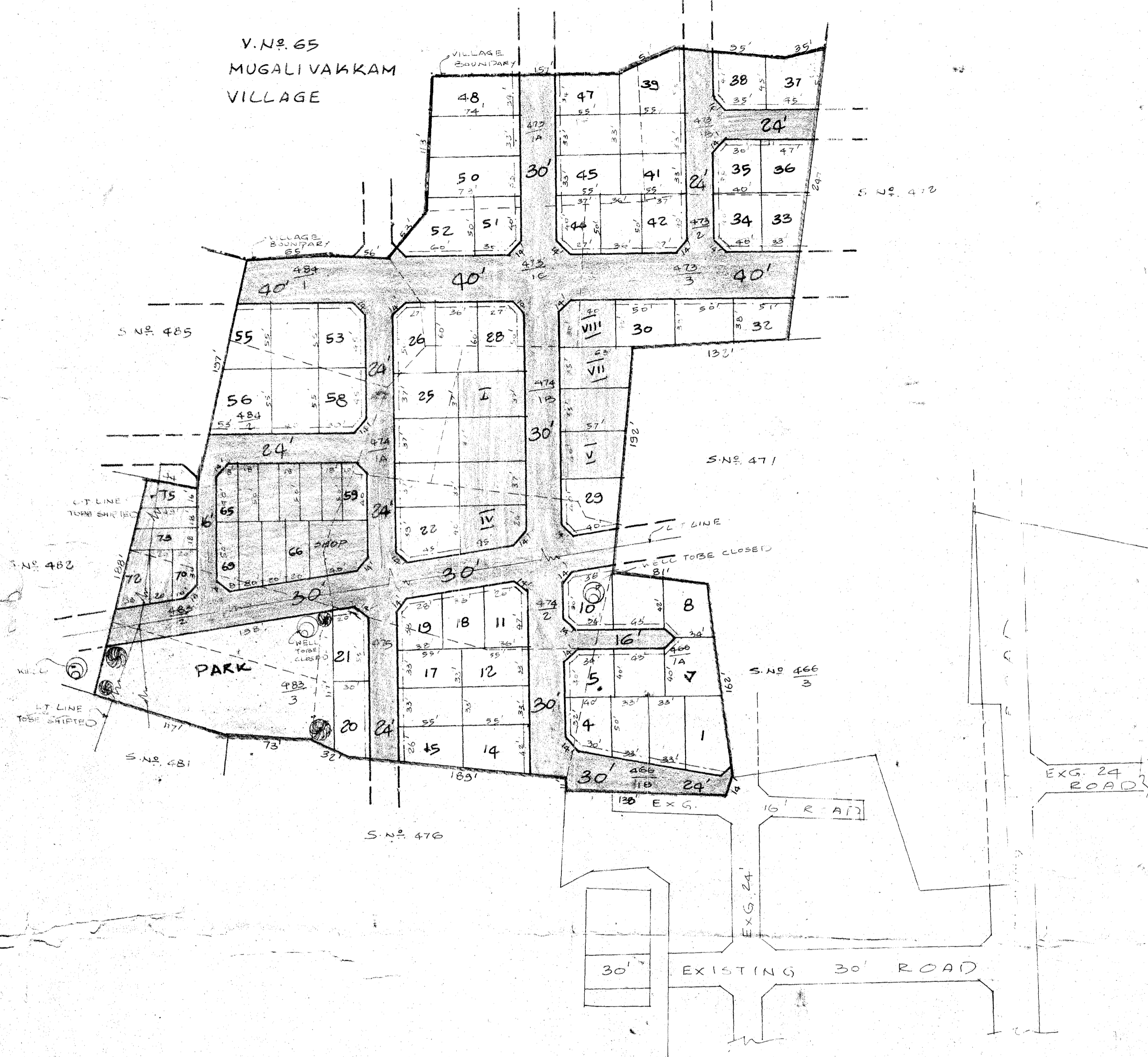

TOTAL EXTENT : 21650 m²
 ROAD AREA : 6826 m²
 PARK AREA : 1500 m²
 PUBLIC PURPOSE PLOTS (I to VII) : 1543 m²
 TOTAL NO. OF PLOTS : 75
 REGULAR PLOTS (1 to 58) : 58
 EWIS PLOTS (59 to 75) : 17
 SHOP SITE : 1 NO.

NOTE:
 1. SPLAY 10' x 10'
 2. MEASUREMENTS INDICATED ARE EXCLUDING
 SPLAY DIMENSIONS.
 3. ROAD AREA & PARK AREA WERE ALREADY HANDLED OVER TO THE LOCAL BODY VIDE GIFT DEED DOC. NO. 2805/2000 DT. 23.6.2000 & RECTIFICATION DOC. NO. 3900/2000 DT. 5.9.2000

CONDITION:
 THE AREA EARMARKED FOR PUBLIC PURPOSE (VIZ. POST & TELEGRAPH OFFICE, POLICE STATION ETC.) WOULD REMAIN RESERVED FOR A SPECIFIC PERIOD OF ONE YEAR FROM THE DATE OF APPROVAL TO ENABLE THE GOVT, DEPT, CONCERNED TO NEGOTIATE WITH THE OWNER AND ACQUIRE THE RESERVED LAND IF REQUIRED FOR THEM. AFTER THE SAID PERIOD OF ONE YEAR, AND IF NONE OF THE AGENCIES PURCHASE THE RESERVED LAND FULLY/PART THE LAYOUT OWNER/DEVELOPER IS FREE TO DISPOSE OF THE SITE RESERVED FOR PUBLIC PURPOSE TO ANY BODY FOR RESIDENTIAL USE ONLY.

P.P.D No. 90 (1C)
 L.O No. 2000
 APPROVED
 VIDE LETTER NO. LI/30786/2000
 DATED 14/11/2000

OFFICE COPY
 FOR MEMBER SECRETARY
 CHENNAI METROPOLITAN
 DEVELOPMENT AUTHORITY

KUNDRATHUR PANCHAYAT UNION
 LAYOUT OF HOUSE SITES IN S.No. 466/IA, IB, 473/IA, IB, IC, 2, 3, 474/A, B, 2,
 475, 483/1, 2, 3, 484/1 AND 484/2 OF MANAPAKKAM VILLAGE

SCALE: 66 FEET TO AN INCH.

