

GATEWAY

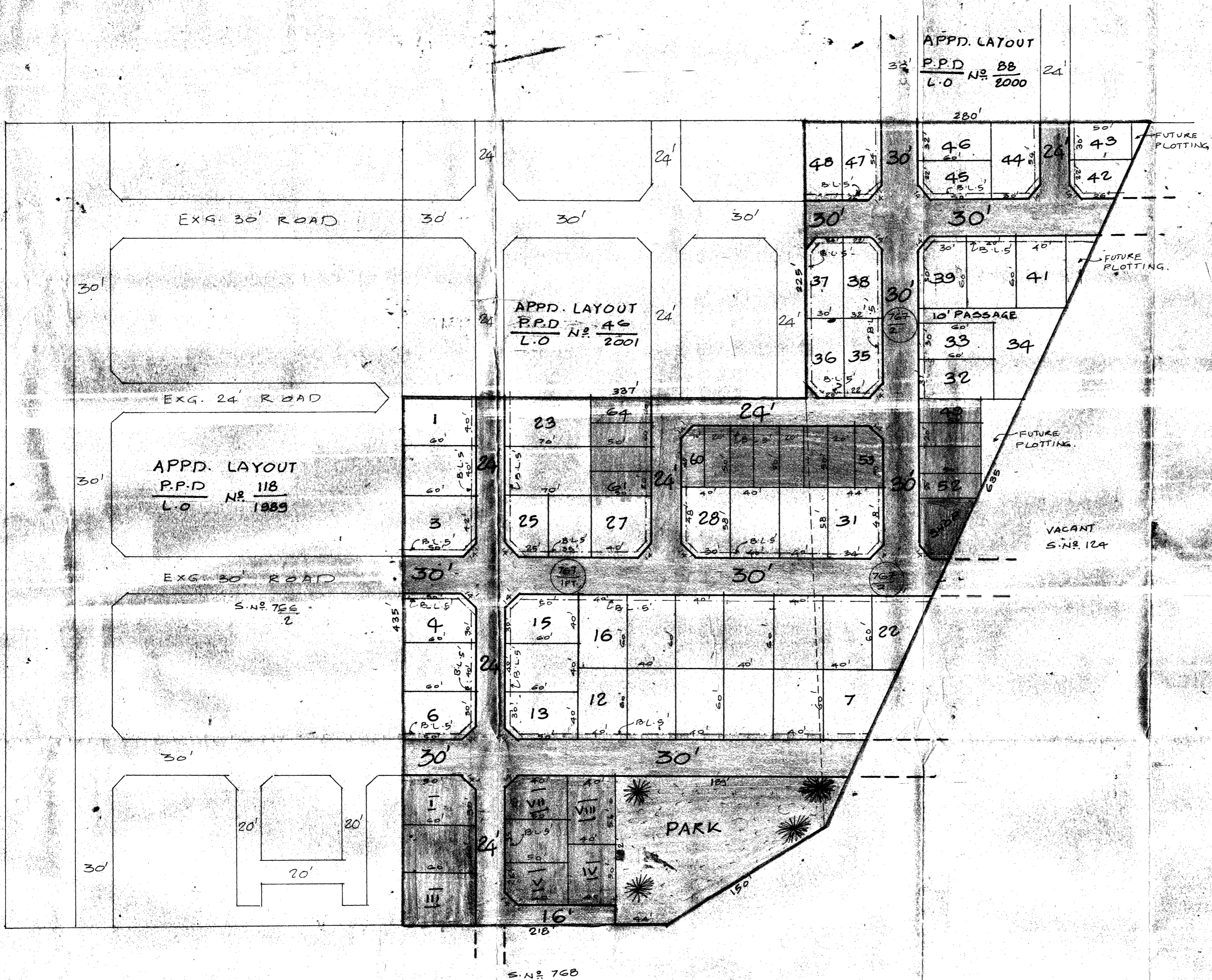

TOTAL EXTENT	20638 m ²
ROAD AREA	5801 m ²
PARK AREA	1501 m ²
PUBLIC PURPOSE } PLOTS (I TO VIII)	1558 m ²
NO. OF PLOTS	64 Nos
REGULAR PLOTS (1 TO 48)	48 Nos
E.W.S. PLOTS (49 TO 64)	16 Nos
SHOP SITE	1 No.

CONDITION:
 THE AREA EARMARKED FOR PUBLIC PURPOSE I TO VIII (VIZ. POST & TELEGRAPH OFFICE, POLICE STATION, ETC.) WOULD REMAIN RESERVED FOR A SPECIFIC PERIOD OF ONE YEAR FROM THE DATE OF APPROVAL TO ENABLE THE GOVT. DEPT. CONCERNED TO NEGOTIATE WITH THE OWNER AND ACQUIRE THE RESERVED LAND IF REQUIRED FOR THEM AFTER THE SAID PERIOD OF ONE YEAR. AND IF NONE OF THE AGENCIES PURCHASE THE RESERVED LAND FULL/PART, THE LAYOUT OWNER/DEVELOPER IS FREE TO DISPOSE OF THE SITE RESERVED FOR PUBLIC PURPOSE TO ANYBODY FOR RESIDENTIAL USE ONLY.

LEGEND

- SITE BOUNDARY
- EXISTING ROADS
- PROPOSED ROADS
- PUBLIC PURPOSE
- PARK
- E.W.S.
- COMMERCIAL

NOTE
 1. SPLOT 10' x 10'
 2. MEASUREMENTS INDICATED ARE EXCLUDING SPURWAY DIMENSIONS.
 3. ROAD AREA } ALREADY HANDED
 PARK AREA } OVER TO THE LOCAL BODY.
 VIDE GIFT DEED DOC. NO. 789/2002 DT. 15.02.2002.

Traced by: *h. Alankar PAIV*
 PAJ (K.K.P.)
 A.P. (G.M.)
 D. (G.M.S.)

P.P.D. No. 17
 L.O. No. 2002
 APPROVED
 VIDE LETTER NO. LI/7807/2002
 DATED 02.2002
 FOR MEMBER SECRETARY,
 CHENNAI METROPOLITAN
 DEVELOPMENT AUTHORITY

MADAMBAKKAM TOWN PANCHAYAT
 LAYOUT OF HOUSE SITES IN S.No. 767/1PT, & 767/2 OF
 MADAMBAKKAM VILLAGE
 SCALE: 66 FEET TO AN INCH

