

EASWARAN NAGAR MAIN ROAD
TO G.S.T. ROAD TO KEELKATTALAI

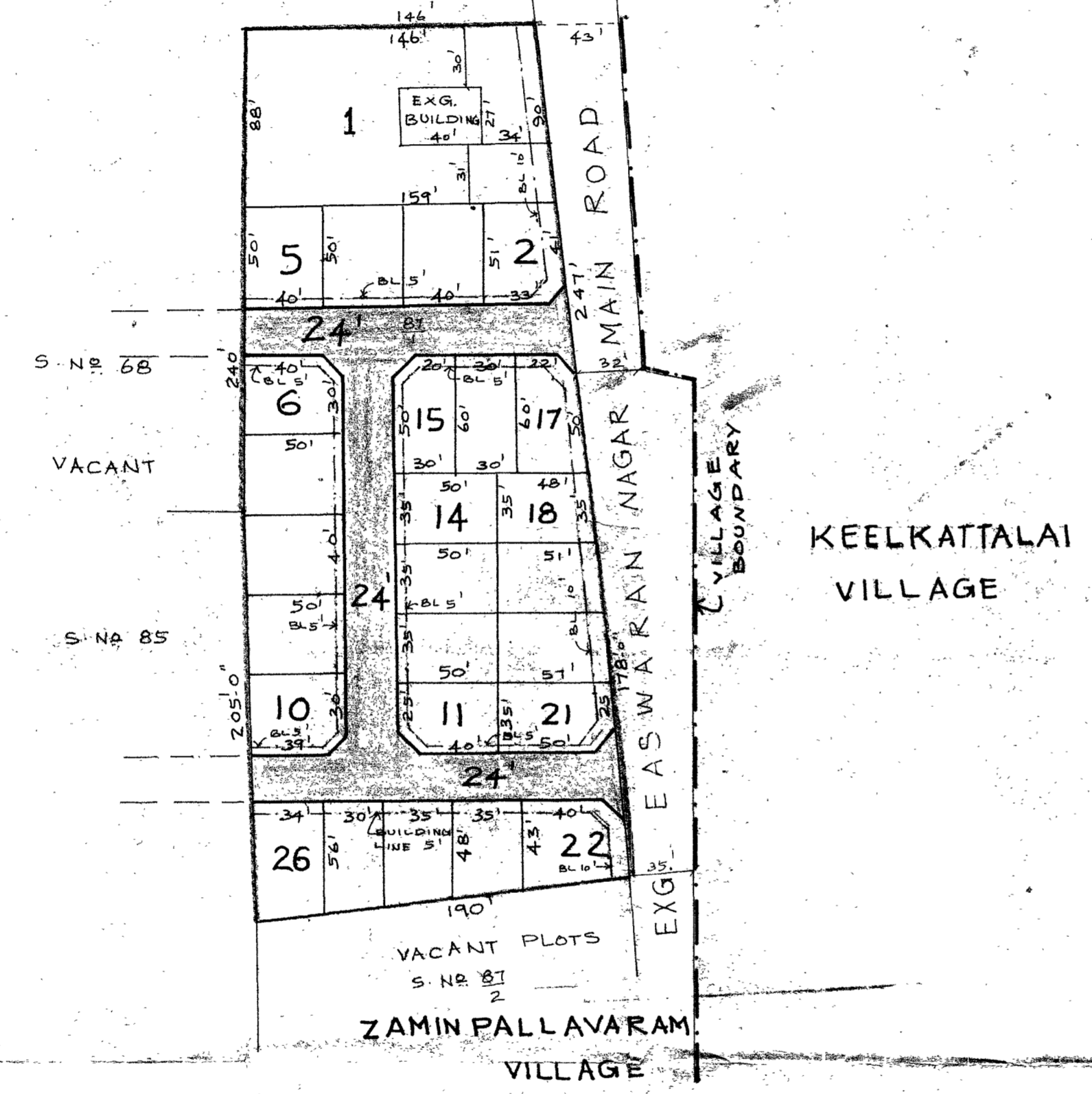

TOTAL EXTENT (1.30 AC) : 5261 M²
 ROAD AREA : 1259 M²
 NO OF PLOTS : 26

NOTE:
 1. SPLAY 10' X 10'
 2. MEASUREMENTS INDICATED ARE EXCLUDING SPLAY DIMENSION
 ROAD AREA WAS ALREADY HANDED OVER TO THE LOCAL BODY
 VIDE GIFT DEED DOC. NO. 2560 DATED 19-08-2002

LEGEND:
 [Symbol] SITE BOUNDARY
 [Symbol] EXISTING ROAD
 [Symbol] PROPOSED ROAD

PALLAVARAM MUNICIPALITY
 LAYOUT OF HOUSE SITES IN S. NO. 87/1 OF
 ZAMIN PALLAVARAM VILLAGE.
 SCALE : 66 FEET TO AN INCH.

P.P.D No. 60/10
 L.O No. 2002
 APPROVED
 VIDE LETTER NO. L1/30710/2002
 DATED 03/10/2002
 OFFICE COPY
 FOR MEMBER SECRETARY
 CHENNAI METROPOLITAN
 DEVELOPMENT AUTHORITY

