

TOTAL EXTENT	56050	M ²
ROAD AREA	15954	M ²
PARK AREA	4031	M ²
PUBLIC PURPOSE (I TO XXIII)	4143	M ²
N ^o OF PLOTS	202	
REGULAR PLOTS (1 TO 150)	150	
E-W-S PLOTS (151 TO 202)	52	
SHOP SITE	4	
CONVENIENCE SHOP SITE	4	

NOTE :-
 1 SPLAY 3.0 M X 3.0 M & 4.5 M X 4.5 M
 2 MEASUREMENTS INDICATED ARE EXCLUDING SPLAY DIMENSION
 3 ROAD AREA WERE ALREADY HANDED OVER TO THE LOCAL BODY
 PARK AREA JVIDE GIFT DEED DOC- NR. 2276/2003, DATED: 21/04/2003.

LEGEND :-
 [Symbol] SITE BOUNDARY
 [Symbol] EXISTING ROAD
 [Symbol] PROPOSED ROAD
 [Symbol] PUBLIC PURPOSE
 [Symbol] E-W-S
 [Symbol] OPEN SPACE RESERVATION
 [Symbol] COMMERCIAL

CONDITIONS :-
 1 THE AREA EARMARKED FOR PUBLIC PURPOSE I TO XXIII [VIZ POST AND TELEGRAPH OFFICE, POLICE STATION ETC...] WOULD REMAIN RESERVED FOR A SPECIFIC PERIOD ONE YEAR FROM THE DATE OF APPROVAL TO ENABLE THE GOVERNMENT DEPT. CONCERNED TO NEGOTIATE WITH THE OWNER AND ACQUIRE THE RESERVED LAND IF REQUIRED FOR THEM AFTER THE SAID PERIOD OF ONE YEAR AND IF NONE OF THE AGENCIES PURCHASE THE RESERVED LAND FULL/PART THE LAYOUT OWNER/DEVELOPER IS FREE TO DISPOSE OFF THE SITE RESERVED FOR PUBLIC PURPOSE TO ANYBODY FOR RESIDENTIAL USE ONLY.

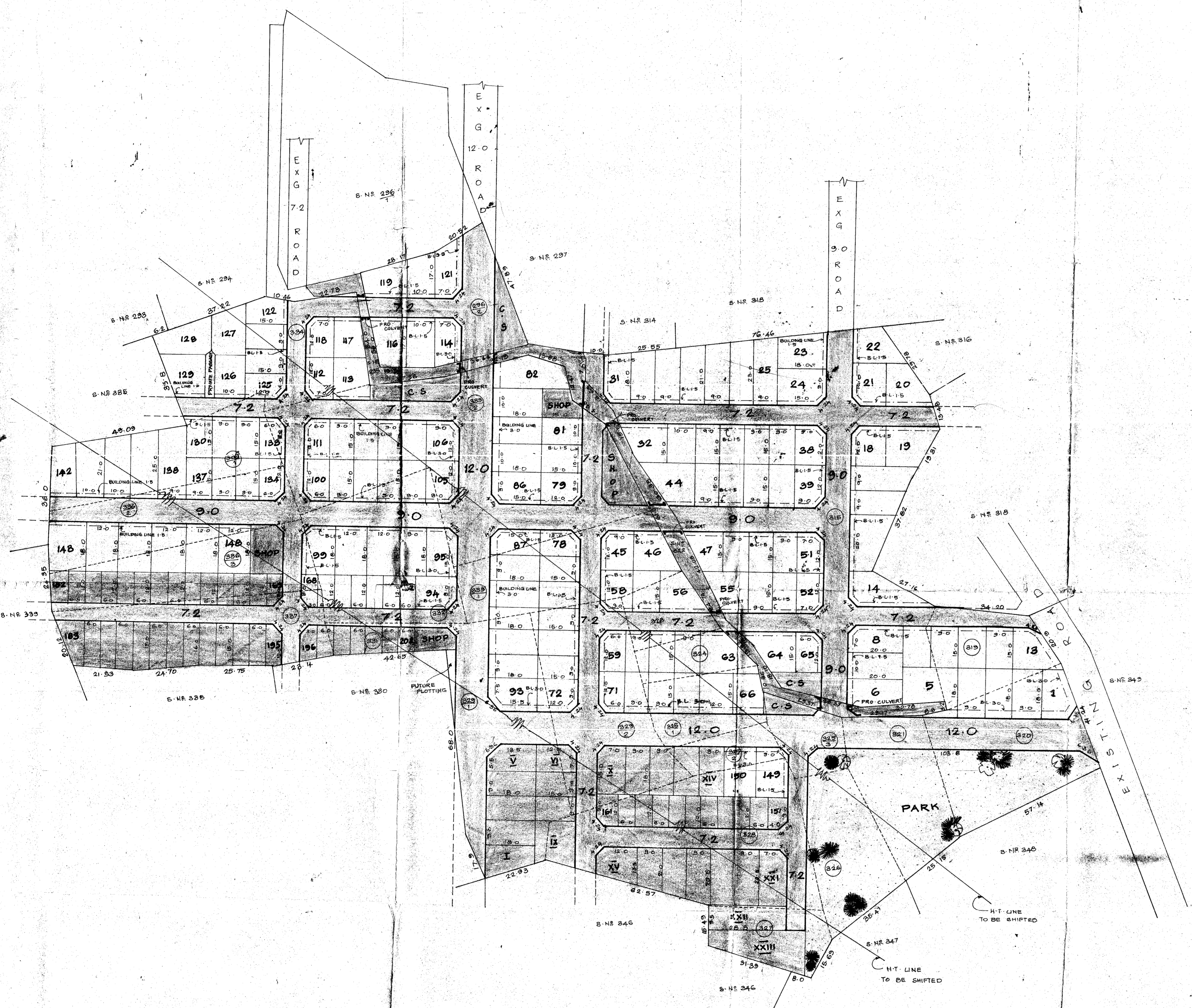

AMBATTUR MUNICIPALITY
 LAYOUT OF HOUSE SITES IN S. NR. 296/2, 315, 319/1, 2, 320, 321, 323, 324, 325/1, 2, 3, 326, 327, 328, 329/1, 2, 331, 332, 333/1, 2, 334/1, 2, 336/1, 2, 3 & 337 OF AMBATTUR VILLAGE.
 SCALE :- 1 : 800

41/2003

PPD NR	41	L.O.	2003	I.C.
APPROVED				
VIDE LETTER NR	L1/10893/2003			
DATED	19/05/2003			
FOR MEMBER SECRETARY CHENNAI METROPOLITAN DEVELOPMENT AUTHORITY				