

56

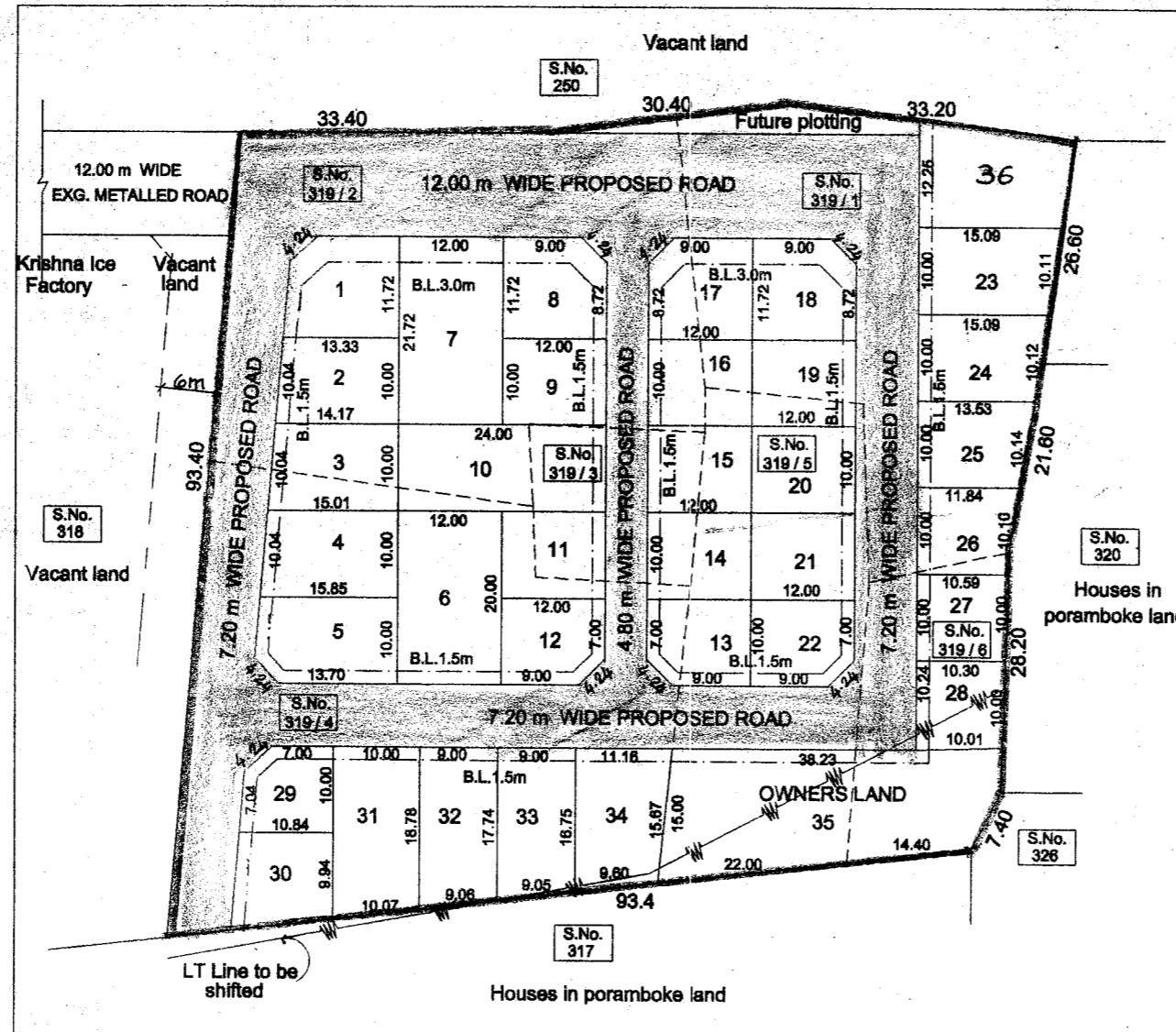

TOTAL EXTENT : 8337 Sqm
 ROAD AREA : 2748 Sqm
 No. OF PLOTS : 36 Nos.

NOTE:
 1. SPLAY SIZE 3.00m x 3.00m
 2. MEASUREMENTS INDICATED ARE EXCLUDING SPLAY DIMENSION
 3. ROAD AREA WAS ALREADY HANDED OVER TO THE LOCAL BODY VIDE (GIFT DEED DOC.No.921/2003 DT.05.05.2003)

LEGEND:
 [Symbol] SITE BOUNDARY
 [Symbol] EXISTING ROADS
 [Symbol] PROPOSED ROADS

P.P.D. No. 56(I.C)
 L.O No. 2003
 APPROVED

VIDE LETTER No: L1/12747/2003
 DATED : 20.06.2003

OFFICE COPY

FOR MEMBER SECRETARY
 CHENNAI METROPOLITAN
 DEVELOPMENT AUTHORITY



ST. THOMAS MOUNT PANCHAYAT UNION
 LAYOUT OF HOUSE SITES IN S.No. 319/1, 2, 3, 4, 5 & 6 OF
 MUDICHUR VILLAGE
 SCALE: 1:800