

TOTAL EXTENT : 1050 M<sup>2</sup>  
 ROAD AREA : 126 M<sup>2</sup>  
 NO OF PLOTS : 6

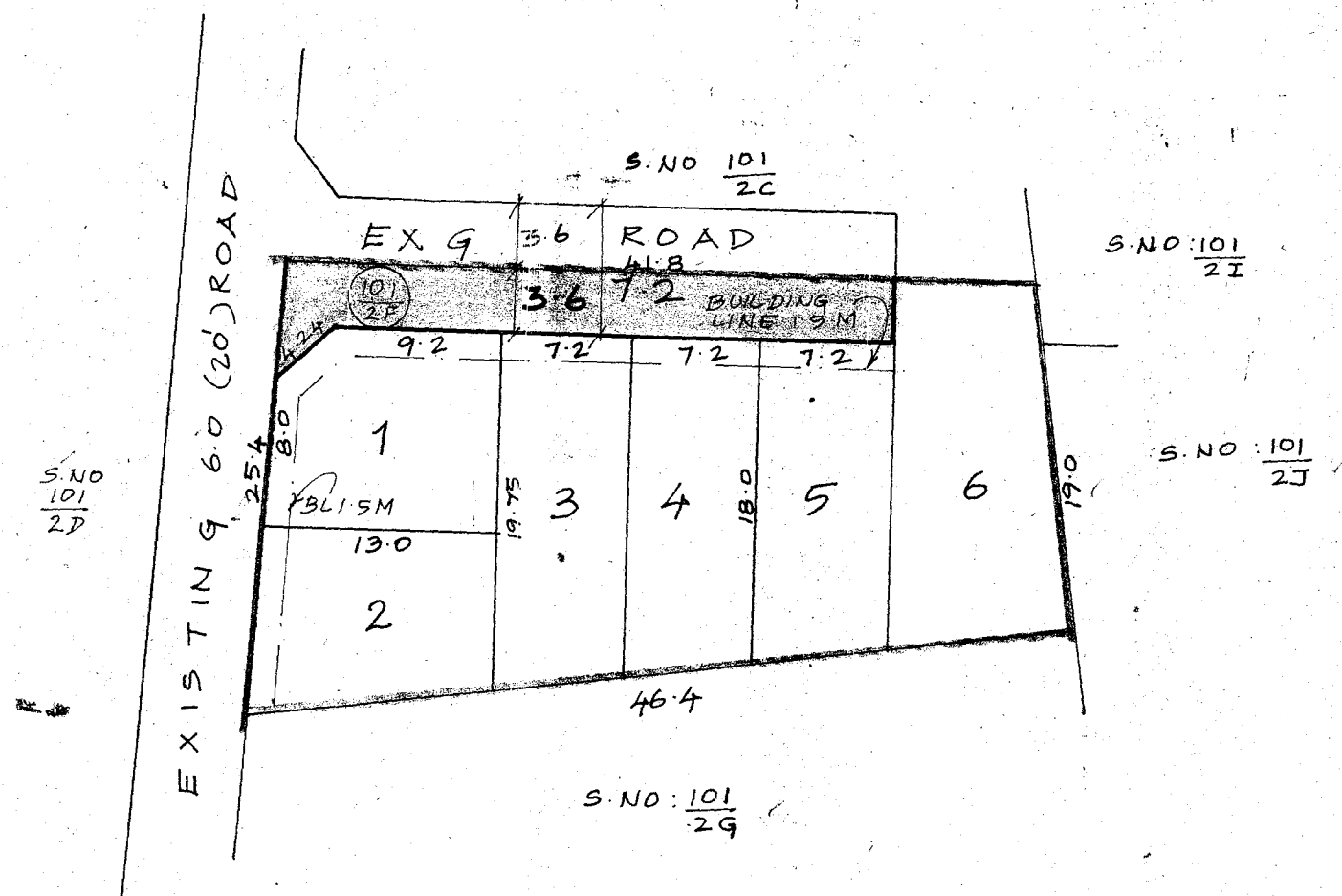

**NOTE**  
 1. SPLAY 3.0M X 3.0M  
 2. MEASUREMENTS INDICATED ARE EXCLUDING SPLAY DIMENSION  
 3. ROAD AREA WAS ALREADY HANDED OVER TO THE LOCAL BODY VIDE GIFT DEED DOC NO: 1157/2003 DATED: 7/8/2003.

**LEGEND**  
 [Symbol] SITE BOUNDARY  
 [Symbol] PROPOSED ROAD  
 [Symbol] EXISTING ROAD

P.P.D NO : 93  
 L.O 2003  
 APPROVED  
 VIDE LETTER NO : L1/21915/2003  
 DATED : 8/9/2003

OFFICE COPY

FOR MEMBER SECRETARY  
 CHENNAI METROPOLITAN  
 DEVELOPMENT AUTHORITY



# POONAMALLEE TOWN PANCHAYAT

SUB DIVISION OF HOUSE SITES IN S.NO: 101/2F OF

POONAMALLEE VILLAGE

SCALE : 1:400