

FILED IN DOOR

GATEWAY

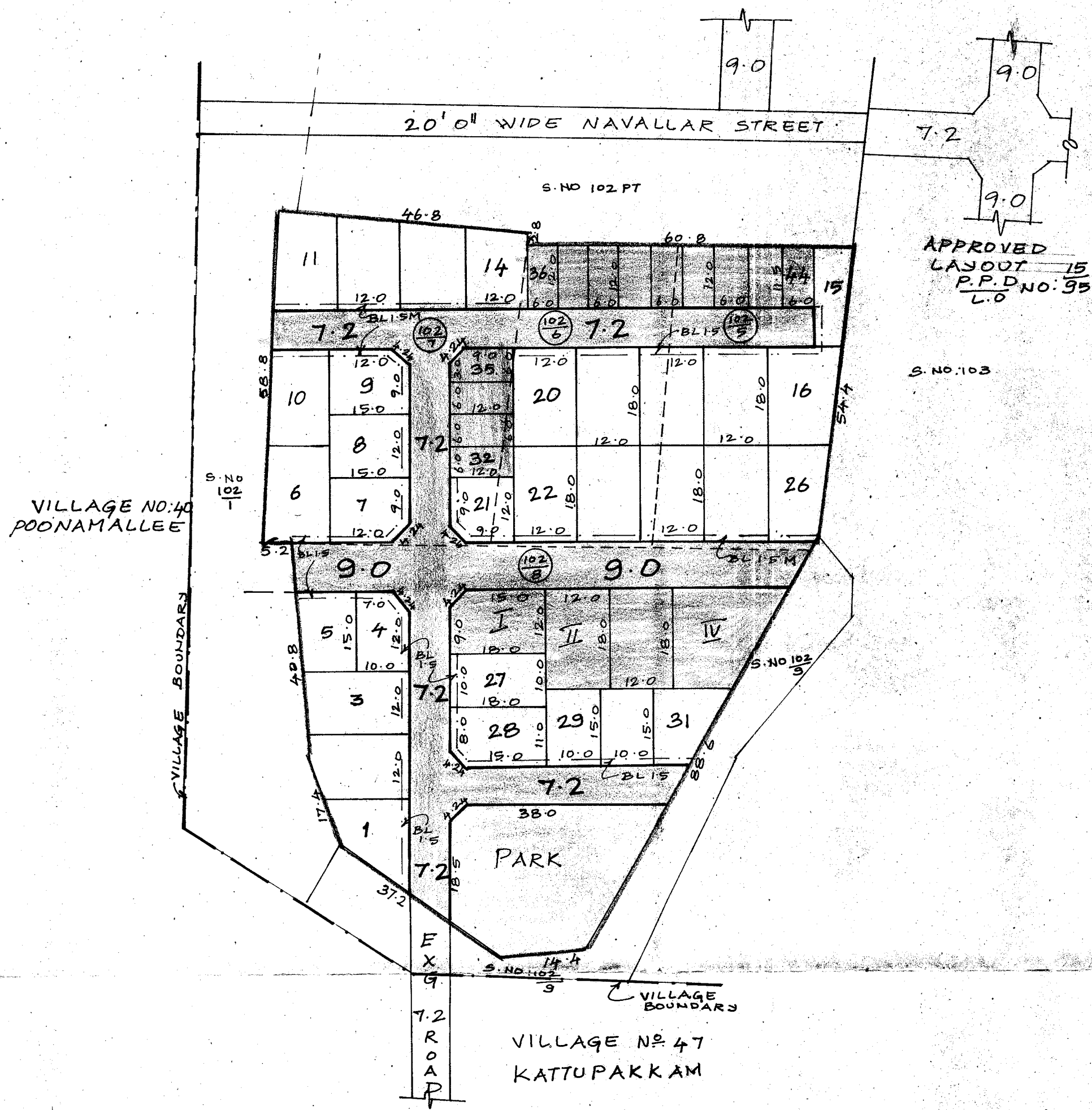

TOTAL EXTENT : 11150 M<sup>2</sup>  
 ROAD AREA : 2449 M<sup>2</sup>  
 PARK AREA : 883 M<sup>2</sup>  
 PUBLIC PURPOSE PLOTS (I TO IV) : 941 M<sup>2</sup>  
 NO OF REGULAR PLOTS (1 TO 31) : 31 NOS  
 NO OF E.W.S. PLOTS (32 TO 44) : 13  
 TOTAL NO OF PLOTS (1 TO 44) : 44 NOS.

**NOTE**

- SPLAY 3.0 M X 3.0 M
- MEASUREMENTS INDICATED ARE EXCLUDING SPLAY DIMENSION.
- ROAD AREA } ALREADY HANDED OVER TO THE LOCAL BODY VIDE GIFT DEED DOC NO: 6039/2004 DATED: 6/8/2004.
- PARK AREA }

**CONDITION**

THE AREA EARMARKED FOR PUBLIC PURPOSE, I TO IV (VIZ POST AND TELEGRAPH OFFICE, POLICE STATION ETC) WOULD REMAIN RESERVED FOR A SPECIFIC PERIOD OF ONE YEAR FROM THE DATE OF APPROVAL TO ENABLE THE GOVERNMENT DEPT. CONCERNED TO NEGOTIATE WITH THE OWNER AND ACQUIRE THE RESERVED LAND IF REQUIRED FOR THEM AFTER THE SAID PERIOD OF ONE YEAR, AND IF NONE OF THE AGENCIES PURCHASE THE RESERVED LAND FULL/PART, THE LAYOUT OWNER/DEVELOPER IS FREE TO DISPOSE OF THE SITE RESERVED FOR PUBLIC PURPOSE TO ANY BODY FOR RESIDENTIAL USE ONLY.

**LEGEND**

- SITE BOUNDARY
- PROPOSED ROAD
- EXISTING ROAD
- PARK
- PUBLIC PURPOSE
- E.W.S.

P.P.D NO: 98  
 L.O 2004  
 APPROVED  
 VIDE LETTER NO. LI/23942/2004  
 DATED 30/08/2004

OFFICE COPY

FOR MEMBER SECRETARY  
 CHENNAI METROPOLITAN  
 DEVELOPMENT AUTHORITY

POONAMALLEE PANCHAYAT UNION  
 LAYOUT OF HOUSE SITES IN S.NO:102/5,6,7 AND 102/8 OF  
 SENEERKUPPAM VILLAGE.  
 SCALE : 1:800

