

4
11/08/2005/17

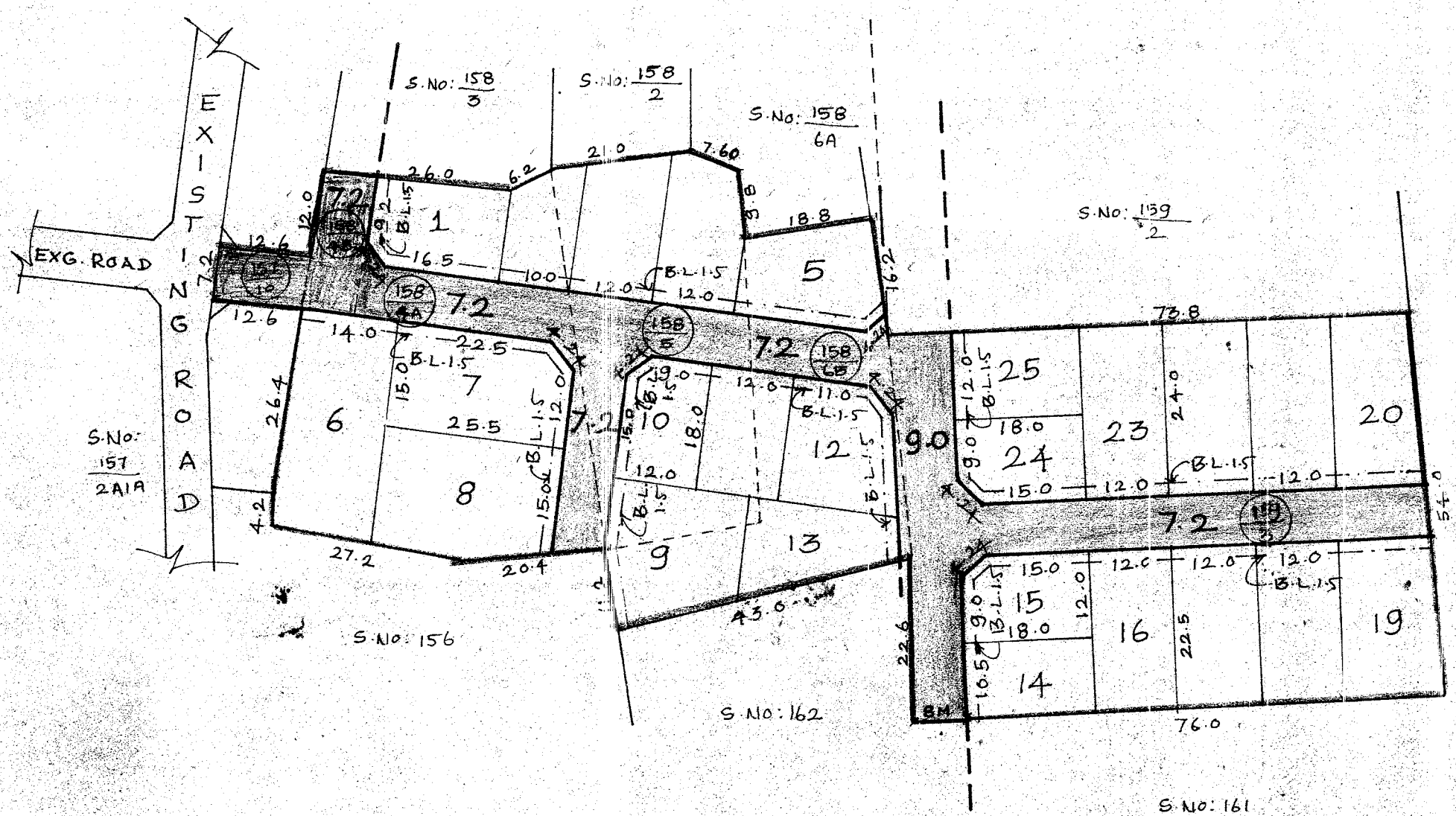

TOTAL EXTENT : 8741 M²
 ROAD AREA : 1961 M²
 NO. OF PLOTS : 25 NOS.

NOTE:-

1. SPLAY 3.0M X 3.0M
2. MEASUREMENTS INDICATED ARE EXCLUDING SPLAY DIMENSION
3. ROAD AREA: ALREADY HANDED OVER TO THE LOCAL BODY.
 VIDE GIFT DEED DOCUMENT NO: 4628/2004
 DE; 13-12-2004, CANCELLATION DEED
 NO: 4901/2004, DE; 30-12-2004 AND GIFT
 DEED NO: 4875/2004, DE; 23-12-2004
4. ALREADY HANDED OVER TO THE COMMISSIONER PADAPPAI
 TOWN PANCHAYAT VIDE GIFT DEED DOCUMENT NO: 1750/2003
 DATED 1/7/2003 IN S.NO: 157/10, 158/4B OF AN EXTENT 2568 Sq.ft.
 (238.56 M²)

- LEGEND**
- SITE BOUNDARY
 - PROPOSED ROAD
 - EXISTING ROAD
 - ALREADY GIFTED ROADS

P.P.D NO: 4 I.C
 L.O. NO: 2005
 APPROVED
 VIDE LETTER NO: L1/381/8/2004
 DATED: 17/01/2005

OFFICE COPY

FOR MEMBER SECRETARY
 CHENNAI METROPOLITAN
 DEVELOPMENT AUTHORITY

KUNDRATHUR PANCHAYAT UNION
 LAYOUT OF HOUSE SITES IN S.NO:- 157/10, 158/4A, 158/4B, 158/5, 158/6B
 AND 159/3 OF KULAPAKKAM VILLAGE.

SCALE : 1:800