

TOTAL EXTENT : 2650 M<sup>2</sup>  
 ROAD AREA : 807 M<sup>2</sup>  
 NO OF PLOTS : 14 NOS.

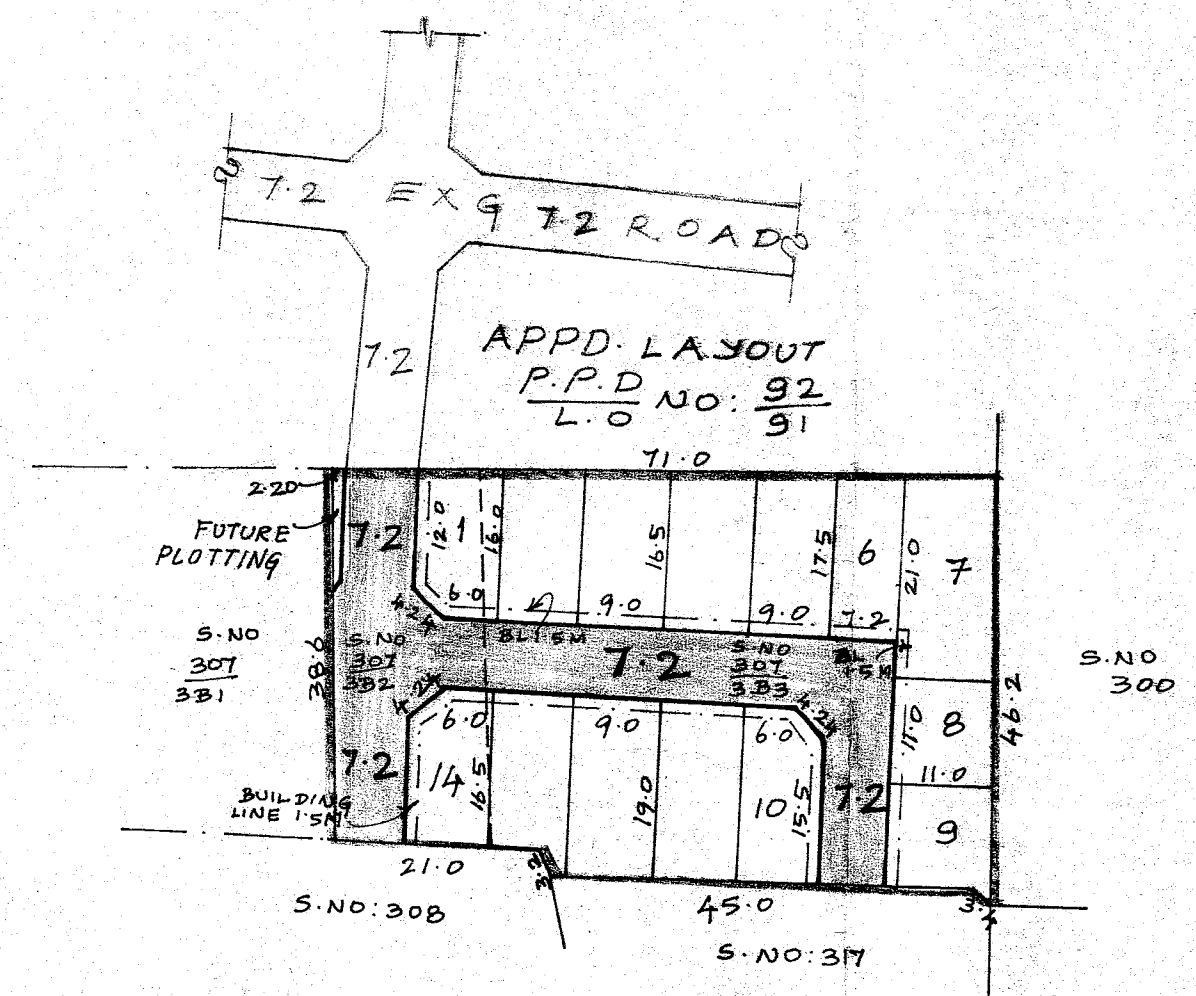

**NOTE :-**

1. SPLAY 3.0 M X 3.0 M
2. MEASUREMENTS INDICATED ARE EXCLUDING SPLAY DIMENSIONS.
3. ROAD AREA ALREADY HANDED OVER TO THE LOCAL BODY VIDE GIFT DEED DOC NO: 1541/2005 DATED: 24/2/2005 AND RECTIFICATION DEED DOC NO: 3020/2005 DATED: 12/4/2005.

**LEGEND**

- SITE BOUNDARY
- ▬ PROPOSED ROAD
- ▬ EXISTING ROAD.

P.P.D NO: 40/1-C  
 L.O 2005

APPROVED  
 VIDE LETTER NO: LI/7066/2005  
 DATED : 23/5/2005

OFFICE COPY

FOR MEMBER SECRETARY  
 CHENNAI METROPOLITAN  
 DEVELOPMENT AUTHORITY



# KUNDRATHUR TOWN PANCHAYAT

LAYOUT OF HOUSE SITES IN S.NO: 307/3B2 AND 307/3B3 OF  
 KUNDRATHUR VILLAGE.

SCALE : 1:800.