

TOTAL EXTENT : 8058 M²
ROAD AREA : 2848 M²
N^o OF PLOTS : 32

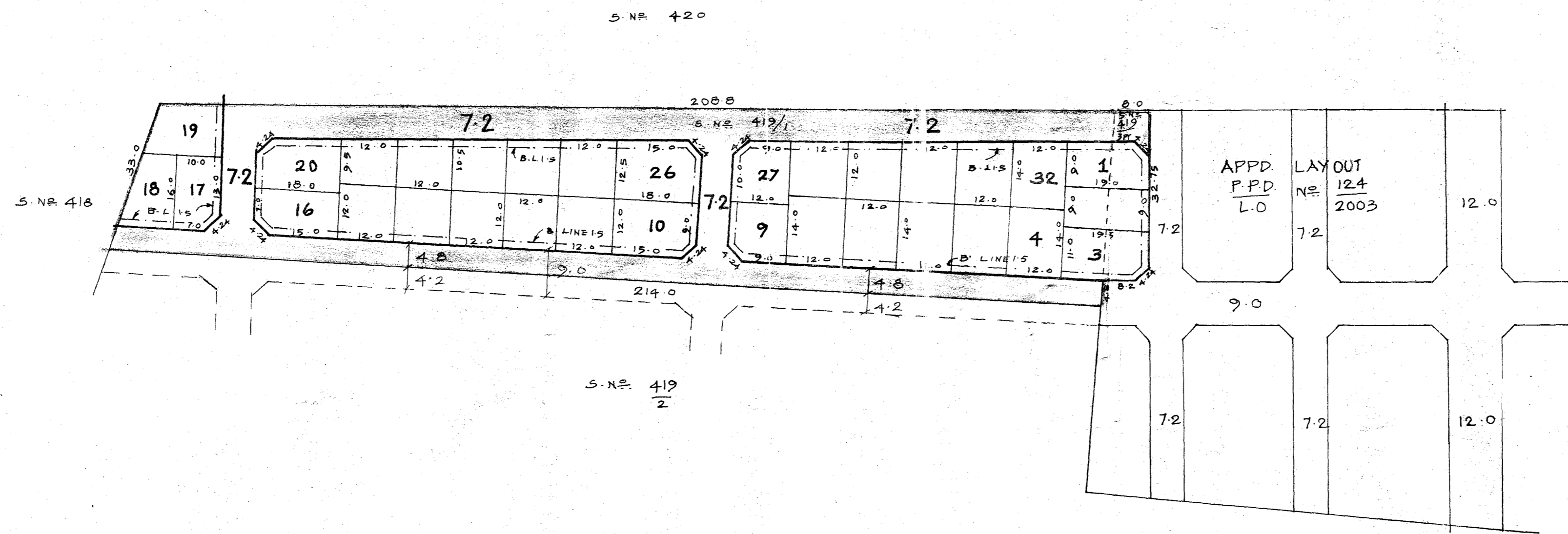

NOTE

1. SPLAY 3.0 x 3.0
2. MEASUREMENTS INDICATED ARE EXCLUDING SPLAY DIMENSIONS
3. ROAD AREA ALREADY HANDED OVER TO THE LOCALBODY VIDE GIFT DEED DOC. NO. 1034/05 DATED 31.3.05

LEGEND

- SITE BOUNDARY
- PROPOSED ROAD
- EXISTING ROAD

P.P.D. No. 48
L.O. No. 2005
APPROVED
VIDE LETTER No : L/9808/05
DATED : 13/06/2005

OFFICE COPY

FOR MEMBER SECRETARY
CHENNAI METROPOLITAN
DEVELOPMENT AUTHORITY

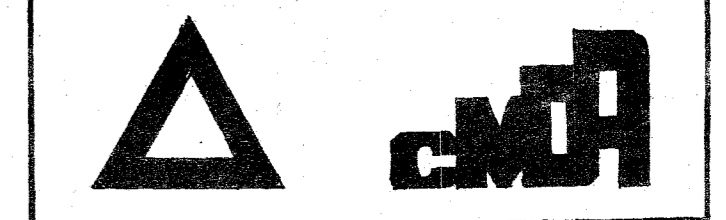

PERUNGALATHUR TOWN PANCHAYAT

LAY OUT OF HOUSE SITES IN S.N. 419/1 AND 419/3PT OF PERUNGALATHUR VILLAGE

SCALE 1:800