



TOTAL EXTENT : 6880 M<sup>2</sup>  
 ROAD AREA : 2416 M<sup>2</sup>  
 NO. OF PLOTS : 30

**NOTE**

1. SPLAY 3.0 X 3.0 M
2. MEASUREMENTS INDICATED ARE EXCLUDING SPLAY DIMENSIONS.
3. ROAD AREA WERE ALREADY HANDED OVER TO THE LOCAL BODY VIDE GIFT DEED DOC. NO. 1471/05 DATED: 2.5.05 AND RECTIFICATION DEED IN DOC. NO. 2426/05 DATED: 4.7.05

**LEGEND**

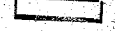
-  SITE BOUNDARY
-  PROPOSED ROAD
-  EXISTING ROAD

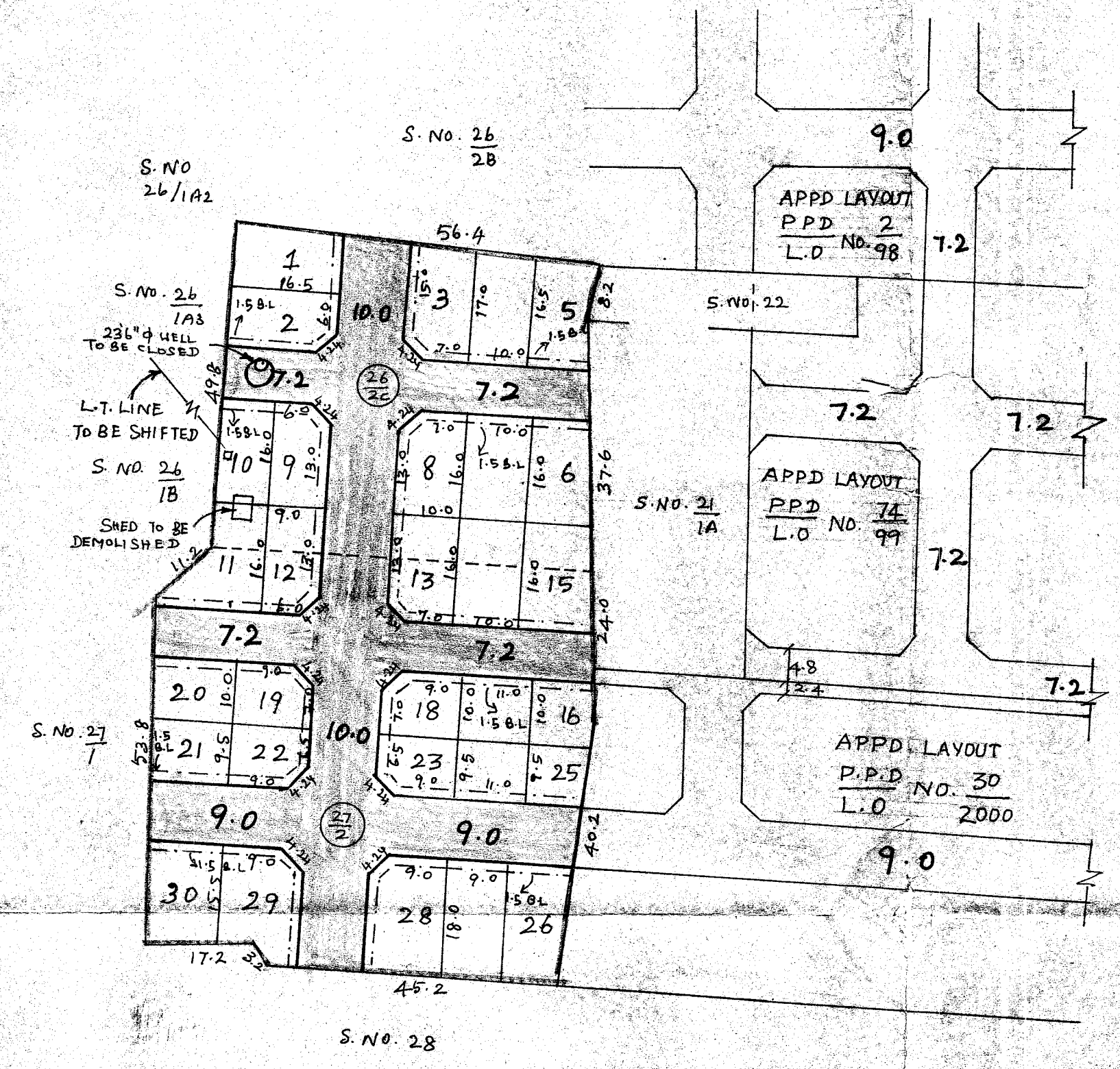

P.P.D NO. 73 1.0  
 L.O NO. 2005

APPROVED

VIDE LETTER NO. LI/25353/04  
 DATED: 22/8/05

OFFICE COPY

FOR MEMBER - SECRETARY  
 CHENNAI METROPOLITAN  
 DEVELOPMENT AUTHORITY

PERUNGALATHUR TOWN PANCHMAYAT  
 LAYOUT OF MOUSE SITES IN S.NO. 26/2C AND 27/2 OF PERUNGALATHUR VILLAGE

SCALE : 1 : 800

