

102

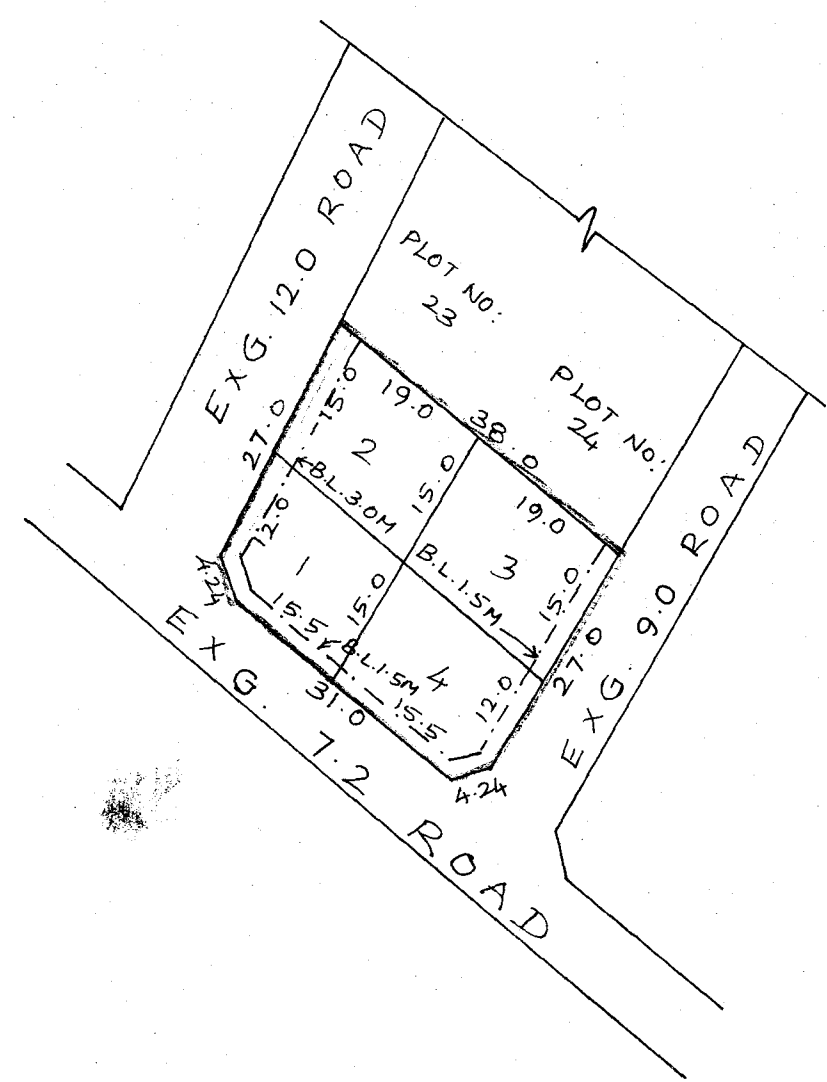

TOTAL EXTENT : 1091.28 M²
 NO OF PLOTS : 4 NOS.

LEGEND :
 SITE BOUNDARY
 EXISTING ROAD

P.P.D NO : 102
L.O NO : 2006
 APPROVED
 VIDE LETTER NO : L/3548/2006
 DATED : 29/09/2006

FOR MEMBER - SECRETARY
 CHENNAI METROPOLITAN
 DEVELOPMENT AUTHORITY.

ST. THOMAS MALAI PANCHAYAT UNION

CONVERSION OF COMMUNITY HALL SITE INTO SUB-DIVISION OF HOUSE SITES IN S.NO. 298/3 OF NANMANGALAM VILLAGE (THIS REVISES EARLIER

APPROVED LAYOUT P.P.D NO : 31 DATED : 17/4/2003 SCALE : 1 : 800
L.O 2003

