

TOTAL EXTENT : 12650M²
 EXTENT OF AGRICULTURE LAND : 4208M²
 EXTENT OF THE PRO. LAYOUT SITE: 8442M²
 ROAD AREA : 2167 M²
 NO OF PLOTS : 29
 SHOP SITE : 2Nos

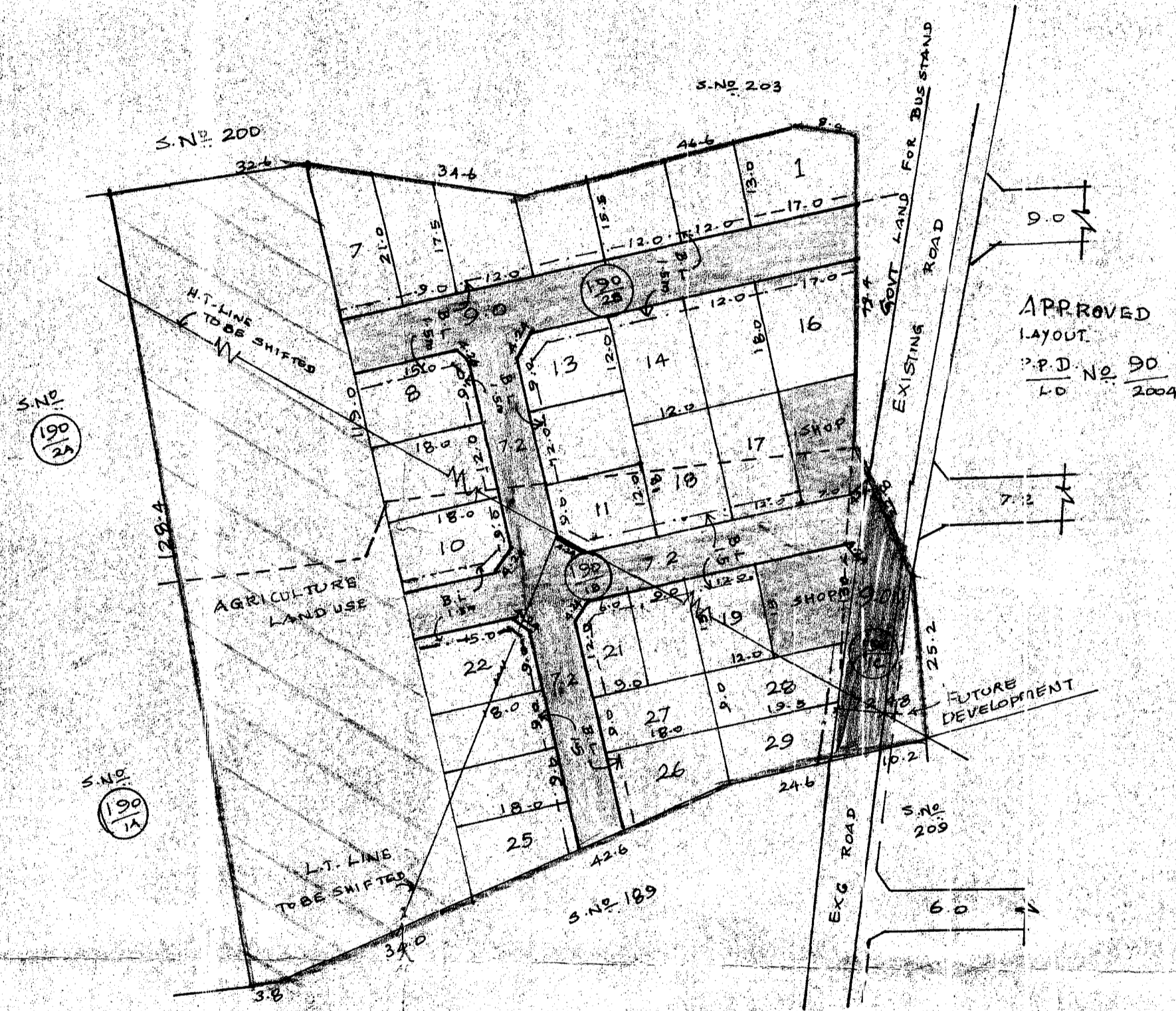

NOTE

- 1 SPLAY 3.0x3.0
- 2 MEASUREMENTS INDICATED ARE EXCLUDING SPLAY DIMENSIONS.
- 3 ROAD AREA WERE ALREADY HANDED OVER TO THE LOCAL BODY VIDE GIFT DEED DOC NO. 8048/05 DT. 13/9/05 AND RECTIFICATION GIFT DEED NO. 397/06 DATED. 23/01/06.

LEGEND

- [Symbol] SITE BOUNDARY
- [Symbol] PROPOSED ROAD
- [Symbol] EXG. ROAD
- [Symbol] EXG. ROAD ALREADY HANDED OVER TO THE LOCAL BODY
- [Symbol] AGRICULTURE LAND USE

P.P.D. No. 22 I.C
 L.O. No. 2006

APPROVED

Vide. LETTER No. : LI/26064/05.
 DATED : 14/03/2006

FOR MEMBER - SECRETARY
 CHENNAI METROPOLITAN
 DEVELOPMENT AUTHORITY

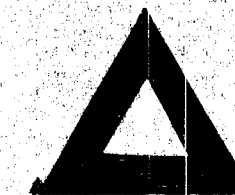

MANGADU TOWN PANCHAYAT

LAY OUT OF HOUSE SITES IN S.No. 190/1B, 1C, 2B OF MANGADU VILLAGE

SCALE 1:800