

TOTAL EXTENT : 250 M²
 No. OF PLOTS : 2 Nos.

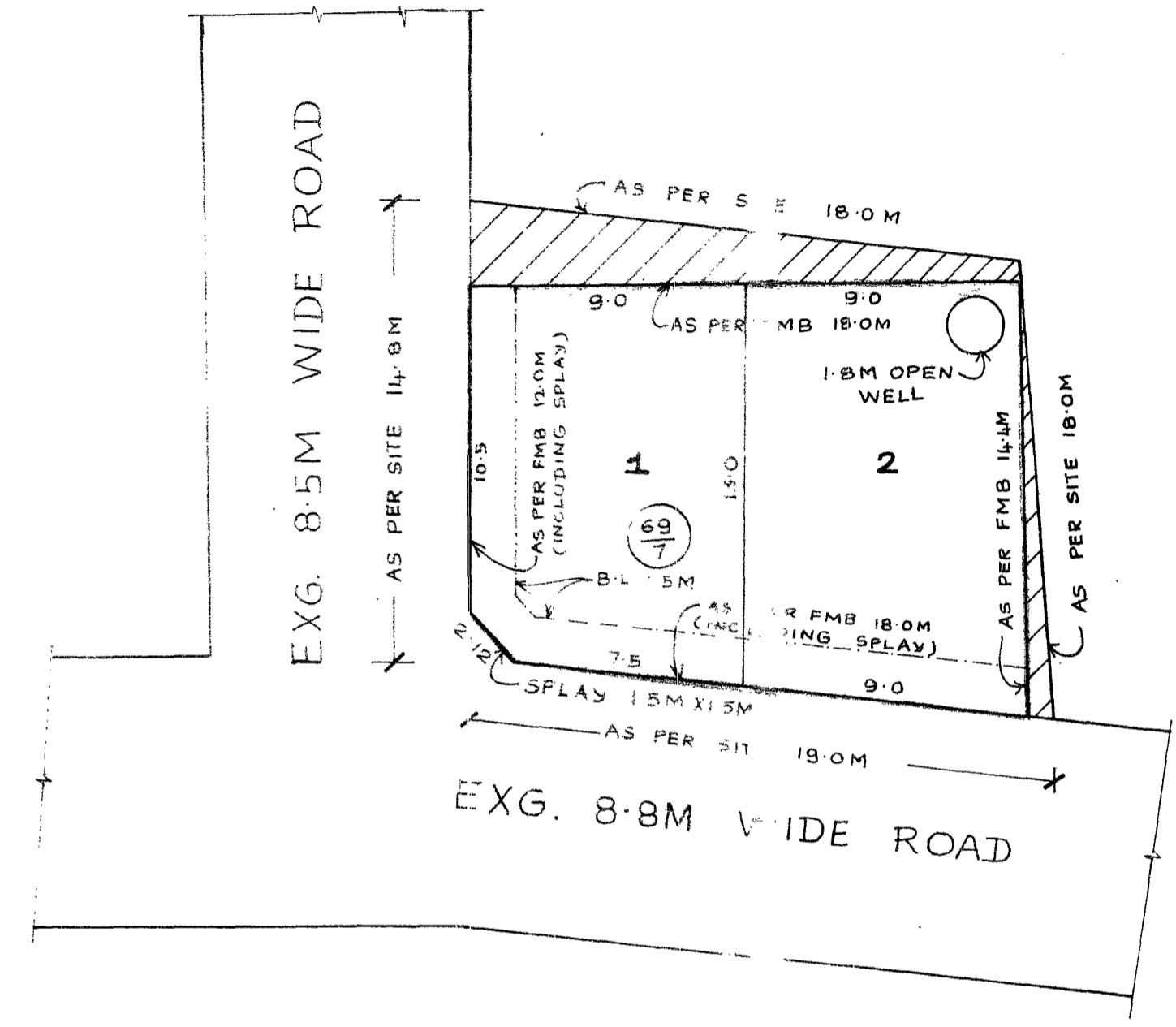

NOTE:-
 1. SPLAY 1.5M X 1.5M
 2. MEASUREMENTS INDICATED ARE EXCLUDING THE SPLAY DIMENSION.

CONDITION:-
 DR RULE No: 29(II)
 THE COST OF LAYING IMPROVEMENTS TO THE SYSTEMS IN RESPECT OF ROAD, WATER SUPPLY, SEWERAGE, DRAINAGE OR ELECTRIC POWER SUPPLY THAT MAY BE REQUIRED AS ASSESSED BY THE COMPETENT AUTHORITY SHALL BE BORNE BY THE APPLICANT.

LEGEND:-
 [Hatched Box] SITE BOUNDARY
 [White Box] EXISTING ROAD

P.P.D NO. 12 / 2009
 L.O APPROVED
 VIDE LETTER No: L1/19887/08
 DATED : 13/03/09
 I.e Not Marking
 FOR MEMBER- SECRETARY
 CHENNAI METROPOLITAN
 DEVELOPMENT AUTHORITY

VALASARAVAKKAM THIRD GRADE MUNICIPALITY

SUB-DIVISION OF HOUSE SITES IN S.No: 69/7 OF VALASARAVAKKAM VILLAGE.

SCALE: 1:200 (ALL MEASUREMENTS ARE IN METRE ONLY)

