

TOTAL EXTENT : 5706 M²
 ROAD AREA : 1518 M²
 NO. OF PLOTS : 21 NOS.

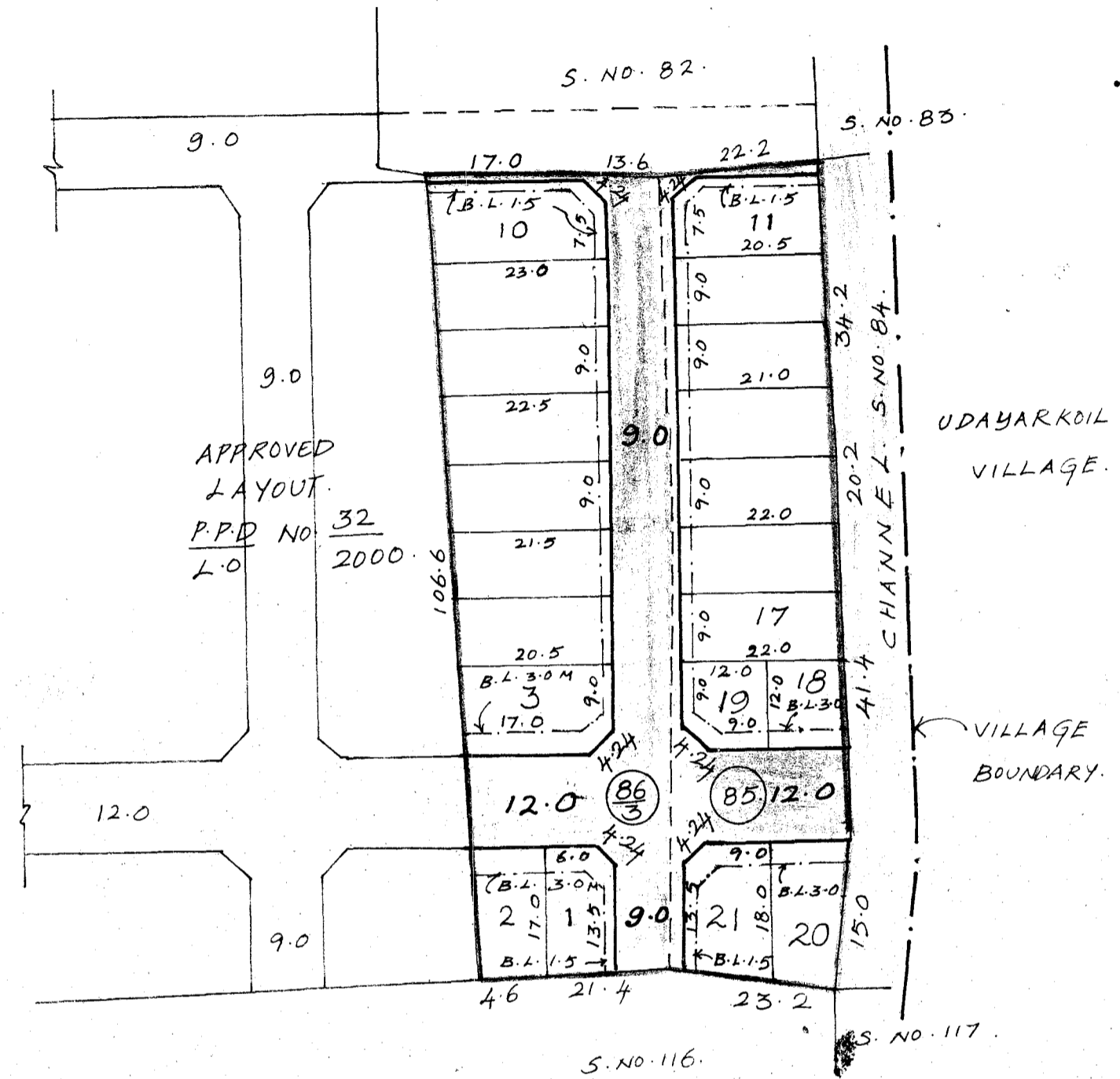

NOTE :

1. SPLAY - 3.0 M X 3.0 M
2. MEASUREMENTS ARE INDICATED EXCLUDING SPLAY DIMENSIONS.
3. ROAD AREA TO BE HANDED OVER TO THE LOCAL BODY
 VIDE GIFT DEED DOCUMENT NO : 1907/09 DATED : 6.8.09
 AND REGISTERED ON 1.12.09.

LEGEND :

- SITE BOUNDARY
- PROPOSED ROAD.
- EXISTING ROAD.

CONDITION
 THE LAYOUT APPROVAL IS VALID
 SUBJECT TO OBTAINING SANCTION
 FROM THE LOCAL BODY CONCERNED

P.P.D NO. 3
 L.O. 2010

APPROVED
 VIDE LETTER NO : L1/16418/09.
 DATED : 01/02/2010.

FOR OFFICE COPY

FOR MEMBER - SECRETARY
 CHENNAI METROPOLITAN
 DEVELOPMENT AUTHORITY
 4.2.10

THIRUMAZHISAI TOWN PANCHAYAT.

LAY OUT OF HOUSE SITES IN S.NO. 85 AND 86/3 OF
 THIRUMAZHISAI VILLAGE.

SCALE - 1 : 800. (ALL MEASUREMENTS ARE IN METRE)

