

TOTAL EXTENT : 48076.00 M2
 ROAD AREA : 11611.92 M2
 PARK AREA : 3678.81 M2
 PUBLIC PURPOSE PLOTS (I TO IX) : 3699.00 M2
 TOTAL NO OF PLOTS : 154 NOS
 CONVENIENCE SHOP SITE : 2 NOS

NOTE:

1. SPRAWY 1.5M X 1.5M, 3.0M X 3.0M.
2. MEASUREMENTS INDICATED ARE EXCLUDING SPRAWY DIMENSIONS.
3. ROAD AREA " " WERE ALREADY HANDED OVER TO THE LOCAL BODY
4. PARK AREA " " WERE GIFT DEED DOC. NO-4299 /2011 , DT: 12.05.2011.

CONDITIONS:

I.D.R RULE NO: 29(8)

THE AREA earmarked for public purpose I TO IX, "UT ROOF" AND TELEGRAPH OFFICE STATION ETC SHOULD REMAIN RESERVED FOR A SPECIFIC PERIOD OF ONE YEAR FROM THE DATE OF APPROVAL. UNLESS THE GOVERNMENT IS CONCERNED TO NEGOTIATE WITH THE OWNER AND TO PURCHASE THE LAND FROM THE LAND OWNER OR DEVELOPER OR PROMOTER ON PAYING THE COST OF PLOTS SO RESERVED THE OWNER OR DEVELOPER OR PROMOTER HAS EVERY RIGHT TO SELL THE LANDS FOR RESIDENTIAL PURPOSE IF NO DEMAND FROM ANY PUBLIC DEPARTMENTS IS RECEIVED WITHIN ONE YEAR.

II. OR RULE NO: 29 (11)
 THE COST OF LAYING INFRASTRUCTURES TO THE EXTENT OF ROAD, WATER, SUPPLY, SEWERAGE, DRAINAGE OR ELECTRIC POWER SUPPLY THAT MAY BE REQUIRED AS ASSESSED BY THE COMPETENT AUTHORITY, SHALL BE BORNE BY THE APPLICANT.

III. ALL THE PLOTS IN THE LAYOUT SHOULD BE ALLOTTED ONLY FOR THE RAILWAY EMPLOYEES AND NOT TO BE ALLOTTED / SOLD TO OTHERS.

IV. PWD CONDITIONS

THE FOLLOWING CONDITIONS OF PWD STIPULATED IN CASE ENGINEER P.W.D. W.B. CHERNA REGION, CHENNAI, CHENNAI, LETTER NO. TE 01 / 6517 / 2009 DATED 21-12-2009, SHALL BE COMPLIED WITH BY THE APPLICANT WHILE FORMATION OF THE LAYOUT AND THE LOCAL BODY SHALL ENSURE THE SAME.

1. THE PROMOTER SHOULD CONSTRUCT A FLOOD PROTECTION WALL ALL AROUND THE PROPOSED SITE AND THE TOP LEVEL OF THE WALL SHALL BE ABOVE THE M.S.L. (a) (+) 17.280 m.
2. THE GROUND LEVEL OF THE SITE SHOULD BE RAISED UP TO THE LEVEL OF (+) 18.230M (a) NEAREST APPROACH ROAD LEVEL (+) 17.230M PLUS 0.30M TO AVOID ANY INUNDATION PROBLEM DURING RAINY SEASON.
3. THE PROMOTER SHOULD PROVIDE NECESSARY RAINWATER HARVESTING ARRANGEMENTS IN THE SITE AT THEIR OWN COST.
4. SEPARATE SEWAGE TREATMENT PLANT AND RECYCLING PLANT SHOULD BE PROVIDED IN THE PROPOSED SITE AT PROMOTERS OWN COST, FOR THEIR USE.
5. THE PROMOTER SHOULD NOT MAKE ANY HINDRANCE TO THE FREE FLOW OF WATER TO THE TANK WHICH IS COMING FROM CATCHMENT AREA AND DAMAGE NET WORK TO BE FORMED TO HARVEST RAINWATER.
6. ANY ENCROACHMENT IN THE WATER SPREAD AREA OF AMBATTUR TANK BY THE PROMOTER WILL BE TREATED AS UNLAWFUL AND WILL BE ECITED BY THE GOVERNMENT.
7. THE PROMOTER SHOULD NOT LET SEWAGE OR ANY KIND OF POLLUTION IN TO THIS TANK AND TO INSTALL TREATMENT ARRANGEMENTS ACCORDING TO THE PLAN OF DEVELOPMENT.
8. THE PROMOTER SHOULD ABIDE BY RULES AND REGULATIONS OF THE WATER RESOURCES DEPARTMENT ISSUED FROM TIME TO TIME.
9. THE PERMISSION GRANTED IS LIABLE TO BE REVOKED IF BREACH IN ANY OF THE CONDITION NOTICED AND IN THE EVENT OF SUCH REVOCATION, THE PROMOTER SHALL NOT BE ELIGIBLE TO CLAIM ANY COMPENSATION WHAT SO EVER.

V. SOUTHERN RAILWAY CONDITIONS

1. THIS NOC IS ISSUED SUBJECT TO THE CONDITION STIPULATED IN THE AGREEMENT EXECUTED BY YOU.
2. DRAINAGE AND SILLAGE WATER SHOULD NOT BE LET IN THE RAILWAY LAND.
3. SET BACK FROM RAILWAY BOUNDARY ON TRACK SIDE SHOULD BE MAINTAINED MINIMUM 5 METERS.
4. THIS NOC IS VALID ONLY FOR OPEN SITE / LAYOUT. FOR PROPOSED STRUCTURES FRESH NOC HAS TO BE OBTAINED WHICH FALLS WITH IN 30M (100 FEET) FROM RAILWAY LIMIT.
5. I.E.M.O. SHOULD CONSTRUCT A COMPOUND WALL AT THE RAILWAY BOUNDARY SIDE.
6. IN FUTURE IF RAILWAYS REQUIRES YOUR LAND / PART OF YOUR LAND THE SAME SHOULD BE HANDED OVER TO THE RAILWAY PREVIOUS LAND ACQUISITION PROCEDURE.
7. A DETAILED PLAN NO. DM / ABU / 74IS ENCLOSED.

VI. TNPCB CONDITION

A 20m width of the GREEN STRIP SHOULD BE MAINTAINED ALONG THE BOUNDARY FROM THE COMPOUND WALL OF THE UNIT AS A BUFFER ZONE.

- LEGEND**
- SITE BOUNDARY
 - PROPOSED ROAD
 - EXISTING ROAD
 - PARK
 - PUBLIC PURPOSE
 - CONVENIENCE SHOP

CONDITIONS:
 THE LAYOUT APPROVED IS VALID SUBJECT TO OBTAINING SANCTION FROM THE LOCAL BODY CONCERNED.

P.P.D NO: 16
 L.O APPROVED 2011
 VIDE LETTER NO. 11 / 4616 / 2011
 DATE : 25 / 07 / 2011

OFFICE COPY

FOR MEMBERS SECRETARY
 CHENNAI METROPOLITAN
 DEVELOPMENT AUTHORITY

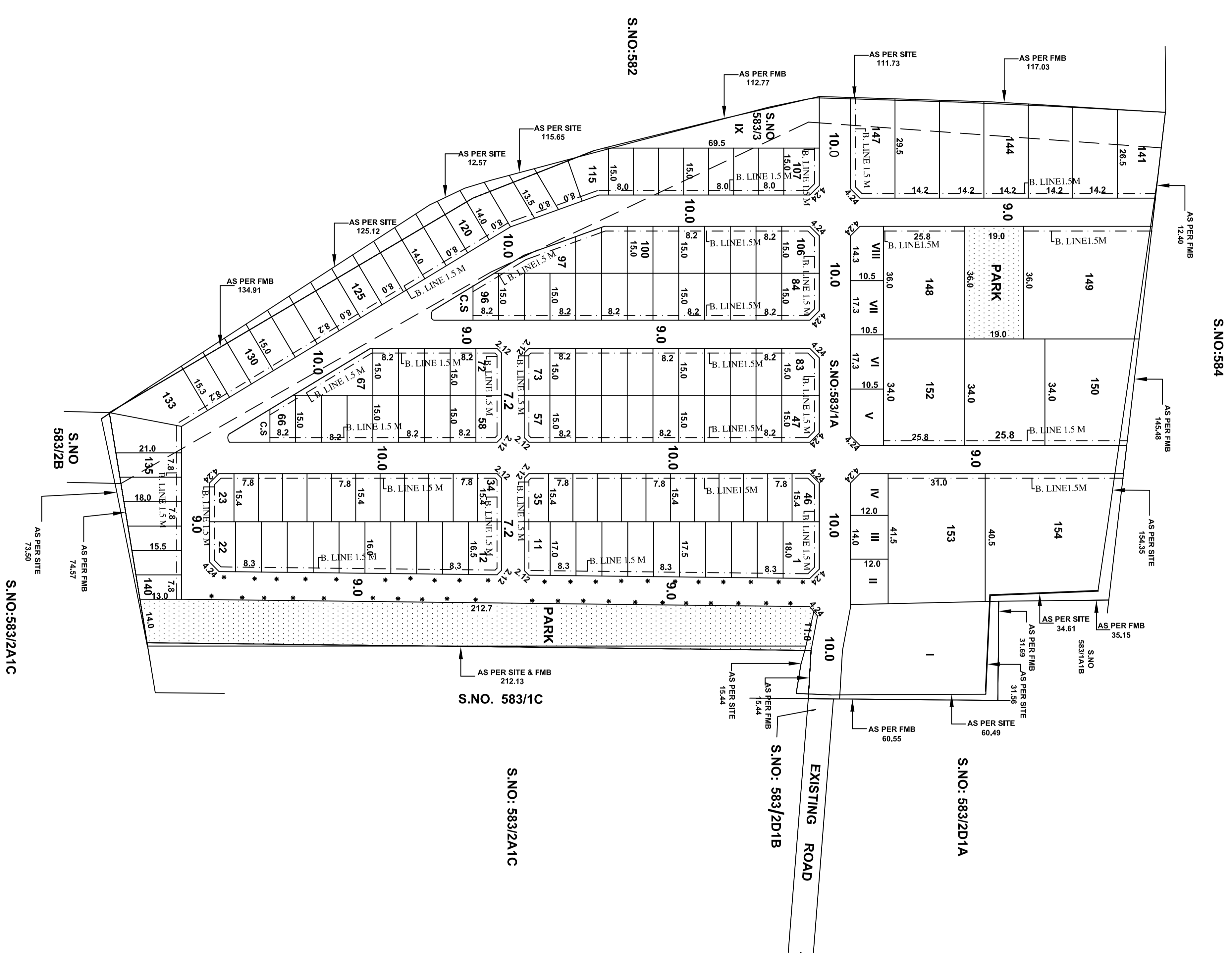

PREPARED BY : P.A.T.(N.M) A.P.(K.M) D.P.(V.K) S.P.(S.C)
AMBATTUR MUNICIPALITY
 LAYOUT OF HOUSE SITES IN S.NOS.583/1A AND 583/3 OF AMBATTUR VILLAGE.
 SCALE 1:800 (ALL MEASUREMENTS ARE IN METRE)