

TOTAL EXTENT (AS PER DOCUMENT) : 9516 SQ.M
ROAD AREA : 3498 SQ.M
PARK AREA : 605 SQ.M
TOTAL NO. OF PLOTS : 47 NOS

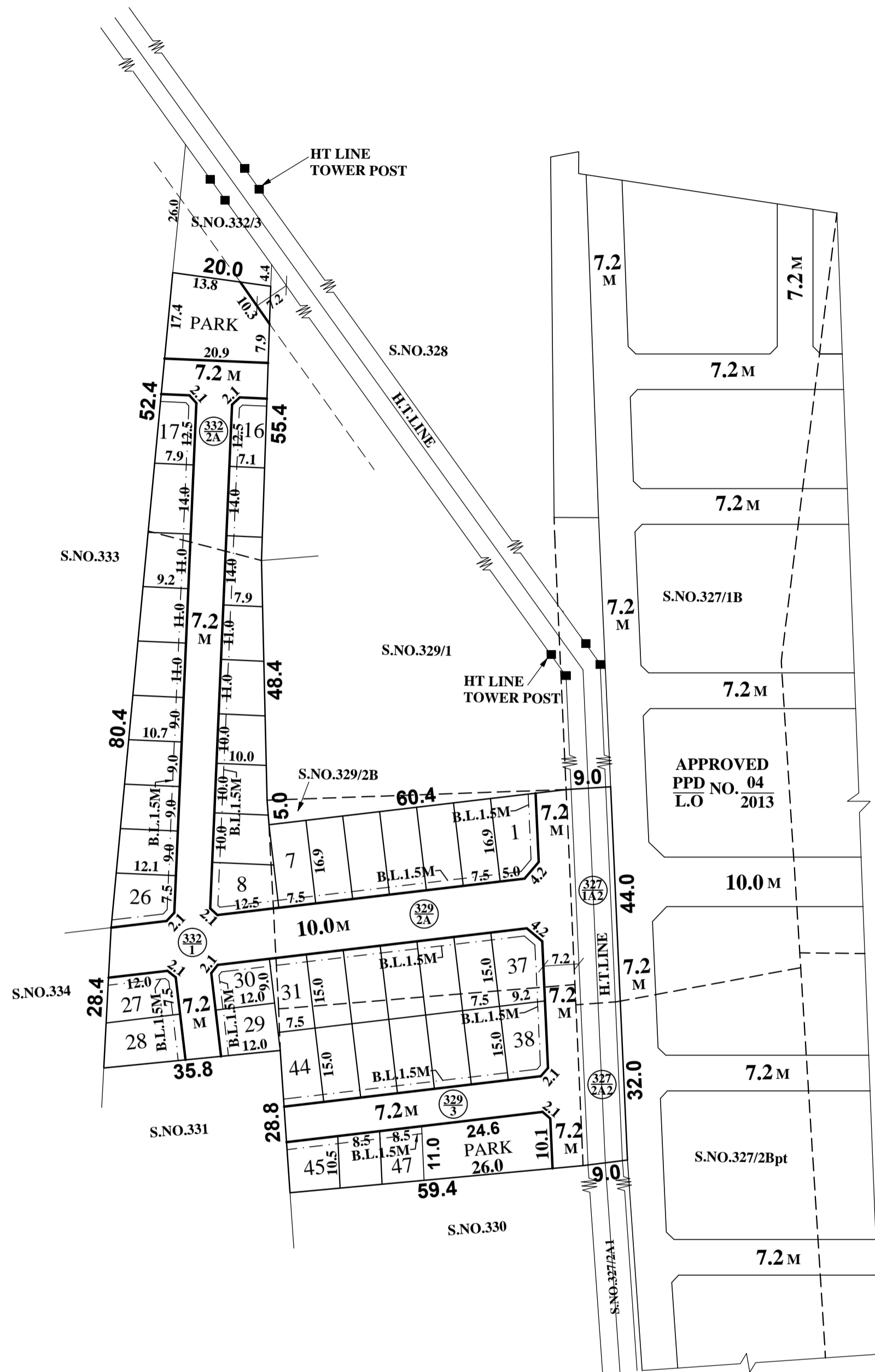

NOTE:

1. SPLAY - 3.0M x 3.0M, 1.5M x 1.5M
2. MEASUREMENTS ARE INDICATED EXCLUDING SPLAY DIMENSIONS
3. ROAD AREA } WERE HANDED OVER TO THE LOCAL BODY VIDE
 PARK AREA } GIFT DEED DOC.NO: 9195 / 2018, DATED: 04/07/2018 @ SRO, AMBATTUR

CONDITIONS:

DR RULE NO: 29 (11)

THE COST OF LAYING IMPROVEMENTS TO THE SYSTEMS INRESPECT OF ROAD, WATER SUPPLY, SEWERAGE, DRAINAGE OR ELECTRIC POWER SUPPLY THAT MAY BE REQUIRED AS ASSESSED BY THE COMPETENT AUTHORITY, SHALL BE BORNE BY THE APPLICANT.

LEGEND:

- SITE BOUNDARY
- ROADS GIFTED TO THE LOCAL BODY
- EXISTING ROAD
- PARK GIFTED TO THE LOCAL BODY

CONDITIONS:

THE LAYOUT APPROVED IS VALID SUBJECT TO OBTAINING SANCTION FROM THE LOCAL BODY CONCERNED.

P.P.D NO: 55
L.O 2018

APPROVED

VIDE LETTER NO : L1 / 12498 / 2017
DATE : 21 / 08 / 2018

OFFICE COPY

FOR MEMBER SECRETARY
CHENNAI METROPOLITAN
DEVELOPMENT AUTHORITY

VILLIVAKKAM PANCHAYAT UNION

LAYOUT OF HOUSE SITES IN S.Nos: 327/1A2,2A2, 329/2A,3 & 332/1,2A OF AYAPAKKAM VILLAGE.

SCALE : 1:800 (ALL MEASUREMENTS ARE IN METRE)

