

**SITE EXTENT** : **1161.55 SQ.M**  
**NO.OF.PLOTS** (RESIDENTIAL) : **5 Nos.**

**NOTE:**

MEASUREMENTS ARE INDICATED EXCLUDING SPLAY DIMENSIONS

**CONDITIONS:**

(I)THE FOLLOWING CONDITIONS OF PWD VIDE THE CE,WRD,CHENNAI REGION, CHEPAUK , CHENNAI -5. LETTER NO.T1/ NOLAMBUR / COC / VGN / 2016 / DATED: 01.03.2016, ARE TO BE COMPLIED BY THE APPLICANT BEFORE ISSUING OF THE LAYOUT APPROVAL BY THE COMPETENT AUTHORITY (LOCAL BODY)

- 1.THE APPLICANT SHOULD RAISE THE EXISTING GROUND LEVEL TO THE LEVEL OF (+)14.320M MSL WITH THE DEPTH OF FILLING RANGING FROM 0.430 TO 1.165M.
- 2.THE PROCESS OF FILLING SHALL BE WITH SUITABLE EARTH AND PROPER COMPACTION SHOULD BE DONE IN LAYERS OF NOT MORE THAN 0.30METRE DEPTH TO ACHIEVE THE REQUIRED DEGREE OF COMPACTION.
- 3.THE APPLICANT SHOULD PROVIDE ADEQUATE DEWATERING ARRANGEMENTS TO BAIL OUT THE WATER WITHIN THE PREMISES AND NECESSARY DRAINAGE FACILITIES MUST BE PROVIDED AS THE NORMS OF THE POLLUTION CONTROL BOARD.
- 4.THE APPLICANT SHOULD PROVIDE RAIN WATER HARVESTING ARRANGEMENTS IN THE SITE AT THEIR OWN COST.
- 5.THE APPLICANT SHOULD MAKE ARRANGEMENT TO COLLECT THE GARBAGE'S WITHIN THE PREMISES AND HAS TO BE DISPOSED OFF AS PER POLLUTION CONTROL BOARD NORMS AND SHOULD NOT DUMP IN THE CHANNEL ETC.
6. PROPER STORM WATER DRAINAGE CHANNEL OF SIZE 0.60X0.90M SHOULD BE CONSTRUCTED ALL-ROUND THE SITE WITH A RULING BED LEVEL BY THE APPLICANT AT THEIR OWN COST AND THIS CHANNEL SHOULD BE LINKED WITH THE EXISTING ROAD DRAIN IN FRONT SIDE OF THE SITE AS SHOWN IN DRAWING TO DRAIN OUT THE RAIN WATER.
- 7.THE SEWAGE WATER FROM THE APPLICANT LAND SHOULD NOT BE LET INTO THE CHANNEL AND FOR THE DISPOSAL OF THE SEWAGE WATER SUITABLE ARRANGEMENTS SHOULD MADE BY THE APPLICANT AT THEIR LAND.
- 8.NO ENCROACHMENT SHOULD BE DONE IN GOVERNMENT LAND AND NECESSARY DEMARCATION SHOULD BE DONE TO FIX THE BOUNDARY LAND THROUGH THE REVENUE DEPARTMENT IN THE PRESENCE OF THE WRD OFFICIALS AND THE APPLICANT SHOULD ALSO FIX THE BOUNDARY STONE OF SIZE 0.15X0.15X1.50M AT THEIR OWN COST.
- 9.NO ENCROACHMENT SHOULD MADE IN THE GOVERNMENT PORAMBOKE LANDS, CHANNEL BY THE APPLICANT AT ANY COST, AT ANY TIME.
- 10.THE APPLICANT SHOULD STRICTLY ADHERE TO MAINTAIN THE HYDRAULIC STANDARDS OF THE EXISTING CHANNEL, PORAMBOKE LANDS, ETC.
- 11.THE WRD OFFICIAL SHOULD BE ALLOWED TO INSPECT THE SITE AT ANY TIME DURING EXECUTION.
- 12.THE APPLICANT SHOULD ABIDE BY THE RULES AND REGULATIONS OF THE WRD FROM TIME TO TIME.
- 13.THE CONDITIONS ALREADY LAID DOWN IN GOVERNMENT LR.NO.4122/R1/2013-2/ DT.03.05.2013 PERMITTING CONSTRUCTION OF CULVERT IN GOVERNMENT IRRIGATION CHANNEL SHOULD ALSO BE STRICTLY FOLLOWED.



FAILING TO COMPLY WITH THE CONDITIONS, MENTIONED IN THE ABOVE LETTER DATED:01.03.2016,WRD RESERVES RIGHTS TO WITHDRAW THE NOC ON INUNDATION POINT OF VIEW TO THE ABOVE SURVEY NUMBER AND IN THAT EVENT, THE APPLICANT SHALL NOT BE ELIGIBLE FOR ANY COMPENSATION WHAT SO EVER.

(II) LOCAL BODY SHOULD ENSURE COMPLIANCE OF ALL THE CONDITIONS STIPULATED BY PWD IN THEIR LETTER NO. T1/NOLAMBUR/COC/VGN/2016/DATED:01.03.2016, AND SHALL OBTAIN A LETTER FROM PWD CONFIRMING THE COMPLIANCE OF THE CONDITIONS BEFORE THE SANCTION AND RELEASE OF THE LAYOUT .

**(III)DR RULE NO : 29 (11)**

THE COST OF LAYING IMPROVEMENTS TO THE SYSTEMS IN RESPECT OF ROAD, WATER SUPPLY, SEWERAGE, DRAINAGE OR ELECTRIC POWER SUPPLY THAT MAY BE REQUIRED AS ASSESSED BY THE COMPETENT AUTHORITY SHALL BE BORNE BY THE APPLICANT.

**LEGEND:**

-  SITE BOUNDARY
-  EXISTING ROAD

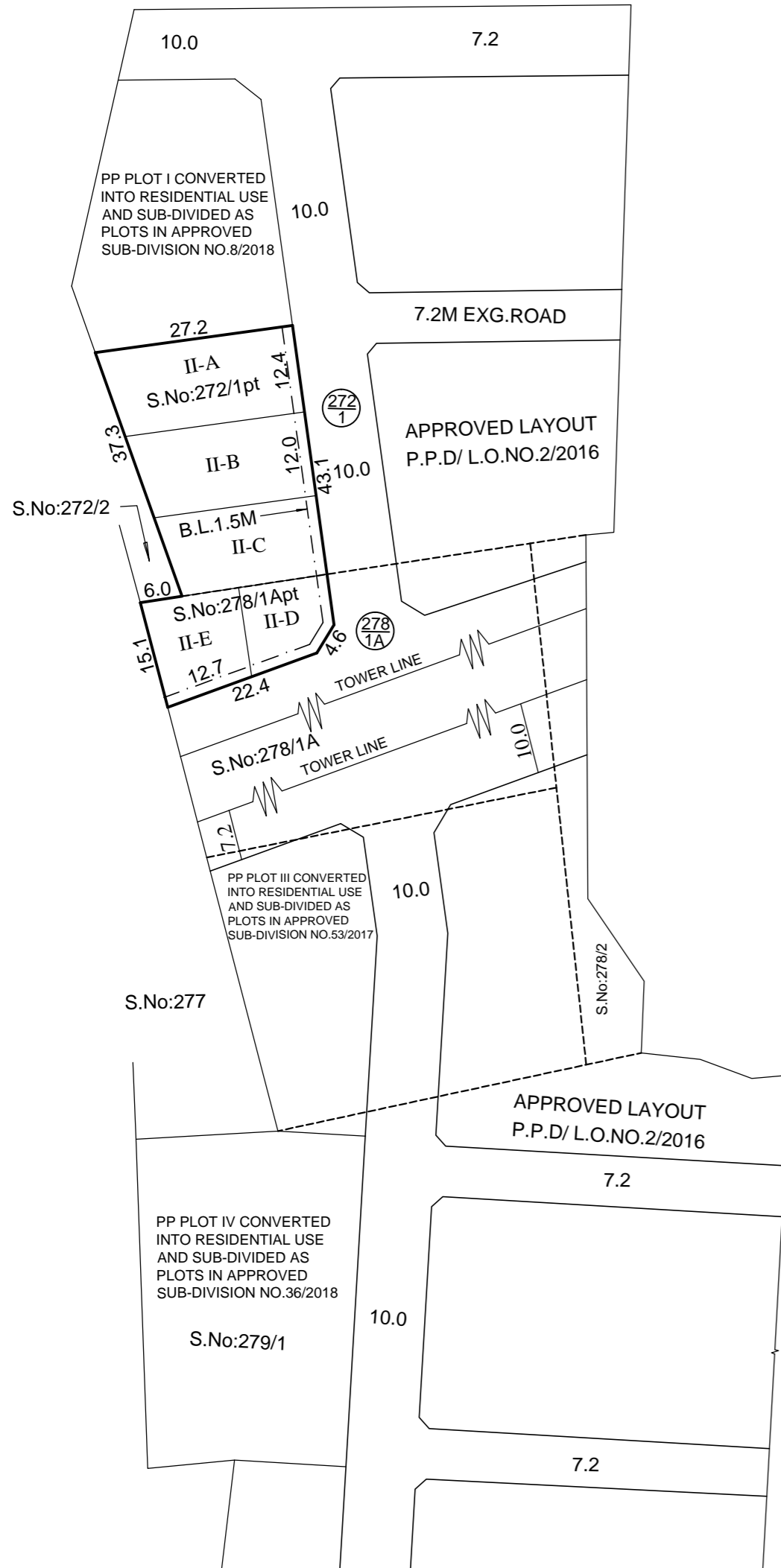

**CONDITION:-**  
**THE SUB-DIVISION APPROVAL IS VALID SUBJECT TO OBTAINING SANCTION FROM THE LOCAL BODY CONCERNED**

<b>P.P.D</b>	<b>NO</b>	<b>58</b>
<b>L.O</b>		<b>2018</b>
<b>APPROVED</b>		
VIDE LETTER NO	:	L1 / 8862 / 2018
DATED	:	11 / 09 / 2018

**OFFICE COPY**

FOR MEMBER SECRETARY  
 CHENNAI METROPOLITAN  
 DEVELOPMENT AUTHORITY

**GREATER CHENNAI CORPORATION**

**SKETCH SHOWING THE SUB DIVISION AND CONVERSION OF PUBLIC PURPOSE PLOT NO.II INTO RESIDENTIAL USE IN THE APPROVED LAYOUT P.P.D/L.O.NO.2/2016 IN S.Nos. 272/1pt AND S.No.278/1Apt OF NOLAMBUR VILLAGE.**

SCALE-1:800 (ALL MEASUREMENTS ARE IN METRE)

