

**TOTAL EXTENT (AS PER PATTA) : 1735 SQ.M**  
**ROAD AREA : 676 SQ.M**  
**NO.OF.PLOTS : 11Nos.**

**NOTE:**



1. SPLAY - 1.5M X 1.5M
2. MEASUREMENTS ARE INDICATED EXCLUDING SPLAY DIMENSION.
3.  ROAD AREA WAS HANDED OVER TO THE LOCAL BODY  
 VIDE GIFT DEED DOCUMENT NO: 4326/2019, DATED: 17.06.2019 @ SRO PADAPPAI

**CONDITION :**

**DR RULE NO : 29 ( 11 )**

THE COST OF LAYING IMPROVEMENTS TO THE SYSTEMS IN RESPECT OF ROAD, WATER SUPPLY, SEWERAGE, DRAINAGE OR ELECTRIC POWER SUPPLY THAT MAY BE REQUIRED AS ASSESSED BY THE COMPETENT AUTHORITY SHALL BE BORNE BY THE APPLICANT.

**LEGEND :**

-  SITE BOUNDARY
-  ROADS GIFTED TO LOCAL BODY
-  EXISTING ROAD

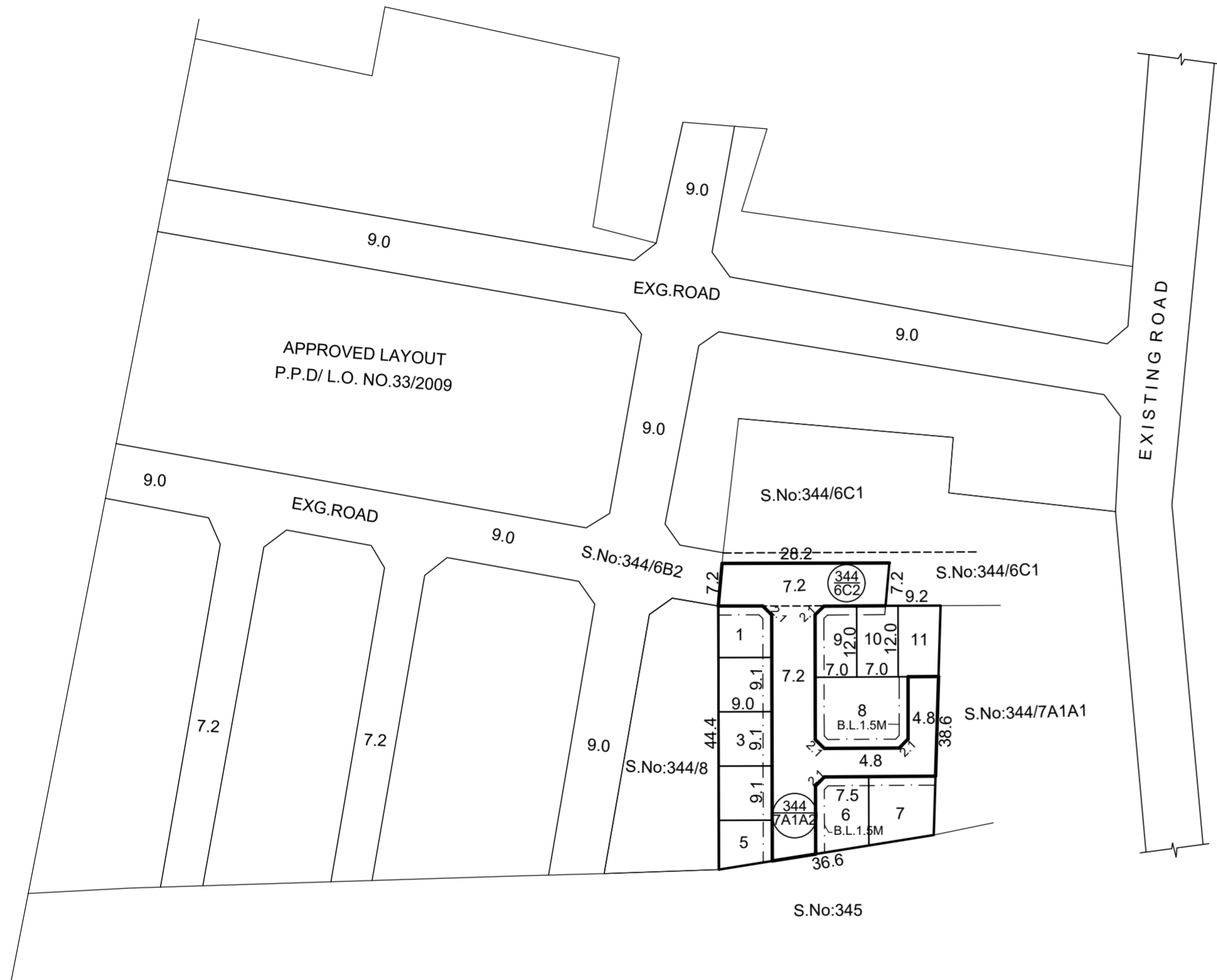

**CONDITION:-**  
 THE LAYOUT APPROVAL IS VALID SUBJECT TO OBTAINING SANCTION FROM THE LOCAL BODY CONCERNED

|          |    |      |
|----------|----|------|
| P.P.D    | NO | 73   |
| L.O      |    | 2019 |
| APPROVED |    |      |

VIDE LETTER NO : L1 / 18589 / 2018  
 DATED : 05 / 07 / 2019

OFFICE COPY

FOR SENIOR PLANNER(M.S.B/LAYOUT)  
 CHENNAI METROPOLITAN  
 DEVELOPMENT AUTHORITY

**KUNDRATHUR PANCHAYAT UNION**

**LAY OUT OF HOUSE SITES IN S.Nos:344/6C2 AND S.No.344/7A1A2 OF NADUVEERAPATTU VILLAGE.**

SCALE-1:800 (ALL MEASUREMENTS ARE IN METRE)

