

**TOTAL EXTENT (AS PER PATTA) = 10000 Sq.M**  
**ROAD AREA = 3383 Sq.M**  
**TOTAL NO OF PLOTS = 64 Nos.**  
**CONVENIENT SHOP SITE = 1 No.**

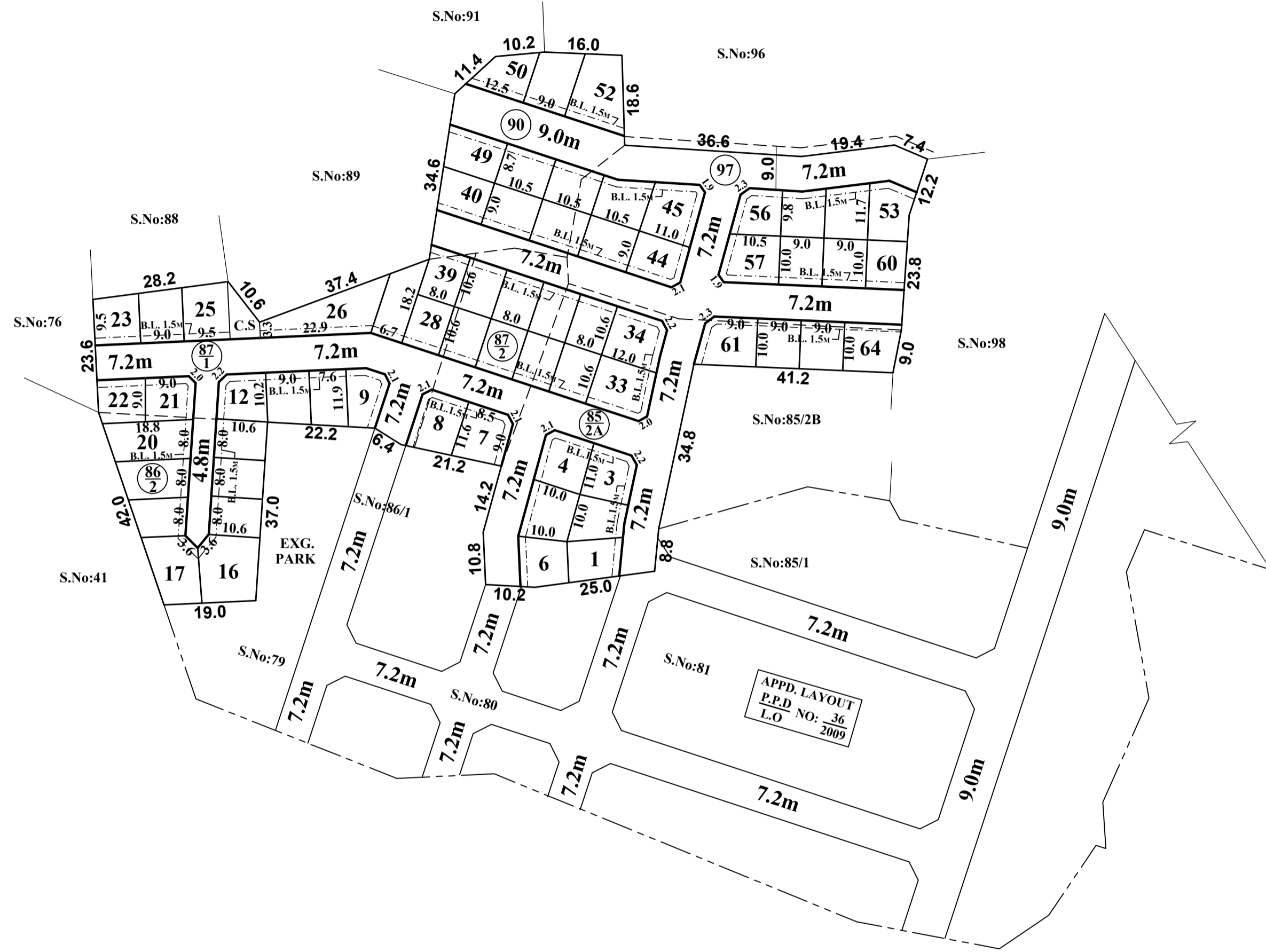

**NOTE:**  
 1. SPLAY - 1.5M x 1.5M  
 2. MEASUREMENTS ARE INDICATED EXCLUDING SPLAY DIMENSIONS  
 3. ROAD AREA WAS HANDED OVER TO THE LOCAL BODY VIDE GIFT DEED  
 DOC.NO: 11946 / 2019, DATED: 23.07.2019 @ SRO, KUNDRATHUR

**CONDITIONS:**  
**DR RULE NO: 29 (11)**  
 THE COST OF LAYING IMPROVEMENTS TO THE SYSTEMS INRESPECT OF ROAD, WATER SUPPLY, SEWERAGE, DRAINAGE OR ELECTRIC POWER SUPPLY THAT MAY BE REQUIRED AS ASSESSED BY THE COMPETENT AUTHORITY, SHALL BE BORNE BY THE APPLICANT.

**LEGEND:**  
 [Symbol] SITE BOUNDARY  
 [Symbol] ROADS GIFTED TO THE LOCAL BODY  
 [Symbol] EXISTING ROAD  
 [Symbol] CONVENIENT SHOP

**CONDITIONS:**  
 THE LAYOUT APPROVED IS VALID SUBJECT TO OBTAINING SANCTION FROM THE LOCAL BODY CONCERNED.

**P.P.D NO: 95**  
**L.O 2019**  
**APPROVED**  
 VIDE LETTER NO : L1 / 22664 / 2018  
 DATE : 29 / 08 / 2019

**OFFICE COPY**

FOR MEMBER SECRETARY  
 CHENNAI METROPOLITAN  
 DEVELOPMENT AUTHORITY

**POONAMALLEE PANCHAYAT UNION**  
**LAYOUT OF HOUSE SITES IN S.Nos: 85/2A, 86/2, 87/ 1, 2, 90 & 97 OF MEPPUR VILLAGE.**  
 SCALE : 1:800 (ALL MEASUREMENTS ARE IN METRE.)

