

SITE EXTENT (AS PER DOCUMENT)	:	3885 SQ.M
ROAD AREA (24%)	:	928 SQ.M
PLOTTABLE AREA (76%)	:	2957 SQ.M
1% PUBLIC PURPOSE REQUIRED	:	30 SQ.M
PUBLIC PURPOSE PROVIDED (1 & 2)	:	31 SQ.M
PUBLIC PURPOSE-1	:	16.0 SQ.M
PUBLIC PURPOSE-2	:	15.0 SQ.M
TOTAL NO. OF PLOTS	:	28 Nos.

NOTE:

1. SPLAY - 1.5M x 1.5M
2. MEASUREMENTS ARE INDICATED EXCLUDING SPLAY DIMENSIONS
3.

	ROAD AREA
	PUBLIC PURPOSE-1
	PUBLIC PURPOSE-2

 WERE HANDED OVER TO THE LOCAL BODY VIDE GIFT DEED
DOC.NO:18815/2022, DATED:07.09.2022 @ SRO,KUNDRATHUR.

CONDITIONS:

(I) TNCDBR-2019 RULE NO: 47 (8) IN G.O.(Ms) No.18, MAWS DEPARTMENT DATED 04.02.2019 & AMENDMENTS APPROVED IN G.O.Ms.No.16, MAWS (MAI) DEPARTMENT DATED 31.01.2020 AND PUBLISHED IN TNGG ISSUE No.41.DATED 31.01.2020

ONE PERCENT OF LAYOUT AREA EXCLUDING ROAD, ADDITIONALLY, SHALL BE RESERVED FOR "PUBLIC PURPOSE". WITHIN THE ABOVE CEILING 0.5% OF AREA SHALL BE TRANSFERRED TO THE LOCAL BODY AND 0.5% OF AREA SHALL BE TRANSFERRED TO THE TANGEDCO OR TO THE LOCAL BODY FREE OF COST THROUGH A REGISTERED GIFT DEED BEFORE THE ACTUAL SANCTION OF THE LAYOUT.

(II) TNCDBR RULE NO: 47 (11)

THE COST OF LAYING IMPROVEMENTS TO THE SYSTEMS IN RESPECT OF ROAD, WATER SUPPLY, SEWERAGE, DRAINAGE OR ELECTRIC POWER SUPPLY THAT MAY BE REQUIRED AS ASSESSED BY THE CONCERNED AUTHORITY, NAMELY, THE LOCAL BODY AND TAMIL NADU ELECTRICITY BOARD, SHALL BE BORNE BY THE APPLICANT.

(III) THE APPLICANT IS RESPONSIBLE FOR THE SHAPE, SIZE & DIMENSIONS OF THE SITE UNDER REFERENCE.

© NECESSARY SPACE FOR BUILDING LINE TO BE LEFT AS PER THE RULE IN FORCE WHILE TAKING UP DEVELOPMENT

LEGEND:

- SITE BOUNDARY
- PROPOSED ROAD
- EXISTING ROAD
- PUBLIC PURPOSE -1
- PUBLIC PURPOSE -2

CONDITIONS:

THE LAYOUT APPROVED IS VALID SUBJECT TO OBTAINING SANCTION FROM THE LOCAL BODY CONCERNED.

P.P.D	NO :	122
L.O		2022

APPROVED

VIDE LETTER NO : LAYOUT-1 / 9221 / 2022
DATE : 14 / 09 / 2022

OFFICE COPY

FOR SENIOR PLANNER (LAYOUT)
CHENNAI METROPOLITAN
DEVELOPMENT AUTHORITY

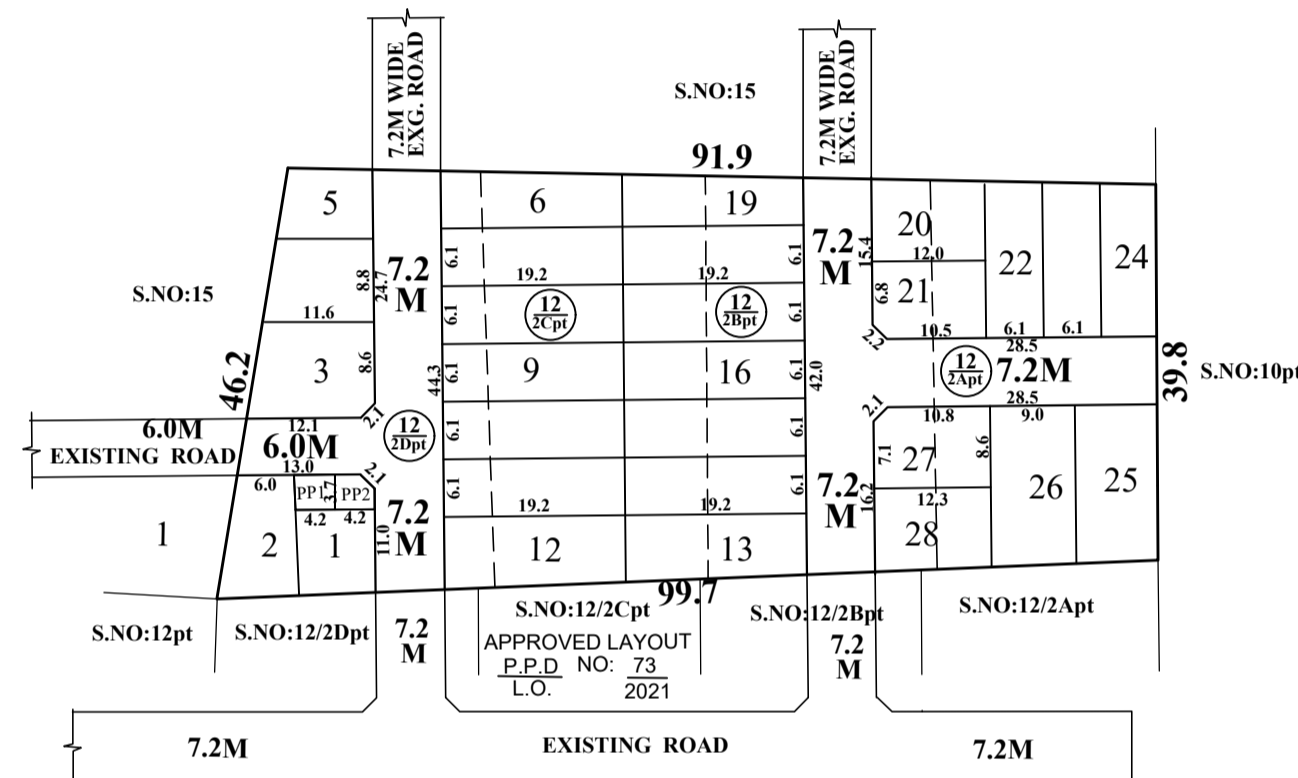

This Planning Permission Issued under New Rule TNCDBR.2019 is subject to final outcome of the W.P(MD) No.8948 of 2019 and WMP (MD) Nos. 6912 & 6913 of 2019.

POONAMALLEE PANCHAYAT UNION

LAYOUT OF HOUSE SITES IN S.Nos: 12/2Apt, 2Bpt, 2Cpt, 2Dpt OF SENNERKUPPAM VILLAGE.

SCALE : 1:800 (ALL MEASUREMENTS ARE IN METRE)