

**SITE EXTENT** (AS PER GPoA DOCUMENT) = **2448 SQ.M**  
**ROAD AREA** = **380 SQ.M**  
**NO. OF PLOTS** = **8 NOS.**

**NOTE:**

1. SPLAY - 1.5M x 1.5M
2. MEASUREMENTS ARE INDICATED EXCLUDING SPLAY DIMENSIONS
3.  ROAD AREA WAS HANDED OVER TO THE LOCAL BODY VIDE GIFT DEED  
DOC. NO: 11967 / 2023, DATED: 22.07.2023 @ SRO, SELAIYUR



**CONDITIONS:**(I) TNCDBR-2019, RULE NO: 47 (11)

THE COST OF LAYING IMPROVEMENTS TO THE SYSTEMS IN RESPECT OF ROAD, WATER SUPPLY, SEWERAGE, DRAINAGE OR ELECTRIC POWER SUPPLY THAT MAY BE REQUIRED AS ASSESSED BY THE CONCERNED AUTHORITY, NAMELY, THE LOCAL BODY AND TAMIL NADU ELECTRICITY BOARD, SHALL BE BORNE BY THE APPLICANT.

(II) THE APPLICANT IS RESPONSIBLE FOR THE SHAPE, SIZE &amp; DIMENSIONS OF THE SITE UNDER REFERENCE.

- ⊙ NECESSARY SPACE FOR BUILDING LINE TO BE LEFT AS PER THE RULE IN FORCE WHILE TAKING UP DEVELOPMENT.

**LEGEND:**

-  SITE BOUNDARY
-  ROAD GIFTED TO LOCAL BODY
-  EXISTING ROAD

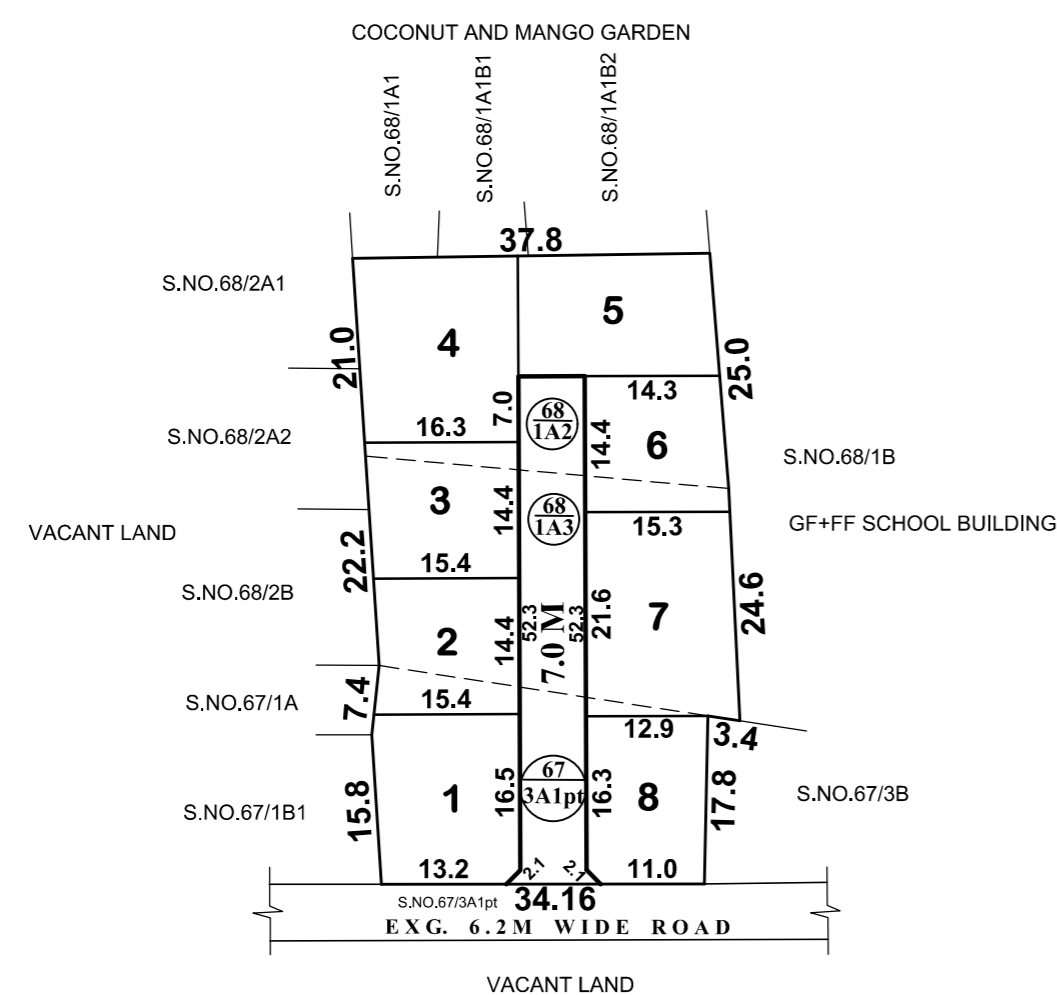
**CONDITIONS:**

THE SUB-DIVISION APPROVED IS VALID SUBJECT TO OBTAINING SANCTION FROM THE LOCAL BODY CONCERNED.

**P.P.D** NO : **260**  
**L.O** **2023**

**APPROVED**

VIDE LETTER NO : LAYOUT-1 / 0195 / 2021

DATE : 15 / 11 / 2023

**OFFICE COPY**

FOR SENIOR PLANNER (LAYOUT)  
 CHENNAI METROPOLITAN  
 DEVELOPMENT AUTHORITY

This Planning Permission Issued under New Rule TNCDBR.2019 is subject to final outcome of the W.P(MD) No.8948 of 2019 and WMP (MD) Nos. 6912 & 6913 of 2019.

**ST.THOMAS MOUNT PANCHAYAT UNION**

SUB-DIVISION OF HOUSE SITES IN S.No: 67 / 3A1pt AND 68 / 1A2 &amp; 1A3 OF SITHALAPAKKAM VILLAGE.

SCALE : 1:800 (ALL MEASUREMENTS ARE IN METRE.)

