

SITE EXTENT (AS PER DOCUMENT) = **3763 SQ.M**
ROAD AREA = **1135 SQ.M**
NO.OF PLOTS = **4 NOS**

NOTE:

1. SPLAY - 1.5M x 1.5M
2. MEASUREMENTS ARE INDICATED EXCLUDING SPLAY DIMENSIONS
3. ROAD AREA WAS HANDED OVER TO THE LOCAL BODY VIDE GIFT DEED
 DOC. NO: 16055 / 2023, DATED: 26.10.2023 @ SRO, CHENNAI SOUTH JOINT I

CONDITIONS:

- (I) TNCDDBR-2019, RULE NO: 47 (11)
 THE COST OF LAYING IMPROVEMENTS TO THE SYSTEMS IN RESPECT OF ROAD, WATER SUPPLY, SEWERAGE, DRAINAGE OR ELECTRIC POWER SUPPLY THAT MAY BE REQUIRED AS ASSESSED BY THE CONCERNED AUTHORITY, NAMELY, THE LOCAL BODY AND TAMIL NADU ELECTRICITY BOARD, SHALL BE BORNE BY THE APPLICANT.
- (II) THE APPLICANT IS RESPONSIBLE FOR THE SHAPE, SIZE & DIMENSIONS OF THE SITE UNDER REFERENCE.
- ☉ NECESSARY SPACE FOR BUILDING LINE TO BE LEFT AS PER THE RULE IN FORCE WHILE TAKING UP DEVELOPMENT.

LEGEND:

- SITE BOUNDARY
- ROAD GIFTED TO LOCAL BODY
- EXISTING ROAD

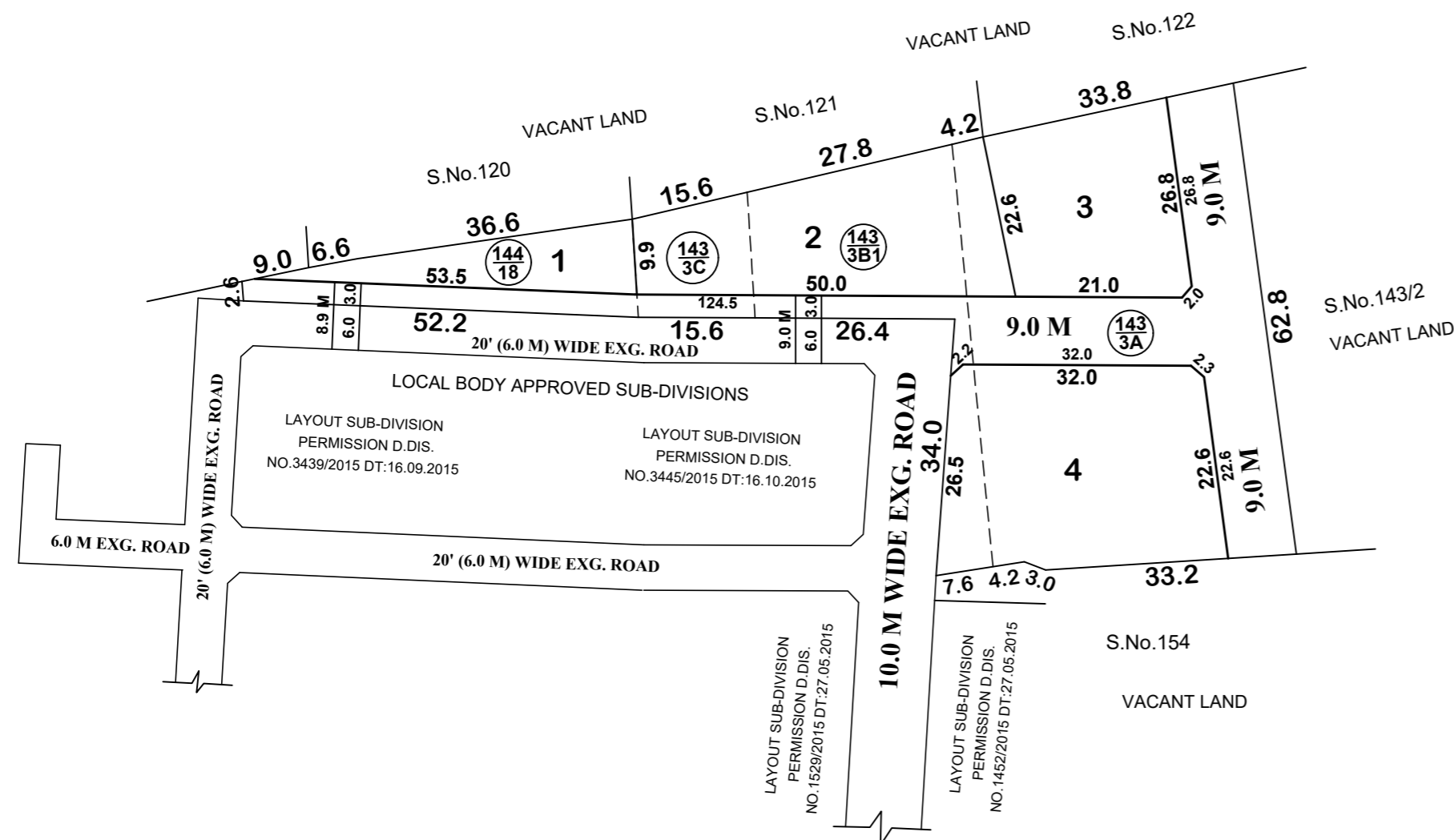

CONDITIONS:

THE SUB-DIVISION APPROVED IS VALID SUBJECT TO OBTAINING SANCTION FROM THE LOCAL BODY CONCERNED.

P.P.D NO : **264**
L.O **2023**

APPROVED

VIDE LETTER NO : LAYOUT-1 / 10094 / 2023

DATE : 17 / 11 / 2023

OFFICE COPY

FOR SENIOR PLANNER (LAYOUT)
 CHENNAI METROPOLITAN
 DEVELOPMENT AUTHORITY

This Planning Permission Issued under New Rule TNCDDBR.2019 is subject to final outcome of the W.P(MD) No.8948 of 2019 and WMP (MD) Nos. 6912 & 6913 of 2019.

ST.THOMAS MOUNT PANCHAYAT UNION

SUB-DIVISION OF HOUSE SITES IN S.Nos: 143 / 3A, 3B1, 3C AND 144 / 18 OF MEDAVAKKAM VILLAGE.

SCALE : 1:800 (ALL MEASUREMENTS ARE IN METRE)

