



**SITE EXTENT (AS PER DOCUMENT) = 3507 SQ.M**  
**ROAD AREA = 708 SQ.M**  
**PUBLIC PURPOSE PROVIDED (1 & 2) = 36 SQ.M**  
 P.P - 1 HANDED OVER TO THE LOCAL BODY (0.5% AREA : 18.0 SQ.M)  
 P.P - 2 HANDED OVER TO THE TANGEDCO (0.5% AREA : 18.0 SQ.M)  
**NO.OF PLOTS = 24 Nos.**





**NOTE:**

- SPLAY - 1.5M x 1.5M
- MEASUREMENTS ARE INDICATED EXCLUDING SPLAY DIMENSIONS
- |   |   |   |
|---|---|---|
|  | ROAD AREA   | } WERE HANDED OVER TO THE LOCAL BODY VIDE GIFT DEED<br>DOC. NO: 22517 / 2023, DATED: 09.11.2023 @ SRO, KUNDRATHUR |
|  | PUBLIC PURPOSE AREA-1<br>(RESERVED FOR LOCAL BODY)  |   |
|  | PUBLIC PURPOSE AREA-2 - WAS HANDED OVER TO THE LOCAL BODY VIDE GIFT DEED<br>(RESERVED FOR TANGEDCO) |   |

**CONDITIONS:**

- (I) TNCDBR-2019, RULE NO: 47 (11)  
 THE COST OF LAYING IMPROVEMENTS TO THE SYSTEMS IN RESPECT OF ROAD, WATER SUPPLY, SEWERAGE, DRAINAGE OR ELECTRIC POWER SUPPLY THAT MAY BE REQUIRED AS ASSESSED BY THE CONCERNED AUTHORITY, NAMELY, THE LOCAL BODY AND TAMIL NADU ELECTRICITY BOARD, SHALL BE BORNE BY THE APPLICANT.
- (II) THE APPLICANT IS RESPONSIBLE FOR THE SHAPE, SIZE & DIMENSIONS OF THE SITE UNDER REFERENCE.  
 ☉ NECESSARY SPACE FOR BUILDING LINE TO BE LEFT AS PER THE RULE IN FORCE WHILE TAKING UP DEVELOPMENT.

**LEGEND:**

-  SITE BOUNDARY
-  ROAD GIFTED TO LOCAL BODY
-  EXISTING ROAD
-  PUBLIC PURPOSE - 1 GIFTED TO LOCAL BODY
-  PUBLIC PURPOSE - 2 GIFTED TO LOCAL BODY (FOR TANGEDCO)

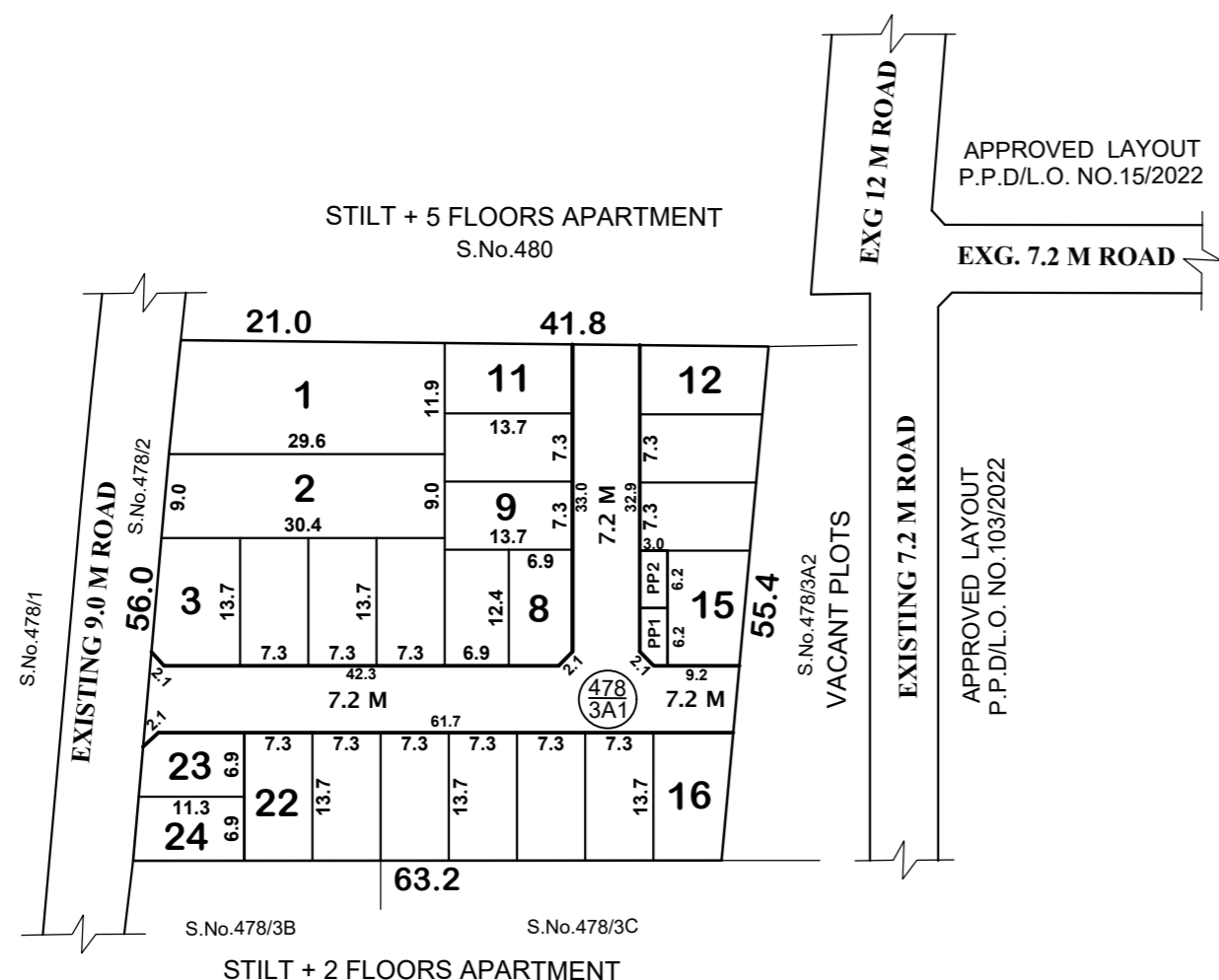

**CONDITIONS:**

THE LAYOUT APPROVED IS VALID SUBJECT TO OBTAINING SANCTION FROM THE LOCAL BODY CONCERNED.

**P.P.D NO : 266**  
**L.O NO : 2023**

**APPROVED**

VIDE LETTER NO : LAYOUT-1 / 0276 / 2023

DATE : 20 / 11 / 2023

**OFFICE COPY**

FOR SENIOR PLANNER (LAYOUT)  
 CHENNAI METROPOLITAN  
 DEVELOPMENT AUTHORITY

This Planning Permission Issued under New Rule TNCDBR.2019 is subject to final outcome of the W.P(MD) No.8948 of 2019 and WMP (MD) Nos. 6912 & 6913 of 2019.

**MANGADU MUNICIPALITY LIMIT**

LAYOUT OF HOUSE SITES IN S.No: 478 / 3A1 OF MANGADU-B VILLAGE.

SCALE : 1:800 (ALL MEASUREMENTS ARE IN METRE)

