

SITE EXTENT (AS PER PATTI)	:	18309 SQ.M
ROAD AREA	:	7999 SQ.M
PARK AREA	:	1677 SQ.M
PARK-1 : 1267.0 SQ.M PARK-2 : 410.0 SQ.M		
EWS PROVIDED	:	1146 SQ.M
PUBLIC PURPOSE PROVIDED (1%)	:	107 SQ.M
PP-1 HANDED OVER TO THE LOCAL BODY : 61.0 SQ.M PP-2 HANDED OVER TO THE TANGEDCO : 46.0 SQ.M		
REGULAR PLOTS (1 TO 66)	:	66 Nos
EWS PLOTS (67 TO 83) (1146 SQ.M)	:	17 Nos
TOTAL NO. OF PLOTS	:	83 Nos
CONVENIENT SHOP SITE	:	3 Nos

NOTE:

1. SPLAY - 1.5M x 1.5M
2. MEASUREMENTS ARE INDICATED EXCLUDING SPLAY DIMENSIONS
3.

	ROAD AREA	}	WERE HANDED OVER TO THE LOCAL BODY VIDE GIFT DEED DOC.NO:19014/2023.DATED:12.12.2023 @ SRO,AVADI.
	PARK AREA		
	PUBLIC PURPOSE-1 (0.5%)		
	PUBLIC PURPOSE-2 (0.5%)		

CONDITIONS:

- (I) TNCDBR-2019 RULE NO: 47 (9) & AMENDMENTS APPROVED IN G.O.Ms.No.16, MAWS (MA1) DEPARTMENT DATED 31.1.2020 AND PUBLISHED IN TNGG ISSUE No.41 DATED:31.01.2020.
THE OWNER OR DEVELOPER OR PROMOTER SHALL SELL THESE PLOTS ONLY FOR EWS PURPOSE. AMALGAMATION SHALL BE PERMISSIBLE IN THOSE CASES OF ECONOMICALLY WEAKER SECTION PLOTS AFTER A PERIOD OF THREE YEARS. IN SUCH CASES OF AMALGAMATION, THE PLANNING PARAMETERS FOR ECONOMICALLY WEAKER SECTION AREAS SHALL NOT APPLY.
- (II) TNCDBR-2019, RULE NO: 47 (11)
THE COST OF LAYING IMPROVEMENTS TO THE SYSTEMS IN RESPECT OF ROAD, WATER SUPPLY, SEWERAGE, DRAINAGE OR ELECTRIC POWER SUPPLY THAT MAY BE REQUIRED AS ASSESSED BY THE CONCERNED AUTHORITY, NAMELY, THE LOCAL BODY AND TAMIL NADU ELECTRICITY BOARD, SHALL BE BORNE BY THE APPLICANT.
- (III) THE APPLICANT IS RESPONSIBLE FOR THE SHAPE, SIZE & DIMENSIONS OF THE SITE UNDER REFERENCE.

© NECESSARY SPACE FOR BUILDING LINE TO BE LEFT AS PER THE RULE IN FORCE WHILE TAKING UP DEVELOPMENT IN EVERY PLOT.

LEGEND:

- SITE BOUNDARY
- ROAD GIFTED TO LOCAL BODY
- EXISTING ROAD
- PARK GIFTED TO LOCAL BODY
- EWS
- PUBLIC PURPOSE-1 GIFTED TO LOCAL BODY
- PUBLIC PURPOSE-2 GIFTED TO LOCAL BODY (FOR TANGEDCO)
- CONVENIENT SHOP SITE

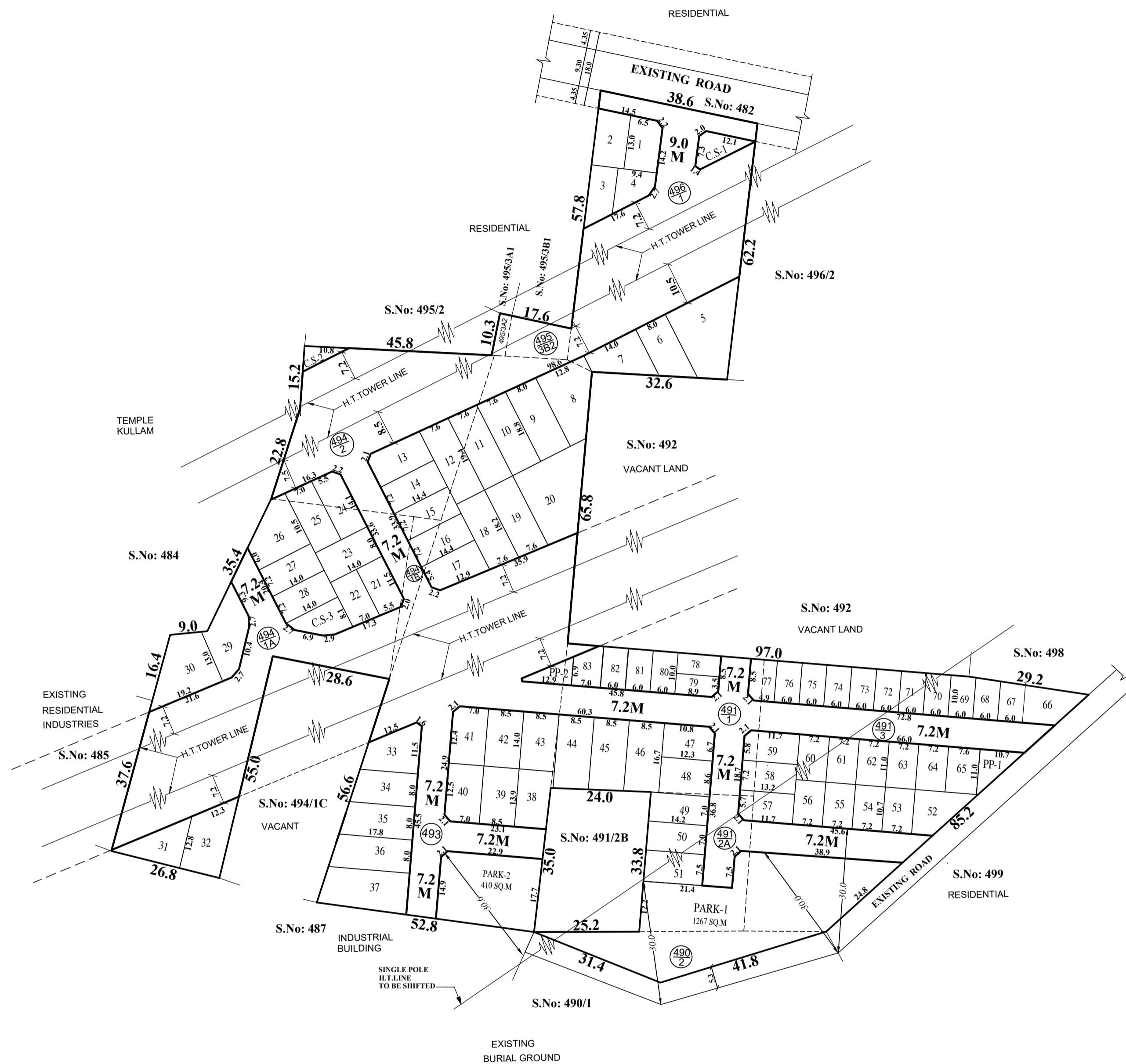

This Planning Permission Issued under New Rule TNCDBR.2019 is subject to final outcome of the W.P(MD) No.8948 of 2019 and WMP (MD) Nos. 6912 & 6913 of 2019.

CONDITIONS:

THE LAYOUT APPROVED IS VALID SUBJECT TO OBTAINING SANCTION FROM THE LOCAL BODY CONCERNED.

P.P.D NO : 300
L.O 2023
APPROVED
VIDE LETTER NO : LAYOUT-1 / 0239 / 2023
DATE : 22 / 12 / 2023

OFFICE COPY
FOR MEMBER SECRETARY
CHENNAI METROPOLITAN
DEVELOPMENT AUTHORITY



POONAMALLEE PANCHAYAT UNION

LAYOUT OF HOUSE SITES IN S.Nos: 490/2, 491/1, 2A, 3, 493, 494/1A, 1B, 2, 495/3A2, 495/3B2 AND 496/1 OF KUTHAMBAKKAM VILLAGE ,

SCALE - 1:800 (ALL MEASUREMENTS ARE IN METRE)