

**SITE EXTENT** (AS PER PATTA) = **5000 SQ.M**  
**ROAD AREA** = **1340 SQ.M**  
**PUBLIC PURPOSE PROVIDED (1 & 2)** = **41 SQ.M**  
 P.P - 1 HANDED OVER TO THE LOCAL BODY (0.5% AREA : 20.0 SQ.M)  
 P.P - 2 HANDED OVER TO THE TANGEDCO (0.5% AREA : 21.0 SQ.M)  
**NO. OF PLOTS** = **26 NOS.**

**NOTE:**

- SPLAY - 1.5M x 1.5M
- MEASUREMENTS ARE INDICATED EXCLUDING SPLAY DIMENSIONS
- |   |  |
|---|--|
| <ul style="list-style-type: none"> <li>ROAD AREA</li> <li>PUBLIC PURPOSE AREA-1 (RESERVED FOR LOCAL BODY)</li> <li>PUBLIC PURPOSE AREA-2 (RESERVED FOR TANGEDCO)</li> </ul> | } WERE HANDED OVER TO THE LOCAL BODY VIDE GIFT DEED<br>DOC. NO: 1404 / 2023, DATED: 17.02.2023 @ SRO, PADAPPAI |
|---|--|

**CONDITIONS :**

(I) THE APPLICANT SHOULD FOLLOW THE CONDITIONS MENTIONED BY THE CE, PWD., WRD., CHENNAI REGION, CHEPAUK, CHENNAI -5. LETTER NO.DB/T5(3)/011354/F-NOC(NADUVEERAPATTU VILLAGE)000459/2023/DATED:30.01.2023 ARE TO BE COMPLIED BY THE APPLICANT BEFORE ISSUING OF THE LAYOUT APPROVAL BY THE COMPETENT AUTHORITY (LOCAL BODY)

- The applicants' land should be filled with earth filling with proper compaction to the minimum level of (+)10.020m (i.e.,) 0.720m above the Crest Level of Weir in Naduveerapattu Chitheri tank (+)9.300m. To protect the site from inundation during floods. The process of earth filling and compaction should be done in layers of not more than 0.30metre depth to achieve required degree of compaction for the depth from (+)1.050m to (+)1.120m depending upon the existing field levels. Also, the applicants should provide emergency pumping operation for the seepage water, if it is proposed to have basement floor and as well as dewatering arrangements during flood periods.
- The all round pavement level within the site should not be less than (+)10.020m. The applicants should prepare the layout proposal by considering the suitable internal storm water drainage network drain as micro drains (ie.,) the peripheral drain not less than 120m x 0.75m should be constructed all-round the site and also linked 0.90m x 0.60m inner the channel and lateral drain of suitable size within the site as per site condition. The same should be connected to the local drain / channel, rainwater harvesting, roads with road side drain and sewerage treatment plant and its disposal and garbages/debris and other solid waste management as per norms in existence within the applicant's land according to existing rules in force and should get proper approval from competent authority without fail.  
The sewage or any unhygienic drainage (Treated or Untreated) should not be let into drain / channel / course at any cost and the debris and other materials should not be dumped into the drain / surplus course obstructing free flow of water. The applicants should make drainage network, at their own cost and the same is to be connected to natural storm water drainage / channel. There should not be any hindrance to the free flow of internal drain to downstream.
- The necessary setback distance should be provided with in the site as per site condition as per the norms in existence and as per the rules in force of CMDA (as per the circular issued by the office of the Commissioner of Town & Country Planning, Chennai - 2 vide Roc. No. 4367 / 2019-BA2/ Dated: 13.03.2019) during development and there should not be any construction activities in setback area in future also, the CMDA should issue completion certificate only after obtaining compliance certificate NOC from WRD.
- The applicants should clearly demarcate boundary of their land before commencement of any developmental activities in the presence of Revenue, Local body and WRD authorities concerned without fail and should not encroach the Government Channel in S.F.No.285 and Government land in S.F.No.286/3, 288/4 and the Chitheri Tank Bund in S.F.No.28 Naduveerapattu village as per Revenue records and abutting the applicant site should be marked as per FMB and monitored and maintained by the applicant at their own cost. The Government Land should be maintained without encroachments as per Revenue records and the applicants should make necessary periodical arrangements for free flow of water through the existing Government Land to the downside area along the proposed site.
- The permission granted to the applicants, should not be altered / modified / changed to any others. Based on the records submitted by the applicants, the permission is granted. If any documents seem to be fake / manipulated / fabricated, in future the above permission will be cancelled without any correspondence. Hence, the applicants are solely responsible of genuineness of the documents submitted.
- The WRD officers should be allowed to inspect the site at any time, during execution and thereafter, if necessary. Advance intimation should be given to the WRD officers concerned before commencement of work.
- The applicants should abide by the rules and regulation of the WRD from time to time. The applicants should also abide court of law of both State & Central Government from time to time.
- The applicants should get clearance certificate for this site from the Revenue department to make sure that the site is not an encroached property from the water body as well as confirming this proposed site boundaries.
- WRD is giving opinion only in connection with the inundation aspect and does not deliver any rights to the applicants to encroach the WRD / Government Lands / river. The NOC for this site from the WRD is purely issued on the basis of inundation point of view.
- The sewage water from the applicant land should not let into the drain and for the disposal of the sewage water, suitable arrangements should be made for the same by the applicants, and as well as the construction materials/debris/garbages should not be dumped into the channel/river/tank at any cost.  
At any cost, sewage / sullage should not be let into channel/river, and the garbages, debris and construction materials should not be dumped into the channel/river restricting the free flow of water.
- The applicant should not object at any time for themaintenance works / improvement works at the channels which are proposed to be carried out by WRD. The applicant should give an undertaking in writing to the effect that the above proposal will not obstruct in case any maintenance / improvement / development works as per Revenue records (FMB), which are proposed to be carried out by WRD in future periodically.
- The Government Field Channel in S.F.No.285, Naduveerapattu village of the applicant land should be completely de-silted and re-sectioned by constructing retaining wall on either sides of the channel with concrete bed as per the FMB at the applicant's own cost. The bed level of the above channel should be ascertained and restores before commencing the development activity in the presence of the concerned WRD Executive Engineer. Moreover, the width of entire channel as per Revenue records (FMB) along & within the stretch et applicant's land should be maintained properly without any change and without encroachments.
- The Government Field Channel in S.F.No.285, Naduveerapattu village stretch abutting the applicant boundary should be marked as per FMB and monitored and maintained by the applicant at his own cost. The width of the channel should be maintained without encroachments as per Revenue records and the hydraulic parameters of the field channel should be maintained. The applicant should make necessary periodical arrangements for free flow of water through the existing channel to the downside area within the proposed layout site. Also, the applicant should de-silt the channel periodically and remove the obstruction then and there without any hindrance for free flow of water at his own cost within the proposed land, after the completion of project also.
- The applicants should not construct any cross masonry across the river without prior permission of WRD.

The owner of the document received from the applicant in respect to the ownership is purely of applicant's responsibility and it is only for reference purpose to this department. The legal validity of this document should be verified by the Development / Revenue authorities. The specific remarks on inundation are purely issued on technical grounds in respect to the physical location of land.

Failing to comply with any of the above conditions, WRD reserves rights to withdraw the Technical opinion on inundat on point of view to the above procosed site and in event the applicants shat not be eligible for any compensation whatsoever and as well as legal entity

(II) LOCAL BODY SHOULD ENSURE COMPLIANCE OF ALL THE CONDITIONS STIPULATE BY WRD, PWD IN THEIR LETTER NO.DB/T5(3)/011354/F-NOC(NADUVEERAPATTU VILLAGE)000459/2023/DATED:30.01.2023, AND SHALL OBTAIN A LETTER FROM WRD CONFIRMING THE COMPLIANCE OF THE CONDITIONS BEFORE THE SANCTION AND RELEASE OF THE LAYOUT.

(III) TNCDBR-2019 RULE NO: 47 (8) IN G.O.(Ms) No.18, MAWS DEPARTMENT DATED 04.02.2019 & AMENDMENTS APPROVED IN G.O.Ms.No.16, MAWS (MAI) DEPARTMENT DATED 31.01.2020 AND PUBLISHED IN TNGG ISSUE No.41, DATED:31.01.2020:

ONE PERCENT OF LAYOUT AREA EXCLUDING ROAD, ADDITIONALLY, SHALL BE RESERVED FOR 'PUBLIC PURPOSE'. WITHIN THE ABOVE CEILING 0.5% OF AREA SHALL BE TRANSFERRED TO THE LOCAL BODY AND 0.5% OF AREA SHALL BE TRANSFERRED TO THE TANGEDCO OR TO THE LOCAL BODY FREE OF COST THROUGH A REGISTERED GIFT DEED BEFORE THE ACTUAL SANCTION OF THE LAYOUT.

(IV) TNCDBR-2019, RULE NO:47 (11)

THE COST OF LAYING IMPROVEMENTS TO THE SYSTEMS IN RESPECT OF ROAD, WATER SUPPLY, SEWERAGE, DRAINAGE OR ELECTRIC POWER SUPPLY THAT MAY BE REQUIRED AS ASSESSED BY THE CONCERNED AUTHORITY, NAMELY, THE LOCAL BODY AND TAMIL NADU ELECTRICITY BOARD, SHALL BE BORNE BY THE APPLICANT.

(V) THE APPLICANT IS RESPONSIBLE FOR THE SHAPE, SIZE & DIMENSIONS OF THE SITE UNDER REFERENCE.

⊙ NECESSARY SPACE FOR BUILDING LINE TO BE LEFT AS PER THE RULE IN FORCE WHILE TAKING UP DEVELOPMENT IN EVERY PLOT.

**LEGEND:**

- SITE BOUNDARY
- ROAD GIFTED TO LOCAL BODY
- EXISTING ROAD
- PUBLIC PURPOSE - 1 GIFTED TO LOCAL BODY
- PUBLIC PURPOSE - 2 GIFTED TO TANGEDCO

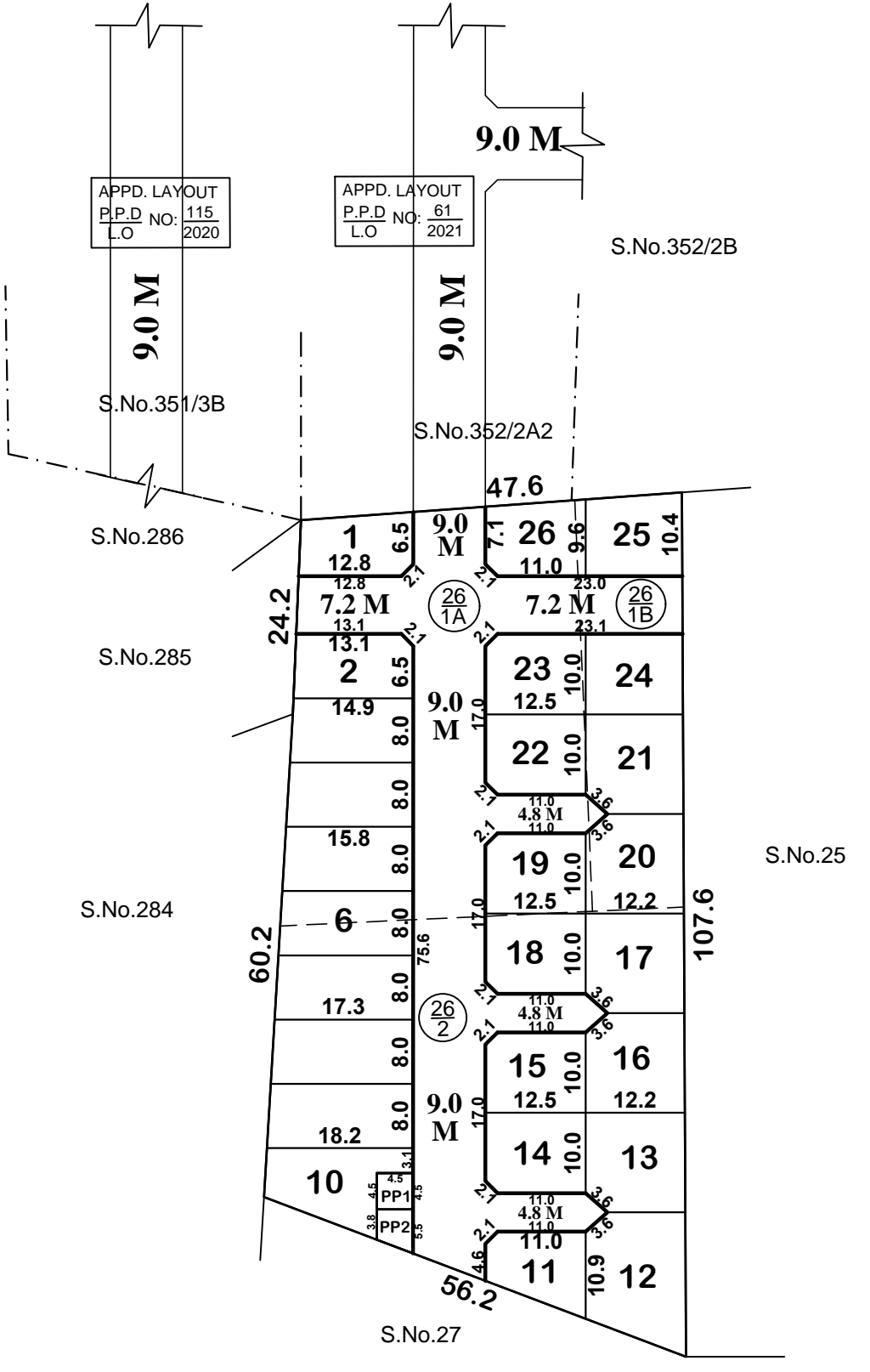

**CONDITIONS:**  
**THE LAYOUT APPROVED IS VALID SUBJECT TO OBTAINING SANCTION FROM THE LOCAL BODY CONCERNED.**

**P.P.D** NO : **57**  
**L.O** 2023  
**APPROVED**  
 VIDE LETTER NO : LAYOUT-1 / 0197 / 2022  
 DATE : 27 / 02 / 2023

**OFFICE COPY**

FOR SENIOR PLANNER (LAYOUT)  
 CHENNAI METROPOLITAN  
 DEVELOPMENT AUTHORITY

This Planning Permission Issued under New Rule TNCDBR.2019 is subject to final outcome of the W.P(MD) No.8948 of 2019 and WMP (MD) Nos. 6912 & 6913 of 2019.

**KUNDRATHUR PANCHAYAT UNION**

**LAYOUT OF HOUSE SITES IN S.Nos: 26 / 1A, 1B & 2 OF NADUVEERAPATTU VILLAGE.**

SCALE : 1:800 (ALL MEASUREMENTS ARE IN METRE)

