

SITE EXTENT (AS PER PATTA) = 1860 SQ.M
ROAD AREA = 250 SQ.M
NO.OF PLOTS = 4 NOS.



NOTE:

1. SPLAY - 1.5 M x 1.5 M
2. MEASUREMENTS ARE INDICATED EXCLUDING SPLAY DIMENSIONS
3.  ROAD AREA WAS HANDED OVER TO THE LOCAL BODY VIDE GIFT DEED
DOC. NO: 2755 / 2023, DATED: 17.03.2023 @ SRO, PALLAVARAM.

CONDITIONS:

- (I) TNCDBR-2019, RULE NO: 47 (11)
THE COST OF LAYING IMPROVEMENTS TO THE SYSTEMS IN RESPECT OF ROAD, WATER SUPPLY, SEWERAGE, DRAINAGE OR ELECTRIC POWER SUPPLY THAT MAY BE REQUIRED AS ASSESSED BY THE CONCERNED AUTHORITY, NAMELY, THE LOCAL BODY AND TAMIL NADU ELECTRICITY BOARD, SHALL BE BORNE BY THE APPLICANT.
 - (II) THE APPLICANT IS RESPONSIBLE FOR THE SHAPE, SIZE & DIMENSIONS OF THE SITE UNDER REFERENCE.
- NECESSARY SPACE FOR BUILDING LINE TO BE LEFT AS PER THE RULE IN FORCE WHILE TAKING UP DEVELOPMENT.

LEGEND:

-  SITE BOUNDARY
 ROAD GIFTED TO LOCAL BODY
 EXISTING ROAD

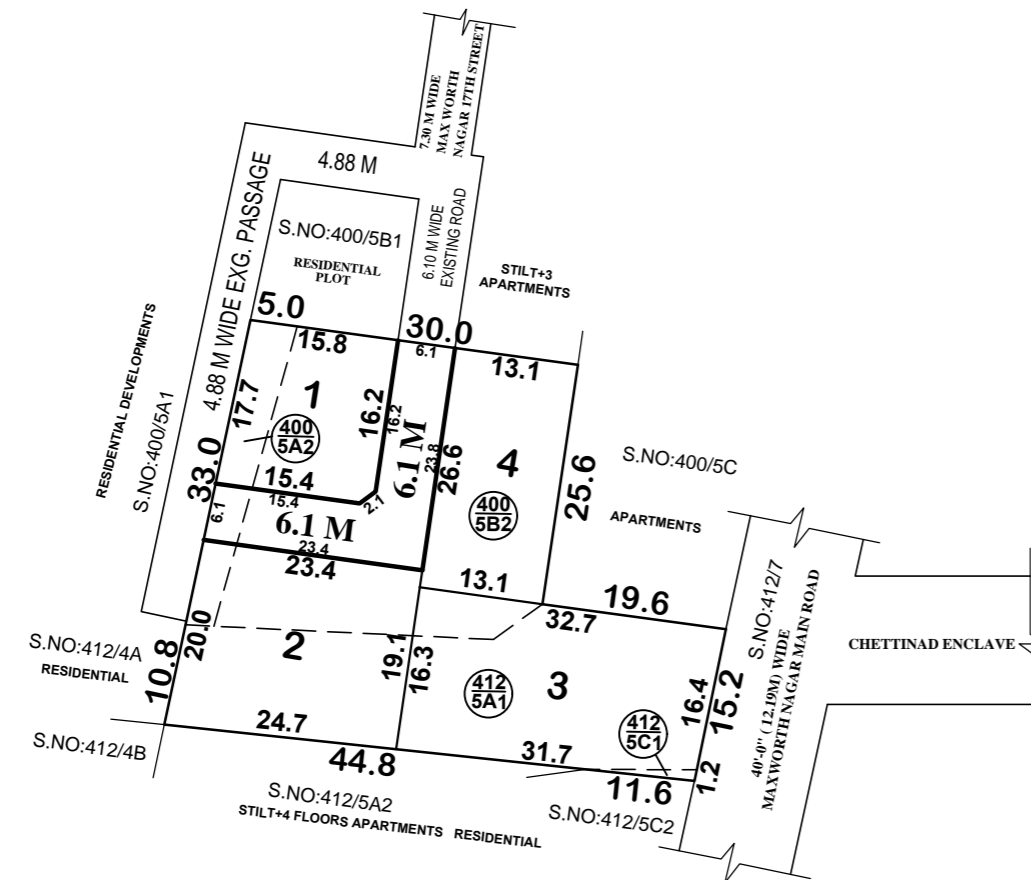
**CONDITIONS:**

THE SUB-DIVISION APPROVED IS VALID SUBJECT TO OBTAINING SANCTION FROM THE LOCAL BODY CONCERNED.

P.P.D NO : 85
L.O 2023

APPROVED

VIDE LETTER NO : LAYOUT-1 / 0024 / 2023

DATE : 27 / 03 / 2023

OFFICE COPY

**FOR SENIOR PLANNER (LAYOUT)
 CHENNAI METROPOLITAN
 DEVELOPMENT AUTHORITY**

This Planning Permission Issued under New Rule TNCDBR.2019 is subject to final outcome of the W.P(MD) No.8948 of 2019 and WMP (MD) Nos. 6912 & 6913 of 2019.

ST. THOMAS MOUNT PANCHAYAT UNION

SUB-DIVISION OF HOUSE SITES IN S.No: 400 / 5A2, 5B2 AND 412 / 5A1, 5C1 OF

S.KOLATHUR VILLAGE.

SCALE : 1:800 (ALL MEASUREMENTS ARE IN METRE)

