

**SITE EXTENT (AS PER PATTI) : 2225 SQ.M**  
**ROAD AREA : 153 SQ.M**  
**NO. OF PLOTS : 3 Nos**

**NOTE:**

- SPLAY - 1.5M x 1.5M
  - MEASUREMENTS ARE INDICATED EXCLUDING SPLAY DIMENSIONS
- ROAD AREA WAS HANDED OVER TO THE LOCAL BODY VIDE GIFT DEED  
 DOC.No:2852/2024, DATED:26.04.2024 @ SRO, TAMBARAM JOINT 1.

**CONDITIONS :**

**(I) TNCDBR-2019, RULE NO: 47 (11)**

THE COST OF LAYING IMPROVEMENTS TO THE SYSTEMS IN RESPECT OF ROAD, WATER SUPPLY, SEWERAGE, DRAINAGE OR ELECTRIC POWER SUPPLY THAT MAY BE REQUIRED AS ASSESSED BY THE CONCERNED AUTHORITY, NAMELY, THE LOCAL BODY AND TAMIL NADU ELECTRICITY BOARD, SHALL BE BORNE BY THE APPLICANT.

**(II) THE APPLICANT IS RESPONSIBLE FOR THE SHAPE, SIZE & DIMENSIONS OF THE SITE UNDER REFERENCE.**

NECESSARY SPACE FOR BUILDING LINE TO BE LEFT AS PER THE RULE IN FORCE WHILE TAKING UP DEVELOPMENT IN EVERY PLOT.

**LEGEND:**

- SITE BOUNDARY
- ROAD GIFTED TO LOCAL BODY
- EXISTING ROAD

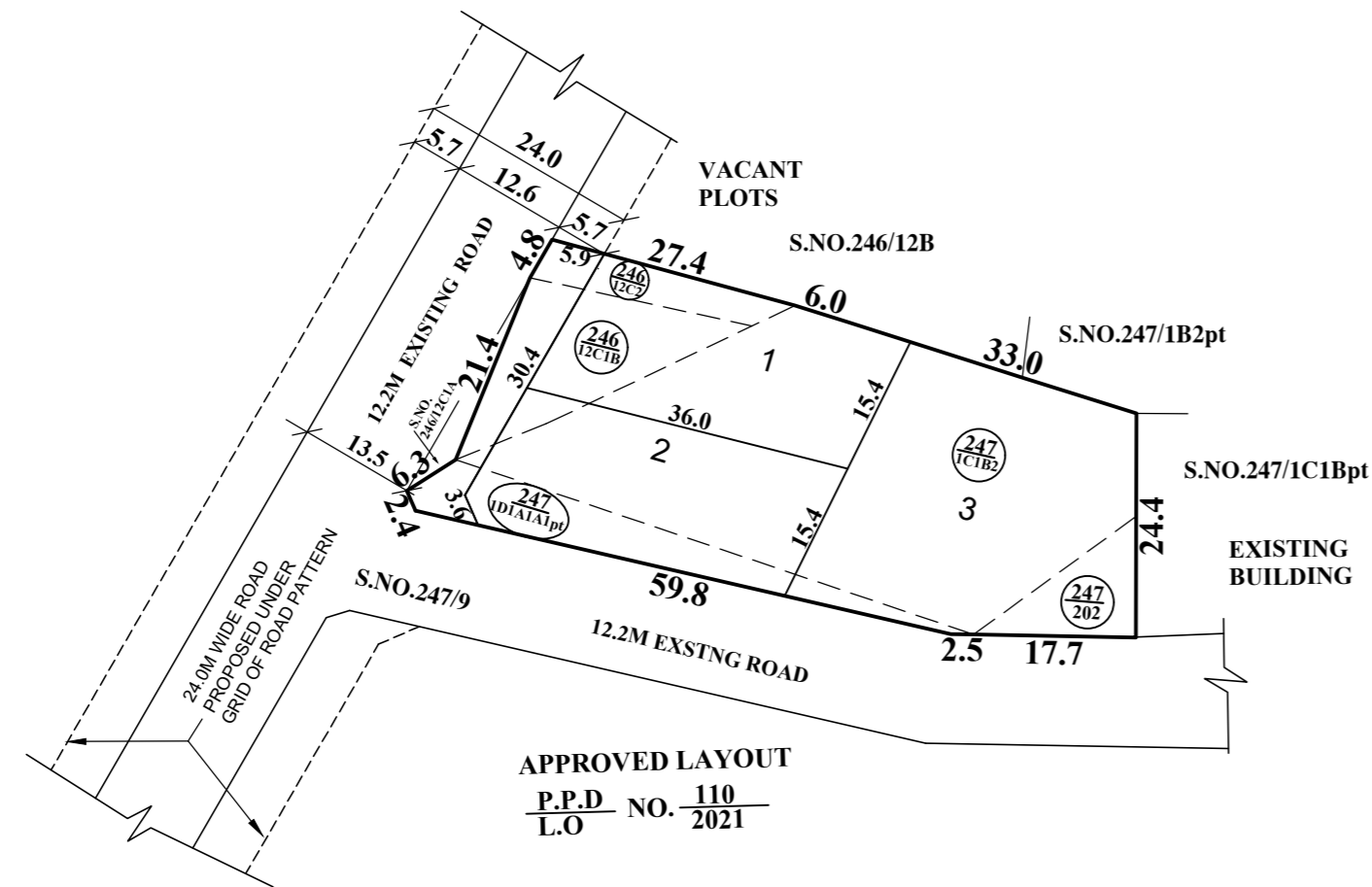

This Planning Permission Issued under New Rule TNCDBR.2019 is subject to final outcome of the W.P(MD) No.8948 of 2019 and WMP (MD) Nos. 6912 & 6913 of 2019.

**CONDITIONS:**

THE SUB-DIVISION APPROVED IS VALID SUBJECT TO OBTAINING SANCTION FROM THE LOCAL BODY CONCERNED.

**P.P.D** NO : **101**  
**L.O** **2024**

**APPROVED**

VIDE LETTER NO : LAYOUT-1/ 0029 / 2024

DATED : 09 / 05 / 2024

**OFFICE COPY**

FOR CHIEF PLANNER (LAYOUT)  
 CHENNAI METROPOLITAN  
 DEVELOPMENT AUTHORITY

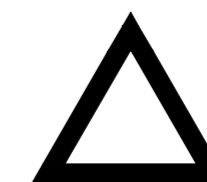

**ST.THOMAS MOUNT PANCHAYAT UNION**

**SUB-DIVISION OF HOUSE SITES IN S.Nos: 246/12C1B, 12C2, 247/1C1B2, 202 & 1D1A1A1pt OF AGARAMTHEN VILLAGE.**

SCALE : 1:800 ( ALL MEASUREMENTS ARE IN METRE )