

SITE EXTENT (AS PER DOCUMENT) = 4168 SQ.M
ROAD AREA = 1457 SQ.M
PUBLIC PURPOSE PROVIDED (1 & 2) = 30 SQ.M
 P.P - 1 HANDED OVER TO THE LOCAL BODY (0.5% AREA : 16.5 SQ.M)
 P.P - 2 HANDED OVER TO THE TANGEDCO (0.5% AREA : 13.5 SQ.M)
NO.OF PLOTS = 25 Nos





NOTE:

1. SPLAY - 1.5M x 1.5M
2. MEASUREMENTS ARE INDICATED EXCLUDING SPLAY DIMENSIONS
3.  WERE HANDED OVER TO THE LOCAL BODY VIDE GIFT DEED
 DOC. NO: 8837 / 2024, DATED: 18.07.2024 @ SRO, SELAIYUR

CONDITIONS:

- (I) TNCDDBR-2019 RULE NO: 47 (8) IN G.O.(Ms) No.18, MAWS DEPARTMENT DATED 04.02.2019 & AMENDMENTS, APPROVED IN G.O.Ms.No.16, MAWS (MAI) DEPARTMENT DATED 31.01.2020 AND PUBLISHED IN TNGG ISSUE No.41, DATED 31.01.2020
 ONE PERCENT OF LAYOUT AREA EXCLUDING ROAD, ADDITIONALLY, SHALL BE RESERVED FOR "PUBLIC PURPOSE". WITHIN THE ABOVE CEILING 0.5% OF AREA SHALL BE TRANSFERRED TO THE LOCAL BODY AND 0.5% OF AREA SHALL BE TRANSFERRED TO THE TANGEDCO OR TO THE LOCAL BODY FREE OF COST THROUGH A REGISTERED GIFT DEED BEFORE THE ACTUAL SANCTION OF THE LAYOUT.
- (II) TNCDDBR-2019, RULE NO: 47 (11)
 THE COST OF LAYING IMPROVEMENTS TO THE SYSTEMS IN RESPECT OF ROAD, WATER SUPPLY, SEWERAGE, DRAINAGE OR ELECTRIC POWER SUPPLY THAT MAY BE REQUIRED AS ASSESSED BY THE CONCERNED AUTHORITY, NAMELY, THE LOCAL BODY AND TAMIL NADU ELECTRICITY BOARD, SHALL BE BORNE BY THE APPLICANT.
- (III) THE APPLICANT IS RESPONSIBLE FOR THE SHAPE, SIZE & DIMENSIONS OF THE SITE UNDER REFERENCE.
- ⊙ NECESSARY SPACE FOR BUILDING LINE TO BE LEFT AS PER THE RULE IN FORCE WHILE TAKING UP DEVELOPMENT.

LEGEND:

-  SITE BOUNDARY
-  ROAD GIFTED TO LOCAL BODY
-  EXISTING ROAD
-  PUBLIC PURPOSE - 1 GIFTED TO LOCAL BODY
-  PUBLIC PURPOSE - 2 GIFTED TO TANGEDCO

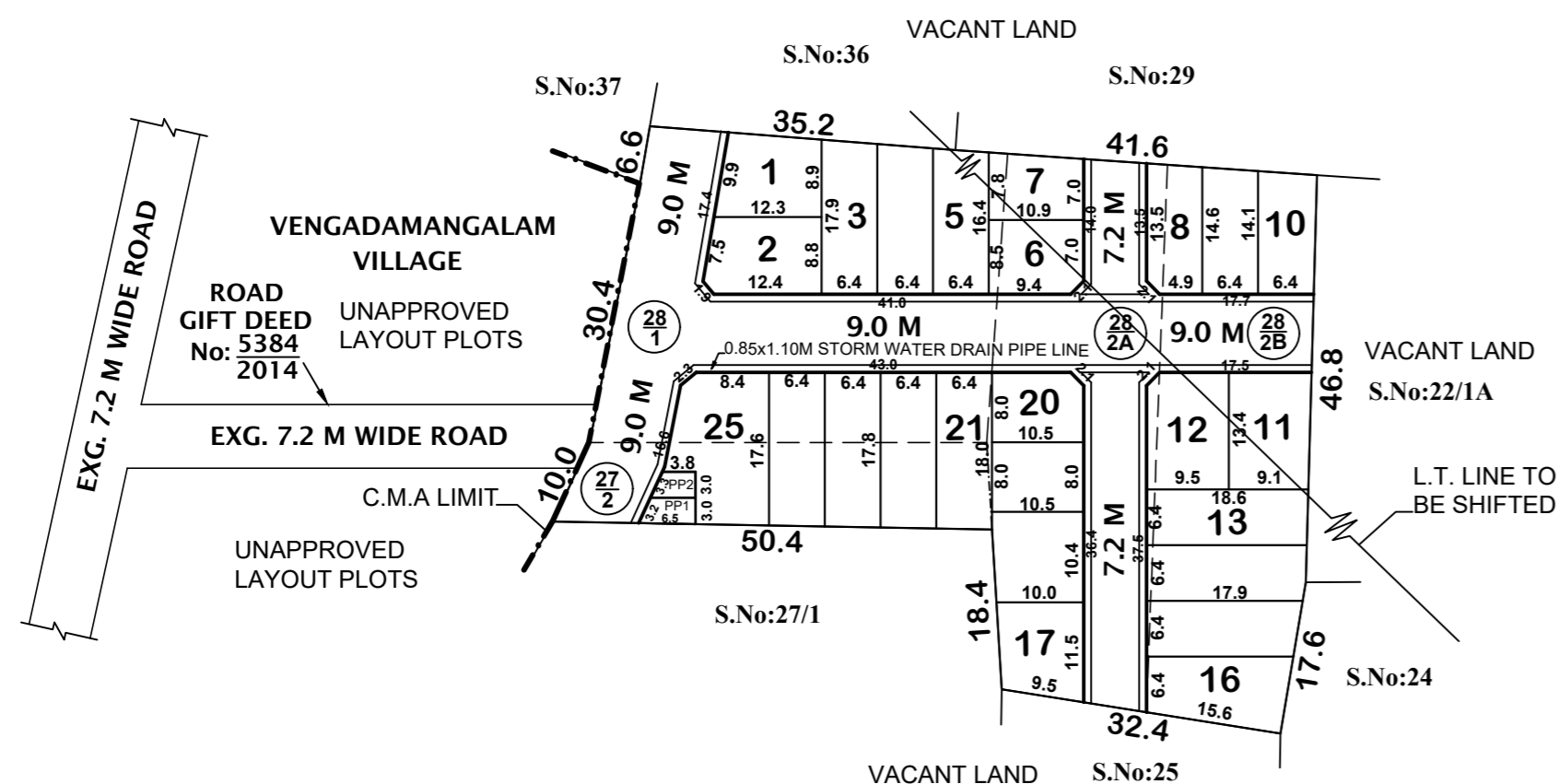

CONDITIONS:

THE LAYOUT APPROVED IS VALID SUBJECT TO OBTAINING SANCTION FROM THE LOCAL BODY CONCERNED.

P.P.D NO : 159
L.O 2024

APPROVED

VIDE LETTER NO : LAYOUT-1 / 0089 / 2024

DATE : 23 / 07 / 2024

OFFICE COPY

**FOR CHIEF PLANNER (LAYOUT)
 CHENNAI METROPOLITAN
 DEVELOPMENT AUTHORITY**



ST. THOMAS MOUNT PANCHAYAT UNION
LAYOUT OF HOUSE SITES IN S.Nos: 27 / 2 AND 28 / 1, 2A, 2B OF MADURAPAKKAM VILLAGE.

SCALE : 1:800 (ALL MEASUREMENTS ARE IN METRE)

This Planning Permission Issued under New Rule TNCDDBR.2019 is subject to final outcome of the W.P(MD) No.8948 of 2019 and WMP (MD) Nos. 6912 & 6913 of 2019.