

TOTAL EXTENT (AS PER PATTA) : 1085 SQ.M
ROAD AREA : 330 SQ.M
REGULAR PLOTS (1&2) : 2 Nos.
E.W.S. PLOTS (315 SQ.M) (3 TO 8) : 6 Nos.
TOTAL No.OF.PLOTS : 8 Nos.

NOTE:

1. SPLAY-1.5MX1.5M
2. MEASUREMENTS ARE INDICATED EXCLUDING SPLAY DIMENSION
3.  ROAD AREA WAS HANDED OVER TO THE LOCAL BODY VIDE GIFT DEED DOCUMENT NO. 5748/2024, DATED: 16.08.2024, @ SRO TAMBARAM JOINT 1

CONDITIONS :

(I) TNCDBR-2019, RULE NO: 47 (9) IN G.O(Ms) No.18,MAWS DEPARTMENT DATED:04.02.2019 & AMENDMENTS APPROVED IN G.O.Ms.No.16,MAWS (MAI) DEPARTMENT DATED 31.1.2020 AND PUBLISHED IN TNGG ISSUE No.41, DATED 31.01.2020.

THE OWNER OR DEVELOPER OR PROMOTER SHALL SELL THE EWS PLOTS ONLY FOR EWS PURPOSE. AMALGAMATION SHALL BE PERMISSIBLE IN THOSE CASES OF ECONOMICALLY WEAKER SECTION PLOTS, AFTER A PERIOD OF THREE YEARS. IN SUCH CASES OF AMALGAMATION, THE PLANNING PARAMETERS FOR ECONOMICALLY WEAKER SECTION AREAS SHALL NOT APPLY.





(II) TNCDBR-2019, RULE NO: 47 (11)

THE COST OF LAYING IMPROVEMENTS TO THE SYSTEMS IN RESPECT OF ROAD, WATER SUPPLY, SEWERAGE, DRAINAGE OR ELECTRIC POWER SUPPLY THAT MAY BE REQUIRED AS ASSESSED BYTHE CONCERNED AUTHORITY, NAMELY, THE LOCAL BODY AND TAMIL NADU ELECTRICITY BOARD, SHALL BE BORNE BY THE APPLICANT.

(III) THE APPLICANT IS RESPONSIBLE FOR THE SHAPE,SIZE & DIMENSIONS OF THE SITE UNDER REFERENCE

Ⓞ NECESSARY SPACE FOR BUILDING LINE TO BE LEFT AS PER THE RULE IN FORCE WHILE TAKING UP DEVELOPMENT IN EVERY PLOT

LEGEND:

-  SITE BOUNDARY
-  ROADS GIFTED TO LOCAL BODY
-  EXISTING ROAD
-  EWS

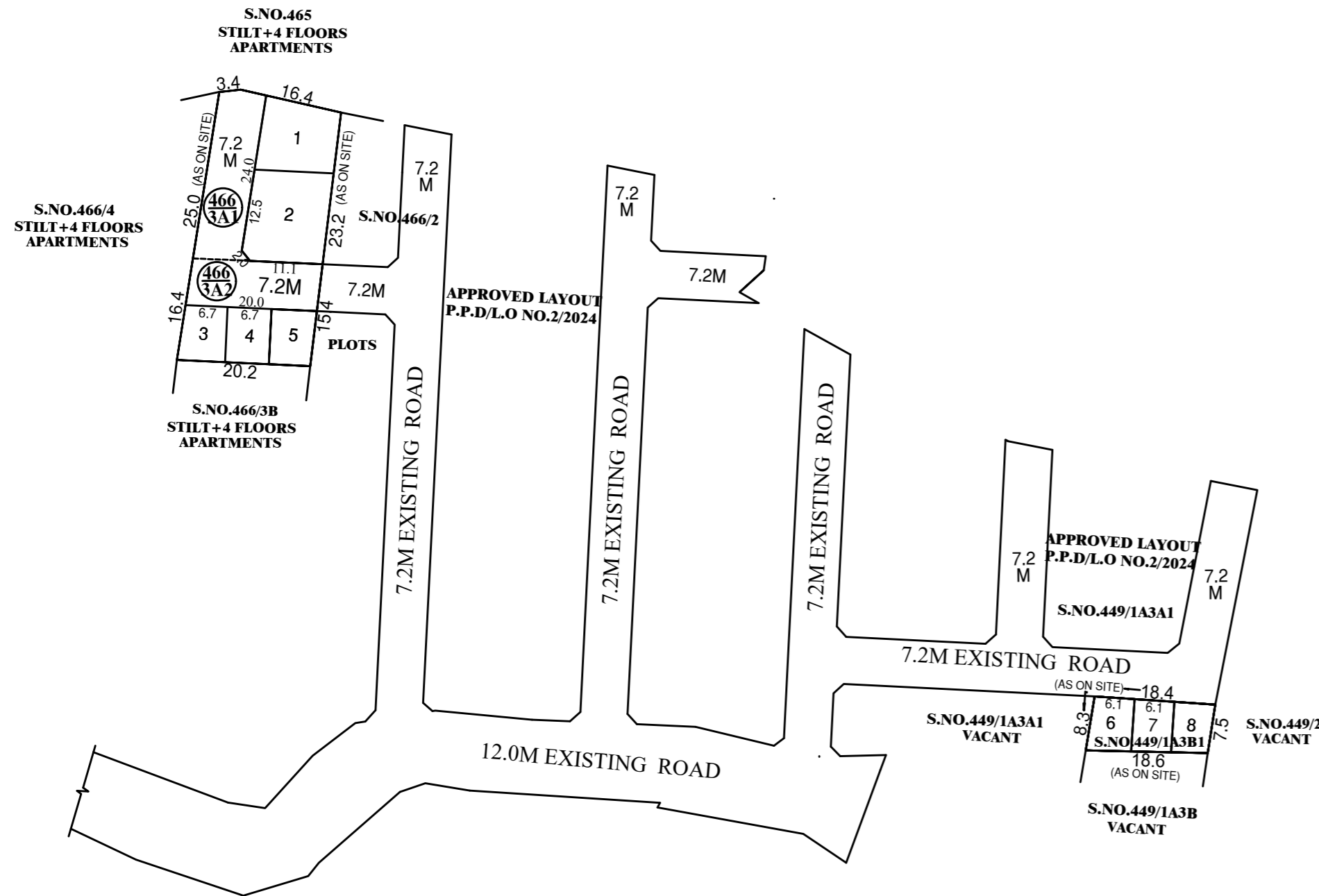

This Planning Permission Issued under New Rule TNCDBR.2019 is subject to final outcome of the W.P(MD) No.8948 of 2019 and WMP (MD) Nos. 6912 & 6913 of 2019.

CONDITION:
 THE SUB DIVISION APPROVED IS VALID SUBJECT TO OBTAINING SANCTION FROM THE LOCAL BODY CONCERNED.

P.P.D L.O NO : 190 / 2024

APPROVED

VIDE LETTER NO : LAYOUT-1 / 0141 / 2024
DATE : 30 / 08 / 2024

OFFICE COPY

**FOR CHIEF PLANNER (LAYOUT)
 CHENNAI METROPOLITAN
 DEVELOPMENT AUTHORITY**



KATTANKOLATHUR PANCHAYAT UNION
SUB DIVISION OF HOUSE SITES IN S.Nos. 449/1A3B1, 466/3A1 & 3A2 OF NEDUNGUNDRAM VILLAGE.

SCALE-1:800 (ALL MEASUREMENTS ARE IN METRE)