

TOTAL EXTENT (AS PER DOCUMENT) : 3989 SQ.M
ROAD AREA : 1470 SQ.M
PUBLIC PURPOSE AREA (1%) : 26 SQ.M
(P.P-1 HANDED OVER TO THE LOCAL BODY 0.5% AREA : 13.0 SQ.M)
(P.P-2 HANDED OVER TO THE TANGEDCO 0.5% AREA : 13.0 SQ.M)
REGULAR PLOTS (1 TO 28) : 28 Nos.
E.W.S PLOTS (114SQ.M) (29,30) : 2 Nos.
TOTAL NO.OF.PLOTS : 30 Nos.

NOTE:

1. SPLAY-1.5MX1.5M
2. MEASUREMENTS ARE INDICATED EXCLUDING SPLAY DIMENSION
3.

| | | | |
|--|---|---|---|
| | ROAD AREA | } | WERE HANDED OVER TO THE LOCAL BODY VIDE GIFT DEED DOCUMENT NO. 15725/2024 , DATED:05.11.2024 , @ SRO AVADI. |
| | PUBLIC PURPOSE AREA-1 | | |
| | PUBLIC PURPOSE AREA-2 (RESERVED FOR TANGEDCO) | | |

CONDITIONS :

(I)TNCDBR-2019, RULE NO : 47 (9)

THE OWNER OR DEVELOPER OR PROMOTER SHALL SELL THE EWS PLOTS ONLY FOR EWS PURPOSE. NO CONVERSION OR AMALGAMATION SHALL BE PERMISSIBLE IN THE CASE OF EWS PLOTS.

(II)TNCDBR-2019, RULE NO: 47 (11)

THE COST OF LAYING IMPROVEMENTS TO THE SYSTEMS IN RESPECT OF ROAD, WATER SUPPLY, SEWERAGE, DRAINAGE OR ELECTRIC POWER SUPPLY THAT MAY BE REQUIRED AS ASSESSED BYTHE CONCERNED AUTHORITY, NAMELY, THE LOCAL BODY AND TAMIL NADU ELECTRICITY BOARD, SHALL BE BORNE BY THE APPLICANT.

(III) THE APPLICANT IS RESPONSIBLE FOR THE SHAPE,SIZE & DIMENSIONS OF THE SITE UNDER REFERENCE.

⊙NECESSARY SPACE FOR BUILDING LINE TO BE LEFT AS PER THE RULE IN FORCE WHILE TAKING UP DEVELOPMENT IN EVERY PLOT

LEGEND :

- SITE BOUNDARY
- ROADS GIFTED TO LOCAL BODY
- EXISTING ROAD
- PUBLIC PURPOSE-1 GIFTED TO LOCAL BODY
- PUBLIC PURPOSE-2 GIFTED TO LOCAL BODY (FOR TANGEDCO)
- EWS

This Planning Permission Issued under New Rule TNCDBR.2019 is subject to final outcome of the W.P(MD) No.8948 of 2019 and WMP (MD) Nos. 6912 & 6913 of 2019.

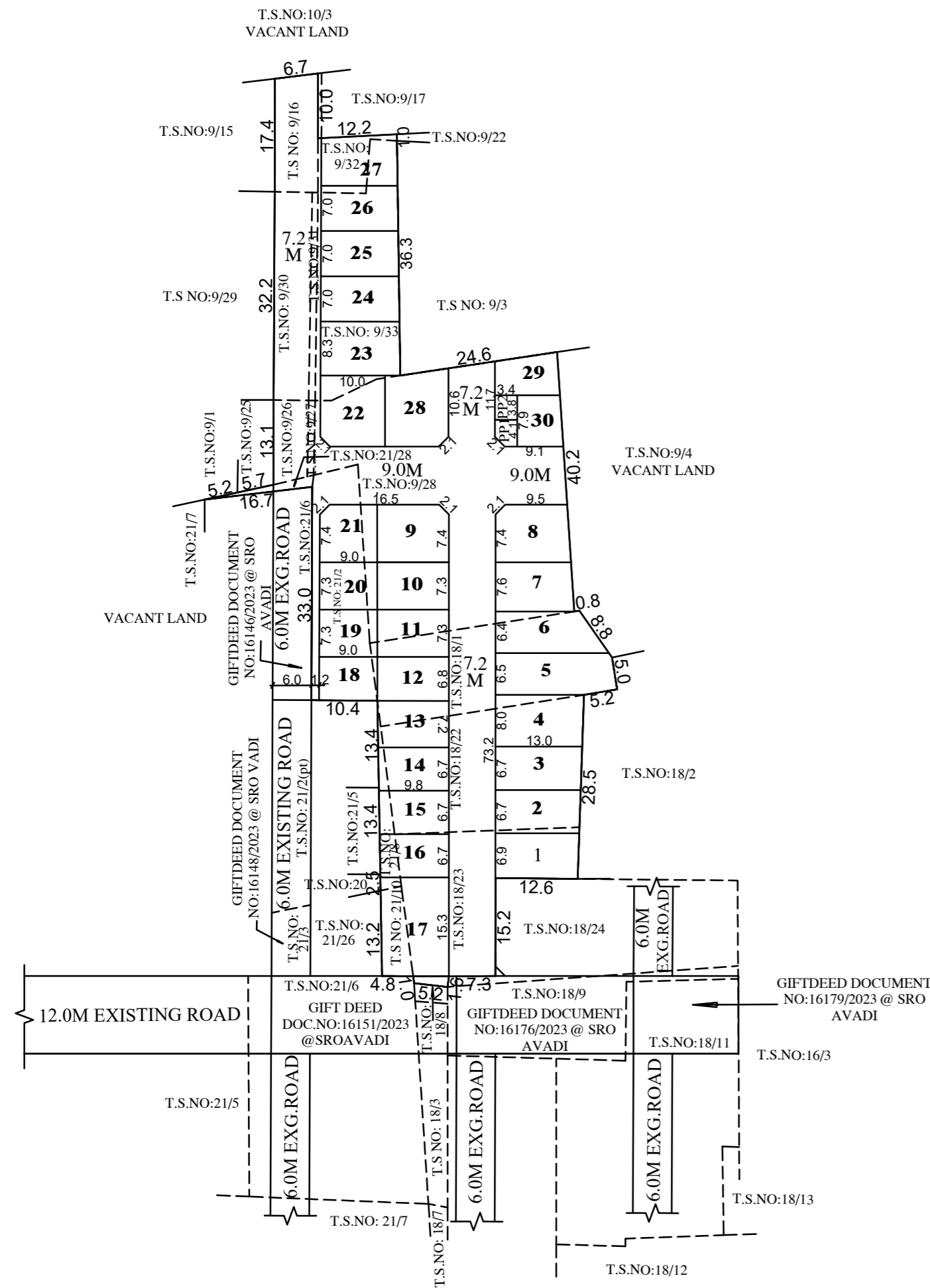

CONDITION:
 THE LAYOUT APPROVED IS VALID SUBJECT TO OBTAINING SANCTION FROM THE LOCAL BODY CONCERNED.

P.P.D NO : 248
L.O 2024

APPROVED

VIDE LETTER NO : LAYOUT-1 / 0151 / 2024
 DATE : 13 / 11 / 2024

OFFICE COPY

FOR CHIEF PLANNER (LAYOUT)
 CHENNAI METROPOLITAN
 DEVELOPMENT AUTHORITY

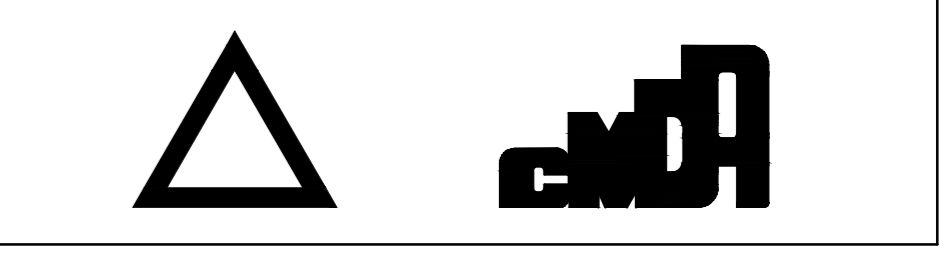

AVADI CORPORATION

LAYOUT OF HOUSE SITES IN T.S.Nos: 9/16, 9/26, 9/27, 9/28, 9/30, 9/31, 9/32, 9/33, 18/1, 18/22, 18/23, 21/2, 8, 10 & 21/28 (OLD S.Nos: 566/2A, 566/2B, 566/2C, 568/1B,2, 572/1,2) WARD - I, BLOCK No.86 OF PARUTHIPATTU VILLAGE.

SCALE-1:800 (ALL MEASUREMENTS ARE IN METRE)